



 JURALCO

## JURALCO SCOPEDOR SHOWER DOOR SYSTEM

ISSUE 1/16

## Juralco Scopedor Shower Door System

Juralco Aluminium Building Products Ltd designs and distributes specialist aluminium joinery systems through a national network of franchised fabricators and agents.

For more than 25 years we have been at the forefront of specialist aluminium door and window products suitable for New Zealand joinery and building methods. Our comprehensive product range includes security and insect screens, balustrades and gates, shutters and awnings, shower screens, wardrobe doors and organisers and internal doors.6

The Juralco Scopedor Shower Door system is ideal for any sized bathroom; the Scopedor frame provides colour as well as the practicality of a watertight seal.

The adjustable-width opening means that even the most out-of plumb walls can be effectively compensated for fitting comfortably into your bathroom's specifications. The Scopedor can be floor mounted with a bottom rail or custom-made without, making it suitable for level entry disabled access. The only fittings on the frameless door panel are small elegant Tee handles and a pair of pivots making it very easy to clean.

The Scopedor is available in standard sizes each expanding up to 70mm and is fully reversible for either right or left-hand opening. Choose from our range of standard sizes or have one custom-made to suit your bathroom.

This Guide is intended for use by Architects, Specifiers and Fabricators  
Pages 2-3 covers areas of general interest. Pages 4 onwards are intended for Fabricators.

### Layouts

Shown below are the three layout possibilities for the Scopedor Shower Door System

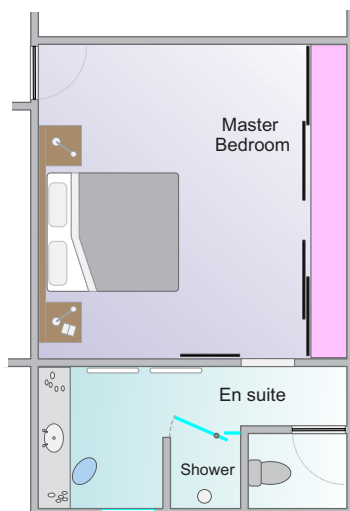

**Juralco Scopedor Shower Door System**  
Pivot Door and fixed Panel

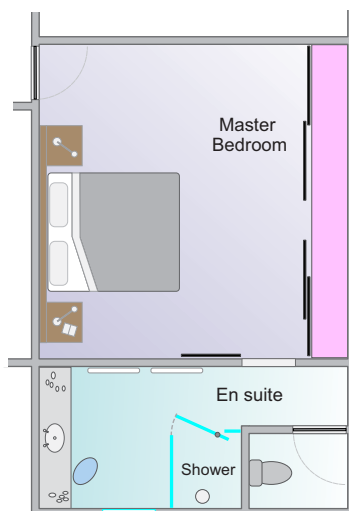

**Juralco Scopedor Shower Door System**  
Pivot Door, fixed Panel and 90 deg glass Return

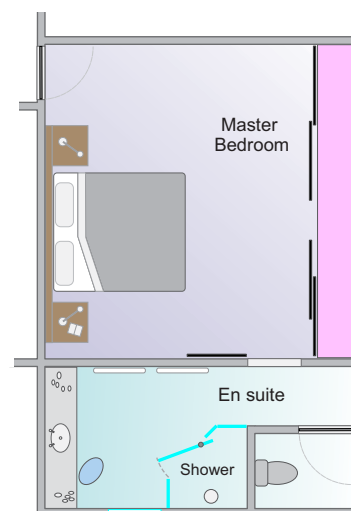

**Juralco Scopedor Shower Door System**  
Pivot Door, fixed panel and 2 x 45 deg glass Returns

## Juralco Scopedor Shower Door System

### General Description

- The Scopedor Shower Pivot Door system is designed to provide a range of adjustable doors to suit standard openings.
- Variations can be made to suit special requirements not covered within the standard range.
- All doors are constructed from our propriety range of aluminium extrusions.
- Pivot Doors are 6mm and Return Fixed Panels 4mm toughened glass, to NZS 4233 Part 3 for human impact requirements.
- Glass stocked as Standard Clear. Available to special order - Frosted or Patterned.
- Installation system copes with out of plumb walls.
- Available in White powdercoat or Anodised polished bright or natural .
- Designed for installation with standard Shower trays, or direct on to suitable flooring.

### Size Range

To Specify select appropriate Door and Return sizes, together with colour

Note - Standard height is 1830mm, some models available at 1930mm high.

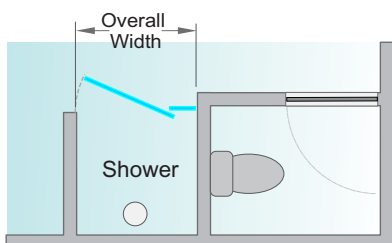

Juralco Scopedor Shower Door System  
Pivot Door and fixed Panel

Scope	Standard	Overall Width		Door Entry
Model	Height	Min	Max	Width
640 Door	1830	640	680	440
700 Door	1830	700	780	475
780 Door	1830/1930	780	860	500
860 Door	1830/1930	860	930	560
930 Door	1830	930	1000	610
950 Door	1930	950	1020	640
1170 Door	1830/1930	1170	1240	720

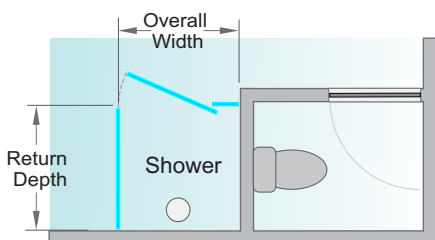

Juralco Scopedor Shower Door System  
Pivot Door, fixed Panel and  
90 deg Return

Scope	Standard	Return Depth		Panel
Model	Height	Min	Max	Depth
670 Return	1830	670	705	630
710 Return	1830	710	745	670
770 Return	1830	770	805	730
790 Return	1830	790	825	750
830 Return	1830	830	865	790
850 Return	1830	850	885	810
870 Return	1830	870	905	830
880 Return	1930	880	915	845
910 Return	1830	910	945	870
950 Return	1830	950	985	910
970 Return	1930	970	1005	930

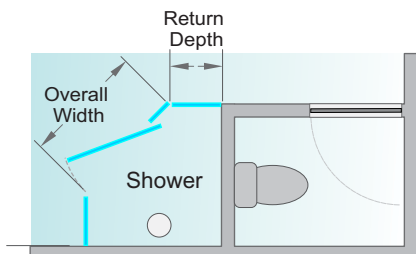

Juralco Scopedor Shower Door System  
Pivot Door, fixed Panel and  
2 x 45 deg Returns

Scope	Standard	Return Depth		Panel
Model	Height	Min	Max	Depth
400 45deg	1830/1930	400	440	394
460 45deg	1830/1930	460	480	452

Note - Also available as complete custom build





## Juralco Scopedor Shower Door System - Extrusions

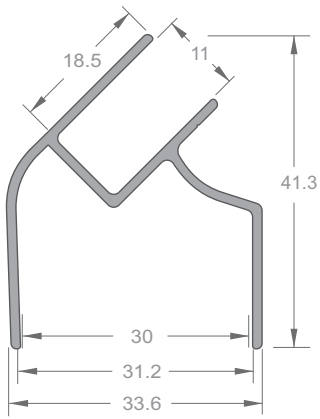

**45 DEG JAMB**  
Part No 6676  
( ID at front, compress to 30mm)

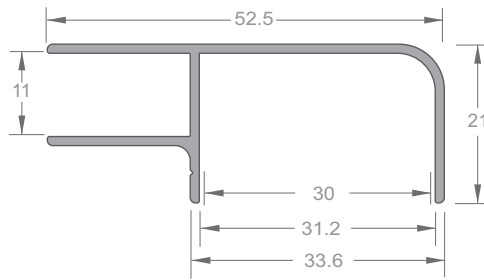

**90 DEG JAMB**  
Part No 6674  
( ID at front, compress to 30mm)

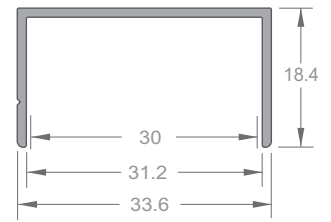

**JAMB CAP**  
Part No 6675  
( ID at front, compress to 30mm)

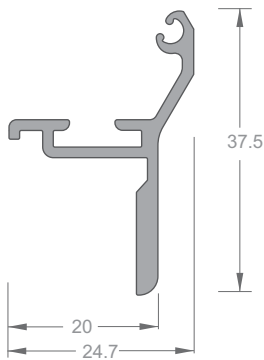

**STRIKER**  
Part No 2989

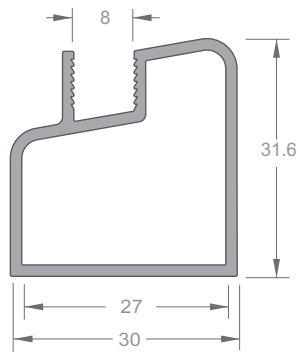

**FIXED PANEL JAMB,  
OUTER RAIL**  
Part No 6678

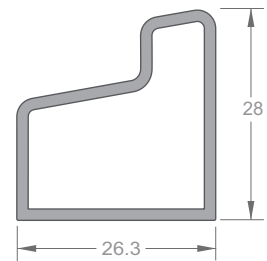

**PLAIN JAMB,  
INNER RAIL**  
Part No 6677

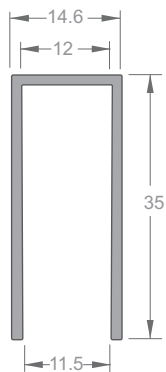

**RETURN WALL CHANNEL**  
Part No 3838

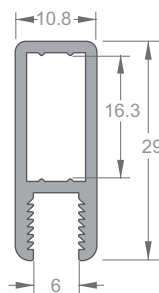

**RETURN FRAME**  
Part No 6679

# Juralco Scopedor Shower Door System - Components

**Pivot Block Set**  
Part No EX 03

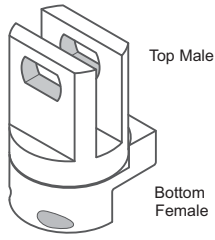

**Pivot Block Cover**  
Part No EX 06

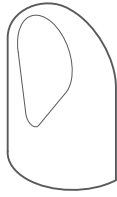

**Pivot Spacer Set**  
Part No EX 03

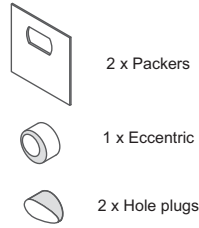

**Pivot Screw**  
Part No EX 12

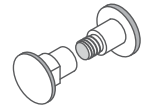

**Corner Stake**  
Part No 04

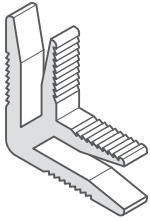

**Corner Block, Large**  
Part No SU 30/LG

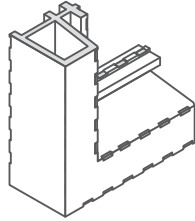

**Corner Block, Small**  
Part No SU 30/SM

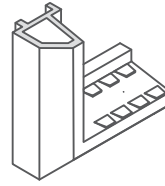

**6677 Inner Rail End caps**  
Part No EX 08

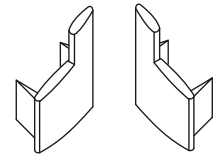

Available only as LH and RH pair

**Door set up Block**  
Part No Scope /AJD

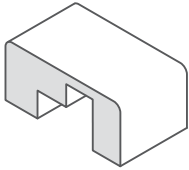

**Bulb Seal, white**  
Part No EX 09

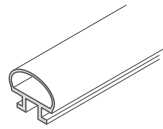

**Glazing Wedge, clear**  
Part No 31

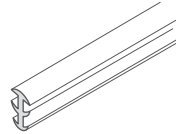

**Bumper, clear**  
Part No EX 07

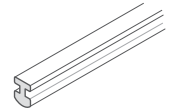

**Splash Strip, clear**  
Part No EX 10

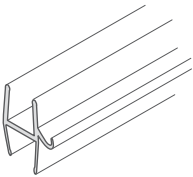

**Fasteners**

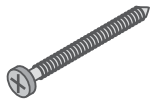

Attach to Walls 8 x 38 Pan SS

**Pivot Lube**  
Part No J/LUBEWT90



Lubricate all Pivots with WT90

**Door Handle**  
Part No 77

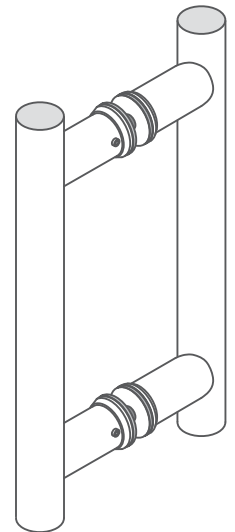

**45 deg Top Bracket**  
Part No EX 20

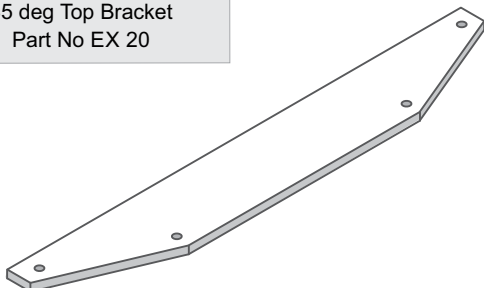

**Knob Set**  
Part No 75

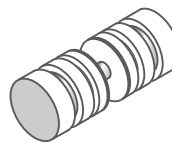

For 6 - 10mm Glass



# Juralco Scopedor Shower Door System - Typical Cross Sections

## Typical Horizontal Cross Section

### Pivot Door and Fixed Panel

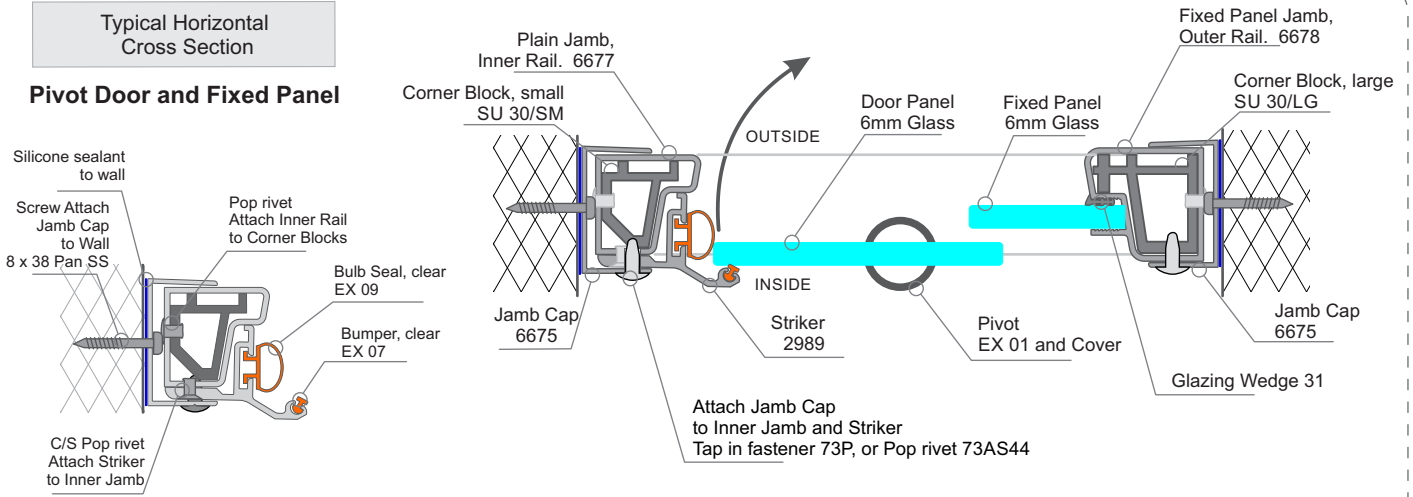

General Attach and Sealing Details

Note - All Pivots to be lubricated with WT90

## Typical Horizontal Cross Section

### Pivot Door, Fixed Panel and 90deg Return

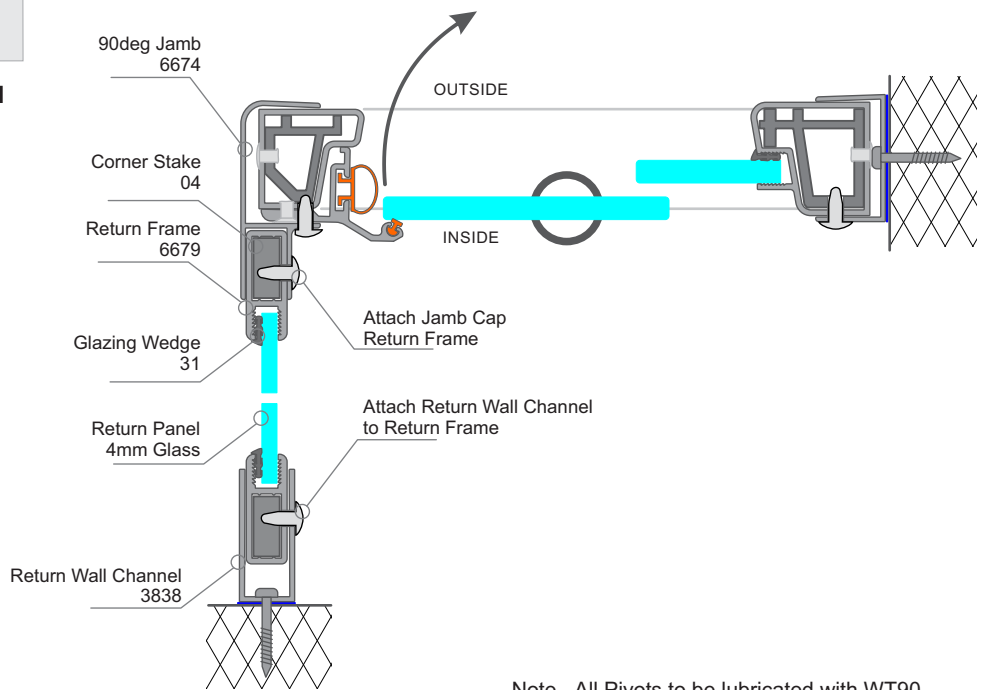

Note - All Pivots to be lubricated with WT90

## Typical Horizontal Cross Section

### Pivot Door, Fixed Panel and 2 x 45deg Returns

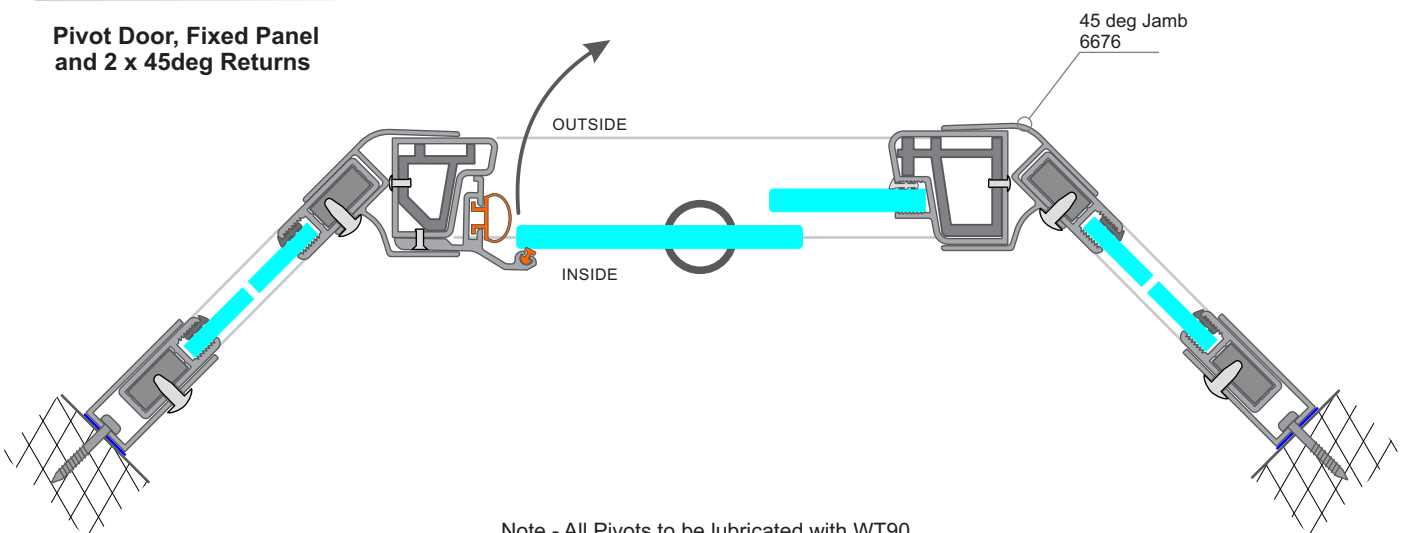

Note - All Pivots to be lubricated with WT90

## Juralco Scopedor Shower Door System - Measuring, Selecting Kits

Measuring  
Pivot Door and Fixed Panel

Note - Standard height 1830mm,  
some models available at 1930mm high.

Scope	Standard	Overall	Width	Door Entry
Model	Height	Min	Max	Width
640 Door	1830	640	680	440
700 Door	1830	700	780	475
780 Door	1830/1930	780	860	500
860 Door	1830/1930	860	930	560
930 Door	1830	930	1000	610
950 Door	1930	950	1020	640
1170 Door	1830/1930	1170	1240	720

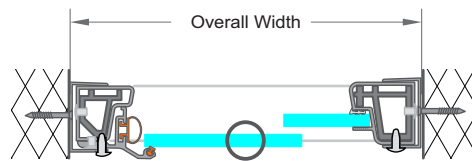

Note - Also available as complete custom build

Measuring, Selection  
Pivot Door, Fixed Panel  
and 90 deg Return

Note - Standard height 1830mm,  
some models available at 1930mm high.

Scope	Standard	Return	Depth	Panel
Model	Height	Min	Max	Depth
670 Return	1830	670	705	630
710 Return	1830	710	745	670
770 Return	1830	770	805	730
790 Return	1830	790	825	750
830 Return	1830	830	865	790
850 Return	1830	850	885	810
870 Return	1830	870	905	830
880 Return	1930	880	915	845
910 Return	1830	910	945	870
950 Return	1830	950	985	910
970 Return	1930	970	1005	930

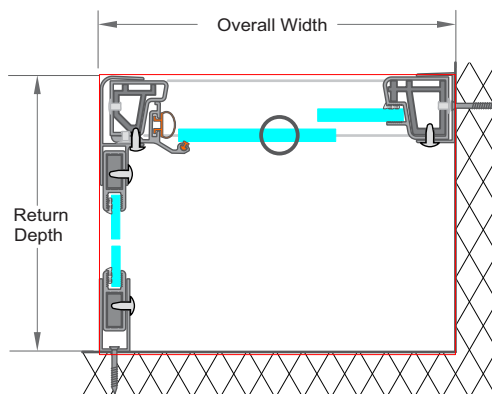

Note - Also available as complete custom build

Measuring, Selection  
Pivot Door, Fixed Panel  
and 2 x 45 deg Returns

Note - Standard height 1830mm,  
both models available at 1930mm high.

Scope	Standard	Return	Depth	Panel
Model	Height	Min	Max	Depth
400 45deg	1830/1930	400	440	394
460 45deg	1830/1930	460	480	452

To Calculate Approx Dimension D, using  
Door and Returns in middle of adjustment range

Return	Door	Square
RT	W	D
420	670	890
420	740	940
420	820	1000
420	900	1060
420	970	1100
420	985	1120
420	1200	1270
470	670	940
470	740	990
470	820	1050
470	900	1100
470	970	1160
470	985	1170
470	1200	1320

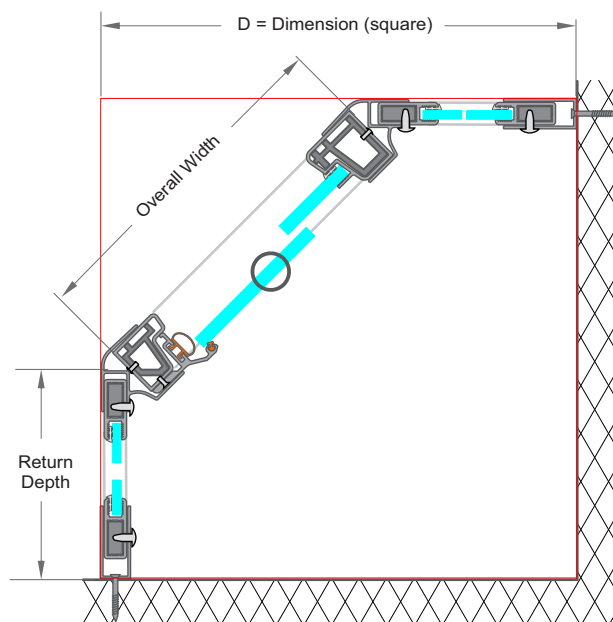

Note - Also available as complete custom build

# Juralco Scopedor Shower Door System - Glass for Kits

## Glass Order

### For Scope 640 Door

#### Glass Door

Glass - 6mm Toughened  
Holes - 4 x 12mm dia  
Edges - Polish all four

#### Glass Panel

Glass - 6mm Toughened  
Edges - Polish 1 x long side only, rough arris others

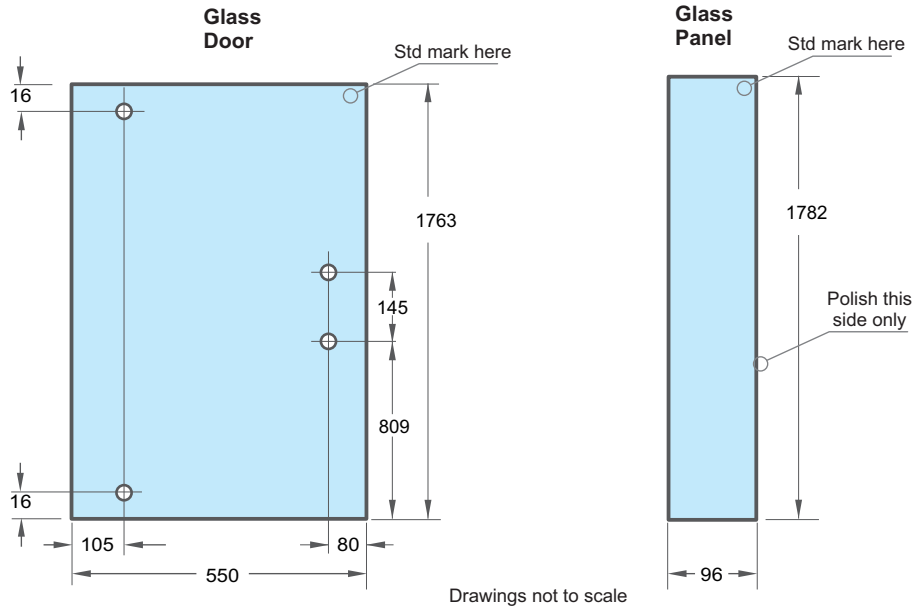

Note - All Glass must have Toughened Safety Glass Stamp

Drawings not to scale

## Glass Order

### For Scope 700 Door

#### Glass Door

Glass - 6mm Toughened  
Holes - 4 x 12mm dia  
Edges - Polish all four

#### Glass Panel

Glass - 6mm Toughened  
Edges - Polish 1 x long side only, rough arris others

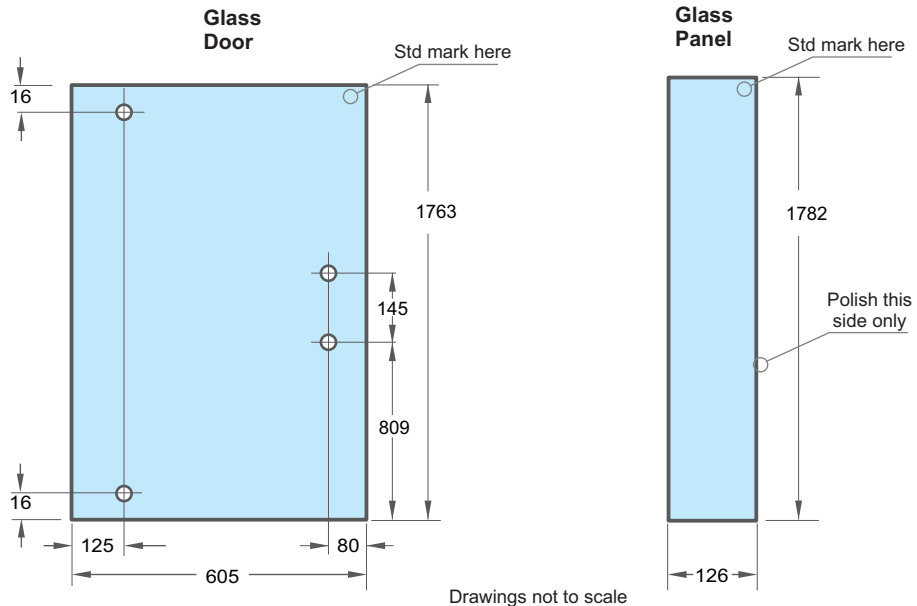

Note - All Glass must have Toughened Safety Glass Stamp

Drawings not to scale

## Glass Order

### For Scope 780 Door

#### Glass Door

Glass - 6mm Toughened  
Holes - 4 x 12mm dia  
Edges - Polish all four

#### Glass Panel

Glass - 6mm Toughened  
Edges - Polish 1 x long side only, rough arris others

#### Note

Choice of two Heights

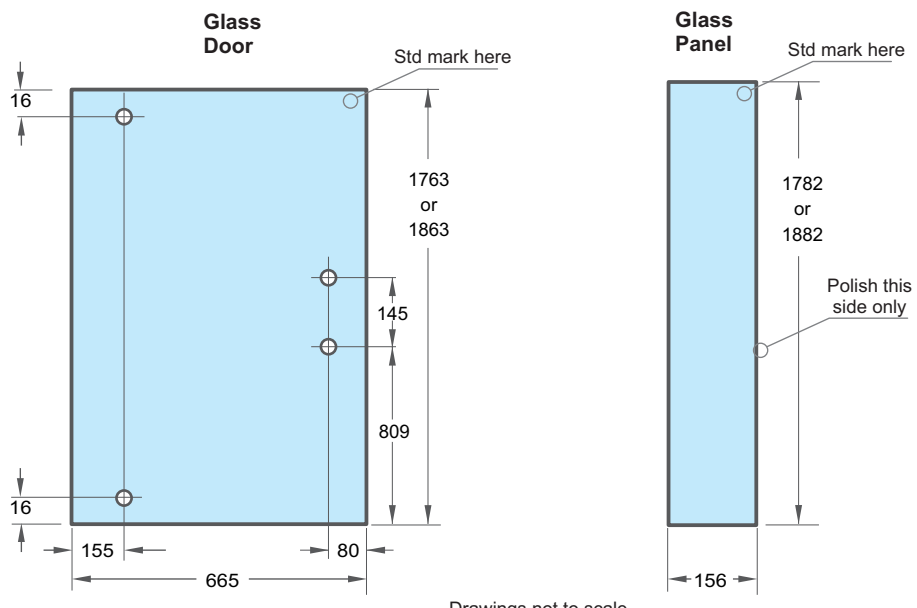

Note - All Glass must have Toughened Safety Glass Stamp

Drawings not to scale



# Juralco Scopedor Shower Door System - Glass for Kits

## Glass Order

### For Scope 860 Door

#### Glass Door

Glass - 6mm Toughened  
Holes - 4 x 12mm dia  
Edges - Polish all four

#### Glass Panel

Glass - 6mm Toughened  
Edges - Polish 1 x long  
side only, rough arris others

#### Note

Choice of two Heights

Note - All Glass must have  
Toughened Safety Glass Stamp

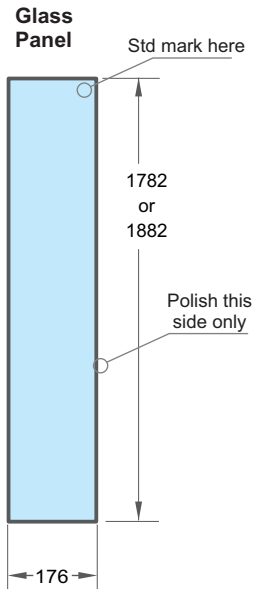
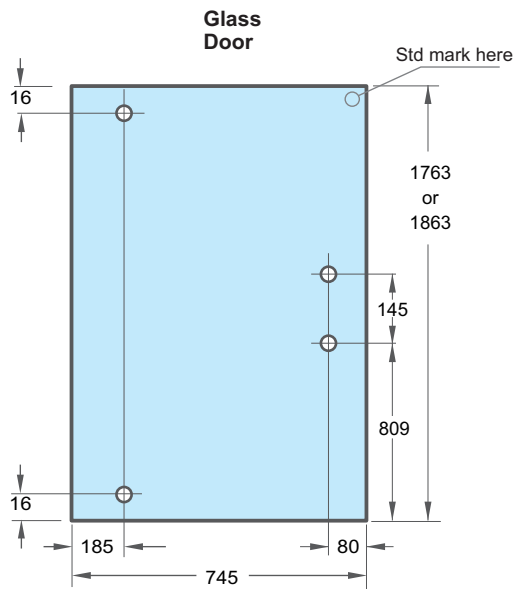

Drawings not to scale

## Glass Order

### For Scope 930 Door

#### Glass Door

Glass - 6mm Toughened  
Holes - 4 x 12mm dia  
Edges - Polish all four

#### Glass Panel

Glass - 6mm Toughened  
Edges - Polish 1 x long  
side only, rough arris others

Note - All Glass must have  
Toughened Safety Glass Stamp

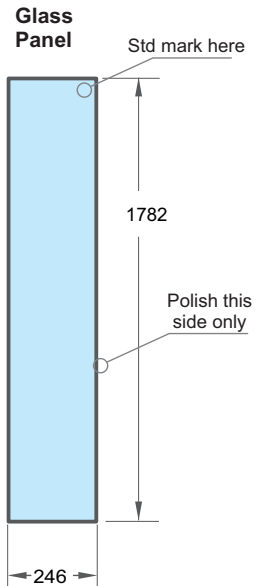
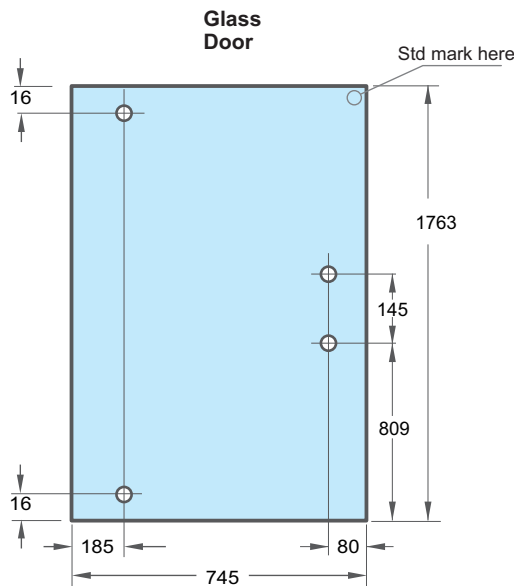

Drawings not to scale

## Glass Order

### For Scope 950 Door

#### Glass Door

Glass - 6mm Toughened  
Holes - 4 x 12mm dia  
Edges - Polish all four

#### Glass Panel

Glass - 6mm Toughened  
Edges - Polish 1 x long  
side only, rough arris others

Note - All Glass must have  
Toughened Safety Glass Stamp

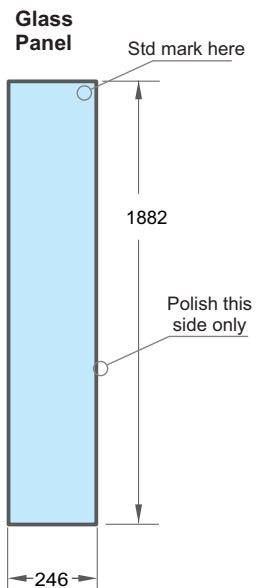
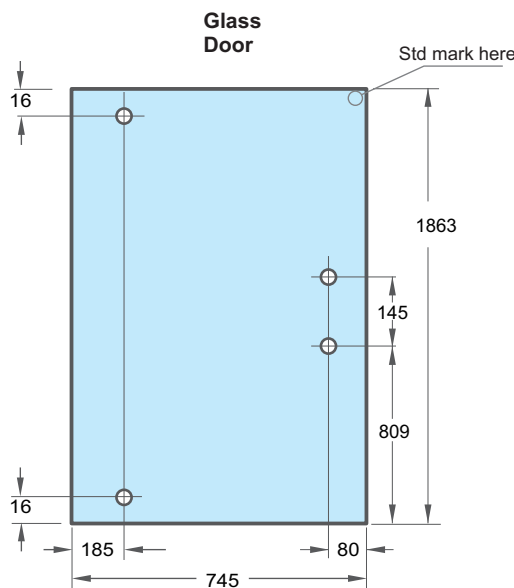

Drawings not to scale



**JURALCO**

www.juralco.co.nz ph (09) 478 8018

**Juralco Scopedor Shower Door System**

Issue 1/16

Page 9

# Juralco Scopedor Shower Door System - Glass for Kits

## Glass Order

### For Scope 1170 Door

#### Glass Door

Glass - 6mm Toughened  
Holes - 4 x 12mm dia  
Edges - Polish all four

#### Glass Panel

Glass - 6mm Toughened  
Edges - Polish 1 x long side only, rough arris others

#### Note

Choice of two Heights

Note - All Glass must have Toughened Safety Glass Stamp

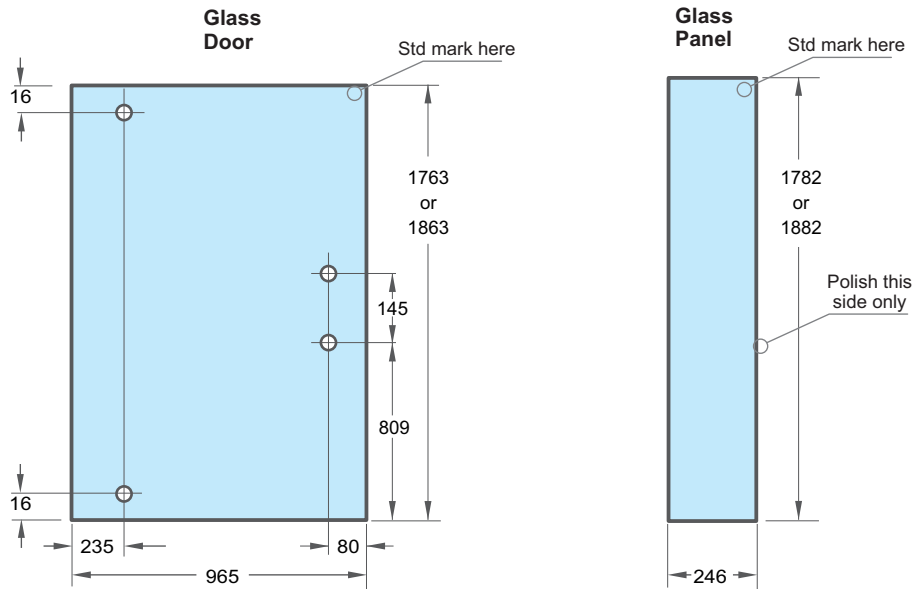

Drawings not to scale

## Glass Order

### 45 and 90 deg Return Glass Panel

#### Glass Panel

Glass - 4mm Toughened  
Edges - Rough arris all edges

90 deg RETURNS	W	H
Scope 670 Return	588	1782
Scope 710 Return	628	1782
Scope 770 Return	688	1782
Scope 790 Return	708	1782
Scope 830 Return	748	1782
Scope 850 Return	768	1782
Scope 870 Return	788	1782
Scope 880 Return	798	1882
Scope 910 Return	828	1782
Scope 950 Return	868	1782
Scope 970 Return	888	1882

2 x 45 deg RETURNS	W	H
Scope 400 45deg Return	348	1782/1882
Scope 460 45deg Return	408	1782/1882

Note - All Glass must have Toughened Safety Glass Stamp

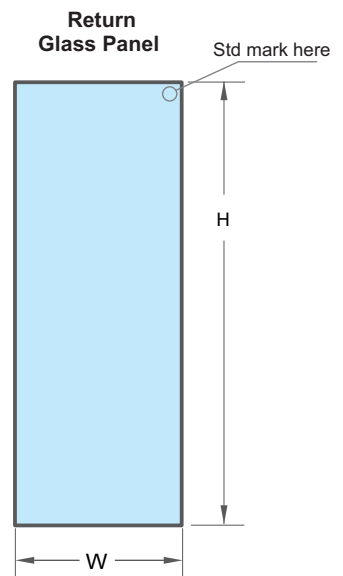

Drawings not to scale

## Glass Order and Cutting

Standard unit height = 1830mm

### Non Standard Heights

Overall Height = OH	
Door Glass	OH - 67mm
Fixed Door Glass	OH - 46mm
Returns Glass	OH - 46mm

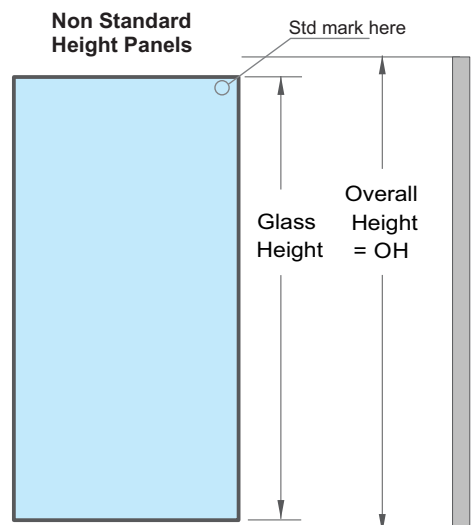

Note - All Glass must have Toughened Safety Glass Stamp

Drawings not to scale

## Juralco Scopedor Shower Door System - Extrusion for Kits

### Extrusion Cutting Door

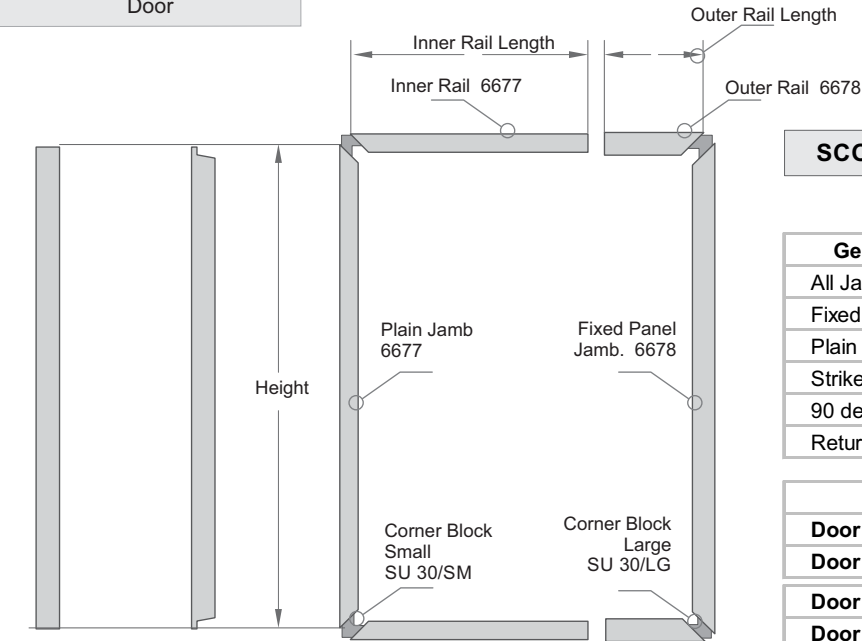

All General Extrusions  
Square ends

Striker 2989  
Notch Ends

Door Extrusions  
Miter and square ends

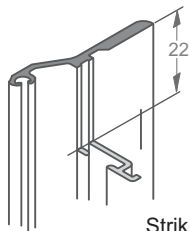

Striker 2989  
Notch Ends

### SCOPEODOR CUTTING CALCULATIONS

Note - Choose appropriate height

General Extrusions	Part No	Height
All Jamb Caps	6674,5,6	1830/1930
Fixed Panel Jamb	6678	1830/1930
Plain Jamb	6677	1830/1930
Striker	2989	1830/1930
90 deg Return Frame	6679	1830/1930
Return Wall Channel	6675	1830/1930

Extrusions	Part No	Length
Door 640 - Outer Rail	6678	120
Door 640 - Inner Rail	6677	580
Door 700 - Outer Rail	6678	150
Door 700 - Inner Rail	6677	635
Door 780 - Outer Rail	6678	180
Door 780 - Inner Rail	6677	695
Door 860 - Outer Rail	6678	200
Door 860 - Inner Rail	6677	775
Door 930 - Outer Rail	6678	270
Door 930 - Inner Rail	6677	775
Door 950 - Outer Rail	6678	270
Door 950 - Inner Rail	6677	775
Door 1170 - Outer Rail	6678	270
Door 1170 - Inner Rail	6677	995

Note - Also available as complete custom build

### Extrusion Cutting Returns

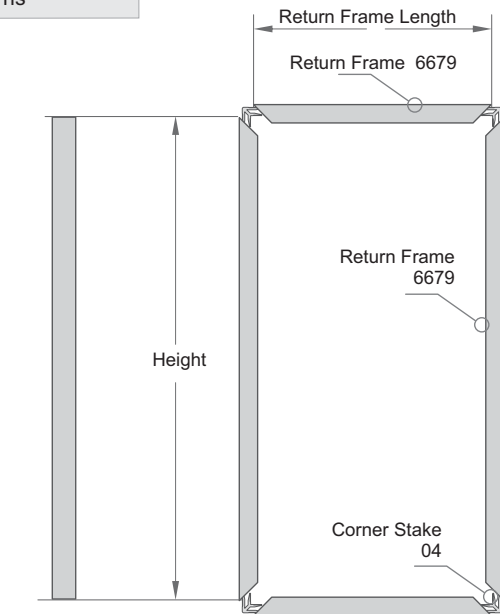

All General Extrusions  
Square ends

Return Extrusions  
Miter ends

### SCOPEODOR CUTTING CALCULATIONS

Extrusions	Part No	Length
Return 670 - Rail	6679	630
Return 710 - Rail	6679	670
Return 770 - Rail	6679	730
Return 790 - Rail	6679	750
Return 830 - Rail	6679	790
Return 850 - Rail	6679	810
Return 870 - Rail	6679	830
Return 880 - Rail	6679	840
Return 910 - Rail	6679	870
Return 950 - Rail	6679	910
Return 970 - Rail	6679	930

45 deg Return 400 - Rail	6679	394
45 deg Return 460 - Rail	6679	452

Note - Also available as complete custom build

# Juralco Scopedor Shower Door System - Extrusion for Custom Builds

Glass and Extrusion Cutting Allowances for Custom Builds

All Horizontal Measurements

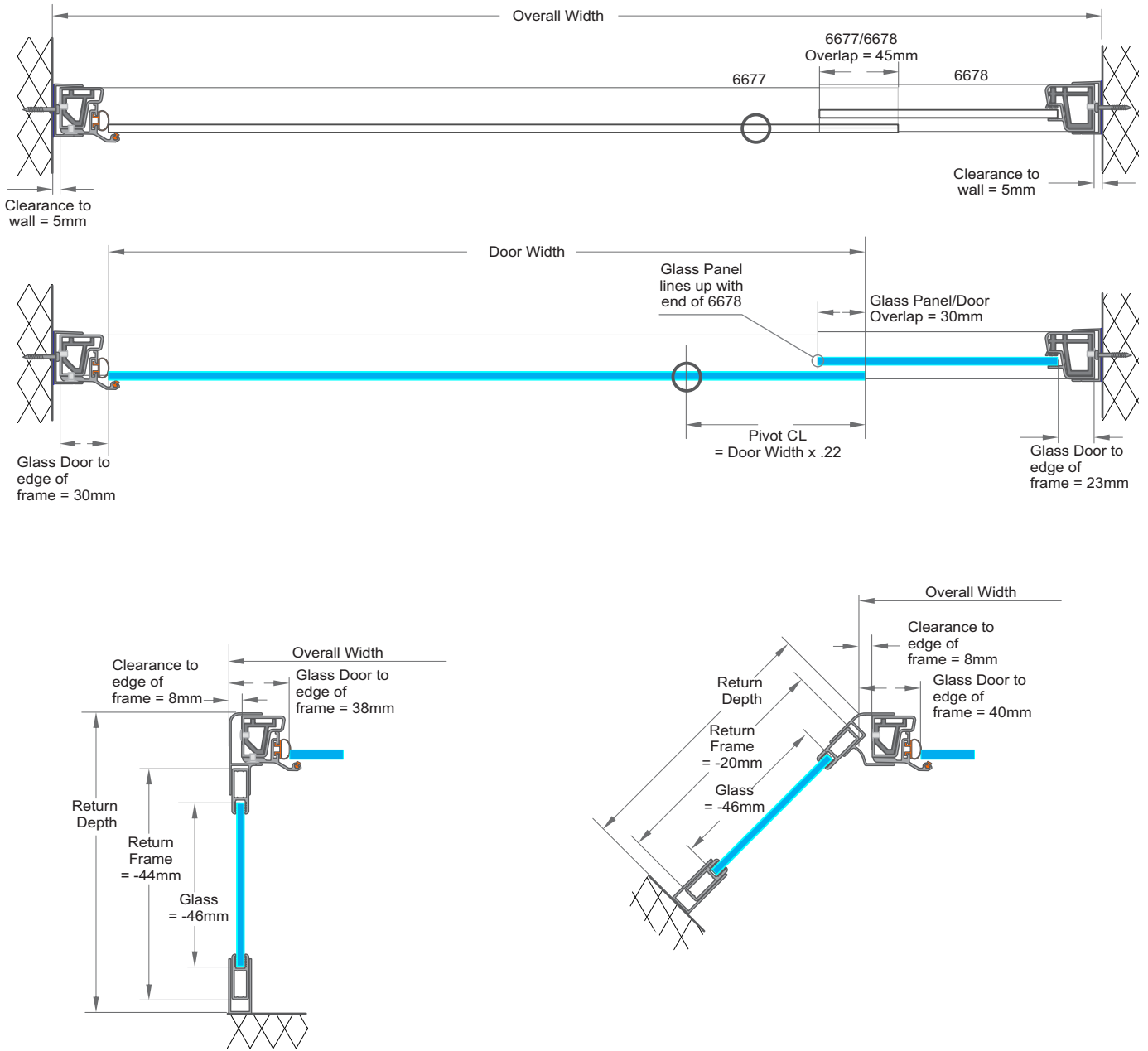

Glass and Extrusion Cutting Allowances for Custom Builds

All Vertical Measurements

Overall Height = OH	
Door Glass	OH - 67mm
Fixed Door Glass	OH - 46mm
Returns Glass	OH - 46mm
Door, Return Extrusions	OH

## Juralco Scopedor Shower Door System - Assembly

### Frame, Doors Assembly

**Note: Prior to delivering to site, unpack and check all items**

Note - Check all Glass is marked with Toughened Safety Glass Stamp

- 1 - Inspect all extrusions for damage, surface defects. Assemble all necessary components. Ensure workplace is clean.
- 2 - Join the 6678 mitered corners using the SU 30/LG corner blocks. Pop rivet in place.
- 3 - Join the 6677 mitered corners using the SU 30/SM corner block. Pop rivet in place.
- 4 - File smooth the inside surfaces of the square cut 6678 rails and the outsides of the square cut 6677 rails.
- 5 - Install the glass into the 6678 channels and glaze on outside face using the 31 clear wedge, polished edge to outside.
- 6 - Check the 6677 frame inner rails will slide smoothly into the fixed panel 6678 extrusion.
- 7 - Mount striker 2989 on to outer frame 6677 after fitting EXO7 clear bumper and EXO9 bulb seal to striker. Attach striker to 6677 using 73AS44 counter sunk rivets. Ensure striker is flush with outer frame. Attach Door set out block ADJ to inner frame with masking tape.
- 8 - Lay out 6 mm glass door panel and check top and bottom widths and height are correct.
- 9 - Fit 2 x pivot block assemblies EX 01 to the 12mm holes in the door :  
Assemble the Pivot Spacer set EX 03, the Pivot Block Set EX 01, on to the glass Door using the Pivot Screw EX 12, Screw head to inside. Top and Bottom.
- 10 - Lay the door glass panel square onto the frame allowing the leading edge of the glass to compress the striker plate bulb seal about 1mm. The female parts of Pivot Block Set EX 01 should line up with the 6677 rails.
- 11 - Ensure that they are correctly seated before drilling through appropriate holes and riveting (using a long nosed rivet gun) using 73AS4344 monel rivets.
- 12 - Fit EX O3 pivot block plugs into both blocks to conceal rivets.
- 13 - Snap on EXO6 Pivot Block covers.
- 14 - Clean off all fingermarks, pack.

Note - All Pivots to be lubricated with WT90

### Return Assembly

**Note: Prior to delivering to site, unpack and check all items**

Note - Check all Glass is marked with Toughened Safety Glass Stamp

- 1 - Inspect all extrusions for damage, surface defects. Assemble all necessary components. Ensure workplace is clean.
- 2 - Lay out the 4 mm glass return panel and check top and bottom widths and height are correct.
- 3 - Place the 6679 extrusion over the glass. Join the 6679 mitered corners using the 04 corner stakes.
- 4 - Square up then glaze on the outside face using the 31 clear wedge.
- 5 - Clean off all fingermarks, pack.



## Juralco Scopedor Shower Door System - Installation

Installation  
Door only

**Note: Prior to delivering to site, unpack and check all items**

- 1 - Unpack, inspect for damage. Check Door is correct one for this job. Assemble tools.
- 2 - Decide which way the door is to open. Turn over if required to facilitate this. NOTE the door always opens outwards.
- 3 - Fit the Jamb Cap to the wall on the Fixed Panel side of the door using a spirit level to ensure the Jamb Cap is plumb, and fasten with 4 off 8 x 38 mm screws supplied; 50mm from the top, 2 x middle and 100mm from the bottom - evenly spaced. A full bead of silicone sealant should be applied to the back face of the jamb before screwing to wall.

NOTE. The Jamb Cap 6675 for the Fixed Pane Jamb 6678 is 3mm longer than the Jamb Cap for the Plain Jamb 6677.

- 4 - Slide the door into the Jamb Cap 6675 now attached to the wall. Then with the Door Setup Block fitted, (taking the weight of the glass door) and with the other Jamb Cap slipped over the Plain Jamb, expand the door out until it touches the far wall.

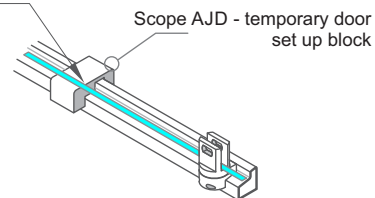
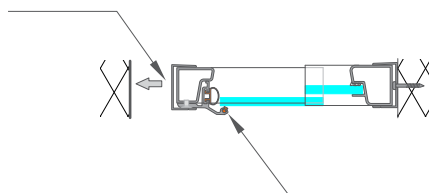

- 5 - Check that the glass Door is touching the Striker Bumper EX 07 and Bulb Seal EX 09 evenly from the top of the door to the bottom. Run a pencil line down the wall beside the Jamb Cap, then compress the door and remove.
- 6 - Remove the Jamb Cap from the closing side of the door and screw it to the wall (as in 3 above), using the pencil line as a guide. Expand the door out again into the Jamb Cap.



NOTE. When expanding the door into the Jamb Caps it should be remembered that if any wall is not plumb, that the Jamb Caps take up this out of plumb, not the door!!!

- 7 - With the door expanded into the Jamb Caps and the Door Setup Block still fitted, drill through the top of the door with a 4.2mm drill bit, then drive in a plastic rivet with a hammer. Open the door, remove the Adjustor Block and check that the door opens and closes and that the top edge of the Door Panel is level with the head Rail.
- 8 - After checking the door operation, drill through the Sill and plastic rivet in place.
- 9 - After rechecking the door, drill a 4.2mm hole through the Jamb Caps into the Fixed Panel Jamb, and Plain Jamb on the inside of the Shower Enclosure. Then place the plastic rivet into the hole and strike with a hammer to set the rivet. Rivet the Jamb in three places, 100mm from the top, middle and 100mm from the bottom.

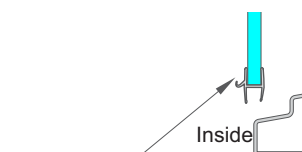

- 10 - Remove the AJD set up block. Attach the Splash strip EX 10 to the bottom of the Door, to both sides of the Pivot. Hook to inside.
- 11 - Apply Silicon Sealer around all of the outside joints of the Shower Door Frame and Jamb Caps. Take special care not to get silicon on clothing or any areas other than joints as above. If you get the sealer smeared anywhere on the frame, wipe it off with a clean dry cloth, then clean off residue with a cloth moistened with methylated spirits.  
NOTE. Once the silicon has set, it is not possible to clean it off!!!
- 12 - The closing adjustment on the Shower Door is preset at the factory, (Glass door edge compresses the Bulb Seal) but if after fitting you find that the door is binding or alternatively is not staying shut, the following adjustment can be made:  
- When the door is fully closed it is held shut by the round sealing strip. Loosen the top and bottom Pivot Screws half to one full turn. Then tap the door in or out with the palm of the hand until the correct closing action is achieved. Retighten the Pivot Screws.
- 13 - Clean off all fingermarks, leave site tidy and clean.

## Juralco Scopedor Shower Door System - Installation

Installation  
Door + 90 deg Return

**Note: Prior to delivering to site, unpack and check all items**

See previous page for General Door Assembly

- 1 - Unpack, inspect for damage. Check Door and Return are correct ones for this job. Assemble tools.
- 2 - Decide which way the door is to open. Turn over if required to facilitate this. NOTE the door always opens outwards.
- 3 - Fit the Jamb Cap to the wall on the Fixed Panel side of the door using a spirit level to ensure the Jamb Cap is plumb, and fasten with 4 off 8 x 38 mm screws supplied; 50mm from the top, 2 x middle and 100mm from the bottom - evenly spaced. A full bead of silicone sealant should be applied to the back face of the jamb before screwing to wall
- 4 - Slide the door into the Jamb Cap 6675 now attached to the wall. Then with the door Door Setup Block fitted, (taking the weight of the glass door) expand the door out to the desired dimension (Stage 1).

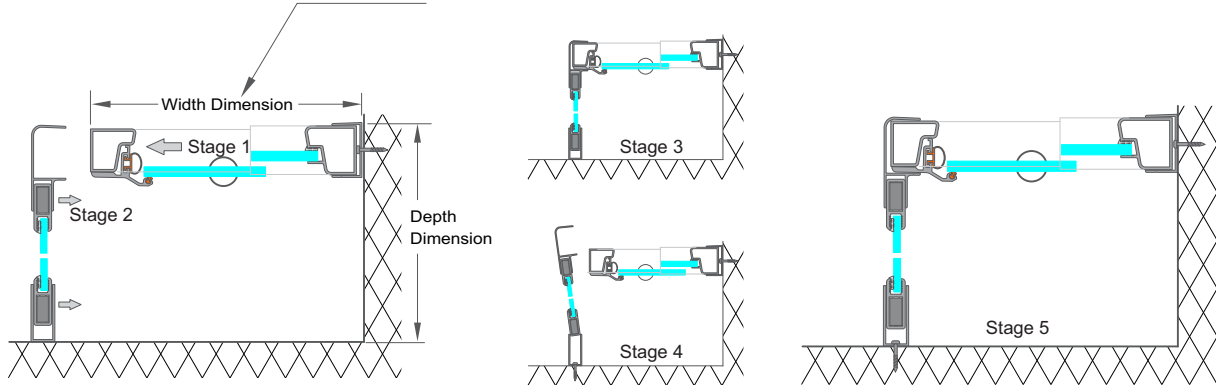

- 5 - Now present the Return panel, complete with 90 deg Jamb, and Return Wall Channel, to the Door unit (Stage 2). Check that the glass Door is touching the Striker Bumper EX 07 and Bulb Seal EX09 evenly from the top of the door to the bottom.
- 6 - Making sure the Return Wall Channel is plumb, mark its position on the wall with a pencil line (Stage 3).
- 7 - Compress the door and remove the 90 deg Jamb Cap and Return Panel. Screw the Return Wall Channel to the wall (as in 3 above), using the pencil line as a guide (Stage 4).
- 8 - Reassemble, expand the door out again into the 90 deg Jamb Cap (Stage 5).  
NOTE. When expanding the door into the Jamb Caps it should be remembered that if any wall is not plumb, that the Jam Caps take up this out of plumb, not the door!!!
- 9 - With the door expanded into the Jamb Caps and the Door Setup Block still fitted, drill through the top of the door with a 4.2mm drill bit, then drive in a plastic rivet with a hammer. Open the door, remove the Adjustor Block and check that the door opens and closes and that the top edge of the Door Panel is level with the head Rail.
- 10 - After checking the door operation, drill through the Sill and plastic rivet in place.
- 11 - After rechecking the door, drill 4.2mm holes on the inside of the Shower Enclosure as below. Then place the plastic rivets into the holes and strike with a hammer to set the rivet. Rivet the Jamb in three places, top, middle and the bottom.

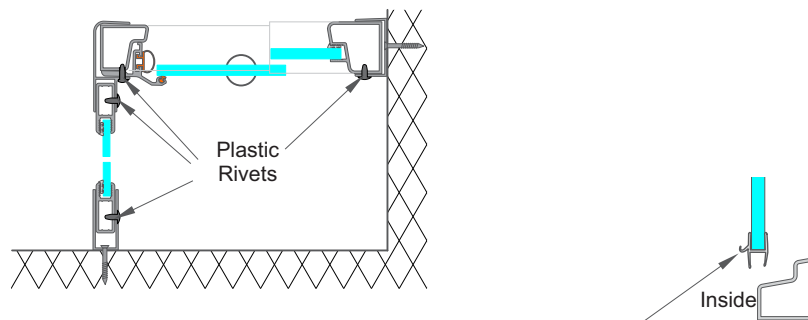

- 12 - Attach the Splash strip EX 10 to the bottom of the Door, to both sides of the Pivot. Hook to inside.
- 13 - Apply NG Silicon Sealer around all of the outside joints of the Shower Door Frame and Jamb Caps. Take special care not to get silicon on clothing or any areas other than joints as above. If you get the sealer smeared anywhere on the frame, wipe it off with a clean dry cloth, then clean off residue with a cloth moistened with methylated spirits.  
NOTE. Once the silicon has set, it is not possible to clean it off!!!
- 14 - The closing adjustment on the Shower Door is preset at the factory, (Glass door edge compresses the Bulb Seal) but if after fitting you find that the door is binding or alternatively is not staying shut, the following adjustment can be made:  
- When the door is fully closed it is held shut by the round sealing strip. Loosen the top and bottom Pivot Screws half to one full turn. Then tap the door in or out with the palm of the hand until the correct closing action is achieved. Retighten the Pivot Screws.
- 15 - Clean off all fingermarks, leave site tidy and clean.

## Juralco Scopedor Shower Door System - Installation

Installation  
Door + 2 x 45 deg Returns

**Note: Prior to delivering to site, unpack and check all items**

See Page 10 for General Door Assembly

- 1 - The installation details are as for Door + 90 deg Return; but the installation sequence is Return1, Door then Return2.
- 2 - Establish if the door opens to right or left. Door always opens outwards.
- 3 - Install the 45 deg top brackets on the topside of each Door/Return junction. Drill 4 off 3.3mm holes, poprivet in place.

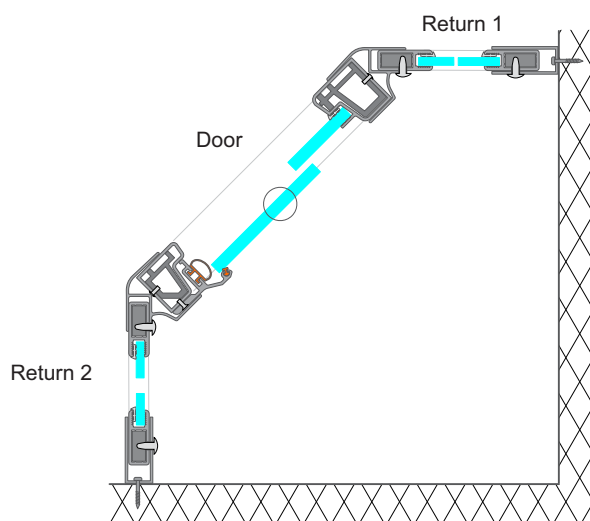

## Juralco Scope Project Shower Door System - General

### General Description

- The Scope Project Shower Pivot Door system is designed primarily for Retirement homes and Hospitals where wheelchair access is required.
- All Scope showers are constructed from our propriety range of aluminium extrusions and components, used in the Scopedoor and Pivot systems
- Pivot Doors are 6mm and Return Fixed Panels 4mm toughened glass, to NZS 4233 Part 3 for human impact requirements.
- Glass stocked as Standard Clear. Available to special order - Frosted or Patterned.
- Available in White powdercoat or Anodised polished bright or natural .
- Designed for installation direct on to suitable flooring.

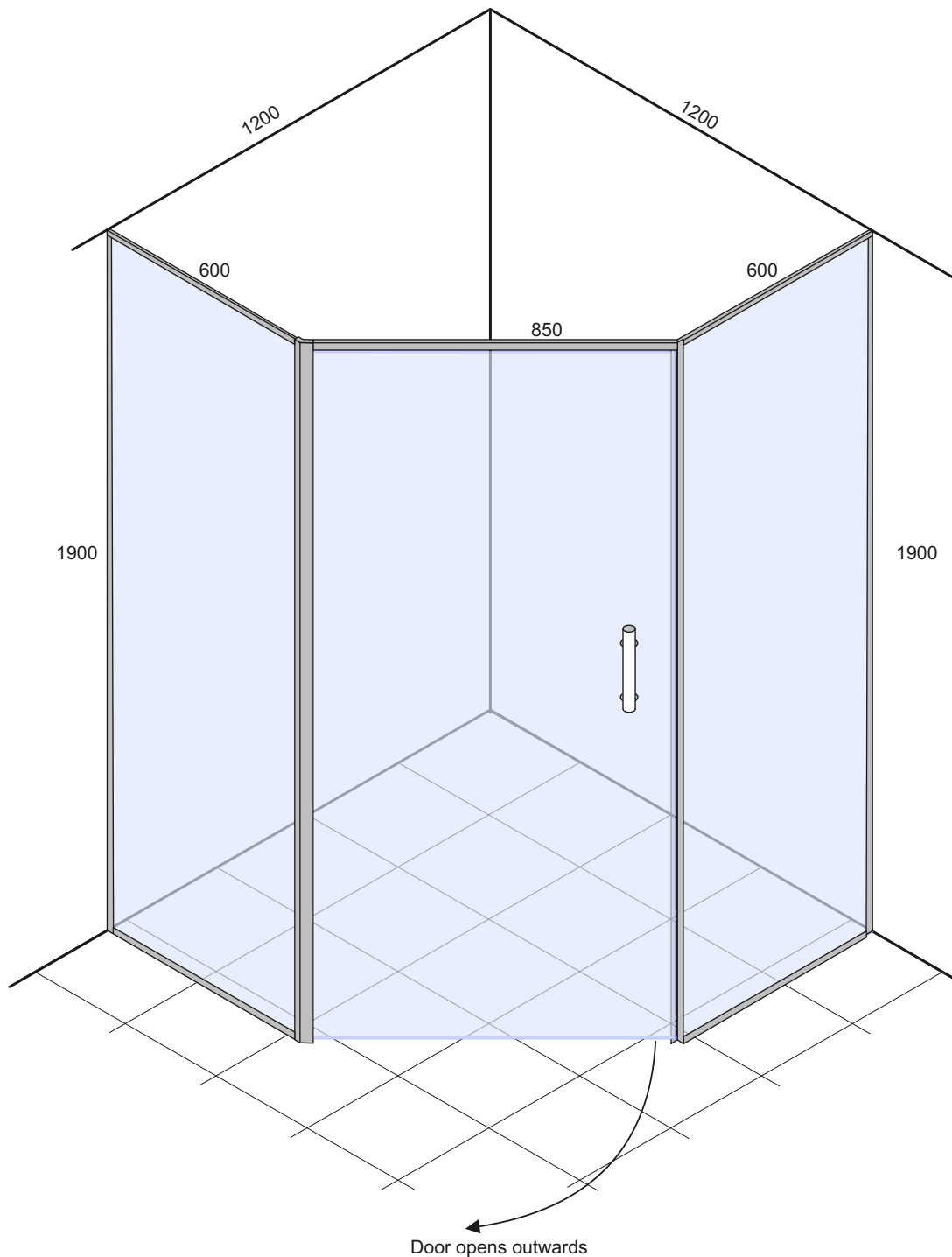

## Juralco Scope Project Shower Door System - Components

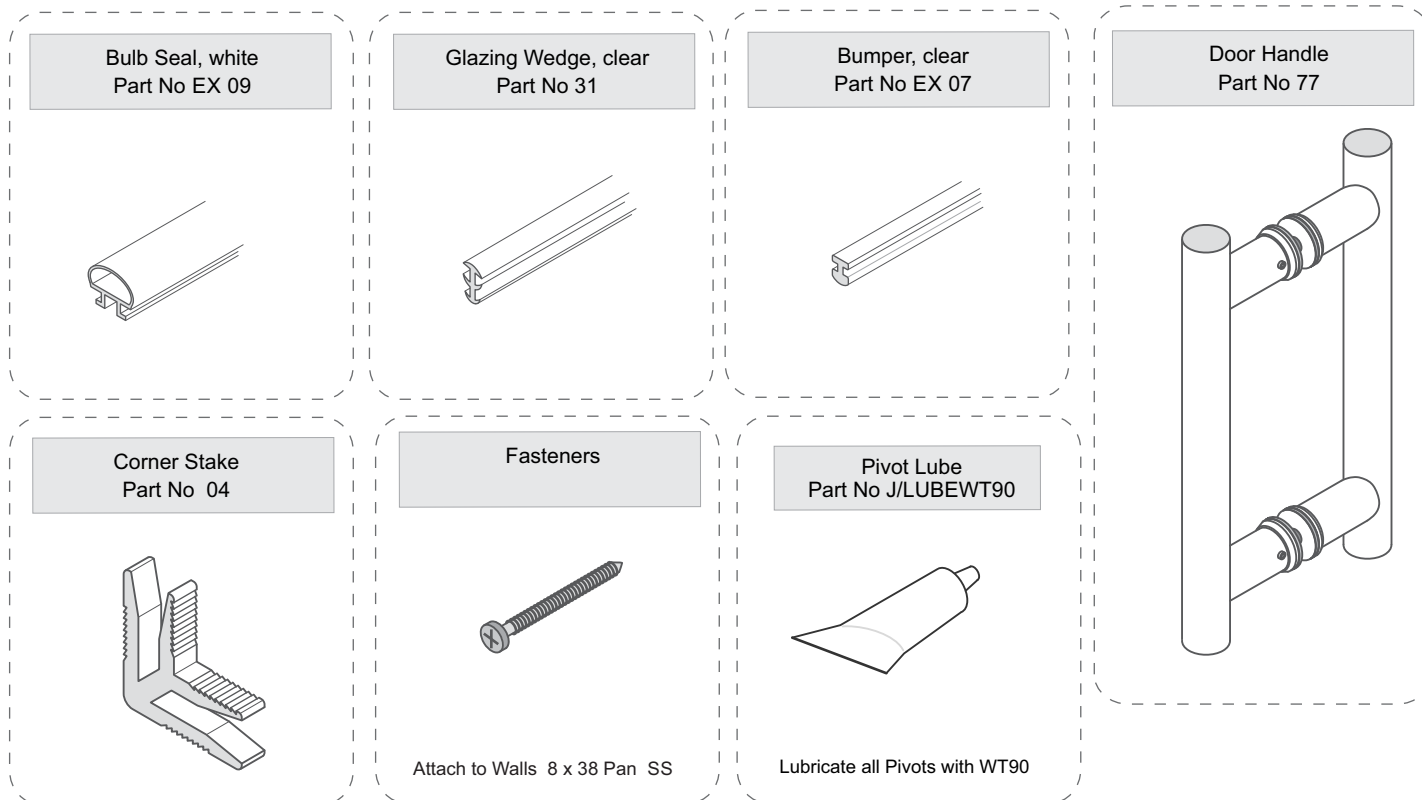

The components above are all from the Scopedor manual

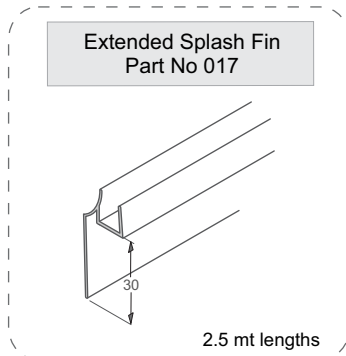
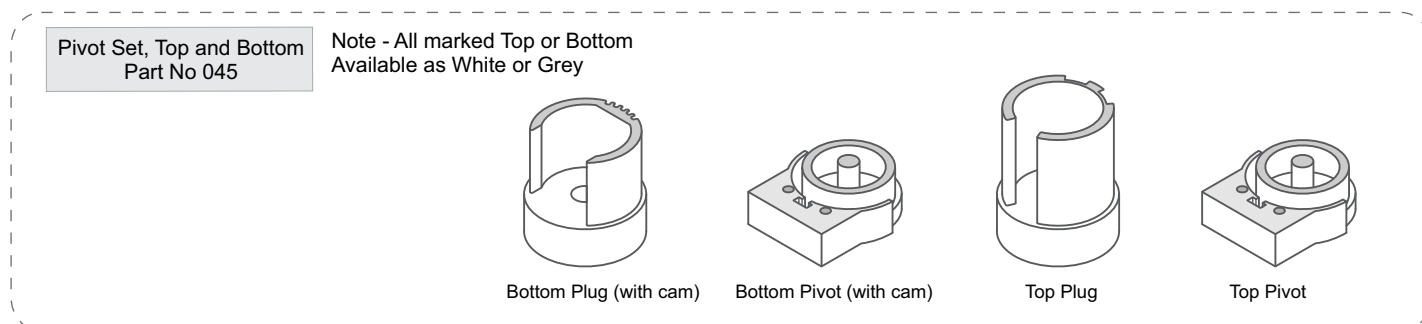

The components above are all from the Pivot Shower manual



## Juralco Scope Project Shower Door System - Extrusions

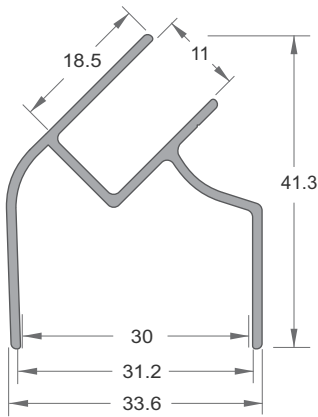

**45 DEG JAMB**  
Part No 6676  
( ID at front, compress to 30mm)

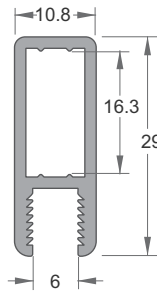

**RETURN FRAME**  
Part No 6679

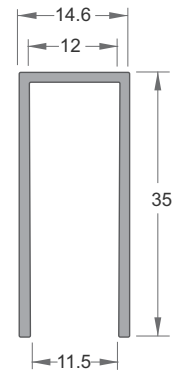

**RETURN WALL CHANNEL**  
Part No 3838

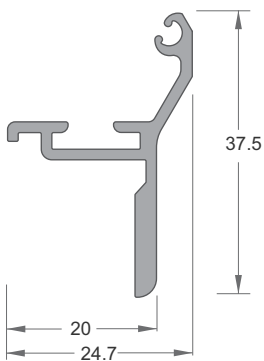

**STRIKER**  
Part No 2989

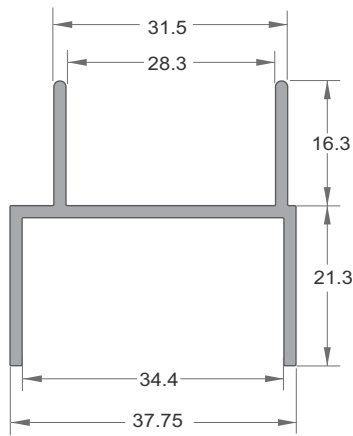

**JAMB ADAPTER**  
Part No 506  
(Used with 6676 and 501)

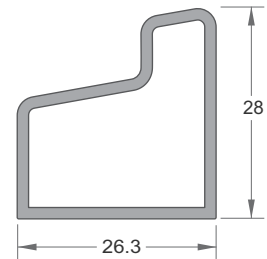

**PLAIN JAMB,  
INNER RAIL**  
Part No 6677

The Extrusions above are all from the Scopedoor manual

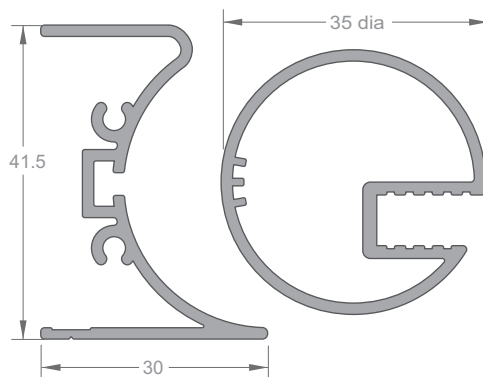

**PIVOT JAMB**  
Part No 501

**PIVOT STILE**  
Part No 502

The Extrusions above are from the Pivot Shower manual

Juralco Scope Project Shower Door System - Components and Glass Sizes

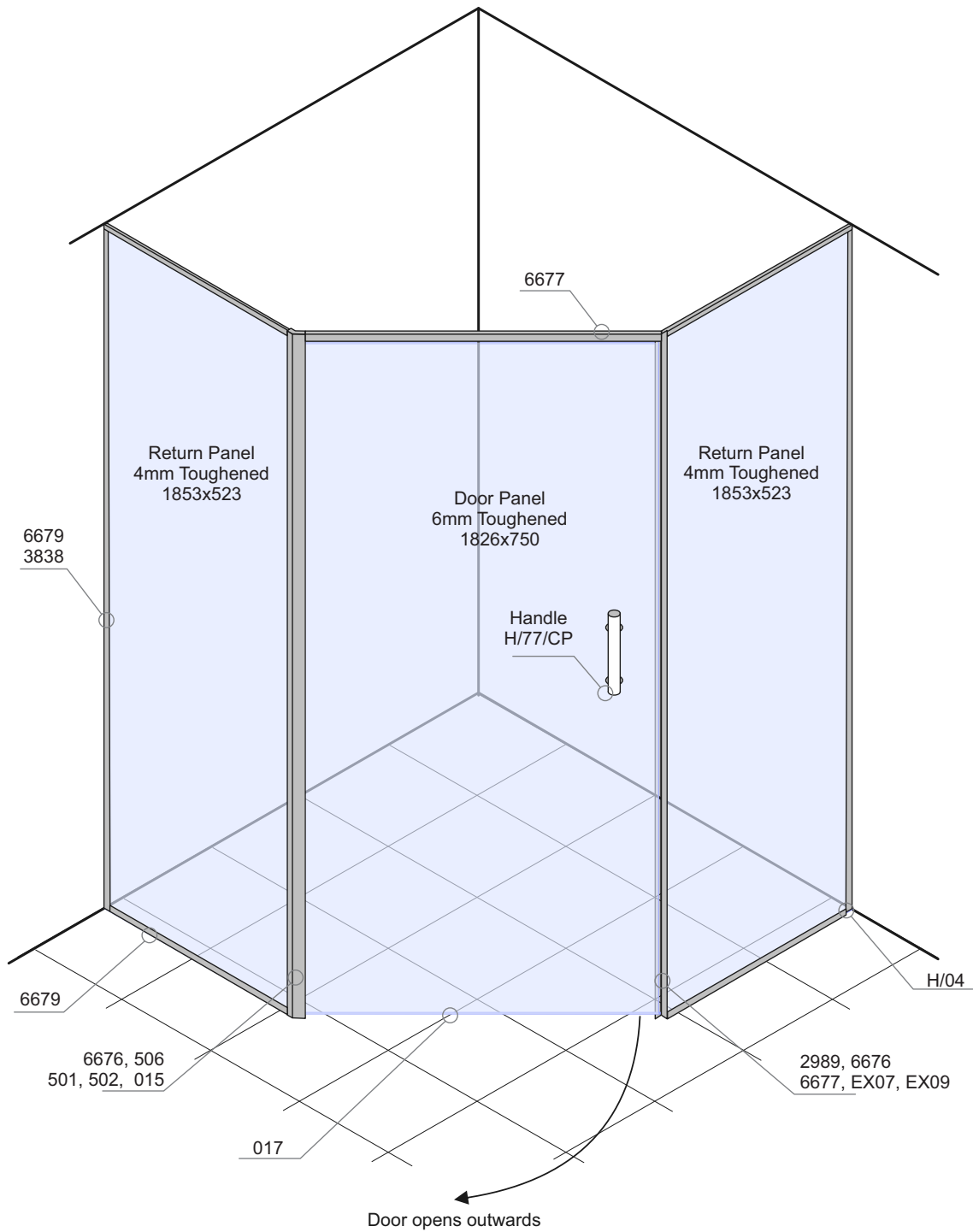

# Juralco Scope Project Shower Door System - Sections

Typical Horizontal Cross Section

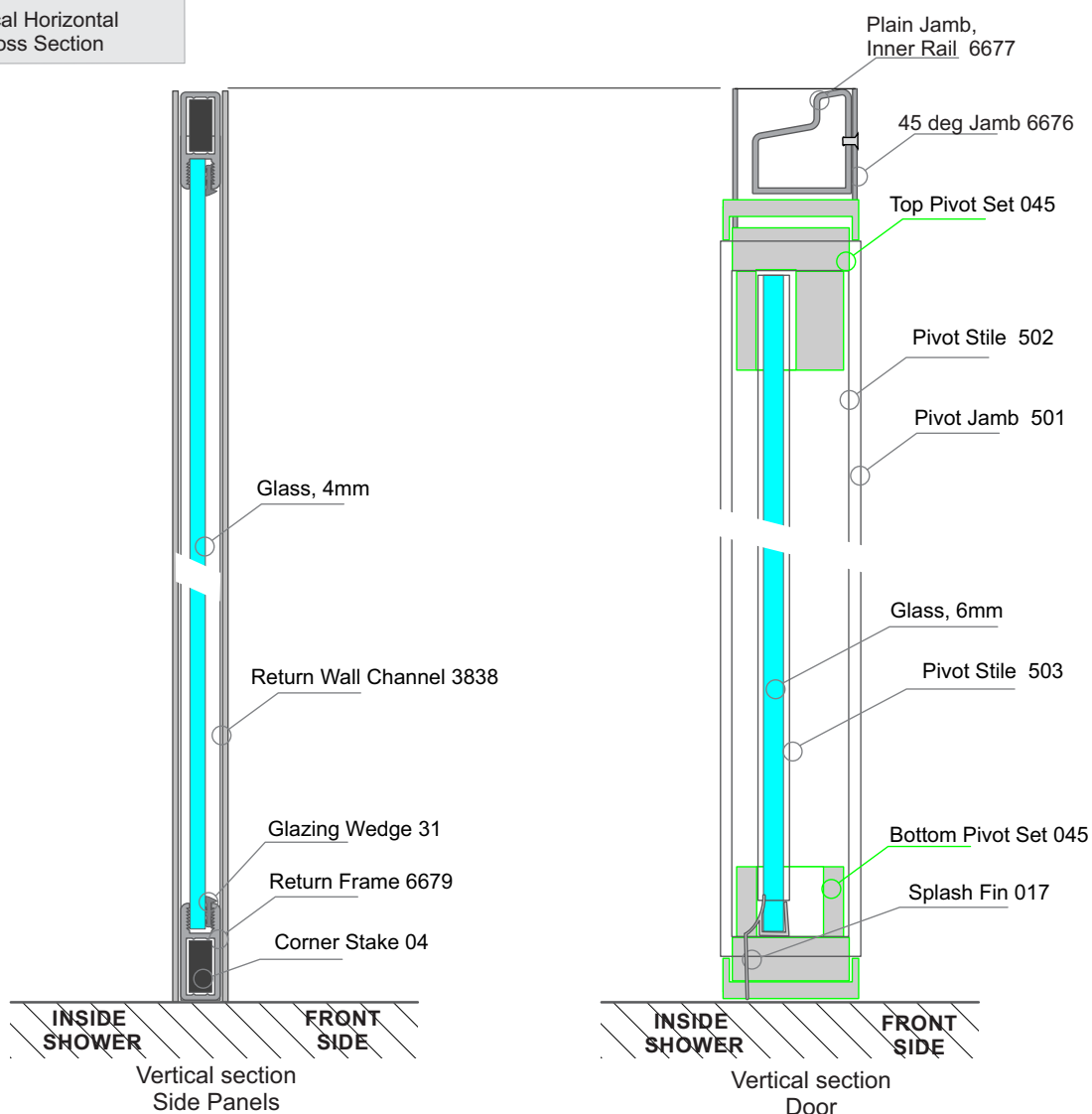

Typical Horizontal Cross Section

Pivot Door and 2 x 45deg Returns

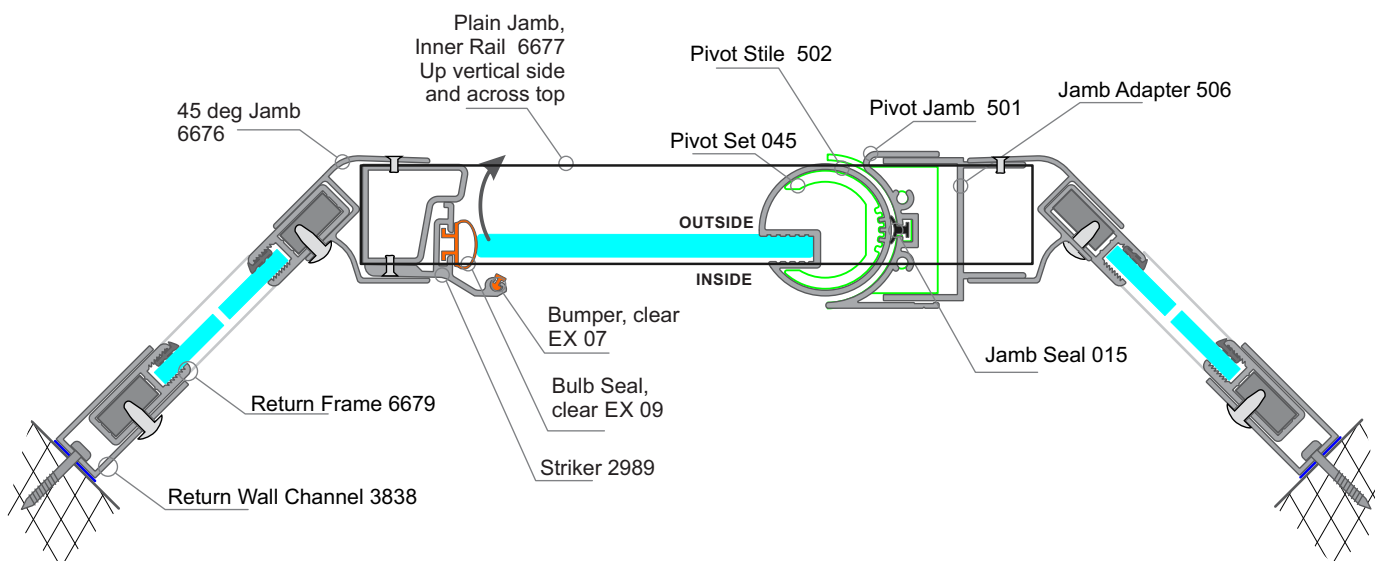

Note - All Pivots to be lubricated with WT90



## Juralco Scope Project Shower Door System - Cutting

Measuring, Selection  
Scope Project. Door  
and 2 x 45 deg Returns

**Note: Prior to delivering to site, unpack and check all items**

Cutting Sizes		
Door	No	Size
H/6677	1	1900
	1	815
H/2989	1	1900
H/501	1	1847
H/502	1	1827
H/506	1	1900

Cutting Sizes		
Returns	No	Size
H/6679	4	1900
	4	570
H/6676	2	1900
H/3838	2	1900

Components	
All	No
Bulb Seal Ex/09/2.1	1
Bumper EX/07	1
Pivot Set H/045, Grey	1 x pr
Handle H/77/CP	1
Glazing Wedge 31	8
Jamb Seal 015	1
Splash Fin 017	1
Corner Stakes 04	8

Cutting Sizes		
Glass	No	Size
Door - 6mm	1	1826x750
Returns - 4mm	2	1853x523

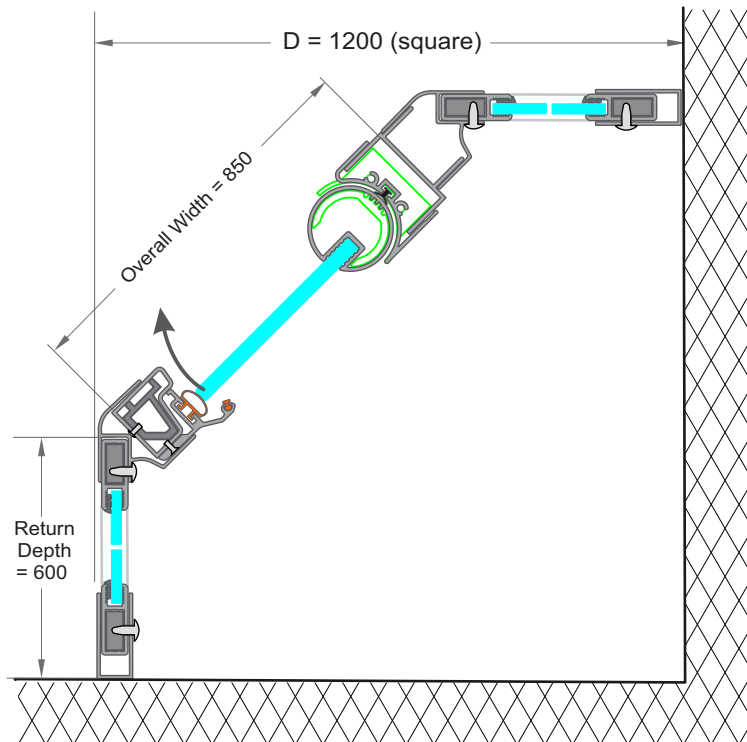

### Glass Order

#### For Scope Project Door

##### Glass Door

Glass - 6mm Toughened  
Holes - 2 x 12mm dia  
Edges - Polish all four

##### Glass Return Panel

Glass - 4mm Toughened  
Edges - Rough arris all

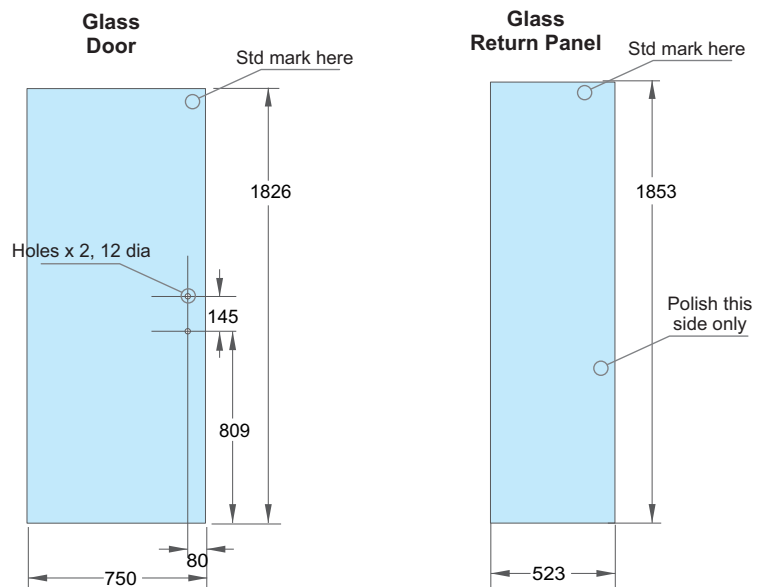

Note - All Glass must have  
Toughened Safety Glass Stamp