

Juralco Edge Canopy System - Projection and Arm Spacings

Projection	Wind Zones up to and Including	Arm C/L Spacings (max)
1.0m	High	1.65m
	Very High	1.18m
	Extra High	0.96m
1.2m	Medium	1.38m
	High	1.11m
	Very High	0.83m
	Extra High	0.67m

Can be multiple arms at these spacings

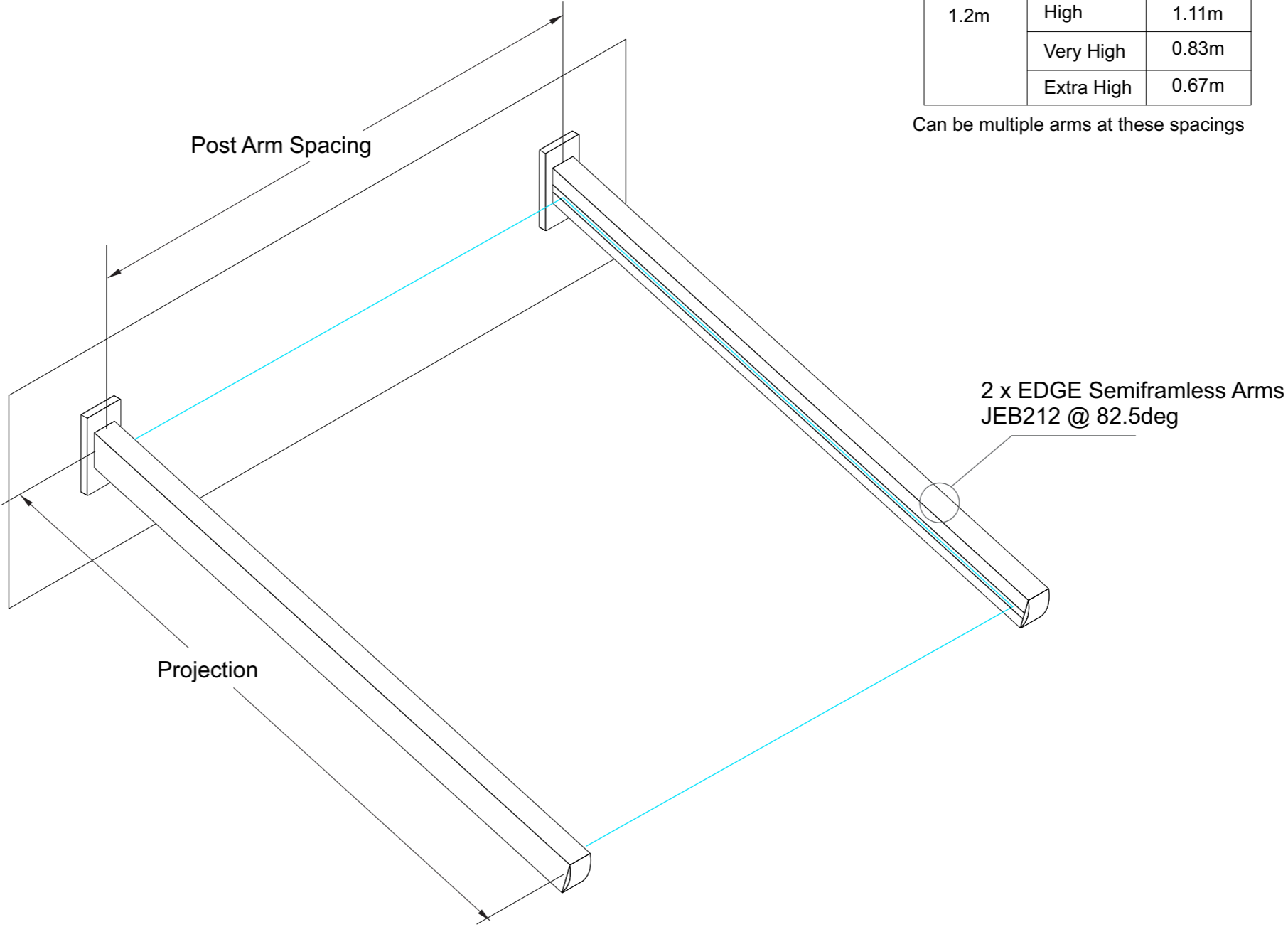

Juralco EDGE Canopy System - Typical Fixing Conforms to NZS3604:2011 - Boundary Joists
 EDGE Canopy - Face Fix to Timber (hidden fixings) - 4 x M10 CS SS Coachscrews

Important Installation notes:

- 1 - The Project Engineer must ensure the structure can support the appropriate loads.
- 2 - Refer the EDGE Canopy Manual for Wind Zones, Projections, Arm Spacings and other Options
- 3 - Substructure shown indicatively only. Timber SG8 minimum strength
- 4 - Coachscrews 90mm min screw engagement into joists. Drill 6mm hole
- 5 - Bond all screws with SIKA Supergrip to full depth
- 6 - There must be a PVC Tape layer between the Baseplate and Cladding
- 7 - All fixings must be Stainless Steel

Projection	Wind Zones up to and Including	Arm C/L Spacings (max)
1.0m	High	1.65m
	Very High	1.18m
	Extra High	0.96m
1.2m	Medium	1.38m
	High	1.11m
	Very High	0.83m
	Extra High	0.67m

Can be multiple arms at these spacings

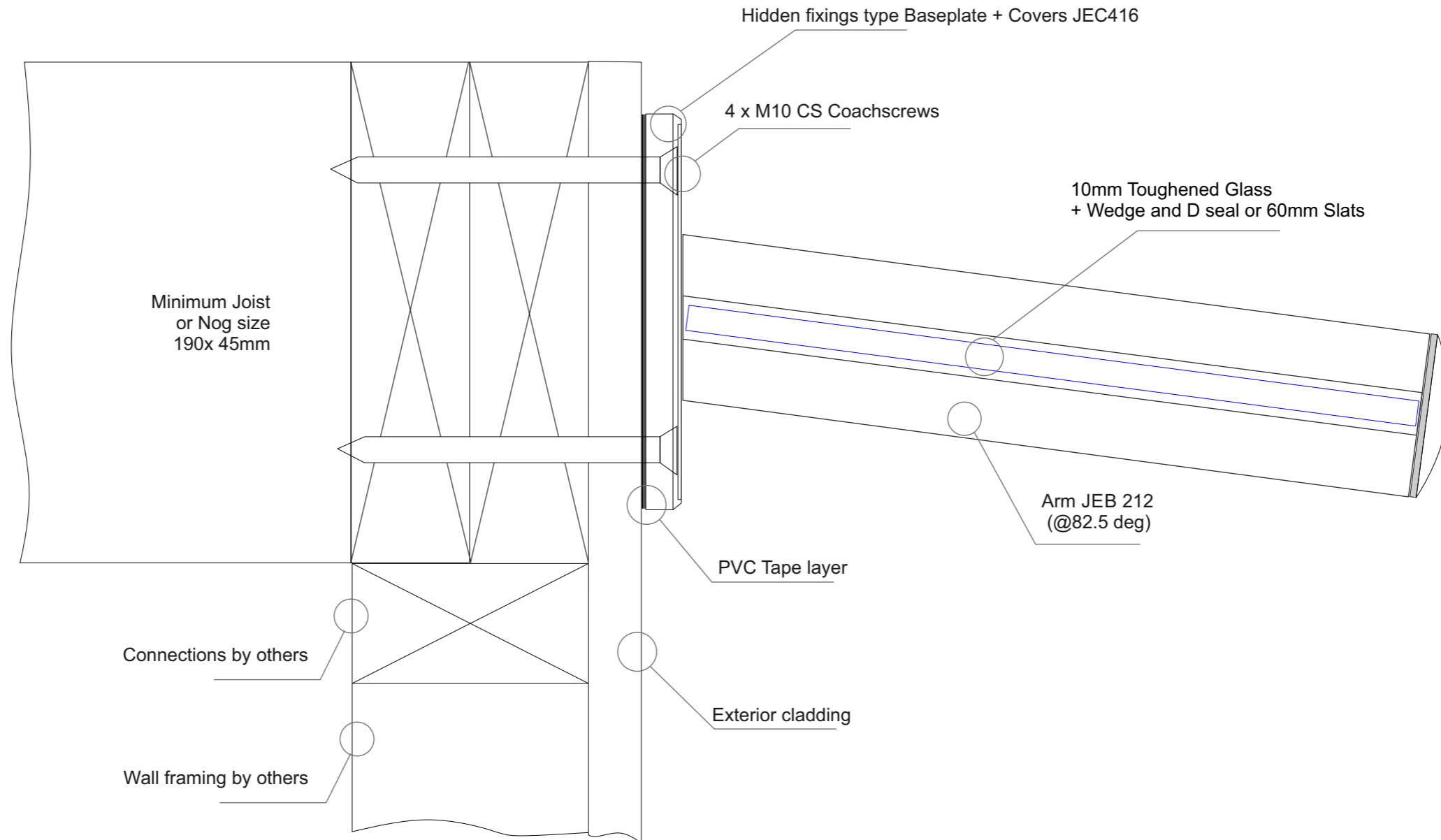

Juralco EDGE Canopy System - Typical Fixing
EDGE Canopy - Face Fix to Masonry/ Block Wall - 2 x M12 SS Studs

Important Installation notes:

- 1 - The Project Engineer must ensure the structure can support the appropriate loads.
- 2 - Refer the EDGE Canopy Manual for Wind Zones, Projections, Arm Spacings and other Options
- 3 - Substructure shown indicatively only.
- 4 - There must be a PVC Tape layer between the Baseplate and Wall
- 5 - All fixings must be Stainless Steel

Projection	Wind Zones up to and Including	Arm C/L Spacings (max)
1.0m	High	1.65m
	Very High	1.18m
	Extra High	0.96m
1.2m	Medium	1.38m
	High	1.11m
	Very High	0.83m
	Extra High	0.67m

Can be multiple arms at these spacings

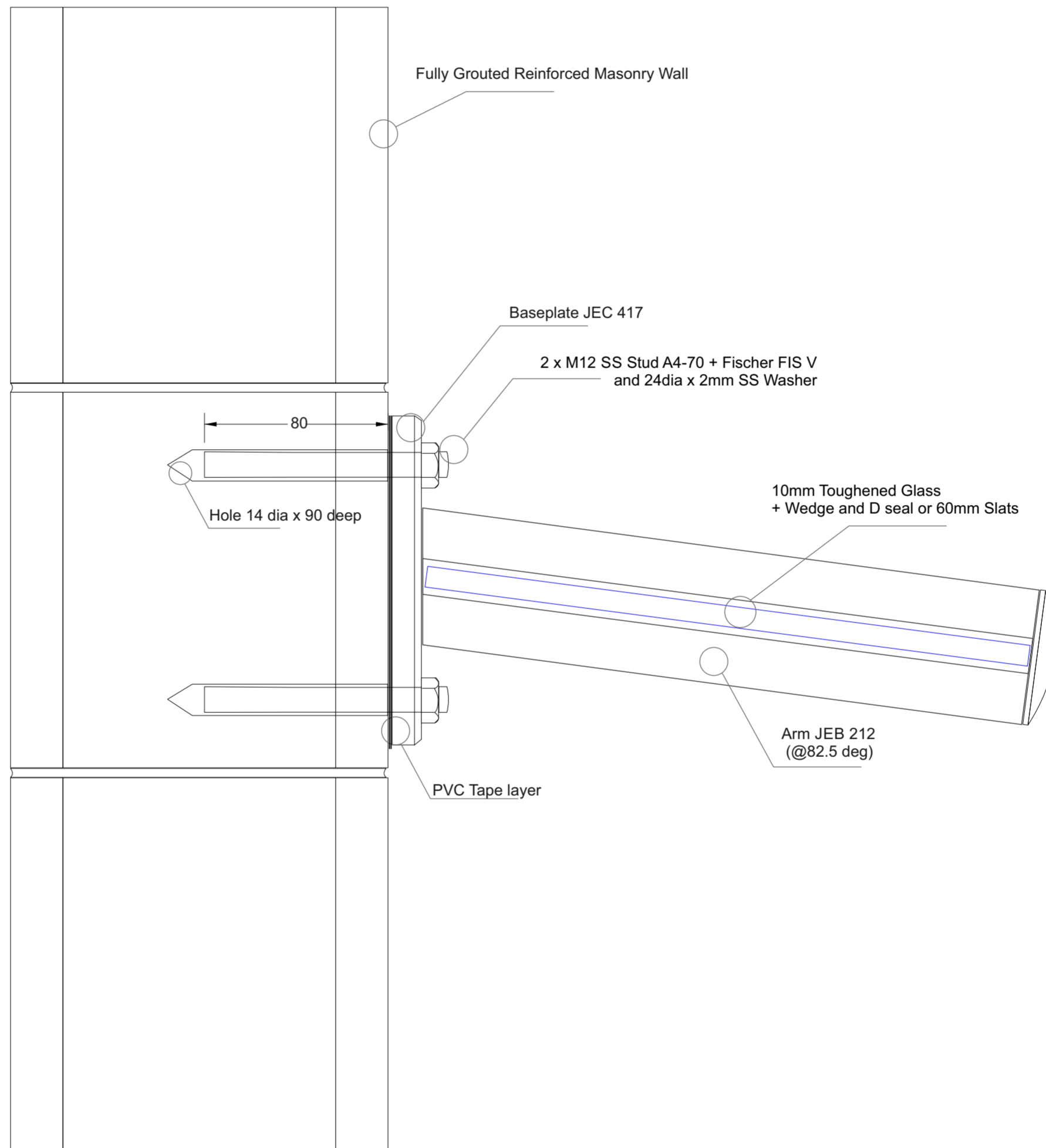

Juralco EDGE Canopy System - Typical Fixing
EDGE Canopy - Face Fix to Single Stud wall (hidden fixings) - 4 x M10 CS SS Coachscrews

Important Installation notes:

- 1 - The Project Engineer must ensure the structure can support the appropriate loads.
- 2 - Refer the EDGE Canopy Manual for Wind Zones, Projections, Arm Spacings and other Options
- 3 - Substructure shown indicatively only. Timber SG8 minimum strength
- 4 - The baseplate must be centered on the studs
- 5 - Coachscrews 90mm min screw engagement into joists. Drill 6mm hole
- 6 - Bond all screws with SIKA Supergrip to full depth
- 7 - There must be a PVC Tape layer between the Baseplate and Cladding
- 8 - All fixings must be Stainless Steel
- 9 - Max Span of lintel - 1.9m. To be confirmed by Engineer
- 10 - All structure and fixings for End Stud details shown are in addition to NZS3604 requirements

Projection	Wind Zones up to and Including	Arm C/L Spacings (max)
1.0m	High	1.65m
	Very High	1.18m
	Extra High	0.96m
1.2m	Medium	1.38m
	High	1.11m
	Very High	0.83m
	Extra High	0.67m

Can be multiple arms at these spacings

Lintel + Timber Framing - Wall Connection Details

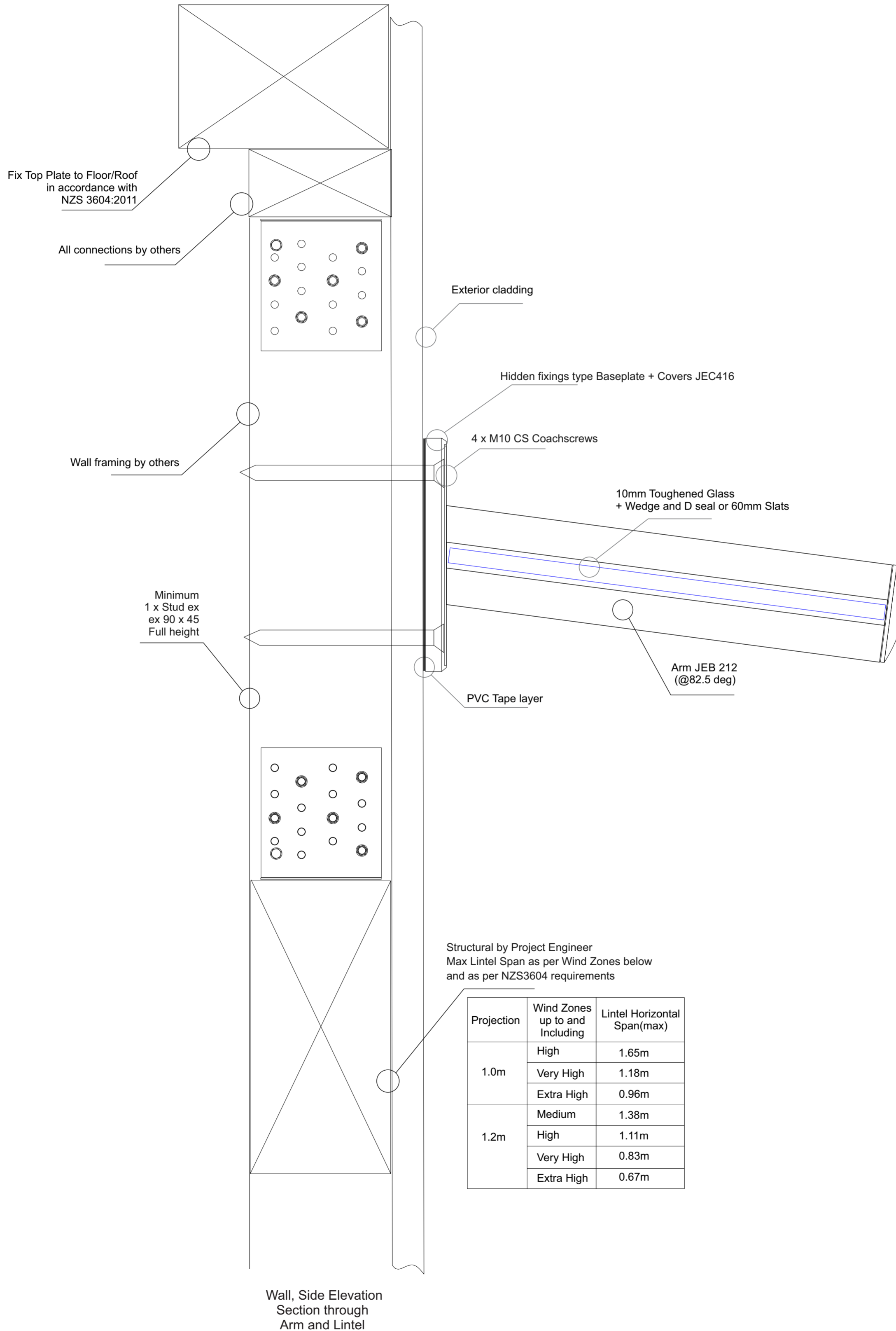

Structural by Project Engineer
 Max Lintel Span as per Wind Zones below
 and as per NZS3604 requirements

Projection	Wind Zones up to and Including	Lintel Horizontal Span(max)
1.0m	High	1.65m
	Very High	1.18m
	Extra High	0.96m
1.2m	Medium	1.38m
	High	1.11m
	Very High	0.83m
	Extra High	0.67m

Juralco EDGE Canopy System - Typical Fixing
EDGE Canopy - Face Fix to Double Studs (hidden fixings) - 4 x M10 CS SS Coachscrews

Important Installation notes:

- 1 - The Project Engineer must ensure the structure can support the appropriate loads.
- 2 - Refer the EDGE Canopy Manual for Wind Zones, Projections, Arm Spacings and other Options
- 3 - Substructure shown indicatively only. Timber SG8 minimum strength
- 4 - The baseplate must be centered on the studs
- 5 - Coachscrews 90mm min screw engagement into joists. Drill 6mm hole
- 6 - Bond all screws with SIKA Supergrip to full depth
- 7 - There must be a PVC Tape layer between the Baseplate and Cladding
- 8 - All fixings must be Stainless Steel

Projection	Wind Zones up to and Including	Arm C/L Spacings (max)
1.0m	High	1.65m
	Very High	1.18m
	Extra High	0.96m
1.2m	Medium	1.38m
	High	1.11m
	Very High	0.83m
	Extra High	0.67m

Can be multiple arms at these spacings

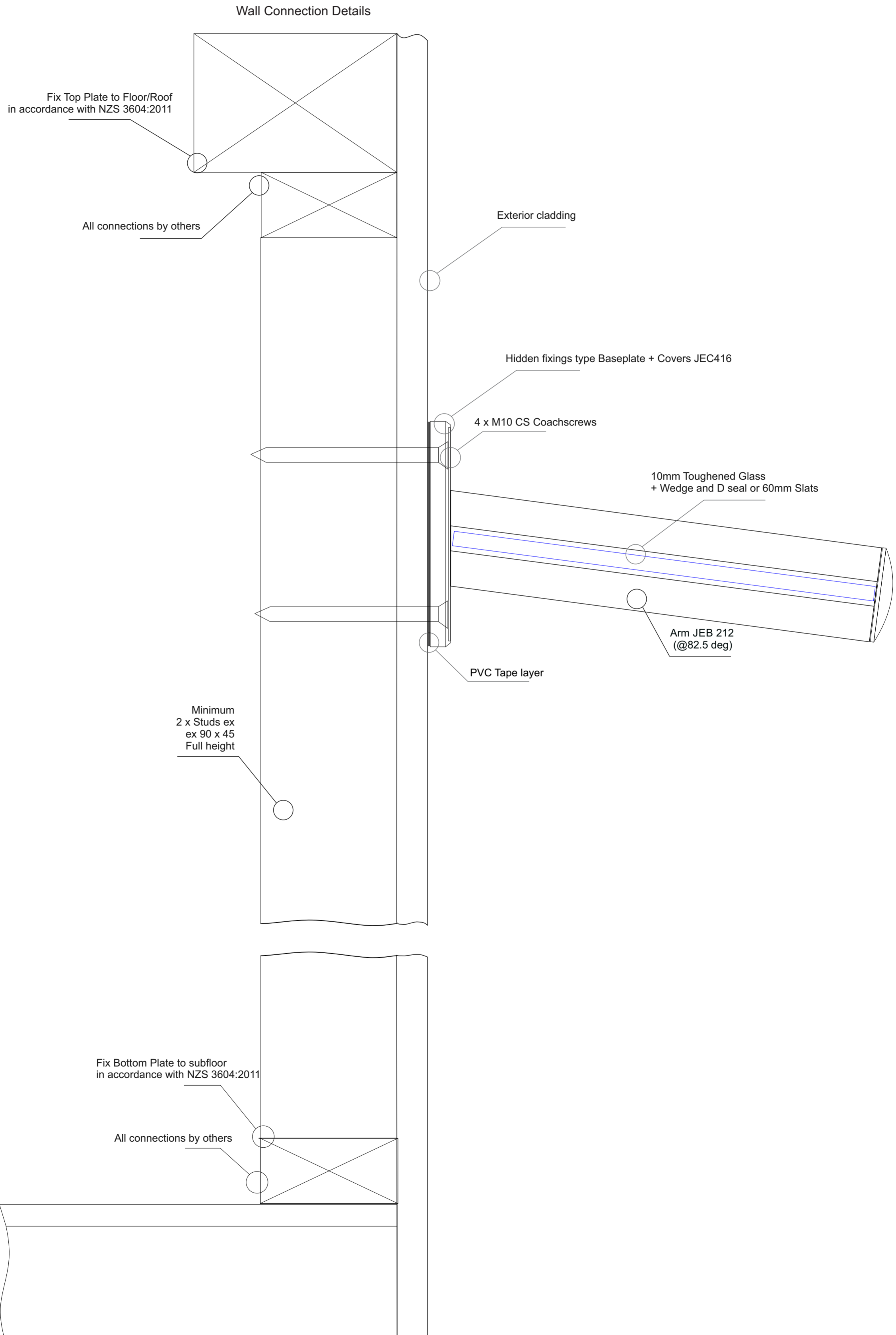

Juralco EDGE Canopy System - Typical Fixing
EDGE Canopy - Face Fix to Cavity Wall (hidden fixings) - 4 x M10 CS SS Coachscrews

Important Installation notes:

- 1 - The Project Engineer must ensure the structure can support the appropriate loads.
- 2 - Refer the EDGE Canopy Manual for Wind Zones, Projections, Arm Spacings and other Options
- 3 - Substructure shown indicatively only. Timber SG8 minimum strength
- 4 - The baseplate must be centered on the studs
- 5 - Coachscrews 90mm min screw engagement into joists. Drill 6mm hole
- 6 - Bond all screws with SIKA Supergrip to full depth
- 7 - There must be a PVC Tape layer between the Baseplate and Cladding
- 8 - All fixings must be Stainless Steel

Projection	Wind Zones up to and Including	Arm C/L Spacings (max)
1.0m	High	1.65m
	Very High	1.18m
	Extra High	0.96m
1.2m	Medium	1.38m
	High	1.11m
	Very High	0.83m
	Extra High	0.67m

