



Juralco Aluminium Building Products Ltd designs and distributes specialist aluminium joinery systems through a national network of franchised fabricators and agents.

For more than 25 years we have been at the forefront of specialist aluminium door and window products suitable for New Zealand joinery and building methods. Our comprehensive product range includes security and insect screens, balustrades and gates, shutters and awnings, shower screens, wardrobe doors and organisers and internal doors.

Batwing custom-made semi-frameless twin pivoting screens can be used in larger tiled bathrooms to provide maximum access or in a smaller bathroom or shower unit where a pivot door does not have the full space to swing outwards.

The pivoting panels can swing both into and outside of the shower and do not have a floor seal making them a practical choice where level entry or wheel-chair access is a requirement. The Bathswing is a single pivoting door over a bath/shower unit. Available as a standard, or can be custom made.

This Guide is intended for use by Architects, Specifiers and Fabricators
Pages 2-3 cover areas of general interest. Pages 4 onwards are intended for Fabricators.
Pages 4-9, Batwing Twin pivot doors. Pages 10-12, Bathswing Single pivot door.

Layouts

Shown below are the Batwing (Full height, Twin Door Pivoting) and Bathswing (Over Bath, Single Door Pivoting)

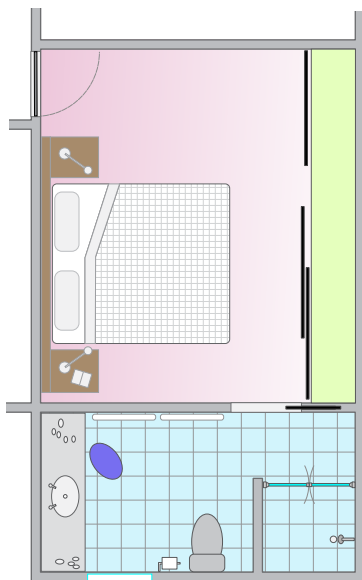

Juralco Batwing Shower Door
(Twin Doors)

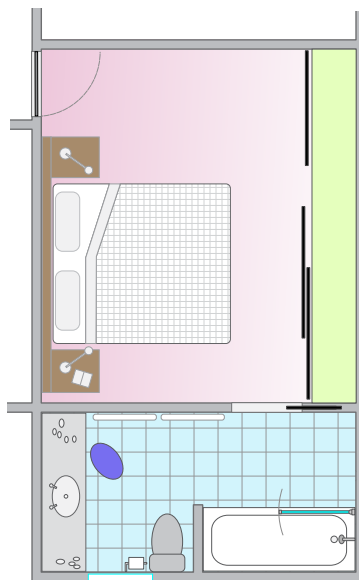

Juralco Bathswing Shower Door
(Single Door)



Juralco Pivot Shower Door Systems - General Descriptions

General Description

Features

- These Shower Door systems are designed to provide a range of easily installed doors to suit any opening.
- There are two door pivoting door configurations.
 - 1 - The Batwing system, available as a full height twin door system for installation with standard Shower trays or direct on to suitable flooring.
 - 2 - The Bathswing system, available as a single door for over bath installations.
- Doors are semi frameless (no rails). Returns are framed.
- All doors are constructed from our propriety range of aluminium extrusions.
- Doors are 6mm toughened glass, returns 4mm glass, all to NZS 4233 Part 3 for human impact requirements.
- Infill panels are Glass, either Clear, Frosted or Patterned.
- The installation system copes with out of plumb walls.
- Extrusion are available in White powdercoat or in a bright polished Anodised finish.

Typical Layouts

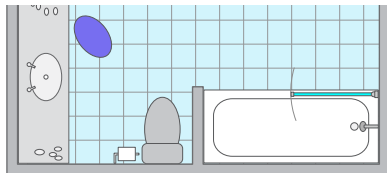

**Juralco Bathswing Shower Door System
For over Bath mounting**

- Single door system
- Self locating door on bottom pivot cam
- Splash trim on bottom of door
- Available as standard 790mm wide x 1500mm high
or custom made up to 900mm wide max x 1500mm high

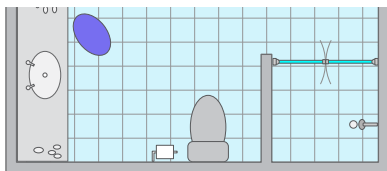

Between Walls installation

- Twin door system
- No outer Frame, mounted to walls
- For Floor or shower tray installations
- Self locating doors on bottom pivot cam
- Magnetic strip to provide center seal
- Splash trim on bottom of door
- Custom made. Height 1830mm or 1930mm
Door widths to 600mm max (1200mm per set)

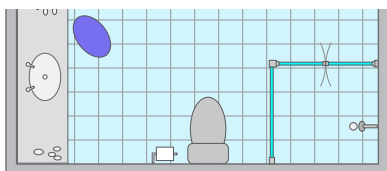

90 deg Return

- Twin door system
- Outer Door Frame, with 90 deg return
- For Floor or shower tray installations
- Self locating doors on bottom pivot cam
- Magnetic strip to provide center seal
- Splash trim on bottom of door
- Custom made. Height 1830mm or 1930mm
Door widths to 600mm max (1200mm per set)
Return to 1200 max

**Juralco Batwing Shower Door System
For Shower Tray or Floor mounting**

Juralco Pivot Shower Door Systems - Extrusions, Components

Batwing Extrusions Full Size

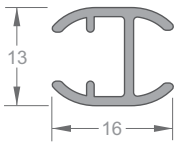

BATWING STILE
Part No 503

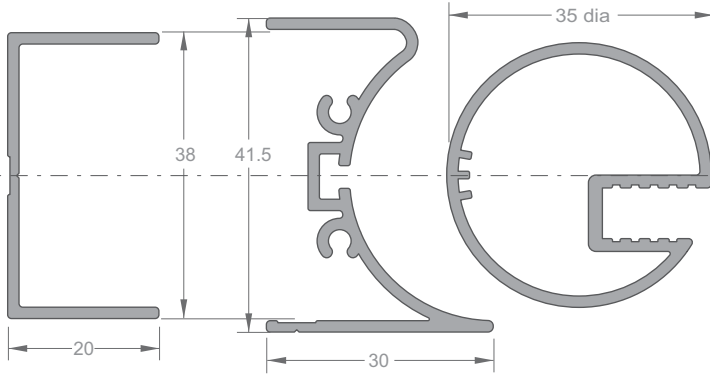

WALL CHANNEL
Part No 504

PIVOT JAMB
Part No 501

PIVOT STILE
Part No 502

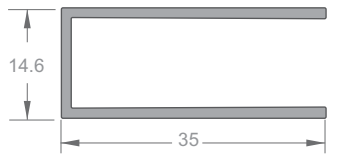

RETURN WALL CHANNEL
Part No 3838

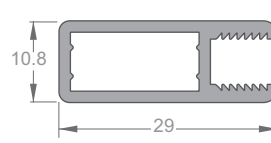

RETURN FRAME
Part No 6679

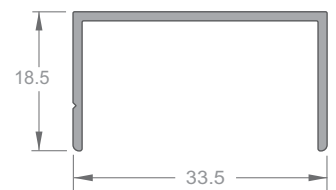

JAMB CAP
Part No 6675

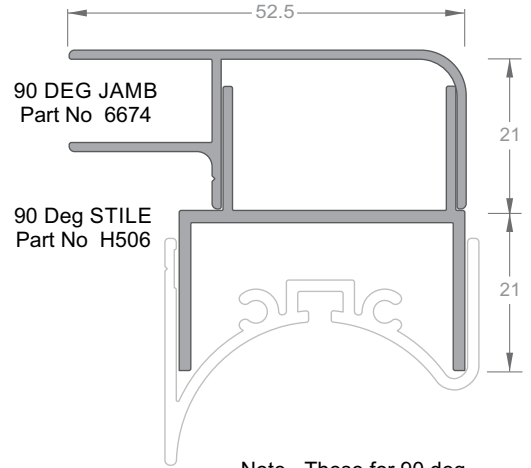

90 DEG JAMB
Part No 6674

90 Deg STILE
Part No H506

Note - These for 90 deg Return option

Batwing Components

Pivot Set, Top and Bottom Part No 045

Note - All marked Top or Bottom Available as White or Grey

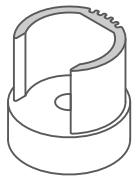

Bottom Plug (with cam)

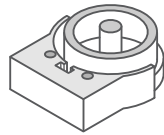

Bottom Pivot (with cam)

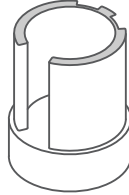

Top Plug

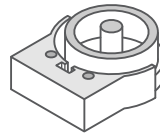

Top Pivot

Note - These for 90 deg Return option

Glazing Wedge, clear Part No 31

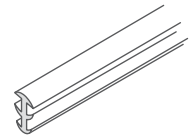

200mt rolls

Pivot Lube Part No J/LUBEWT90



Lubricate all Pivots with WT90

Jamb Seal Part No 015

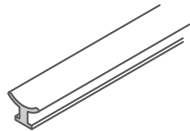

50 mt Rolls

Door Handle Part No 77

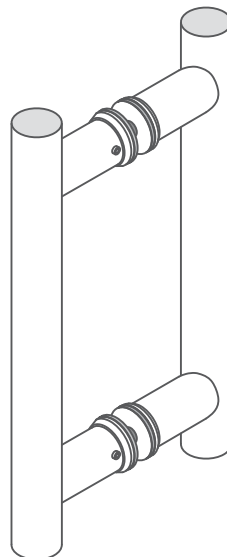

Chrome

Corner Stake Part No 04

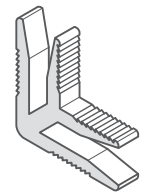

Magnetic Strip Part No 50311

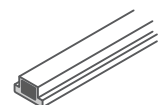

2 mt lengths, White

Extended Splash Fin Part No H/017

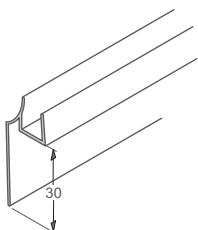

2.5 mt lengths

Plastic Fastener Part No 73P



Tap in Fastener

Juralco Pivot Shower Door Systems - Measuring, Typical Sections

Batwing Twin Door Door Measuring

- Measure width at top and bottom of the shower opening. Check for out of square walls.
 - Double check all measurements.
 - For shower enclosures with return panels establish points at corners where outside line of screen will finish.
- Measure to these points. Small off-cuts of corner sections are useful to assist in determining where the shower enclosure is to finish.
- Decide on your (out of square) fitting allowances to give Width and Height, then use the appropriate Cutting formula sheets.
 - Height normally 1830mm or 1930mm.

Typical Batwing Horizontal and Vertical Cross Sections

Note - All Pivots to be lubricated with WT90

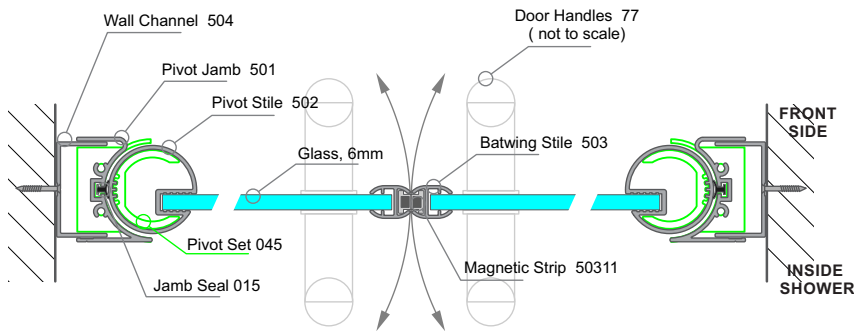

Horizontal section

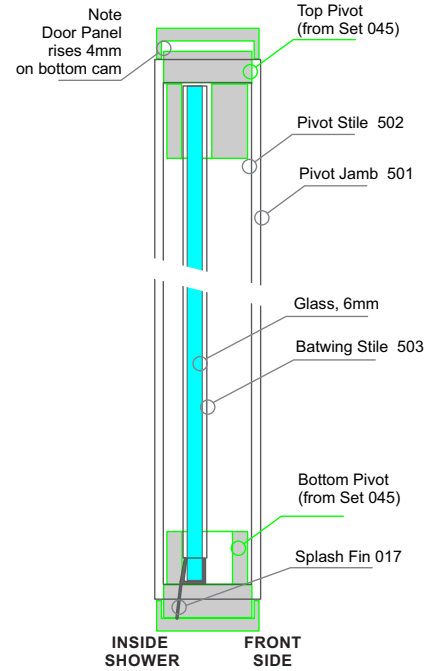

Vertical section

Twin Door, Between Walls, Doors 6mm Glass

90 Deg STILE Part No H506

Note - All Pivots to be lubricated with WT90

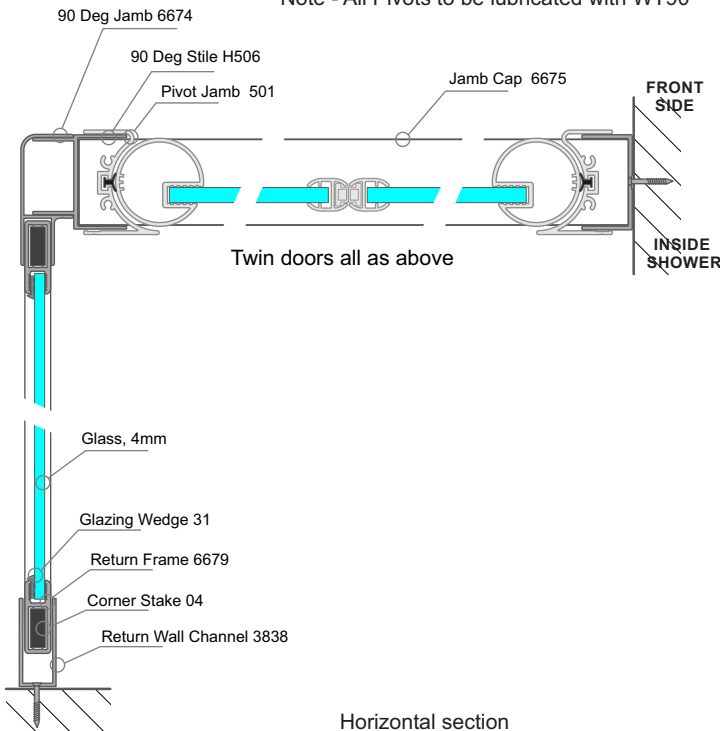

Horizontal section

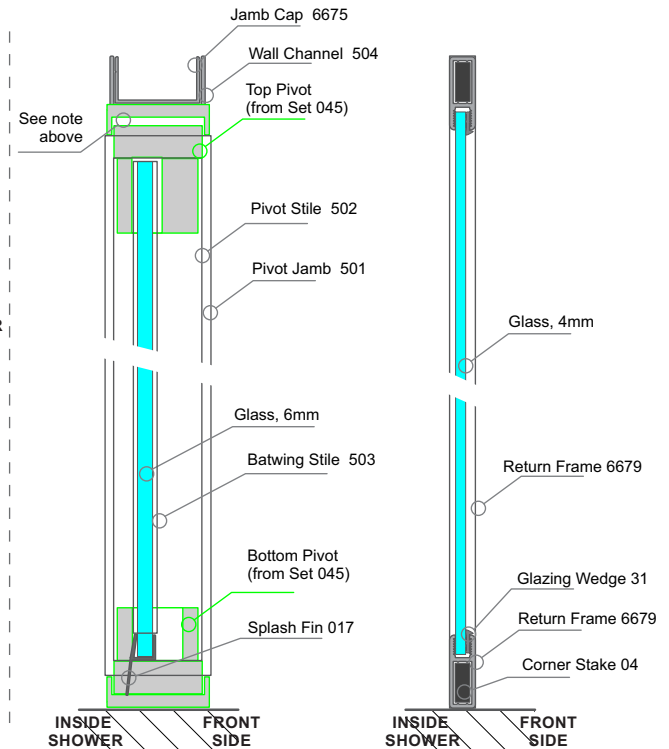

Vertical sections

Twin Doors and 90 deg return, Doors 6mm Glass, Return 4mm glass



JURALCO

www.juralco.co.nz ph (09) 478 8018

Juralco Pivot Shower Door Systems

Issue 1/17

Page 5

Juralco Pivot Shower Door Systems - Cutting Allowances

Batwing Twin Door Cutting Allowances

Note - All Pivots to be lubricated with WT90

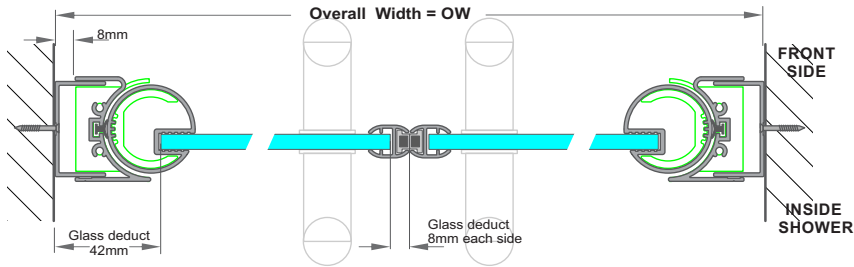

Horizontal section

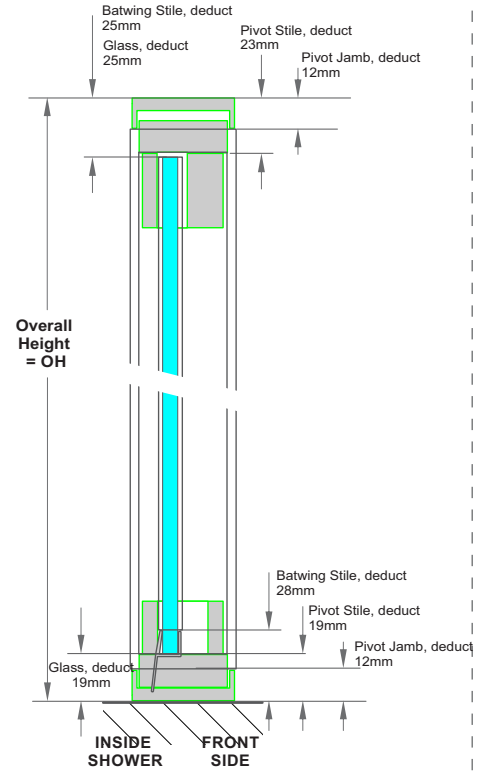

Vertical section

Twin Door, Between Walls, Doors 6mm Glass

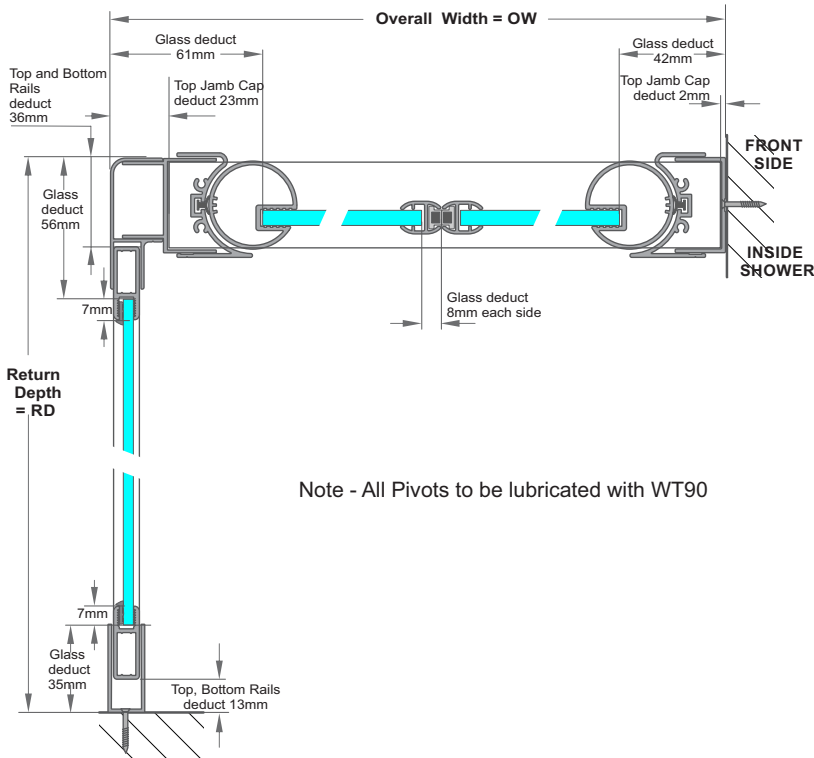

Note - All Pivots to be lubricated with WT90

Horizontal section

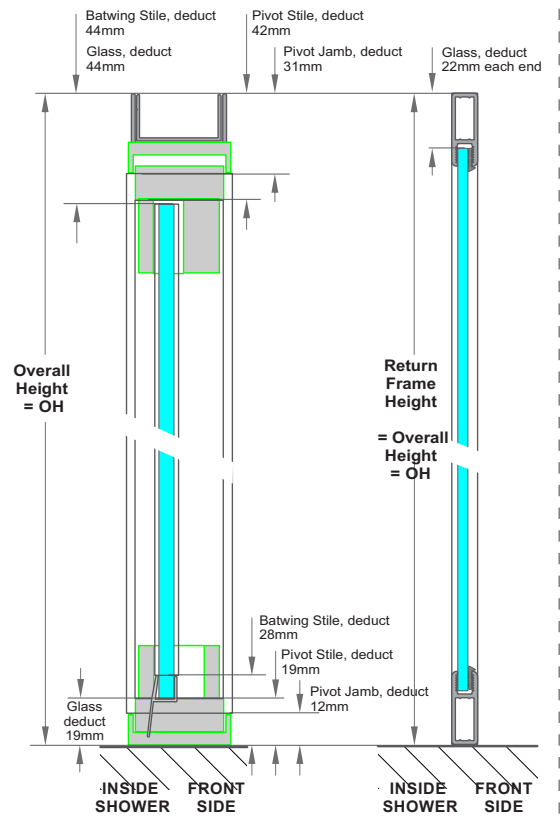

Vertical sections

Twin Doors and 90 deg return, Doors 6mm Glass, Return 4mm glass

Rhodorsil V-60

Note - This Architectural, structural grade RTV must be used for Showers.
Do not use normal retail clear RTV.

General

- Rhodorsil V-60 is a one component, non-flowing, neutral cure, High modulus silicone sealant. It cures by absorption of atmospheric moisture to form a flexible and durable elastomeric sealant.
- Special Features Rhodorsil V-60 is a premium grade neutral cure glazing silicone sealant. It has superior adhesion to painted and anodised aluminium, as well as glass.
- The thixotropic nature of this product ensures that it will not slump in typical construction joints

Conditions

- Always ensure that the surfaces to be sealed are dry and free from oil, dirt and grease.
- Use the two-wipe process for impervious substrates. Ensure the cloths are clean and changed frequently, and use a suitable solvent such as Rhodorsil R-40, ® IPA or White Spirits.
- When extruding the sealant cut the nozzle to the desired width, cut the tip off the cartridge, and apply the sealant firmly to ensure good contact between the sealant and the substrate.
- Before the sealant has skinned, tool it off to ensure a good finish, and to improve the wetting out of the sealant to the substrate.
- RHODORSIL V-60 cures by absorbing atmospheric moisture, it will skin over in 8 minutes and cure to a depth of 9mm in 7 days.

Properties

- Skin Time 8 Minutes BS 5889
- Tack Free Time 45 Minutes ASTM C
- Tooling Time 8 Minutes ASTM C
- Sag or Slump Nil BS5889

Juralco Pivot Shower Door Systems - Cutting, Assembly, Installation

Batwing Twin Door Cutting

- Glass Doors all toughened 6mm, Polish Top, bottom edges. 2 x 12 dia holes
- Door heights either 1830mm or 1930mm.

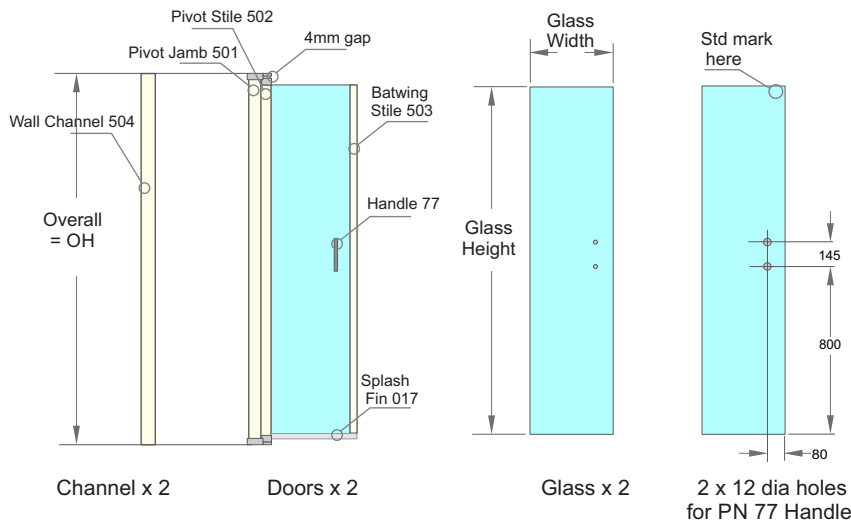

Note - All Pivots to be lubricated with WT90

Batwing Twin Doors, Cutting			PART	Formula, mm
1	Width	Overall Width		OH
2	Width	Door , Glass	6mm	(OH - 92)/2

1	Height	Overall Height		OH
2	Height	Wall Channel	504	OH
3	Height	Pivot Jamb	501	OH - 24
4	Height	Pivot Stile	502	OH - 42
5	Height	Door , Glass	6mm	OH - 44
6	Height	Batwing Stile	503	OH - 53

Batwing Twin Door Assembly, Installation

Note: Prior to delivering to site, unpack and check all items

Note - Check all Glass is marked with Toughened Safety Glass Stamp

Assembly

- 1 - Inspect all extrusions for damage, surface defects. Assemble all necessary components. Ensure workplace is clean.
- 2 - Assemble Top, bottom pivots (marked, 045 set) to the Pivot Jamb 501 and Pivot Stile 502, making sure that the Jamb seal 015 is in place. Screw up tight. Note 1 - the Jamb seal extends into the plastic Pivots. Note 2 - Make sure cams are lined up to central position.
- 3 - Insert Glass into Pivot Stile 502. Rhodorsil V-60 securely in place. Wipe clean. Allow 24 hrs to fully cure before moving / installing.
- 4 - Attach Batwing Stile 503 to Glass edge. Rhodorsil V-60 securely in place. Wipe clean. Allow 24 hrs to fully cure before moving / installing.
Note 3 - Insert Magnetic strip 50311, making sure the doors attract each other. Note 4 - Stile 503 finishes 10mm from glass bottom.
- 5 - Attach Splash Fin EX 13 across full width of exposed glass bottom.
- 6 - Clean up, pack for despatch.

Installation.

- 1 - Inspect Doors and extrusions for damage. Assemble all necessary components. Ensure site is clean.
- 2 - Fix the pre-drilled Wall Channel 504 to the wall using the four supplied stainless steel screws.
- 3 - Present the door panels (with Splash Fin fitted to the bottom) over the Wall Channel.
- 4 - Any out of square to be corrected as Doors are installed into the Wall Channel.
- 5 - Using a 4.2mm drill bit, drill through the pre-drilled holes into the Wall Channel, both front and back. Fix with the plastic fastener 73P and tap home carefully with a soft hammer. Note 5 - ensure the Door does not move from position when drilling holes.
- 6 - Fit the Handle 77 to each Door.
- 7 - Make sure the cams and Magnetic strips work together to seal the door correctly.
- 8 - Apply a bead of NG Silicone on the outside only of the Wall channel.
- 9 - Clean all fingermarks, leave site clean and tidy.

Note - All Pivots to be lubricated with WT90

Juralco Pivot Shower Door Systems - Cutting, Assembly, Installation

Batwing Twin Doors and Return, Cutting

- Glass Doors all toughened 6mm, Polish top, bottom edges. 2 x 12 dia holes.
- Glass Returns all toughened 4mm, Arris all edges
- Door heights either 1830mm or 1930mm.

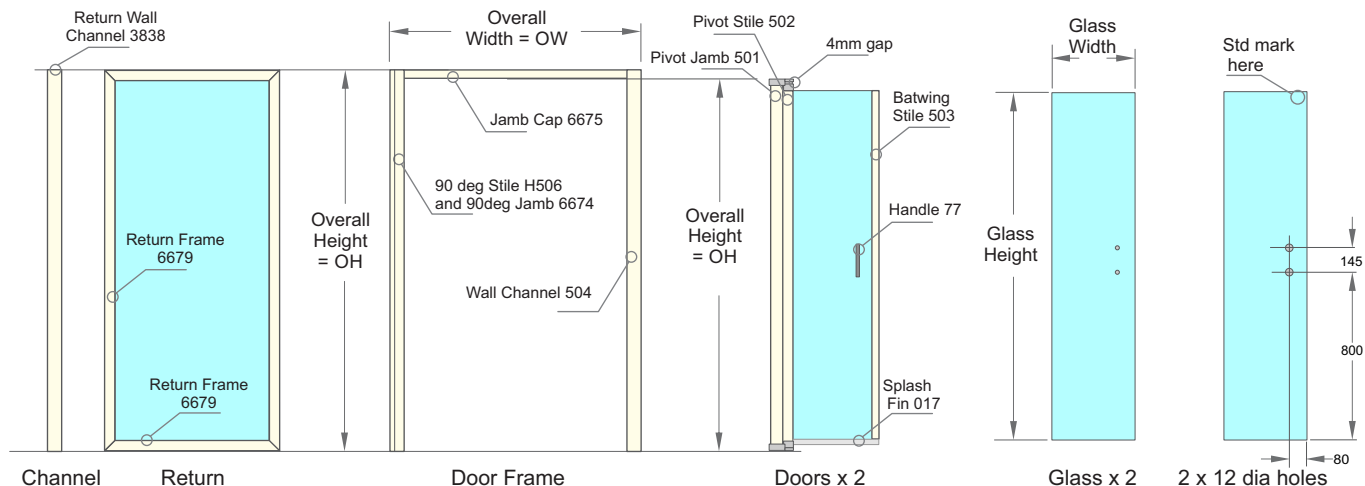

Note - All Pivots to be lubricated with WT90

Batwing Twin Doors and 90 deg return, Cutting			PART	Formula, mm
1	Width	Overall Width		OW
2	Width	Jamb Cap	6675	OW - 25
3	Width	Door, Glass	6mm	(OW - 120) / 2
4	Width	Return Depth		RD
5	Width	Return, Top, Bottom Rail (miter cuts)	6679	RD - 50
6	Width	Return Glass	4mm	RD - 90
1	Height	Door Frame Height		OH
2	Height	90 deg Jamb and 90deg Stile	6674, 506	OH
3	Height	Pivot Jamb	501	OH - 43
4	Height	Pivot Stile	502	OH - 61
5	Height	Door, Glass	6mm	OH - 63
6	Height	Batwing Stile	503	OH - 72
7	Height	Return Frame Height		OH
8	Height	Return, Top, Bottom Stiles (miter cuts)	6679	OH
9	Height	Return Wall channel	3838	OH
10	Height	Return, Glass	4mm	OH - 44

Batwing Twin Door and 90 Deg Return Assembly, Installation

Note: Prior to delivering to site, unpack and check all items

Note - Check all Glass is marked with Toughened Safety Glass Stamp

Assembly

- 1 - Inspect all extrusions for damage, surface defects. Assemble all necessary components. Ensure workplace is clean.
 - 2 - Assemble Top, bottom pivots (marked, 045 set) to the Pivot Jamb 501 and Pivot Stile 502, making sure that the Jamb seal 015 is in place. Screw up tight. Note 1 - the Jamb seal extends into the plastic Pivots. Note 2 - Make sure cams are lined up to central position.
 - 3 - Insert Glass into Pivot Stile 502. Rhodosil V-60 securely in place. Wipe clean. Allow 24 hrs to fully cure before moving / installing.
 - 4 - Attach Batwing Stile 503 to Glass edge. Clear Rhodosil V-60 securely in place. Wipe clean. Allow 24 hrs to fully cure before moving / installing.
- Note 3 - Insert Magnetic strip 50311, making sure the doors attract each other. Note 4 - Stile 503 finishes 10mm from glass bottom.
- 5 - Attach Splash Fin EX 13 across full width of exposed glass bottom.
 - 6 - Assemble Return Frame 6679, using Corner stakes 04. Glaze 4mm glass using Glazing Wedge 31 to outside.
 - 7 - Clean up, pack for despatch.

Installation.

- 1 - Inspect Doors and extrusions for damage. Assemble all necessary components. Ensure site is clean.
- 2 - The Door Frame consists of Wall Channel 504, Jamb Cap 6675 and the 90deg Return. Pop Rivet together at top corners.
- 3 - After carefully setting the Door Frame and Return Wall Channel out attach the Wall Channel 504 and 90deg Return to their walls using four stainless steel screws in each.
- 4 - Insert the Return Panel in place and attach to the 90 deg Return (on the Door Frame) and Return Wall Channel.
- 5 - Present the door panels (with Splash Fin fitted to the bottom) over the Wall Channel / 90 deg Return.
- 6 - Any out of square to be corrected as Doors are installed into their Channels.
- 7 - Using a 4.2mm drill bit, drill through the pre-drilled holes into the Channels, both front and back. Fix with the plastic fastener 73P and tap home carefully with a soft hammer. Note 5 - ensure the Door does not move from position when drilling holes.
- 8 - Fit the Handle 77 to each Door.
- 9 - Apply a bead of NG Silicone on the outside only of both the Wall channel and base of the Return Frame/Floor.
- 10 - Make sure the cams and Magnetic strips work together to seal the door correctly.
- 11 - Clean all fingermarks, leave site clean and tidy.

Note - All Pivots to be lubricated with WT90

Juralco Pivot Shower Door Systems - Extrusions, Components

Bathswing Extrusions Full Size

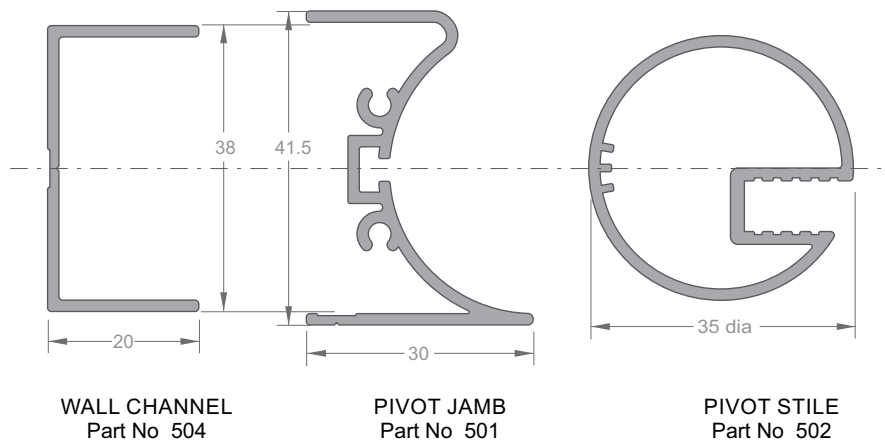

Bathswing Components

Pivot Set, Top and Bottom Part No 045

Note - All marked Top or Bottom Available as White or Grey

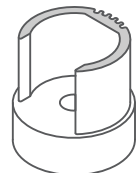

Bottom Plug (with cam)

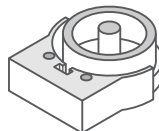

Bottom Pivot (with cam)



Top Plug

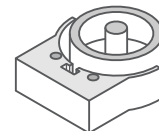

Top Pivot

Extended Splash Fin Part No 017

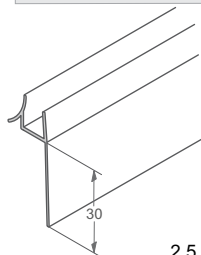

2.5 mt lengths

Jamb Seal Part No 015/50

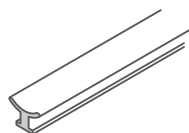

50 mt Rolls

Plastic Fastener Part No 73P



Tap in Fastener

Juralco Pivot Shower Door Systems - Typical Section, Cutting Allowances

Typical Bathswing Horizontal and Vertical Cross Sections

Note - All Pivots to be lubricated with WT90

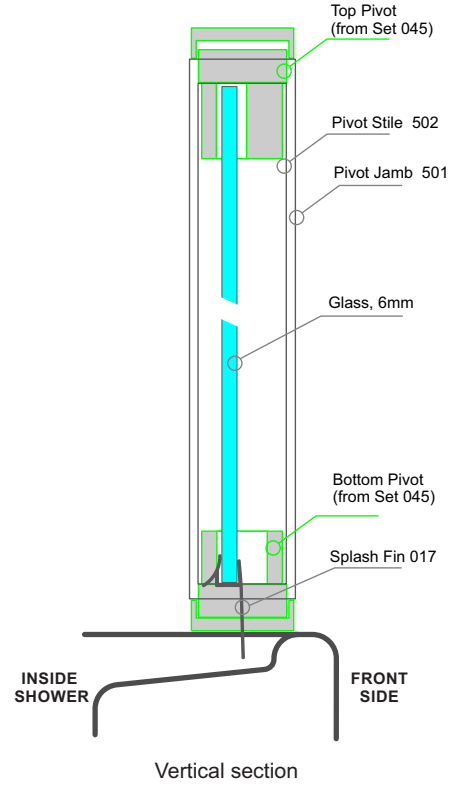
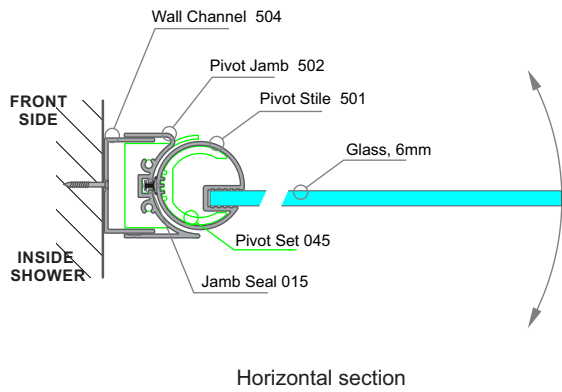

Single Door, Over Bath, 6mm Glass

Bathswing Cutting Allowances

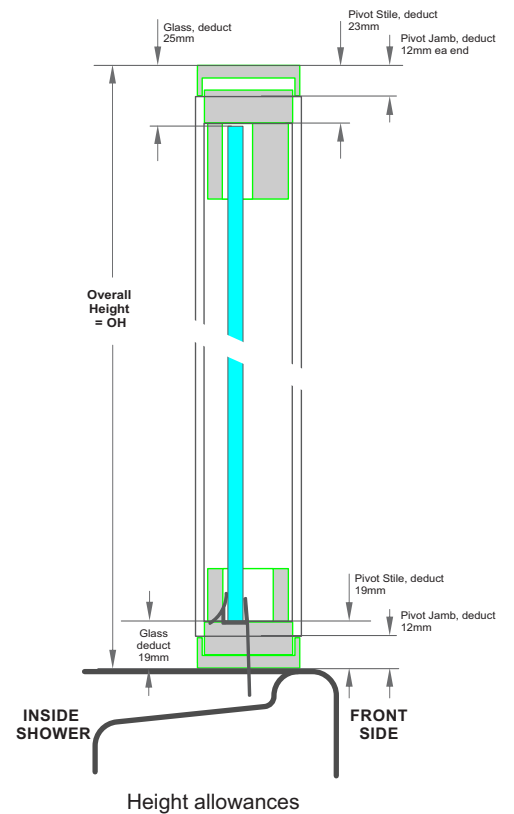
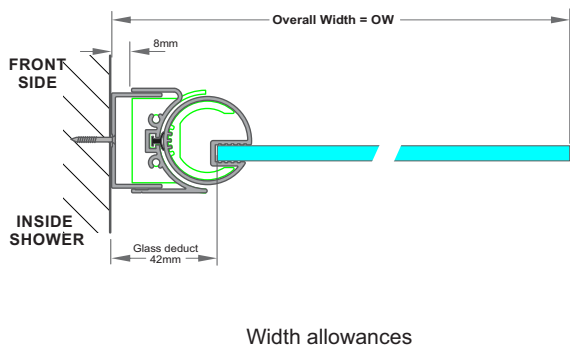

Single Door, Over Bath, 6mm Glass



Juralco Pivot Shower Door Systems - Cutting, Assembly, Installation

Bathswing Single Door Cutting

- Glass Doors all toughened 6mm, Polish All edges.
- Outside Corners top, bottom 10mm Radius
- Standard Door 1500mm high x 790mm wide.

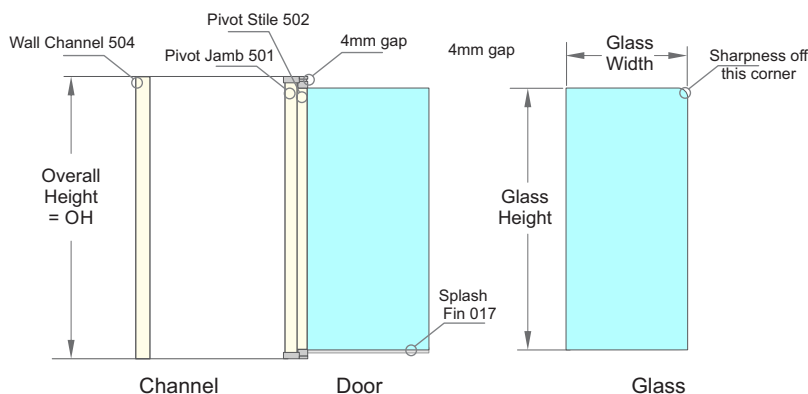

Note - All Pivots to be lubricated with WT90

Bathswing, Single Door Cutting			PART	Formula, mm
1	Width	Overall Width (standard 790mm)		OW
2	Width	Door, Glass	6mm	OW - 42

1	Height	Door Height (standard 1500mm)		OH
2	Height	Wall Channel	504	OH
3	Height	Pivot Jamb	501	OH - 24
4	Height	Pivot Stile	502	OH - 42
5	Height	Door, Glass	6mm	OH - 44

Bathswing Single Door Assembly, Installation

Note: Prior to delivering to site, unpack and check all items

Note - Check all Glass is marked with Toughened Safety Glass Stamp

Assembly

- 1 - Inspect all extrusions for damage, surface defects. Assemble all necessary components. Ensure workplace is clean.
- 2 - Assemble Top, bottom pivots (marked, 9802 set) to the Pivot Jamb 501 and Pivot Stile 502, making sure that the Jamb seal 015 is in place. Screw up tight. Note 1 - the Jamb seal extends into the plastic Pivots. Note 2 - Make sure cams are lined up to central position.
- 3 - Insert Glass into Pivot Stile 502. Rhodorsil V-60 securely in place. Wipe clean. Allow 24 hrs to fully cure before moving / installing
- 4 - Attach Splash Fin EX 13 across full width of glass bottom.
- 5 - Clean up, pack for despatch.

Installation (note - Doors come assembled for fitting to the right hand end of a bath.

For LH install, disassemble and rotate Glass panel top to bottom ensuring the Top and Bottom Pivots Remain in place, as originally.)

- 1 - Inspect Doors and extrusions for damage. Assemble all necessary components. Ensure site is clean.
- 2 - Line up the edge of the Wall channel about 5mm inside the Bath Profile.

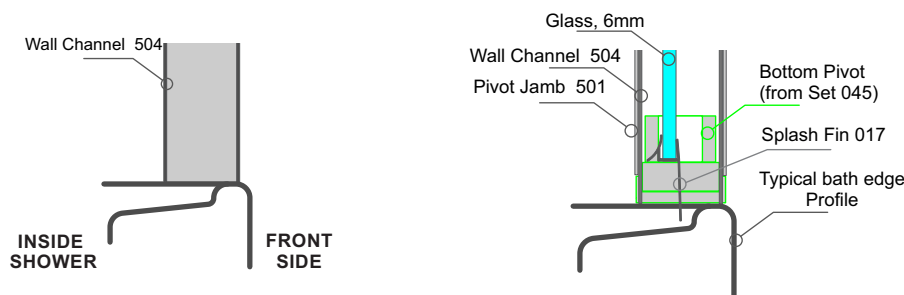

- 3 - Fix the pre-drilled Wall Channel 504 to the wall using the four supplied stainless steel screws plumb and square.
- 4 - Present the door panel (with Splash Fin fitted to the bottom) over the Wall Channel.
- 5 - Any out of square to be corrected as Door is installed into the Wall Channel.
- 6 - Using a 4.2mm drill bit, drill through the pre-drilled holes into the Wall Channel, both front and back. Fix with the plastic fastener 73P and tap home carefully with a soft hammer. Note - ensure the Door does not move from position when drilling holes.
- 7 - Make sure the cam locates the door correctly. If not remove the Top Pivot, lift the door and locate into a more appropriate fine adjustment groove. Screw to Top pivot back and retest.
- 8 - Apply a bead of NG Silicone on the outside only of the Wall channel.
- 9 - Clean all fingermarks, leave site clean and tidy.

All pages © Copyright Juralco Aluminium Building Products Ltd, 2017



JURALCO

www.juralco.co.nz ph (09) 478 8018

Juralco Pivot Shower Door Systems

Issue 1/17

Page 12