



Juralco Frameless Shower Systems

Juralco Aluminium Building Products Ltd designs and distributes specialist aluminium joinery systems through a national network of franchised fabricators and agents.

For more than 25 years we have been at the forefront of specialist aluminium door and window products suitable for New Zealand joinery and building methods. Our product range includes security and insect screens, balustrades and gates, Louvre Roofs, shutters and awnings, shower screens, wardrobe doors and organisers and internal doors.

Juralco Framless Shower enclosures are custom designed installations for medium to larger sized bathrooms. With clean elegant lines they are especially suited to the contemporary modern home or hotel. They are available as full height Shower enclosures or as Bath Screens in 10mm Toughened Glass. Layouts includes a Hinged door with 90 or 45 deg Returns or as a fixed panel, having no door. Sliding options include Single and Double Doors. The mounting aluminium extrusions, Hinges and Handles are available in a range different finishes. Refer to top of p4 for details.

Index

Heading	Pages	Description
Typical Layouts	3	General Arrangements. Hinged and Sliding
Extrusions and Components	4 - 11	Shows all Extrusions and Components
Measuring	12	Shows typical measurements needed
Hinged Panels - Cutting	13	Shows necessary Hinged Panel Height and Width cutting allowances
Hinged Cutting Calculators	14 - 16	Shows Hinged Panels cutting calculations
Over Panels	17	Shows various Over Panels
Bath Screens	18	Shows details relating to Bath Screens
Hinged Installation Tips	19	Shows on site Installation Tips
Hinged Door Order Forms	20 - 40	Glass Panel Order forms for Hinged configurations. Index (p20), Panels (p21-40)
Sliding Panels - Cutting	41- 42	Shows necessary Sliding Panel Height and Width cutting allowances.
Sliding Installation Tips	43	Shows Oasis Sliding Kit, and Install instructions
Sliding Door Order Forms	44 - 49	Glass Panel Order Forms for various Oasis Sliding configurations. Index (p44), Panels (p45-49)
Surface Care	50 - 51	Instructions for the care of Glass and Stainless Steel surfaces

Typical
Layouts

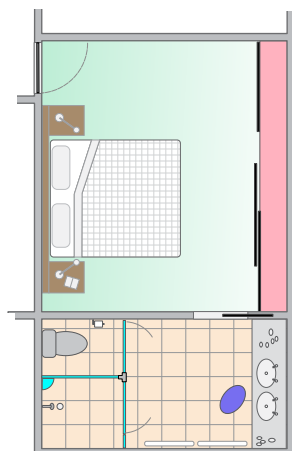

Juralco Frameless Shower/Toilet
Enclosures using a Back to Back
Glass Hinge

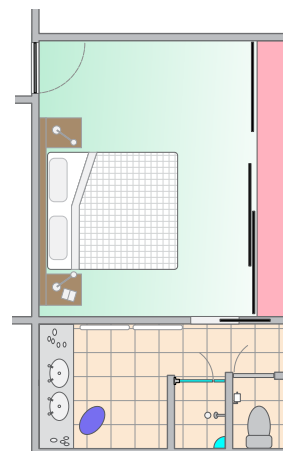

Juralco Frameless Shower Door
- between wall mount.

Juralco Frameless Shower Systems - General Descriptions

General Description

GENERAL DESCRIPTION

- The Shower Enclosure is not load bearing.
- All glass is toughened and the hinge systems provides for 10mm glass thicknesses, all to NZS 4233 Part 3 for human impact requirements.
- Also available as fixed panels, having no door.
- Although most enclosures are specially built to suit the designers requirements there are restrictions relating to door and glass panel sizes. All designs are checked to ensure compliance with regulations.
- All components are non rusting. Screws, springs and pins are manufactured in stainless steel. All hinges, handles and brackets are manufactured from solid brass.
- Most hinges have a cam action which allows the door to swing open and to self close from 20 degrees.
- The standard door height is 1900mm, but can range from 1850mm to 2100mm depending upon client specification.
- Normal Door width is 650mm. Minimum Side Panel width (for Glass to Glass hinge) is 150mm, otherwise 100mm.
- For doors hinged directly from the wall adequate stud fixings are required. Where inadequate wall fixing is suspected it is recommended the door be hinged from a glass Sidel Panel.

Typical Hinged Layouts

- Door Hinges come in two basic types, Wall mount or Glass mount.
- The Wall mounts are always 90 deg, Glass mounts may be 180 deg or 135 deg.
- Hinge selection depends on width and available wall fixings. Normally 2 per door, but 3 if door over 40kg.
- All shower enclosures are for 10mm Toughened Glass
- Doors normally 650mm wide. Height normally 1900mm
- Various Overhead bracing Struts are available to stabilise Panels.

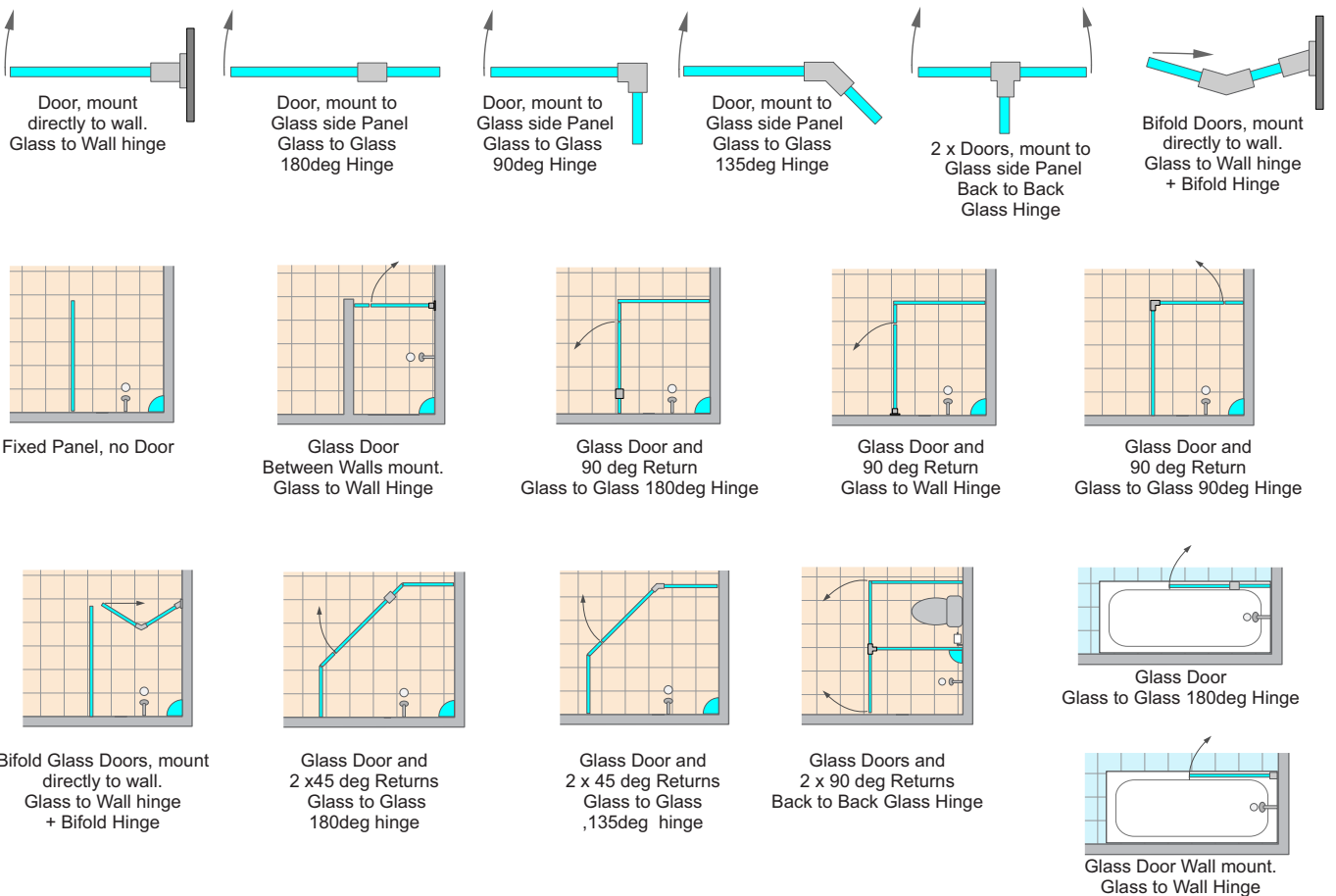

Typical Sliding Layouts

- Sliding Door using Oasis Hardware Kits
- All shower enclosures are for 10mm Toughened Glass
- Doors normally 750mm wide. Height normally 1900mm
- Various Overhead bracing Struts are available to stabilise Panels.

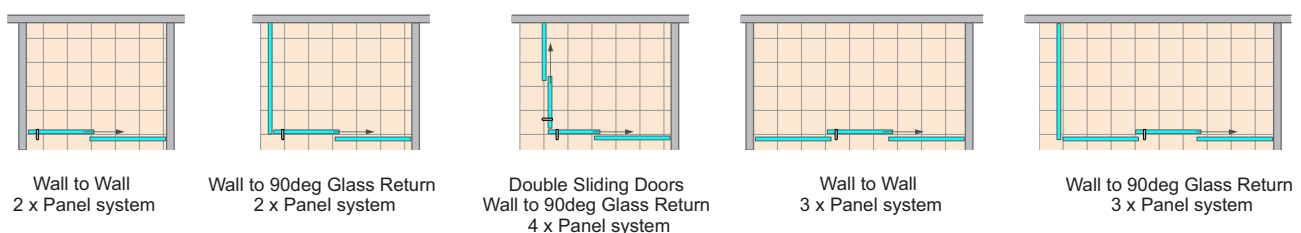

JURALCO

www.juralco.co.nz ph (09) 478 8018

Juralco Frameless Shower Systems

Issue 6- 24 v1

Page 3

Juralco Frameless Shower Systems - Extrusions, Components

Codes	Finishes	Codes	Finishes	Codes	Finishes	Codes	Finishes
BB	Brushed Brass	BRG	Brushed Rose Gold Copper	NAT	Natural Anodised	SCP	Satin Chrome
BCP	Black Chrome	CP	Polished Chrome	PSS	Polished SS	SN	Brushed Satin Nickel
BG	Brushed Gold	GM	Brushed Gun Metal	SB	Satin Brass	SSS	Satin SS
BN	Brushed Nickel	MB	Matt Black	SCC	Powder Coated	STE	Sterling Bright Anodised

Glazing Channels

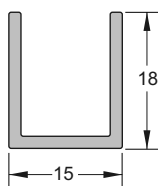

CHANNEL
15mm x 18mm
H/3877/2.1
and H/3877/3

Finishes
2.1 = STE, NAT, MB, SCC
3 = STE, NAT, MB, SCP
SN, GM, SB, BG, SCC

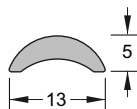

WATERBAR
H/978/2.8

Finishes
STE, NAT, MB, SCP, BN, SB
SN, GM, BG, BRG, SCC

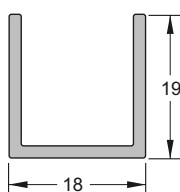

CHANNEL
18mm x 19mm
H/970/2.1
and H/970/3

Finishes
2.1, 3 = STE, NAT, MB, SCC

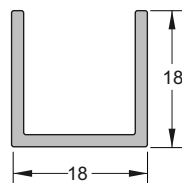

CHANNEL
18mm x 18mm
H/970/2.1
and H/970/3/

Finishes
2.1 = SCP, SN, GM, BG
3 = SCP, SN, BN,
GM, SB, BG, BRG, MB, SCC, SC

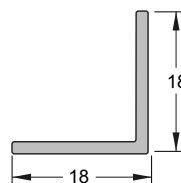

ANGLE
18mm x 19mm
H/976/2.5

Finishes
STE, NAT, SCC

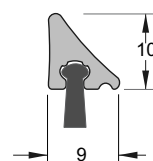

WATER SEAL
with FELT
H/979/2.8

Finishes
STE, NAT, MB, SCP, SN, BN
GM, SB, BG, BRG, SCC

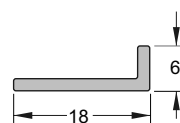

ANGLE
18mm x 6mm
H/975/2.8

Finishes
STE, NAT, SCP, BN, SB
SN, GM, BG, SCC

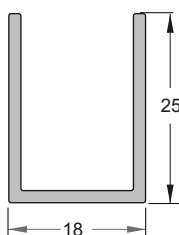

CHANNEL
18mm x 25mm

Finishes
H/973/2.1 - STE, MAT, SCC
H/973/3 - STE, NAT, BLK, BG, BN, GM, SCP, SN, SCC



Glazing Wedge
200m Roll
PN 31

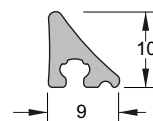

WATER SEAL
No FELT
H/980/2.8

Finishes
STE, NAT, MB, SCP, SN, BN
GM, SB, BG, BRG, SCC

Elite Shower Hinges

- All for 10mm Glass
- 2 x Hinges, max Door weight 40kg (for 10mm Glass = 1.6sqm)
- 3 x Hinges, max Door weight 60kg

Features include:

- Glued Clamp Gaskets
- Glued Notch Gaskets
- Knuckle protectors

Wall to Glass Hinge, Centered JH1

Finishes CP, SCP, MB, SN,
GM, BB, SCC

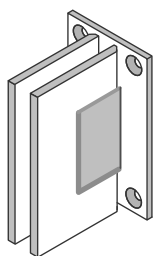

Wall fixing plate available

Wall to Glass Hinge, Offset JH1/L3

Finishes CP, SCP, MB, SN,
GM, BB, SCC

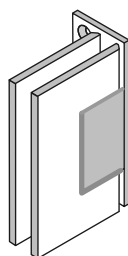

Wall fixing plate available

Glass to Glass Hinge, 180deg JH2

Finishes CP, SCP, SN, BN, MB, GM,
BB, BCP, BG, BRG, SCC

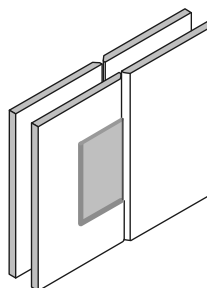

Glass to Glass Hinge, Bifold JH2/BF

Finishes CP, SCP, BN, MB, SCC

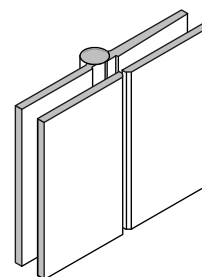

Glass to Glass Hinge, 135 deg JH2/135

Finishes CP, SCP, MB, SN,
GM, BB, SCC

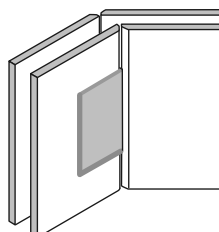

Glass to Glass Hinge, 135 deg JH2/135A (Adjustable)

Finishes CP
5 Degrees Adjustment

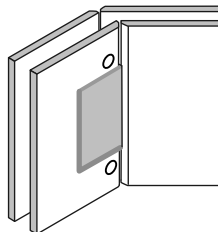

Glass to Glass Hinge, 90deg JH2/90

Finishes CP, SCP, BN, MB, SCC

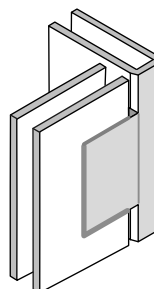

Back to Glass Hinge, 90deg JH3/90

Finish CP

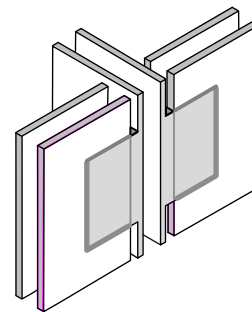

Juralco Frameless Shower Systems - Components

Codes	Finishes
BB	Brushed Brass
BCP	Black Chrome
BG	Brushed Gold
BN	Brushed Nickel

Codes	Finishes
BRG	Brushed Rose Gold Copper
CP	Polished Chrome
GM	Brushed Gun Metal
MB	Matt Black

Codes	Finishes
NAT	Natural Anodised
PSS	Polished SS
SB	Satin Brass
SCC	Powder Coated

Codes	Finishes
SCP	Satin Chrome
SN	Brushed Satin Nickel
SSS	Satin SS
STE	Sterling Bright Anodised

Glazing Channel End Caps

Channel End Caps
for 15mm x 18mm channel
H/EC3877

Finishes STE, NAT, MB, SCP,
BN, GM, BG, SCC

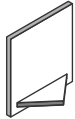

Channel End Caps
for 18mm x 18mm channel
H/EC1818

Finishes SCP, SN, GM, BN,
BG, BRG

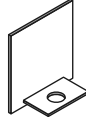

Channel End Caps
for 19mm x 18mm channel
H/EC970

Finishes STE, NAT, MB, SCC



Channel End Caps
for 18mm x 25mm channel
G/EC1825

Finishes STE, NAT, MB, SCP
BN, GM, SN, SCC

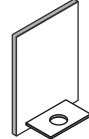

Over Panel Clips

Chamfered Over Panel Clip
10mm to 6mm Glass
OP/10C

Finishes PSS, SSS, BN, SN, MB, GM,
BB, BCP, BG, BRG, SCC

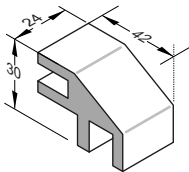

Fits 6mm Glass Horizontal
Fits over 10mm Glass Vertical
Clamp screws. Gaskets included

Round Over Panel Clip
10mm to 6mm Glass
OP/10R

Finishes CP, SCP, BN, SN, MB, GM,
BG, BB, SCC

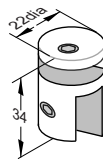

Fits 6mm Glass Horizontal
Fits over 10mm Glass Vertical
Clamp Screws. Gaskets included

Square Over Panel Clip
10mm to 6mm Glass
OP/10S

Finishes PSS, SSS, MB, GM, SN,
BB, SCC

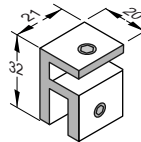

Fits 6m Glass Horizontal
Fits over 10mm Glass Vertical
Clamp Screws. Gaskets included

Square Over Panel Clip
10mm to 10mm Glass
OP/1010S

Finishes CP

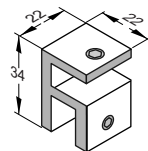

Fits 10m Glass Horizontal
Fits over 10mm Glass Vertical
Clamp Screws. Gaskets included

Shower Pulls

Note - Shower Pull Holes all 100mm C/L from Edge of Glass Panel

Round Pull Knob Set
30mm dia x 50mm(ea)
JK/25

Finishes CP, SCP, SCC

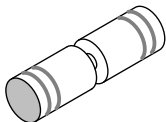

12mm hole

Round Pull Knob Set
30mm dia x 30mm(ea)
H/75

Finishes CP

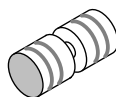

12mm hole

Square Pull Knob Set
25mm sq x 43mm (ea)
JK/25S

Finishes CP, SCP, SCC

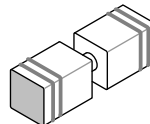

12mm hole

Round Pull Knob Set
30mm dia x 40mm(ea)
JK/30

Finishes CP, SCP, SCC

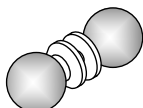

12mm hole

Round Pull Knob Set
32mm dia x 30mm(ea)
JK/32

Finishes CP, SCP, BN, MB, GM,
SB, BG, SCC

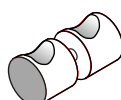

12mm hole

Tapered Pull Knob Set
38mm dia x 43mm (ea)
JK/60

Finishes CP, SCP, SCC

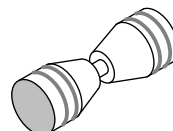

12mm hole

Sq Paddle Pull Knob Set
70mm x 50mm x 24mm (ea)
JK/70

Finishes CP, SCP, SCC

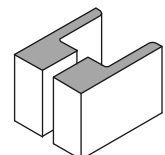

2x12mm holes @32crs (vertical)

Juralco Frameless Shower Systems - Components

Codes	Finishes
BB	Brushed Brass
BCP	Black Chrome
BG	Brushed Gold
BN	Brushed Nickel

Codes	Finishes
BRG	Brushed Rose Gold Copper
CP	Polished Chrome
GM	Brushed Gun Metal
MB	Matt Black

Codes	Finishes
NAT	Natural Anodised
PSS	Polished SS
SB	Satin Brass
SCC	Powder Coated

Codes	Finishes
SCP	Satin Chrome
SN	Brushed Satin Nickel
SSS	Satin SS
STE	Sterling Bright Anodised

Handles

Note - Handle Holes all 100mm C/L from Edge of Glass Panel

Double D Handle
25mm dia x 275 high
JH/D250

Finishes PSS, SSS, BN, MB, GM,
BG, SN, BB, SCC

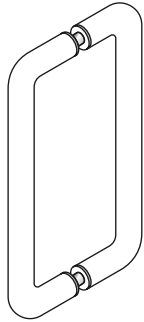

2x10mm holes @250crs

Double D Handle
25mm dia x 235 high
JH/D210

Finishes PSS, SSS, MB, GM,
SN, BB, SCC

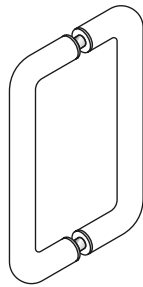

2x10mm holes @210crs

Quadrant Double D Handle
20 x 10mm x 270 high
JH/Q250

Finishes PSS, SSS, BN, MB, GM,
BB, SB, SN, BG, BCP, BRG, SCC

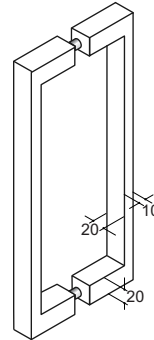

2x10mm holes @250crs

Quadrant Double D Handle
20 x 10mm x 230 high
JH/Q210

Finishes PSS, SSS MB,
BB, SN, GM, SCC

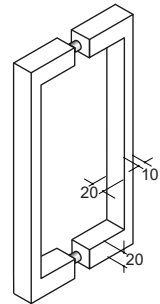

2x10mm holes @210crs

Fineline Round Double Handle
25mm dia x 350 high
JH/FR250

Finishes PSS, SSS, MB, GM,
BB, SN, SCC

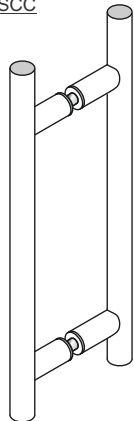

2x10mm holes @250crs

Fineline Round Double Handle
20mm dia x 310 high
JH/FR210

Finishes PSS, SSS, GM,
BB, SN, SCC

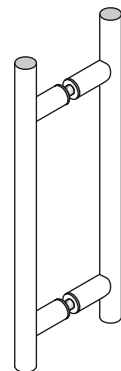

2x10mm holes @210crs

Fineline Square Double Handle
19mm sq x 350 high
JH/FS250

Finishes PSS,
MB,SSS, SCC

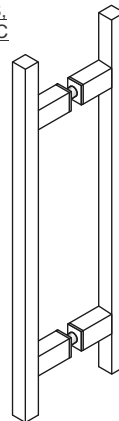

2x10mm holes @250crs

Fineline Square Double Handle
19mm sq x 250 high
JH/FS150

Finishes PSS, SCC

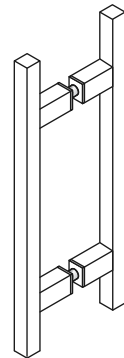

2x10mm holes @150crs

Towel + Pull Handles

Note - First Handle Hole all 100mm C/L from Edge of Glass Panel

Single D/Towel & Pull Handle
25mm dia x 475 wide
JH/SD400P

Finishes PSS, SSS, SCC

2x12mm holes @400crs

Single D/Towel & Pull Handle
25mm dia x 575 wide
JH/SD500P

Finishes PSS, SSS, SCC

2x12mm holes @500crs

Single D & Pull Handle
25mm dia x 275 high
JH/SD250P

Finishes PSS, SSS, SCC

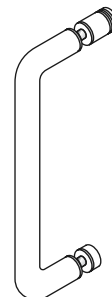

2x10mm holes @250crs

Sliding Door Pull Set
58mm dia JSS/SPP

Finishes PSS, SSS, BN, MB,
GM, SB, BG, SCC

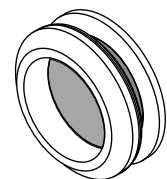

48mm hole

Juralco Frameless Shower Systems - Components

Codes	Finishes
BB	Brushed Brass
BG	Brushed Gold
BN	Brushed Nickel

Codes	Finishes
BRG	Brushed Rose Gold Copper
CP	Polished Chrome
GM	Brushed Gun Metal
MB	Matt Black

Codes	Finishes
NAT	Natural Anodised
PSS	Polished SS
SB	Satin Brass
SCC	Powder Coated

Codes	Finishes
SCP	Satin Chrome
SN	Brushed Satin Nickel
SSS	Satin SS
STE	Sterling Bright Anodised

Brackets and Shelves

Round Shelf Bracket
5-6mm Glass
G/GSB6R

Finishes CP

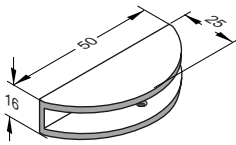

1x10gx38 C/S screw

Round Shelf Bracket
8-10mm Glass
G/GSB10R

Finishes CP, SCC

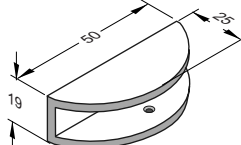

1x10gx38 C/S screw

Rectangular Shelf Bracket
8-10mm Glass
G/GSB10SQ

Finishes CP, SCP, BN, MB, GM, SB, BG, BRG, SCC

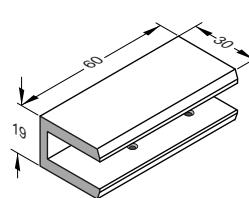

2x10gx38 C/S screw

Towel/Robe Hook
25dia x 55mm 10mm Glass
G/TRH

Finishes PSS, SCC

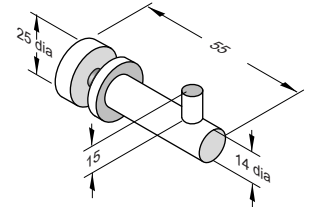

12mm hole

Glass Corner shelf 200mm
10mm Toughened Glass
G/GS1/200

Clear Toughened



Glass Corner shelf 250mm
10mm Toughened Glass
G/GS1/250

Clear Toughened



Glass shelf 150 x 300mm
10mm Toughened Glass
G/GS3/300

Clear Toughened

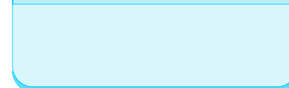

PVC Seals - Clear

Bottom Door Seal
10mm Glass
G/FS01/1.4/CLE

Clear

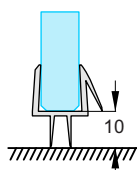

1400mm long

Extended Bottom Door Seal
10mm Glass
G/FS02/2.1/CLE

Clear

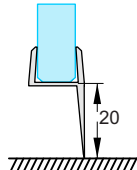

2100mm long

Glass To Glass 135 deg Seal
10mm Glass
G/FS03/2.1/CLE

Clear

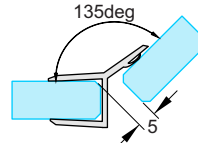

2100mm long

Glass To Glass 180 deg Seal
10mm Glass
G/FS04/2.1/CLE

Clear

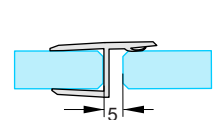

2100mm long

Bulb Door Seal
10mm Glass
G/FS05/2.1/CLE

Clear

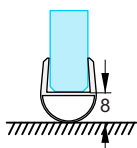

2100mm long

Sliding Door Seal
10mm Glass
G/FS06/2.1/CLE

Clear

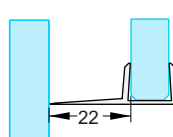

2100mm long

Glass To Glass 90 deg Seal
10mm Glass
G/FS07/2.1/CLE

Clear

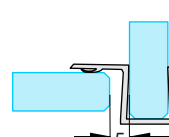

2100mm long

Bulb Door Seal
10mm Glass
G/SFS08/2.1/CLE

Clear (with DS Tape)

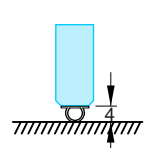

2100mm long



JURALCO

www.juralco.co.nz ph (09) 478 8018

Juralco Frameless Shower Systems

Issue 6- 24 v1

Page 7

Juralco Frameless Shower Systems - Components

Codes	Finishes
BB	Brushed Brass
BG	Brushed Gold
BN	Brushed Nickel

Codes	Finishes
BRG	Brushed Rose Gold Copper
CP	Polished Chrome
GM	Brushed Gun Metal
MB	Matt Black

Codes	Finishes
NAT	Natural Anodised
PSS	Polished SS
SB	Satin Brass
SCC	Powder Coated

Codes	Finishes
SCP	Satin Chrome
SN	Brushed Satin Nickel
SSS	Satin SS
STE	Sterling Bright Anodised

Shower Brace Components

Shower Brace Rod
19mm dia x 1mm
G/SBR/19DX1200
G/SBR/19DX600
G/SBR/19DX100

Finishes All - PSS, SSS, SCC

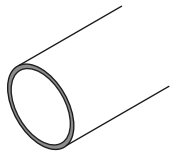

Lengths. 1200,600 and 100mm

Shower Brace to Wall
- Adjustable Bracket.
- 19mm dia Tube
G/SBR/01

Finishes CP, SCP, SCC

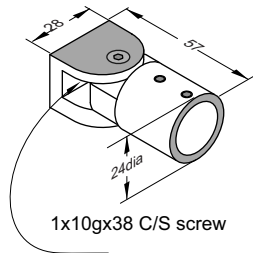

Shower Brace to 10mm Glass
- Adjustable Bracket.
- 19mm dia Tube
G/SBR/02

Finishes CP, SCP, SCC

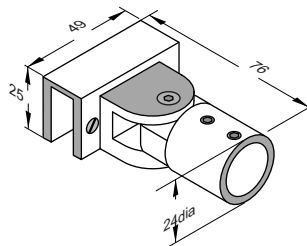

Shower Brace to 10mm Glass
- Inline Bracket.
- 19mm dia Tube
G/SBR/03

Finishes CP, SCP, SCC

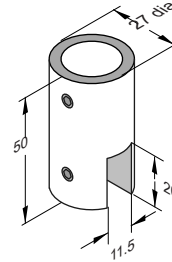

Shower Brace to
- Ceiling or Floor.
- 19mm dia Tube
G/SBR/04

Finishes CP, SCP, SCC

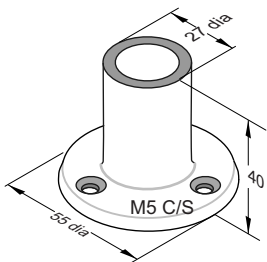

Shower Brace
Wall Fix Bracket
- 30x10mm Rail
JSS/WFB

Finishes: PSS, SSS, BN, MB, GM,
SB, BG

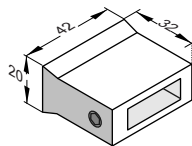

Rail to Glass 90deg
End Brace
- Bracket to 10mm Glass
- 30x 10mm Raile
G/GBR/RGB

Finishes PSS, SCC

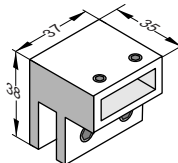

Rail to Glass Extended 90deg
- End Brace to 10mm Glass
- 30 x10mm Rail
G/GBR/RGE

Finishes PSS, SCC

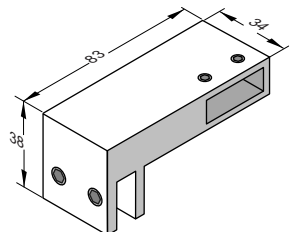

Rail 30 x 10mm
JSS/RAIL/1000

Finishes PSS, SCC

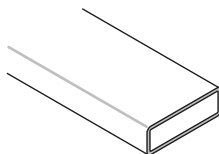

Hinge Fixing Plates

Fixing Plate
for Hinge JH1

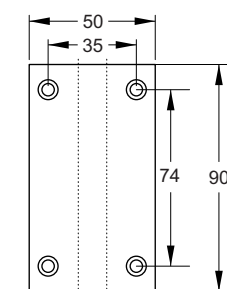

Approx Glass Lines

Fixing Plate
for Hinge JH1/L3

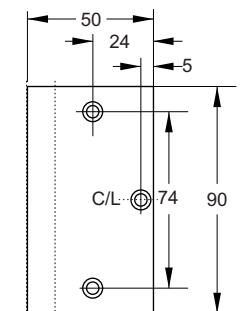

Approx Glass Lines

Header Support Bar
20 x 5mm
G/HB/1000

Finish PSS only

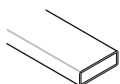

Header Support Bar
20 x 5mm
G/HB/1200

Finishes PSS, SSS,
MB, GM, BG, SCC

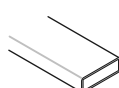

Header Support Bar
End Cap
G/HB/EC

Finishes PSS, SSS,
MB, GM, BG, SCC



This system replaces the use of Glass Over Panels to stabilise the Shower.
Use in conjunction with the Chamfered Over Panel Clip OP/10C

Juralco Frameless Shower Systems - Components

Codes	Finishes
BB	Brushed Brass
BG	Brushed Gold
BN	Brushed Nickel

Codes	Finishes
BRG	Brushed Rose Gold Copper
CP	Polished Chrome
GM	Brushed Gun Metal
MB	Matt Black

Codes	Finishes
NAT	Natural Anodised
PSS	Polished SS
SB	Satin Brass
SCC	Powder Coated

Codes	Finishes
SCP	Satin Chrome
SN	Brushed Satin Nickel
SSS	Satin SS
STE	Sterling Bright Anodised

Shower Brace Sets

- Shower Brace Rod Set**
 - Wall to 10mm Glass,
 - 19mm dia Tube, 1200mm
 - Swivel Bracket
 - Adjustable length
 G/SBR/1200

Finishes: PSS, SSS, SCC

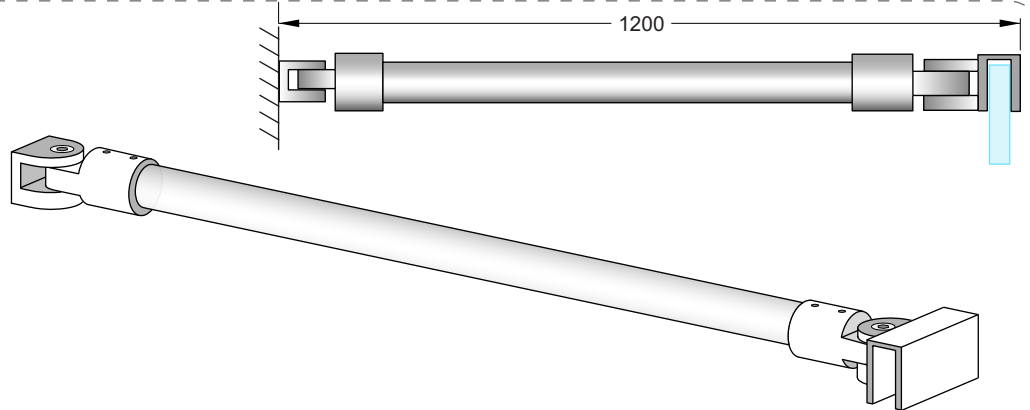

- Shower Brace Rod Set**
 - Wall to 10mm Glass,
 - 30x10mm Rail 1000mm
 - Fixed Bracket
 - Adjustable length
 G/SBS/1000

Finishes: PSS, SSS, SCC

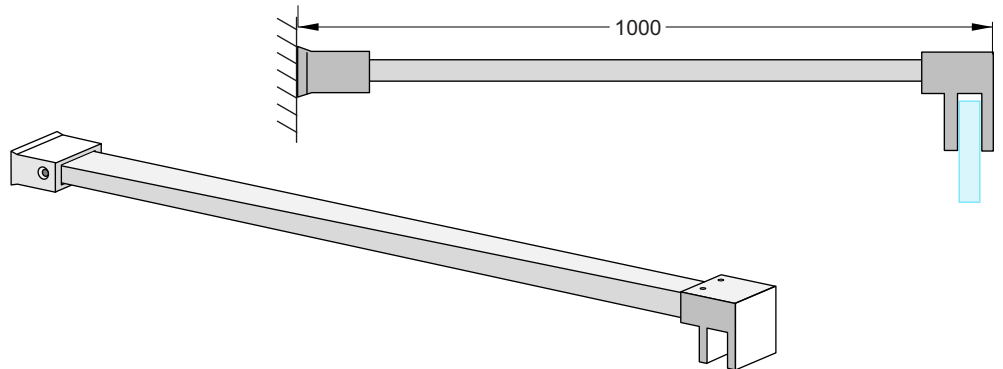

- Shower Ceiling Brace Rod Set**
 - 19mm dia Tube, 600mm
 - Adjustable length
 G/SCBR/600

Finishes: PSS, SSS, SCC

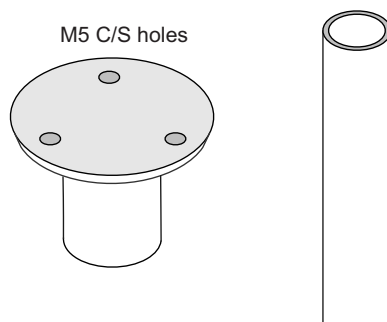

- Shower Floor Brace Rod Set**
 - 19mm dia Tube, 100mm
 - Adjustable length
 G/SFBR/100

Finishes: PSS, SSS, SCC

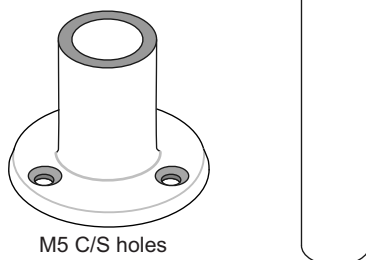

- Shower Brace to Ceiling**
 - 19mm dia Tube
 G/SBR/04

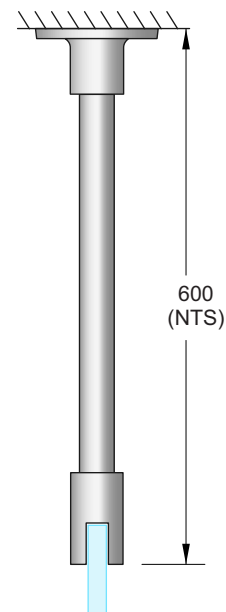

- Shower Brace**
 10mm Glass
 - Inline Bracket.
 - 19mm dia Tube
 BR/03

- Shower Brace**
 10mm Glass
 - Inline Bracket.
 - 19mm dia Tube
 BR/03

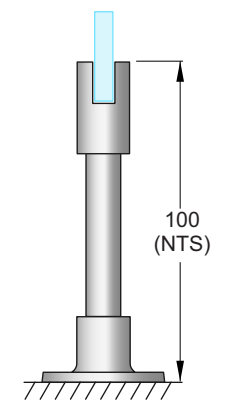

- Shower Brace to Floor.**
 - 19mm dia Tube
 G/SBR/04

Juralco Frameless Shower Systems - Cutouts

Glass to Wall Hinge
Centered JH1

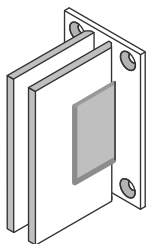

Glass to Wall Hinge
Offset JH1/L3

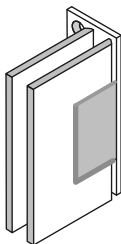

Glass Cutouts, Both Hinges

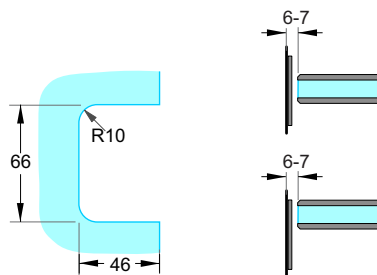

Glass to Glass Hinge
180deg JH2

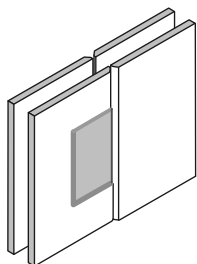

Glass Cutouts
JH2

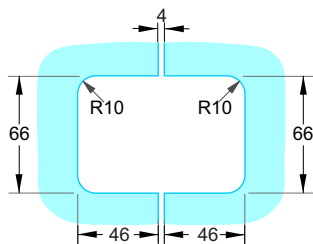

Glass to Glass Hinge
135 deg JH2/135

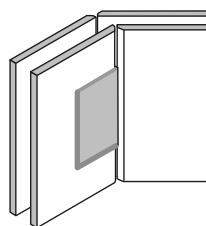

Glass Cutouts
JH2/135

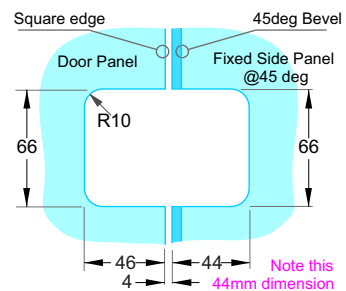

Glass to Glass Hinge
Bifold JH2/BF

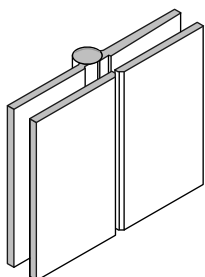

Glass Cutouts
JH2/BF

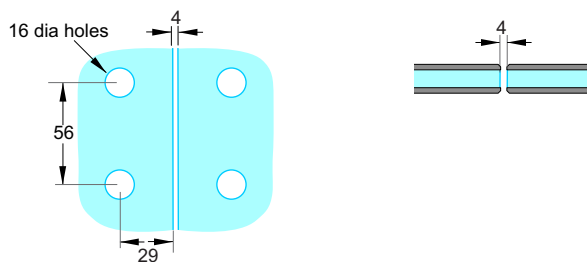

Glass to Glass Hinge
90deg JH2/90

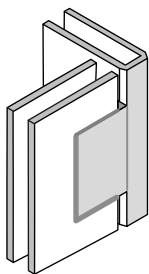

Glass Cutouts
JH2/90

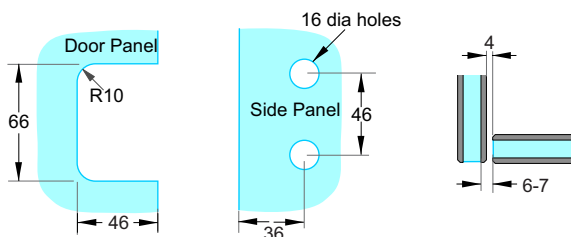

Back to Glass Hinge
90deg JH3/90

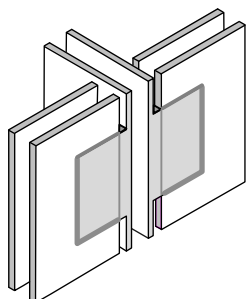

Glass Cutouts
JH3/90

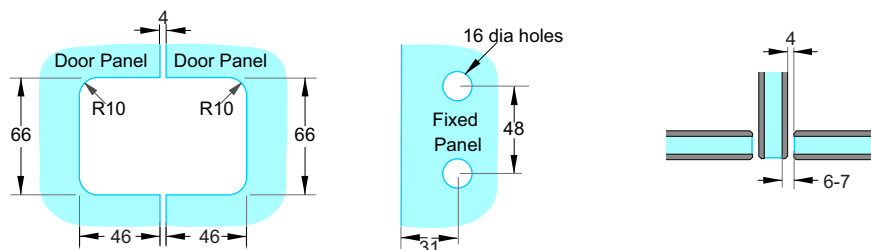

Juralco Frameless Shower Systems - Components

Shower Door Privacy Latches

G/IL600C/SSS. Hinged Glass Door to Wall. Includes Keeper (No glass cutout required)

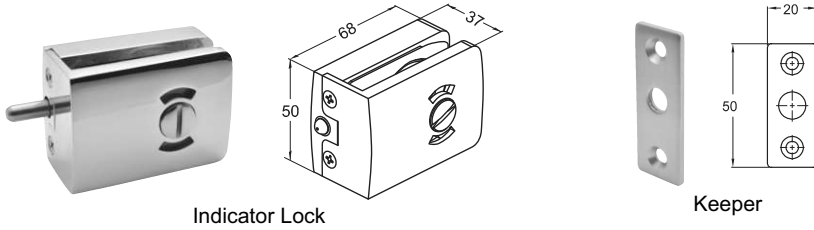

Indicator Lock

Keeper

G/IL700C/SSS and PSS. Hinged Glass Door to Wall. Includes Keeper (Glass cutout required)

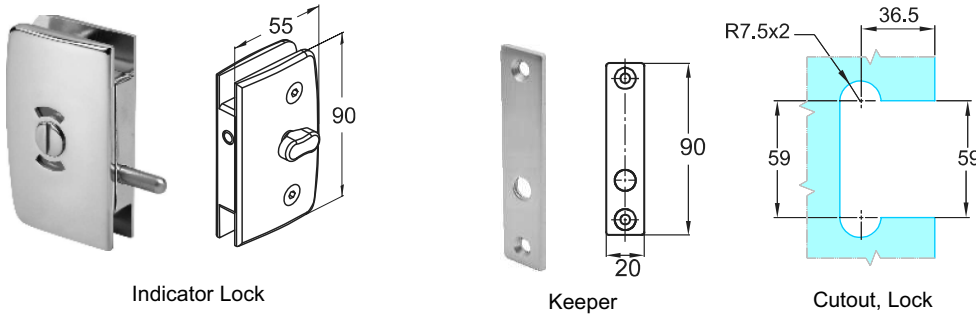

Indicator Lock

Keeper

Cutout, Lock

G/IL701C/SSS and PSS. Hinged Glass Door to Glass Side Panel. Includes Keeper (Glass cutout required)

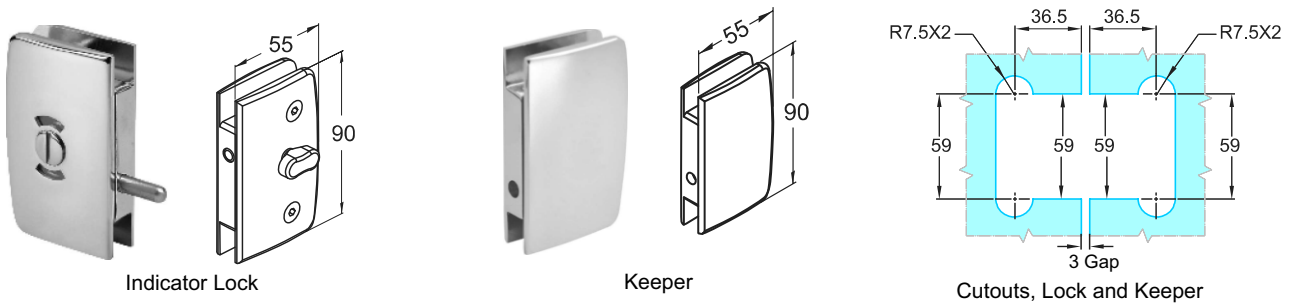

Indicator Lock

Keeper

Cutouts, Lock and Keeper

G/IL700C-H/SSS and PSS. Sliding Glass Door to Wall. Includes Keeper (Glass cutout required)

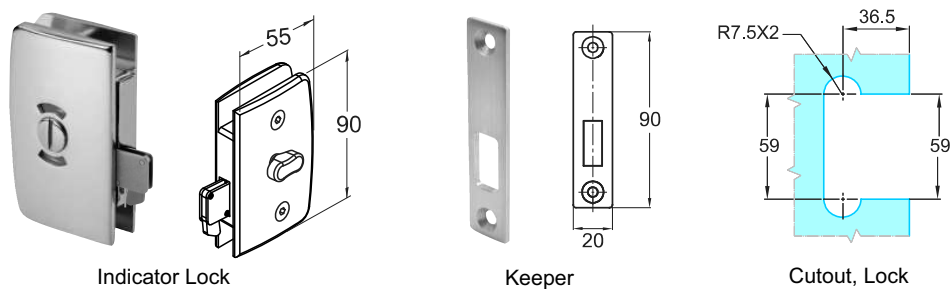

Indicator Lock

Keeper

Cutout, Lock

G/IL701C-H/SSS and PSS. Sliding Glass Door to Glass Side Panel. Includes Keeper (Glass cutout required)

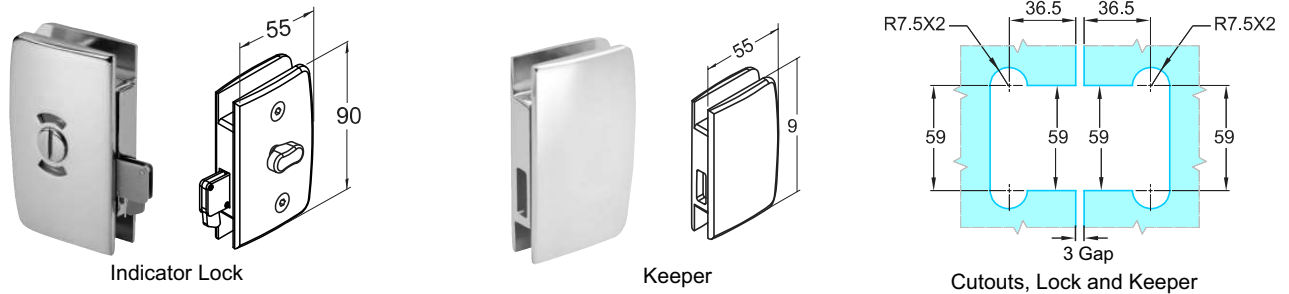

Indicator Lock

Keeper

Cutouts, Lock and Keeper

Juralco Frameless Shower Systems - Measuring, Typical Sections

Measuring

- Measure twice, cut once!
- For doors hinged directly from the wall adequate stud fixings are required. Either a double stud or a 90mm width of timber fitted between nogs at hinge level is required.
- Where inadequate wall fixing is suspected or penetration of Waterproofing isn't an option it is recommended the door be hinged from a glass sidelight panel.
- For shower enclosures with return panels, establish points at corners where outside line of the Glass will finish. Measure to these points. Small off-cuts of channel sections are useful to assist in determining where shower the enclosure is to finish. This is especially true for the 45 deg return panel type..
- Measure and take note of all out of square situations. If necessary take a pattern of shape and mark all straight lines on pattern.
- For sloped floors deduct 5mm from door height measured at the highest point of the complete door swing area.
- For out of plumb situations it is often best to measure and fit the glass side panel/s (which will have been cut to provide a true perpendicular edge from which to hinge the door) first and remeasure the remaining door opening before toughening and fitting the door.
- Height normally 1900mm.

Typical Layout, Components

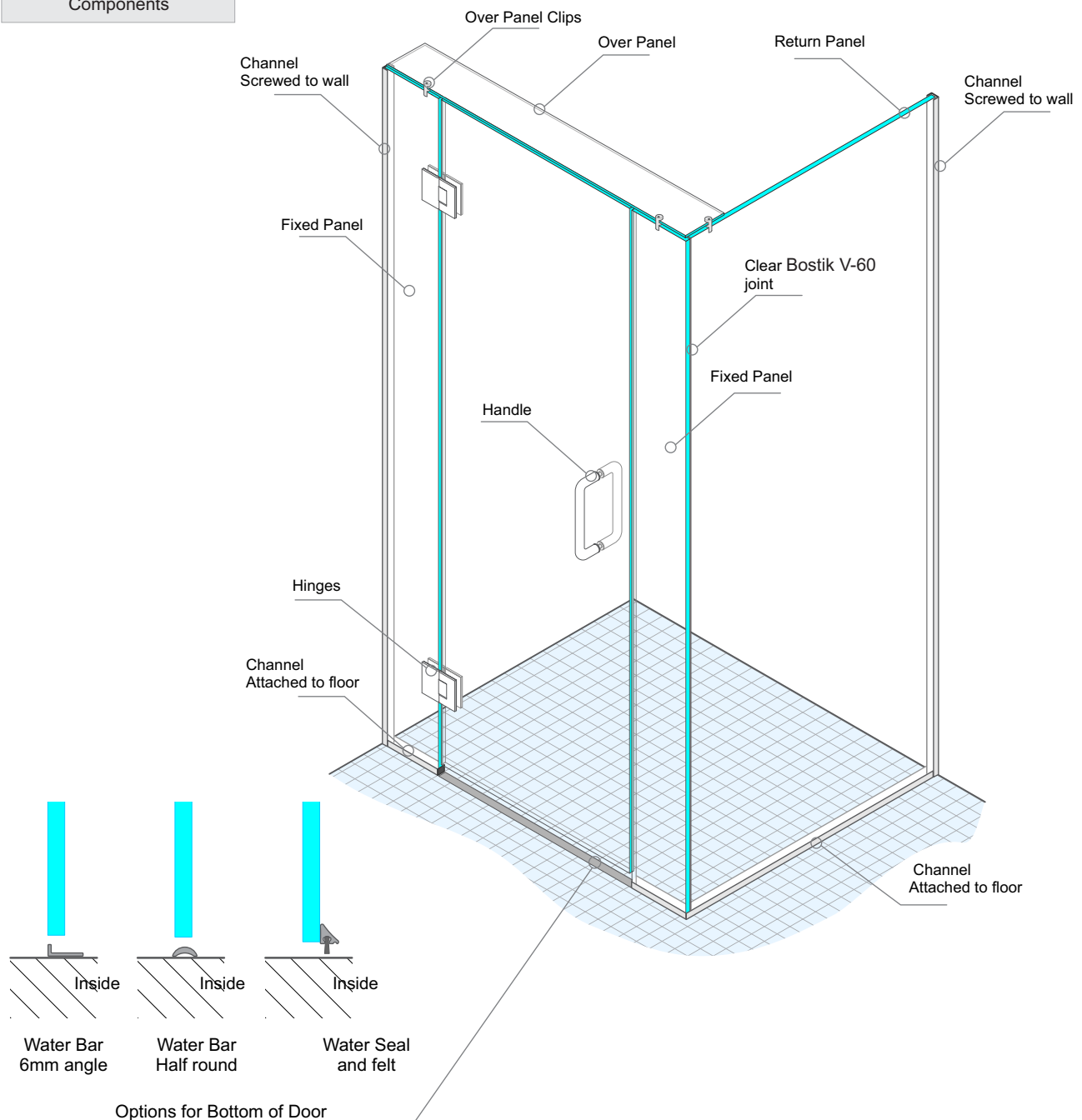

Juralco Frameless Shower Systems - Hinged Cutting Allowances

Glass Cutting Height Allowances

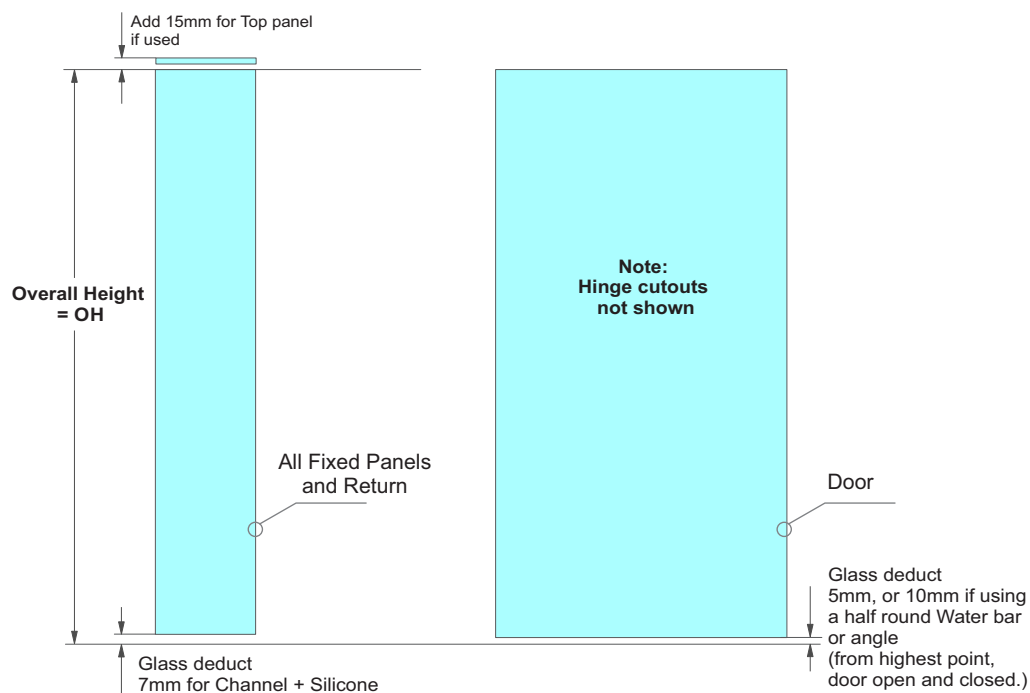

Glass Cutting Width Allowances

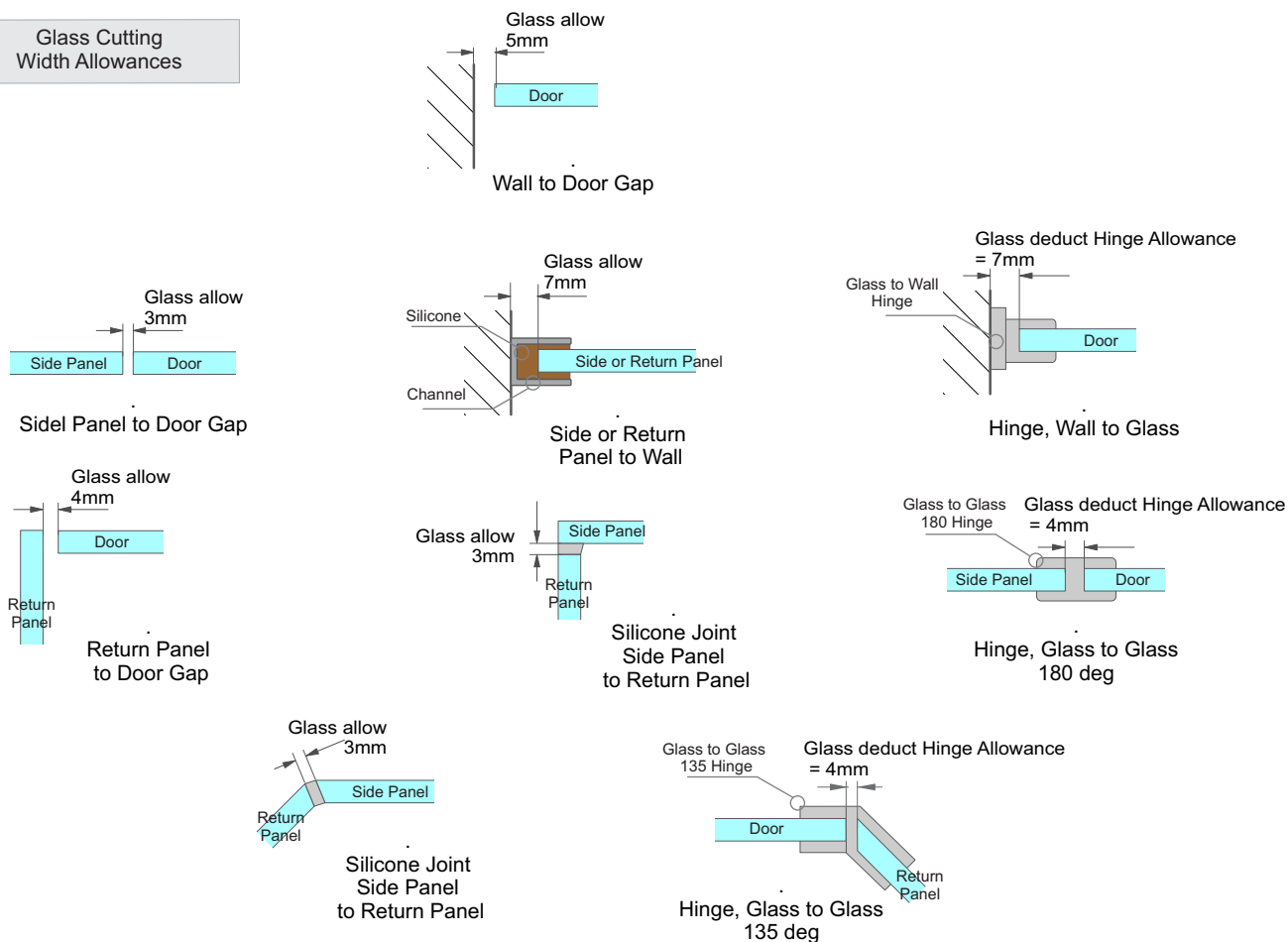

JURALCO

www.juralco.co.nz ph (09) 478 8018

Juralco Frameless Shower Systems

Issue 6- 24 v1

Page 13

Juralco Frameless Shower Systems - Cutting

Between Walls Cutting. **Glass 10mm**

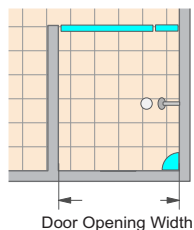

A 10mm Glass
Glass to Glass 180 Hinge
1 x Door,
2 x Sidelights
1 x Overpanel



Opening Width range
1000 - 1250+mm

B 10mm Glass
Wall to Glass Hinge
1 x Door,
1 x Sidelight



Opening Width range
800 - 1100mm

C 10mm Glass
Glass to Glass 180 Hinge
1 x Door,
1 x Sidelight
1 x Overpanel



Opening Width range
850 - 1100mm

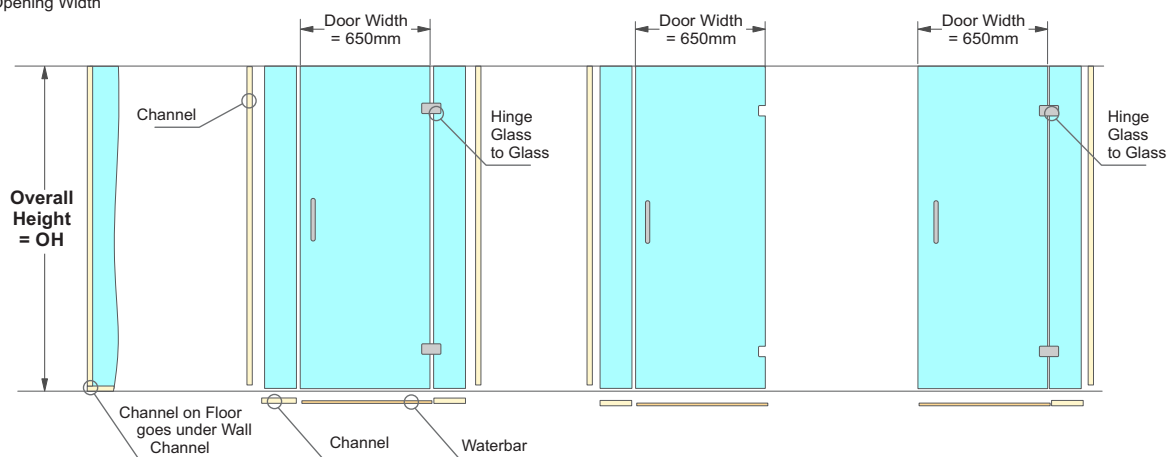

Note 1 - All these width cutting formula assume Door width = 650mm

Shower between Walls - Heights

Heights	Item	Dimension
Overall Height		OH
Glass Door (No Waterbar)	10mm Glass	OH-5
Glass Door (Waterbar)		OH-10
Glass Side Panel		OH-7
Channel	H/970	OH-18

Option A - Shower between Walls - Widths

Widths	Item	Dimension
Opening Width - 1000mm		OW
Glass Door	10mm Glass	650
Glass Side Panels (100mm min)		(OW-670)/2
Channel	H/970	(OW-663)/2
Water Bar (clearance for End Caps)	H/970	654

Option B - Shower between Walls - Widths

Widths	Item	Dimension
Opening Width - 1000mm		OW
Glass Door	10mm Glass	650
Glass Side Panels (100mm min)		OW-667
Channel	H/970	OW-660
Water Bar (clearance for End Caps)	H/970	659

Option C - Shower between Walls - Widths

Widths	Item	Dimension
Opening Width - 1000mm		OW
Glass Door	10mm Glass	650
Glass Side Panels (100mm min)		OW-665
Channel	H/970	OW-658
Water Bar (clearance for End Caps)	H/970	657



JURALCO

www.juralco.co.nz ph (09) 478 8018

Juralco Frameless Shower Systems

Issue 6- 24 v1

Page 14

Juralco Frameless Shower Systems - Cutting

Door and 90deg Return
Cutting. **Glass 10mm**

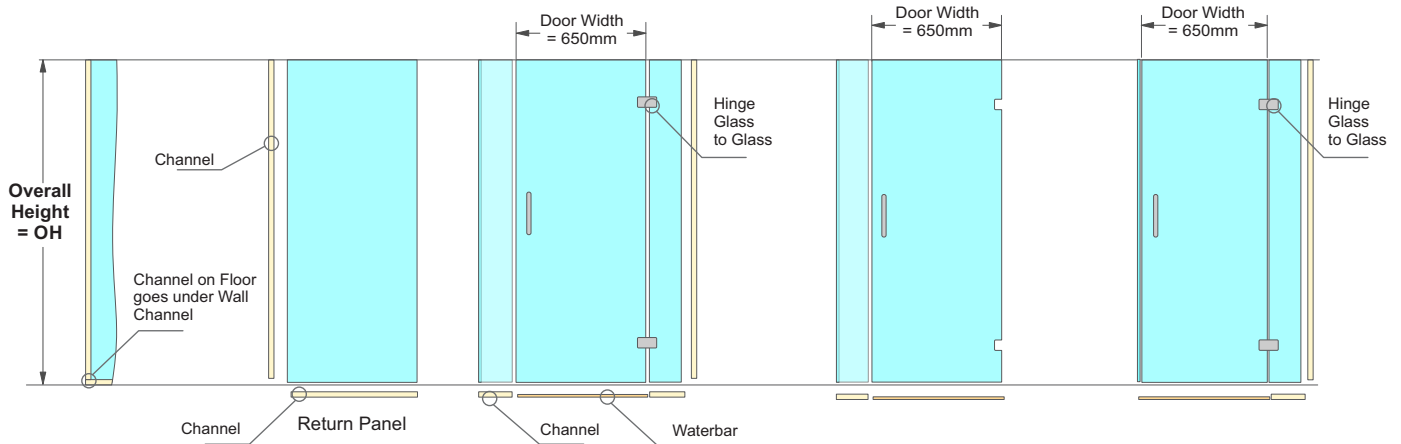
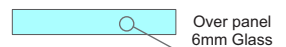
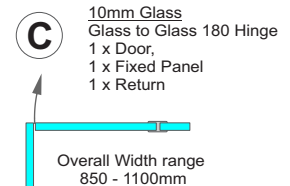
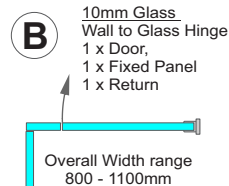
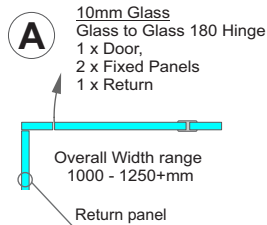
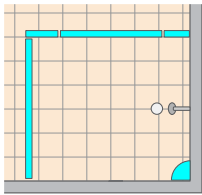

Note 1 - All these width cutting formula assume Door width = 650mm

Shower with 90deg Return - Heights

Heights	Item	Dimension
Overall Height		OH
Glass Door (No Waterbar)	10mm Glass	OH-5
Glass Door (with Waterbar)		OH-10
Glass Side Panel		OH-7
Glass Return Panel		OH-7
Channel	H/970	OH-18

All Options - Return Panel - Widths

Widths	Item	Dimension
Return Width		RW
Glass Return Panel (A&B options)	10mm Glass	RW-16
Channel, miter corner (A&B options)	H/970	RW+7
Glass return Panel (C option)	10mm Glass	RW-7
Channel, sq end (C option)	H/970	RW

Option A - Shower 90deg return - Widths

Widths	Item	Dimension
Opening Width - 1000mm		OW
Glass Door	10mm Glass	650
Glass Side Panels (100mm min)		(OW-670)/2
Channel, Side Panel A, sq ends	H/970	(OW-670)/2+7
Channel, Side Panel B, 1 x miter end	H/970	(OW-656)/2+7
Water Bar	975,978	654
Over Panel. Width x Depth	6mm	(OW-5) x 150

Option B - Shower 90deg return - Widths

Widths	Item	Dimension
Opening Width - 1000mm		OW
Glass Door	10mm Glass	650
Glass Side Panel (100mm min)		OW-660
Channel, Side Panel B, 1 x miter end	H/970	OW-653
Water Bar	975,978	659
Over Panel. Width x Depth	6mm	(OW-5) x 150

Option C - Shower 90deg return - Widths

Widths	Item	Dimension
Opening Width - 1000mm		OW
Glass Door	10mm Glass	650
Glass Side Panel (100mm min)		OW-670
Channel, Side Panel B, 1 x miter end	H/970	OW-663
Water Bar	975,978	655
Over Panel. Width x Depth	6mm	(OW-5) x 150



JURALCO

www.juralco.co.nz ph (09) 478 8018

Juralco Frameless Shower Systems

Issue 6- 24 v1

Page 15

Juralco Frameless Shower Systems - Cutting

Door and 45deg Returns
Cutting. **Glass 10mm**

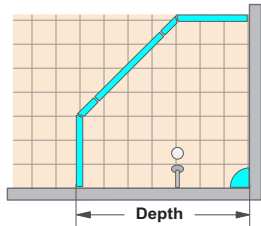

**Table showing Theoretical
Return Width = RW**

Depth	Door + Sidelights = OW				
	800	900	1000	1100	1200
800	234	164	NA	NA	NA
900	334	264	193	NA	NA
1000	434	364	293	222	152
1100	534	464	393	322	252
1200	634	564	493	422	352
1300	734	664	593	522	452
1400	834	764	693	622	552

A 10mm Glass
Glass to Glass 180 Hinge
1 x Door, 2 x Fixed Panels
2 x Returns
1 x Overpanel

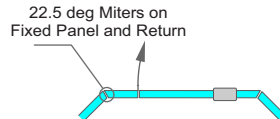

Overall Width range
1000 - 1250+mm

B 10mm Glass
Wall to Glass 135 Hinge
1 x Door, 1 x Fixed Panel
2 x Returns
1 x Overpanel

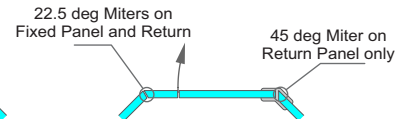

Overall Width range
800 - 1100mm

Over panel
6mm Glass

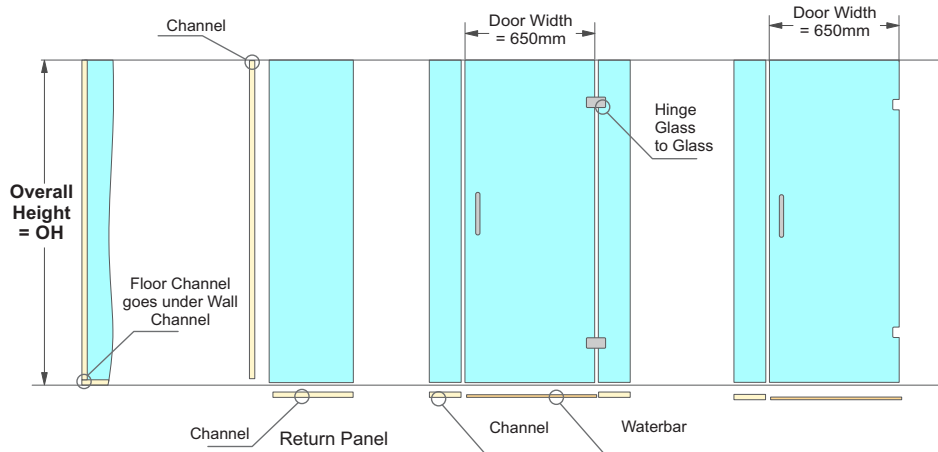

Note 1 - All these width cutting formula assume Door width = 650mm

Shower with 2 x 45deg Returns - Heights

Heights	Item	Dimension
Overall Height		OH
Glass Door (No Waterbar)	10mm Glass	OH-5
Glass Door (Waterbar)		OH-10
Glass Side Panel		OH-7
Glass Return Panel		OH-7
Channel Side and Return Panels	H/970	OH-18

Option B - Shower 2 x 45deg Returns - Widths

Widths	Item	Dimension
Opening Width - 1000mm		OW
Glass Door	10mm Glass	650
Glass Side Panels (100mm min)		OW-667
Channels, Side Panels, (1 x miter end)	H/970	OW-664
Water Bar (clearance for End caps)	975,978	654
Over Panel Lozenge Width x Depth	6mm	(OW+300) x 150
Return Widths	975,978	RW
Glass Return Panels	10mm	RW-8
Channel, Return A (1 x Miter end)	3877	RW+3
Channel, Return B (1 x Miter end)	3877	RW+7

Option A - Shower 2 x 45deg Returns - Widths

Widths	Item	Dimension
Opening Width - 1000mm		OW
Glass Door	10mm Glass	650
Glass Side Panels (100mm min)		(OW-658)/2
Channels, Side Panels, (1 x miter end)	H/970	(OW-658)/2+3
Water Bar (clearance for End caps)	975,978	654
Over Panel Lozenge Width x Depth	6mm	(OW+300) x 150
Return Widths	975,978	RW
Glass Return Panels	10mm	RW-8
Channel, Return (1 x Miter end)	3877	RW+3



JURALCO

www.juralco.co.nz ph (09) 478 8018

Juralco Frameless Shower Systems

Issue 6- 24 v1

Page 16

Juralco Frameless Shower Systems - Over Panels

Over Panels

- All Over panels, 6mm or 10mm Toughened Glass, polish all edges
- All 150mm deep
- See Components page for a variety of Over Panel and Glass Shelf brackets

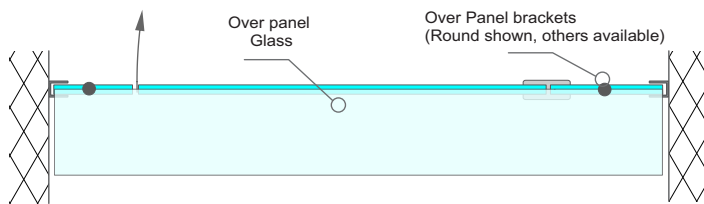

- 1 x Door, 2 x Side Panels to Walls
- Between Walls mount

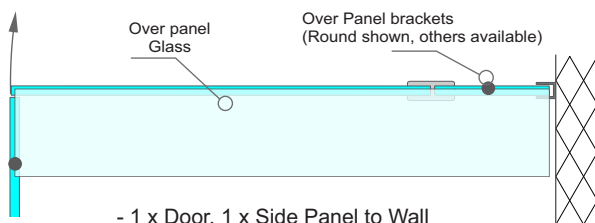

- 1 x Door, 1 x Side Panel to Wall
- 1 x 90 deg Return

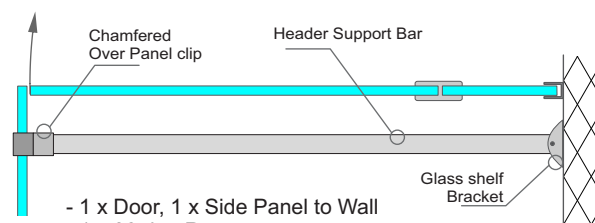

- 1 x Door, 1 x Side Panel to Wall
- 1 x 90 deg Return

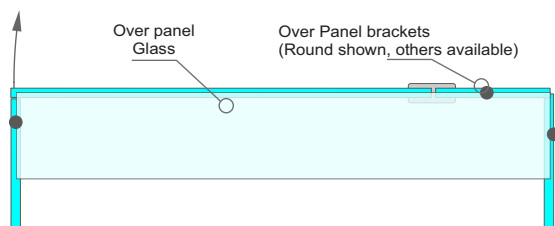

- 1 x Door, 1 x Side Panel to Glass
- +1 x Fixed Panel- 1 x 90 deg Return

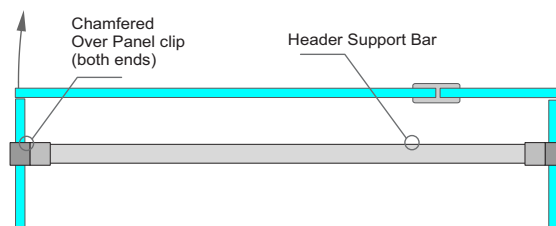

- 1 x Door, 1 x Side Panel to Glass
- +1 x Fixed Panel- 1 x 90 deg Return

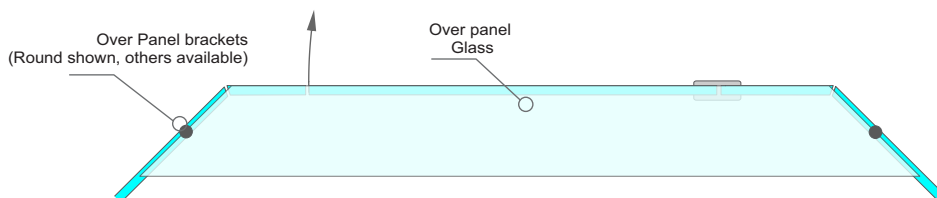

- 1 x Door, 2 x Sidelights
- 2 x 45 deg Returns

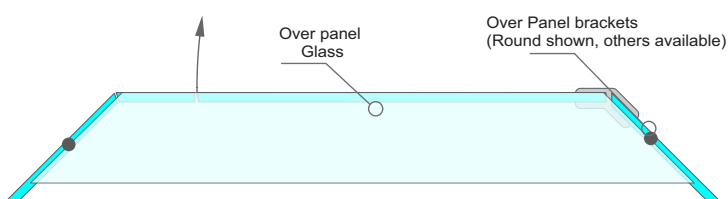

- 1 x Door, 1 x Side Panels
- 2 x 45 deg Returns
- Hinge 135

Juralco Frameless Shower Systems - Bath Screens - Measuring, Typical Sections

Measuring

- Measure twice, cut once!
- Bath screens 10mm toughened Glass
- For doors hinged directly from the wall adequate stud fixings are required. Either a double stud or a 90mm width of timber fitted between nogs at hinge level is required.
- Where inadequate wall fixing is suspected it is recommended the door be hinged from a glass side panel.
- If a Sidelight panel to wall is used, a Top Support bracket will be necessary.
- Measure and take note of all out of square situations. If necessary take a pattern of shape and mark all straight lines on pattern.
- Bath Screen Height normally 1500mm

Typical Sections, Height Allowance

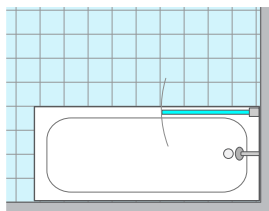

Bath Screen
Wall hung Door

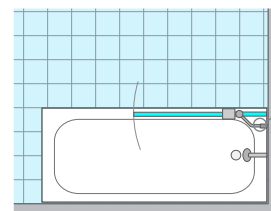

Bath Screen
Glass hung Door

Support bracket
for Fixed Panel

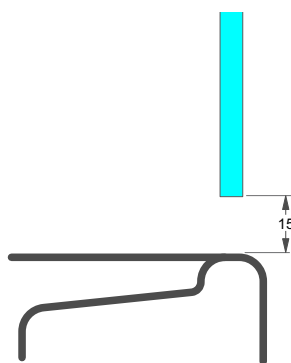

Bath Screen Door
to Bath Clearance

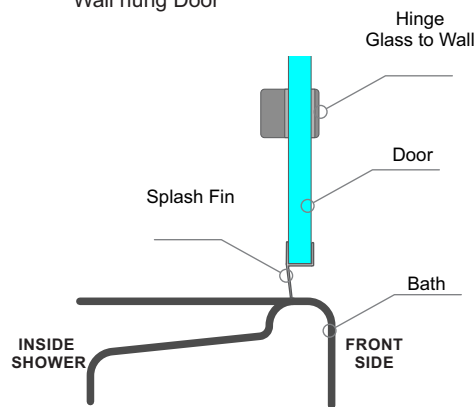

Bath Screen
Wall hung Door

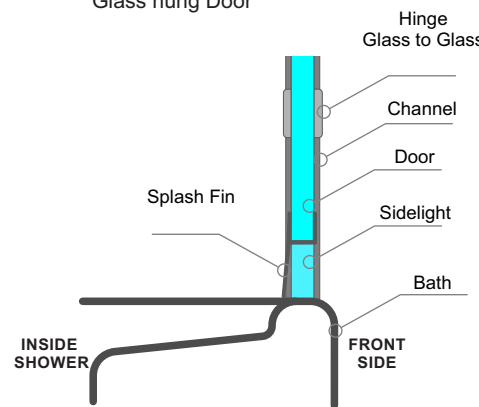

Bath Screen
Glass hung Door

Hinge
Glass to Wall

Door

Splash Fin

Bath

INSIDE
SHOWER

FRONT
SIDE

Hinge
Glass to Glass

Channel

Door

Splash Fin

Sidelight

Bath

INSIDE
SHOWER

FRONT
SIDE

Juralco Frameless Shower Systems - Installation

Installation

Note: Prior to delivering to site, unpack and check all items

Note - Check all Glass is marked with Toughened Safety Glass Stamp

Installation

Glass to Glass Hinge Types.

- 1 - Inspect Glass and extrusions for damage. Assemble all necessary components. Ensure site is clean.
- 2 - Attach Channel H/970, (10mm Glass) to desired setout, Walls and Floor, ensuring a continuous bead of Bostik V-60 between channels and wall / floor.
- 3 - Attach waterbar to floor if allowed for
- 4 - Insert the appropriate Glass Panel. Plumb all square. Remove for silicone.
- 5 - Starting at the wall lay a full bead of Bostik V-60 into the inside face of the channels, then reinstall the glass.
- 6 - Glaze to outside with Wedge No 31 for 10mm glass.
- 7 - Clean off excess Bostik. Apply end caps to exposed channel ends.
- 8 - After installing leave for at least 7 days to develop full strength.
- 9 - Install Over panel if needed
- 10 - Install Door and Hinges, adjust to correct clearances.
- 11 - Attach Splash fin if needed.
- 12 - Clean all fingermarks, leave site clean and tidy.

Glass to Wall Hinge Type,

- 1 - Mark off Hinge positions on wall. Must be into solid timber.
- 2 - Screw hinges to wall.
- 3 - Mount Door, splash fin.
- 4 - Check operation.
- 5 - Clean all fingermarks, leave site clean and tidy

BostikV-60

Note - This supplied Architectural, structural grade Silicone must be used for Frameless Showers. Do not use normal retail clear Silicone

General

- Bostik V-60 is a one component, non-flowing, neutral cure, High modulus silicone sealant. It cures by absorption of atmospheric moisture to form a flexible and durable elastomeric sealant.
- Special Features Bostik V-60 is a premium grade neutral cure glazing silicone sealant. It has superior adhesion to painted and anodised aluminium, as well as glass.
- The thixotropic nature of this product ensures that it will not slump in typical construction joints

Conditions

- Always ensure that the surfaces to be sealed are dry and free from oil, dirt and grease.
- Use the two-wipe process for impervious substrates. Ensure the cloths are clean and changed frequently, and use a suitable solvent such as IPA or White Spirits.
- When extruding the sealant cut the nozzle to the desired width, cut the tip off the cartridge, and apply the sealant firmly to ensure good contact between the sealant and the substrate.
- Before the sealant has skinned, tool it off to ensure a good finish, and/or remove Masking Tape. Tooling off will improve the wetting out of the sealant to the substrate. Clean / wipe of excess sealant with clean cloth or polyethylene scraper.
- Bostik V-60 cures by absorbing atmospheric moisture, it will skin over in 8 minutes and cure to a depth of 9mm in 7 days.

Properties

- Skin Time 8 Minutes BS 5889
- Tack Free Time 45 Minutes ASTM C
- Tooling Time 8 Minutes ASTM C
- Sag or Slump Nil BS5889



FRAMELESS SHOWER - GLASS ORDER SHEETS

HINGED DOOR GLASS ORDER SHEETS

Page No.	Panel Description
21	Hinged Door - for Vertical Handle
22	Hinged Door - for Horizontal handle
23	Hinged Door - for Pull knob set
24	Plain Return or Sidelight Panel
25	Right Sidelight - with polished back mitre
26	Left Sidelight - with polished back mitre
27	Right Sidelight Hinge Panel - with polished back mitre
28	Left Sidelight Hinge Panel - with polished back mitre
29	Sidelight Panel - with two polished back mitres
30	Hinge Panel
31	Right Return Hinge Panel - with polished back mitre
32	Left Return Hinge Panel - with polished back mitre
33	Plain Notched Return Panel
34	Plain Notched Return Hinge Panel
35	Right Notched Return Hinge Panel - with polished back mitre
36	Left Notched Return Hinge Panel - with polished back mitre
37	Screen Panel - with radius corner
38	Screen Panel - with raking back corner
39	Head Brace
40	Blank Special Panel Sheet

FRAMELESS HINGED SHOWER - GLASS ORDER SHEETS

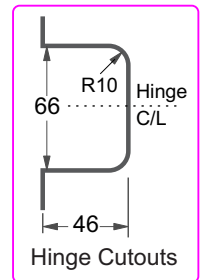
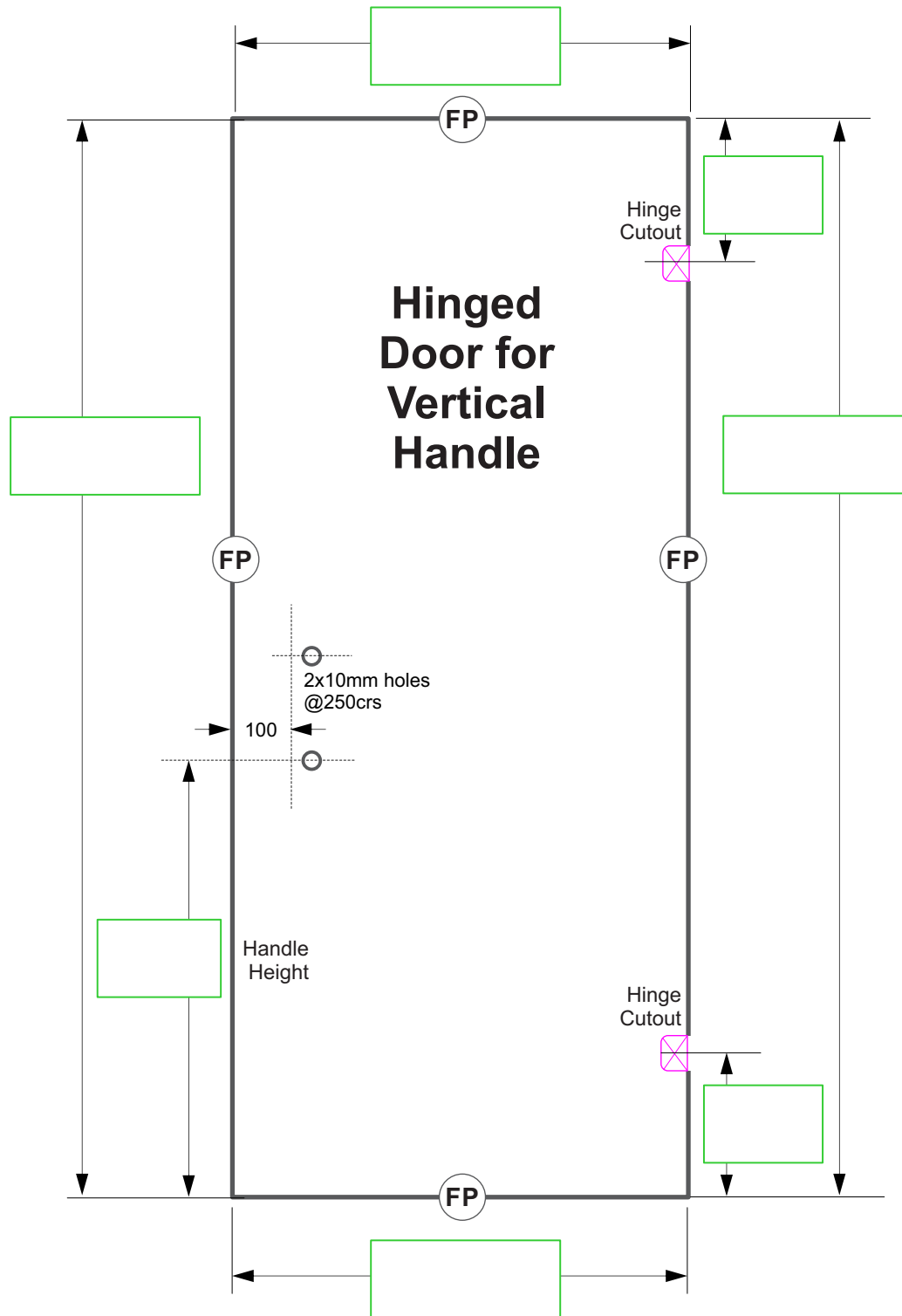

Enter No of Panels

All for 10mm Toughened Glass	All dimensions mm	Flat Polish Edges (FP)	Rough Arris Edges (RA)	Toughened Stamp (T)	No Sharp Corners
------------------------------	-------------------	------------------------	------------------------	---------------------	------------------

ORDER FROM:

.....

ORDER NO:

.....

DELIVER TO:

.....

DATE:

.....

FRAMELESS HINGED SHOWER - GLASS ORDER SHEETS

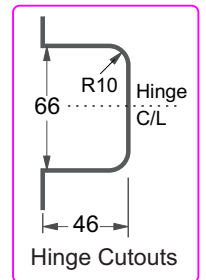
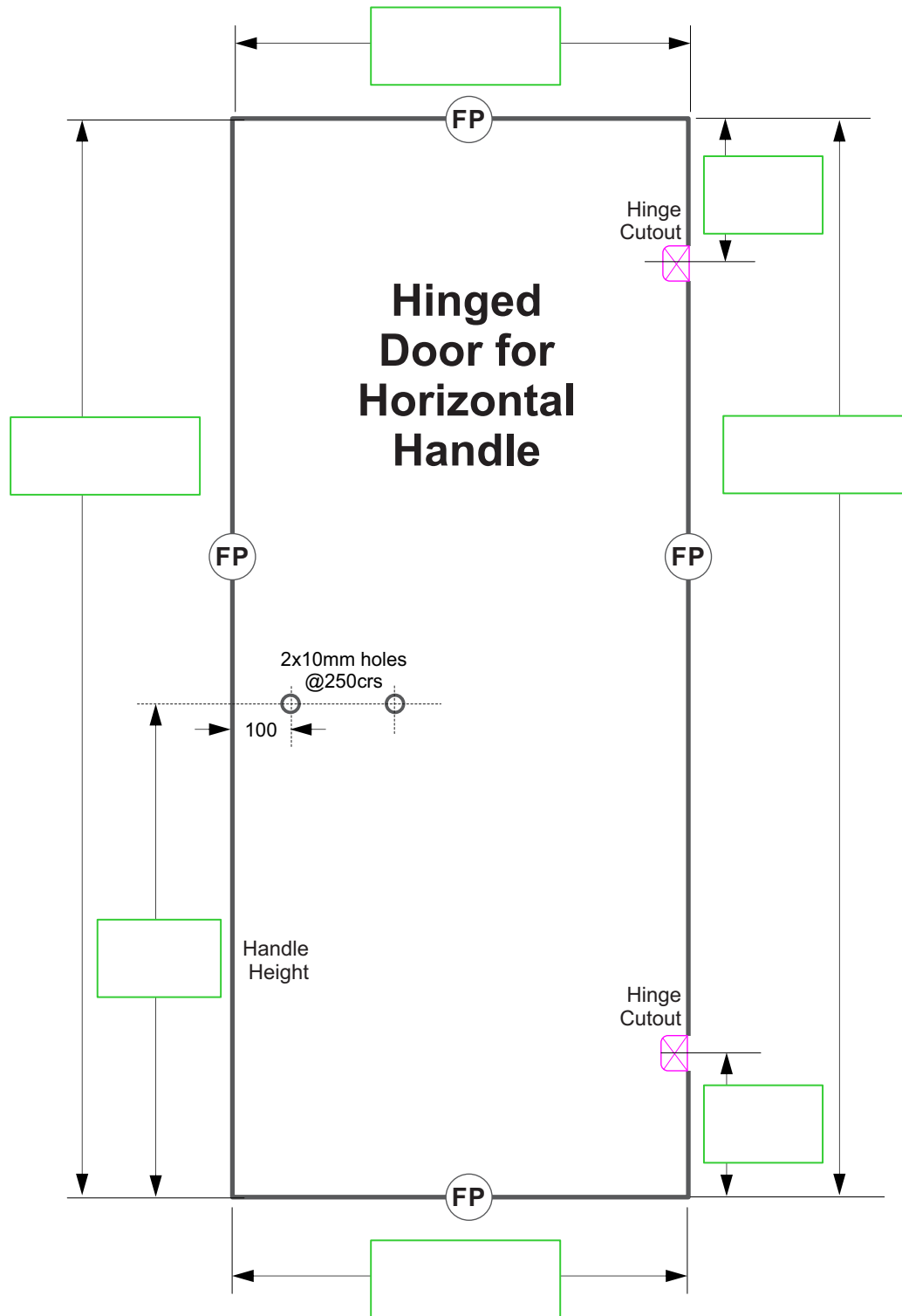

Enter No of Panels

All for 10mm Toughened Glass	All dimensions mm	Flat Polish Edges (FP)	Rough Arris Edges (RA)	Toughened Stamp (T)	No Sharp Corners
------------------------------	-------------------	------------------------	------------------------	---------------------	------------------

ORDER FROM:

.....

ORDER NO:

.....

DELIVER TO:

.....

DATE:

.....

FRAMELESS HINGED SHOWER - GLASS ORDER SHEETS

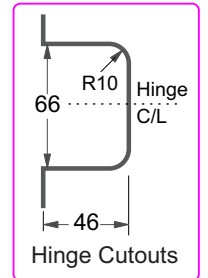
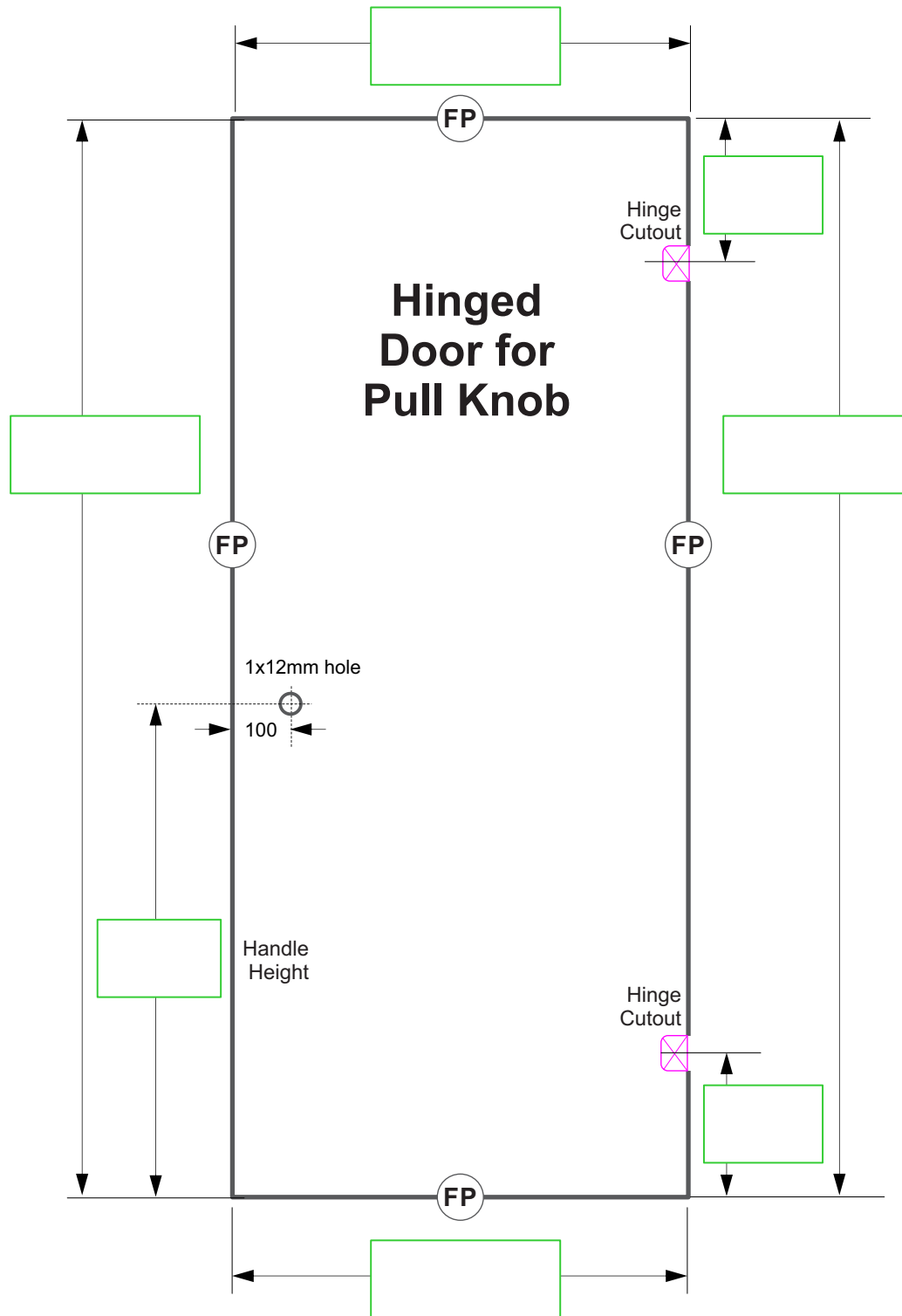

Enter No of Panels

All for 10mm Toughened Glass	All dimensions mm	Flat Polish Edges (FP)	Rough Arris Edges (RA)	Toughened Stamp (T)	No Sharp Corners
------------------------------	-------------------	------------------------	------------------------	---------------------	------------------

ORDER FROM:

.....

ORDER NO:

.....

DELIVER TO:

.....

DATE:

.....

FRAMELESS HINGED SHOWER - GLASS ORDER SHEETS

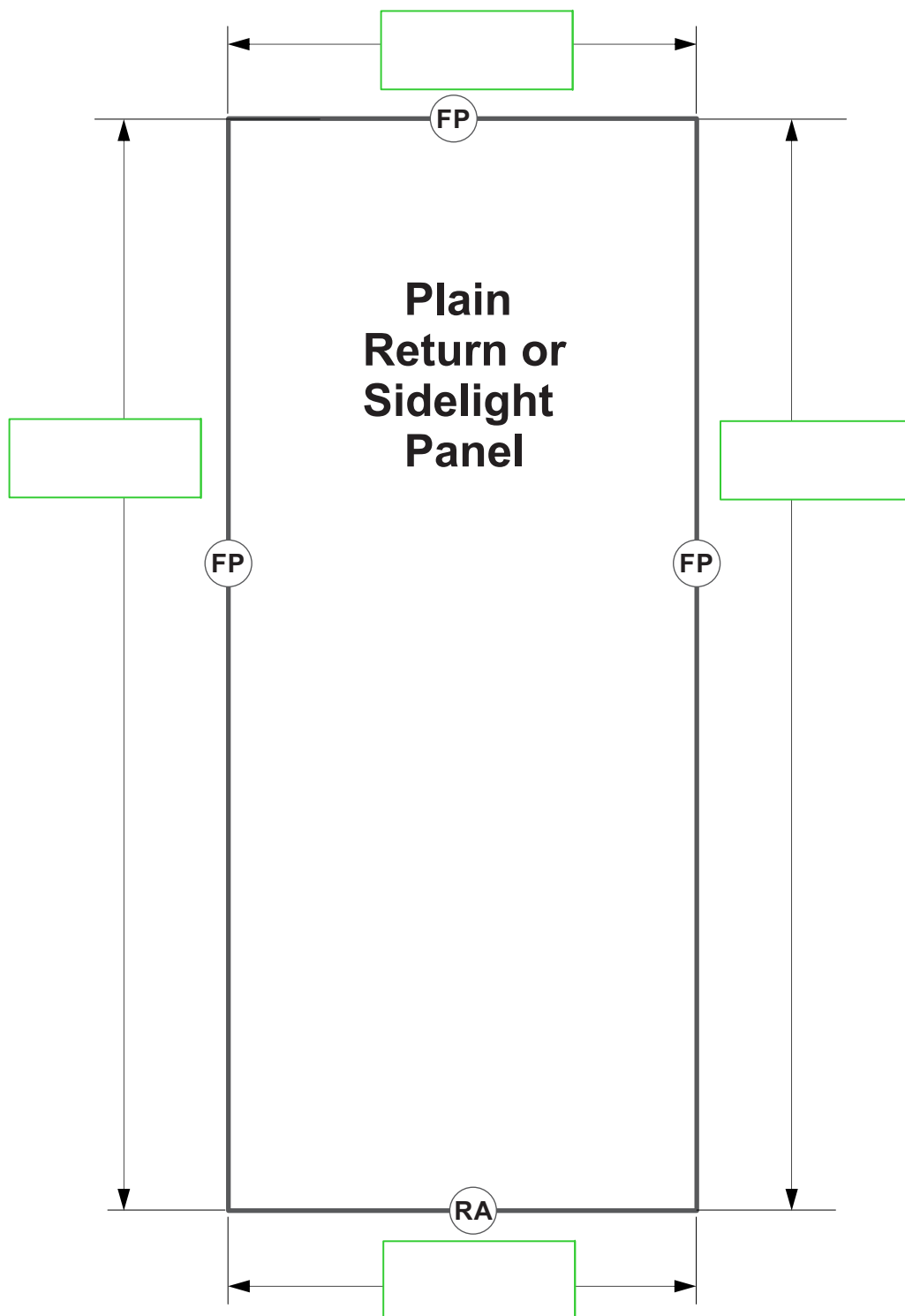

Enter No of Panels

All for 10mm Toughened Glass | All dimensions mm | Flat Polish Edges (FP) | Rough Arris Edges (RA) | Toughened Stamp (T) | No Sharp Corners

ORDER FROM:

.....

ORDER NO:

.....

DELIVER TO:

.....

DATE:

.....

FRAMELESS HINGED SHOWER - GLASS ORDER SHEETS

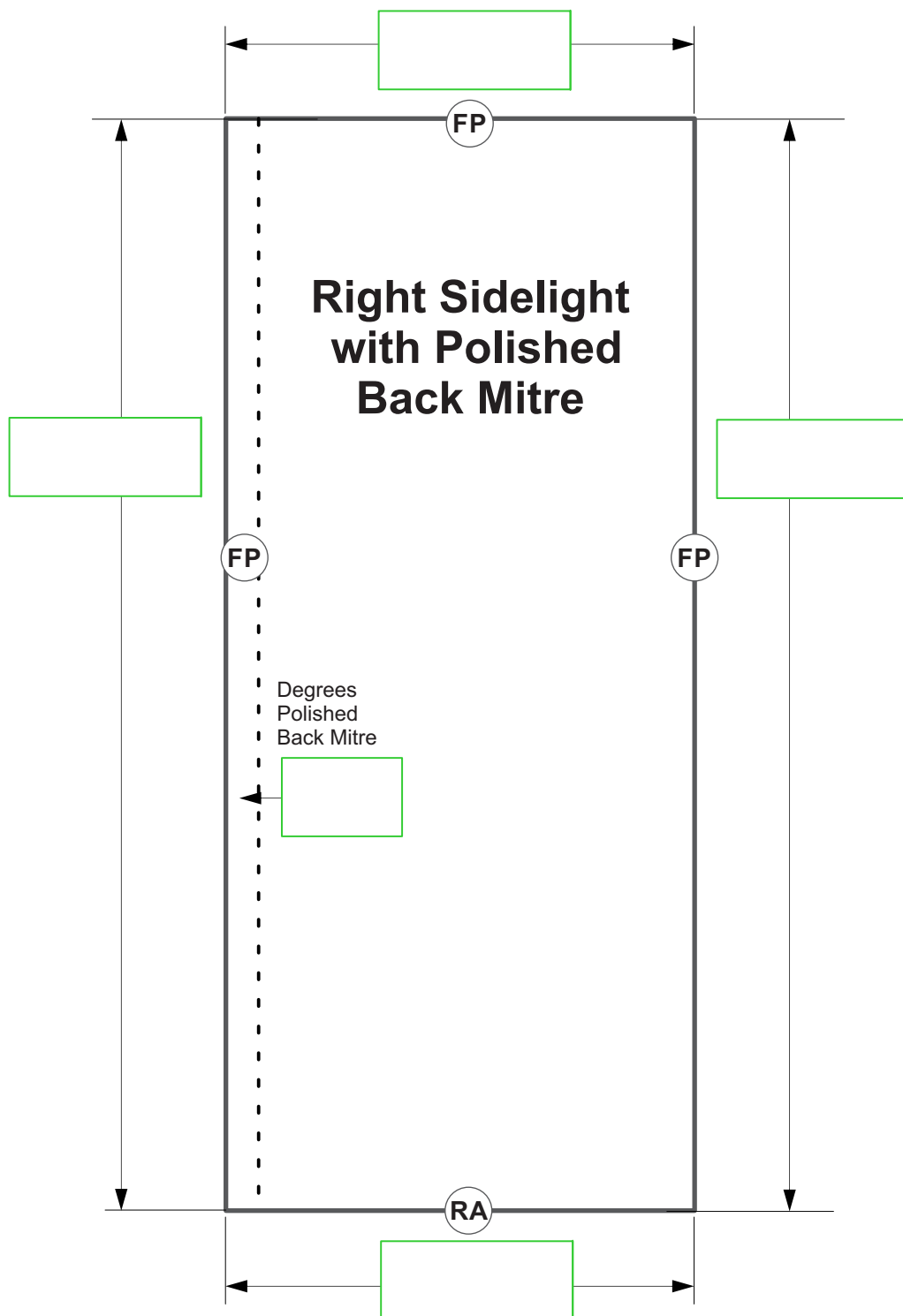

Enter No of Panels

All for 10mm Toughened Glass | All dimensions mm | Flat Polish Edges (FP) | Rough Arris Edges (RA) | Toughened Stamp (T) | No Sharp Corners

ORDER FROM:

.....

ORDER NO:

.....

DELIVER TO:

.....

DATE:

.....

FRAMELESS HINGED SHOWER - GLASS ORDER SHEETS

The diagram shows a rectangular glass panel for a frameless hinged shower. It includes dimension lines for width and height, with green boxes for input. Labels include 'Left Sidelight with Polished Back Mitre', 'FP' (Flat Polish Edges) at the top and bottom, 'RA' (Rough Arris Edges) on the right, and 'Degrees Polished Back Mitre' with a green box for input. A pink box on the right says 'Enter No of Panels' with a green box for input.

Left Sidelight with Polished Back Mitre

FP

FP

FP

RA

Degrees Polished Back Mitre

Enter No of Panels

All for 10mm Toughened Glass	All dimensions mm	Flat Polish Edges (FP)	Rough Arris Edges (RA)	Toughened Stamp (T)	No Sharp Corners
------------------------------	-------------------	------------------------	------------------------	---------------------	------------------

ORDER FROM:

.....

ORDER NO:

.....

DELIVER TO:

.....

DATE:

.....

FRAMELESS HINGED SHOWER - GLASS ORDER SHEETS

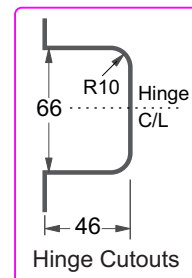
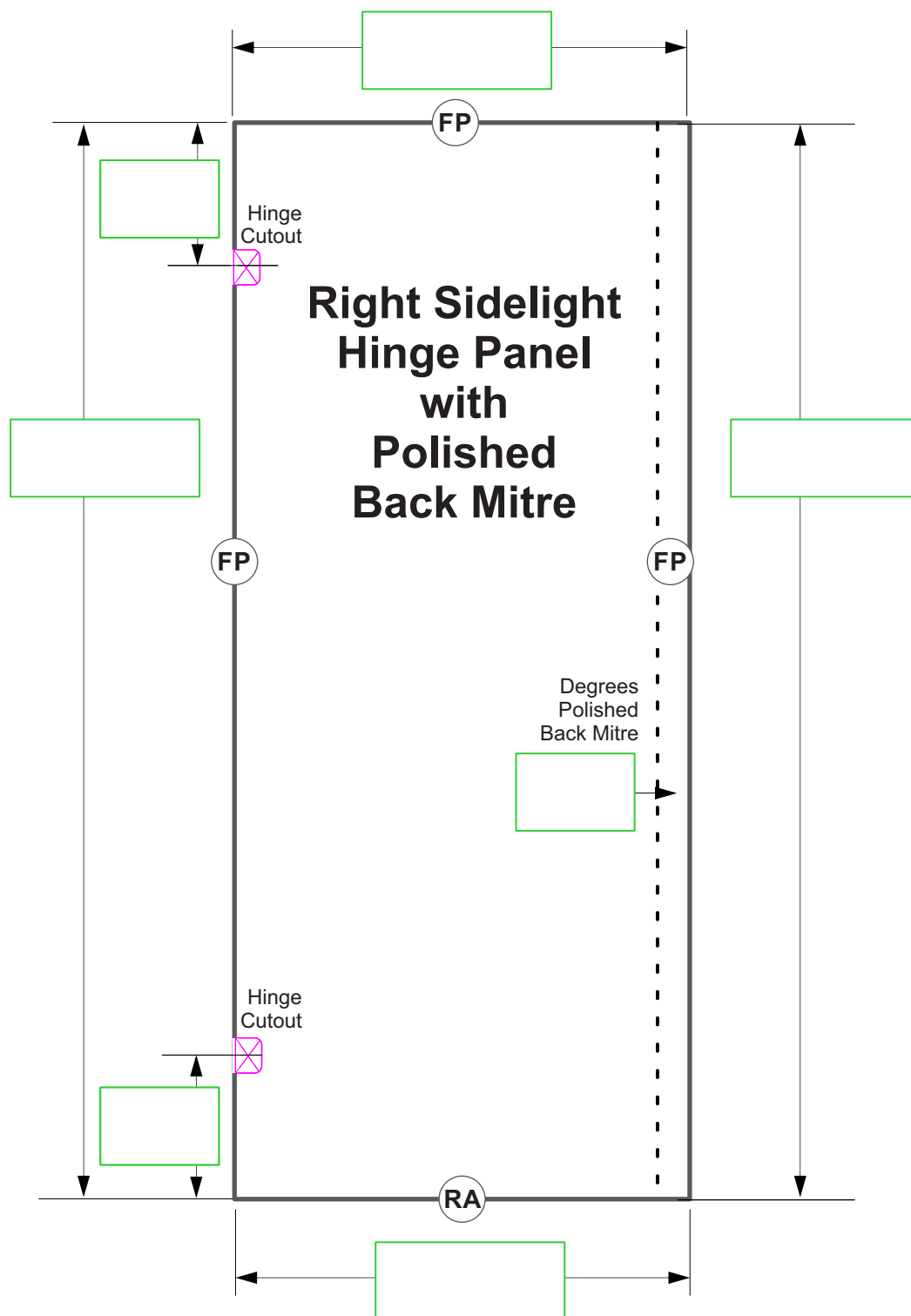

Enter No of Panels

All for 10mm Toughened Glass	All dimensions mm	Flat Polish Edges (FP)	Rough Arris Edges (RA)	Toughened Stamp (T)	No Sharp Corners
------------------------------	-------------------	------------------------	------------------------	---------------------	------------------

ORDER FROM:

.....

ORDER NO:

.....

DELIVER TO:

.....

DATE:

.....

FRAMELESS HINGED SHOWER - GLASS ORDER SHEETS

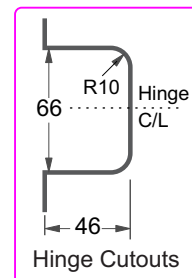
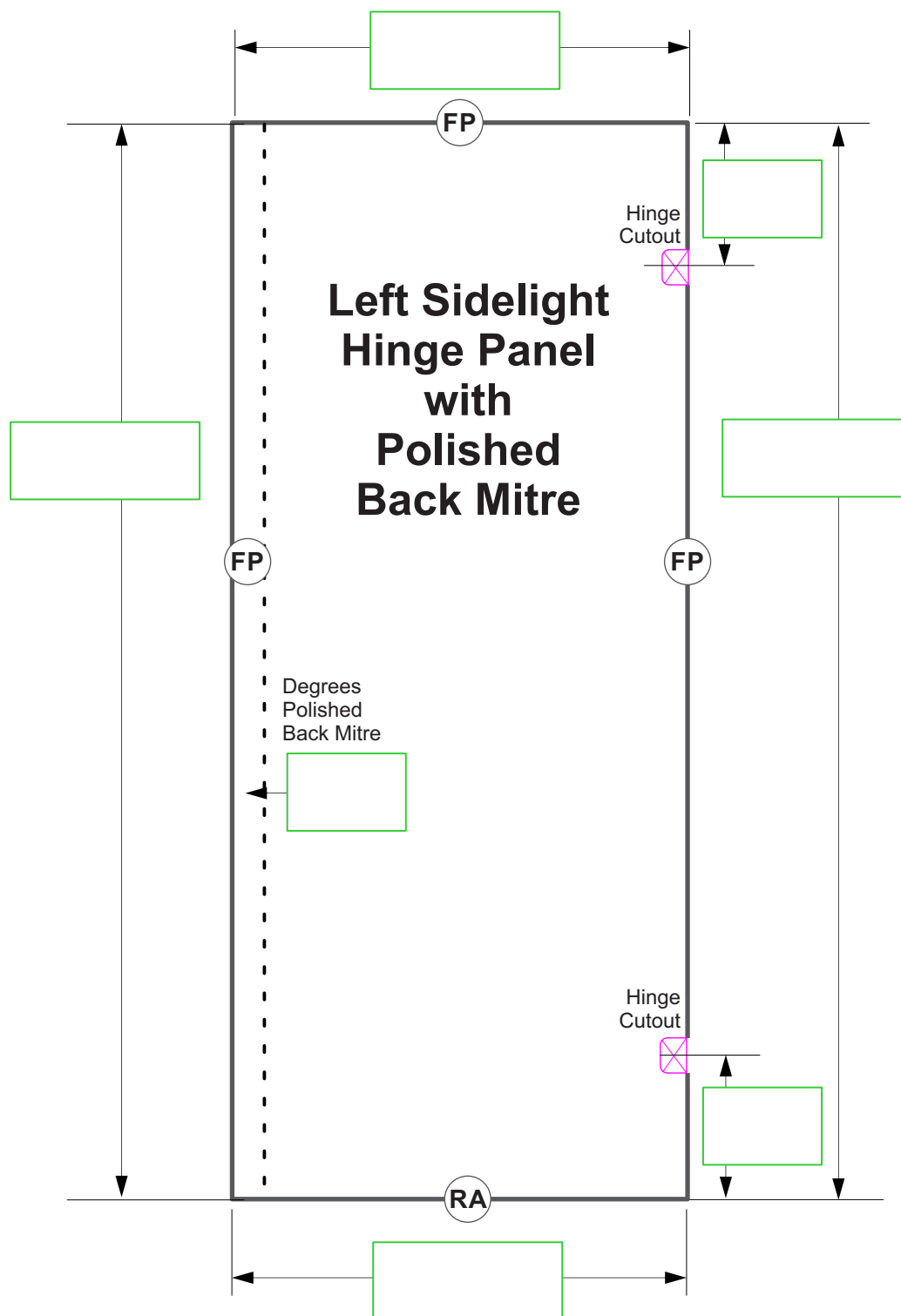

Enter No of Panels

All for 10mm Toughened Glass	All dimensions mm	Flat Polish Edges (FP)	Rough Arris Edges (RA)	Toughened Stamp (T)	No Sharp Corners
------------------------------	-------------------	------------------------	------------------------	---------------------	------------------

ORDER FROM:

.....

ORDER NO:

.....

DELIVER TO:

.....

DATE:

.....

FRAMELESS HINGED SHOWER - GLASS ORDER SHEETS

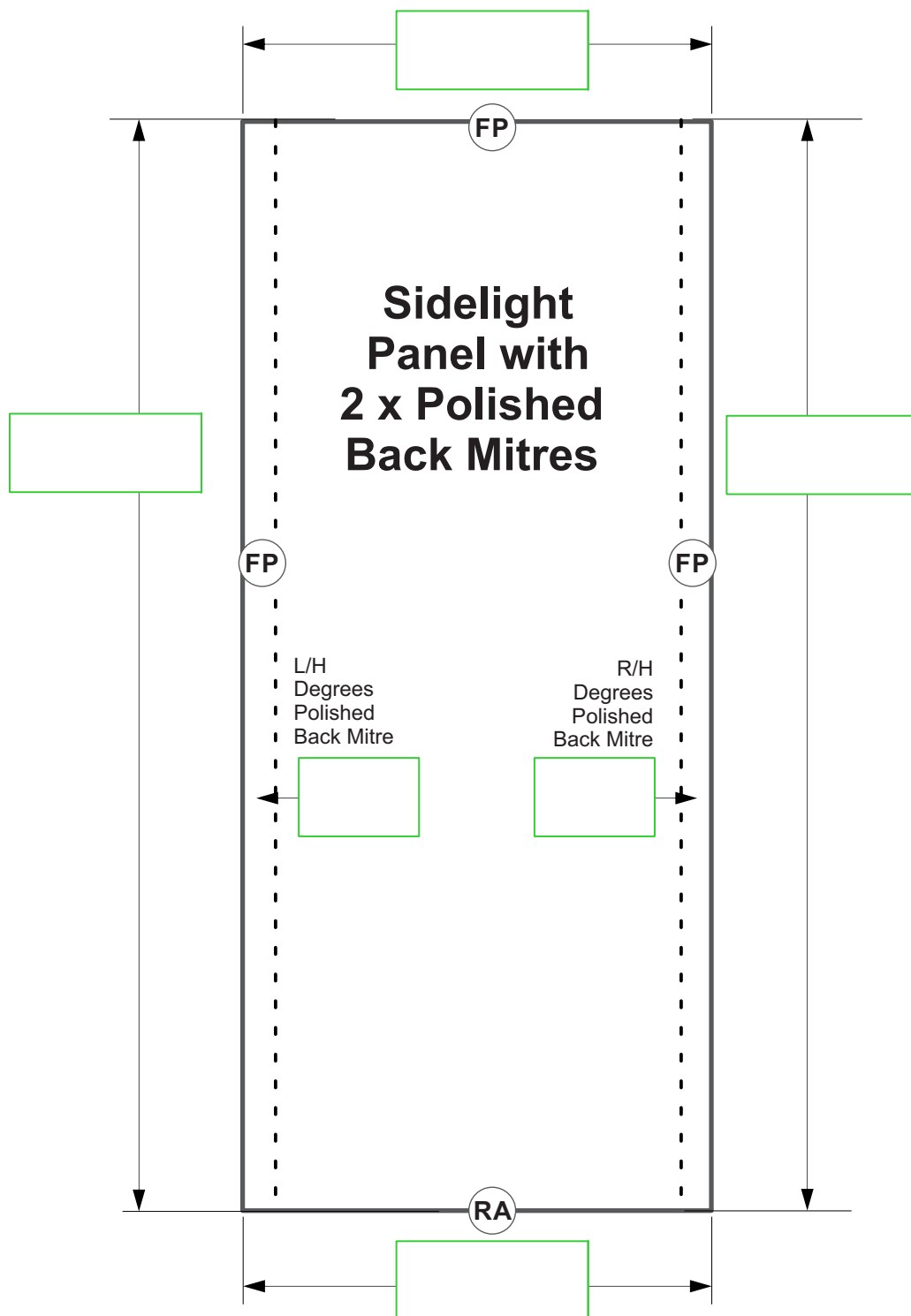

Enter No of Panels

All for 10mm Toughened Glass | All dimensions mm | Flat Polish Edges (FP) | Rough Arris Edges (RA) | Toughened Stamp (T) | No Sharp Corners

ORDER FROM:

.....

ORDER NO:

.....

DELIVER TO:

.....

DATE:

.....

FRAMELESS HINGED SHOWER - GLASS ORDER SHEETS

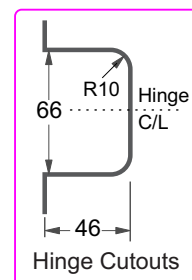
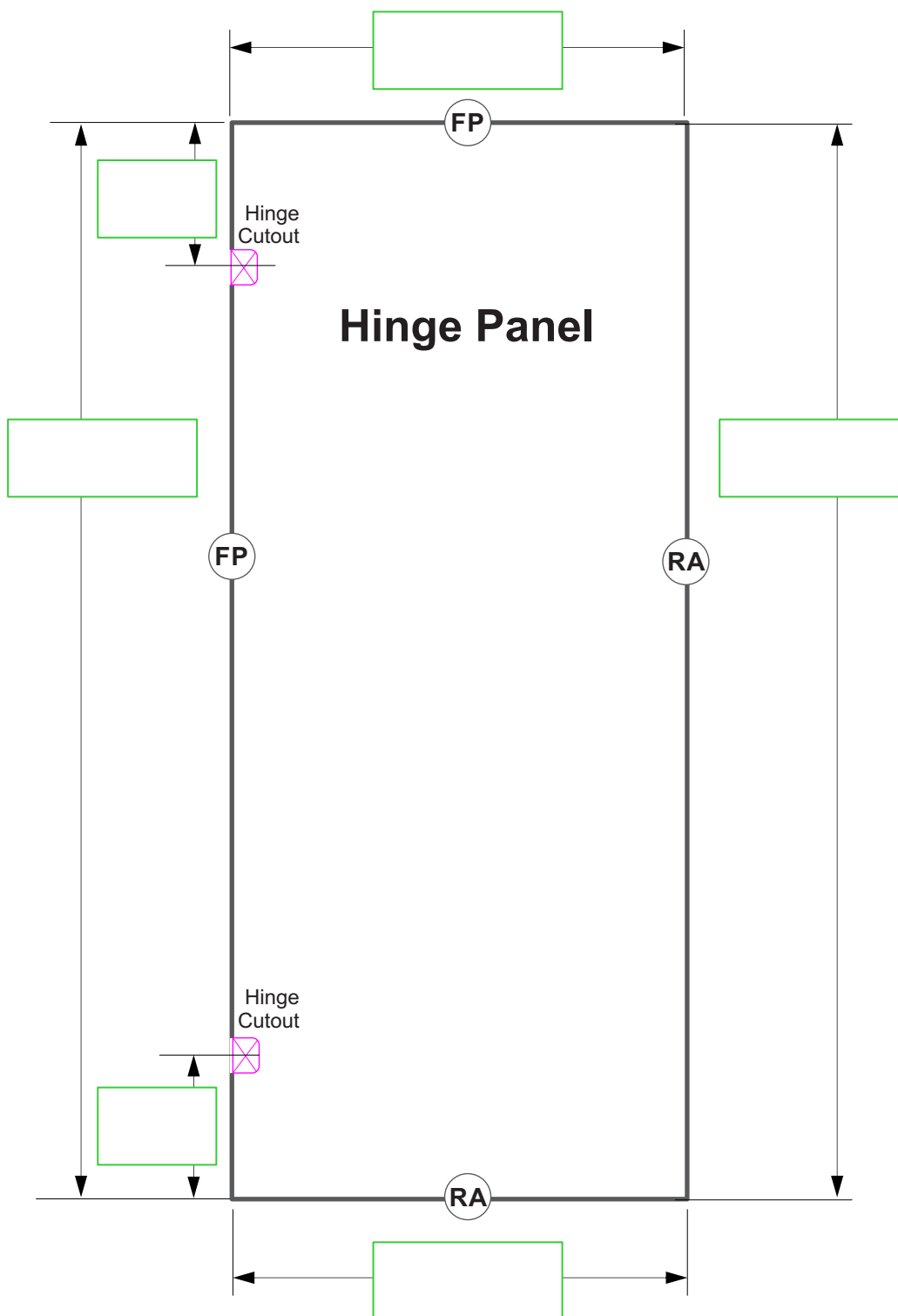

Enter No of Panels

All for 10mm Toughened Glass	All dimensions mm	Flat Polish Edges (FP)	Rough Arris Edges (RA)	Toughened Stamp (T)	No Sharp Corners
------------------------------	-------------------	------------------------	------------------------	---------------------	------------------

ORDER FROM:

.....

ORDER NO:

.....

DELIVER TO:

.....

DATE:

.....

FRAMELESS HINGED SHOWER - GLASS ORDER SHEETS

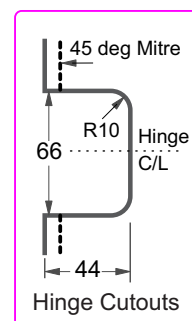
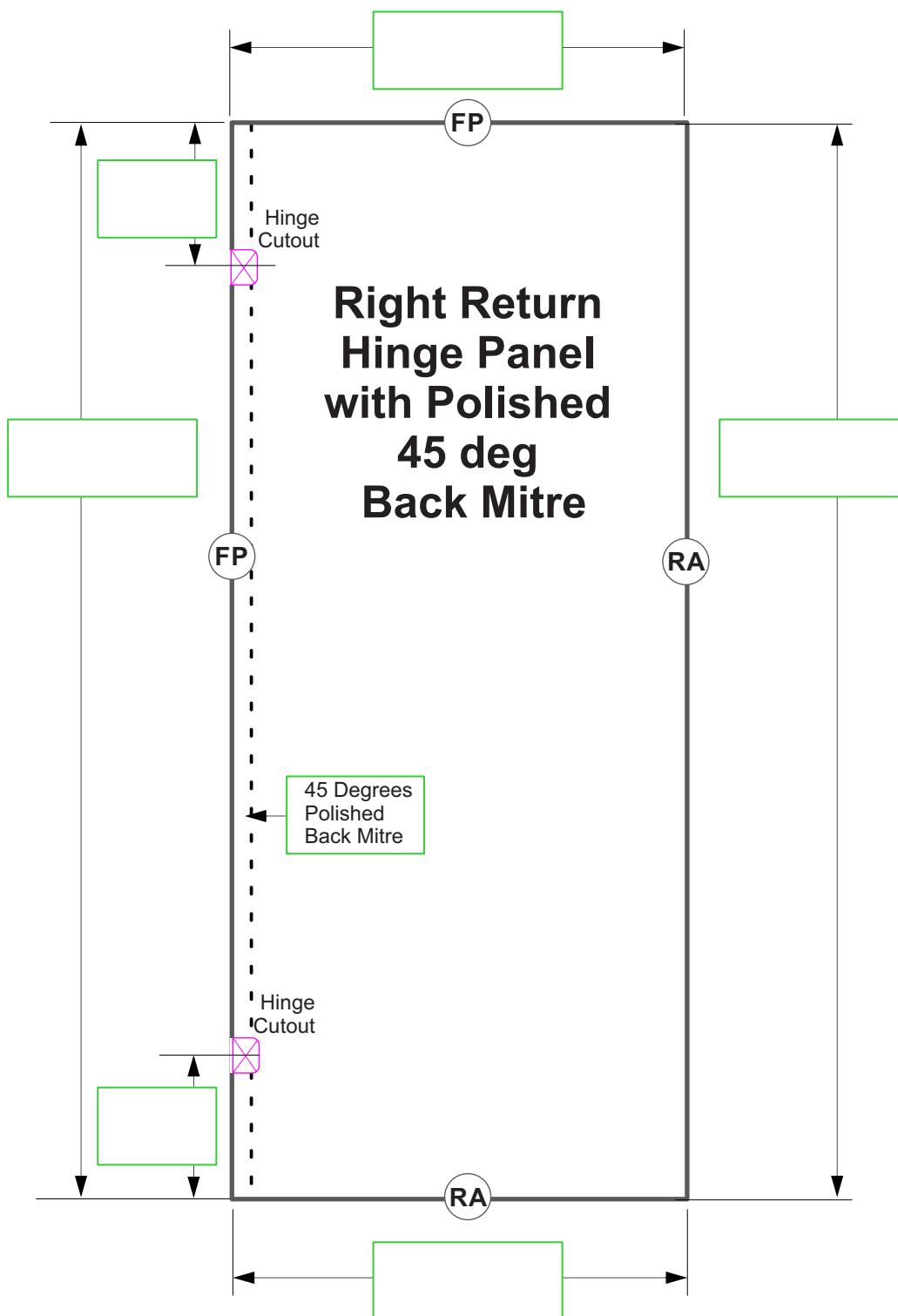

Enter No of Panels

All for 10mm Toughened Glass	All dimensions mm	Flat Polish Edges (FP)	Rough Arris Edges (RA)	Toughened Stamp (T)	No Sharp Corners
------------------------------	-------------------	------------------------	------------------------	---------------------	------------------

ORDER FROM:

.....

ORDER NO:

.....

DELIVER TO:

.....

DATE:

.....

FRAMELESS HINGED SHOWER - GLASS ORDER SHEETS

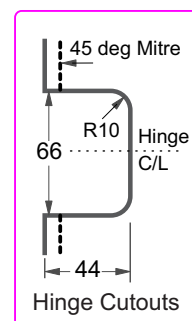
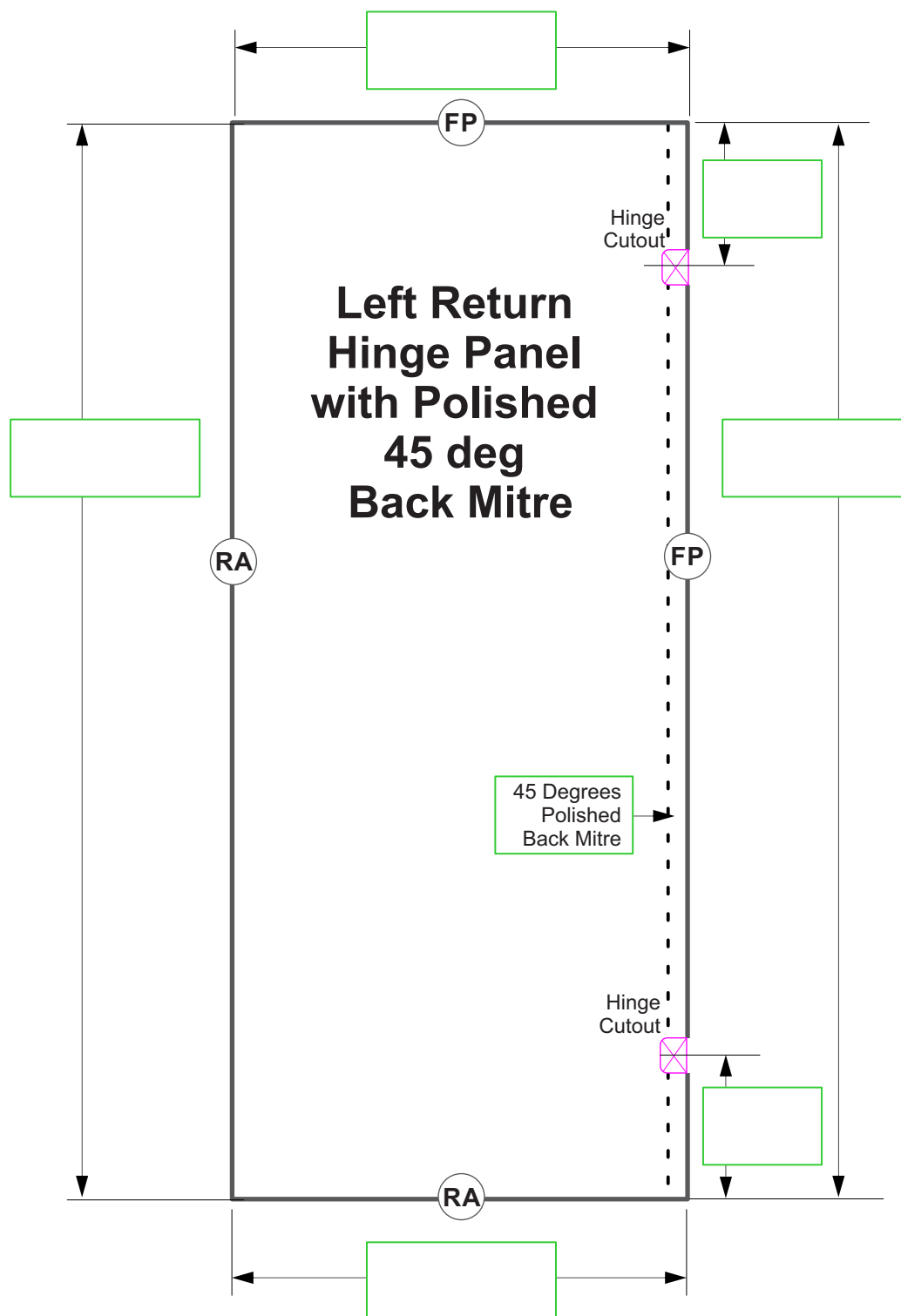

Enter No of Panels

All for 10mm Toughened Glass	All dimensions mm	Flat Polish Edges (FP)	Rough Arris Edges (RA)	Toughened Stamp (T)	No Sharp Corners
------------------------------	-------------------	------------------------	------------------------	---------------------	------------------

ORDER FROM:

.....

ORDER NO:

.....

DELIVER TO:

.....

DATE:

.....

FRAMELESS HINGED SHOWER - GLASS ORDER SHEETS

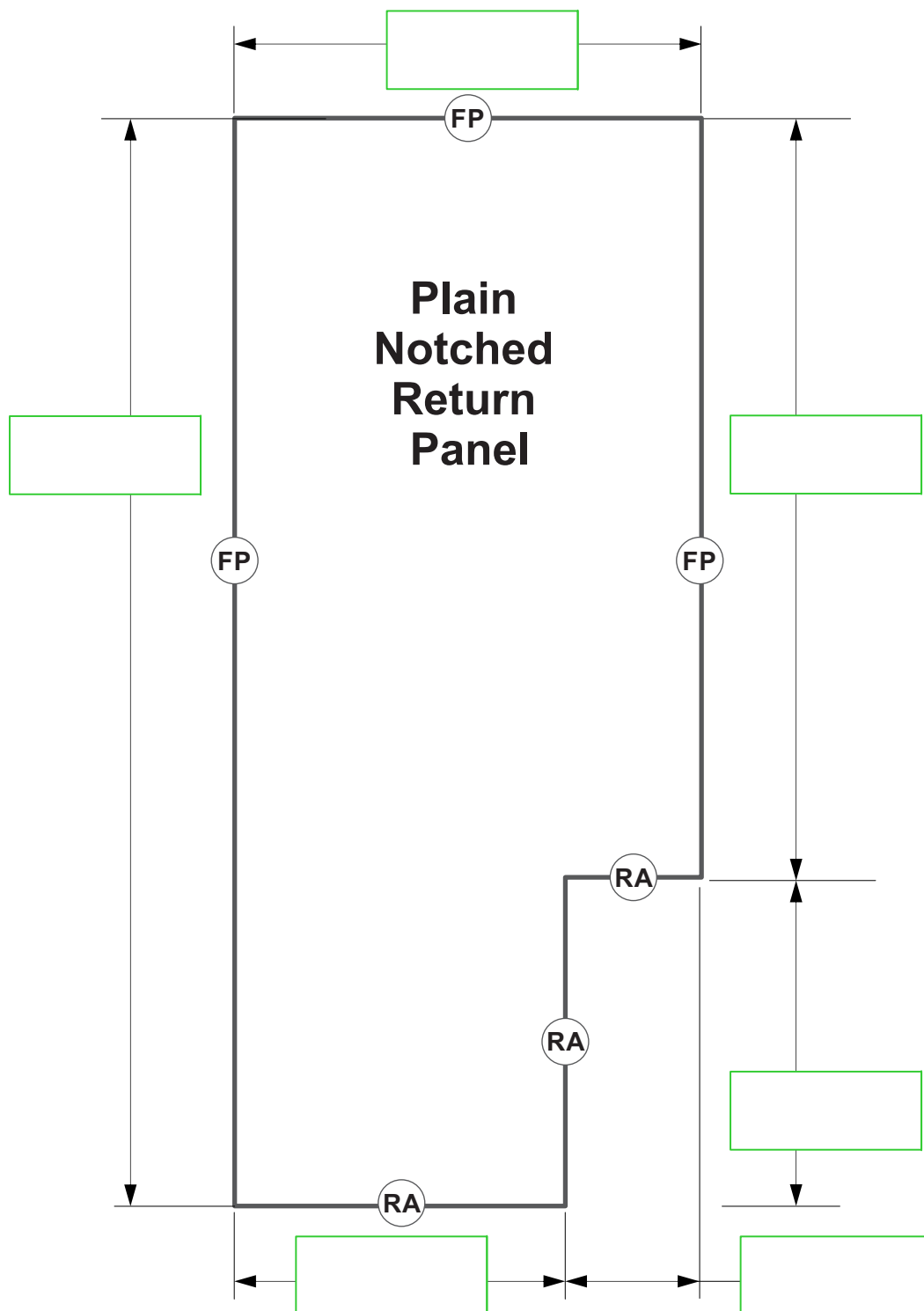

Enter No of
Panels

All for 10mm Toughened Glass | All dimensions mm | Flat Polish Edges (FP) | Rough Arris Edges (RA) | Toughened Stamp (T) | No Sharp Corners

ORDER FROM:

DELIVER TO:

ORDER NO:

DATE:

FRAMELESS HINGED SHOWER - GLASS ORDER SHEETS

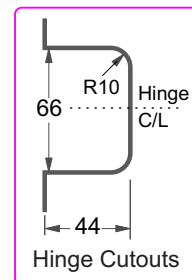
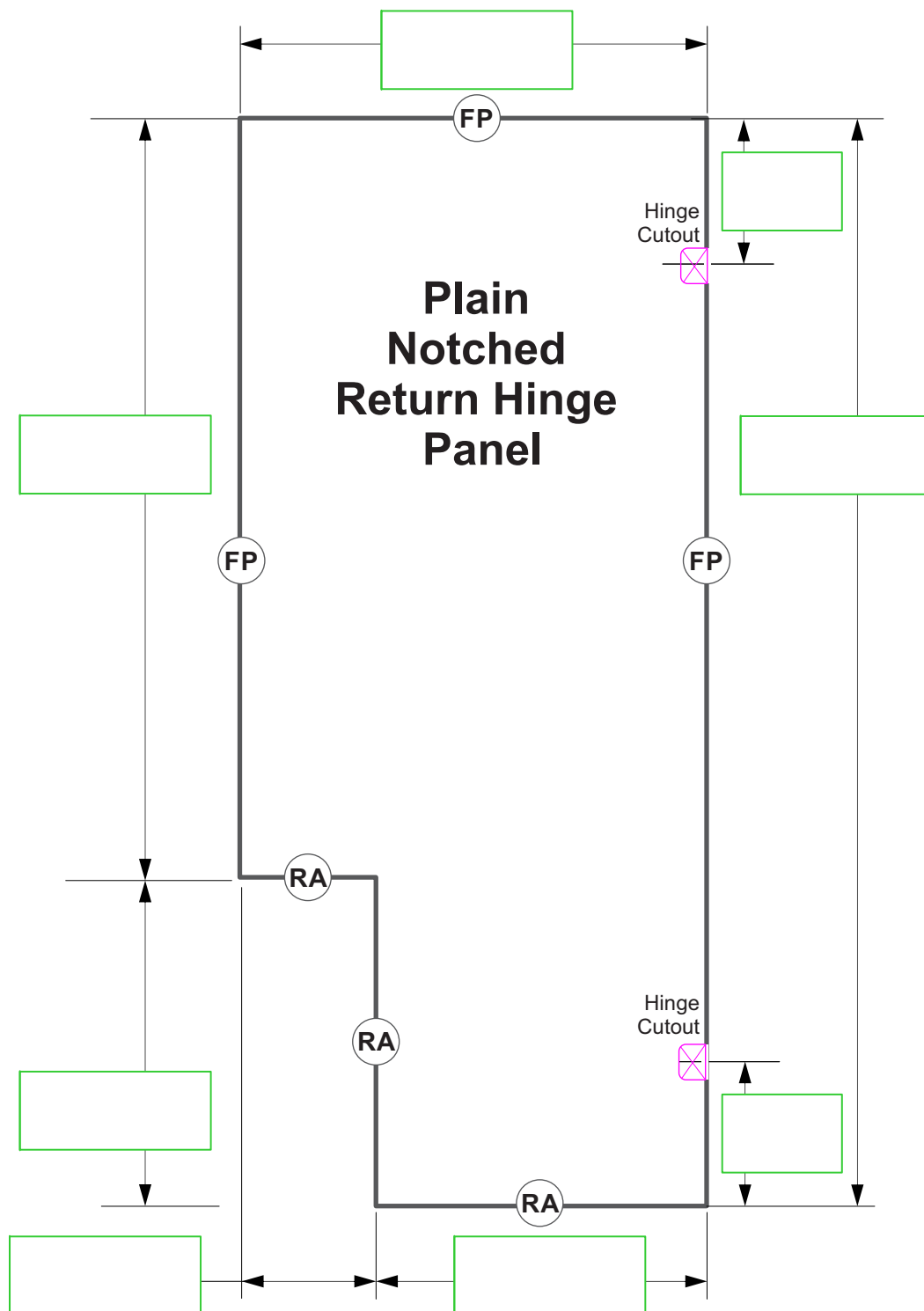

Enter No of Panels

All for 10mm Toughened Glass	All dimensions mm	Flat Polish Edges (FP)	Rough Arris Edges (RA)	Toughened Stamp (T)	No Sharp Corners
------------------------------	-------------------	------------------------	------------------------	---------------------	------------------

ORDER FROM:

.....

ORDER NO:

.....

DELIVER TO:

.....

DATE:

.....

FRAMELESS HINGED SHOWER - GLASS ORDER SHEETS

Right Notched Return Hinge Panel with Polished 45 deg Back Mitre

Hinge Cutout

FP

RA

45 Degrees Polished Back Mitre

Hinge Cutout

RA

RA

45 deg Mitre

R10

66

44

Hinge C/L

Hinge Cutouts

Enter No of Panels

All for 10mm Toughened Glass	All dimensions mm	Flat Polish Edges (FP)	Rough Arris Edges (RA)	Toughened Stamp (T)	No Sharp Corners
------------------------------	-------------------	------------------------	------------------------	---------------------	------------------

<p>ORDER FROM:</p> <p>.....</p> <p>ORDER NO:</p> <p>.....</p>	<p>DELIVER TO:</p> <p>.....</p> <p>DATE:</p> <p>.....</p>
---	---

FRAMELESS HINGED SHOWER - GLASS ORDER SHEETS

Left Notched Return Hinge Panel with Polished 45 deg Back Mitre

FP

RA

45 Degrees Polished Back Mitre

Hinge Cutout

Hinge Cutout

45 deg Mitre

R10

66

44

Hinge C/L

Hinge Cutouts

Enter No of Panels

All for 10mm Toughened Glass	All dimensions mm	Flat Polish Edges (FP)	Rough Arris Edges (RA)	Toughened Stamp (T)	No Sharp Corners
------------------------------	-------------------	------------------------	------------------------	---------------------	------------------

ORDER FROM:

.....

ORDER NO:

.....

DELIVER TO:

.....

DATE:

.....

FRAMELESS HINGED SHOWER - GLASS ORDER SHEETS

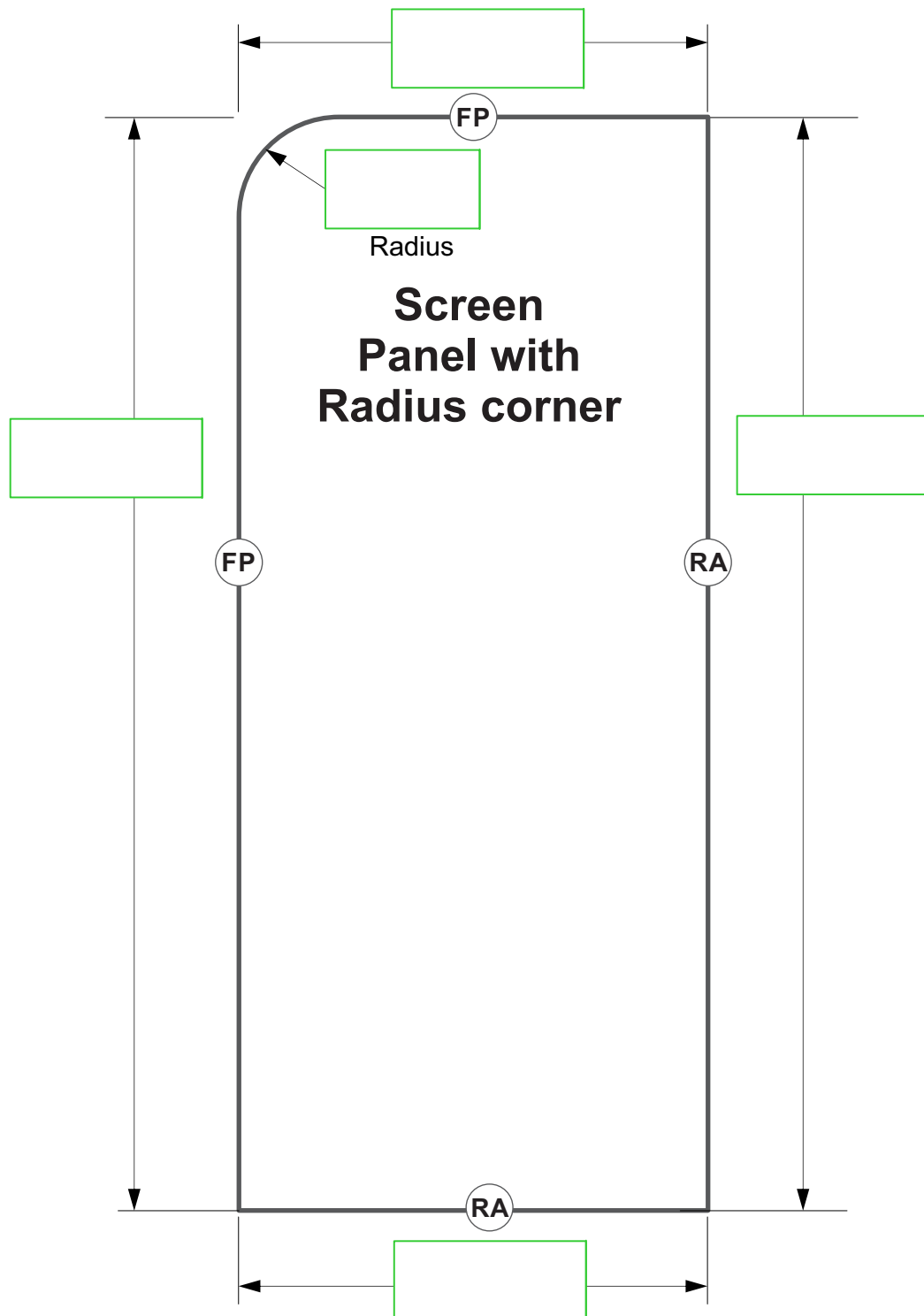

All for 10mm Toughened Glass	All dimensions mm	Flat Polish Edges (FP)	Rough Arris Edges (RA)	Toughened Stamp (T)	No Sharp Corners
------------------------------	-------------------	------------------------	------------------------	---------------------	------------------

ORDER FROM:

DELIVER TO:

ORDER NO:

DATE:

FRAMELESS HINGED SHOWER - GLASS ORDER SHEETS

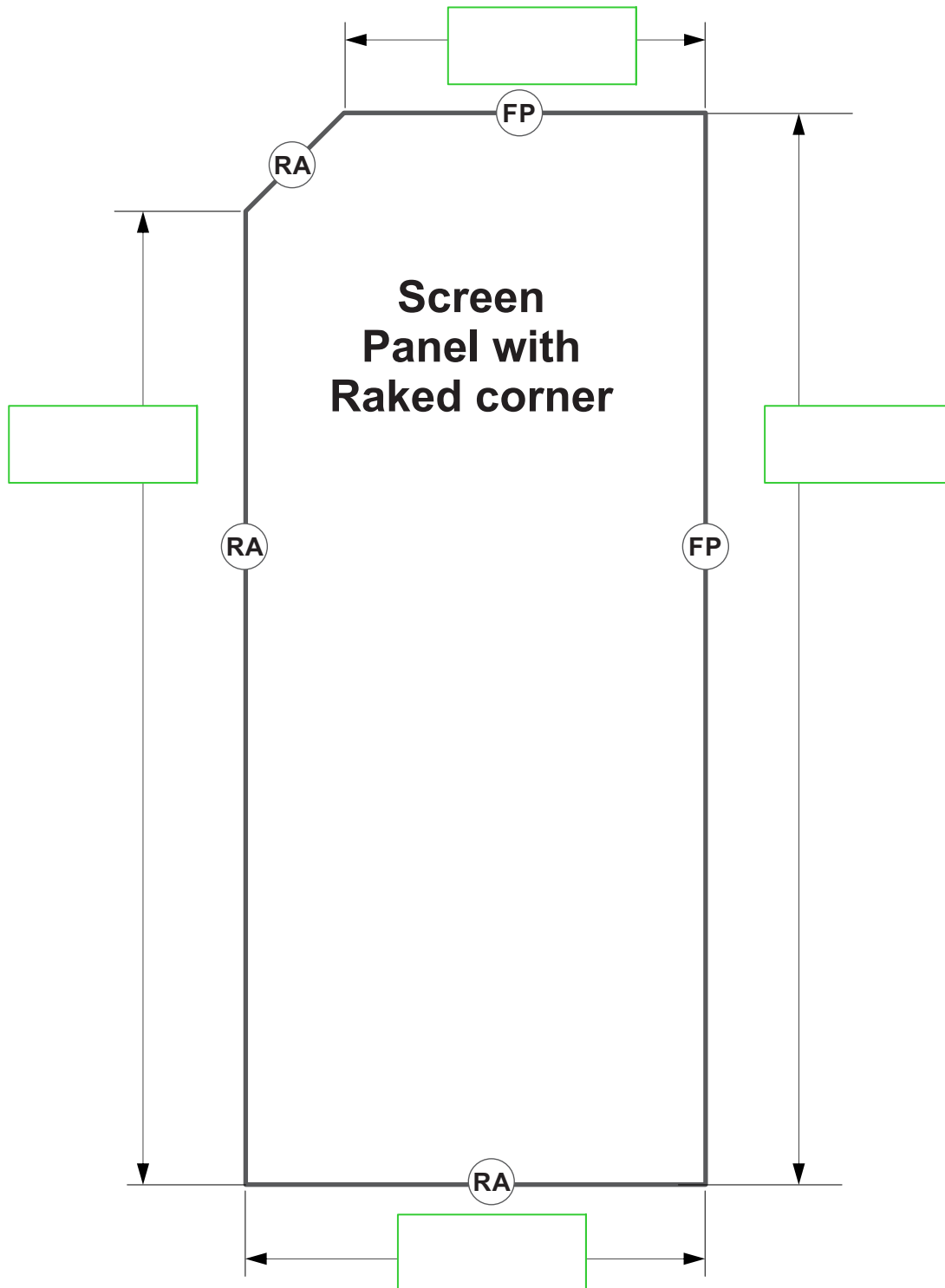

Enter No of Panels

All for 10mm Toughened Glass	All dimensions mm	Flat Polish Edges (FP)	Rough Arris Edges (RA)	Toughened Stamp (T)	No Sharp Corners
------------------------------	-------------------	------------------------	------------------------	---------------------	------------------

ORDER FROM:

.....

ORDER NO:

.....

DELIVER TO:

.....

DATE:

.....

FRAMELESS HINGED SHOWER - GLASS ORDER SHEETS

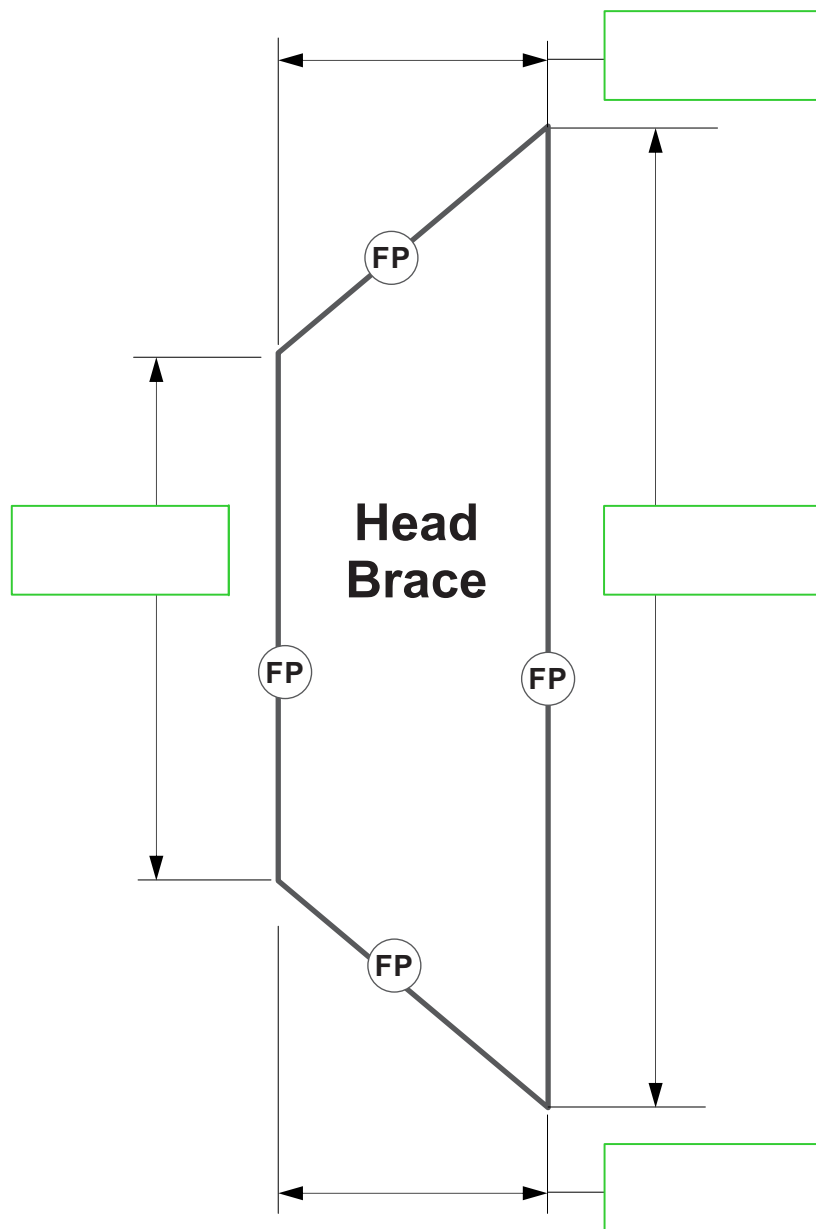

Enter No of Panels

All for 10mm Toughened Glass	All dimensions mm	Flat Polish Edges (FP)	Rough Arris Edges (RA)	Toughened Stamp (T)	No Sharp Corners
------------------------------	-------------------	------------------------	------------------------	---------------------	------------------

ORDER FROM:

.....

ORDER NO:

.....

DELIVER TO:

.....

DATE:

.....

Special Panel

--

Page 40

Juralco Frameless Shower Systems - Sliding Cutting Allowances

Glass Cutting Height Allowances

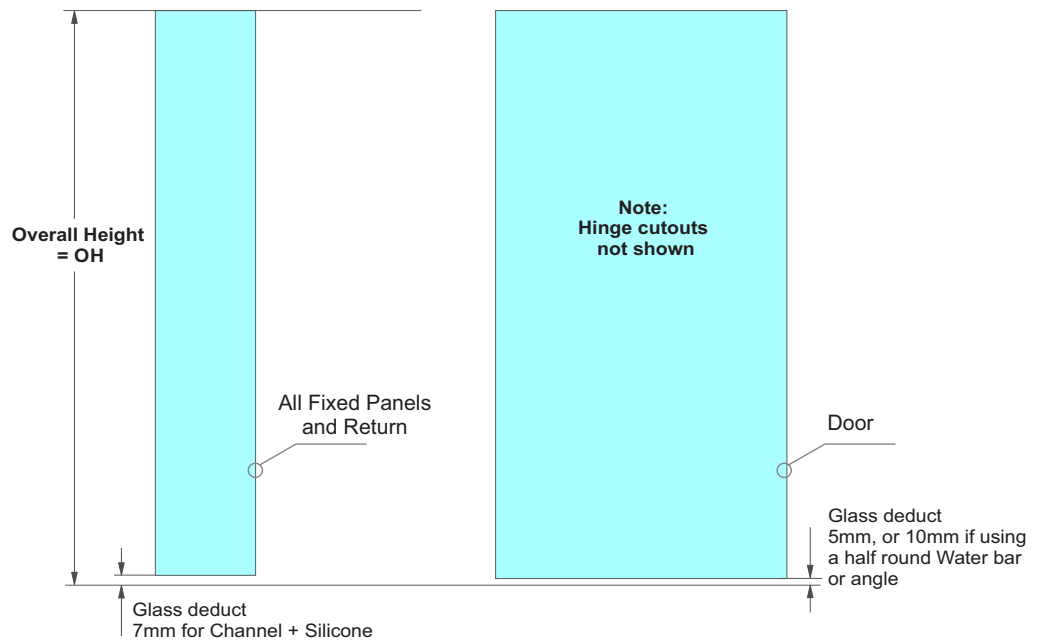

Sliding Door Shower Layouts

NOTE: These Drawings are schematic only and are not to scale

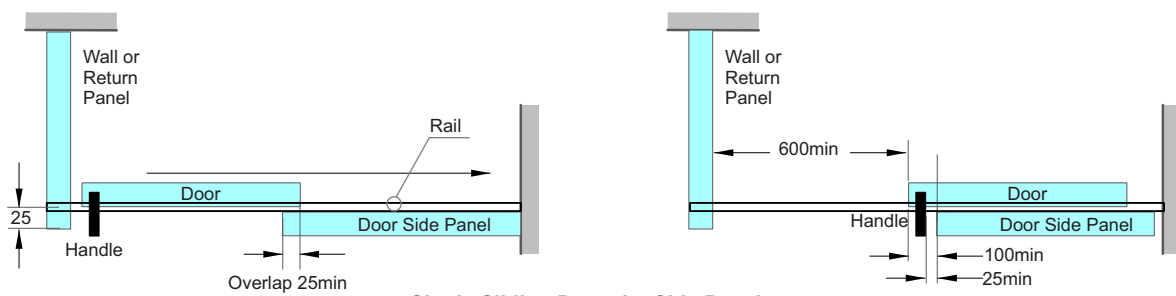

Single Sliding Door, 1 x Side Panel

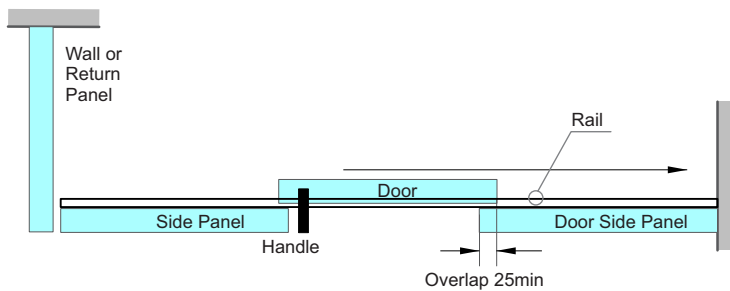

Single Sliding Door, 2 x Side Panels

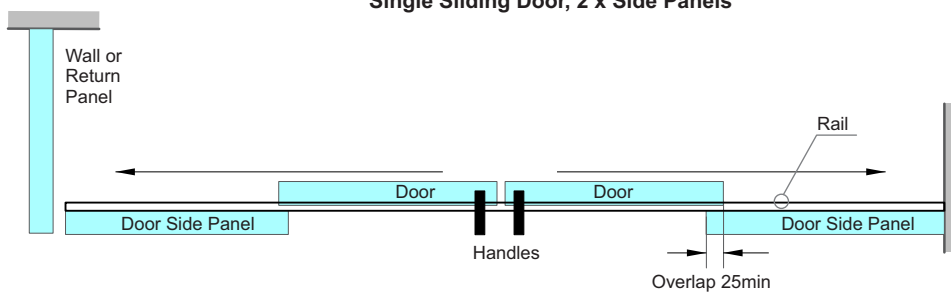

Double Sliding Door, 2 x Side Panels



Juralco Frameless Shower Systems - Sliding Components

Codes	Finishes
BB	Brushed Brass
BG	Brushed Gold
BN	Brushed Nickel

Codes	Finishes
BRG	Brushed Rose Gold Copper
CP	Polished Chrome
GM	Brushed Gun Metal
MB	Matt Black

Codes	Finishes
NAT	Natural Anodised
PSS	Polished SS
SB	Satin Brass
SCC	Powder Coated

Codes	Finishes
SCP	Satin Chrome
SN	Brushed Satin Nickel
SSS	Satin SS
STE	Sterling Bright Anodised

Oasis Sliding Shower Kits

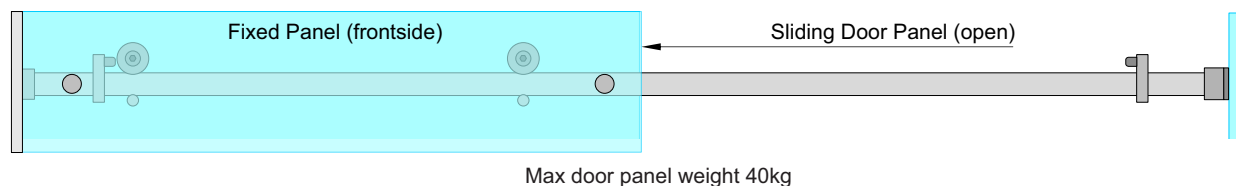
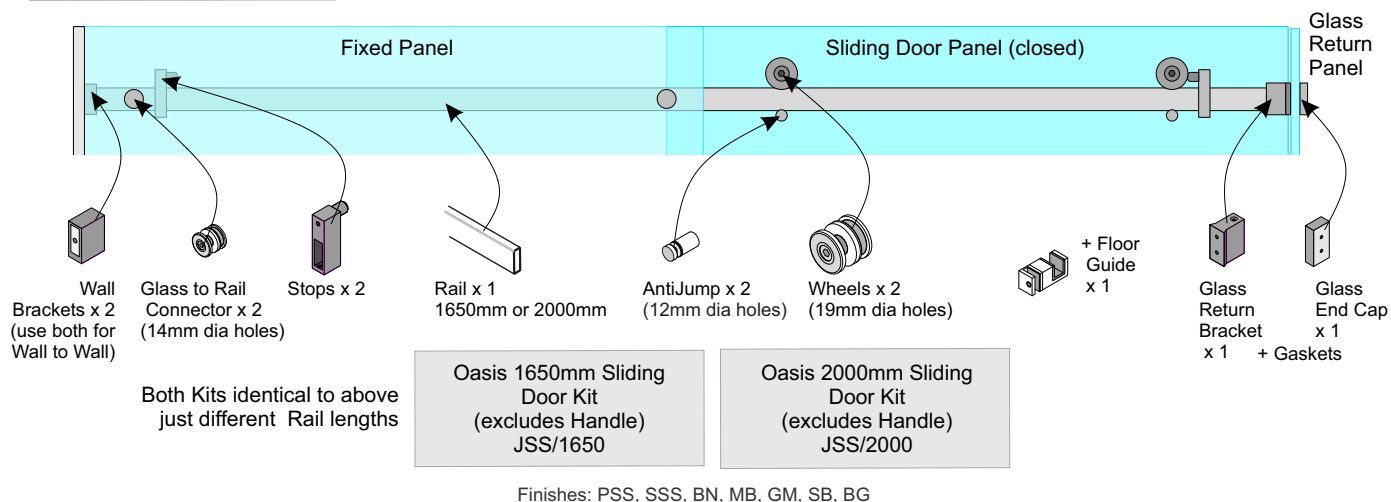

Note - Fixed Glass Panel.
Cut bottom Channel 20mm
short to allow for Floor Guide

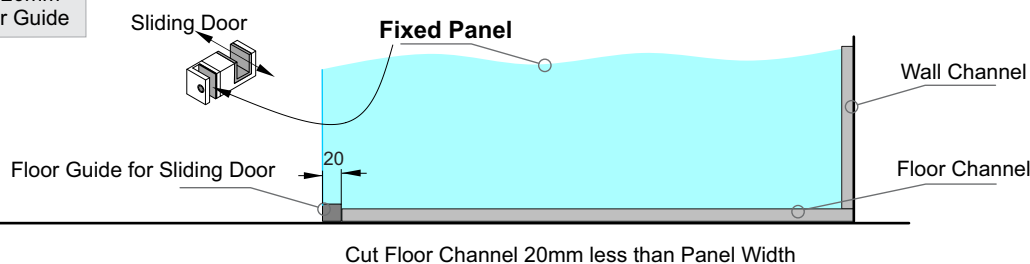

Glass Cutting Width Allowances

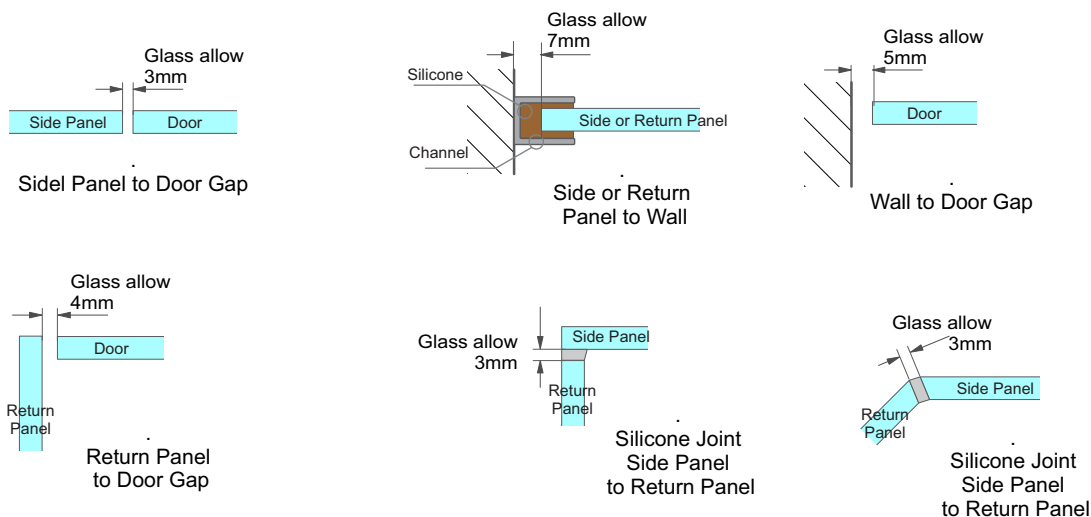

Measuring, Cutting, Installing Floor and Wall Channels

- Check shower opening for squareness. Adjust glass channels by packing them up/out if opening is less than 3-5mm out of square.
- Adjust Side Panels for proper glass cover if walls are out of square by 3-5mm.
- Measure and Cut your channels, when measuring for your Wall channels, make sure to deduct 18mm from the total height.
Also make sure to know how much you are going to pack up the glass off the bottom channel as you will need to add this back on to ensure that the side guides internal measurements will be the same height as the Side Panels final height
e.g (Final height of shower required is 2000mm, Measurement for Side channel for this glass will be 2000mm – 18mm + 5mm (Channel height +3mm packing in the bottom channel) Cut size= 1987)
- The Floor channel will be the full width of the glass +5mm e.g. (The Side Panel width is 700mm, so the bottom channel will be 700mm + 5mm (for silicone and packing) Cut size =705mm.
- **Cutting the Floor channel for the Door Side Panel only. Deduct 20mm from this total measurement to allow for the bottom door guide, as this needs the glass sticking out of the channel 20mm for this to attach to.**
- These examples show the cutting sizes for your glass channels if they are butted together. You can mitre these joins if you would like to. These measurements will be the total size height and width +5mm in each direction for packing material and silicone but with a 45 Deg mitre in the joining corner.
- Once your channels are cut for all your Side and Fixed panels, install these using “Bostik V60” Structural silicone ensuring full coverage of the underside of the channel to Walls and Floor Tiles
Place these down in the marked locations predetermined and make sure to plumb these up using either a level or a laser.
- After gluing the channels down and applying pressure, some silicone may have come out the sides; tidy this up using soapy water in a spray bottle and a silicone spatula. (Tip, clean your spatula after every wipe to ensure no smudging of the silicone onto the channel finish. Always make sure the silicone has soapy water on it before each wipe to avoid this also)
- Allow the Silicone/Channels joint to mature in place at least 48 hrs before installing the glass (Silicone reaches full cured strength in 7 days).
- Once the channels are clean and dry, you are ready to install your glass.

Installing Glass

- Make sure to install your predetermined packer (3mm in this example) then place a bead of silicone in the back of the channel making sure to have extra silicone in the joins in the channel as this is where it is prone to leaking if not fully sealed
- Install glass ensuring that the panel is plumb in all directions.
- Silicone the outside of the channel to fill any of the gaps that may have formed
- Using Wedge PN 31 cut to length, using a wedge roller roll this into the inside edge of the glazing channel.
This will force the glass panel to the outside of the channel. Clean excess and allow to dry for 48hrs or more.
- Or Silicone both side of Glass and press glass to outside edge. Then remove excess silicone. Allow 48 hrs to set or 7 x days for full cure.

Installing Hardware

- Prepare hardware, measure and cut the Stainless steel Rail to the desired length for your shower.
As this is Stainless steel it requires cutting with an angle grinder, Steel drop saw or a hacksaw cutting at a slow pace. Take off any burrs. (This should run from the Side Panel to the wall)
- Mark out your Rail for drilling. Drill 6.5mm dia holes in the Bar for attaching this to your door side panel using the supplied hardware
- Once the two holes are marked out, use a center punch to create an indent to guide your drill bit.
- It is recommended to drill a smaller hole and work your way up to the desired hole size using your choice of lubricating compound.
- Slide both End Stops on the drilled bar, facing ea other
- **Wall to Glass Return** - Install the Wall Bracket. Slide the Glass Return Bracket onto one end of the Rail. Mark and centre punch the Bar.
Drill 2 x 3.5mm dia holes top and bottom. Install the Glass Return Bracket to your Return Panel using the Glass Endcap.
There are two M4x20 screws and a gasket to protect the glass. Tighten these accordingly. Insert the Bar + Stops before final installation
- **Wall to Wall Return** - Install both Wall Brackets. Insert the Bar + Stops before final installation.

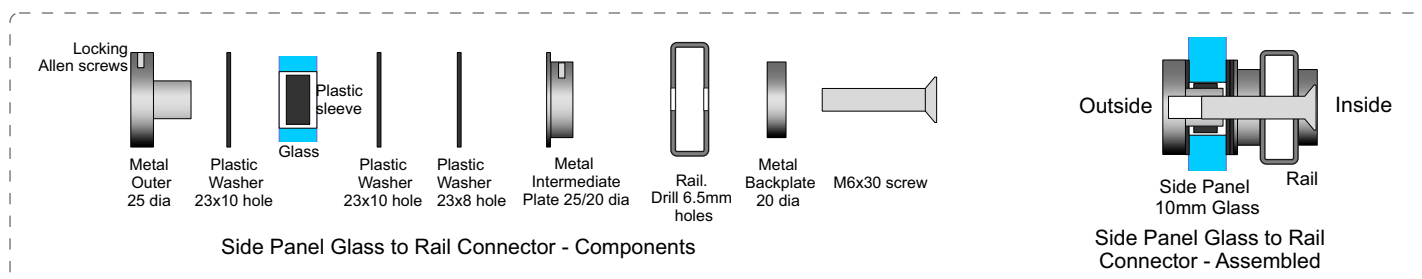

- Install the **Glass-to-Rail** connectors onto the rail. There must be 1 x washer on the Outside and 2 x washers on the Inside of the Glass. Tighten up.
- Insert the rail into the Glass Return bracket (and Wall Bracket(s) if applicable) and screw the Glass-to-Rail connector onto the rail
(Lock these using a small Allen key in the side of the Metal Outer/Intermediate plates)
- Ensure that the rail is level to ensure that the door does not roll open or close by itself.
- Tighten the Allen key underneath the Glass Return Bracket and Wall brackets to lock it in place.
- Install Door Wheels to the door and hang the door on the rail.
- Once the door is hung on the Wheels, you can install the Anti-jump components to the door.
- Slide the door to the open position and then install the Floor Guide to the Door Side Panel, sliding this on and tightening then onto the glass.
- There is height adjustment in the Door wheels and these can adjust the door height using the Allenkey in the face of the door wheels on the inside.
- Install the handle to the door.
- Make sure everything is tight and operating as intended. - Install all covers to the Allen key heads
- Clean glass and stainless using glass cleaner.

FRAMELESS SLIDING SHOWER - GLASS ORDER SHEETS

OASIS SLIDING DOOR GLASS ORDER SHEETS

Page No.	Panel Description
----------	-------------------

45	Sliding Door, Vertical Handle
46	Sliding Door Slides Pull Handle
47	Sidelight for Sliding Door
48	Return Panel
49	Blank Special Panel Sheet

OASIS SLIDING DOOR SHOWER

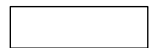

Page 45

FRAMELESS SLIDING SHOWER

GLASS ORDER SHEETS

OASIS SLIDING DOOR SHOWER

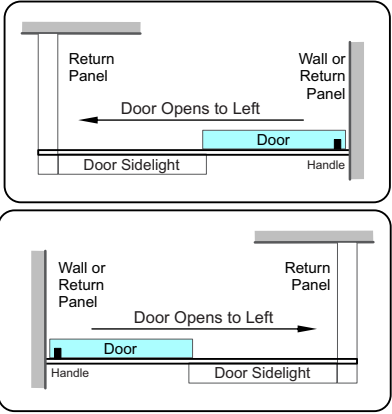
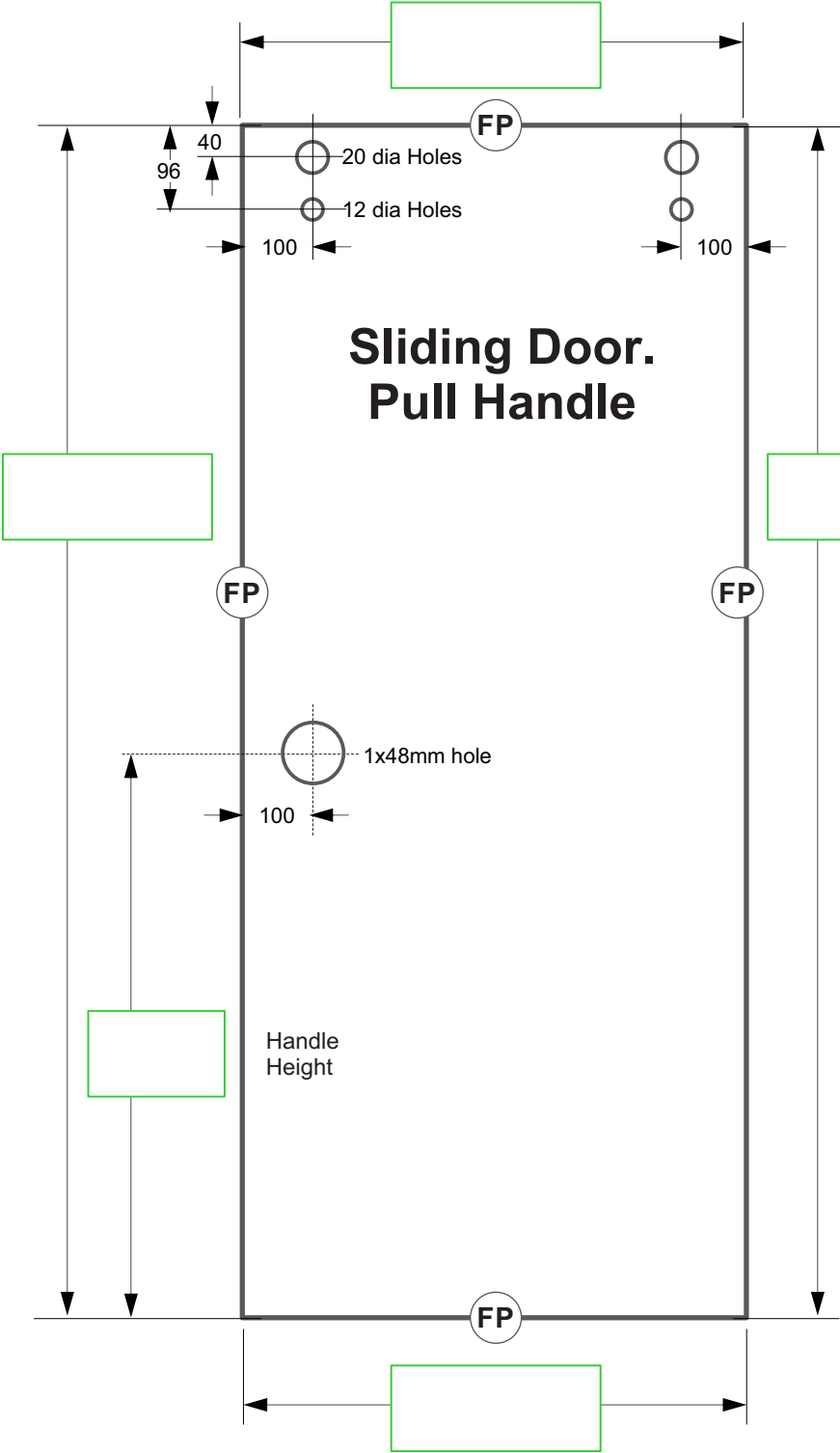

3 Panel Layouts above.
Also Applies to 4 and 5
Panel layouts

Enter No of
Panels

All for 10mm Toughened Glass	All dimensions mm	Flat Polish Edges (FP)	Rough Arris Edges (RA)	Toughened Stamp (T)	No Sharp Corners
------------------------------	-------------------	------------------------	------------------------	---------------------	------------------

ORDER FROM:

.....

ORDER NO:

.....

DELIVER TO:

.....

DATE:

.....

FRAMELESS SLIDING SHOWER

GLASS ORDER SHEETS

OASIS SLIDING DOOR SHOWER

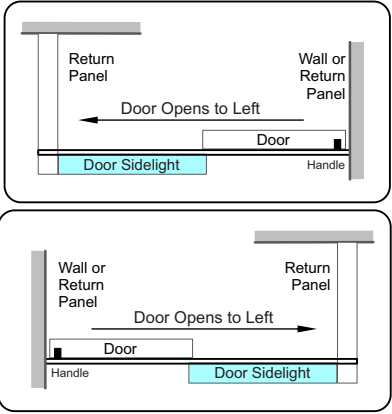
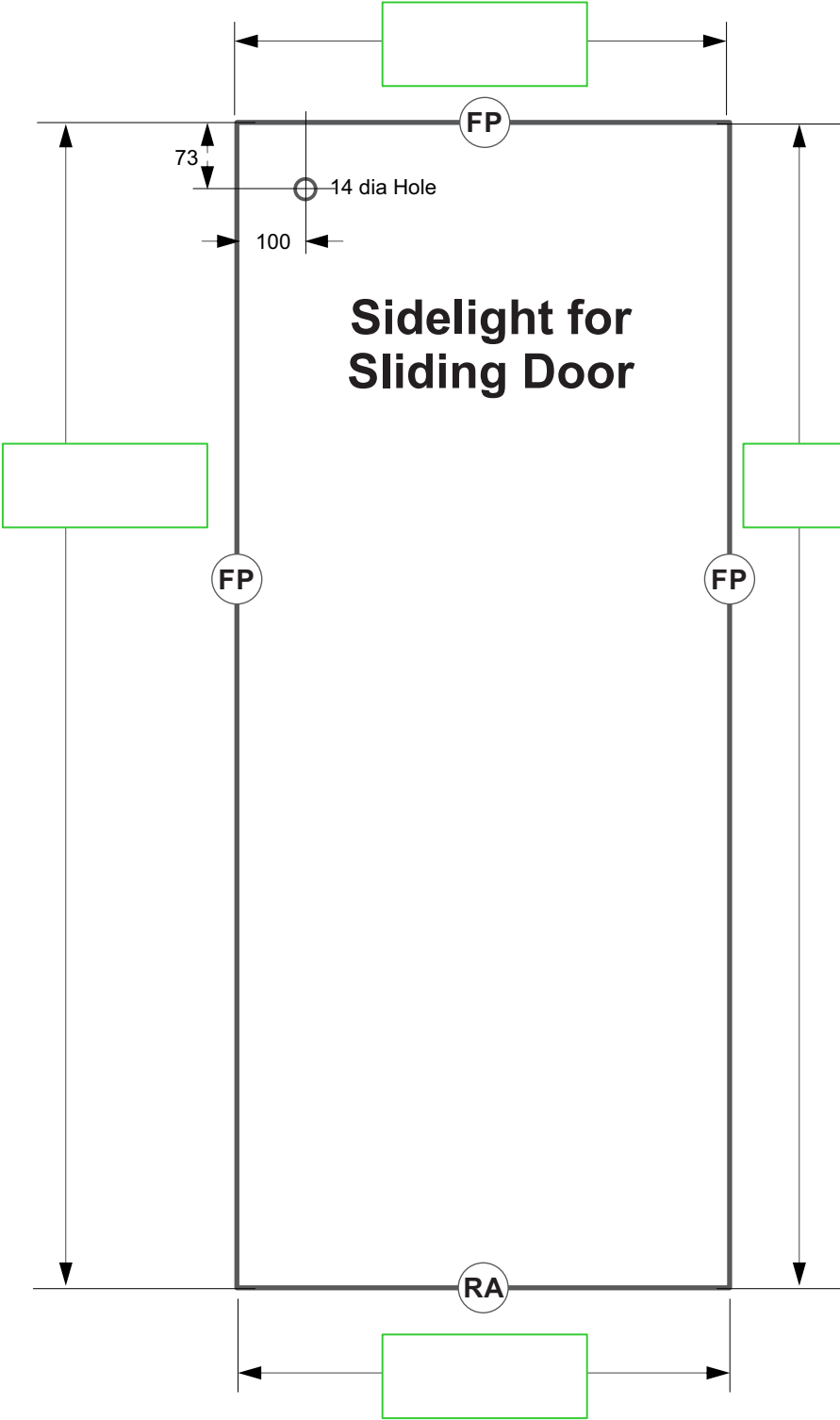

3 Panel Layouts above.
Also Applies to 4 and 5
Panel layouts

Enter No of
Panels

All for 10mm Toughened Glass	All dimensions mm	Flat Polish Edges (FP)	Rough Arris Edges (RA)	Toughened Stamp (T)	No Sharp Corners
------------------------------	-------------------	------------------------	------------------------	---------------------	------------------

ORDER FROM:

ORDER NO:

DELIVER TO:

DATE:

JURALCO

www.juralco.co.nz ph (09) 478 8018

Juralco Frameless Shower Systems

Issue 6- 24 v1

Page 47

FRAMELESS SLIDING SHOWER

GLASS ORDER SHEETS

OASIS SLIDING DOOR SHOWER

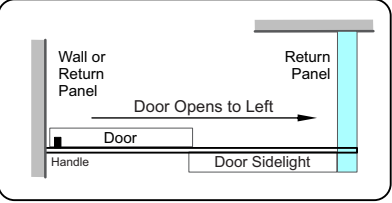
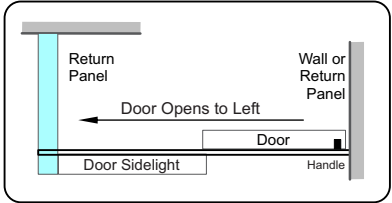
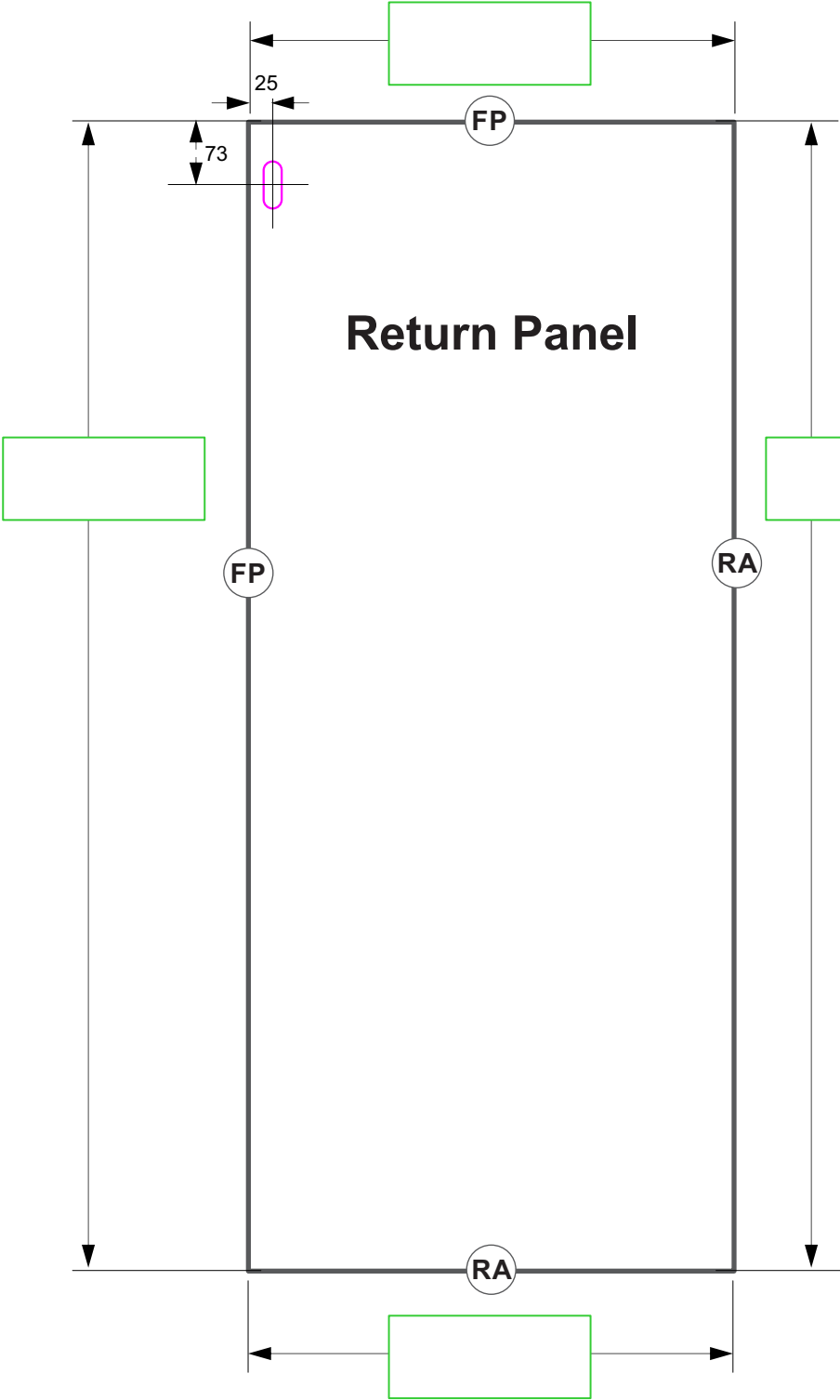

3 Panel Layouts above.
Also Applies to 4 and 5
Panel layouts

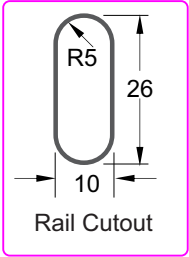

Enter No of Panels

All for 10mm Toughened Glass	All dimensions mm	Flat Polish Edges (FP)	Rough Arris Edges (RA)	Toughened Stamp (T)	No Sharp Corners
------------------------------	-------------------	------------------------	------------------------	---------------------	------------------

ORDER FROM:

ORDER NO:

DELIVER TO:

DATE:

Special Panel

Enter No of
Panels

All for 10mm Toughened Glass	All dimensions mm	Flat Polish Edges (FP)	Rough Arris Edges (RA)	Toughened Stamp (T)	No Sharp Corners
------------------------------	-------------------	------------------------	------------------------	---------------------	------------------

ORDER FROM: ORDER NO: 	DELIVER TO: DATE:
--	--

Glass Care and Maintenance

Glass Cleaning and Maintenance

Architectural glass products must be properly cleaned during the construction period so visual and aesthetic clarity are maintained. Because glass can be permanently damaged if improperly cleaned, glass producers and fabricators recommend strict compliance with the following procedures.

First, determine whether the glass is clear, tinted or reflective. Surface damage is more noticeable on reflective glass compared with the other glass products. If the reflective coated surface is exposed, either on the exterior or interior, special care must be taken when cleaning, as scratches can result in coating removal and a visible change in light transmittance. Cleaning tinted and reflective glass in direct sunlight should be avoided. Cleaning should begin at the top of the building and continue to the lower levels.

Commence cleaning by soaking the glass surfaces with clean water and a soap solution to loosen dirt or debris. Then, using a mild, non-abrasive commercial window washing solution, uniformly apply the solution to the glass surfaces with a non-abrasive applicator and follow with a squeegee to remove all of the cleaning solution from the glass surface.

Ensure that no metal parts of the cleaning equipment touch the glass surface and that no abrasive particles are trapped between the glass and the cleaning materials. All water and cleaning solution residue should be dried from the window gaskets, sealants and frames.

Scratches and Metal Scrapers

Scratches can occur from hard pointed objects or poor handling, but most often occurs from the careless removal of foreign matter from the glass surface.

Mortar splatter and paint are common offenders and efforts to remove after hardening almost always lead to surface damage. It is essential that the foreign materials are removed before they harden. Better still, if construction work continues after glazing, that the glazed areas are protected by adhesive plastic films or suitable tarpaulins or covers.

One of the common mistakes made by non-glass trades people, including glass cleaning contractors, is the use of razor blades or other metal scrapers on a large portion of the glass surface. Using large blades to scrape a window clean carries considerable risk of causing damage to the glass.

The glass industry, fabricators, distributors and installers neither condones nor recommends any scraping of glass surfaces with metal blades or knives. Such scraping usually permanently damages or scratches the glass surfaces. When paint or other construction materials cannot be removed with normal cleaning procedures, a new 25mm razor blade may have to be used. The razor blade should be used on small spots only. Cleaning should be done in one direction only. Never scrape in a back and forth motion as this could trap particles under the blade that could scratch the glass.

Blades or scrapers can dislodge "pickup" on toughened glass. There are fine particles of glass that are fused on to the surface during toughening. Once dislodged they can scratch the glass.

Glass Cleaning, Do's and Don'ts

DO NOT..

- Do Not - Use Scrapers of any type or size on a Glass surface
- Do Not - Leave building dirt or residues to remain on Glass for a period of time.
- Do Not - Begin cleaning glass until you have identified the surface type.
- Do Not - Clean Glass surfaces in direct sunlight.
- Do Not - Allow dirty water or cleaning residues to remain on the Glass.
- Do Not - Begin cleaning before rinsing off a loose residues.
- Do Not - Use abrasive cleaning solutions, materials or solvents.
- Do Not - Allow metal parts of the cleaning equipment to come in contact with the Glass.
- Do Not - Trap abrasive particles between the cleaning material and the Glass.

DO...

- Clean glass promptly when dirt or building residues appear.
- Determine glass surface type.
- Exercise special care when cleaning coated surfaces.
- Avoid cleaning glass surfaces in direct sunlight.
- Start cleaning at the top of a building, then continue to lower levels.
- Soak the glass surface in a clean soapy solution before cleaning.
- Use a mild non abrasive commercial cleaner.
- Use a squeegee to remove all cleaning solution.
- Try your procedures on a small window and check.
- Caution other trades re the care and protection of the glass surfaces.

**Residues of surface grit may be present from the toughening production process.
These grit particles must not be dragged across the surface.
NEVER use Metal Scrapers**

All above reprinted with permission from Metro Glass Tech

Care and Maintenance of Stainless Steel

Introduction

Stainless steels are selected for applications where their inherent corrosion resistance, strength and aesthetic appeal are required. However, dependent on the service conditions, stainless steels will stain and discolour due to surface deposits and so cannot be assumed to be completely maintenance-free. In order to achieve maximum corrosion resistance and aesthetic appeal, the surface of the stainless steel must be kept clean. Provided the grade of stainless steel and the surface finish are correctly selected, and cleaning schedules carried out on a regular basis, good performance and long service life will result.

For the correct selection of a Stainless Steel grade, with respect to Location, see Table below.

Factors affecting maintenance

Surface contamination and the formation of deposits on the surface of the stainless steel must be prevented. These deposits may be minute particles of iron or rust generated during construction. Industrial and even naturally occurring atmospheric conditions can produce deposits which can be equally corrosive, e.g. salt deposits from marine conditions.

Working environments can also provide aggressive conditions such as heat and humidity in swimming pool buildings. These conditions can result in surface discolouration of stainless steels and so maintenance on a more frequent basis may be required.

Modern processes use many cleaners, sterilizers and bleaches for hygienic purposes. Proprietary solutions, when used in accordance with makers' instructions, should be safe but if used incorrectly (e.g. warm or concentrated), may cause discolouration or corrosion on stainless steels. Strong acid solutions are sometimes used to clean masonry and tiling of buildings. These acids should never be used where contact with metals, including stainless steel, is possible. If this happens, the acid solution must be removed immediately, followed by dilution and rinsing with clean water.

Maintenance programme

With care taken during fabrication and installation, cleaning before 'hand-over' should not present any problems. More attention may be required if the installation period has been prolonged or hand-over delayed. Where surface contamination is suspected, immediate cleaning after site fixing should avoid problems later.

The frequency of cleaning is dependent on the application. This may vary from once to four times a year for external applications, Recommendations on cleaning frequencies in architectural applications are shown below.

Cleaning frequency

Reccommended Cleaning for various grades of Stainless Steel		
Location	304 Grade	316 Grade
Surbarban or Rural	Clean at 6-12mth intervals or as necessary	
Industrial or Urban	Clean at 3-6mth intervals	Clean at 6-12mth intervals
Coastal or Marine	Not recommended	