



Juralco Felicia Awning System

Juralco Aluminium Building Products Ltd designs and distributes specialist aluminium joinery systems through a national network of franchised fabricators and agents.

For more than 25 years we have been at the forefront of specialist aluminium door and window products suitable for New Zealand joinery and building methods. Our comprehensive product range includes security and insect screens, balustrades and gates, shutters and awnings, shower screens, wardrobe doors and organisers and internal doors.

The Juralco Felicia Awning is a compact, ready-to-install, cantilevered folding twin arm awning system designed for outside use where protection is needed from sun or light rain. All the components are made of aluminium alloy, ABS plastic or stainless steel, forming a highly-resistant, lightweight, rust-proof construction.



General Description

- The Juralco Felicia Awning system is available as a single unit up to 5.9mt wide, with a max 3.5mt awning extension.
- Typical applications include Decks, Bars, Shops, Terraces, or anywhere needing protection from the sun, or light rain.
The awning is supplied pre assembled, all necessary brackets, awning roll and two arm units.
- **Box** - Supplied as a single, enclosed unit complete with mounting brackets. Attachment by end brackets, either wall or ceiling mount.
- **Awning fabric** - Many styles available, all mildew and UV resistant. A valance to match can be fitted if required.
- **Drive - Manual** - A gearbox fitted to the end of the roller tube assists the operator to raise/lower the curtain.
- **Drive - Motorised** - An inline tubular motor retracts the awning automatically.
The motor is wired to a 3 position switch in-off-out. Remote wireless controls available. Optional wind sensor.
- **Arms** - Factory set spring loaded arms evenly tension the fabric cover, and absorb movement in windy conditions.
- **Slope** - Awning angle adjustable. For Wall mount 0 to 38 degrees down and for Ceiling mount 0 to 58 degrees down.
- **Finish** - All Aluminium, powder coated colour of your choice. Arms powder coat Silver only.
- **Wind** - As for all Awnings, care must be taken when installing in Wind prone areas. A Volo wind sensor is strongly recommended.

Important information - Powder Coating systems.

Powdercoat Systems The new standard Dulux powder coating system used by Juralco is Duralloy Plus®. Also Duralloy® and Duratec®. Juralco Powder coated prices are for Duralloy Plus® and Duralloy® (same pricing). Duratec® prices on application. The following specs apply to Building Exteriors.

- Dulux Duralloy Plus® powder coating systems are suitable for properties greater than 10m from high tide level. Residential and Light commercial buildings, 3 levels max. Warranty 15 yrs
- Dulux Duratec® powder coating systems are suitable for properties greater than 10m from high tide level. All Residential and Commercial buildings. Warranty 25 yrs.

Attachment to structures A PVC Tape or similar material spacer must be used to separate powder coated aluminium items from all concrete and steel structures. Failure to do so can lead to the chemicals in the structure affecting the powder coating, leading to corrosion.

Swimming Pools The chlorinated water in swimming pools can cause the deterioration of powder coated surfaces, leading to corrosion of the underlying surface. It is recommended that Powder coated surfaces be 1200mm min from a pool.

Care The Dulux powder coating warranty period is conditional upon the surface being maintained in accordance with the Dulux 'Care and Maintenance Instructions'. Download from Dulux or refer to the back page of this manual.

All pages © Copyright Juralco Aluminium Building Products Ltd, 2023

Juralco Felicia Awning System - General Arrangement

General Arrangement

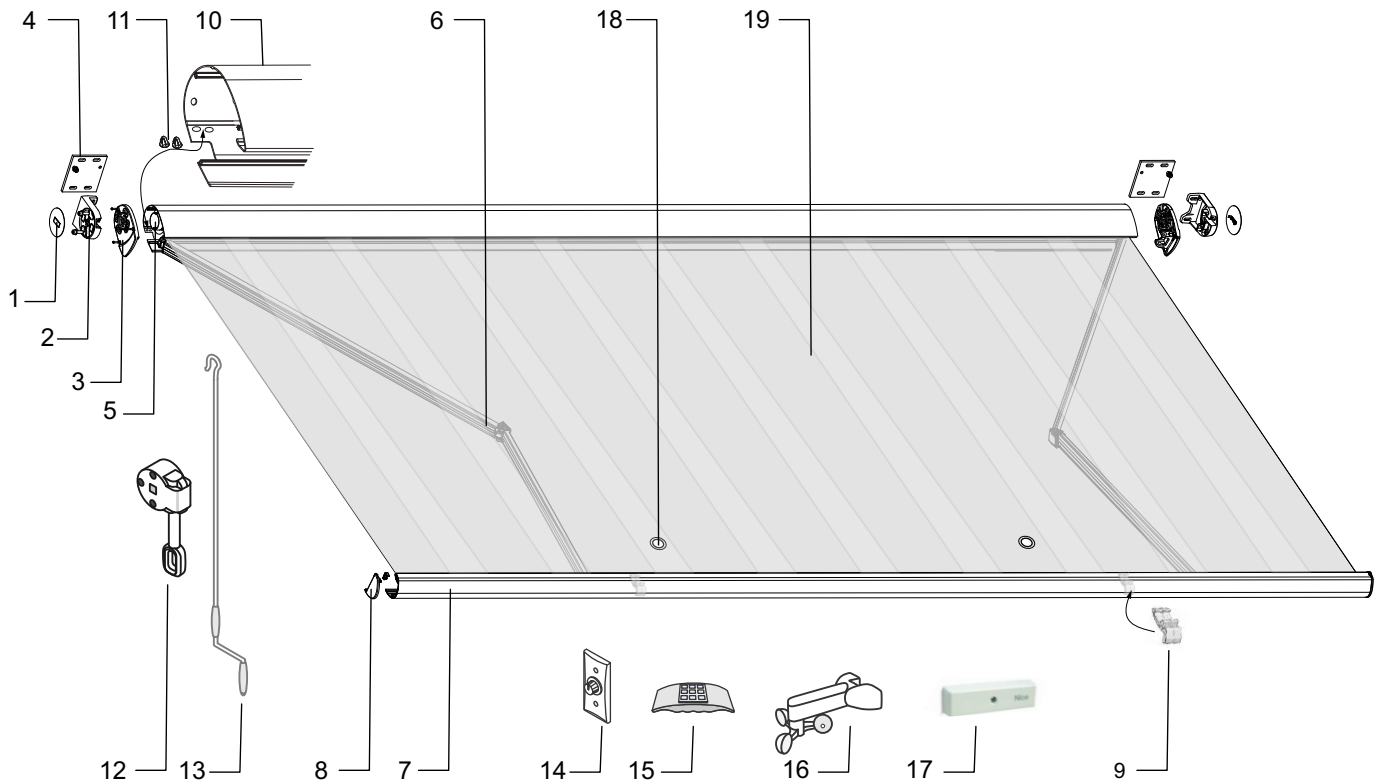

Fixings

- 1 - Cover and HomePlus nameplate
- 2 - Aluminum Fixing Bracket
- 3 - Head Box End Cap with Arm mounting
- 4 - Aluminium Fixing Plate

Roller Components

- 5 - 80mm RollerTube and Gearbox or 230v inline motor

Arms

- 6 - Folding Arms

Front Profile

- 7 - Aluminum Front Profile extrusion
- 8 - Front Profile End cap
- 9 - Front Profile/Arm Closer

Head Box

- 10 - Aluminum Head Box extrusion with optional LED Lighting
- 11 - SJ037 Stile Plugs

Operating Mechanism

- 12 - Gearbox (for manual operation option)
- 13 - Crank (for manual operation option?)
- 14 - Hard Wired In/Out switch
- 15 - Wireless Remote control - optional
- 16 - Wind sensor - optional
- 17 - Wind Sensor, Vibration - Optional

Awning

- 18 - Optional Drainage Eyelets
- 19 - Planosol or Dixon Fabric Awning

Not Shown - Valance option.

Removable Straight type included
Scalloped, optional



Planosol Awning Fabric

Planosol is manufactured from 100% acrylic fibre and will retain a light fastness rating of 6-8 on a 1-8 scale.

Planosol is very tightly woven, with minimal light transmission, resulting in excellent UV protection. It has Ultraviolet Protection factor of 50+, maximum value granted for percentage of protection against UV ray and SPF 100. Planosol fabric will remain rot resistant for 5 years under normal exposure conditions.

Dicksons Awning & Outdoor Canvas

The outdoor fabric of choice when it comes to solar protection, offering long-term protection against UV rays, heat, glare and inclement weather. Its solution-dyed Sunacryl acrylic fibres and special Cleangard treatment give it exceptional long-term colour fastness and superior resistance to tearing, water damage and dirt.

Sunacryl, 100% solution-dyed acrylic: the colour is locked right into the very core of the fibres during manufacture (in contrast to the traditional yarn-dyeing process whereby colours are applied to the finished yarn and remain on the surface). Dyed all the way through, this type of yarn ensures exceptionally long-lasting, ultra vivid colours.

Note: It is recommended that eyelets are fitted to the front edge of the fabric, to promote draining.

Juralco Felicia Awning System - General Components

General Components

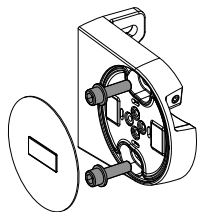

FIXING BRACKET in heavy wall cast aluminium
Powder coated in a colour of your choice
Used in pairs and fixed directly onto the facings at both ends of the awning.
They house the spindles for the casing and can be used for either wall or ceiling mounting.
Cover Plate with HomePlus Logo

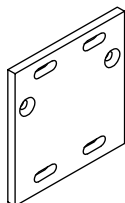

FIXING Plate in heavy wall cast aluminium
Powder coated in a colour of your choice
For extra support at Walls or Ceilings, and for large Awnings

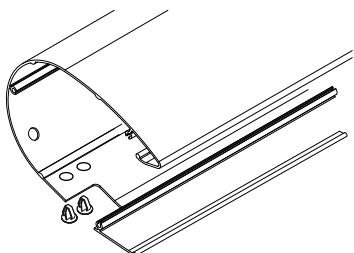

HEAD BOX, extruded aluminium
Powder coated in a colour of your choice
Gives effective protection for the canvas, operating mechanism and arms, which are hidden from view when retracted.
Optional LED light bar.

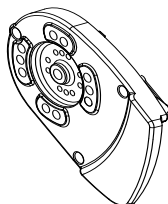

HEAD BOX END CAP, heavy wall cast aluminium
Powder coated in a colour of your choice
This end cap is the most important part of the awning.
It is the component to which the rolling tube, casing and operating mechanism are all mounted, as well as being the attachment point for the arm.

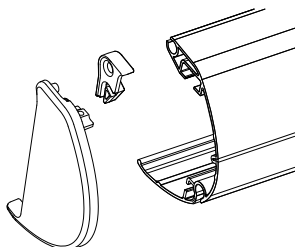

FRONT PROFILE, extruded aluminium
Powder coated in a colour of your choice
Sealed at both ends by polyamide end caps, it's specially designed shape allows the casing to close completely when the arms are retracted.

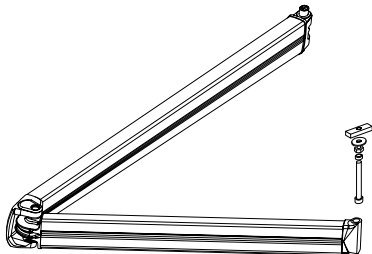

ARMS
Powder Silver only
The arms consist of extruded aluminium sections, cast aluminium hinge joints and extension springs which are connected internally by sheathed cables.
They are capable of supporting extensions of 1500, 2000, 2500, 3000 and 3500mm, and are produced in two sizes, according to the size the extension and width of the awning.
They attach directly to the end caps of the casing at either end of the awning and require no adjustment.



ARMS/CLOSING
This part is clipped into the Front Profile and allows the Headbox/Front Profile to be completely closed off when the arms are folded

Juralco Felicia Awning System - Components

Roller Tube End Cap
JFA/4090689

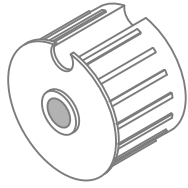

80mm dia
12mm dia hole

Stile Plug
SJ037



For Motor limit stop adjust and wiring access

Fixing Bracket Set
incl Cover with H+ logo

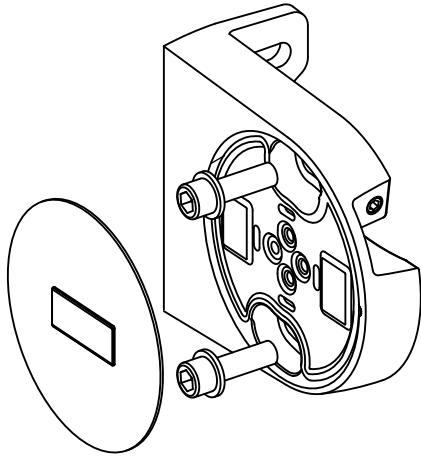

RH + LH Set
JFA/4036220

Head Box End Caps

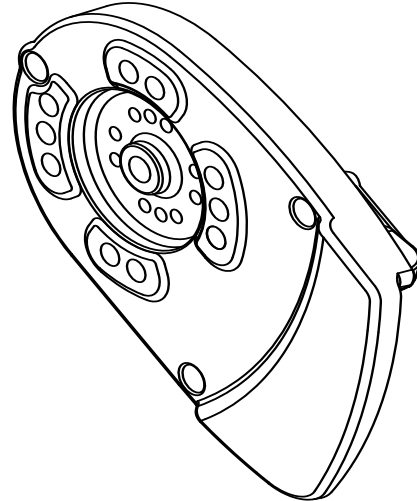

RH + LH Set
For Large Arm JFA/4036215
For Small Arm JFA/4036211

Manual Gearbox 1:9
JDA/4032424

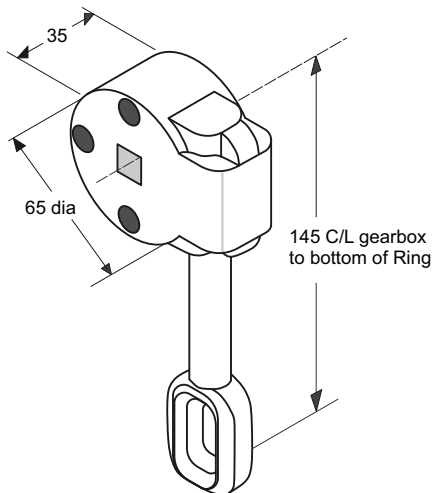

Gear Ratio 1:9
Incorporates a Limit Stop

Fixing Plate
JFA/4036221

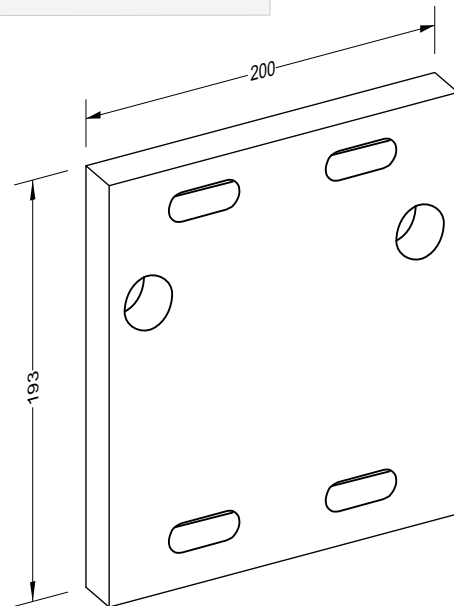

Optional extra support at Walls or ceilings for Awnings
less than 4700mm wide.
Supplied as (No cost) as part of Awnings over 4700mm wide

Juralco Felicia Awning System - Components

Gearbox Handle



Gearbox Handle
Clip, Pt No
JDA 4026500



JDA/4030431 - 1200mm
JDA/4030593 - 1600mm
JDA/4030595 - 2000mm

Folding Arms

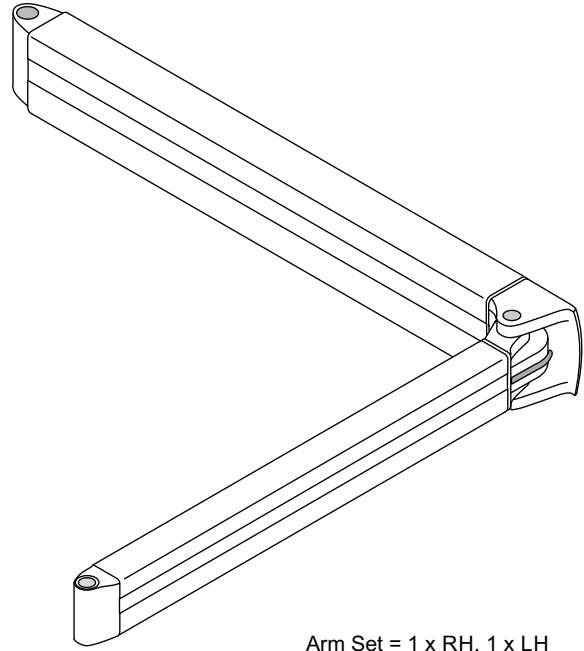

Arm Set = 1 x RH, 1 x LH

Small Arm JDA/4039708 - 1500mm (Single Wire)
JDA/4039716 - 2000mm (Single Wire)

Large Arm JDA/4039720 - 2500mm (Double Wire)
JDA/4039724 - 3000mm (Double Wire)
JDA/4039728 - 3500mm (Double Wire)

Front Profile End Cap
JFA/4036271

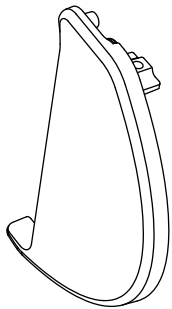

Front Profile End Cap set
= 1 x RH, 1 x LH

Arm Pusher
JFA/4032799



Arm Pusher set = 1 off.
White Plastic

Roller Tube Pin Set
JFA/4036235

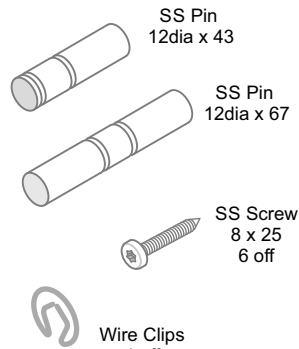

SS Pin 12dia x 43
SS Pin 12dia x 67
SS Screw 8 x 25
6 off
Wire Clips
4 off
Roller Pin set = 1 off

Folding Arm Attach Set
JFA/4036223

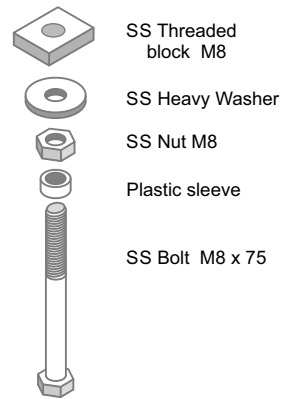

SS Bolt set = 2 off

Soffit Fixing Bracket
JFA/SFBRKT

To be ordered ex factory individually

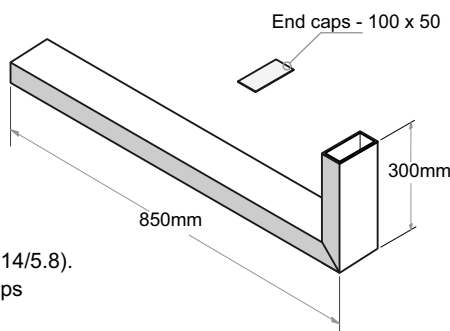

Manufactured ex 100mm x 50mm x 3mm (JA314/5.8).
Kit includes Bracket as above and 2 x End Caps

- Installer to cut down to size to suit
- Installer to drill own holes to suit
- Installer to RTV End Caps in place
- Installer to supply own Bolts/Coachscrews and JVB125 spacers if required.

Juralco Felicia Awning System - In Line Motors and Controls

Tubular Motors
JNICE ERA M 3017 and 5012

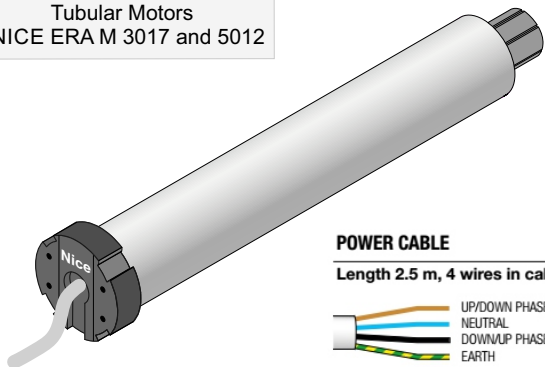

POWER CABLE
Length 2.5 m, 4 wires in cable

- UP/DOWN PHASE
- NEUTRAL
- DOWN/UP PHASE
- EARTH

Tubular Motors 45mm dia
Mechanical Limit switches
Motor 3017 - 30Nm, 17rpm
Motor 5012 - 50Nm, 12rpm

Easily set Mechanical In/Out Limit switches

Tubular Motors
JNICE ERA PLUS 3017 and 5012

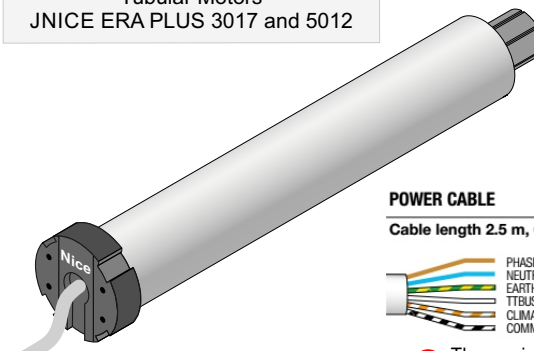

POWER CABLE
Cable length 2.5 m, 6 wires in cable

- PHASE
- NEUTRAL
- EARTH
- TTBUS
- CLIMATIC SENSORS
- COMMON TTBUS

These wires must be isolated if not being used

Tubular Motors 45mm dia
Push Button Limit switches
Built in Wireless Receiver & TTBUS Technology
Motor 3017 - 30Nm, 17rpm
Motor 5012 - 50Nm, 12rpm

Easily set Wireless In/Out Limit switches and Awning tensioning. Also Climate controls

Motor Mount Brackets
JNICE/BRKT/ERAM

For 45mm dia Motors
Compact aluminium support. 2 x holes M6 at 48 and 60mm CL

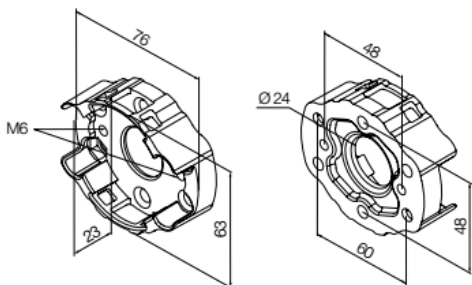

Manual Controls
Switch Controls

Wall Controls

3 position Rotary Wall Switch
Up - Off - Close
Cover Plate - SSW 770 CPSM
Switch - SSW 770 RSB



Wireless Remote Controls

Wireless Receiver



JNICE/BIDIAWNING. Nice controller for Wireless operation. Can be added to Switch operation and Manual override Motors to make for wireless control

Drive Wheel and Crown
JNICE/45ROUND78



Wireless Remote Controls

Portable Wireless Transmitters



P1 P6 P18

- P1 Portable transmitter to control 1 electrical load system or automation group
- P6 Portable transmitter to control 6 electrical load systems or automation groups for activation in single or multigroup mode
- P18 Portable transmitter to control 18 electrical load systems or automation groups for activation in single or multigroup mode

Motor Remote Control Sensors

Wind Sensor threshold has 3 wind speed settings
15, 30, 45 Kph



JNICE/WIND/S
Volo Wind Sensor

NEMO VIBE does not require any additional connections because it is battery powered. It screw attaches to the front of the awning. During windy conditions, a signal (adjustable) is sent via radio sensor to the motor mounted in the awning, which then retracts the awning.



JNICE/NEMOVIBE
Vibration Sensor

Juralco Felicia Awning System - In Line Motors and Controls

Manual Control

HPM Rotary
Switch Controls



One switch per Single Motor only.
Use relays if more than single Motor
Motor fully tested
and Limits set at factory

Tubular Motors
JNICE ERA M 3017 and 5012

Motor Power Cable

Length 2.5 m, 4 wires in cable

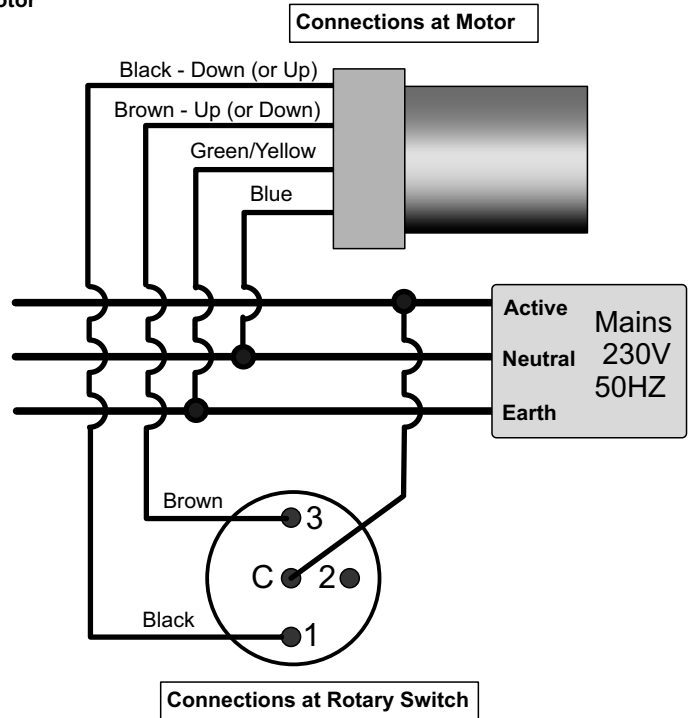

Remote Control

Wireless Controls
TTBus

Volo Wind Sensor 15kph Limit set at factory
(set limits available 5,10,15,30,45kph)
Motor fully tested
and Limits set at factory

Wireless Remote Control

Portable Wireless Transmitters



P1 P6 P18

Tubular Motors
JNICE ERA PLUS 3017 and 5012

Motor Power Cable

Cable length 2.5 m, 6 wires in cable

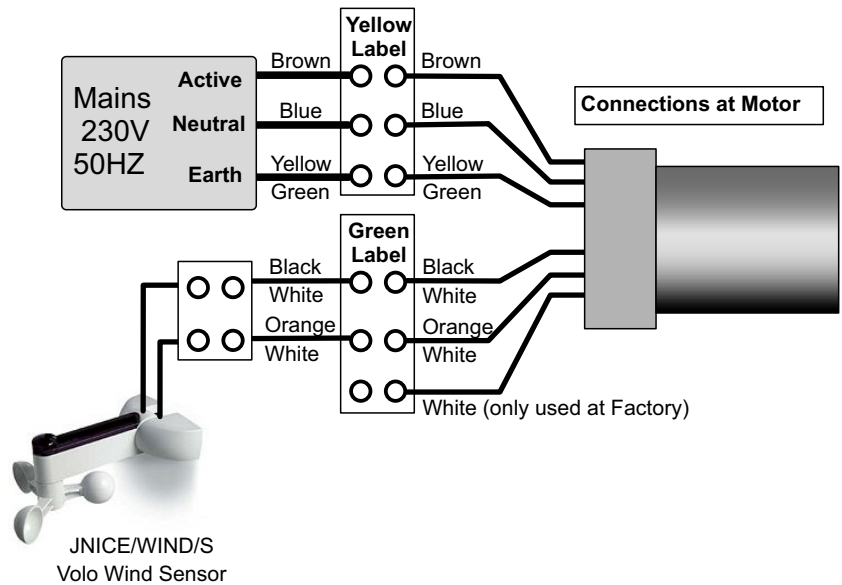
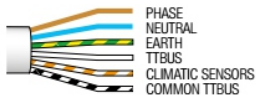

Wind Speed Adjustment - Awning Retraction settings

At the factory, the intervention threshold is set at level 3 and to change it you must take the following steps

01. Keep the **n** key pressed and wait for the motor to perform 2 movements. Upon completion, release the key.
02. Keep the **t** key pressed and wait for the motor to perform 3 movements. Upon completion, release the key.
03. Briefly press the **s** key a few times, depending on the level you want to set for wind threshold.

- 1 press = wind, 5 km/h
- 2 presses = wind, 10 km/h
- 3 presses = wind, 15 km/h (factory settings)*
- 4 presses = wind, 30 km/h
- 5 presses = wind, 45 km/h

After about 10 seconds, the motor performs the number of movements indicated by the level number selected
 Note – If this does not occur, cancel the procedure.

This way, the adjustment is completed without changing the factory setting.

04. Keep the **n** key pressed and wait for the motor to perform 3 movements. Upon completion, release the key.

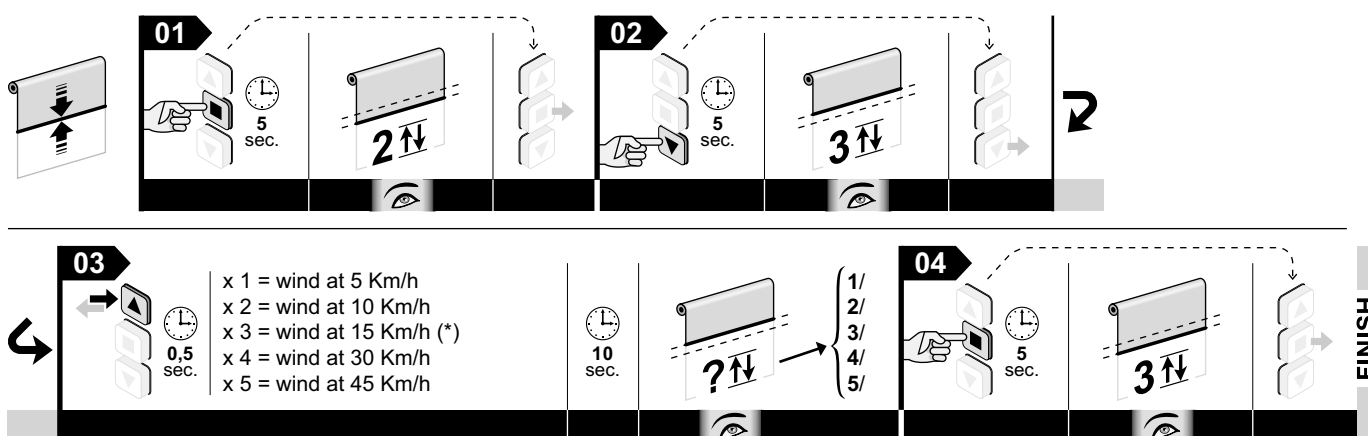

Notes.

- When performing the procedure, you can cancel it at any time by keeping the **n** and **t** keys pressed simultaneously for 4 seconds.
- Otherwise, do not press any key and wait 60 seconds for the motor to perform 6 movements.
- If you use a sensor equipped with a “trimmer”, you must read the sensor instructions and adjust the threshold directly on the sensor.

Juralco Felicia Awning System - Measuring

Measuring Face Fix

This Table for Low and Medium Wind Zones
For High Wind Zones please consult Juralco

Applies to Face Fix only

Projection	Widths, Up to								
	2000	2500	3000	3500	4000	4500	5000	5500	5920
1500	✓	✓	✓	✓	✓	✓	✓	✓	✓
2000	NA	✓	✓	✓	✓	✓	✓	✓	✓
2500	NA	NA	✓	✓	✓	✓	✓	✓	✓
3000	NA	NA	NA	✓	✓	✓	✓	✓	✓
3500	NA	NA	NA	NA	✓	✓	✓	✓	✓

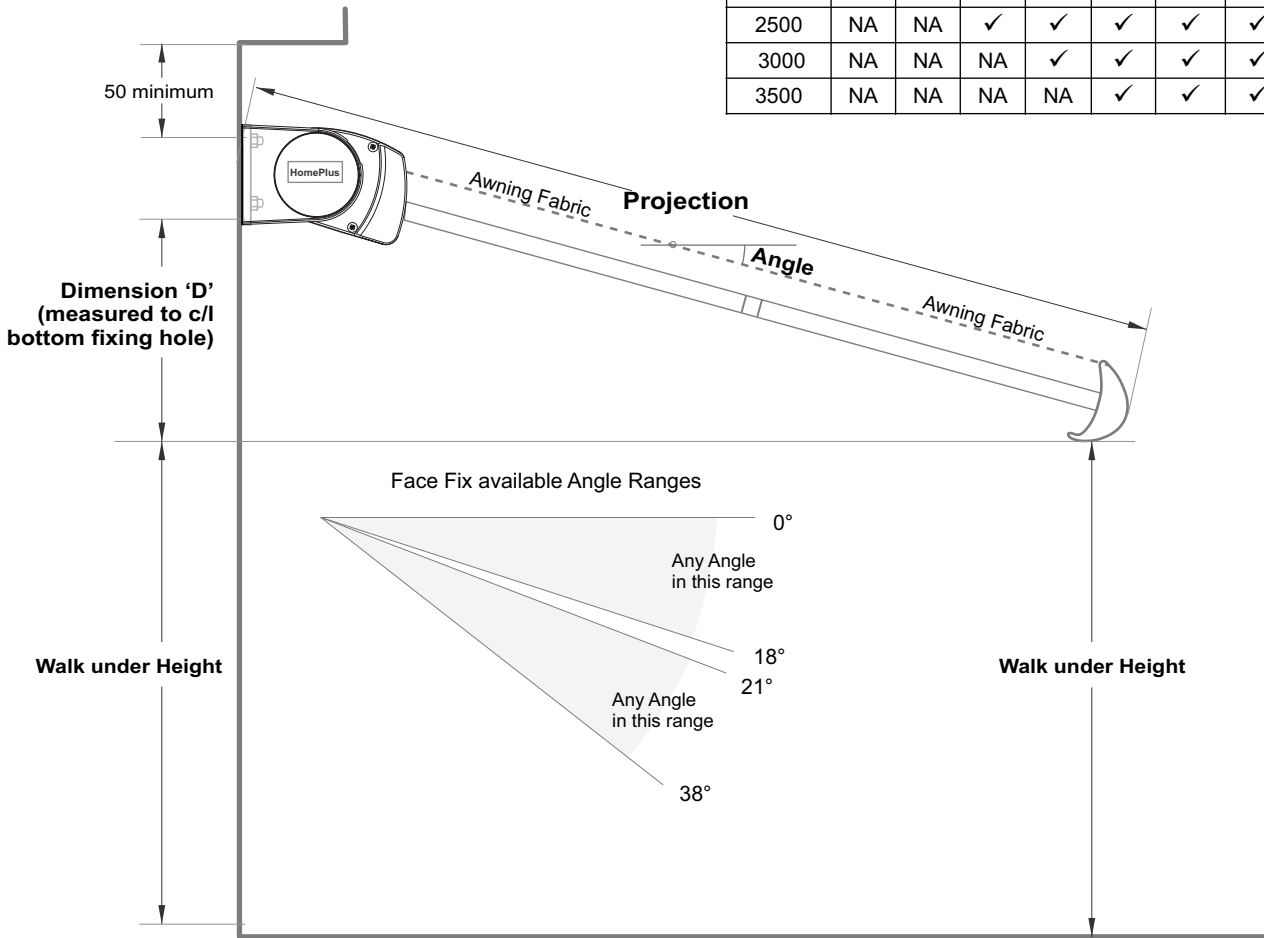

Tables giving a nominal 'D', from Projection at various angles

- 1 - Angles between 18 and 21 degrees and greater than 38degrees not obtainable
- 2 - Projections greater than 3500mm not possible

Add Walk under Height to Dimension 'D' to get total Height Floor to C/l bottom Hole

5 Degree Tilt		10 Degree Tilt		15 Degree Tilt		21 Degree Tilt		25 Degree Tilt		30 Degree Tilt		35 Degree Tilt	
Projection	'D'	Projection	'D'	Projection	'D'	Projection	'D'	Projection	'D'	Projection	'D'	Projection	'D'
1500	135	1500	260	1500	370	1500	505	1500	595	1500	695	1500	800
2000	180	2000	345	2000	500	2000	685	2000	805	2000	945	2000	1085
2500	225	2500	430	2500	630	2500	865	2500	1015	2500	1195	2500	1370
3000	270	3000	515	3000	760	3000	1045	3000	1225	3000	1445	3000	1655
3500	310	3500	600	3500	890	3500	1225	3500	1435	3500	1695	3500	1940

Approximate calculations only - Fine tune the angle to get a desired Walk under height

Minimum Awning Widths for correct Arm operation at various Projections

Projection	Width
1500	1820
2000	2310
2500	2830
3000	3330
3500	3820

Juralco Felicia Awning System - Measuring

Measuring Ceiling Fix

This Table for Low and Medium Wind Zones
For High Wind Zones please consult Juralco

Applies to Ceiling Fix only

Projection	Widths, Up to								
	2000	2500	3000	3500	4000	4500	5000	5500	5920
1500	✓	✓	✓	✓	✓	✓	✓	✓	✓
2000	NA	✓	✓	✓	✓	✓	✓	✓	✓
2500	NA	NA	✓	✓	✓	✓	✓	✓	✓
3000	NA	NA	NA	✓	✓	✓	✓	✓	✓
3500	NA	NA	NA	NA	✓	✓	✓	✓	✓

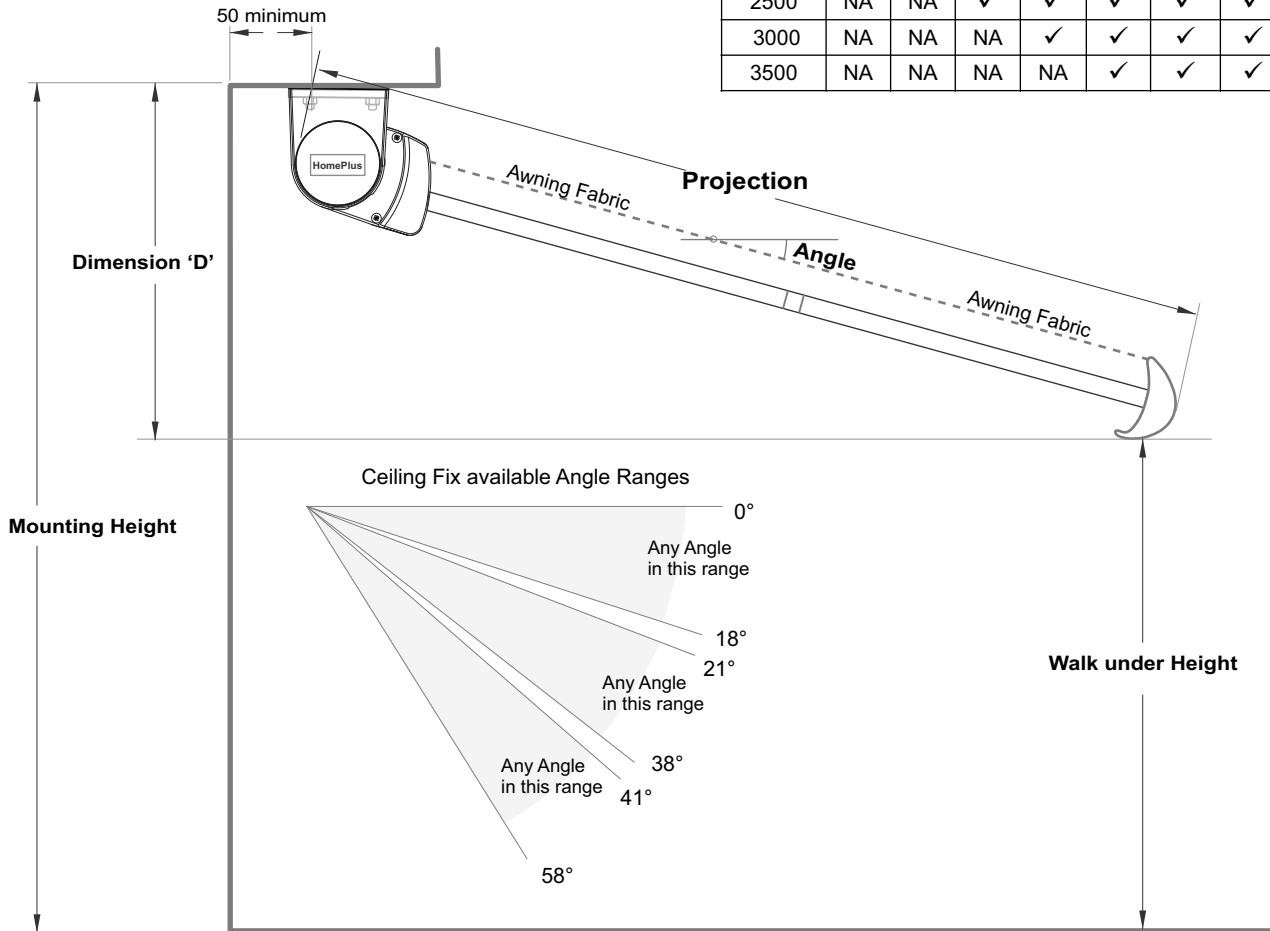

Tables giving a nominal 'D', from Projection at various angles
 1 - Angles between 18 and 21, 38 and 41 degrees and greater than 58degrees not obtainable
 2 - Projections greater than 3500mm not possible

Subtract Dimension 'D' from Mounting Height to get Walk under Height

5 Degree Tilt		10 Degree Tilt		15 Degree Tilt		21 Degree Tilt		25 Degree Tilt		30 Degree Tilt		35 Degree Tilt	
Projection	'D'	Projection	'D'	Projection	'D'	Projection	'D'	Projection	'D'	Projection	'D'	Projection	'D'
1500	300	1500	425	1500	535	1500	670	1500	760	1500	860	1500	965
2000	345	2000	510	2000	665	2000	850	2000	970	2000	1110	2000	1250
2500	390	2500	595	2500	795	2500	1030	2500	1180	2500	1360	2500	1535
3000	270	3000	680	3000	925	3000	1210	3000	1390	3000	1610	3000	1820
3500	475	3500	765	3500	1055	3500	1390	3500	1600	3500	1860	3500	2105

Approximate calculations only - Fine tune the angle to get a desired Walk under height

Minimum Awning Widths for correct Arm operation at various Projections

Projection	Width
1500	1820
2000	2310
2500	2830
3000	3330
3500	3820

Juralco Felicia Awning System - Installation

Tools

Tools Needed.

- Stepladder
- Drill, extension cable
- Screwdrivers
- Selection of SS screws
- Tape measure
- Levels
- Soft Hammer
- Allen keys 6mm
- Open ended spanners
13mm, 17mm, 19mm

Contents, Awning Package

Awning Roll, Head Box,
Arms, and Front Profile.
Manual gearbox or inline motor

Fixing Brackets
1 x LH + RH set

Options

- Fixing plates x 2
- Handle for manual gear box operation
- Motor controls, switched or remote.
- Remote controls

Site Setouts

- Notes - Mark out the fixing bracket mounting holes on the wall or ceiling
- Observe the clearances as below
 - Check for Manual gearbox operation at steep angles
 - There must be a PVC layer between the base plate Steel/Concrete structures
 - All fixings must be SS

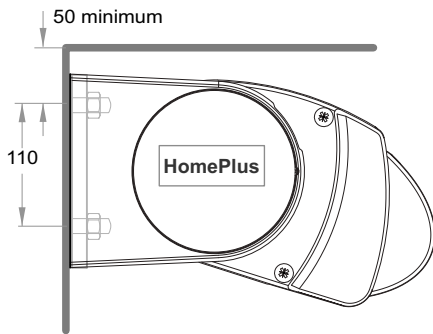

Face Mount - No Fixing Plate

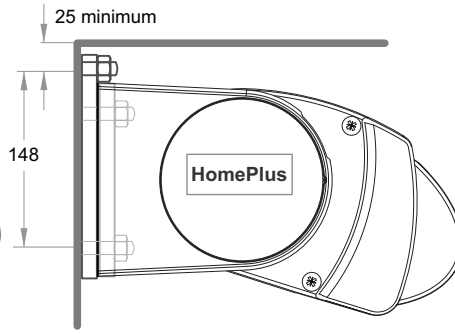

Face Mount - Including Fixing Plate

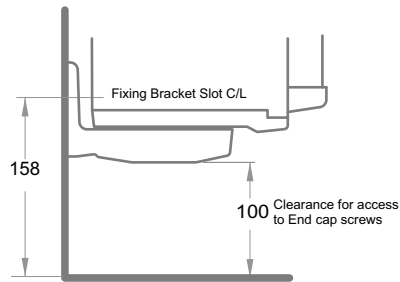

End Clearances - Wall or Ceiling

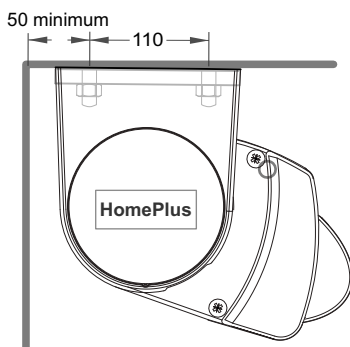
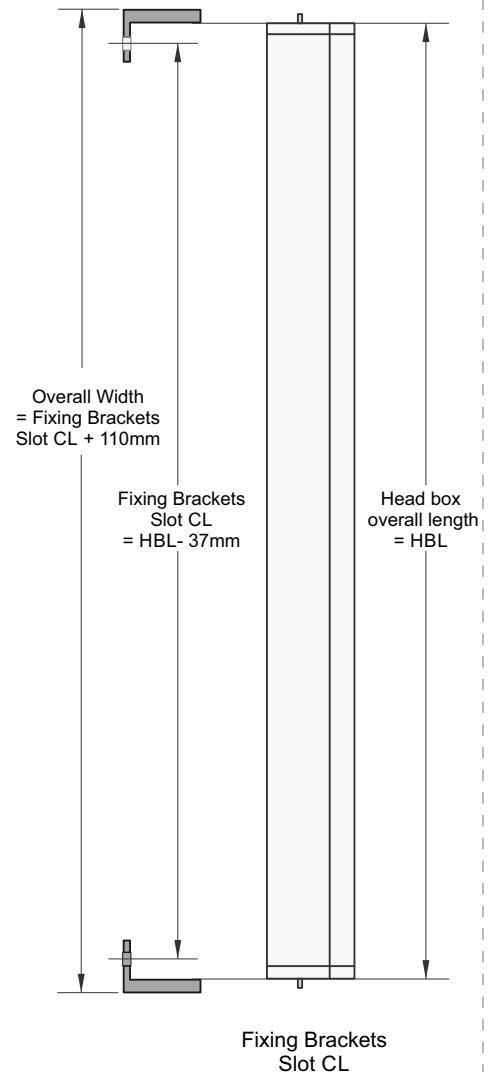

Ceiling Mount - No Fixing Plate

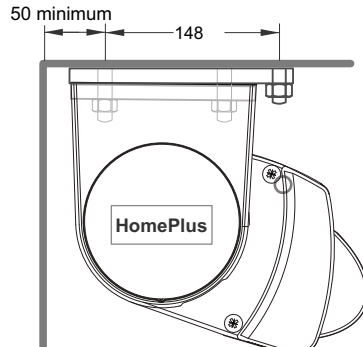

Ceiling Mount - Including Fixing Plate

Juralco Felicia Awning System - Installation

Stud Setout

Recommended Hole Sizes.

- Wood - For M12 SS coach screws - 8 - 9mm hole
- Concrete, Brick - For M12SS Studs - 12.5mm Hole

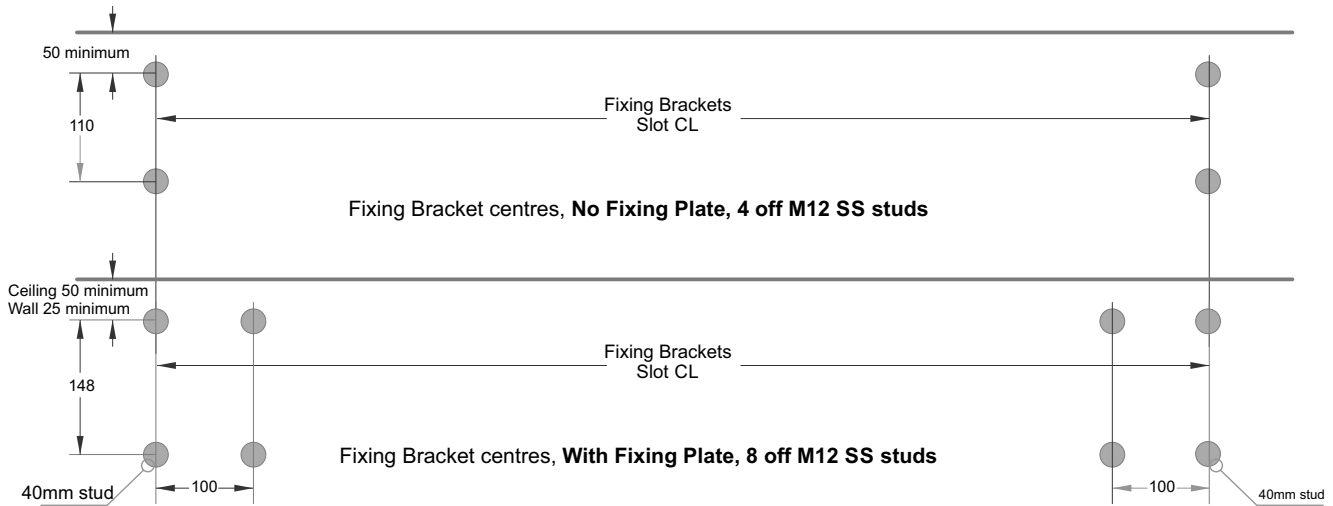

Attach Fixing Bracket

Note: Prior to delivering to site, unpack and check all items

At the time of installation you will need to consider the variety of supports (wood, brick, concrete), the amount of preparation work required, as well as choosing the correct fixing for that particular support. Ask your supplier for advice if needed.

- Wood - Use M12 x 80/100mm SS coach screws, into a heavy wooden member.
- Brick - Only use chemical fixings & M12 SS studs. Use enough to at least cross over two Cavities (= minimum 120mm)
- Concrete - Only use chemical fixings & M12 SS studs. Depth minimum 150mm
- Apply the correct quantity of chemical as recommended by the manufacturer.
- Let the chemical full cure to the manufacturers recommendations.

Fixing Plates must be used on Awnings greater than 4.7m wide or 3.0m projection

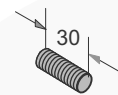

M12 SS stud, projection for fixing directly to the Fixing Bracket

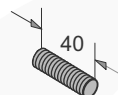

M12 SS stud, projection for fixing directly to the Fixing Bracket + Fixing Plate

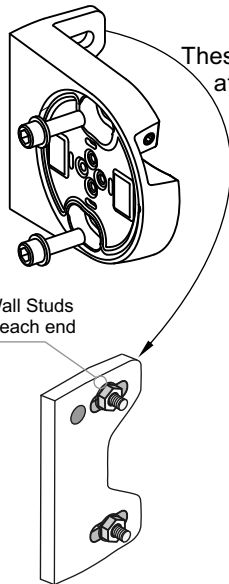

These Views showing Fastening area at rear side of the Fixing Bracket

M12 Wall Studs x 2 off each end

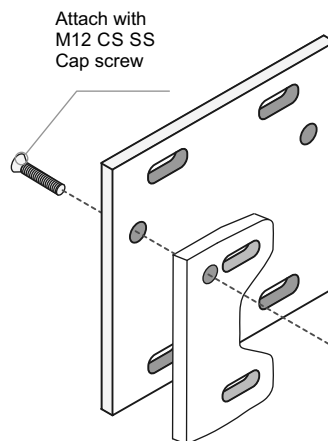

Attach with M12 CS SS Cap screw

M12 SS Washer and nut

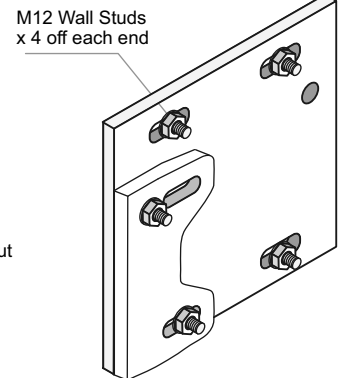

M12 Wall Studs x 4 off each end

No Fixing Plate
Attach Fixing Bracket directly to Wall/Ceiling surface.
For smaller Awnings on Firm Surfaces

Step 1 - attach Fixing Plate to Fixing Bracket

Fixing Plates.
For awnings greater than 4.7m wide or 3.0m projection
And Smaller Awnings on less than firm surfaces

Step 2 - attach Fixing Plate /Fixing Bracket to mounting surface

Juralco Felicia Awning System - Under Soffit Installation

Soffit Fixing Bracket
Part No JFA/SFBRKT

Option 1

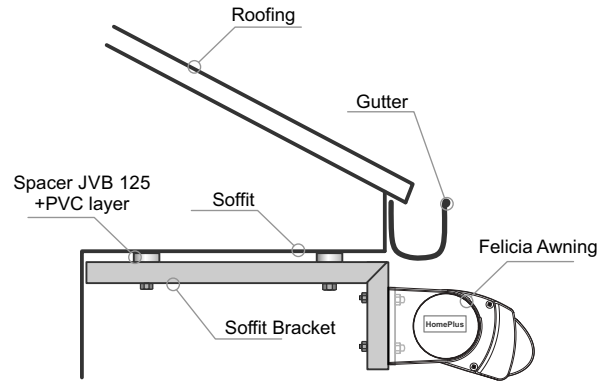
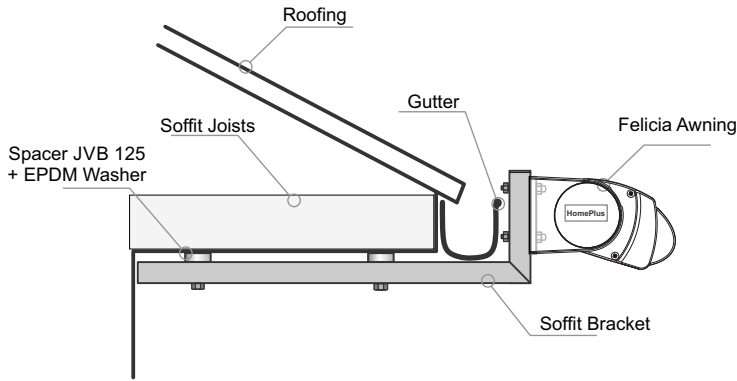

Soffit Fixing Bracket
JFA/SFBRKT

Option 2 - Soffit Rail

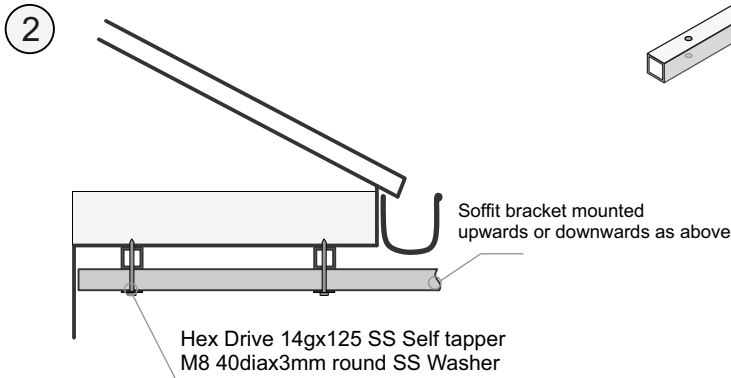
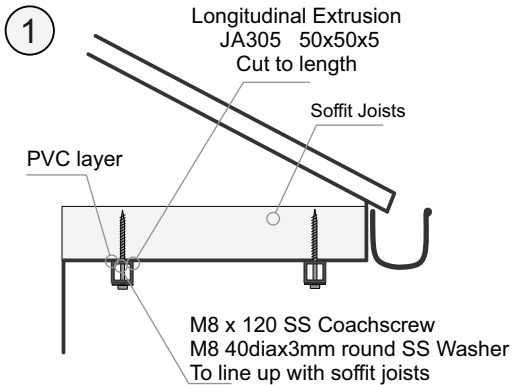

Soffit bracket mounted upwards or downwards as above
Twin Holes 10dia through, at 40crs CL to match 50sq installed, below

Holes 10dia through To line up with Joists in Soffit

Twin holes through, for 14g self tappers To line up with Soffit Bracket

Longitudinal Extrusion JA305 50x50x5 Cut to length

Note:
There must be 1 x Joist fixing on the outside of the Soffit Fixing Brackets

Soffit Fixing Bracket
JFA/SFBRKT

To be ordered ex factory individually

- Manufactured ex 100mm x 50mm x 3mm (JA314/5.8).
Kit includes 1 x Bracket and 2 x End Caps
- Installer to cut down to size to suit
 - Installer to drill own holes to suit
 - Installer to RTV End Caps in place
 - Installer to supply own Bolts/Coachscrews and JVB125 spacers if required.

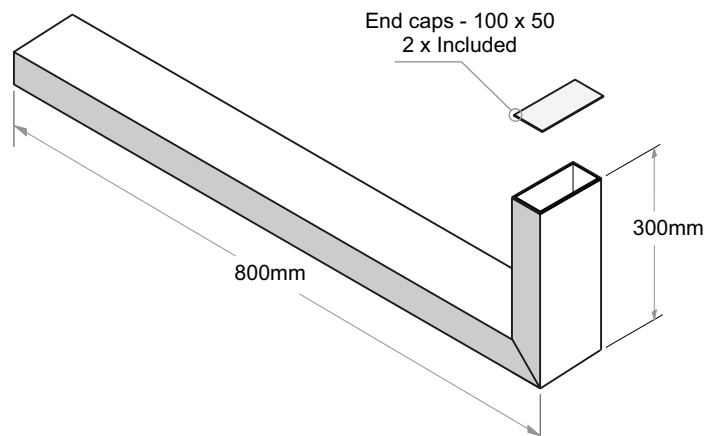

JURALCO

www.juralco.co.nz ph (09) 478 8018

Juralco Felicia Awning System

Issue 1-24 v1
Page 14

Juralco Felicia Awning System - Installation

Lift Awning to Fixing Brackets

- Loosen one bracket a little and slide along to give a say 4-5mm gap, to make the headbox install easier.
- Carefully present the Headbox/End caps to the Fixed Brackets
- Slide/ drop Headbox into place
- Slide the loosened bracket back to neatly against the Headbox end cap.
- Tighten all M12 fastenings

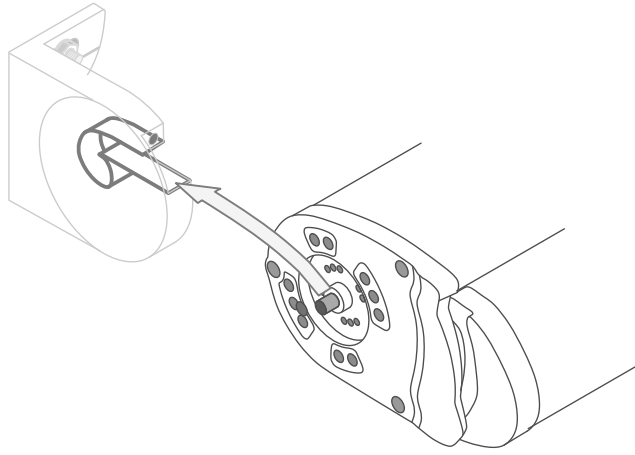

Angle Selection, Adjustment

- Select the appropriate threaded holes for the angle range desired
- Insert M12 capscrew and washers
- Nip bottom screw up tight at angle
- Use the adjusting screw to fine tune squareness and level, then tighten top screw
- Clip plastic covers in place
- Check for smoothness of operation.

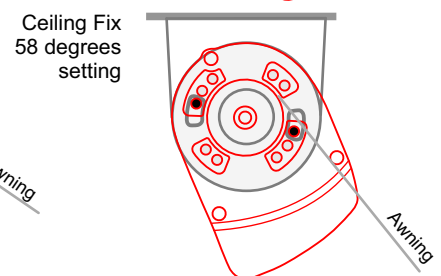
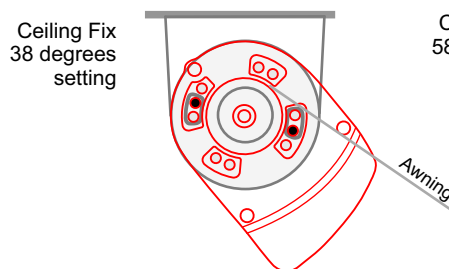
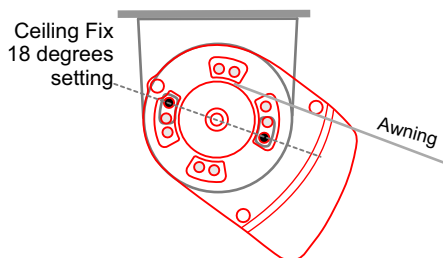
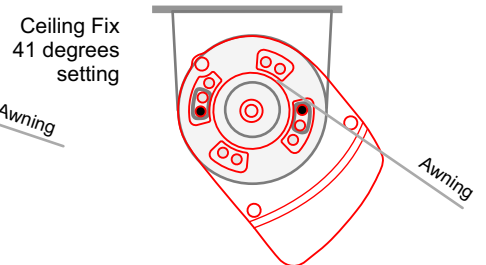
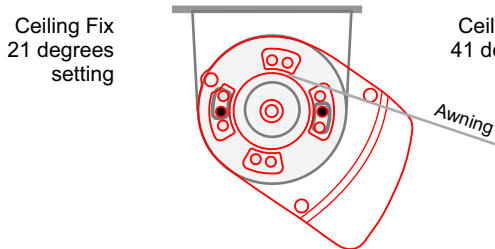
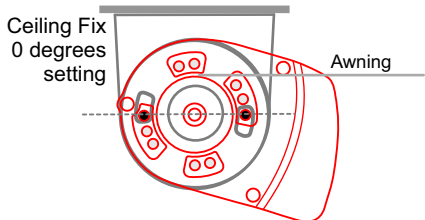
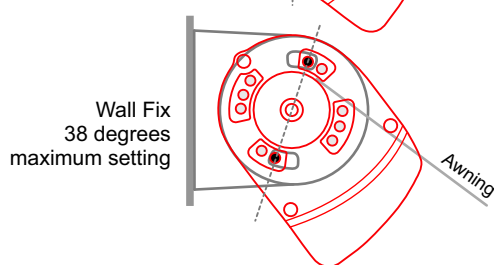
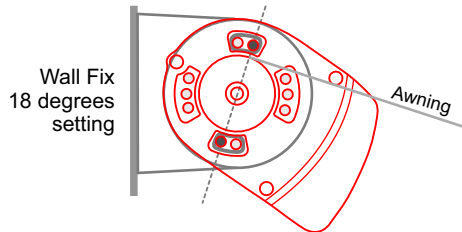
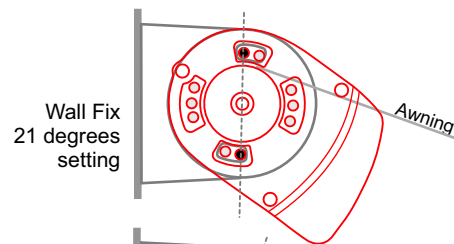
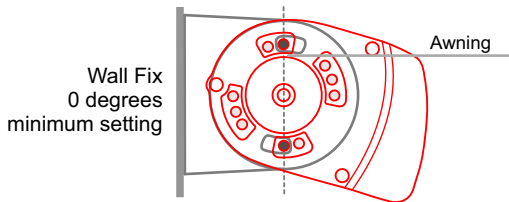
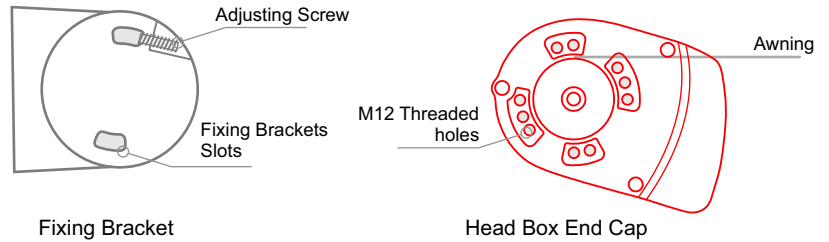

FELICIA

Awning System - Order Form

AW #

Customer

Contact

Order No

Date

WO Juralco**SO** Juralco**\$** Juralco**Select/Enter Dimensions below. Enter details/selections into all boxes. Then scan and send to sales@juralco.co.nz****1****Unsuitable for use in Strong Wind Areas**

Select Projection then enter desired Overall Width dimension

Available Projections	Select Projection	Widths Minimum	Enter Overall Width
1500		1820	
2000		2310	
2500		2830	
3000		3330	
3500		3820	

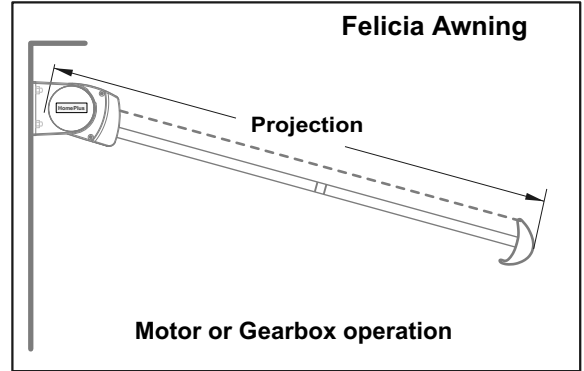
Width Maximums = All 5900mmNote: Fixing Plates must be used on Awnings greater than 4.5mt wide or 3.0mt projection(supplied) or on awnings with less than firm mountings**2**

Select Powder Coat Type and Colour

Specify PC Colour and Code

Note: Arms Silver finish only

3

Select Fabric Type and Colour

Specify Fabric Colour and Code

4

Valence, if needed

5

Select Gear Box or Motor

6

Select Motor or Gearbox End, viewed from Front

7

Extended Soffit Fixing Brackets. Number, if required

8

Fixing Plates. Number if required (Auto for Large Awnings)

If Gearbox selected, Handle length**If Motor + Remote selected, these options apply****9**

10

Volo Wind sensor?

11

NemoVibe sensor?

12

Additional Motor Remote Control? BIDI/Awning + Portable controller. Tick to select

13

Notes:

Juralco Felicia Awning System - Building Consents

These two pages are an extract from the Department of Building and Housing

- Building Work that does not require a Building consent - pages 21 to 24. Online at www.dbh.govt.nz/bc-no-consent
- These are new exemptions dated Dec 2010

While every effort has been made to ensure that this information is correct at time of writing, it is provided for guidance only and Juralco will accept no liability for, nor warrants the accuracy of this guidance. It is the sole responsibility of the of the purchaser to confirm current status of consent requirements with the relevant territorial authority before purchase and installation.

Awnings

Awnings.

Exemption (ja) of Schedule 1

A building consent is not required for the following building work:

- (ja) the construction, alteration, or removal of any fabric, glass, or metal awning on any building that-
 - (i) is on the ground or first storey level; and
 - (ii) does not exceed 20 square metres in size.

Guidance:

Awnings are usually coverings that are fabric, glass or metal. They are normally attached to the exterior of a building and are commonly used for protection from sun, rain or as a wind buffer (eg, a shadesail or window awning). The installation of awnings that are 20 square metres or less on any building at a ground floor or first floor level will comply with this exemption.

Size is a factor for large awnings, as they can damage the walls they are attached to or adjacent property or potentially injure people in high winds. Accordingly, any awnings larger than 20 square metres require a building consent.

This exemption relates to awnings which are currently attached or are to be attached to a building's external envelope or exterior surfaces.

Awnings may be removed, altered and constructed, providing this work complies with the Building Code. Particular emphasis should be placed on weather tightness detailing when removing, altering and constructing such structures. All mechanical connections (eg, nuts, bolts, coach screws etc) which penetrate the building envelope and provide support to awnings must provide adequate resistance to moisture getting into the structure. Please note, this exemption does not relieve the owner of any other requirements under the Resource Management Act 1991 and or local district plan rules and provisions.

Examples where this exemption could apply:

A shadesail is to be attached above a deck at first floor level of a dwelling. The proposed shadesail has a total area of 18 square metres, and meets all Building Code requirements.

The removal of an existing 12 square metres awning providing shade at the entry to a building (situated at first floor level).

Examples where building consent is required:

A glass awning is to be fitted to an apartment on the sixth floor of the building. Though the awning has a total coverage of 14 square metres, it is not exempt because of its height above ground and a building consent is required.

Territorial Authority discretionary exemptions

Territorial authority discretionary exemptions

Exemption (k) of Schedule 1

A building consent is not required for the following building work:

- (k) any other building work in respect of which the territorial authority (or, as the case requires, the regional authority) considers that a building consent is not necessary for the purposes of this Act because that building work-
 - (i) is unlikely to be carried out otherwise than in accordance with the building code; or
 - (ii) if carried out otherwise than in accordance with the building code, is unlikely to endanger people or any building, whether on the same land or on other property.

Guidance:

Exemption (k) allows a discretionary decision to be made by a territorial authority (city or district council) or regional authority (regional council) to exempt proposed building work from the requirement to obtain a building consent in the circumstances specified in (i) and (ii), above.

Members of the public may ask their local council to consider their proposed building work under this exemption. However, the decision to allow any exemption under this part of Schedule 1 is totally at the council's discretion, based on the risk of building work not complying with the Building Code or endangering people or property.

Local councils should have procedures for making formal decisions under exemption (k) to exempt building work, that meet the specific criteria of (i) and (ii) above, from the requirement to obtain a building consent.

In all cases, the Department recommends that the decision, reason for the decision and the outcome of the decision be recorded by the local council and placed on the property file that relates to the building work.

Juralco Felicia Awning System - Powder Coating Care and Maintenance

Powder Coating Installation Care

Warning re use of solvents:

- In some cases strong solvents are recommended for thinning various types of paints and also for cleaning up mastics and sealants.
- These can be harmful to the extended life of the powder coated surface, and must not be used for cleaning purposes.
- It is important to note that the damage will not be visible immediately and may take up to 12 months to develop.

If paint splashes or sealants and mastics need to be removed then the following may be safely used:
Methylated Spirits, Ethyl Alcohol, Isopropanol or preferably a mild detergent in warm water.

Joinery Protection during Installation:

All the activity on a construction site means that your powder coated items may get knocked or scratched, splattered with mortar, plaster, textured coating or paint during the later stages of construction.

Please ensure that all powder coated articles are masked or covered at this time. It is far easier to prevent accidents than to try and correct them. Should your joinery receive mortar or paint splashes see that these are removed before cure and follow the instructions contained in this brochure.

Typical sticker used to warn other trades of the need to protect and mask off powder coated joinery (applies to anodised joinery also)

"IMPORTANT ALL TRADES"
This valuable aluminium joinery will suffer permanent damage from: plaster, mortar and paint splashes - Protect if splashes occur - Immediately wash down joinery with water or meths - Do not allow splashes to harden! - Do not use solvents! - Do not remove this label until final clean completed.

This photograph display damage that has occurred on site, post installation. The photo of the masked joinery displays clear signs of damage that could have occurred were it not masked. Please ensure that your joinery is protected right through the entire construction process.



Powder Coating Maintenance

External - Maintenance Program:

To extend the life of external powder coated articles and to comply with warranty requirements for powder coated aluminium joinery, a simple, regular maintenance program must be implemented.

The effects of ultra violet light, atmospheric pollution, dirt, grime and airborne salt deposits will all accumulate over time and must be removed or surface staining and weathering will occur, leading to an unsightly appearance.

For external coatings, cleaning should take place every six months. In areas where pollutants are more prevalent, such as beachfront houses and industrial or geothermal areas, then a cleaning program should be carried out on a more frequent basis ie. every one to three months.

Cleaning your powder coating:

1. Carefully remove any loose surface deposits with a wet sponge.
2. Use a soft brush (non abrasive) and a mild household detergent (do not use solvents) in warm water, remove dust, salt and other deposits.
3. Rinse off with clean fresh water.



Restoring weathered or scratched surfaces:

Repair of Scuffed or Scratched surfaces
Dulux Spray Cans are available in all colour card colours.

Repair of Small Scratches or Chips.
Dulux Dabsticks are ideally suited for the repair of small scratches.
Dabsticks may not be available in all colour card colours.

Repair of Weathered areas .
Dulux Gloss Up is a light to medium cutting cream ideally suited for gloss restoration and has been specifically designed for this purpose.
Gloss Up contains no waxes or silicone and is a one step system.



Contact Dulux Powder Coatings , ph 0064 9 441 8244

All pages © Copyright Juralco Aluminium Building Products Ltd, 2023



JURALCO

www.juralco.co.nz ph (09) 478 8018

Juralco Felicia Awning System

Issue 1-24 v1
Page 18