

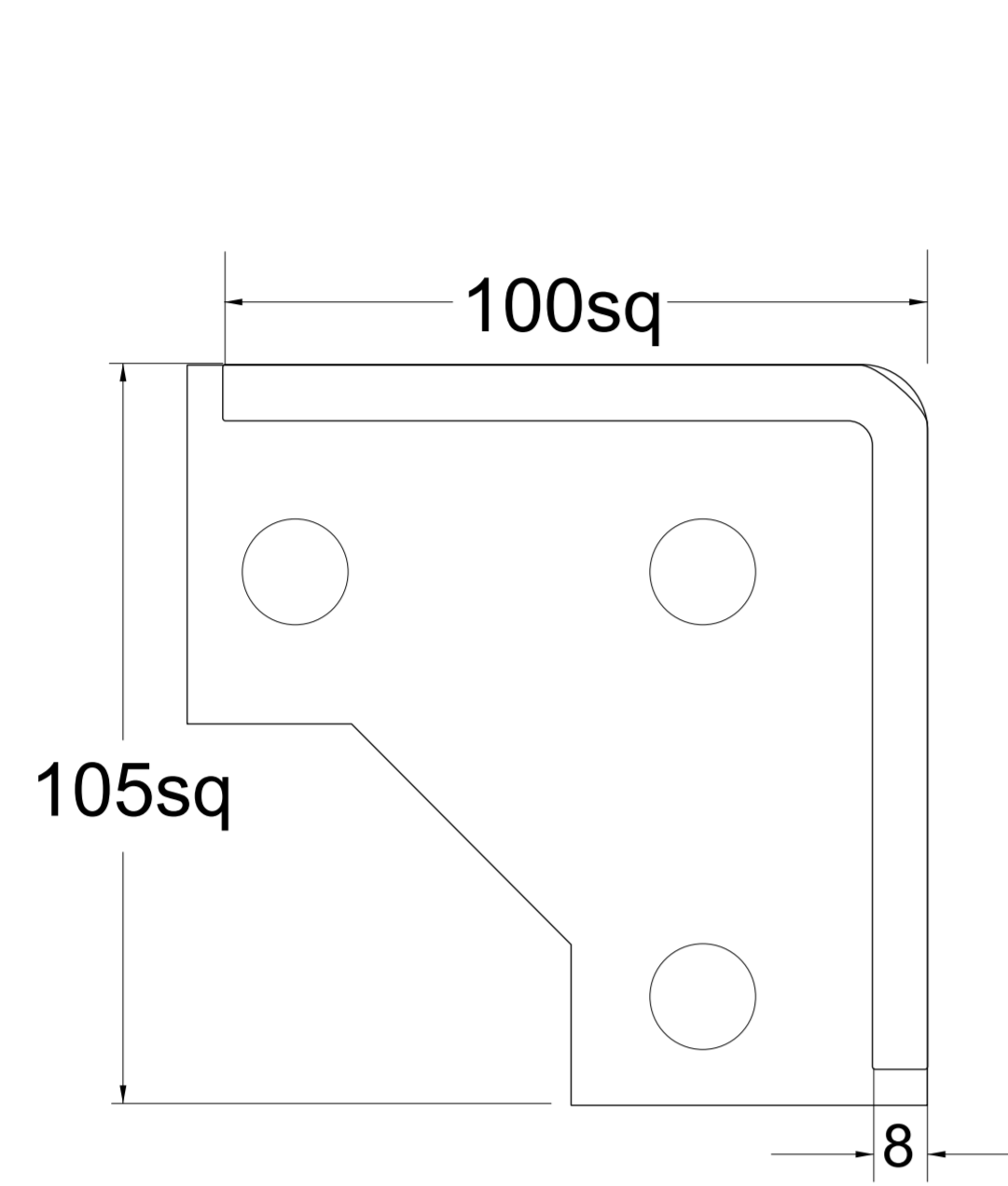

HomePlus® Outdoor Living System

Post attach to Concrete

Important Note - These Concrete foundations conform to NZS 1170 Appendix D, and can be used as per the specifications below.
Please refer to the HomePlus Outdoor Living System/ Manual/Structural /Configurations/Areas/Wind Zones for guidance on Forces the structure will have to withstand.



Post, Std Base Bracket
Steel, Hot Dip Galvanised

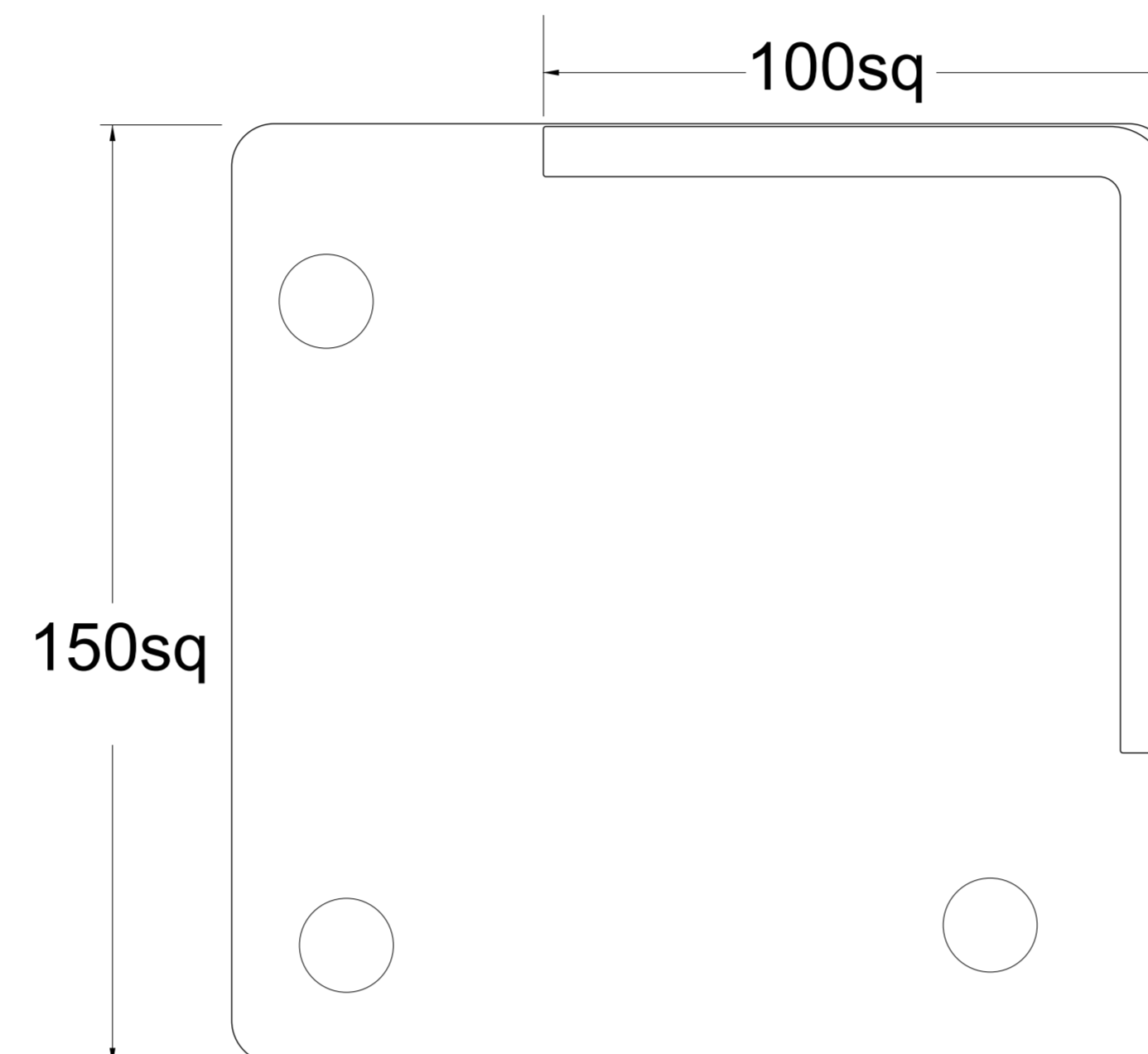

Post, Large Base Bracket
Steel, Hot Dip Galvanised

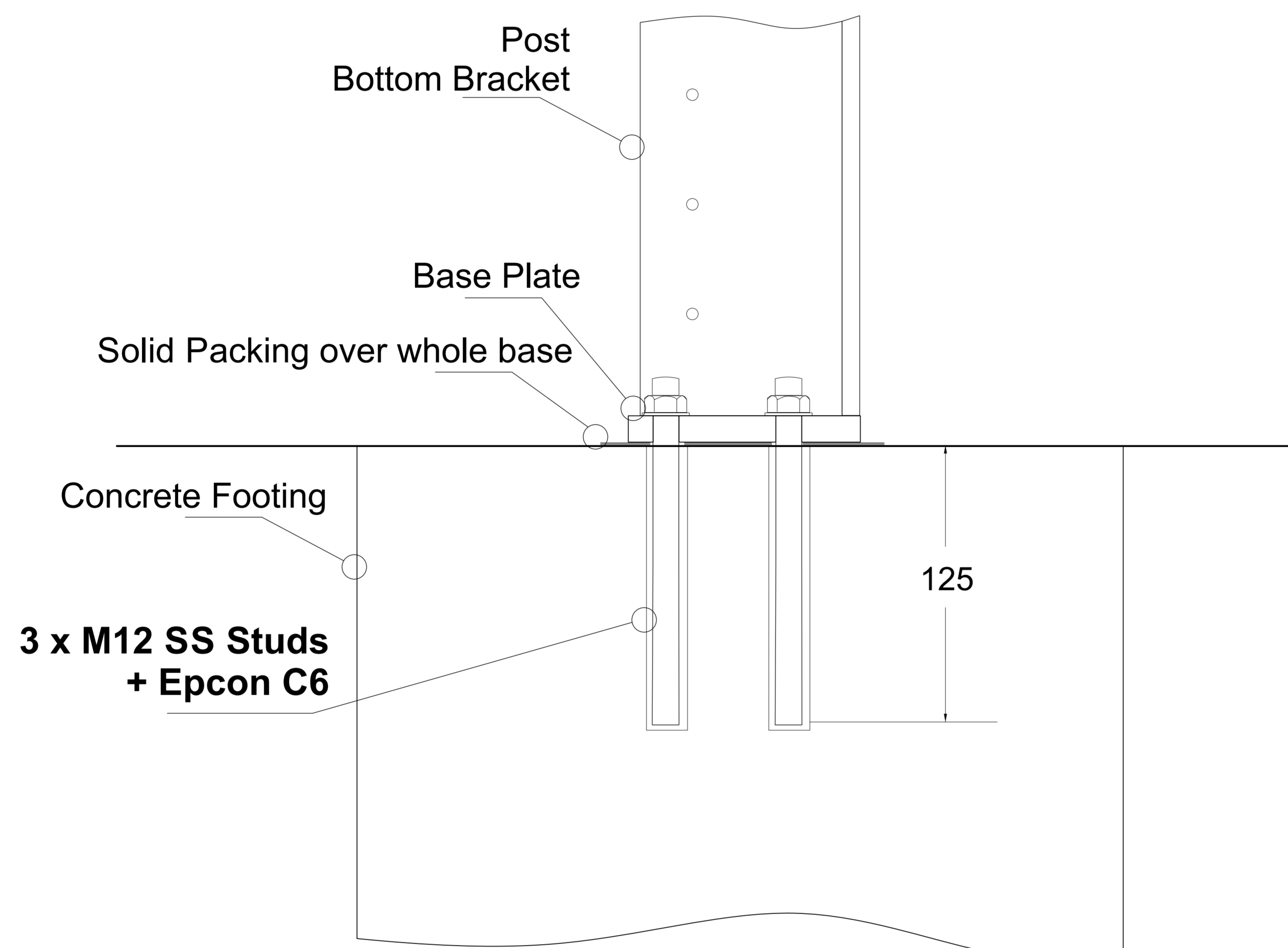

Typical Mounting to Concrete Footing or Concrete Slab

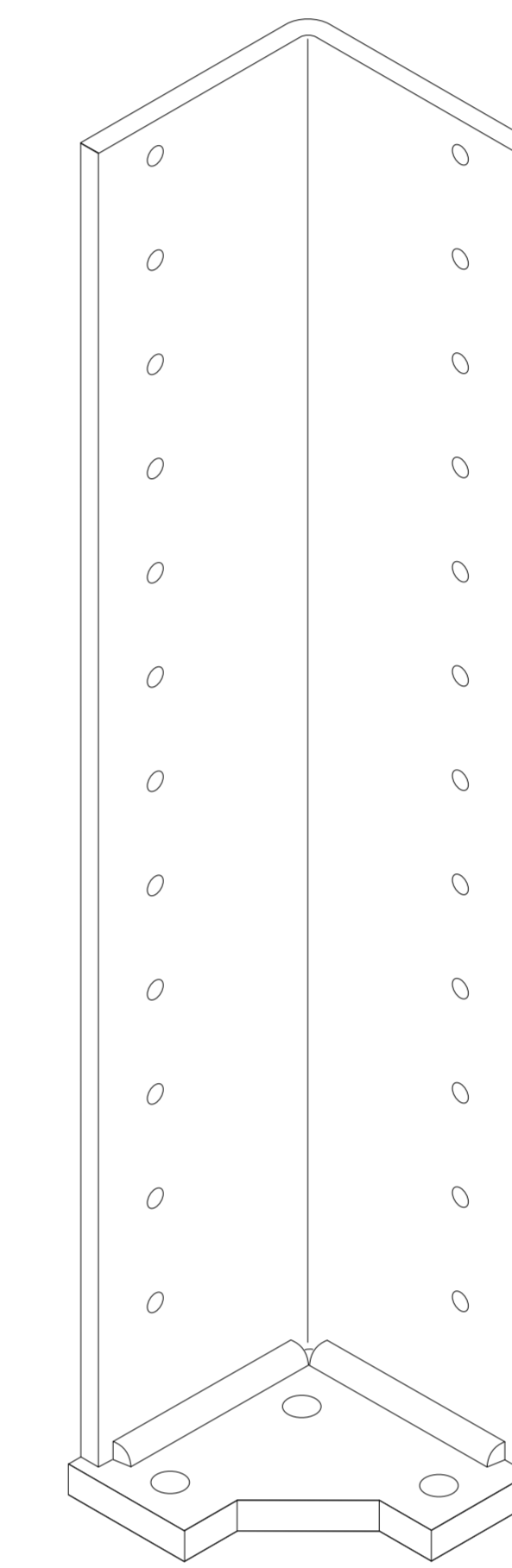

POST
BOTTOM BRACKET
Part No JOR 702

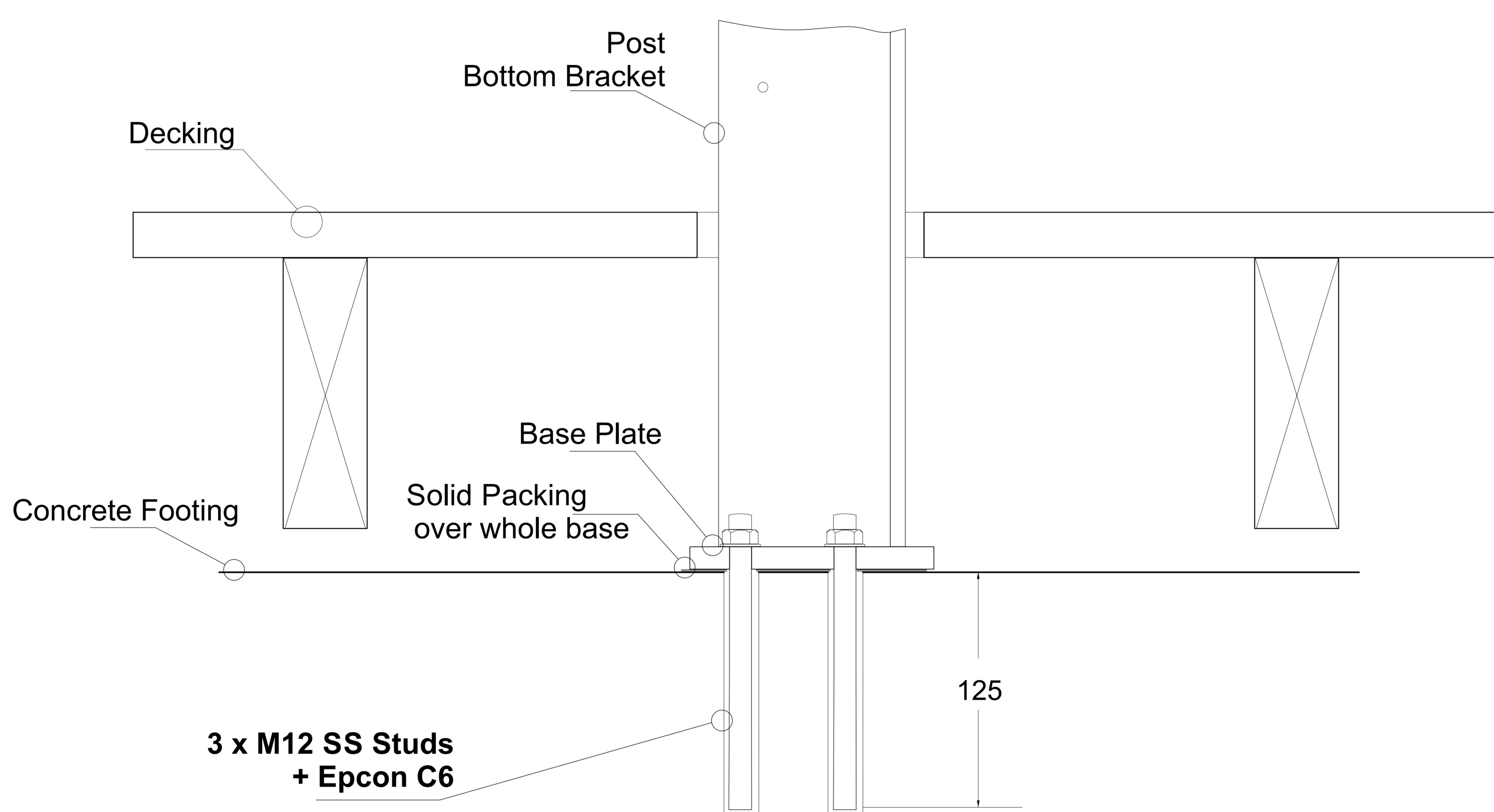

Typical Mounting to Concrete Footing through a Timber Deck, using extra long Corner Post Bracket

500 std,
longer lengths
available
to order

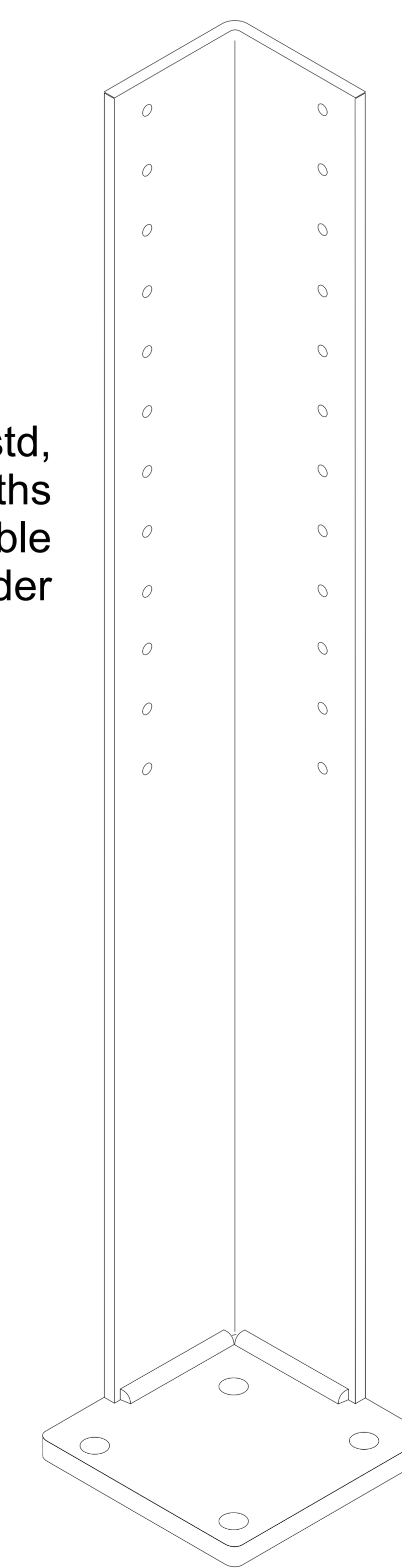

POST
BOTTOM BRACKET,
WIDE BASE,HIGH
Part No JOR 706

Important Installation notes:

- 1 - A Design engineer must ensure the structure can support the appropriate loads
- 2 - All fixings must engage into the structural slab
- 3 - A Rubber, EPDM or Foam Tape layer must be installed between the Base plate and Concrete
- 4 - All fixings must be Stainless steel