

Juralco Bask® Outdoor Living System - Structural - Integrated Installation Attach

Notes:

- 1 - Only applicable to Integrated Structure. Refer to Bask Manual

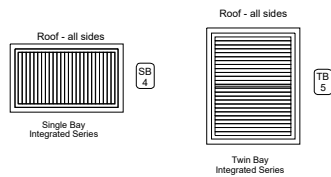

Important Note:

Juralco can only guarantee the suitability of the initial connection. In this case the 14g screws attaching the JOR507 Wall Beam to the Structure. All subsequent connections and strengthening to a structure are the clear responsibility of the builder/ installer. Any other specifications on this page are general suggestions only. Please refer to the Juralco Bask Manual/Structural/Configurations/Areas /Wind Zones for guidance on Forces the structure will have to withstand.

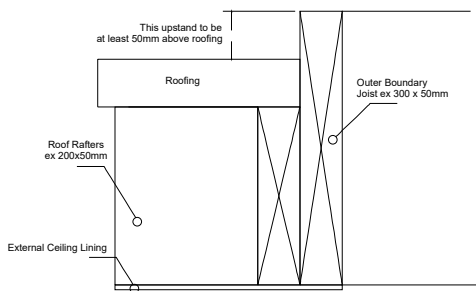

Typical Integrated Roof Construction. Boundary joists all very firmly attached to Roof rafters. Engineer to check structure

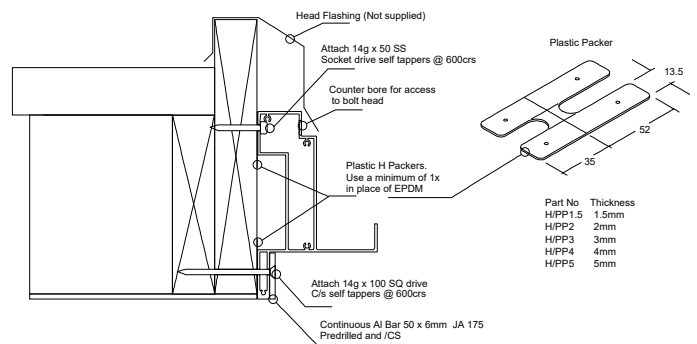

Important Installation Notes:

- 1 - A Design engineer must ensure the building structure can support the appropriate wind loading
- 2 - Coachcrews 90mm min thread engagement into joists
- 3 - Bond all Coachscrews with SIKA Supergrip to full depth
- 4 - An EPDM, Rubber or Foam Tape layer must be installed between the JOR 507 and Timber
- 5 - All fixings must be Stainless Steel