



JURALCO INTERCEPT® ROLLERSHUTTER SYSTEM

ISSUE 5-24 v1

Juralco Aluminium Building Products Ltd designs and distributes specialist aluminium joinery systems through a national network of franchised fabricators and agents. For more than 25 years we have been at the forefront of specialist aluminium door and window products suitable for New Zealand joinery and building methods. Our comprehensive product range includes security and insect screens, balustrades and gates, shutters and awnings, shower screens, wardrobe doors and organisers and internal doors.

Intercept® Roller Shutters are constructed from heavy-duty aluminium profiles which roll down to protect windows and doors. Strong inter-locking profiles and deep side channels resist forced entry by intruders, reduce noise levels by up to 50% and offer storm protection. They are also especially suitable for smaller commercial, marine and cabinet applications. All Intercept roller shutters are available either in a manual spring balanced operation or with high quality tubular motors and are custom-made to size in a variety of powder-coat finishes.



General Description

- The Rollershutter system is designed to fit small to mid sized openings up to 3.5mt wide and up to 3.25mt high.
- Typical applications include Security, Marine Hatches, Display Cabinets, Bars and Serverys and Lockable storage areas.
- Curtain finishes - Powdercoat
- The door is supplied pre assembled, consisting of a Curtain package and two side guides.
- **Headbox** - A folded galvanised headbox in 5 x sizes, available in a range of powdercoat colors
Easily removed Front cover to provide access for installation or maintenance.
- **Axle Assembly** - 60mm or 70mm Octagonal steel axle, depending on curtain weight. Mounting brackets and axle holders.
- **Rollershutter curtain** - Four styles available - see below and next page.
- **Drive - Manual** - A torsion spring fitted inside the axle assists the operator to raise/lower the curtain.
It is fitted and pre-tensioned before delivery.
- **Drive - Motorised** - A torsion spring fitted inside the axle plus an inline tubular motor raise/lower the curtain automatically.
The motor is wired to a 3 position switch (up-off-down) supplied. Remote wireless controls available.
- **Side Guides** - A 58mm x 22mm extruded aluminium side guide for shutters up to 2mt wide . A 72mm x 22mm for shutters over 2mt wide. These run full height on both sides.
- **Bottom Rail** - An 50mm extruded bottom rail with detachable back plate.
A keyed locking system fits within this rail which can be incorporated at the bottom of the curtain

Note - Juralco 40mm Double Wall Slat has been tested for Faceload resistance by BRANZ - see Test Report STR 343

Juralco Intercept® Rollershutter Systems

Index

Type	Pages	Description	Use the Bookmarks  List to jump to selected pages
Curtains	4	Shows the differing types of curtains	
Materials	5 - 8	Shows all Extrusions and Components	
Door	9	Shows typical Door components and layout	
Motors,Controls	10 - 12	Show Motors, wiring Diagrams,Roll weights and Switch and Wireless controls	
Order Form	13	Rollershutter Door Order Form	
Installation	14 - 15	Installation hints and cutting tables	
Powder coat	16	Instructions for the care of Powder coated surfaces	

Important information - Powder Coating systems.

Powdercoat Systems The new standard Dulux powder coating system used by Juralco is Duralloy Plus®. Also Duralloy® and Duratec®. Juralco Powder coated prices are for Duralloy Plus® and Duralloy® (same pricing). Duratec® prices on application. The following specs apply to Building Exteriors.

- Dulux Duralloy Plus® powder coating systems are suitable for properties greater than 10m from high tide level. Residential and Light commercial buildings, 3 levels max. Warranty 15 yrs
- Dulux Duratec® powder coating systems are suitable for properties greater than 10m from high tide level All Residential and Commercial buildings. Warranty 25 yrs.

Attachment to structures A PVC Tape or similar material spacer must be used to separate powder coated aluminium items from all concrete and steel structures. Failure to do so can lead to the chemicals in the structure affecting the powder coating, leading to corrosion.

Swimming Pools The chlorinated water in swimming pools can cause the deterioration of powder coated surfaces, leading to corrosion of the underlying surface. It is recommended that Powder coated surfaces be 1200mm min from a pool.

Care The Dulux powder coating warranty period is conditional upon the surface being maintained in accordance with the Dulux 'Care and Maintenance Instructions'. Download from Dulux or refer to the back page of this manual.



Juralco Intercept® Rollershutter Systems - Curtain Options

Curtain Types, Finishes

All types available in Powdercoat



25mm Curved Wall



40mm Twin Wall



40mm Twin Wall, Vented
Vent holes only show when
Curtain partly open.
All closed off when fully down.

Juralco Intercept® Rollershutter Systems - Extrusions

Curtain Bottom Extrusions

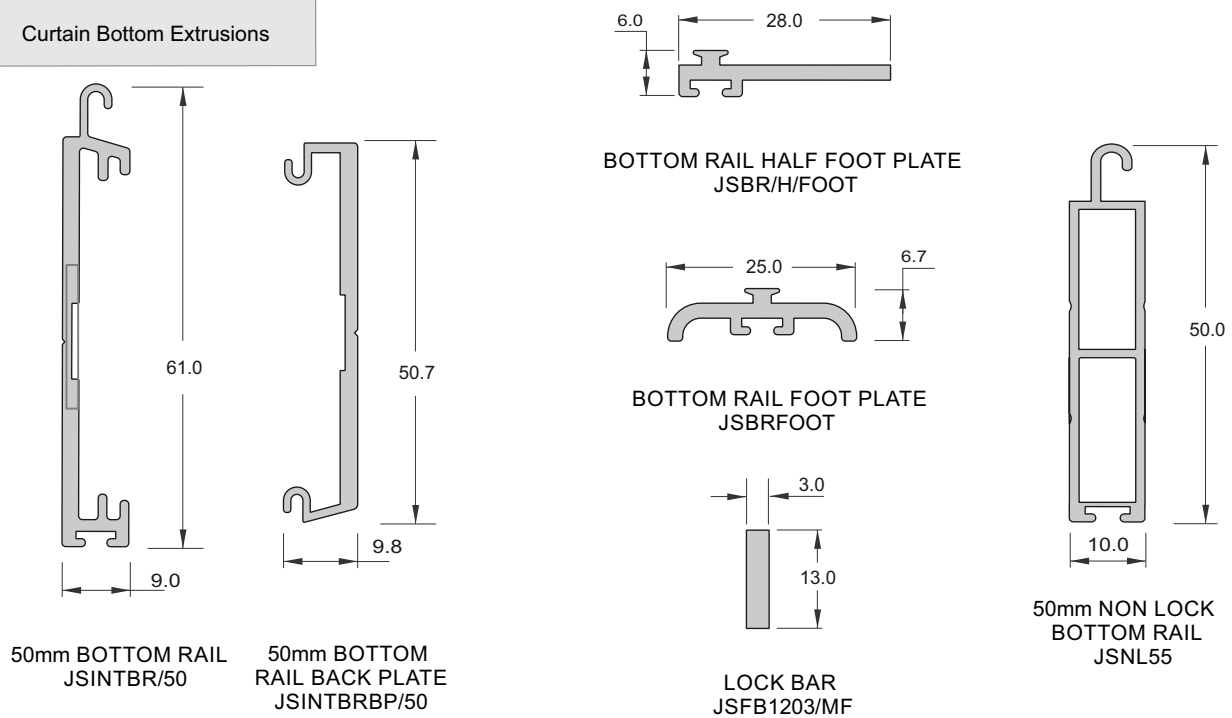

Curtain Extrusions

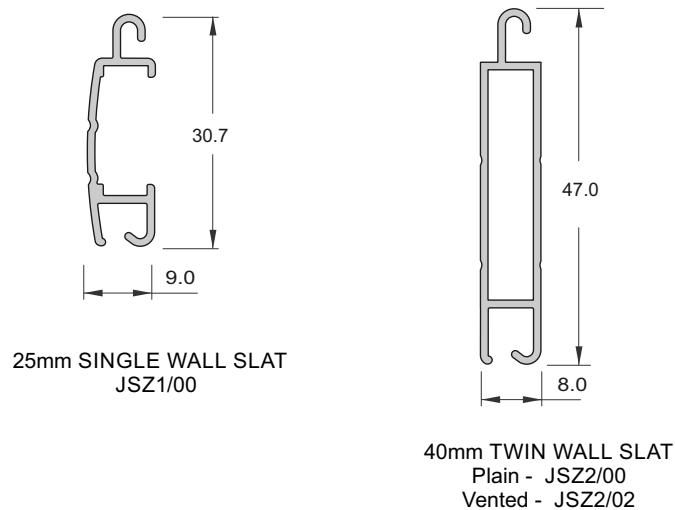

Side Guide Extrusions

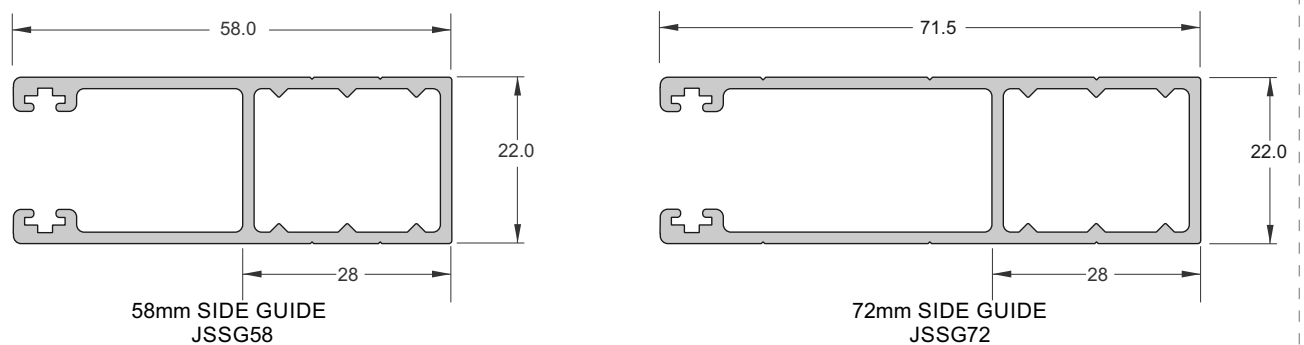

Juralco Intercept® Rollershutter Systems - Components

60mm Axle Bearing Holder
JKGL2/02

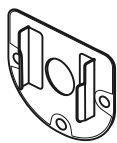

70mm Axle Bearing Holder
JSL2/06

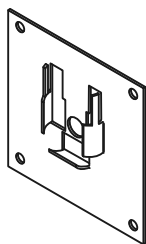

Bearing
JKG6C35802



Spring Support Brkt
JKG1003/SQ

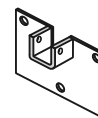

Plastic End Plugs 40mm
JSP4/40

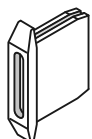

Plastic End Plugs 25mm
JSP4/45

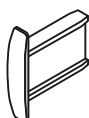

Wool Pile
JSINTMH/THICK



Entry Guide - 40mm Std
JSC3/57/WH

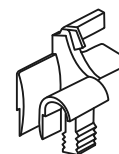

Conical Stop
JSD1/02

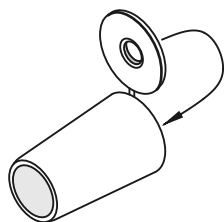

Centre Mullion,
Black Nylon
JKG1004/INTERCEPT

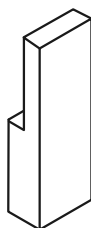

Side Guide Fixing Screw
JKG/SGSCREW.1.5

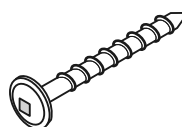

Gearbox Handle
JDA/403 0431
1200mm



D Handle
JSDHANDLE/CP

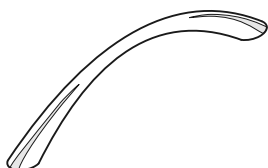

Lock
JSE3/05

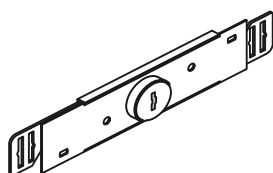

Lock Bar Support
JSBR/LBSUP

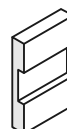

For use with 50mm Bottom Rail
Part No JS INTBR/50

Gearbox Handle
Clip
JDA/402 6500



For use with Manual
Override Motors



Motor Manual O/Ride
JNICE/MOEYE/350

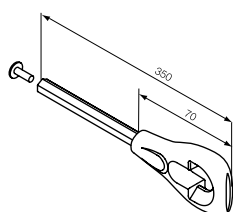

Eyebolt with 7 mm handcrank

Juralco Intercept® Rollershutter Systems - Components

Octagonal Axle 70mm
JKGV6B4470

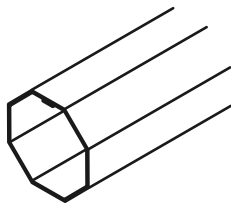

Nylon Adapter Wheel 70mm
JKGK2/06

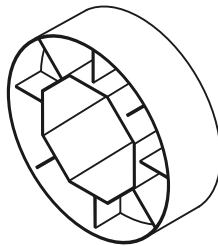

Adjustable End Cap 70mm
JKGK1/19

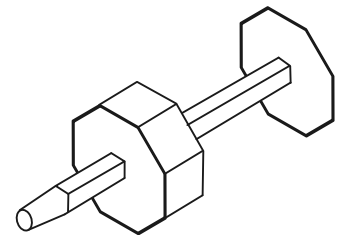

Octagonal Axle 60mm
JKG6B44260

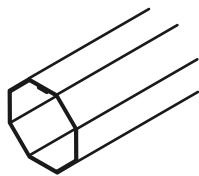

Nylon Adapter Wheel 60mm
JKGK2/02

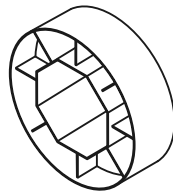

Adjustable End Cap, 60mm
JKGK1/20

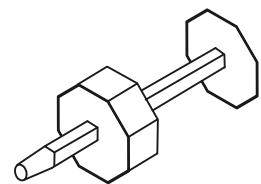

Spring End cap, 60mm
JKG756E2260

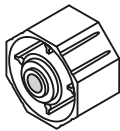

Spring Drive Wheel, 60mm
JKG756E1260



Security Spring, Felted
JSH1/170F



Spring End cap, 70mm
JKG756E2270

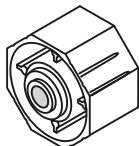

Spring Drive Wheel, 70mm
JKG756E1270

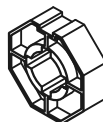

Headbox Ends (LH+RH)

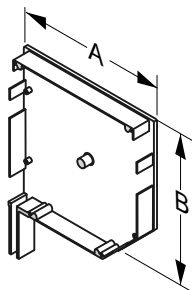

JS03/20 - 150mm
JS03/30 - 165mm
JS03/40 - 180mm
JS03/50 - 205mm
JS04/60 - 250mm
(A and B)

Headbox Pelmets

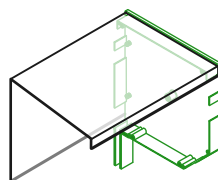

Top Pelmet
- 24g Zincalume Steel

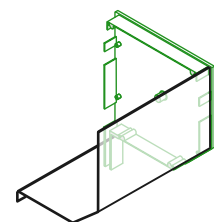

Front Pelmet
- 24g Zincalume Steel

JSHB/90/150 - 150mm
JSHB/90/165 - 165mm
JSHB/90/180 - 180mm
JSHB/90/205 - 205mm
JSHB/90/250 - 250mm

JSHB/45/150 - 150mm
JSHB/45/165 - 165mm
JSHB/45/180 - 180mm
JSHB/45/205 - 205mm
JSHB/45/250 - 250mm



Bottom Extrusions
Locking (Spring) 1:1

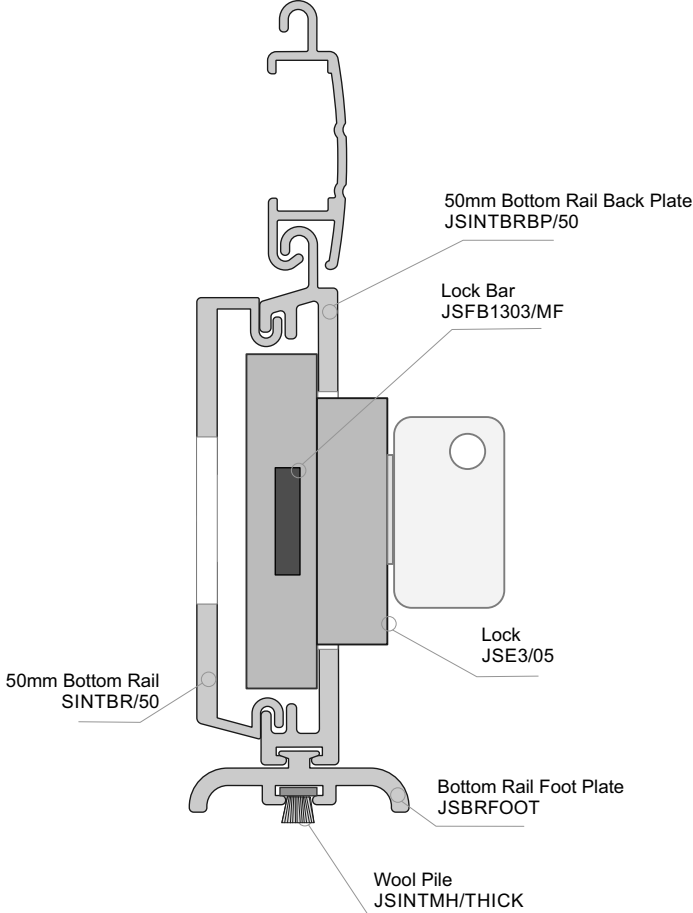

Bottom Extrusions
Non Locking (Motor) 1:1

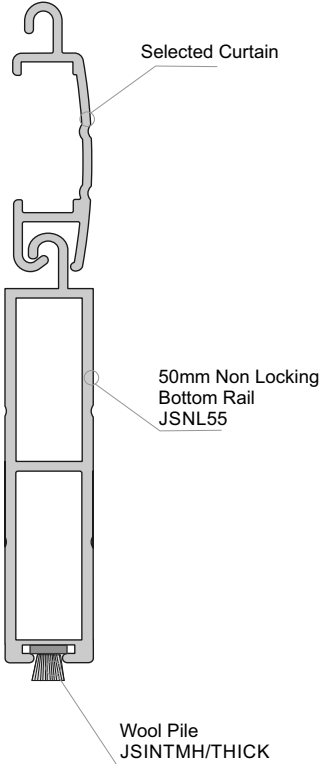

Juralco Intercept® Rollershutter Systems - Component Layouts

Typical Door Component Layout

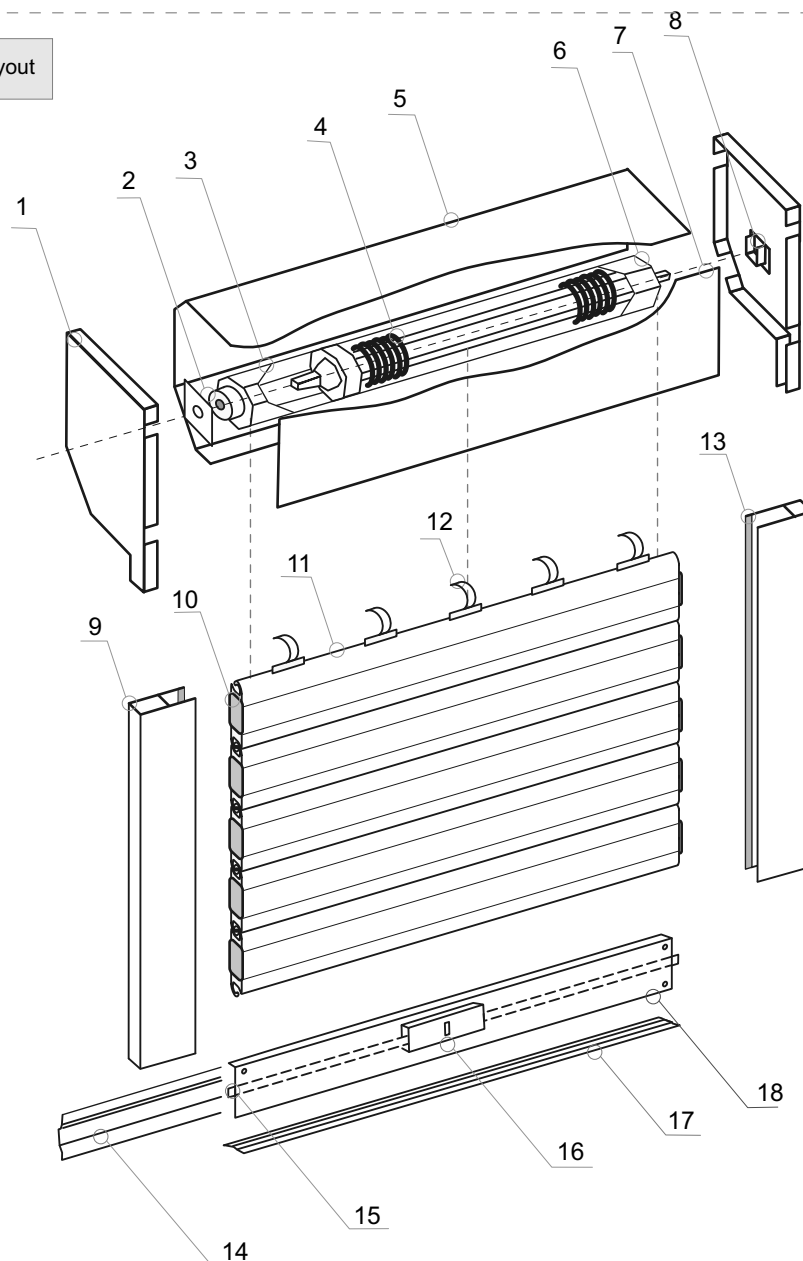

Components for Rollershutter, Manual Spring Balanced with 50mm Bottom Rail, Cover and Lock

ITEM		ITEM	
1	Headbox Ends 150,165, 180, 205, 250	10	Selected Nylon End Cap
2	Bearing + Bearing Holder	11	Selected Curtain - see above
3	Octagonal Hollow Steel Axle, 60mm or 70mm dia	12	Security Spring
4	Torsion Spring or Tubular Motor	13	Wool Pile
5	Head Box Front 150,165,180, 205, 250	14	Cover Plate for Bottom Rail
6	Octagonal Adjustable End Caps	15	Aluminium Lock Bar 13mm x 3mm
7	Head Box Back 150, 165,180, 205, 250	16	Bottom Rail Key Lock
8	Spring Support Bracket	17	Bottom Rail Footplate
9	Side Guide, 58mm or 72mm x 22mm	18	Bottom Rail



Juralco Intercept® Rollershutter Systems - Springs, Motors

Torsion Spring

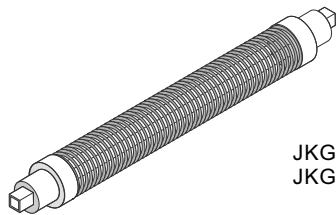

JKG31/66 Red
JKG31/117 Blue

Juralco Proprietary Torsion Spring
Manufactured from 12.5mm dia Chromed Steel Shaft,
Nylon drive wheels and Carbon Spring steel.
All to AS1472(2003) Range 2.
Finish - Phosphate coated

Tubular Motors 45mm dia
JNICE ERA M
Models 3017 and 5012

Tubular Motor 45mm dia
Mechanical Limit switches

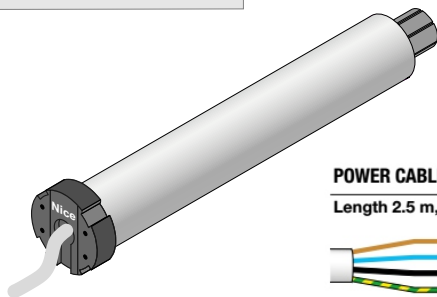

POWER CABLE

Length 2.5 m, 4 wires in cable



Tubular Motors 45mm dia
JNICE ERA MH
Model 5012 only

Tubular Motor 45mm dia
Mechanical Limit switches
Manual emergency Override

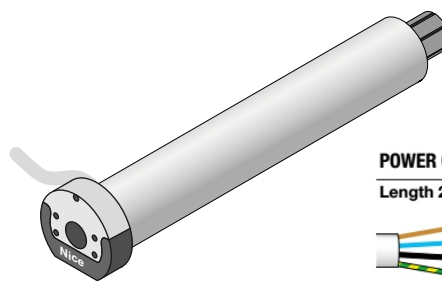

POWER CABLE

Length 2.5 m, 4 wires in cable



Tubular Motors 58mm dia
JNICE ERA L
Models 8012, 10012 and 12012

Tubular Motor 58mm dia
Mechanical Limit switches

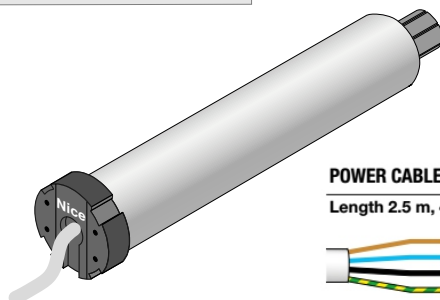

POWER CABLE

Length 2.5 m, 4 wires in cable



Tubular Motors 58mm dia
JNICE ERA LH
Models 8012, 10012 and 12012

Tubular Motor 58mm dia
Mechanical Limit switches
Manual emergency Override

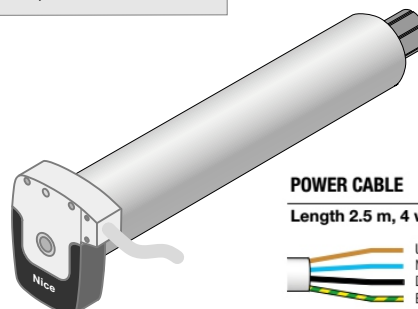

POWER CABLE

Length 2.5 m, 4 wires in cable



Motor Mount Brackets
JNICE/BRKT/ERAM

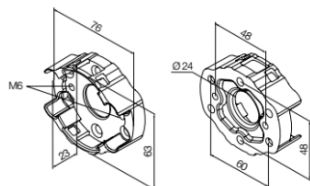

For 45mm dia Motors
Compact aluminium
support. 2 x holes M6 at
48 and 60mm CL

Drive Wheel and Crown
JNICE/45OCT60



Motor Mount Brackets
JNICE/BRKT/ERAL

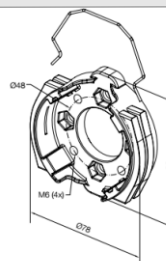

For 58mm dia Motors
Compact aluminium
support. 4 x holes M6
& 4 x Hex seats for M6 nuts.
For ERA L 12012 motor use
all 8 x Fastening points

Drive Wheel and Crown
JNICE/58OCT70



Manual Control

HPM Rotary
Switch Controls

One switch per Single Motor only.
Use relays if more than single Motor
**Motor fully tested
and Limits set at factory**



Tubular Motors 45mm dia
JNICE ERA M 3017 and 5012
JNICE ERA MH 3017 and 5012

Tubular Motors 58mm dia
JNICE ERA L 8012, 10012 and 12012
JNICE ERA LH 8012, 10012 and 12012

Motor Power Cable

Length 2.5 m, 4 wires in cable



Connections at Motor

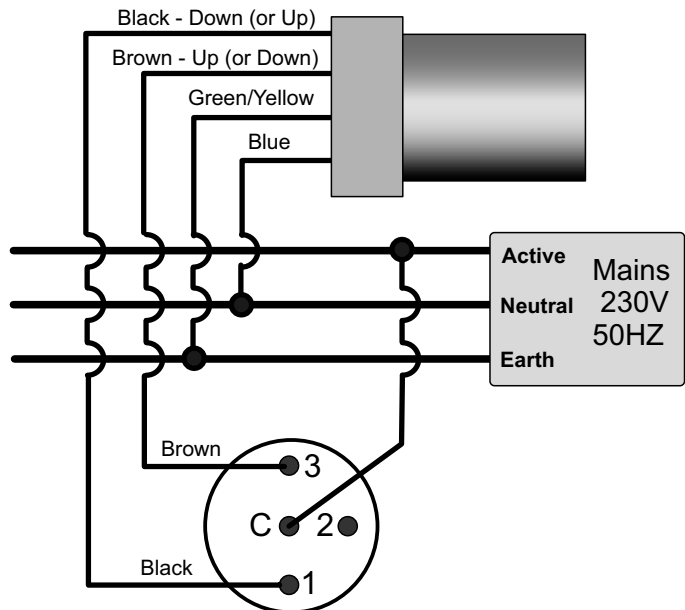

Connections at Rotary Switch

Remote Control

Wireless Controls BiDi

**Motor fully tested
and Limits set at factory**

Wireless Remote Control

From your NiceWay controller



WM001G - 1 x Single or Multigroup
WM002G - 2 x Single or Multigroup
WM003G - 3 x Groups in Single or Multigroup
WM006G - 6 x Groups in Single or Multigroup

Tubular Motors 45mm dia
JNICE ERA M 3017 and 5012
JNICE ERA MH 3017 and 5012

Tubular Motors 58mm dia
JNICE ERA L 8012, 10012 and 12012
JNICE ERA LH 8012, 10012 and 12012

Motor Power Cable

Length 2.5 m, 4 wires in cable



Connections at Motor

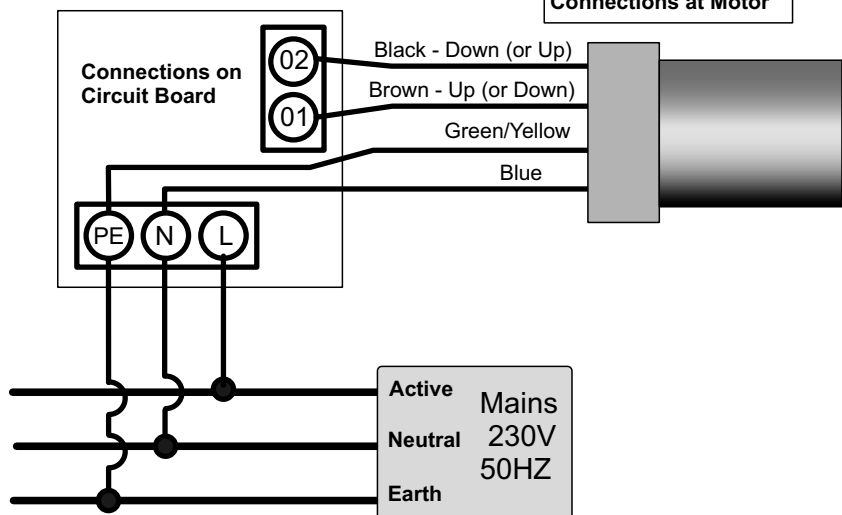

Juralco Intercept® Rollershutter Systems - In Line Motors and Controls

Manual Controls Switch Controls

Wall Controls



3 position Rotary Wall Switch
Up - Off - Close
Cover Plate - SSW 770 CPSM
Switch - SSW 770 RSB

Wireless Remote Controls

Wireless Receiver



JNICE/BIDIAWNING. Nice controller for
Wireless operation. Can be added to
Switch operation and Manual override
Motors to make for wireless control

Wireless Remote Controls

Portable Wireless Transmitters



P1

P6

P18

- P1 Portable transmitter to control 1 electrical load system or automation group
- P6 Portable transmitter to control 6 electrical load systems or automation groups for activation in single or multigroup mode
- P18 Portable transmitter to control 18 electrical load systems or automation groups for activation in single or multigroup mode

INTERCEPT® ROLLER SHUTTER

Order Form

RS #

Customer

Contact

Order No

Date

WO Juralco

SO Juralco

\$ Juralco

Enter Dimensions Enter details/selections into all boxes. Then scan and send to sales@juralco.co.nz

1

Overall Height

Enter Overall
Measurements

Overall Height, incl Headbox

Overall width

Overall Width, to outside of Side guides

2

Select
Curtain
Type

25mm Single Curved Wall

40mm Twin Wall, Plain

40mm Twin Wall, Vented

3

Select Mounting. Head Box, Side Guides

Face Mount

Reveal Mount

From Height enter Headbox Size. Can be min or above

Headbox Size

25mm Slat

Height From - To

0 -1000

1001-1749

1750-1999

2000-2250

2500-3250

Head Box min

150

165

180

205

250

40mm Slat

Height From - To

0-999

1000-1249

1250-1749

1750-2499

2500-3250

Head Box min

150

165

180

205

250

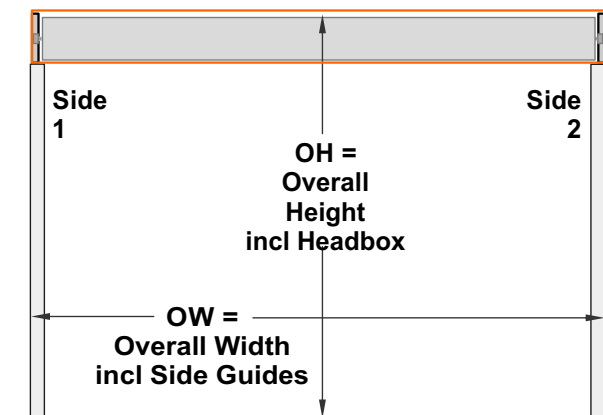

Intercept Roller Shutter
Overall Height 1000min - 3000max,
Overall Width 1000min - 4000max

4

Tick box to select one only

Side Guides Select

Side 1 - 58mm

Side 1 - 72mm

Side 2 - 58mm

Side 2 - 72mm

5

Tick box to select one only

Rollershutter Operation Select

Manual/Spring assist operation

Motor, Switched operation

Motor, Switch + M/Override

Motor, Wireless operation

6

If Motor - Tick box to select

Motor Wireless Control No

JNICE/Bidi Awning. Switch to Wireless

P Portable Transmitters. P1, P6, P18

7

This Section **Motor**
Operation only

Tick box to select

Motor Position

Select

Motor at Right End

Motor at Left End

Motor Position
Viewed from

8

Select
Powder
Coat Type
and Colour

Duralloy Plus

Duratec

Specify PC Colour and Code

Powder Coating not an Option for Econolink or Ultra Security. Both supplied as Natural Anodised

9

Notes



JURALCO

www.juralco.co.nz ph (09) 478 8018

Juralco Intercept® Rollershutter System

Issue 5-24 v1
Page 13

Juralco Intercept® Rollershutter Systems - Machining, Installation

Note: Prior to delivering to site, unpack and check all items

INSTALLATION HINTS

1 - RULE NO 1 - THINK, carefully before commencing the work. Carefully plan your work before commencing.

The diligent installer should carefully inspect each opening and make certain where and how the shutter is to be affixed.

2 - RULE NO 2 - THINK, safety first.

3 - HANDY HINTS

a - Always keep some spare drill bits.

b - Have all drill bits ready sharpened before commencing work.

c - Have some touch-up paint with you.

d - Have a piece of flat aluminium sheet of 2mm to 3mm thickness. You may need to improvise on site.

e - Have a piece of side guide handy to help you space out and mark where to drill fixing holes.

f - Upon arrival at the work site, assign all the numbered componentry to each shutter and to each opening.

g - Test the Rollershutter to your satisfaction, adjust top and bottom limits, silicone spray inside the side guides.

Test all controls and locks, that they work cleanly and smoothly.

h - Attach company labels and maintenance phone contacts in an obvious place.

i - Hand the customer any operating Manuals.

J - Always leave the installation (and site) in a clean and tidy condition.

Intercept Rollershutters are enclosed in Head boxes and are less prone to mechanical difficulties as the components used for the box have been carefully developed as a total system and not just part of a shutter. The front cover of the two-part box system is easily removed for installation, or subsequent servicing of the shutter, should the need arise. The boxes come in a range of colours to suit most homes and may even be repainted to suit the desires of the customer.

Lock Machining Bottom Rail

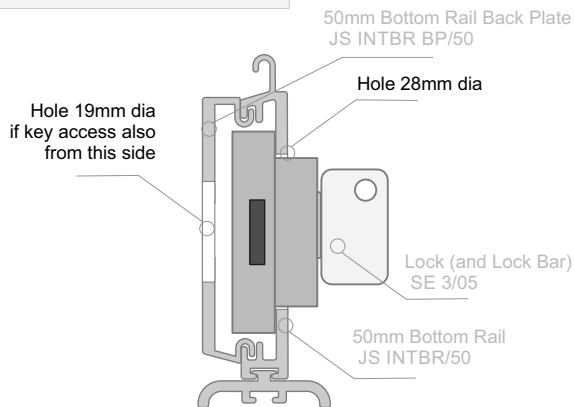

Lock Bar Slots Side Rails

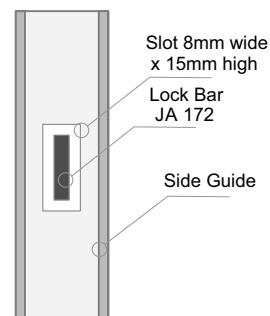

Attach Side Guides

A - If not drilling into timber, be sure to fix into full bricks or blocks and not into mortar joints.

b - Use galvanised 10 gauge x 35mm screws as a minimum standard for fixing.

For maximum security alternative security anchors should be used.

Reveal Fix

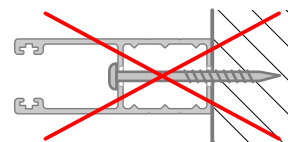
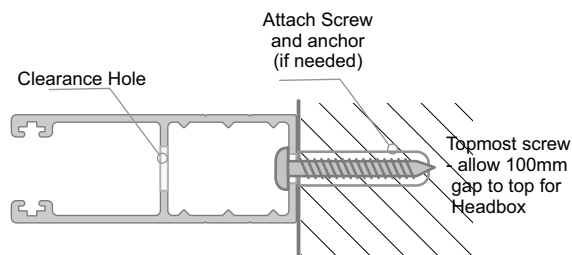

Face Fix

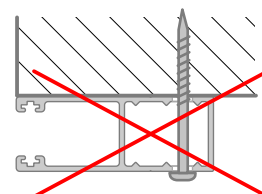
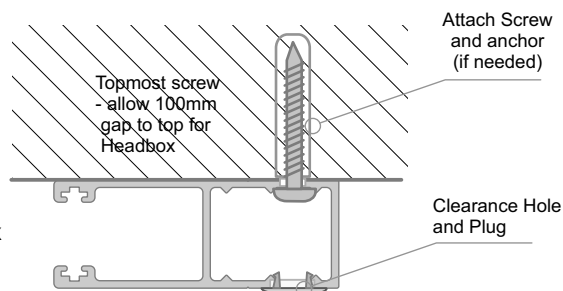

Side Guides should be square and parallel after fixing - pack out if necessary

Juralco Intercept® Rollershutter Systems - Installation

Attach Headbox

The sheet metal pelmets are attached to the Headbox ends with two rivets on each face through the Head box tongues. The complete headbox is then fixed to the lintel either through the Top pelmet with screws every 400mm or by attaching an angle to the top of the pelmet and face fixing - depending on available fixing (Face fixing) or through the side guides (reveal fixing)

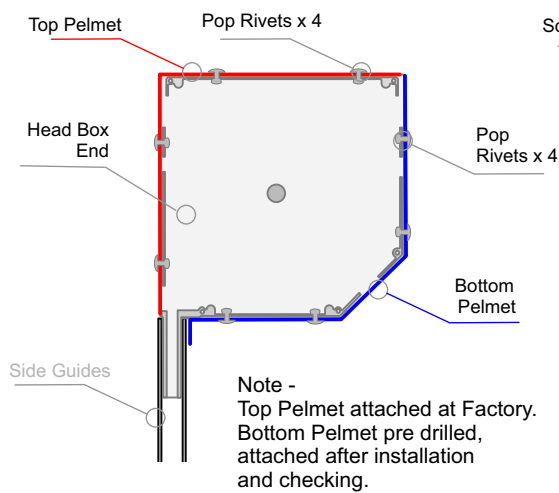

**Pelmets,
Headbox ends**

Attach Headbox.
Attach 25x25x3 Angle (JA120/5) to Wall
Screw through Tabs

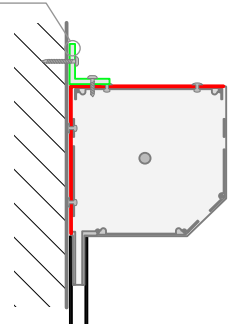

Face Fix 1

Attach Headbox,
Screw through Ends

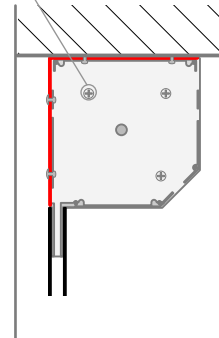

Reveal Fix

Attach Headbox.
Screw through Tabs into
lintel or similar

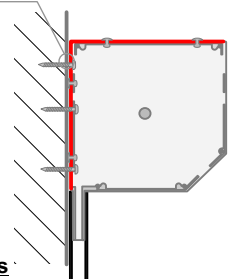

Face Fix 2

**Do not use Side guides/Headbox ends
to support the weight of the Roller Shutter**

Security Spring

In order for the Security Spring to function correctly ie to prevent the curtain being forced up from the outside, the spring must be correctly positioned

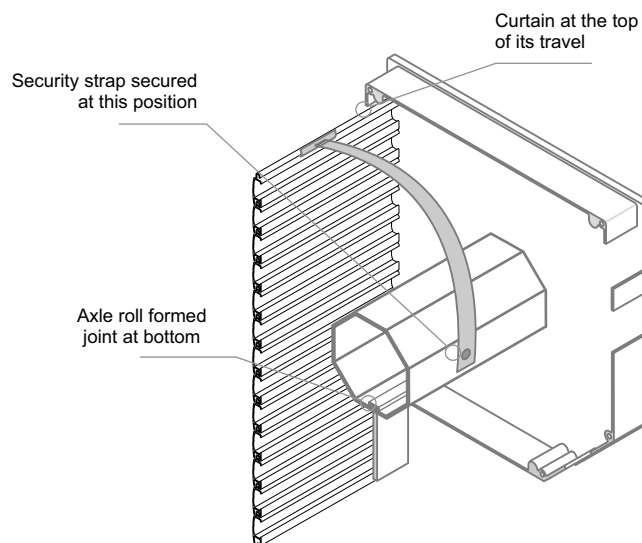

Powder Coating Installation Care

Warning re use of solvents:

- In some cases strong solvents are recommended for thinning various types of paints and also for cleaning up mastics and sealants.
- These can be harmful to the extended life of the powder coated surface, and must not be used for cleaning purposes.
- It is important to note that the damage will not be visible immediately and may take up to 12 months to develop.

If paint splashes or sealants and mastics need to be removed then the following may be safely used:
Methylated Spirits, Ethyl Alcohol, Isopropanol or preferably a mild detergent in warm water.

Joinery Protection during Installation:

All the activity on a construction site means that your powder coated items may get knocked or scratched, splattered with mortar, plaster, textured coating or paint during the later stages of construction.

Please ensure that all powder coated articles are masked or covered at this time. It is far easier to prevent accidents than to try and correct them. Should your joinery receive mortar or paint splashes see that these are removed before cure and follow the instructions contained in this brochure.

Typical sticker used to warn other trades of the need to protect and mask off powder coated joinery (applies to anodised joinery also)

"IMPORTANT ALL TRADES"
This valuable aluminium joinery will suffer permanent damage from: plaster, mortar and paint splashes - Protect if splashes occur - Immediately wash down joinery with water or meths - Do not allow splashes to harden! - Do not use solvents! - Do not remove this label until final clean completed.

This photograph displays damage that has occurred on site, post installation. The photo of the masked joinery displays clear signs of damage that could have occurred were it not masked. Please ensure that your joinery is protected right through the entire construction process.



Powder Coating Maintenance

External - Maintenance Program:

To extend the life of external powder coated articles and to comply with warranty requirements for powder coated aluminium joinery, a simple, regular maintenance program must be implemented.

The effects of ultra violet light, atmospheric pollution, dirt, grime and airborne salt deposits will all accumulate over time and must be removed or surface staining and weathering will occur, leading to an unsightly appearance.

For external coatings, cleaning should take place every six months. In areas where pollutants are more prevalent, such as beachfront houses and industrial or geothermal areas, then a cleaning program should be carried out on a more frequent basis ie. every one to three months.

Cleaning your powder coating:

1. Carefully remove any loose surface deposits with a wet sponge.
2. Use a soft brush (non abrasive) and a mild household detergent (do not use solvents) in warm water, remove dust, salt and other deposits.
3. Rinse off with clean fresh water.



Restoring weathered or scratched surfaces:

Repair of Scuffed or Scratched surfaces

Dulux Spray Cans are available in all colour card colours.

Repair of Small Scratches or Chips.

Dulux Dabsticks are ideally suited for the repair of small scratches.

Dabsticks may not be available in all colour card colours.

Repair of Weathered areas .

Dulux Gloss Up is a light to medium cutting cream ideally suited for gloss restoration and has been specifically designed for this purpose.

Gloss Up contains no waxes or silicone and is a one step system.



Contact Dulux Powder Coatings , ph 0064 9 441 8244

All pages © Copyright Juralco Aluminium Building Products Ltd, 2024