



 JURALCO

JURALCO RETRACTABLE ROLLER CICERO™ SCREEN SYSTEM

ISSUE 12-23 v1

Juralco Cicero™ Retractable Roller Insect Door Screen System

Juralco Aluminium Building Products Ltd designs and distributes specialist aluminium joinery systems through a national network of franchised fabricators and agents. For more than 25 years we have been at the forefront of specialist aluminium door and window products suitable for New Zealand joinery and building methods. Our comprehensive product range includes security and insect screens, balustrades and gates, shutters and awnings, shower screens, wardrobe doors and organisers and internal doors.

Juralco Retractable Insect Door screens can be fitted to most types of residential door joinery including - hinged, sliding, french and bifold doors to prevent entry of insects. These Sheer screens are normally fitted into doorways and have low profile PVC bottom tracks. Custom made in a variety of powder coat colours.

Juralco Cicero™ is a breakthrough retractable insect screen system. This new concept door combines the benefits of existing retractable Insect Screen Doors with the advantages of pleated mesh doors.

- Mesh - thin, extremely stable and UV resistant
- Slow rewinding during opening
- Semi Transparent, lets in the air without restricting the view
- Adjustable spring tension
- Easy installation, using press fit wall brackets
- Fits uneven openings (max 10mm out of parallel Top to Bottom Track)
- Strong, robust extruded Sliding Front Bar
- Low profile 5mm Bottom floor Guide
- Max Dimensions - Single door 2200mm high x 1800mm wide
Double Door 2200mm high x 3600mm wide



All pages© Copyright Juralco Aluminium Building Products Ltd, 2023

Juralco Cicero™ Retractable Roller Insect Door Screen System

Pages	Codes	Description
4	Layouts	Showing Single Door component layout.
5		Showing Twin Door component layout
6 - 7	Components	Showing all components
8 - 10	Installation	Single and Twin Door Shipping, Unpacking and Installation Instructions
11	Build Out	Shows Door Build out Frame and components
12	Order Forms	Juralco Order Form - Single Door
13		Juralco Order Form - Twin Doors
14	Care	Care of Powder Coated Surfaces

Important instructions for Powder Coatings near Salt Water

The standard Dulux powder coating system used by Juralco is Duralloy® and is suitable for installations greater than 100 metres from high tide level and for buildings up to 3 stories above ground. Use Duratec® for installations between 10 and 100 metres from high tide level and for prestigious residential and commercial developments. For all other applications contact Juralco for alternative systems.

Note - Powder coated prices listed in Juralco price books are for the standard Duralloy® system. If the Duratec® system is required it must be specified upon placement of the order and will incur a surcharge – Duratec® prices on application.

Important instructions for Powder Coating - Attachment to structures

An EPDM or similar material spacer must be used to separate powder coated aluminium items from all timber, concrete and steel structures. Failure to do so can lead to the chemicals in the structure affecting the powder coating layer on the aluminium.

Powder Coating Warranty

The Dulux powder coating warranty period is conditional upon being maintained in accordance with the Dulux 'Care and Maintenance Instructions'. Contact your installer for a copy (or download from Dulux) of the Care and Maintenance instructions or refer to the back page of this manual.

Juralco Cicero™ Retractable Roller Insect Door Screen System - Single Door For Reveal Installations or Face Fixed with a Build out Frame.

Juralco will supply the Cassette, Mesh and Sliding Bar all fully Assembled.
Also included are the Top guide (6), U Profiles (5) and PVC Bottom Rail (20), all cut to length .Top Guide and U Profiles Powder coated to a colour of your choice.
Supplied loose are the End Caps(8) and Clips (23)

- 1 Cassette
- 2 Polypropylene mesh on tube
- 3 Sliding bar
- 4 Closure profile with magnet
- 5 U profile
- 6 Top guide
- 7 Setting plate
- 8 Top guide cap
- 9 Pile
- 10 Guide plate for sliding bar top cap
- 11 Positive magnet
- 12 Negative magnet
- 13 Sliding bar top cap
- 14 Sliding bar bottom cap
- 15 Upper scorpion tail
- 16 Lower scorpion tail
- 17 Case top cap
- 18 Bush
- 19 Complete endcap with spring
- 20 PVC bottom Rail
- 21 Steel ballast
- 22 Ballast holder
- 23 Clip
- 24 Brush pile
- 25 Upper Scorpion Tail terminal
- 26 Lower Scorpion Tail terminals
- 27 Wire

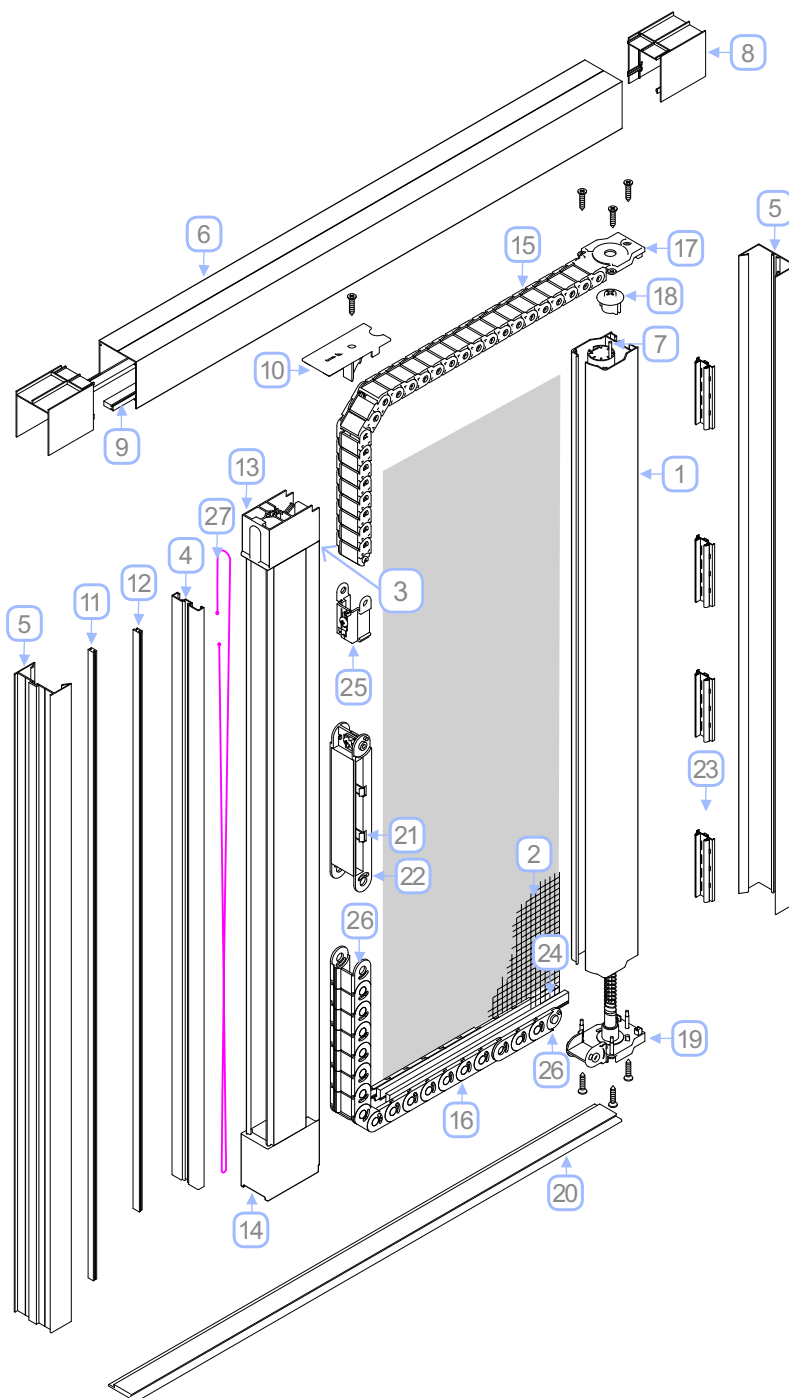

Profile Sections

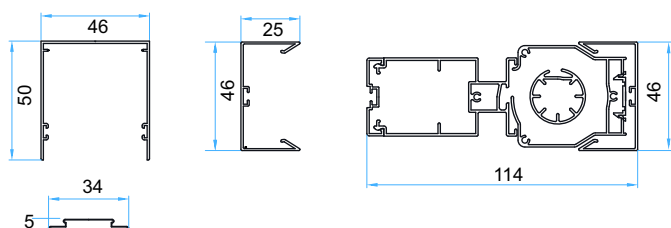

Opening Options

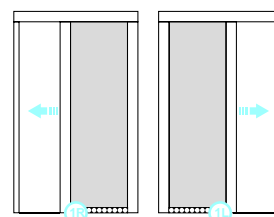

Max Dimensions

Height 2200 max
Width 1800 max

Juralco Cicero™ Retractable Roller Insect Door Screen System - Twin Doors For Reveal Installations or Face Fixed with a Build out Frame.

Juralco will supply the Cassette, Mesh and Sliding Bar all fully Assembled.
Also included are the Top guide (6), U Profiles (5) and PVC Bottom Rail (20), all cut to length .Top Guide and U Profiles Powder coated to a colour of your choice.
Supplied loose are the End Caps(8), Clips (23). See previous page.
Also (A below

A Additional references for double horizontal

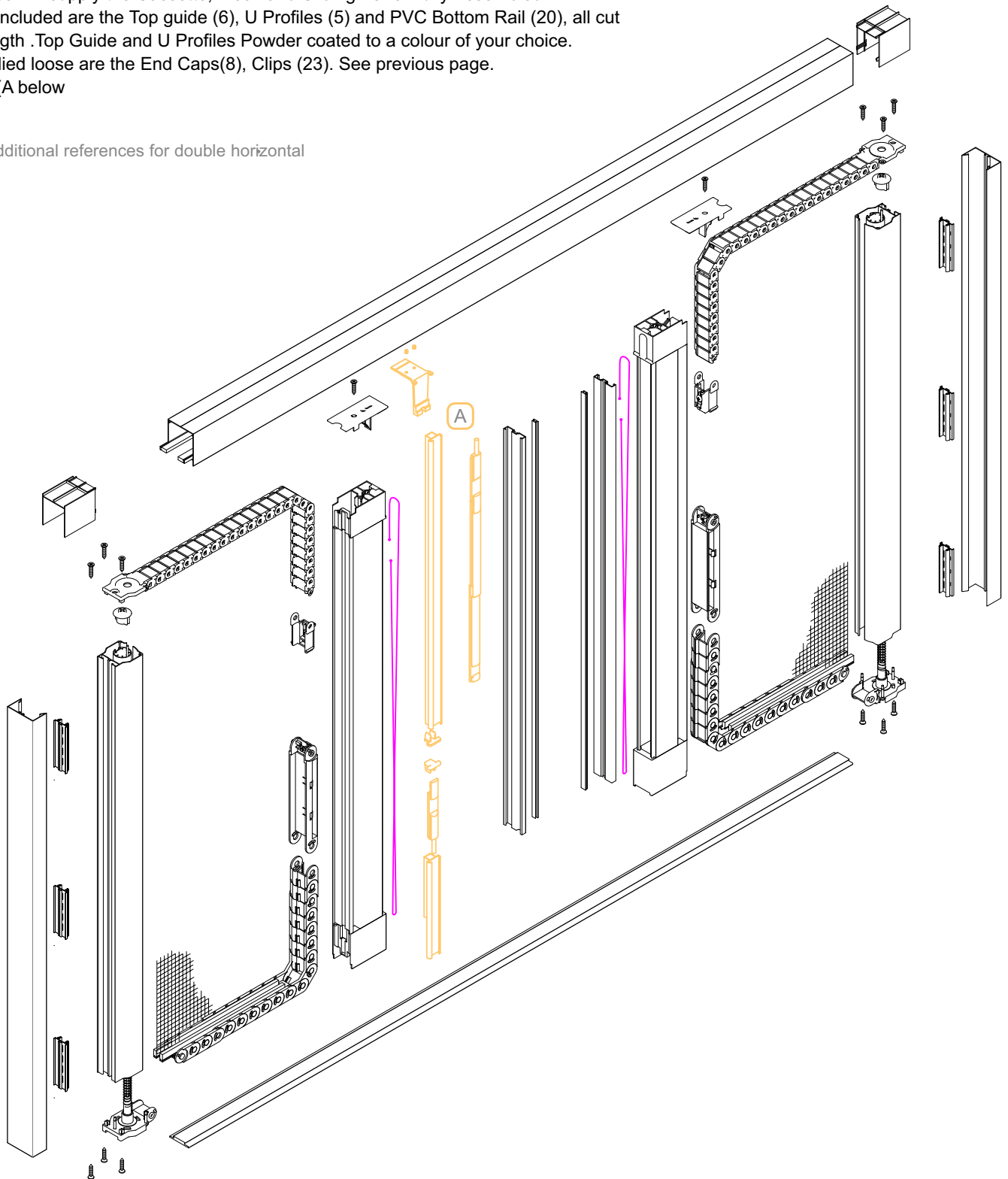

Profile Sections

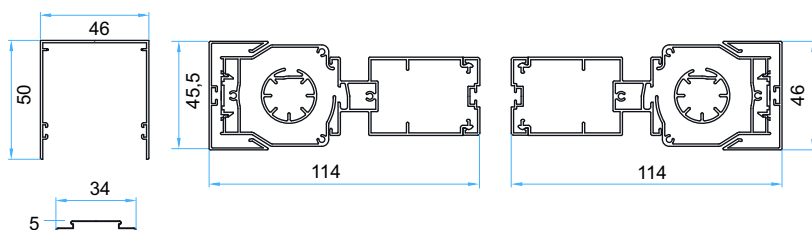

Opening Options

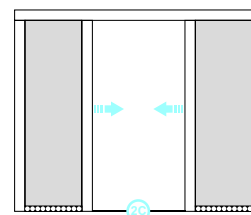

Max Dimensions

Height 2200 max
Width 3600 max

Juralco Cicero™ Retractable Roller Insect Door Screen System - Extrusions

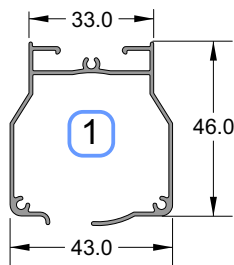

CASSETTE 5m
JMX/08-00120-x-x



POLYPROPOLYNE MESH
ON 23.5 MM DIA TUBE 5m
JMX/08-10120-4-5

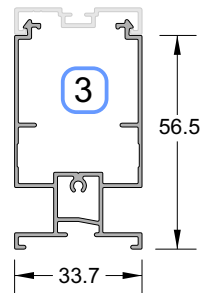

SLIDING BAR 4.9m
JMX/08-00140-0-0

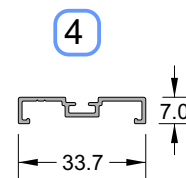

MAGNET HOLDER 4.9m
JMX/08-00070-0-0

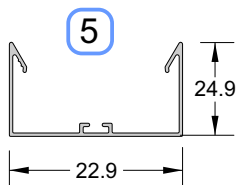

U PROFILE 5m
JMX/08-00160-0-0

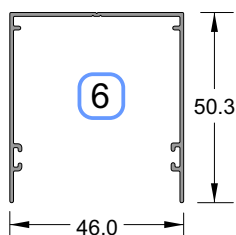

TOP GUIDE 5m
JMX/08-00150-0-0

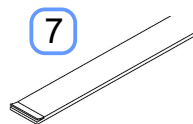

SETTING PLATE 2.6m
JMX/08-00000-0-5

Juralco Cicero™ Retractable Roller Insect Screen Systems - Components

Top Guide Cap (case side)
JMX/08-13340-0-5

8

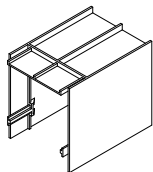

Top Guide Pile
JMX/00-02400-0-5

9



Pile 4.8 x 12mm. 300m Roll

Guide plate for Sliding Bar
Top Cap
JMX/08-13330-0-5

10

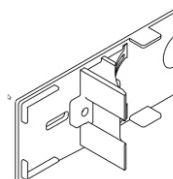

Magnets 100mm Rolls - Large Doors

11



Small Positive Magnet
Medium
JMX/08-16001-0-5

12



Small Negative Magnet
Medium
JMX/08-16011-0-5

Magnets 100mm Rolls Small Doors

11



Small Positive Magnet
Low
JPL/05-16001-0-5

12



Small Negative Magnet
Low
JPL/08-16011-0-5

Sliding Bar Top Cap
JMX/08-13300-0-5

13

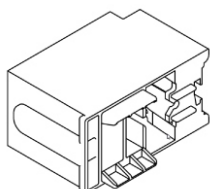

Insert Slider for Pull Bar
bottom end Cap
JMX/08-13050-0-5

14

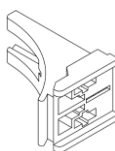

Sliding Bar Bottom Cap
JMX/08-13290-0-5

14

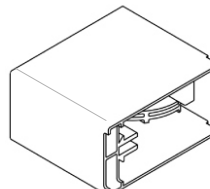

Upper Scorpion Tail - 53pcs
JMX/08-13380-0-5

15

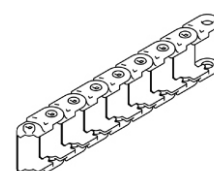

Build Out Frame
Extrusions,
Components

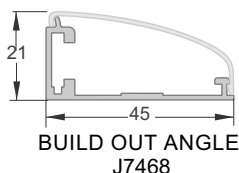

BUILD OUT ANGLE
J7468



BUILD OUT COVER
J7469

CORNER STAKE
FOR BUILD OUT
JC298

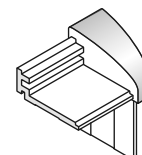

Juralco Cicero™ Retractable Roller Insect Door Screen System - Components

Lower Scorpion Tail - 58pcs
JMX/08-13310-0-5

16

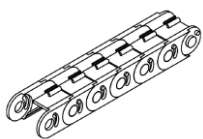

Case Top Cap
JMX/08-13286-0-5

17

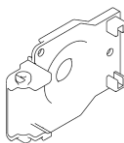

Bushing
JMX/08-13270-0-5

18



Complete Endcap with Spring
JMX/08-13260-0-5

19

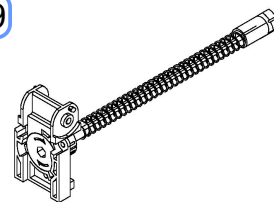

PVC Bottom Rail 2.6m
JMX/08-00170-0-5

20

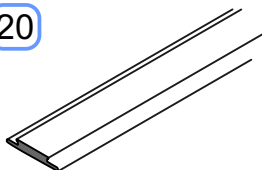

Ballast Holder
JMX/08-13070-0-3

21

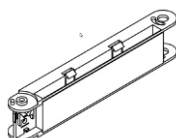

Steel Ballast
JMX/08-13080-0-0

22

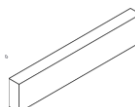

Clip
JMX/08-13010-0-5

23



Brush Pile
JRF98/10MM

24



Pile 4.8 x 10mm.

Upper Scorpion Tail Terminal
JMX/08-13320-0-5

25

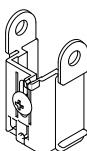

Screen Transfer
JRF125/6



Set of 6. Very thin. 102 x 20mm
Self Adhesive back, For applying to
Door screens as a walk through
prevention.
Backing removes easily at back joint
Typical application shown.

Lower Scorpion Tail Terminals
JMX/08-13520-0-5

26



Attach ea end of the Lower tail

Wire 1000m Roll
JPL/05-13000-0-5

27

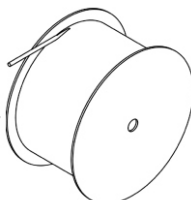

Accessory Kit for
Double Door
JMX/08-13510-0-5

A

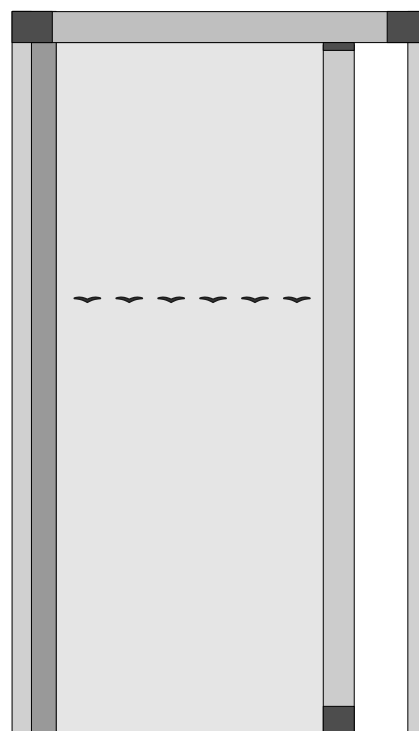
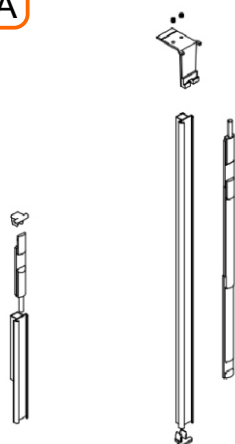

Juralco Cicero™ Retractable Roller Insect Door Screen System - Single Door

Instructions for Shipment, Unpacking and Installation

Shipment:

- During the shipment of the insect screen, do not drop the package. The plastic components could be damaged.
- Avoid heavy materials being placed on top, that could bend the long profiles of the insect screen.

Unpacking:

- Remove all the cardboard packaging from around the product. Pay attention not to cut or to mark the insect screen with cutter or scissors.
- Don't leave packaging material where there are children; it could represent a source of danger.
- Ensure all parts are clean, tidy and are undamaged. If any are damaged contact the shipper immediately.

Installation of a Cicero™ Single Door Insect Screen:

- Insert the brush pile and the telescopic end caps into the Top guide. The correct brush pile **MUST** be used or the Top scorpion Track will collapse.
- Fix the Top guide in place with suitable SS fasteners
- Fix the U profile with clips (one side only) to the side Frame or Wall.
- Fix the other U profile (with Magnet) to the side Frame or Wall
- Fix the PVC Bottom Track to the Floor.
- Push the Insect screen Mesh pack up into the Top Guide, then onto the Clips, so it locks into the U profile. The Narrow sliding Bar top Cap must be at the Top side.
- Can fit uneven openings (max10mm out of parallel Top to Bottom Tracks), but over that will need packing back to parallel.



ATTENTION: It is the responsibility of the installer to evaluate the suitability of the fixing systems supplied by the manufacturer and whether to use them, relative to the condition of the materials of the fixing surface (wall) and to applicable standards. During installation, follow workplace safety regulations.

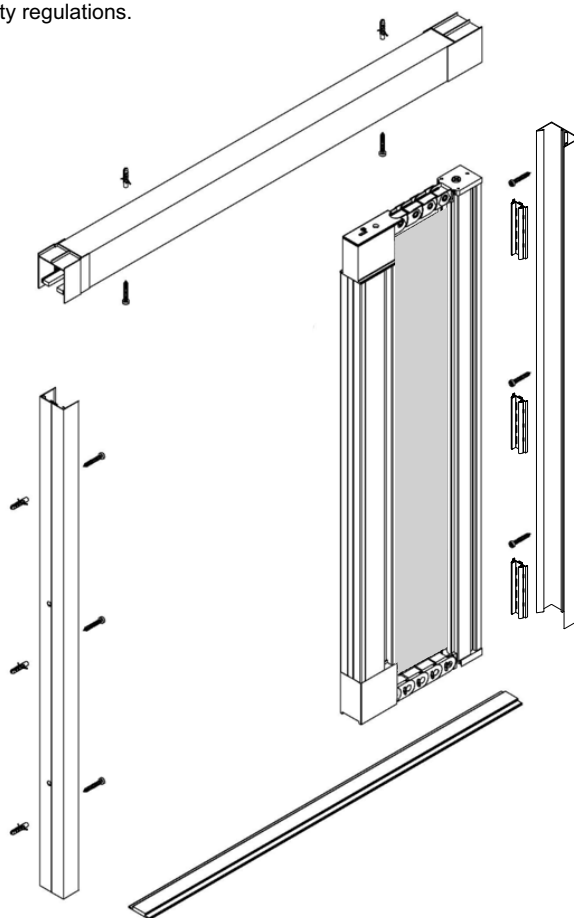

Instructions for use:

-  **ATTENTION:** The insect screen is not any kind of barrier for adults or children. It is therefore strictly recommended not to lean on the mesh. Improper use will invalidate product warranty.



- Take care over the small step created by the guide on the floor.

Instructions for maintenance

- Periodically clean the net with a damp sponge.
- Periodically clean the insides of the profiles cleaning out any object resting in there (Dirt, Leaves, dead insects etc)



- ATTENTION:** If the insect screen is not installed and used according to the conditions shown in the Manual, the manufacturer cannot accept responsibility for any damage caused.

CERTIFICATE OF CONFORMITY CE

This product conforms to the Standard EN 13561 and 98/37/CE

Model: Cicero™ - External use

Juralco Cicero™ Retractable Roller Insect Door Screen System - Twin Doors

Instructions for Shipment, Unpacking and Installation

Shipment:

- During the shipment of the insect screen, do not drop the package. The plastic components could be damaged.
- Avoid heavy materials being placed on top, that could bend the long profiles of the insect screen.

Unpacking:

- Remove all the cardboard packaging from around the product. Pay attention not to cut or to mark the insect screen with cutter or scissors.
- Don't leave packaging material where there are children; it could represent a source of danger.
- Ensure all parts are clean, tidy and are undamaged. If any are damaged contact the shipper immediately.

Installation of Cicero™ Twin Door Insect Screens

- Insert the brush pile and the telescopic end caps into the Top Guide. The correct brush pile **MUST** be used or the Top scorpion Track will collapse.
Insert the central stopper in the top guide and fix it in the desired position.
- Fix the U profiles with clips (both sides) to the side frame or wall.
- Fix the PVC Bottom Rail to the Floor.
- Push the Insect screen Mesh packs up into the Top Guide, then onto the Clips, so they lock into the U profiles. The Narrow sliding Bar top Cap must be at the Top side.
- Can fit uneven openings (max10mm out of parallel Top to Bottom Tracks), but over that will need packing back to parallel.



ATTENTION: It is the responsibility of the installer to evaluate the suitability of the fixing systems supplied by the manufacturer and whether to use them, relative to the condition of the materials of the fixing surface (wall) and to applicable standards. During installation, follow workplace safety regulations. .

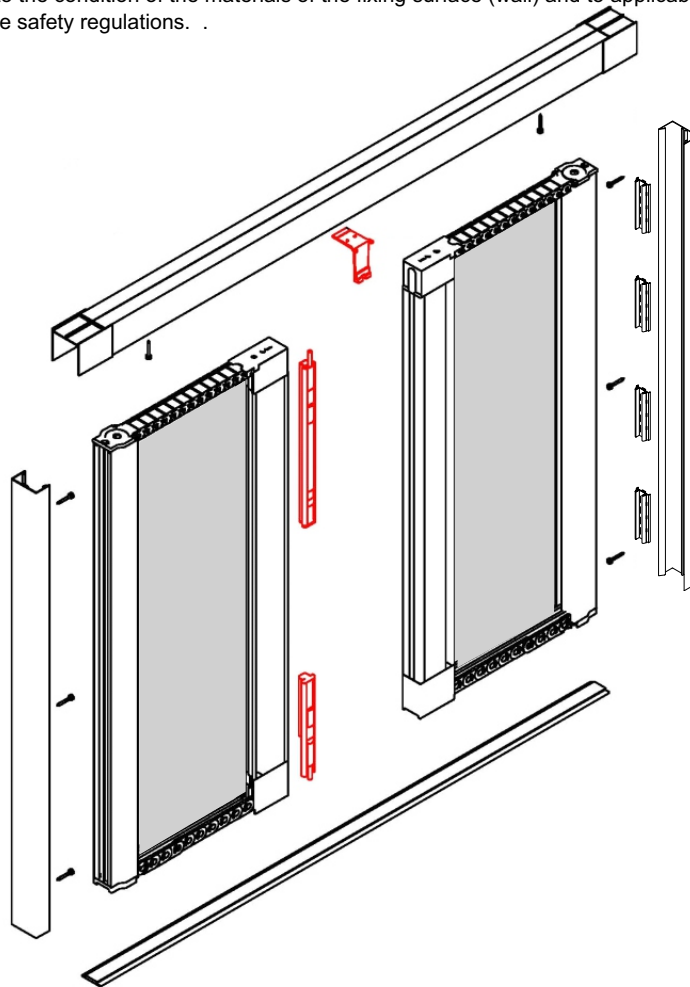

Instructions for use:

 **ATTENTION:** The insect screen is not any kind of barrier for adults or children. It is therefore strictly recommended not to lean on the mesh. Improper use will invalidate product warranty.

 Take care over the small step created by the guide on the floor.

Instructions for maintenance

- Periodically clean the net with a damp sponge.
- Periodically clean the insides of the profiles cleaning out any object resting in there (Dirt, Leaves, dead insects etc)

 **ATTENTION:** If the insect screen is not installed and used according to the conditions shown in the Manual, the manufacturer cannot accept responsibility for any damage caused.

CERTIFICATE OF CONFORMITY CE

This product conforms to the Standard EN 13561 and 98/37/CE

Model: Cicero™ - External use

Juralco Cicero™ Retractable Roller Insect Door Screen System - Single Door Installation

To watch this Installation video,
click or enter the link below
https://youtu.be/9k_LXejoZPY

Note: For Twin Doors closing central Magnets, or install the Latch if required



1 - Top Guide, Insert Piles,
Attach both End Caps



2 - Attach Top Guide to the Ceiling, with suitable SS fasteners.
Pack if necessary; must be no greater than 10mm out of
parallel to floor.

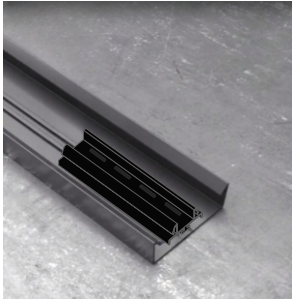

3 - Slide Clips
into the U Profile
(x 2 for Twin Door)



4 - Insert the U Profile
(with attached clips) into the
Top Guide

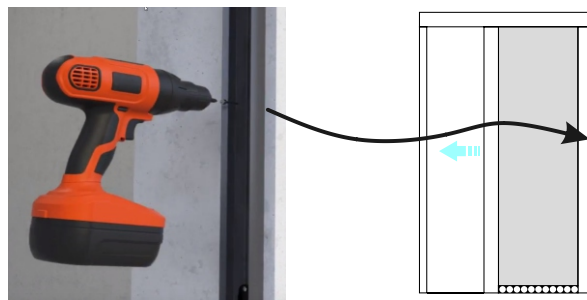

5 - Attach U Profile + clips to Wall, with suitable SS fasteners



6 - Insert the other
U Profile (with Magnet)
into the Top Guide (for Twin
doors this profile has clips)



7 - Attach the U profile to Wall
with suitable SS fasteners.
(to ea side of Magnet).
For Twin Doors as in 5 above



8 - After cleaning the floor area, attach Bottom
Rail to the Floor with attached DS tape



9 - Insert Mesh pack into the Top Guide.
Then push Mesh Pack firmly
onto the Clips inside the U profile. 'Clicks'
(x 2 for Twin Doors)



10 - Test for Smooth operation.
Test Magnet closing satisfactory

Juralco Cicero™ Retractable Roller Insect Door Screen System - Face Fix Door Build Out

**General Assembly for a Face Fix Installation
using the Build Out Angle and Cover together with the Corner Stake**

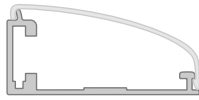

Build out angle
Part No J7468



Build out cover
Part No J7469

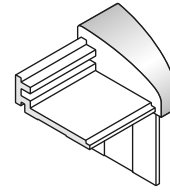

Corner Stake for Build Out
Part No JC298

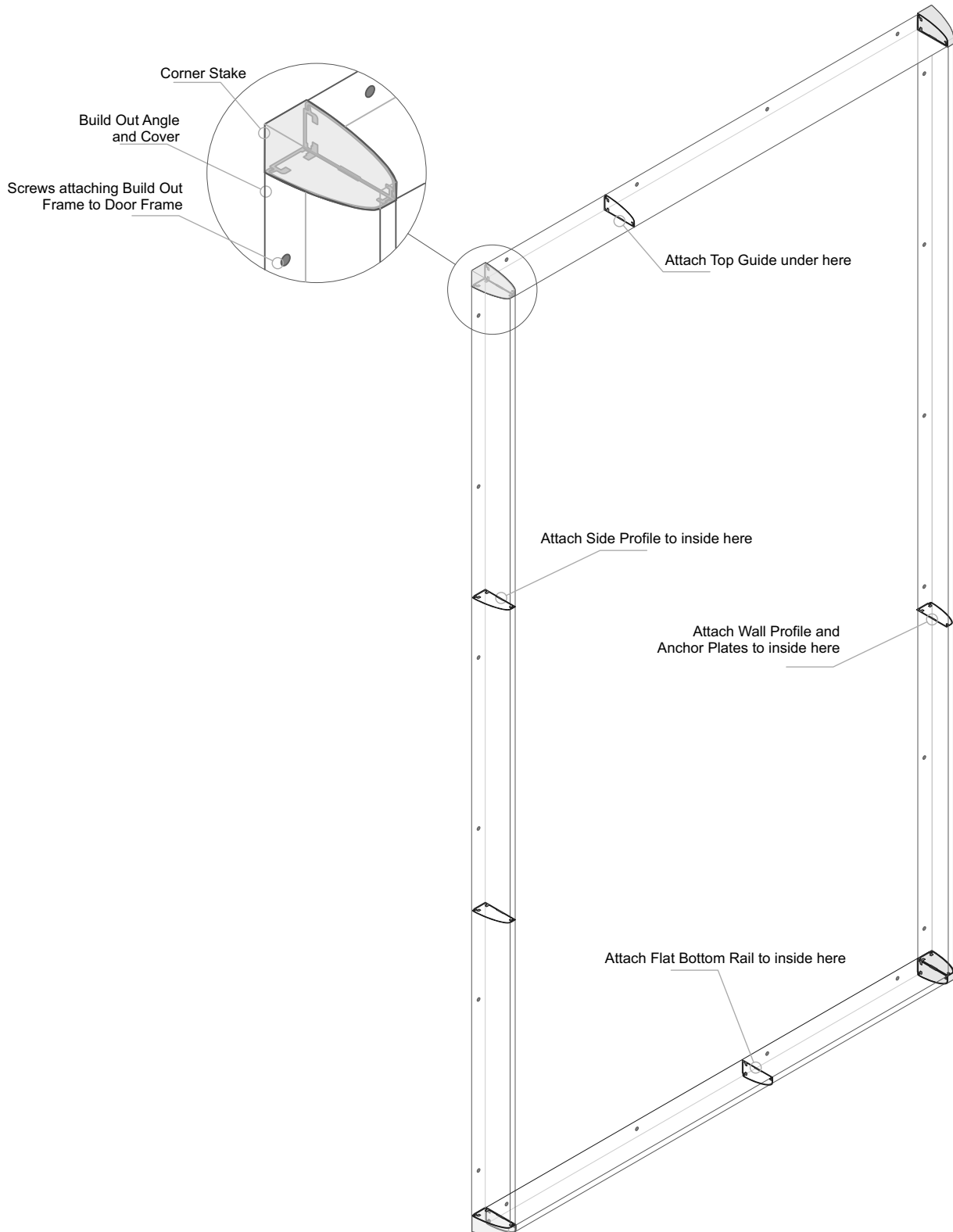

CICERO	Retractable Roller Insect Door - Order Form		
Customer		Contact	
Order No		Date	
WO Juralco		SO Juralco	\$ Juralco
Select/Enter Dimensions below. Enter details/selections into all boxes. Then scan and send to sales@juralco.co.nz			

This Order Form - for **CICERO™** **SINGLE DOORS** only.

1 Enter Sizes. Please note, these are produced exactly square. If opening out of square you to pack out.

CICERO™ Roller Insect Screen Single Door Units

This Order for Cicero Single Doors		
Enter Exact Dimensions, mm		No of Units. (Identical,max 5)
Unit 1	Height	
	Width	
Unit 2	Height	
	Width	
Unit 3	Height	
	Width	
Unit 4	Height	
	Width	

Note: Juralco will supply the Cassette, Mesh and Sliding Bar all fully assembled. Pack includes the Frame, ie Upper guide, U Profiles and PVC track. All cut to length. All Aluminium Powder coated to order.

Min/Max Height x Min/Max Width Dimensions
 1000mm - 2200mm High x 500mm -1800mm Wide

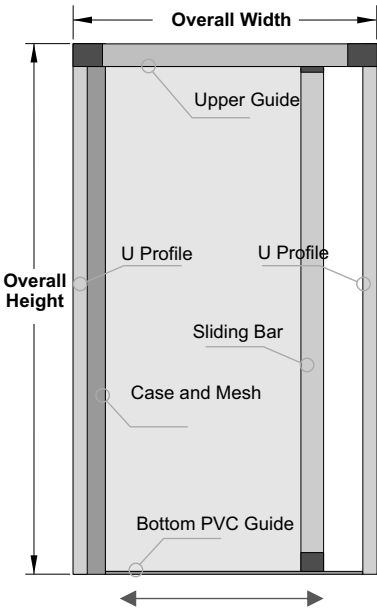

2 Enter Buildouts if Required	Build out + Cover @ 2.9m.		Build out + Cover @ 5.8m.		Build out Corner Cleats	
	J7468/2.9 +J7469/2.9		J7468/5.8 +J7469/5.8		JC298 (Black)	

3 Select Finish	Duralloy <input type="checkbox"/>	Duralloy Plus <input type="checkbox"/>	Specify PC Colour and Code
	Duratec <input type="checkbox"/>		

4 Notes

CICERO		Retractable Roller Insect Door - Order Form		
Customer		Contact		
Order No		Date		
WO Juralco		SO Juralco		\$ Juralco
Select/Enter Dimensions below. Enter details/selections into all boxes. Then scan and send to sales@juralco.co.nz				

This Order Form - for **CICERO™ DOUBLE DOORS** only

1 Enter Sizes. Please note, these are produced exactly square. If opening out of square you to pack out.

This Order for Cicero Double Doors		
Enter Exact Dimensions, mm		No of Units. (Identical,max 5)
Unit 1	Height	
	Width	
Unit 2	Height	
	Width	
Unit 3	Height	
	Width	
Unit 4	Height	
	Width	

Note: Juralco will supply the Cassette, Mesh and Sliding Bar all fully assembled. Pack includes the Frame, ie Upper guide, U Profiles and PVC track. All cut to length. All Aluminium Powder coated to order.

CICERO™ Roller Insect Screen Double Door Units

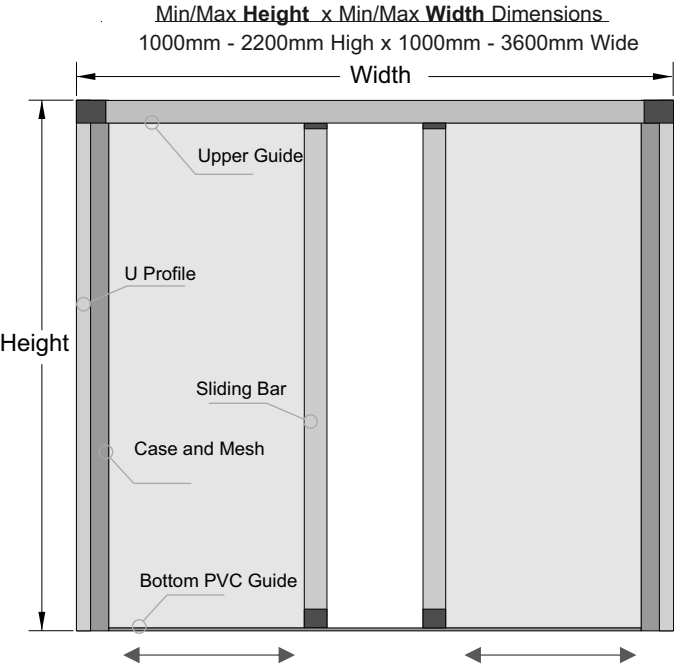

2 Enter Buildouts if Required	Build out + Cover @ 2.9m.	Build out + Cover @ 5.8m.	Build out Corner Cleats
	J7468/2.9 +J7469/2.9	J7468/5.8 +J7469/5.8	JC298 (Black)

3 Select Finish	Duralloy <input type="checkbox"/>	Duralloy Plus <input type="checkbox"/>	Specify PC Colour and Code
	Duratec <input type="checkbox"/>		

4 Notes

Powder Coating Installation Care

Warning re use of solvents:

- In some cases strong solvents are recommended for thinning various types of paints and also for cleaning up mastics and sealants.
- These can be harmful to the extended life of the powder coated surface, and must not be used for cleaning purposes.
- It is important to note that the damage will not be visible immediately and may take up to 12 months to develop.

If paint splashes or sealants and mastics need to be removed then the following may be safely used:
Methylated Spirits, Ethyl Alcohol, Isopropanol or preferably a mild detergent in warm water.

Joinery Protection during Installation:

All the activity on a construction site means that your powder coated items may get knocked or scratched, splattered with mortar, plaster, textured coating or paint during the later stages of construction.

Please ensure that all powder coated articles are masked or covered at this time. It is far easier to prevent accidents than to try and correct them. Should your joinery receive mortar or paint splashes see that these are removed before cure and follow the instructions contained in this brochure.

Typical sticker used to warn other trades of the need to protect and mask off powder coated joinery (applies to anodised joinery also)

"IMPORTANT ALL TRADES"
This valuable aluminium joinery will suffer permanent damage from: plaster, mortar and paint splashes - Protect if splashes occur - Immediately wash down joinery with water or meths - Do not allow splashes to harden! - Do not use solvents! - Do not remove this label until final clean completed.

This photograph displays damage that has occurred on site, post installation. The photo of the masked joinery displays clear signs of damage that could have occurred were it not masked. Please ensure that your joinery is protected right through the entire construction process.



Powder Coating Maintenance

External - Maintenance Program:

To extend the life of external powder coated articles and to comply with warranty requirements for powder coated aluminium joinery, a simple, regular maintenance program must be implemented.

The effects of ultra violet light, atmospheric pollution, dirt, grime and airborne salt deposits will all accumulate over time and must be removed or surface staining and weathering will occur, leading to an unsightly appearance.

For external coatings, cleaning should take place every six months. In areas where pollutants are more prevalent, such as beachfront houses and industrial or geothermal areas, then a cleaning program should be carried out on a more frequent basis ie. every one to three months.

Cleaning your powder coating:

1. Carefully remove any loose surface deposits with a wet sponge.
2. Use a soft brush (non abrasive) and a mild household detergent (do not use solvents) in warm water, remove dust, salt and other deposits.
3. Rinse off with clean fresh water.



Restoring weathered or scratched surfaces:

Repair of Scuffed or Scratched surfaces

Dulux Spray Cans are available in all colour card colours.

Repair of Small Scratches or Chips.

Dulux Dabsticks are ideally suited for the repair of small scratches.

Dabsticks may not be available in all colour card colours.

Repair of Weathered areas .

Dulux Gloss Up is a light to medium cutting cream ideally suited for gloss restoration and has been specifically designed for this purpose.

Gloss Up contains no waxes or silicone and is a one step system.



Contact Dulux Powder Coatings , ph 0064 9 441 8244