

Briton

2300 Series

Door controls

The Briton 2300 Series incorporates cam action technology to reduce the resistance encountered when opening fire or smoke barrier doors.

The 2300 series makes opening fire doors much easier, ensuring that the elderly, children, and those with physical disabilities are able to exit the building easily.

In contrast to a conventional rack and pinion door closer, the linear cam action principle is extremely efficient. The initial opening force decreases as the door opens, and the closer retains power and control to close the door afterwards.

The Briton 2300 Series offers easy opening and reliable closing, while meeting accessibility standards.



Features

- Extruded aluminium body with cam action technology
- High quality hydraulic fluid with built-in temperature compensation (will operate effectively between -15 to +40 degrees Celsius)
- Adjustable backcheck as standard
- Adjustable closer strength 2 – 4
- Separate closing speed and latch action adjustment
- Optional mechanical hold-open available: 80° - 120° angle

| Warranties | |
|------------|--|
| Mechanical | 10 years |
| Finish | allegion.co.nz/finisheswarranty |

Specification guide

| Series | Function | Finish |
|---|-------------|--|
| Briton cam action closer strength 2-4 pull side.....BNT-2320B | Track.....T | Electroplated stainless steel cover.....SS |
| Briton cam action closer strength 2-4 push side.....BNT-2321B | | |
| | | Slide Cover Options |
| | | Silver.....SE |
| | | Matt black.....B |

1. Series

Select the desired series e.g. Briton cam action closer strength 2-4 pull side BNT-2320B

2. Function

Select the desired function e.g. Track BNT-2320BT

3. Finish

Select the desired finish e.g. Electroplated stainless steel BNT-2320BT-SS

Finishes

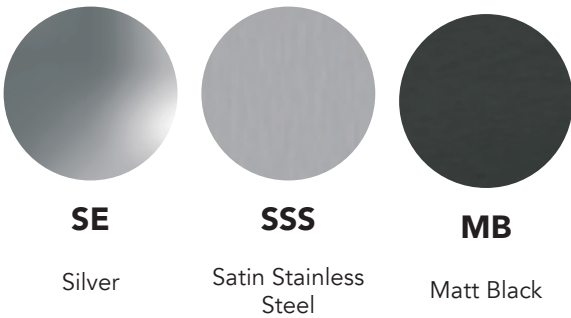

Specifications

| | |
|----------------------------|--|
| Door type | Timber or metal |
| Door size | Max width: 850mm – 1100mm Max weight: 40kg – 80kg |
| Applications | Regular – pull side mount Stop face – push side mount |
| Adjustment controls | Closing speed Latching speed Backcheck |
| Strength | 2-4 adjustable |

Testing and Compliance



Fire Rating:

Successfully tested on fire door assemblies in accordance with AS1905 Part1: Fire resistance doorsets. Check with fire door manufacturer prior to installation.

Front/Arm

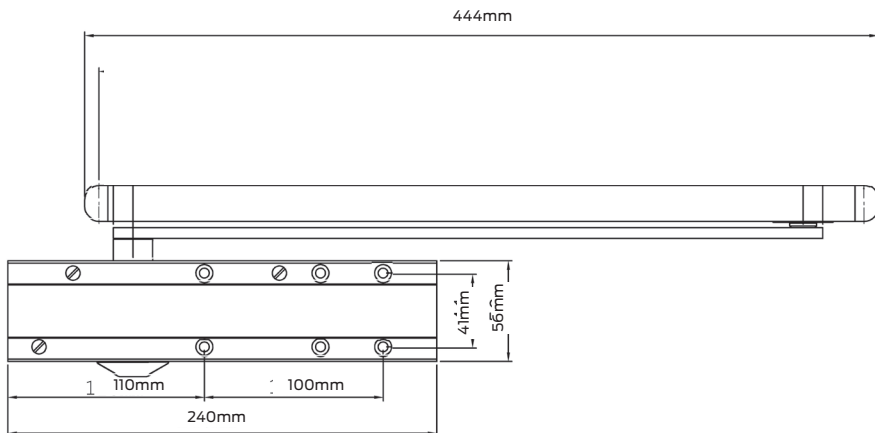

Side

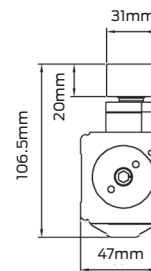

Cover

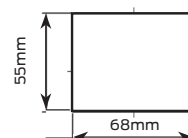
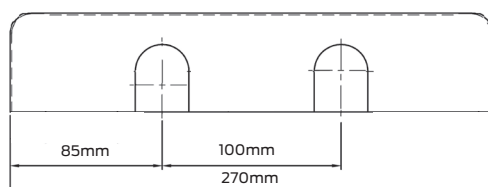

Regulating controls

The Briton 2300 has independent regulators to control:

| | |
|-----------------------|--|
| Closing speed | Adjustment to increase or decrease the speed at which the door closes. This allows the appropriate momentum to close the door in a safe and secure manner. Closing speed adjustment operates from the maximum opening to 15° |
| Latching speed | The latching speed allows the door to close quietly and firmly. It can be adjusted to increase or decrease the speed at which the door finally closes. This assists the final stage of the closing cycle to help overcome stubborn latch bolts or air pressure conditions. Alternatively the latching speed can be decreased to cushion the door into the frame. The latching speed adjustment operates from 15° to closing. |
| Backcheck | Adjustable hydraulic backcheck provides a cushioning effect to prevent damage to the closer, door and frame when the door is forcibly thrown open. The backcheck adjustment allows the level of resistance in the latter stage of opening to be set at the level required. Backcheck is effective from 75°. Backcheck is a requirement for all fire rated closers |

Functions

| | |
|------------------|--|
| Regular | For applications where the door must fully close after each opening |
| Hold open | Suitable for doors where the door may need to be left in a hold open position. The hold open function can be set to hold open at a single point. Hold open closers can not be used on fire doors |

2300 Series accessories

Hold open conversion kit

Allows doors to be held open at desired position. Not to be used on fire doors.

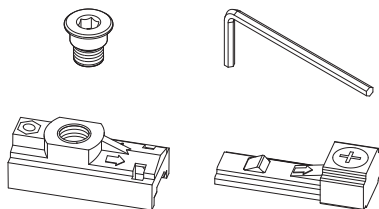

Angle mounting bracket

When mounting closers to the push side

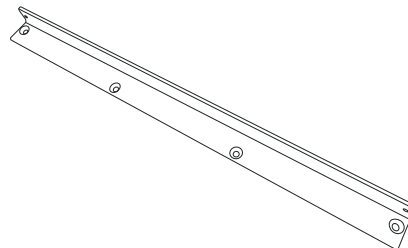

Cushion limit stay

Optional cushion limit stay for standard applications to assist slowing door in opening cycle

