

Bi-fold sill and roller.

Key Features

- Bottom rolling with an in-frame track for optimum panel support
- A wide range of configurations available
- Assured smooth operation through enhanced adjustability
- Adjustable jamb pivots remove any stresses in bi-fold geometry
- A slender door stile and rail option is available to minimise visual intrusion
- Overlights possible
- Maximum glass thickness of 44mm IGU – compliance with NZBC clause H1 Energy Efficiency requires high performing Low-E double glazing.



Narrow rail option.



Urbo, Miro and Icon bi-fold handle.

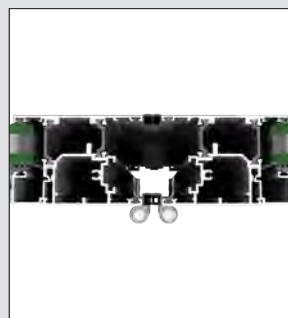

Bi-fold door meeting stiles.

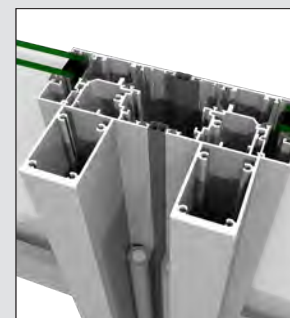

Bi-fold door meeting stiles with exterior box stiffeners.

Specifications

Dimensions

Recommended maximum panels of 2700mm high by 900mm wide

Maximum Glass Thickness

44mm IGU

Thermal Values

Complies with the Construction R-values provided in NZBC clause H1, Appendix E, table E1.1.1.

Performance

Tested to Extra High wind zone

Design Considerations

- Careful consideration of bi-fold use is required when projecting on to decks or pedestrian areas
- A good option for maximum views and ventilation when open, but needs to be monitored if windy conditions occur
- A slender door stile and rail option is available to minimise visual intrusion in the closed position
- Free-swinging panels can provide easy exit in bi-fold sets
- In closed position, bi-fold door stiles impact views.