

Sliding door sill - single panel.

Key Features

- Smartwood sliding doors slide on an exterior track
- Accompanying opening windows for ventilation can be used in overlights or non-stack adjoining fixed panels (FSF configurations)
- Three sliding panels stacking in front of an adjoining fixed light are possible for maximum opening.



Sliding door rail with sightline adaptor behind.

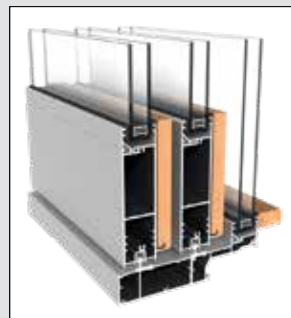

Two-track sliding door sill with standard fixed light behind.

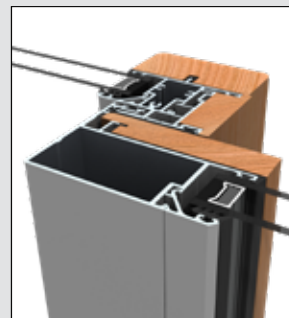

Sliding door interlocker mullion.



The sliding door roller is rated to 150kg so panels of 300kg can be carried.

Specifications

Dimensions

Recommended maximum panels of 2400mm high x 1200mm wide. Sliding door rollers are rated to 150kg each (300kg per panel)

Maximum Glass Thickness

32mm IGU

Thermal Values

U-value 4.601 R-value 0.217

Performance

Tested to Very High wind zone

Design Considerations

- Smartwood products need sealing after installation with an appropriate finish e.g. oiled, varnished, stained or painted - regular care and restoration recommended
- Smartwood three-panel sliding doors allow approximately three-quarters opening
- Narrow stiles and large glass expanses maximise views in the closed position compared with bi-folds
- Window ventilation options with Smartwood sliding doors are available in overlights or in adjoining (non-stack) sidelights
- For enhanced flush indoor-outdoor levels consider recessing the sill into the floor pad to minimise the upstand.

