

# MAGNUM 50, A520CD OPEN IN HINGED DOOR FRENCH DOOR MEETING STILE OPTIONS

## CROSS SECTION

Cad Ref. ACMD03-0 Scale 1:2 Date 01.06.11

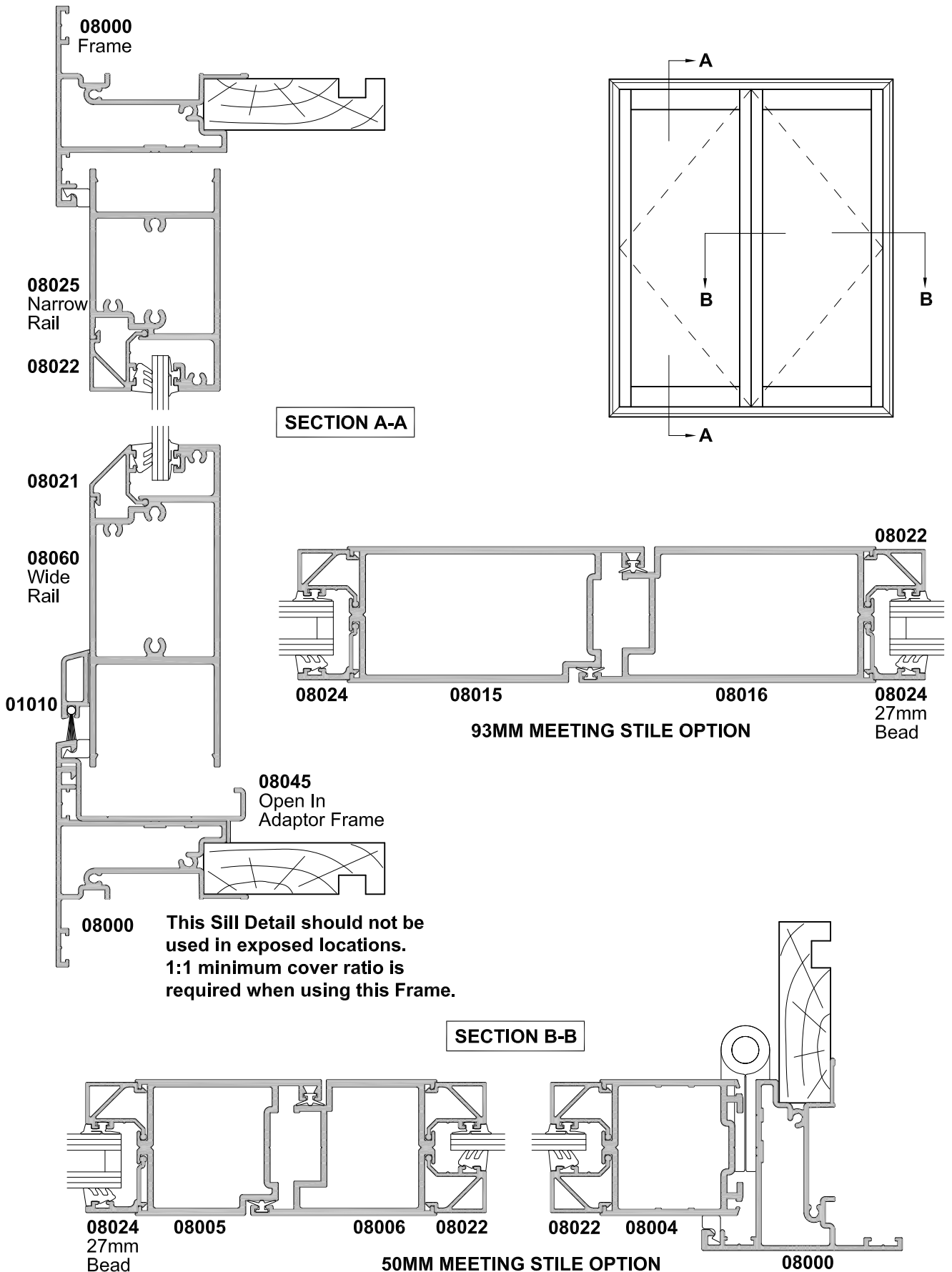

# MAGNUM 50, A500CD OPEN OUT HINGED DOOR WITH COUPLED SIDELIGHT

## CROSS SECTION

Cad Ref. ACMD04-0 Scale 1:2 Date 01.01.09

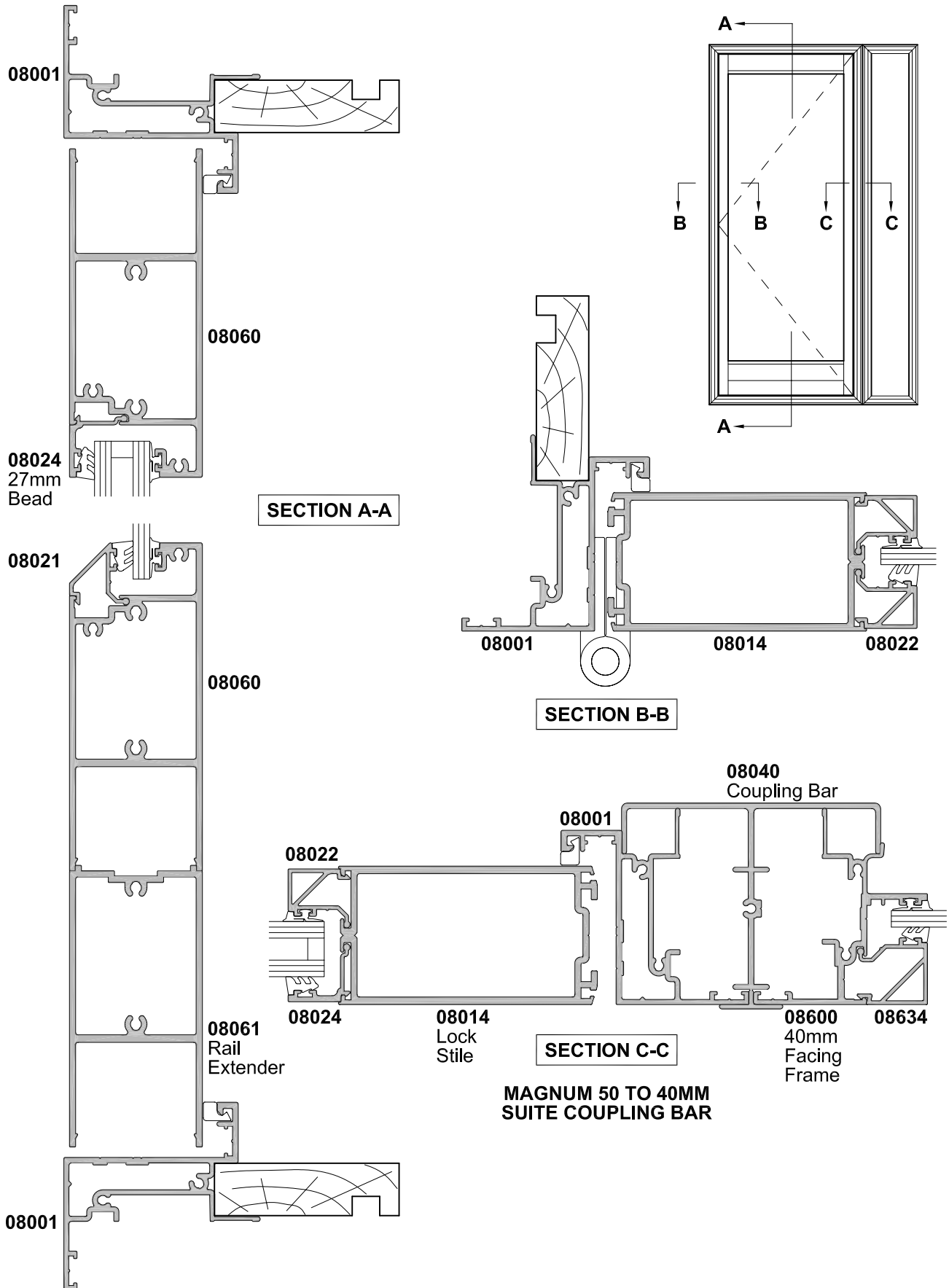

# MAGNUM 50, A500CD HINGED DOOR INTO 100MM SHOPFRONT, SILL OPTIONS 40MM ADAPTORS

## CROSS SECTION

Cad Ref. ACMD05-0 Scale 1:2 Date 01.01.09

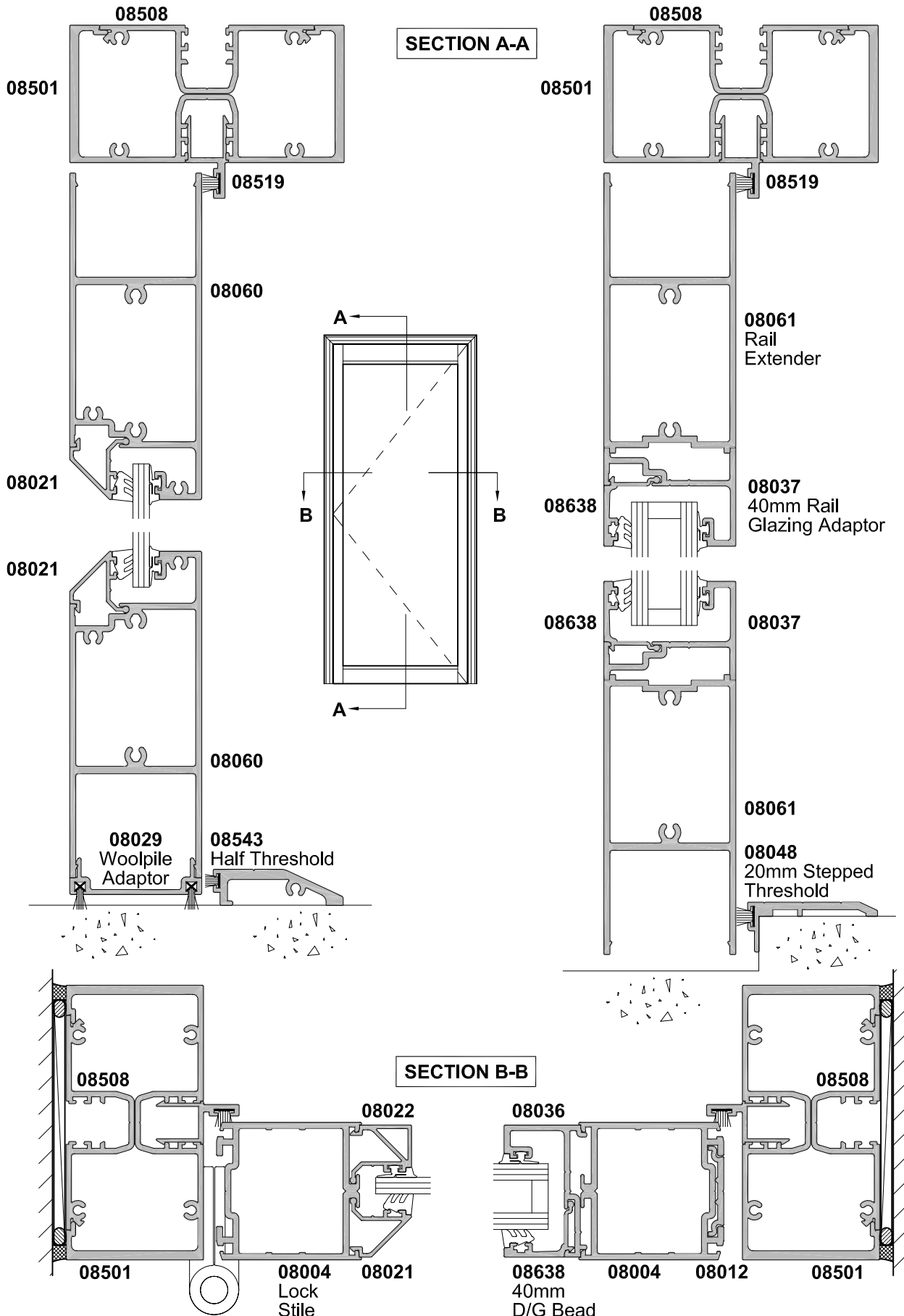

# MAGNUM 50, A700CD SLIDING DOOR INTO 100MM SHOPFRONT 4 PANEL, MEETING STILE OPTIONS

## CROSS SECTION

Cad Ref. ACMD06-0 Scale 1:2 Date 01.01.09

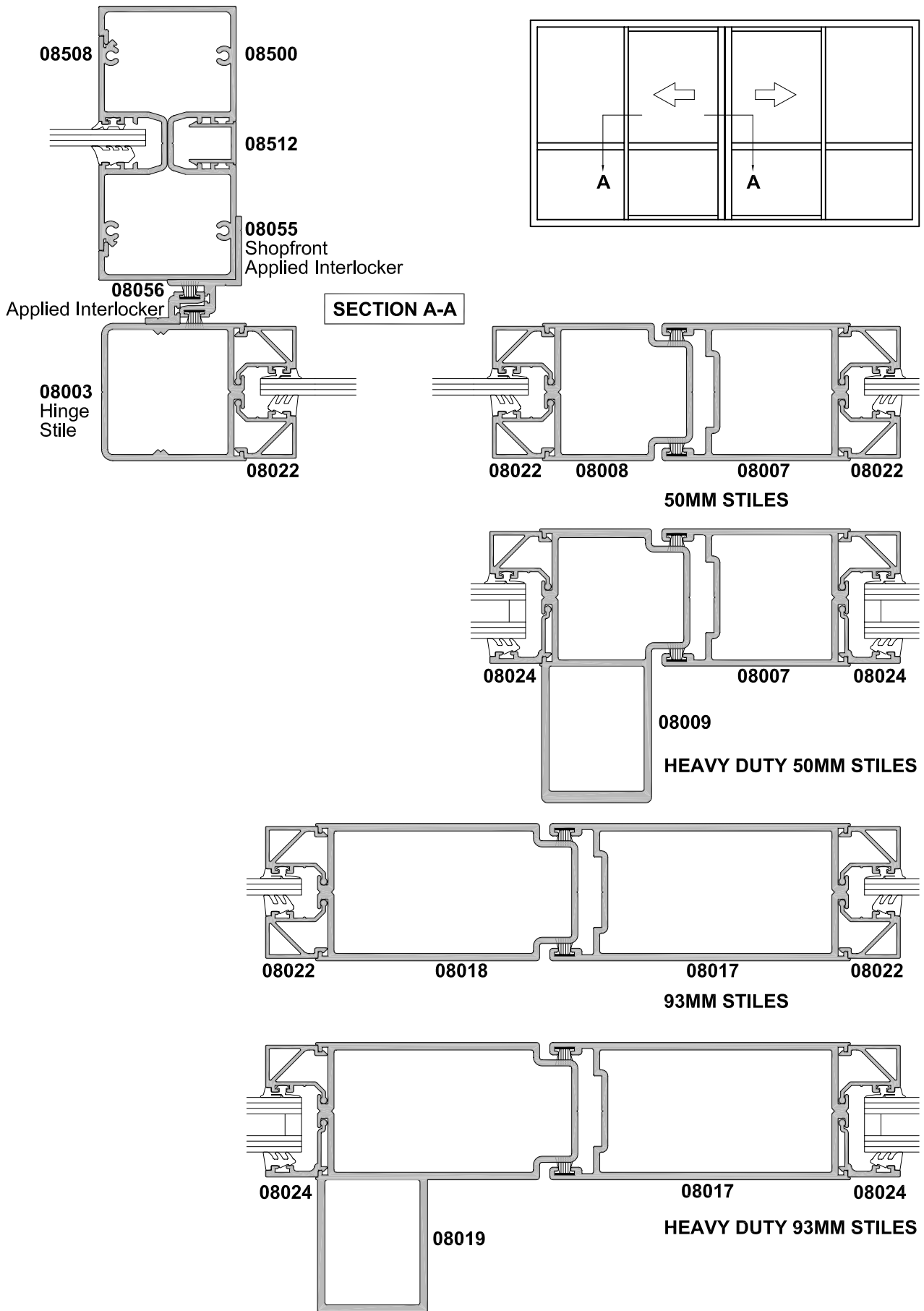

# MAGNUM 50, A700CD SLIDING DOOR INTO 100MM SHOPFRONT, VISION RAIL OPTIONS

## CROSS SECTION

Cad Ref. ACMD07-0 Scale 1:2 Date 01.01.09

**08050**  
Door Channel  
Mounting Bracket

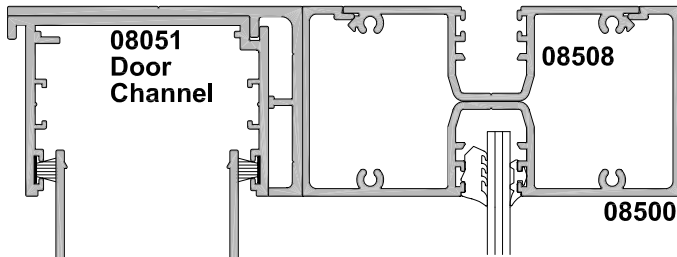
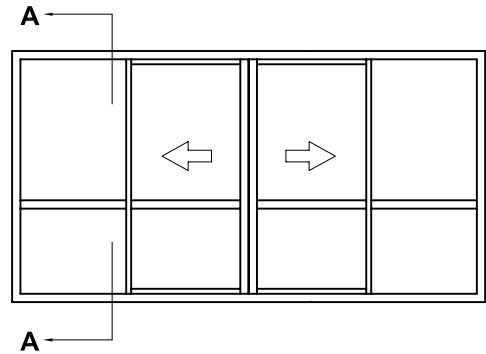

08060

SECTION A-A

08021

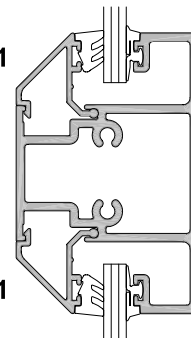

08030

08021

74 MM VISION RAIL  
TO SUIT 40MM TRANSOM

08022



08021



**08031**  
50mm  
Sloped  
Vision  
Rail

08510

08502

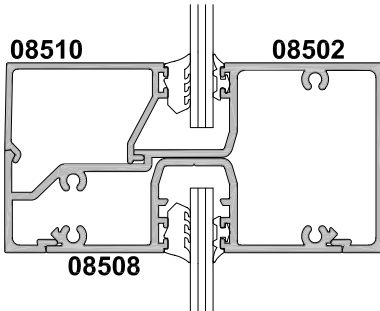

08508

08022

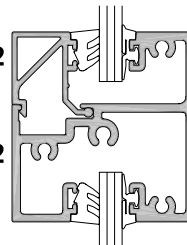

08032

50MM SQUARE  
VISION RAIL

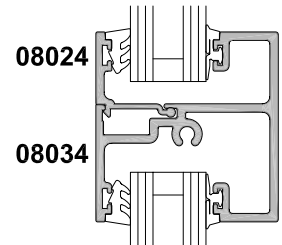

08024

08034

50MM D/G  
VISION RAIL

08021



08060

08511

08502

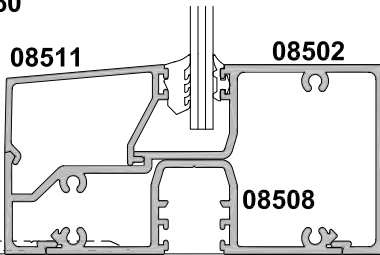

08508

08503

08024

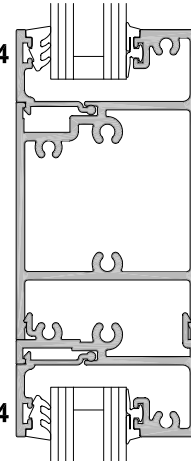

08025

08024

08028

VISION RAIL OPTIONS  
STANDARD

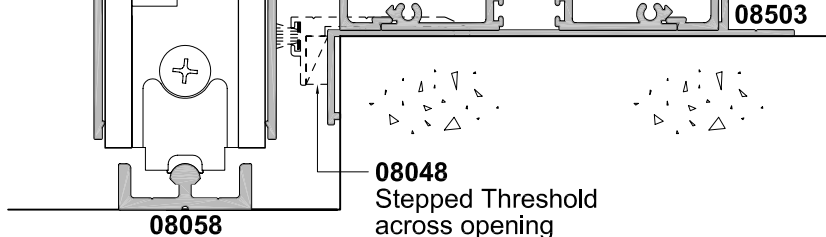

**08048**  
Stepped Threshold  
across opening

08058

# MAGNUM 50, A700CD SLIDING DOOR INTO 100MM SHOPFRONT WITH DUO SLIDER

## CROSS SECTION

Cad Ref. ACMD08-0    Scale 1:2    Date 01.01.09

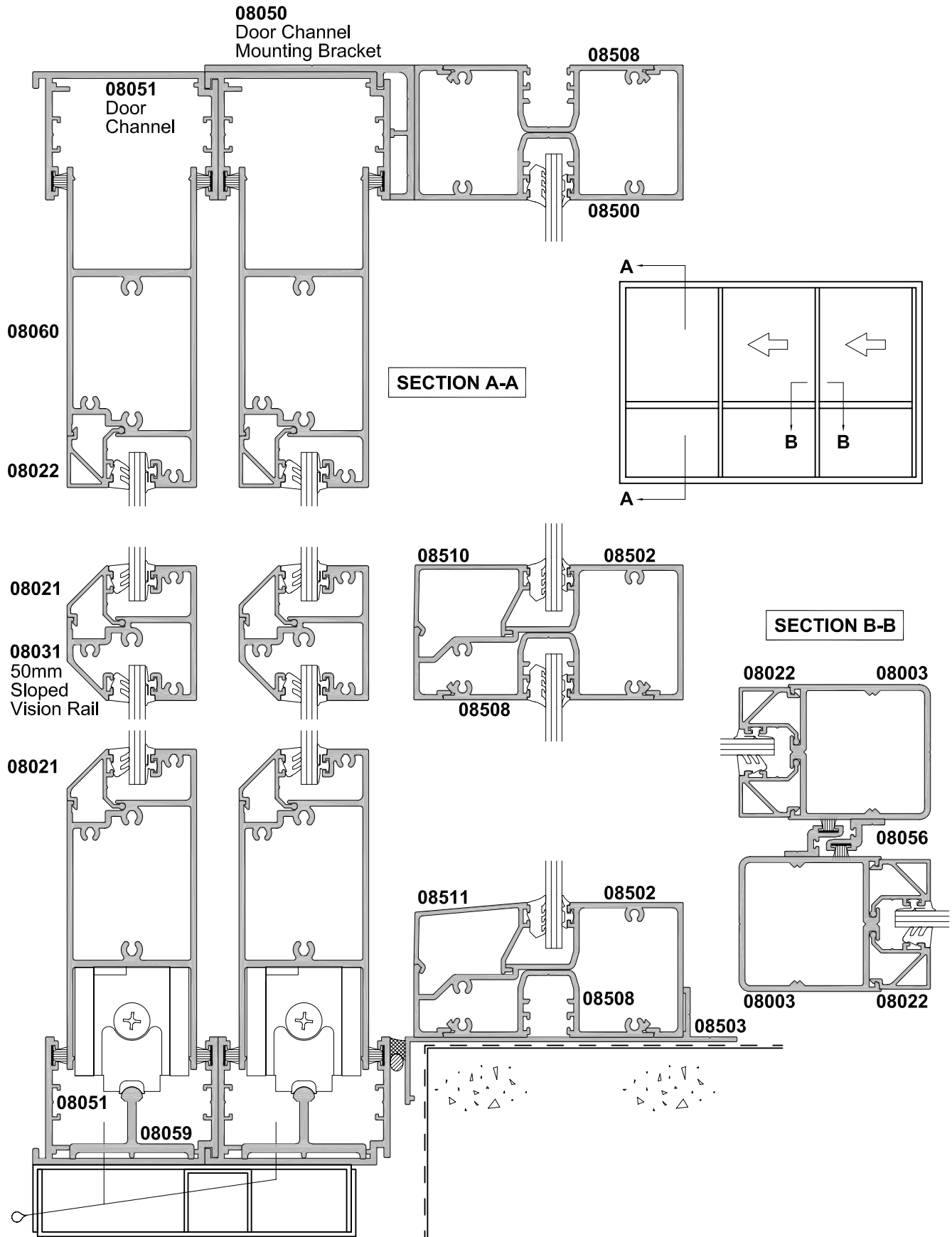

NOTE: This detail is indicative only and will differ for various claddings and building in situations.  
Contact Technical Advisory Service for more information

# MAGNUM 50, A700CD SLIDING DOOR VISION RAIL AND BEAD OPTIONS

## CROSS SECTION

Cad Ref. ACMD09-0    Scale 1:2    Date 01.01.09

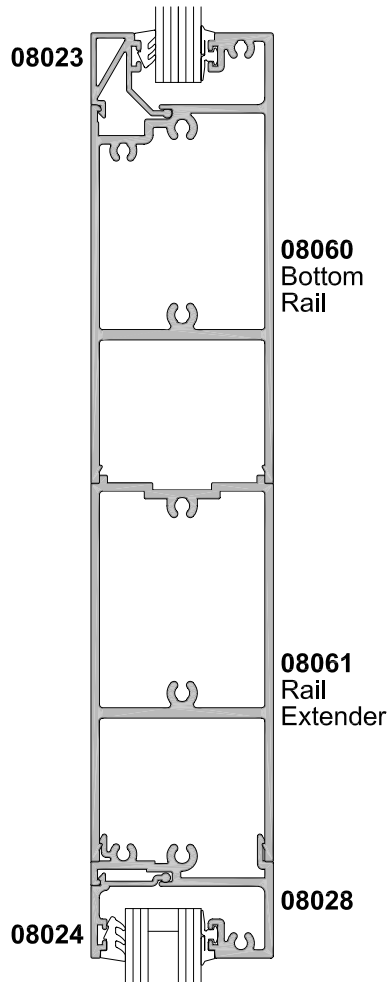
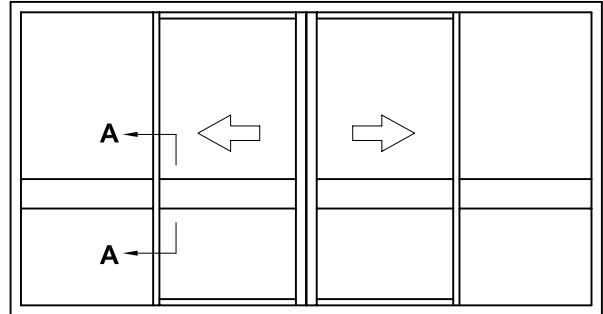

SECTION A-A

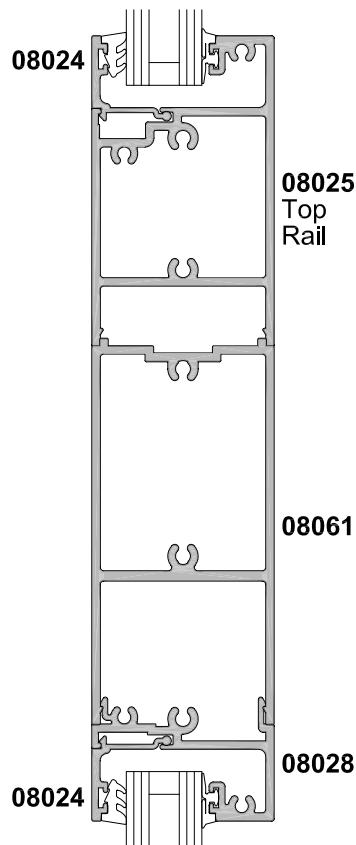

SECTION A-A

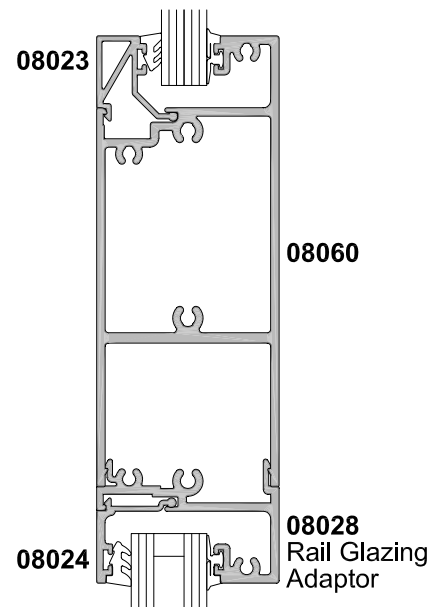

SECTION A-A



# MAGNUM 50, A700CD SLIDING DOOR INTO 100MM SHOPFRONT

## CROSS SECTION

Cad Ref. ACMD10-0    Scale 1:2    Date 01.01.09

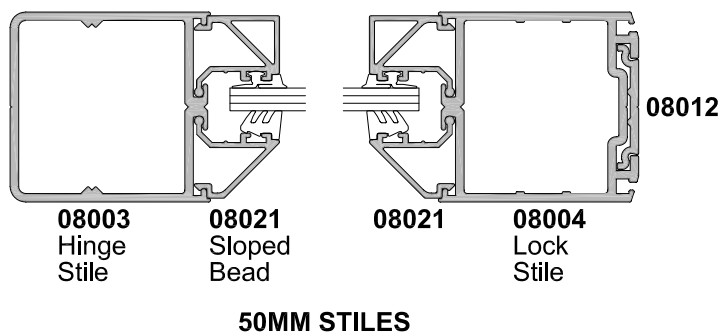
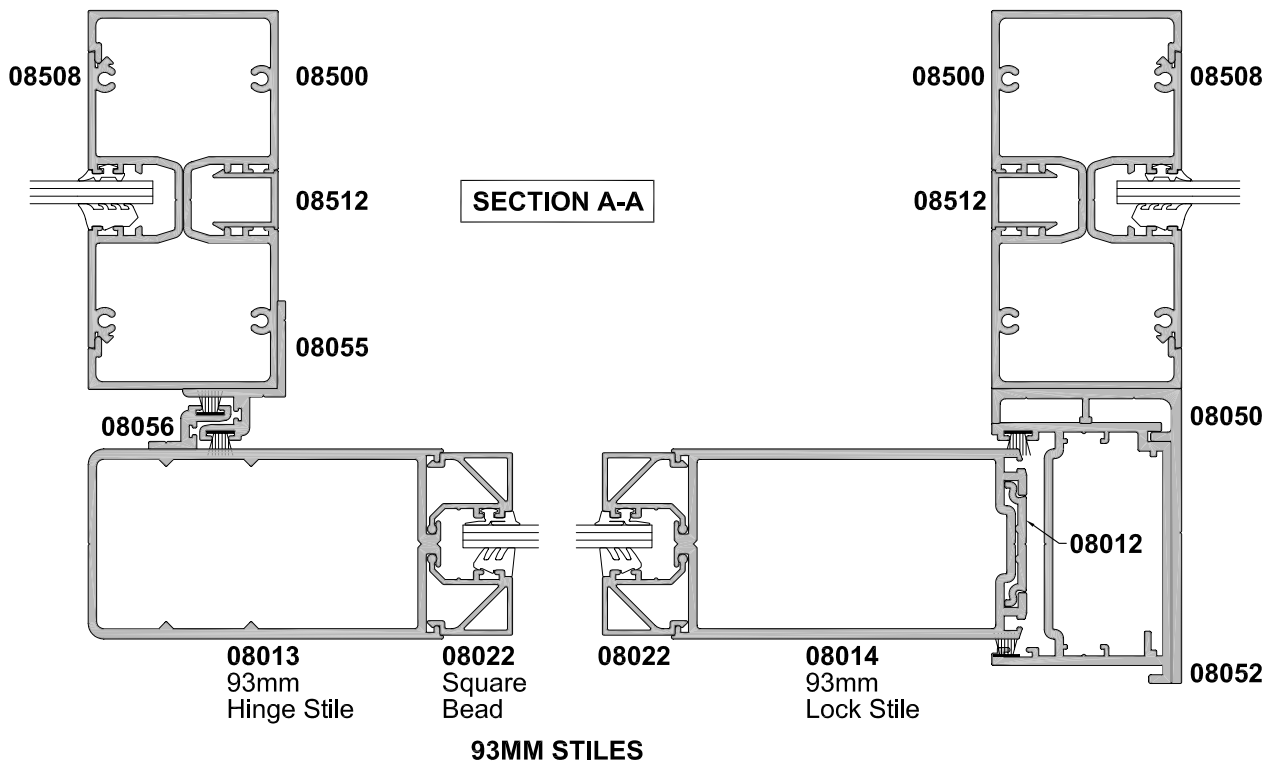
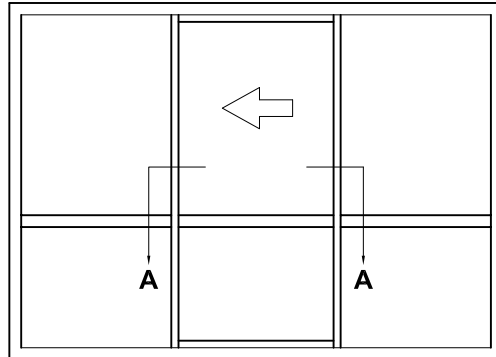

# MAGNUM 50 A700CD SLIDING DOOR OVER WALL CROSS SECTION

Cad Ref. ACMD11-0    Scale 1:2    Date 01.01.09

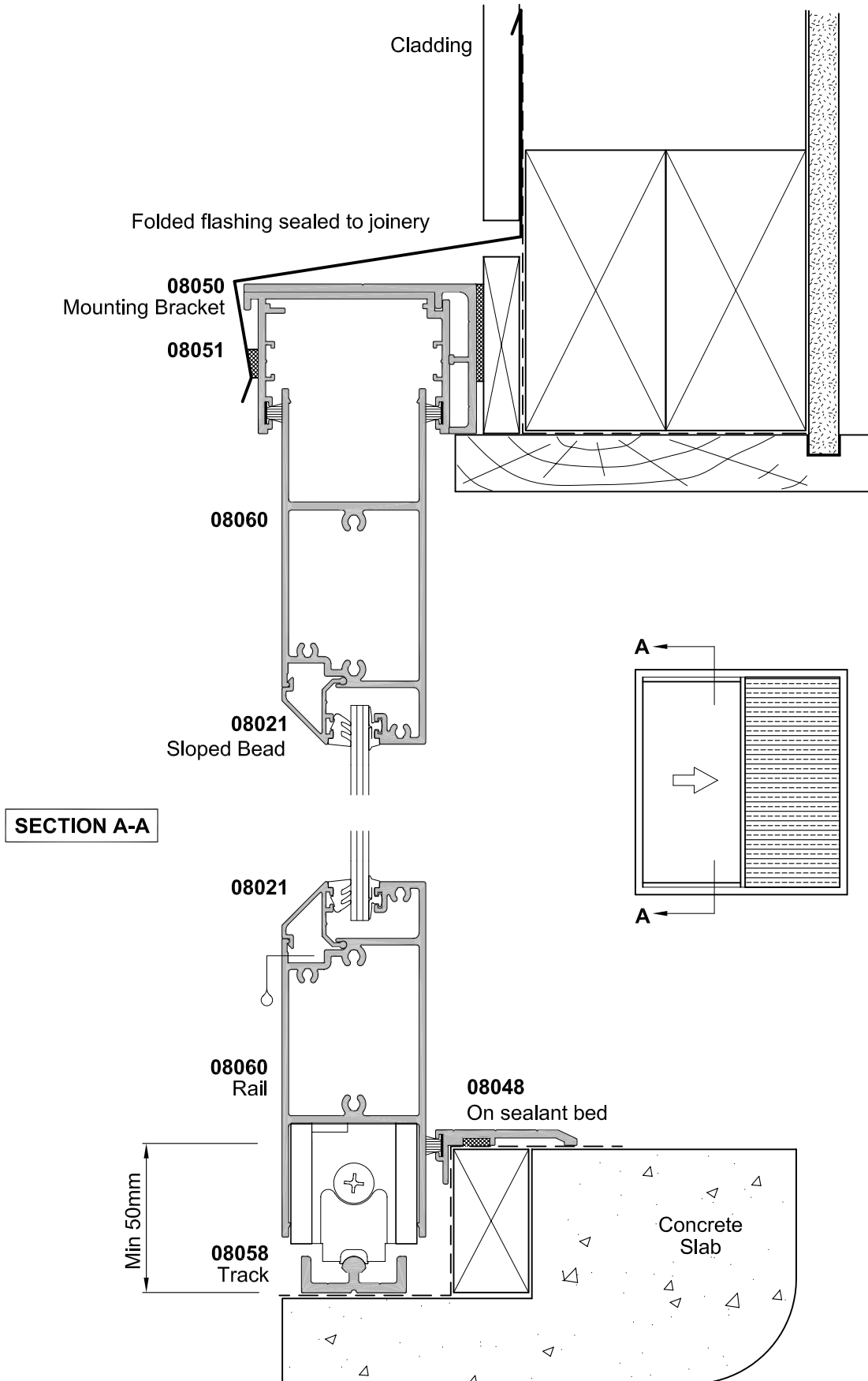

NOTE: This detail is indicative only and will differ for various claddings and building in situations. Contact Technical Advisory Service for more information

**MAGNUM 50**  
**A700CD SLIDING DOOR OVER WALL**  
CROSS SECTION

Cad Ref. ACMD12-0    Scale 1:2    Date 01.01.09

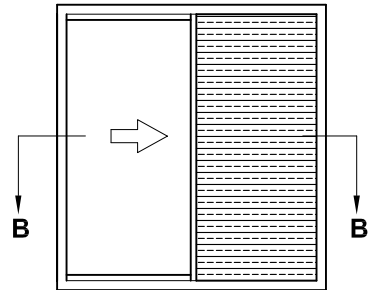

**SECTION B-B**

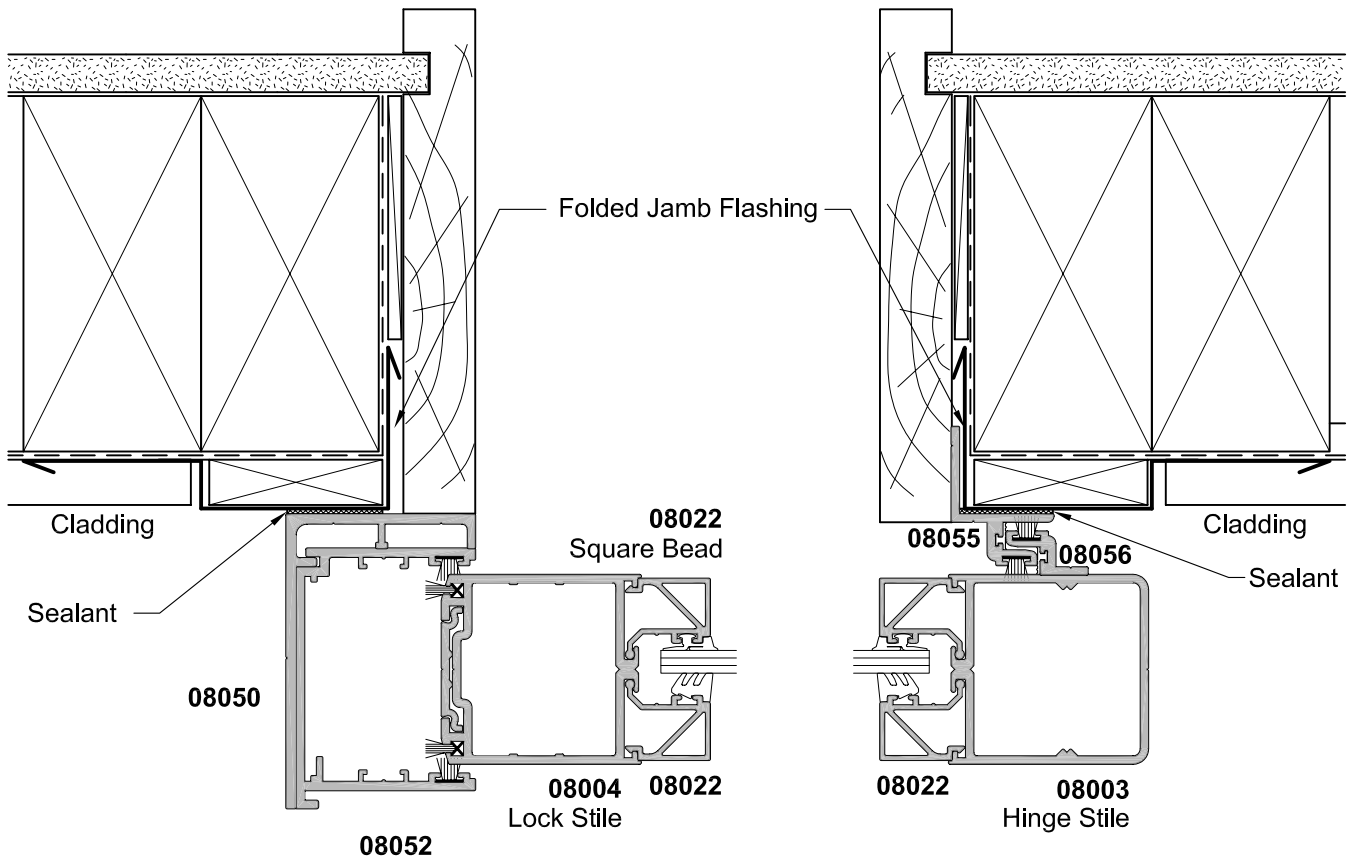

NOTE: This detail is typical only and may differ for various claddings and building in situations.  
Contact Technical Advisory Service for more information

# MAGNUM 50

## A500CD HINGED DOOR INTO 40MM SERIES

### CROSS SECTION

Cad Ref. ACMD13-0    Scale 1:2    Date 01.01.09

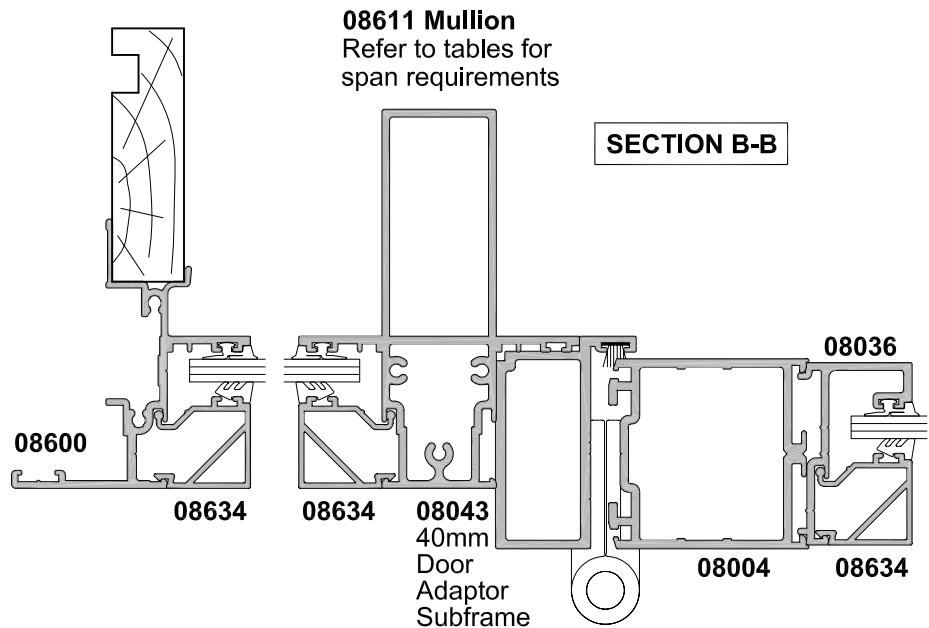
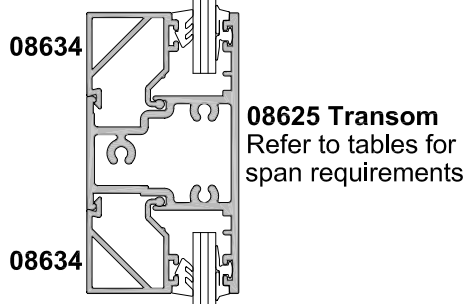
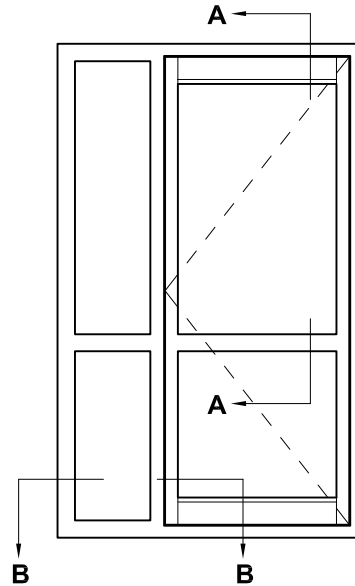
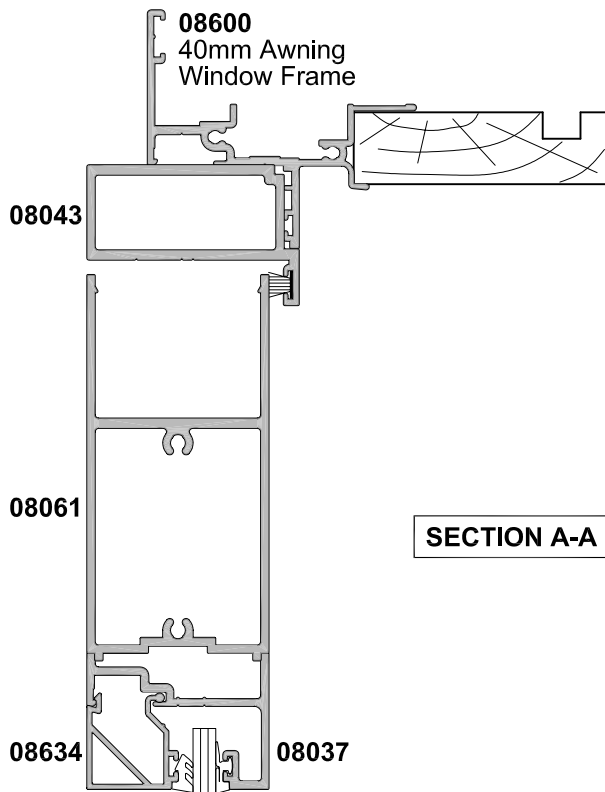

# MAGNUM 50 A500CD HINGED DOOR WITH COMPOSITE VISION RAIL CROSS SECTION

Cad Ref. ACMD14-0 Scale 1:2 Date 01.01.09

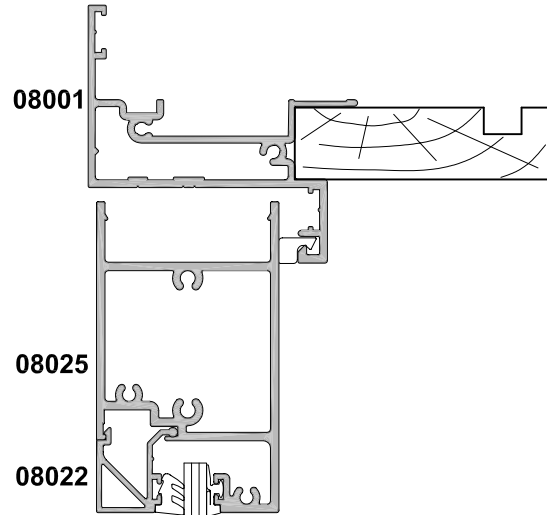

SECTION A-A

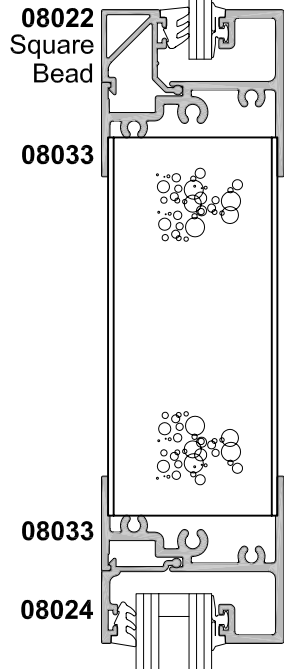

SECTION B-B

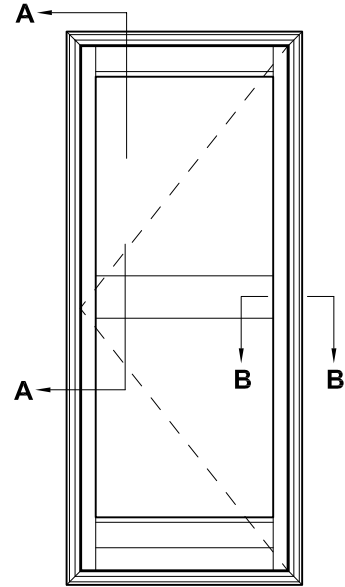
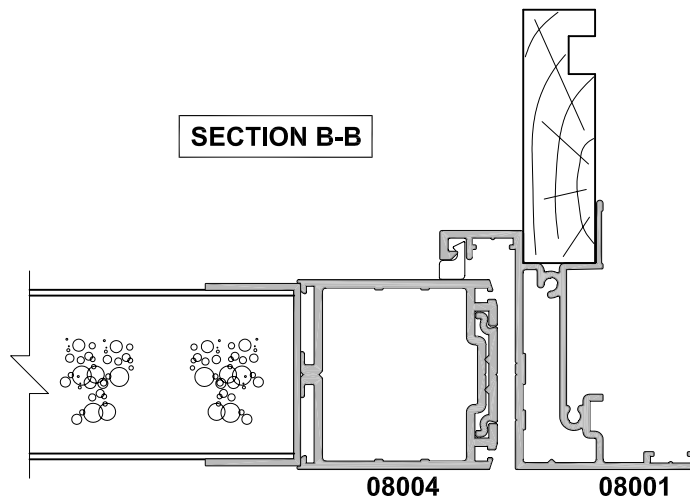

# MAGNUM 50

## A500CD HINGED DOOR INTO 100MM FLUSHGLAZE

### CROSS SECTION

Cad Ref. ACMD15-0    Scale 1:2    Date 01.01.09

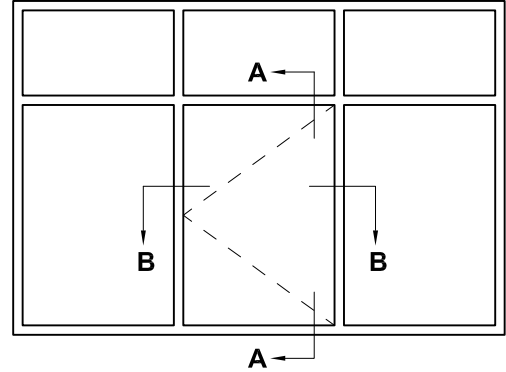
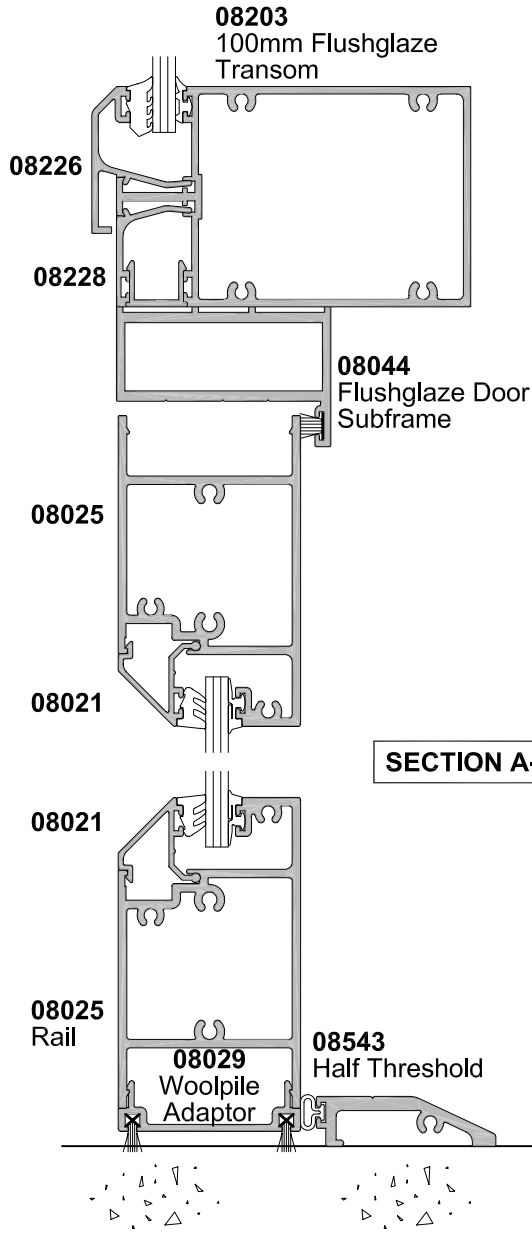

**SECTION A-A**

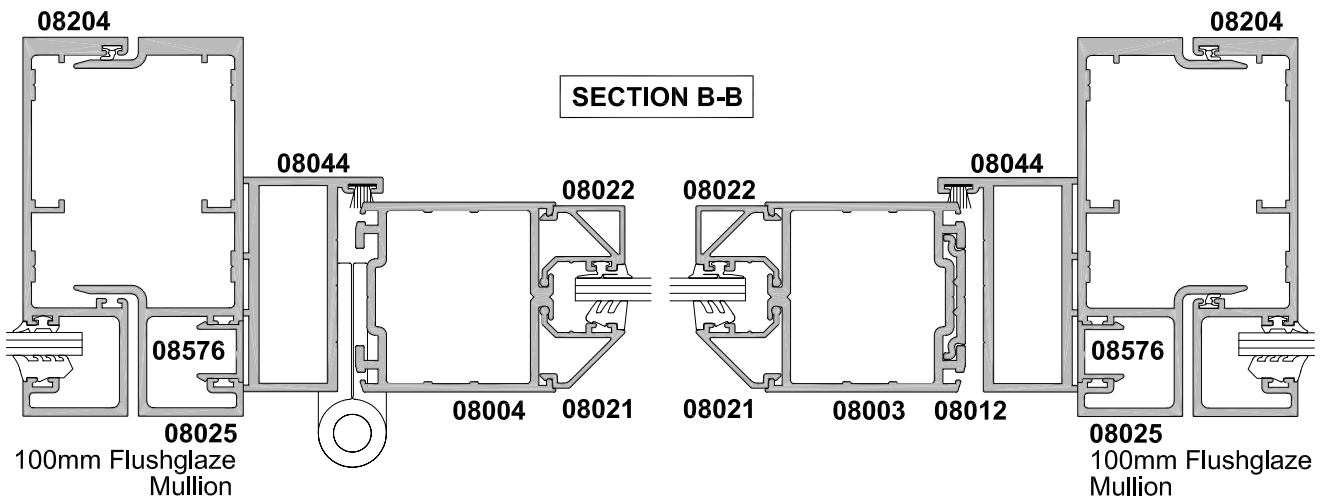

**SECTION B-B**

# MAGNUM 50, A500CD OPEN OUT HINGED DOOR WITH ARCHITECTURAL DOOR PANEL

## CROSS SECTION

Cad Ref. ACMD16-0 Scale 1:2 Date 01.01.09

