

# A100GB GLAZING BARS, GABLE GLAZING LEAN-TO, SMALL FIN RAFTER CROSS SECTION

Cad Ref. ACOG03-0 Scale 1:2 Date 01.01.09

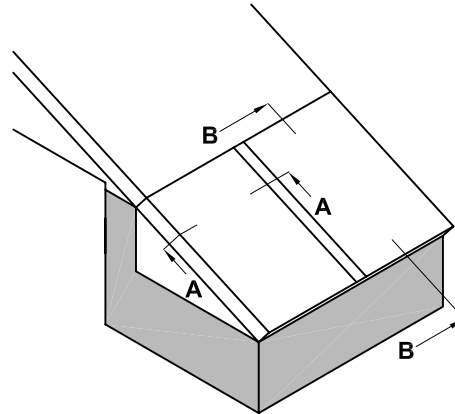

Folded flashing on bed of suitable sealant

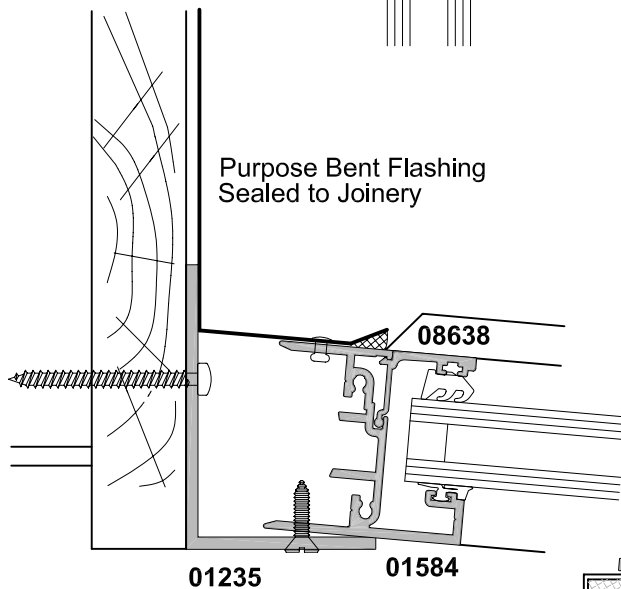
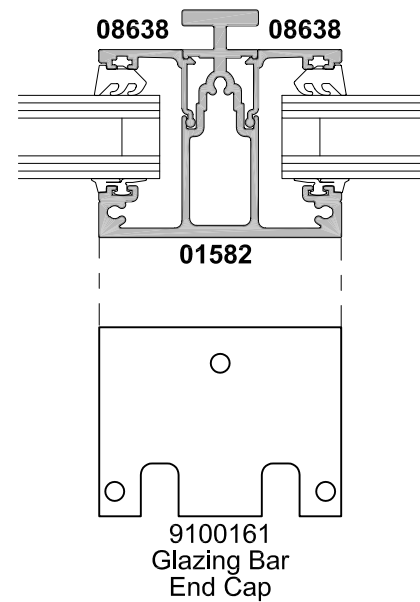
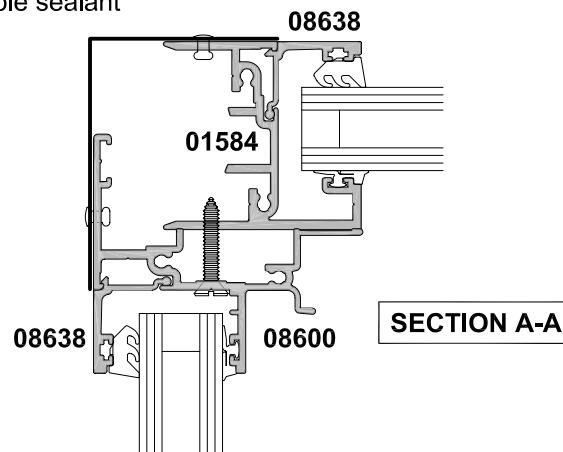

**SECTION B-B**

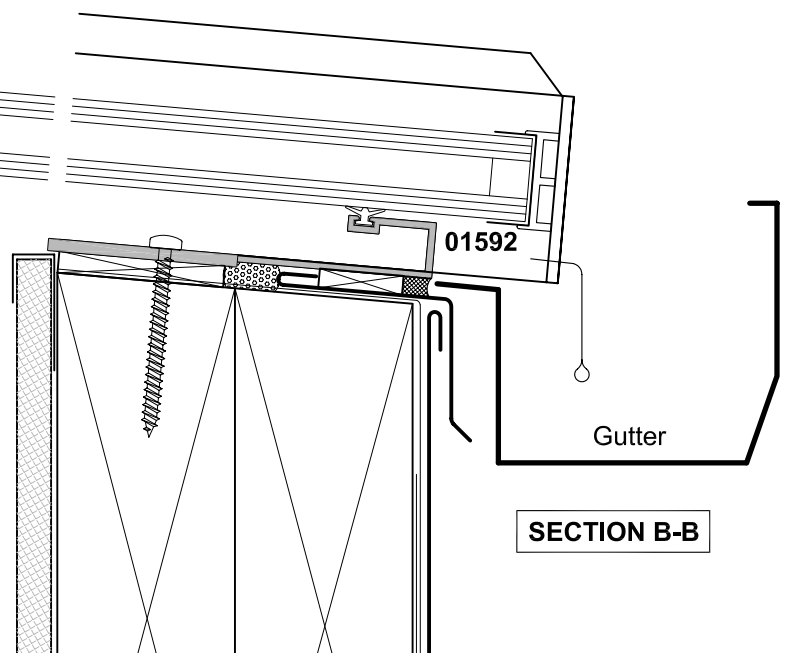

Note:  
A Minimum Pitch of 5° (Double Glazing) is required to allow water to run off the glass.