

BYTUM BAND

SELF-ADHESIVE BITUMINOUS BAND, CAN BE PLASTERED



CAN BE PLASTERED

Polypropylene means the fabric can be plastered, offering greater versatility.

COST - PERFORMANCE

The bituminous mixture guarantees good adhesion, even on concrete.

COMPOSITION

- 1 release liner: silicone coated paper
- 2 glue: black adhesive bituminous compound
- 3 support: non-woven PP fabric



TECHNICAL DATA

Properties	standard	value	USC units
Tensile strength MD/CD	EN 12311-1	140/105 N/50 mm	16/12 lbf/in
Elongation MD/CD	EN 12311-1	100/100 %	-
Initial Tack +23/+5 °C	ASTM D 2979	7/1 N	1.6/0.2 lbf
Adhesion strength on concrete	ASTM D 1000	2,9 N/mm	16.56 lbf/in
Adhesion strength of class C2E cementitious glue on TNT	EN 12004/EN 1348	0,9 N/mm ²	130.53 lbf/in ²
Reaction to fire	EN 13501-1	class E	-
Resistance to temperature	-	-30/+80 °C	-22/+176 °F
Application temperature ⁽¹⁾	-	+5/+40 °C	+41/+104 °F
Storage temperature ⁽²⁾	-	+5/+40 °C	+41/+104 °F
Exposure to weather	-	2 weeks	-
VOC	ISO 16000	8 µg/m ³	-

⁽¹⁾ On dry support and at a temperature > 5 °C. The absence of condensation or frost on the surface must be guaranteed.

⁽²⁾ Store the product in a cool, dry place for no more than 12 months. It is recommended to store the product at room temperature until application, as it is sensitive to temperature changes. We recommend applying it during the cooler hours in summer and the warmer hours in winter, possibly with the help of a hot air gun.

Waste classification (2014/955/EU): 08 04 10.

CODES AND DIMENSIONS

CODE	B [mm]	s [mm]	L [m]	B [in]	s [mil]	L [ft]	
BYTBAND240	240	1	15	9.5	39	49	2
BYTBAND370	370	1	15	14.6	39	49	1

■ FIELDS OF APPLICATION

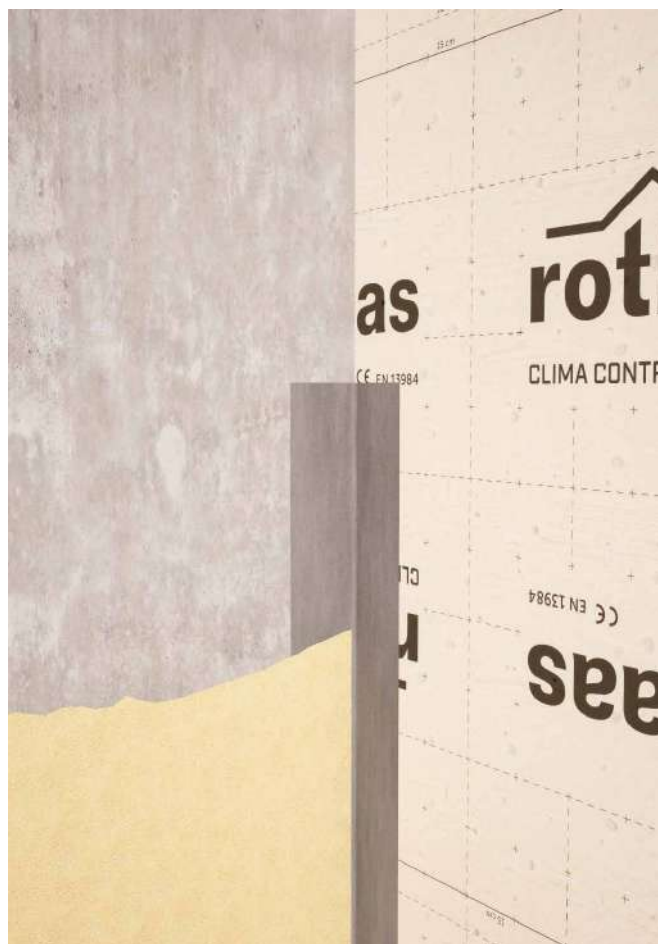

■ RELATED PRODUCTS



BYTUM LIQUID
page 50



BYTUM SPRAY
page 48



HAMMER STAPLER 22
page 396



BYTUM PRIMER
page 53



VERY LOW EMISSIONS

Thanks to the special formulation of the bituminous compound, it guarantees health safety with regard to emissions.

SAFETY

It protects walls and foundation walls against rising damp over time. Also suitable as a general damp-proof course barrier or window/door node waterproofing product.