

ROOFING INDUSTRIES

HALF ROUND GUTTER BRACKETS

Detail Number: R1-F01B

Date drawn: 21/10/2024

Scale: 1 : 5@ A4

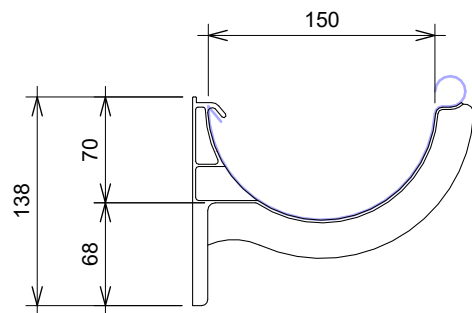

ROOFING INDUSTRIES
150mm HALF ROUND GUTTER BRACKET

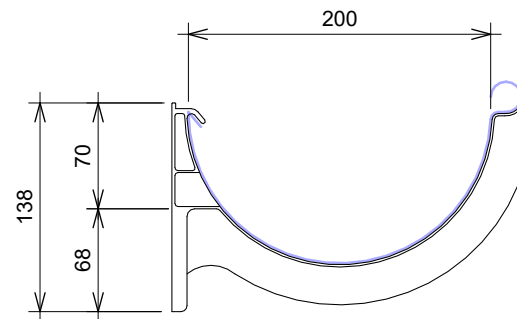
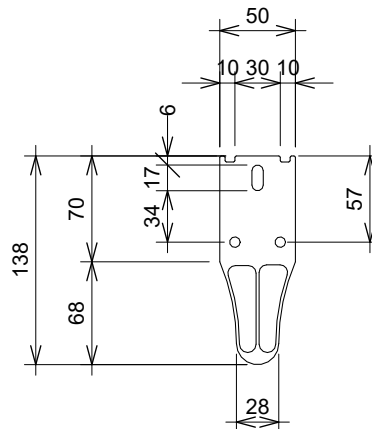

ROOFING INDUSTRIES
200mm HALF ROUND GUTTER BRACKET

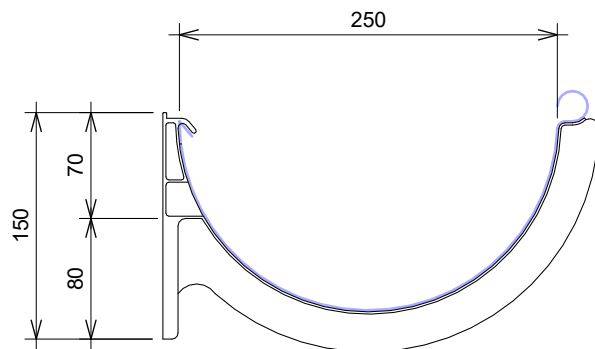

ROOFING INDUSTRIES
250mm HALF ROUND GUTTER BRACKET

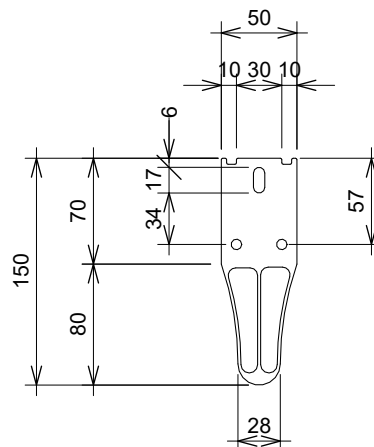

GENERAL NOTES:

- These details to be read with Roofing Industries Product Technical Statement.
- The building designer is ultimately responsible to ensure that the details used meet the requirements of the NZ Building Code for the specific project.
- Details of the supporting structure (including cavity battens if used) are indicative only and are the responsibility of the building designer. For steel framed buildings thermal break cavity battens may be required.
- Roof/wall underlay selection are the responsibility of the designer. Underlay to be installed in accordance with underlay manufacturer's recommendations and requirements.
- These details are for Roofing Industries profile/s as nominated and may not be applicable to other profiles.
- This drawing is the copyright of 'Roofing Industries' and can only be copied or reproduced with their permission.
- Further information can be obtained from the NZ Metal Roof & Wall Cladding Code of Practice: www.metalroofing.org.nz or E2/AS1 where applicable.
- Details are for steel-based materials, other substrates may require some changes.
- All dimensions are nominal.
- Fixing: The designer needs to check the screw manufacturers technical data of the selected screw type for the design wind load and the material being fastened to.

Copyright detail © 2024

