

Euro Roof Snap Lock 25

Scale 1:2

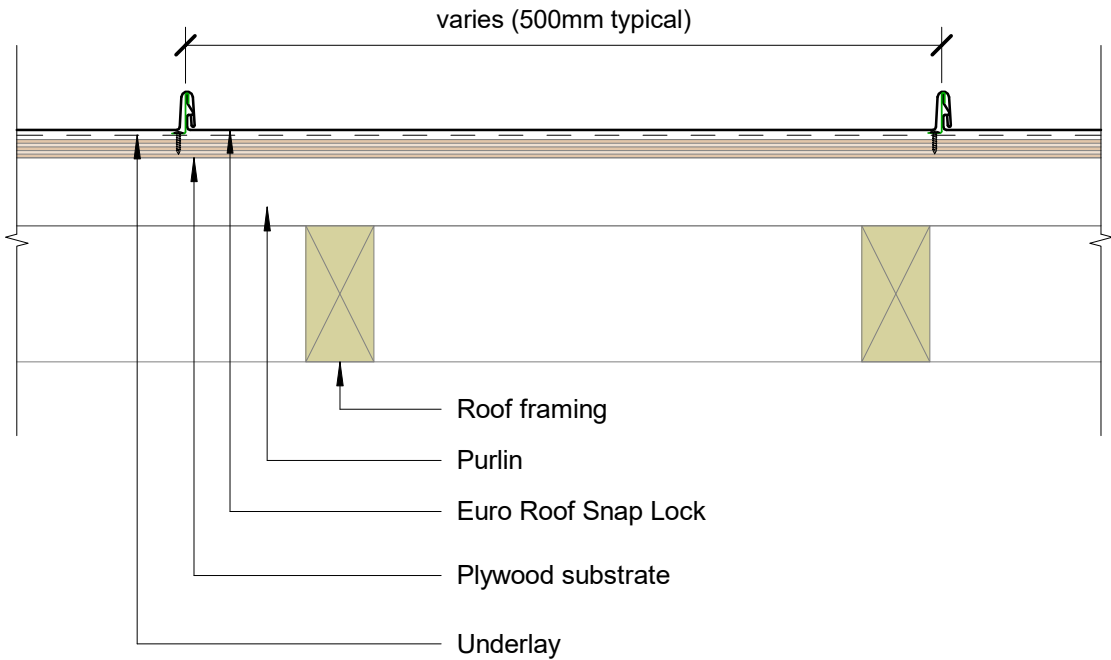

Euro Roof Snap Lock 38



Scale 1:5

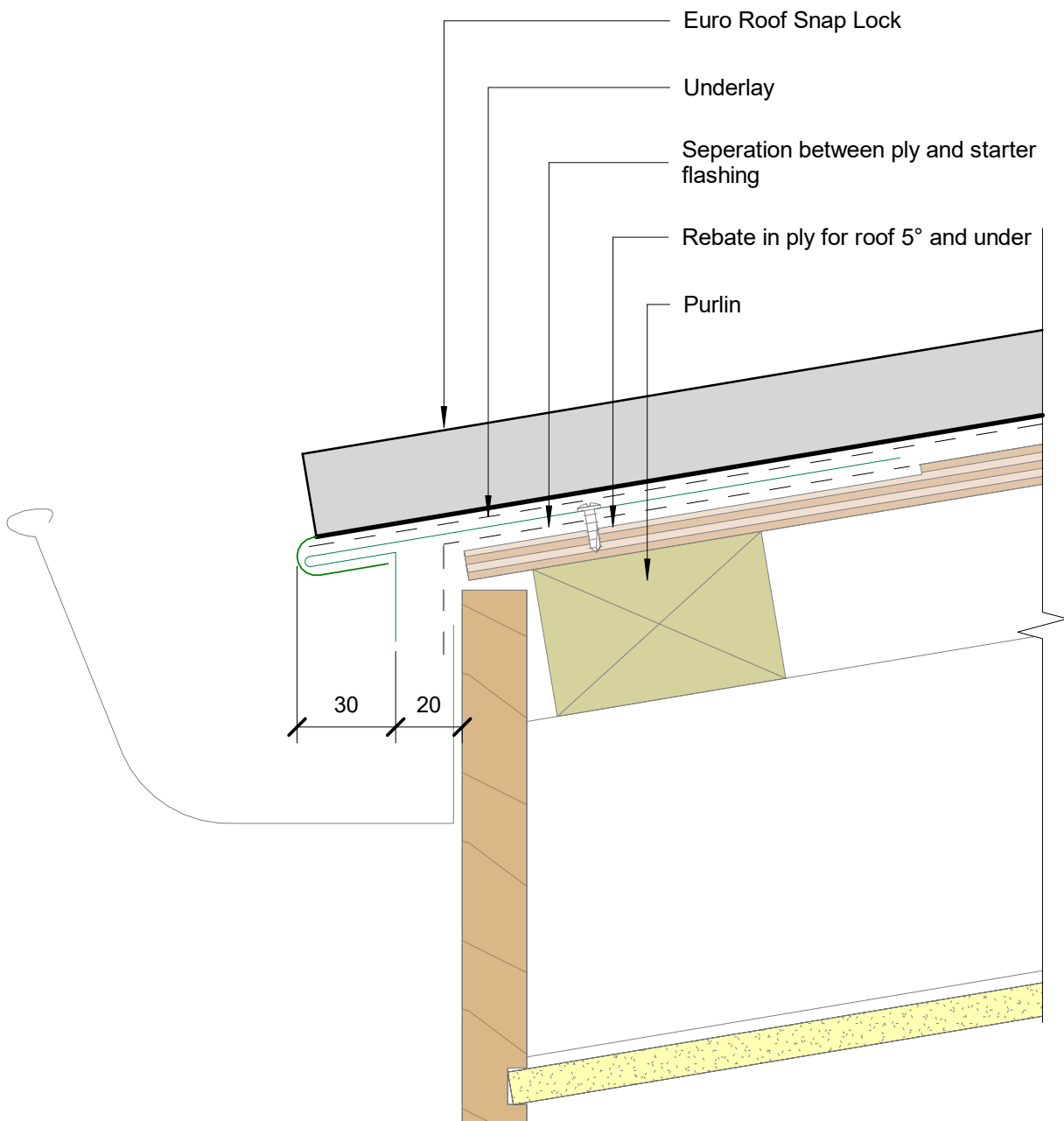

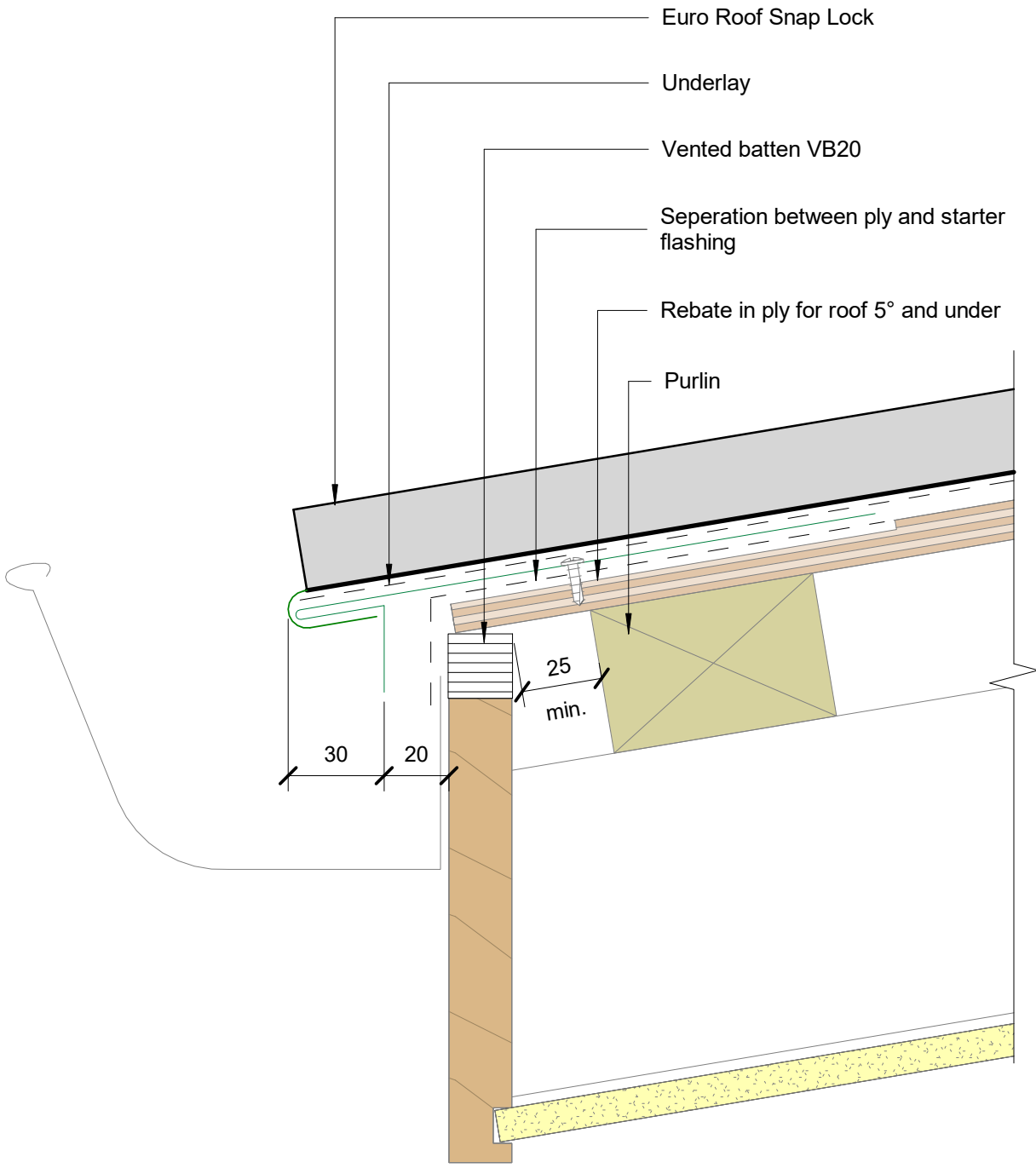

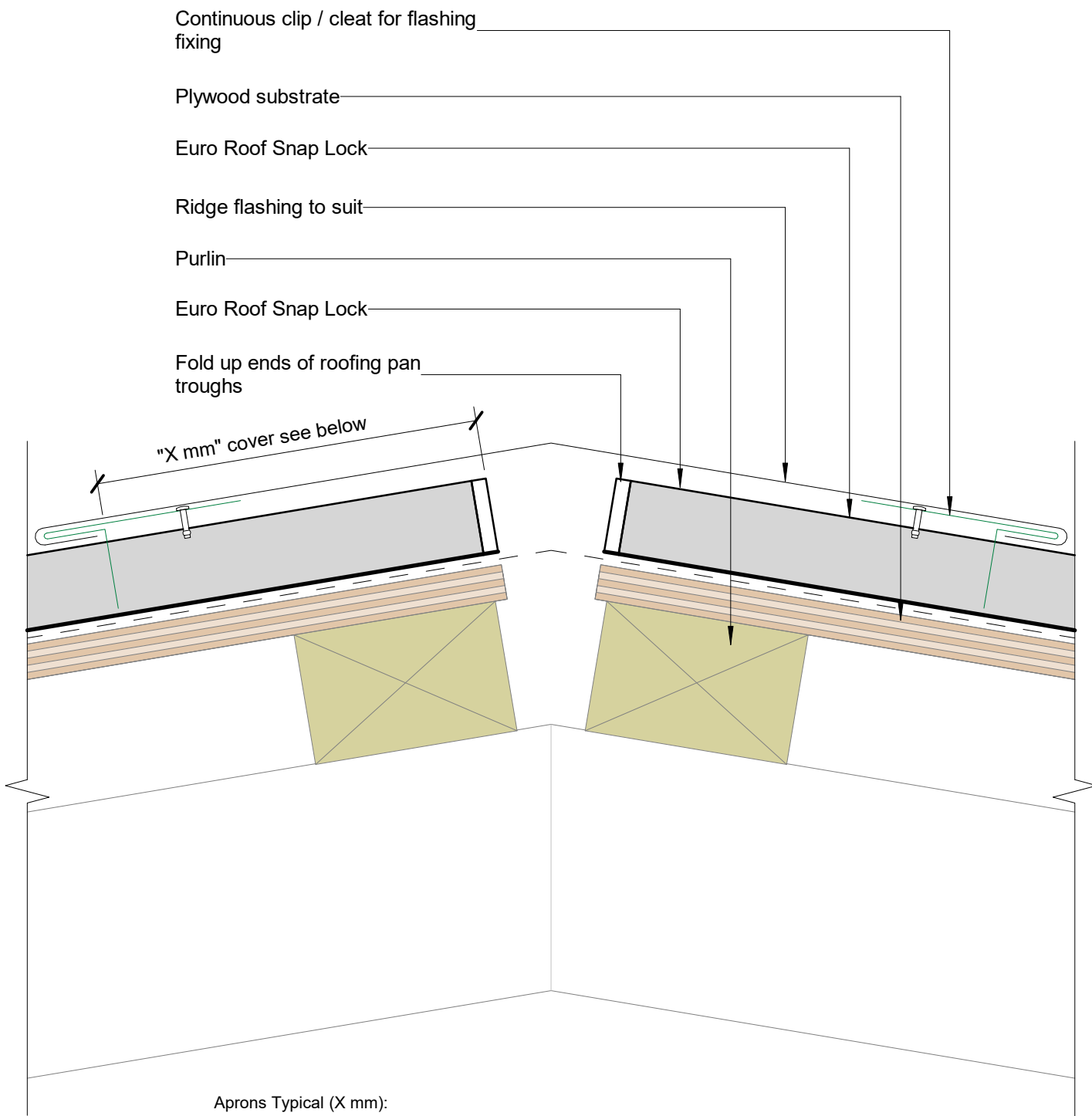

Aprons Typical (X mm):

- 130mm in situation 1: Low, Medium and High wind zones where roof pitch  $\geq 10^\circ$
- 200mm in situation 2: All roof pitches in Very High wind zones  
Low, Medium and High wind zones where roof pitch  $\leq 10^\circ$
- 200mm in situation 3: All roof pitches in Extra High wind zones

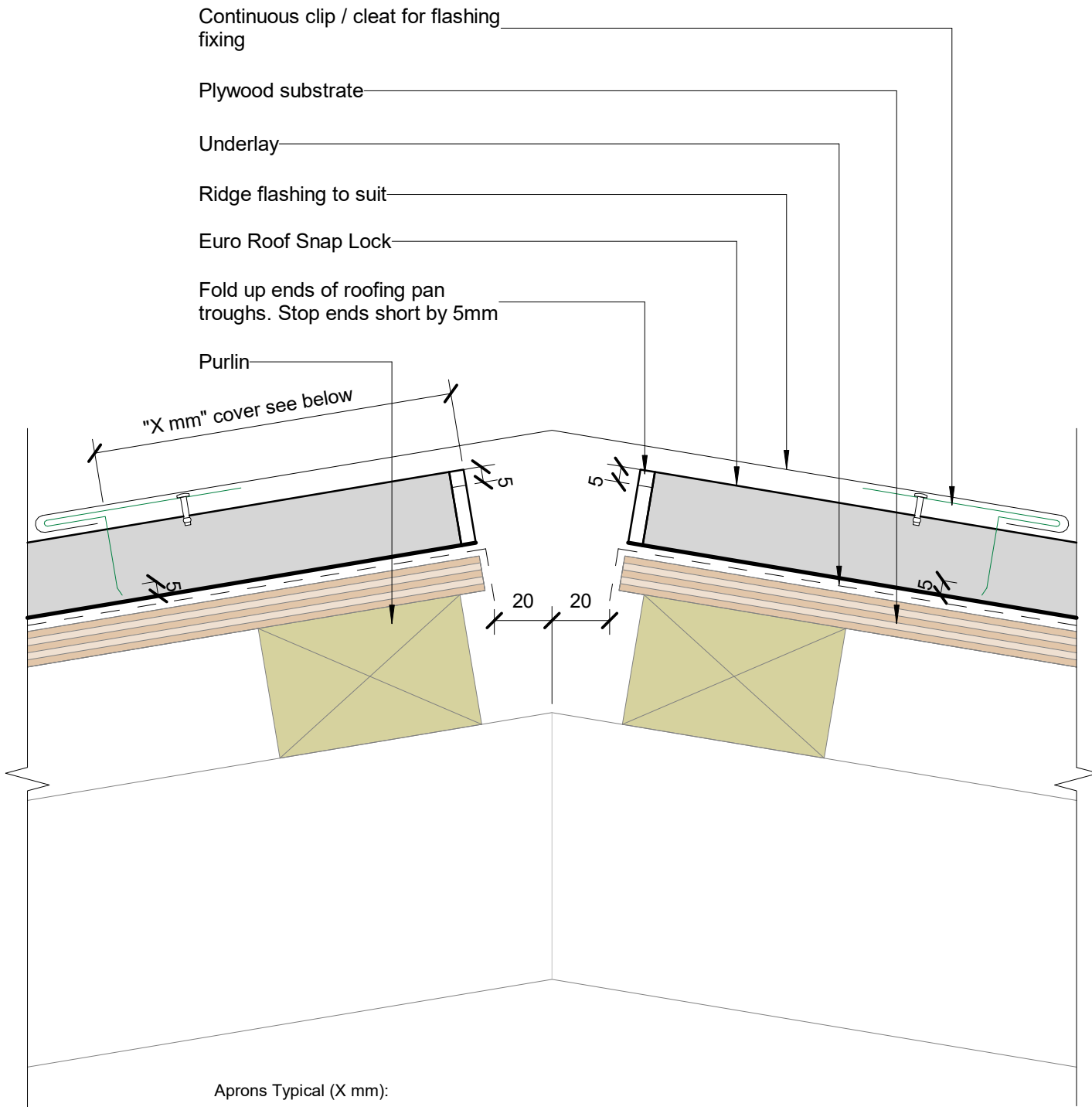

Aprons Typical (X mm):

130mm in situation 1: Low, Medium and High wind zones where roof pitch  $\geq 10^\circ$

200mm in situation 2: All roof pitches in Very High wind zones  
Low, Medium and High wind zones where roof pitch  $\leq 10^\circ$

200mm in situation 3: All roof pitches in Extra High wind zones

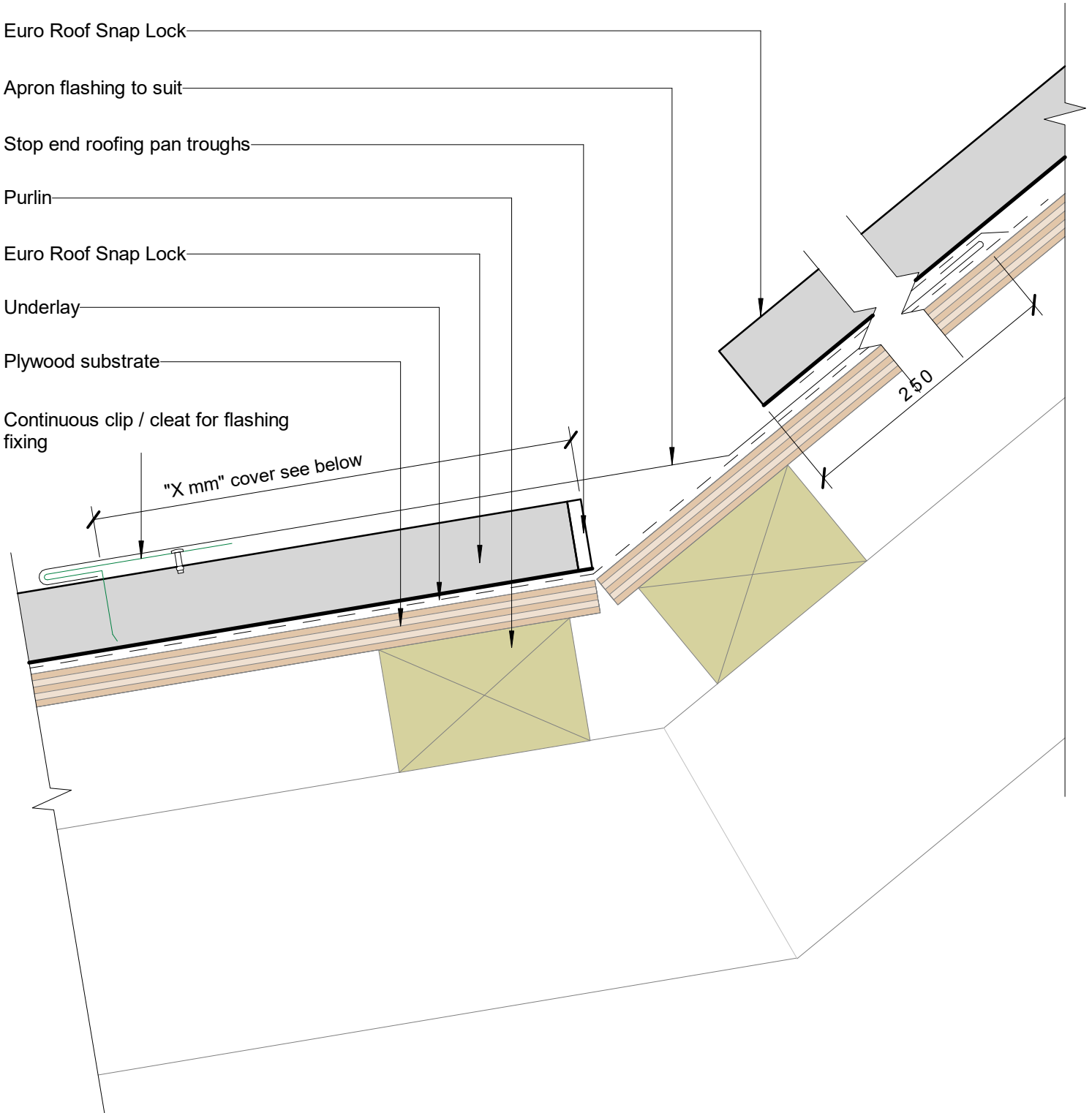

Aprons Typical (X mm):

- 130mm in situation 1: Low, Medium and High wind zones where roof pitch  $\geq 10^\circ$
- 200mm in situation 2: All roof pitches in Very High wind zones  
Low, Medium and High wind zones where roof pitch  $\leq 10^\circ$
- 200mm in situation 3: All roof pitches in Extra High wind zones

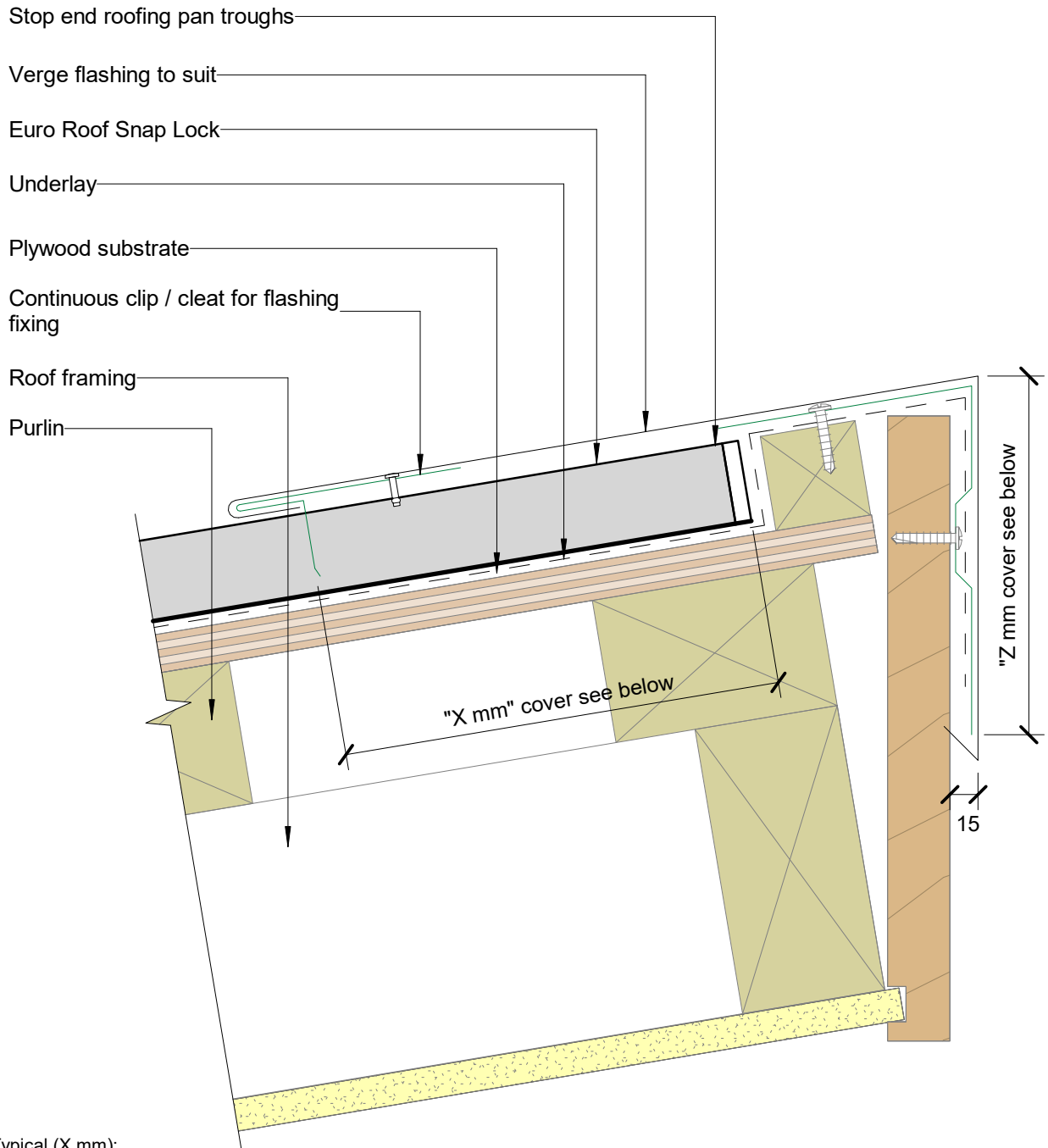

Aprons Typical (X mm):

130mm in situation 1: Low, Medium and High wind zones where roof pitch  $\geq 10^\circ$

200mm in situation 2: All roof pitches in Very High wind zones  
Low, Medium and High wind zones where roof pitch  $\leq 10^\circ$

200mm in situation 3: All roof pitches in Extra High wind zones

Barge Typical (Z mm): excluding drip edge:

50mm in situation 1: Low, Medium and High wind zones where roof pitch  $\geq 10^\circ$

70mm in situation 2: All roof pitches in Very High wind zones  
Low, Medium and High wind zones where roof pitch  $\leq 10^\circ$

90mm in situation 3: All roof pitches in Extra High wind zones

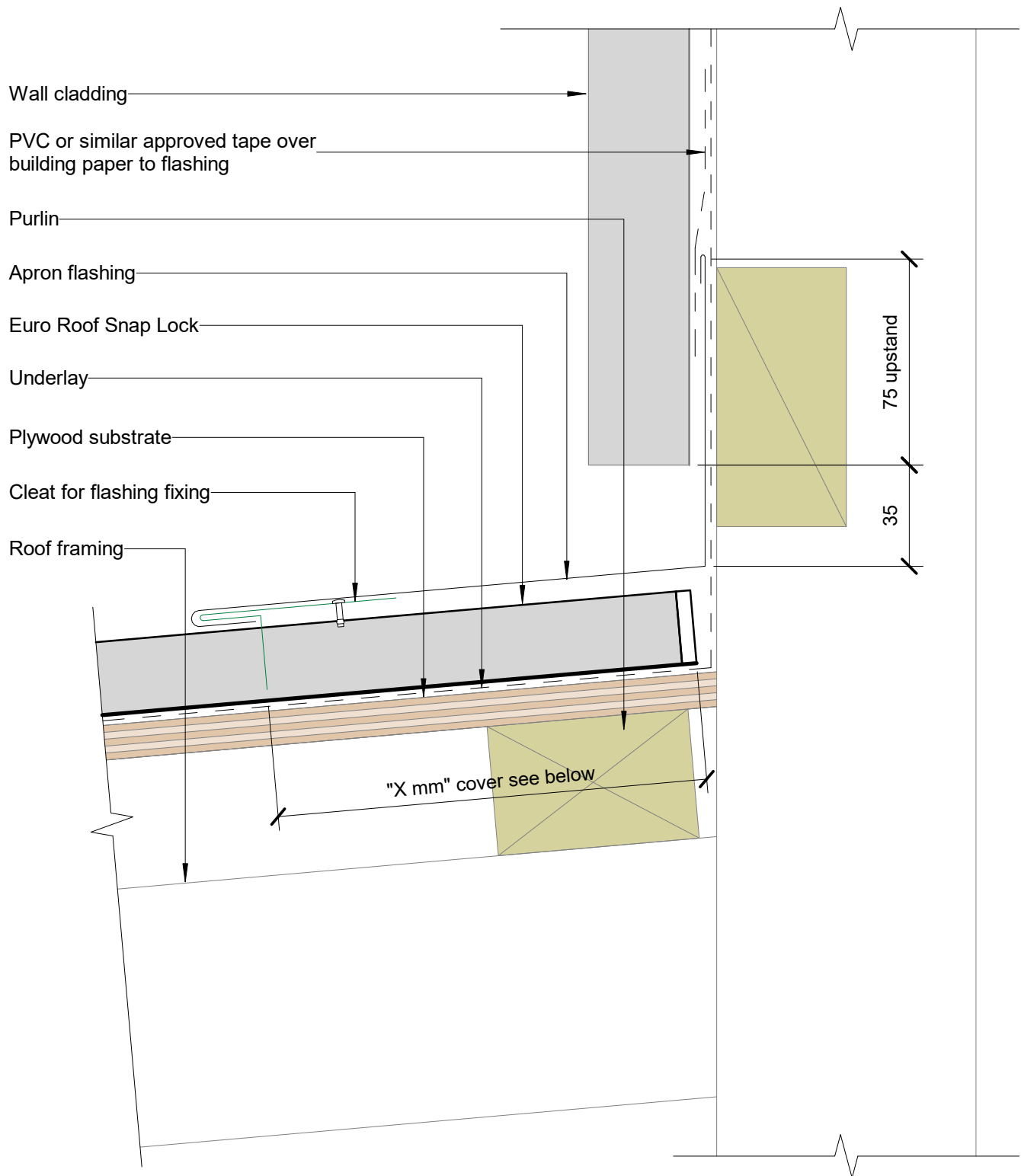

Aprons Typical (X mm):

- 130mm in situation 1: Low, Medium and High wind zones where roof pitch  $\geq 10^\circ$
- 200mm in situation 2: All roof pitches in Very High wind zones  
Low, Medium and High wind zones where roof pitch  $\leq 10^\circ$
- 200mm in situation 3: All roof pitches in Extra High wind zones



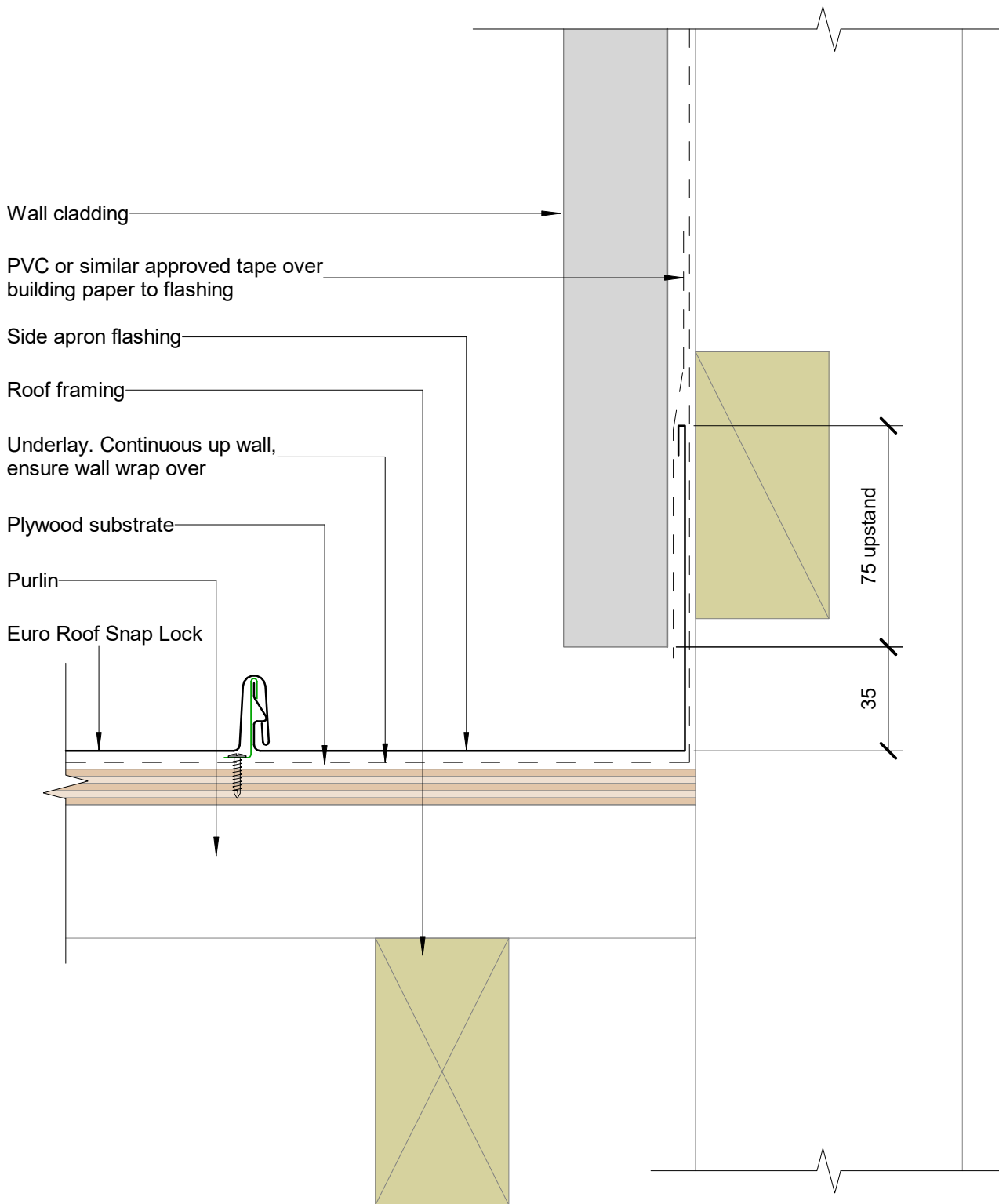

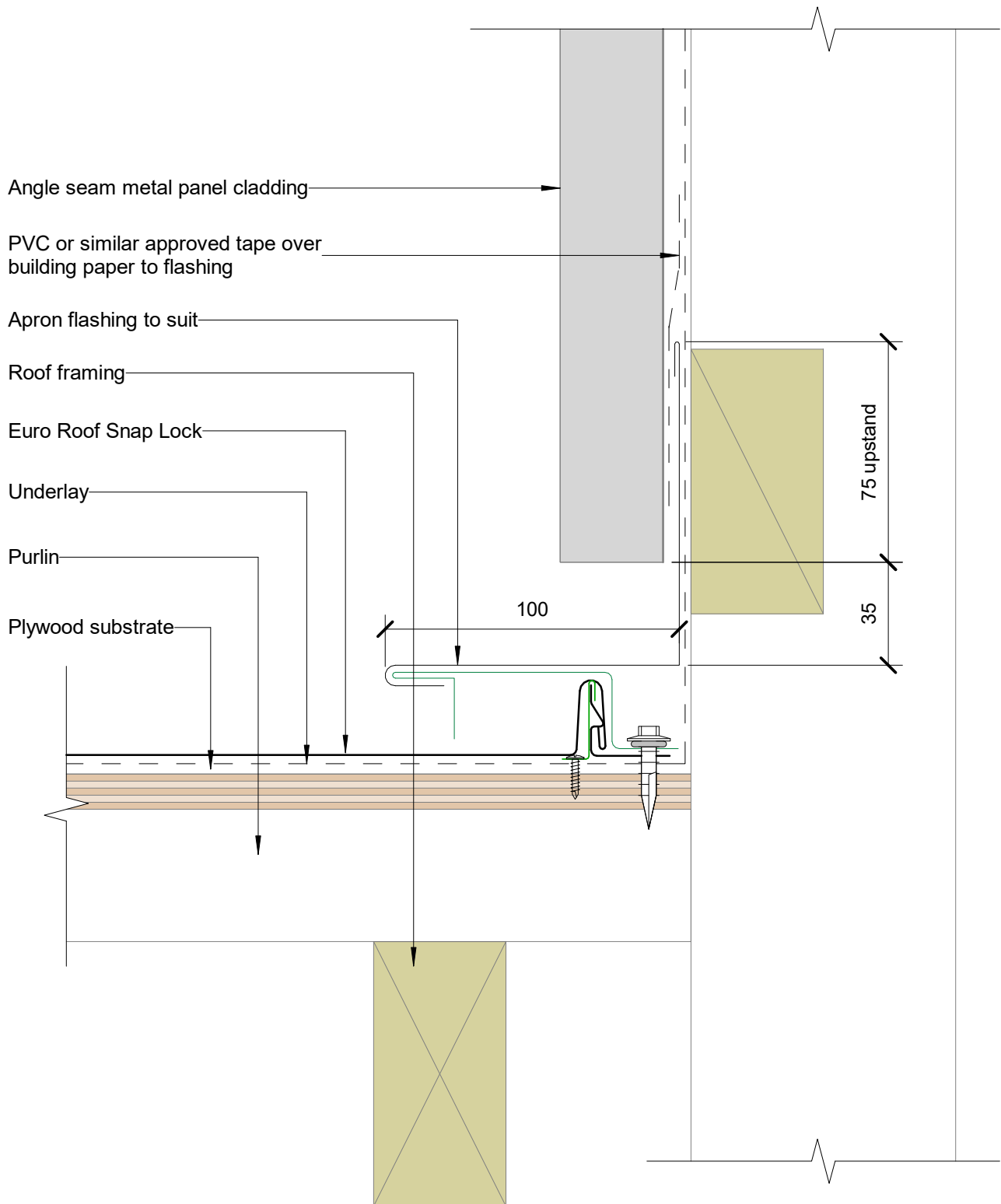

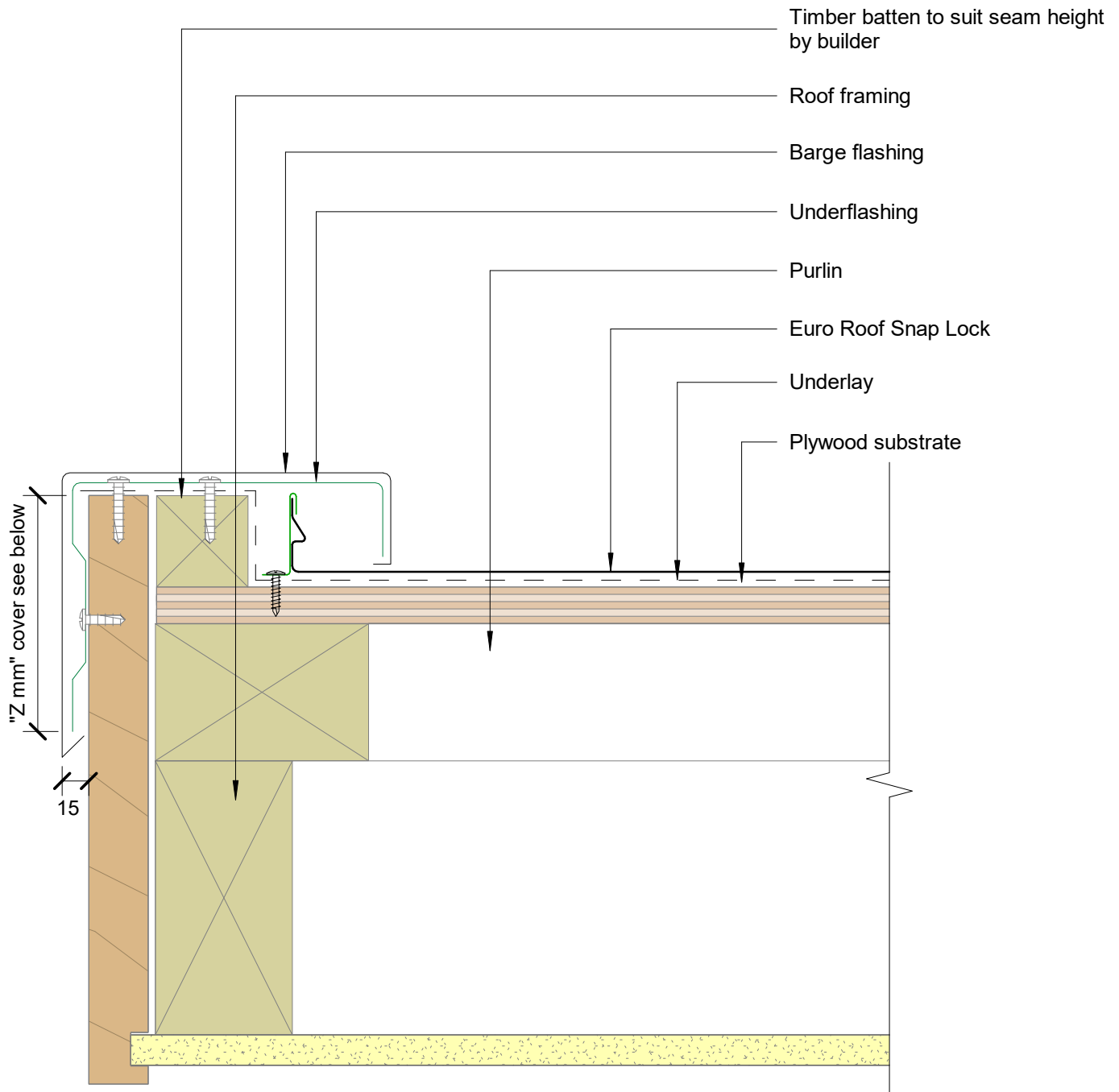

Barge Typical (Z mm): excluding drip edge:

50mm in situation 1: Low, Medium and High wind zones where roof pitch  $\geq 10^\circ$

70mm in situation 2: All roof pitches in Very High wind zones  
Low, Medium and High wind zones where roof pitch  $\leq 10^\circ$

90mm in situation 3: All roof pitches in Extra High wind zones

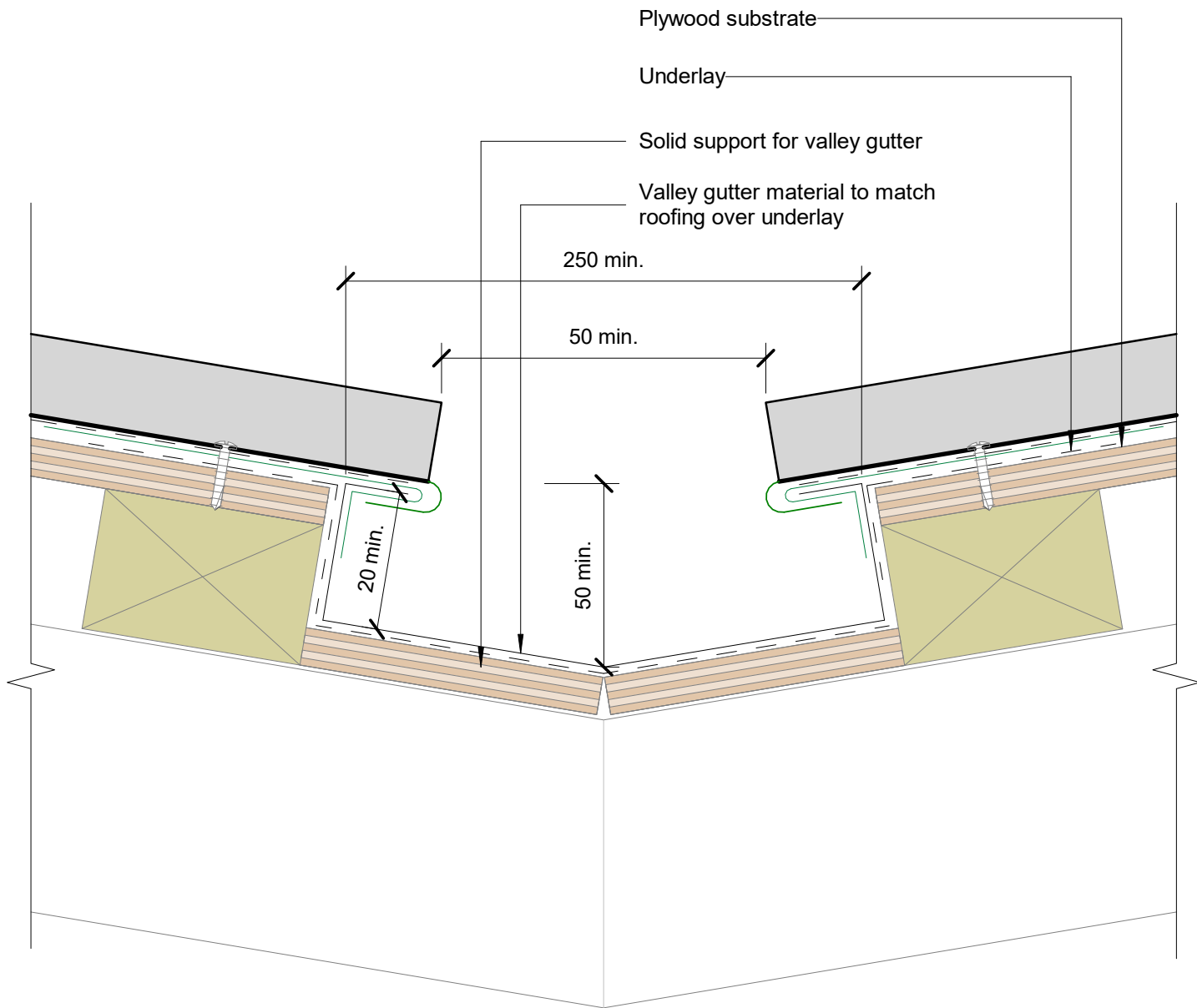

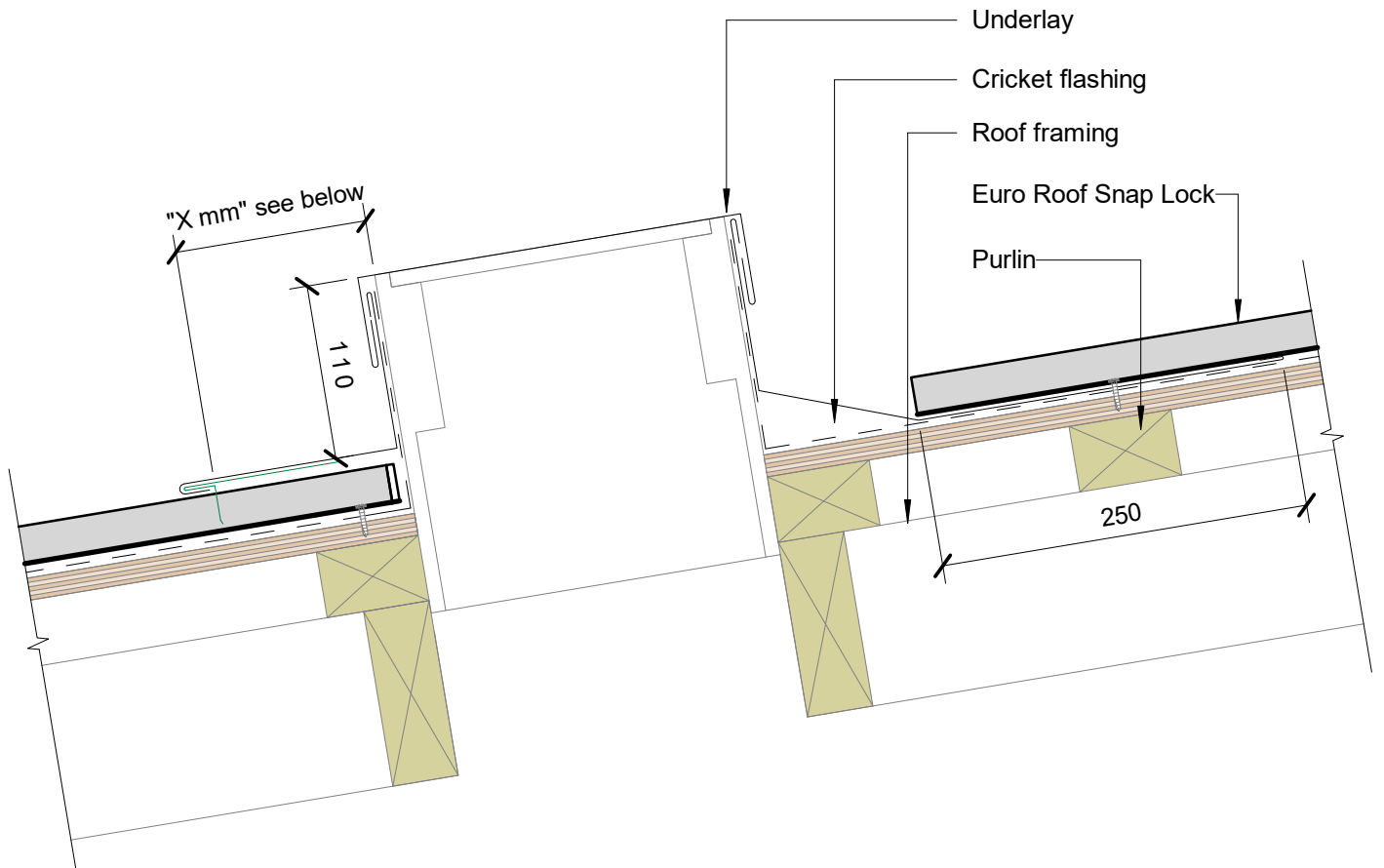

Aprons Typical (X mm):

130mm in situation 1: Low, Medium and High wind zones where roof pitch  $\geq 10^\circ$

200mm in situation 2: All roof pitches in Very High wind zones  
Low, Medium and High wind zones where roof pitch  $\leq 10^\circ$

200mm in situation 3: All roof pitches in Extra High wind zones

