



Continuous Group®

Spouting Fascia Downpipes



BIG CHIEF 150mm OG CLASSIC

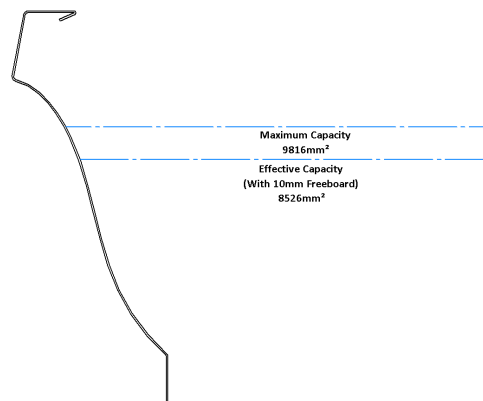
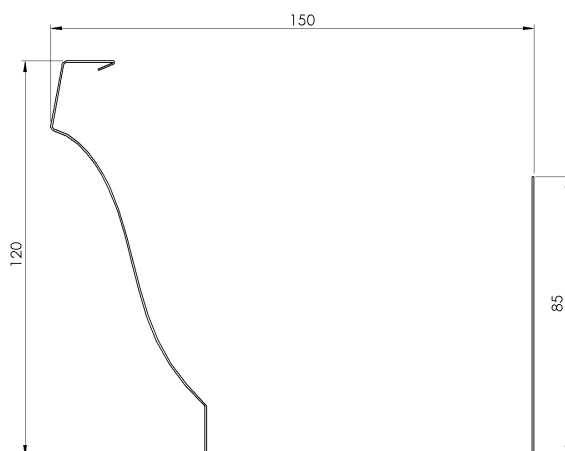

PRODUCT SPECIFICATIONS		CAPACITY SPECIFICATIONS	
MagnaFlow™ Pre-painted Steel	0.55mm G300 with a minimum of 240gsm alloy/zinc coating.	Maximum cross sectional area	9,816mm²
AlumiGard™ Pre-painted Aluminium	0.70mm Grade 5005 H34	Effective cross sectional area with 10mm freeboard	8,526mm²
Pure Copper Copper 3/4 Hard	0.60mm Grade C12200	Flow Capacity	131 Litres/min
Internal Bracket	2.50mm Aluminium 5052 H34 2.50mm Copper—hard (C12200)	Recommended fall	1:500 = 2mm per 1 metre
External Bracket	3.00mm Aluminium 5052 H34 2.50mm Copper—hard (C12200)	Minimum Downpipe cross section	3,215mm²
Recommended Maximum bracket spacing	750mm 600mm where snow fall is possible	Recommended round standard downpipe sizes	100mm Ø = 7,539mm² 80mm Ø = 4,776mm²
Recommended Fixings	Minimum Class 4 screw &/or rivet fasteners compatible with substrate	Recommended rectangle standard downpipe sizes	4x2" = 5,346mm² 3x2" = 3,996mm²

Scope of use	Continuous Group rainwater systems are intended to collect and channel water that runs off a roof. It is intended that the metal spouting be placed at the perimeter of the building (Positioned outside the building envelope).
NZBC Compliance	Test information available from Pacific Coilcoaters, New Zealand Steel and Ambro Metals, combined with past history of rainwater products indicate, that provided the product use and maintenance is in line with the guidelines contained in the current literature, Continuous Group rainwater systems can be expected to meet the performance criteria in clause E2 of the New Zealand building code.
Durability	All copper and aluminium products listed above are fit for purpose in environment zone B, C, D and E* Pre-painted steel products are fit for purpose in environment Zone B and C* They may be used in environment zone D subject to a pre-approval warranty application based on site address* *In all cases, areas with high wind &/or salt &/or thermal/industrial atmospheric conditions may require specific engineering design (S.E.D) Reference: Section 4, "Durability" from NZS3604:2011.
Maintenance	Continuous Group rainwater systems require regular maintenance to ensure the useful life of the products. Minimum maintenance interval of every 6 months or as often as needed to avoid build up of contaminants (dirt, salt, pollen etc.) on the spouting surface. Simply spray and rinse with water and/or if necessary scrub with a soft nylon brush. More information and specific maintenance products are available on our website www.continuous.co.nz/care-and-maintenance
Warranty	MagnaFlow™ : Environment zone B & C—10 year paint warranty ; 12 year perforation warranty. MagnaFlow™ : Environment zone D—10 year paint warranty ; 10 year perforation warranty. AlumiGard™ : 10 year paint warranty ; 12 year perforation warranty. Pure Copper : 20 year material and perforation warranty. Full details and conditions of our comprehensive warranty can be found at www.continuous.co.nz/warranties

0800 50 1993

WWW.CONTINUOUS.CO.NZ