

Scale	1:10
Date	05/06/2019

TGI-Spacer M
 Cross Section
 Example 14mm Spacer

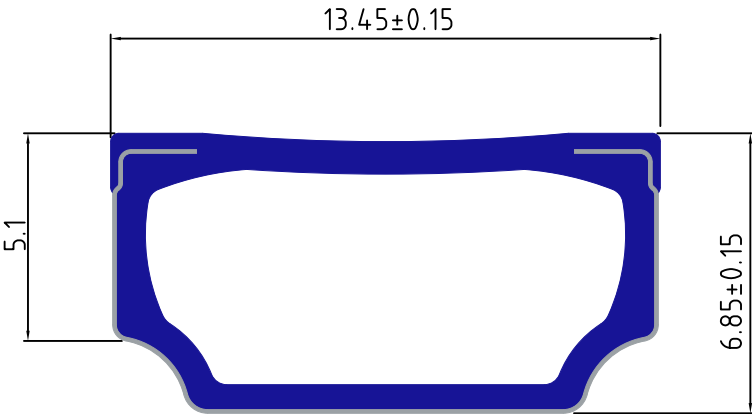

Scale	1:1
TGI-Spacer 8mm	
TGI-Spacer 10mm	
TGI-Spacer 12mm	
TGI-Spacer 14mm	
TGI-Spacer 16mm	
TGI-Spacer 18mm	
TGI-Spacer 20mm	
TGI-Spacer 22mm	
TGI-Spacer 24mm	
TGI-Spacer 30mm	

Material:

- 1. Polypropylene (0.22 W/mK)
- 2. Stainless Steel (15 W/mK)

Effective Conductivity: 0.31 W/m²K (For use in thermal modelling: Two box method)
 EN1279 Certification: Part 2, 3 & 6
 Passive certified component: phB for cold climate (all New Zealand climate zones)

Example Double Glazing

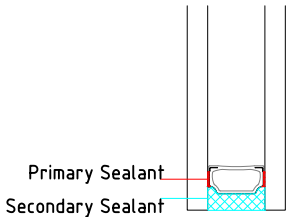

Example Triple Glazing

