

19mm X 90mm UNTREATED TIMBER SERVICE NOG

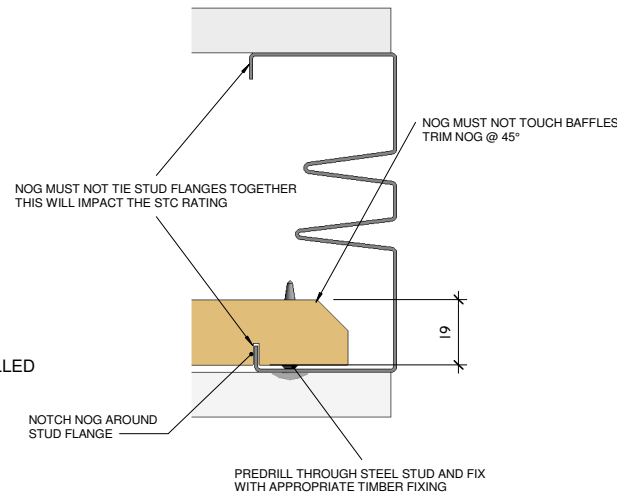

KEY INSTALLATION DETAILS:

- DO NOT "BOX" STUD BY FIXING BOTH FLANGES TOGETHER THIS CAN IMPACT STC RATING.
- DO NOT TOUCH BAFFLES WITH NOG AS THIS WILL STOP BAFFLE MOVEMENT.
- NOGGIN MUST BE UNTREATED TIMBER.
- USE APPROPRIATE TIMBER FIXING SCREWS THROUGH A PREDRILLED HOLE IN STEEL STUD.

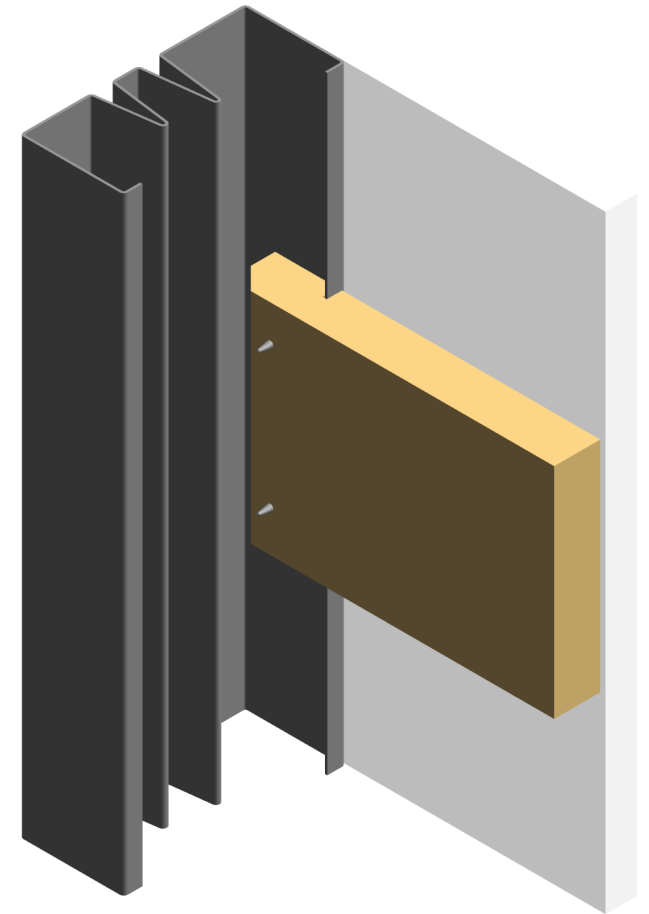

27B OLIVE ROAD, PENROSE, AUCKLAND 1061

PH: 0800 579 017

DWG TITLE:	WHISPERWALL SERVICE NOGGING	DWG #:	A101	CLIENT:	SRP	DRAWN BY:	AH
SCALE:	As indicated	PROJECT:	Project Name	PROJECT ADDRESS:	Enter address here	ISSUE DATE:	27/11/2017

THIS DRAWING IS PROVIDED FOR INFORMATIONAL PURPOSES ONLY. IF USED FOR CONSTRUCTION, THE CONTRACTOR ASSUMES ALL RESPONSIBILITY FOR LOCAL CODE COMPLIANCE. ALL DRAWINGS, PLANS, SKETCHES ETC. ARE PROVIDED TO OUR CLIENTS BASED UPON INFORMATION PROVIDED BY THE CLIENT AND DRAWN IN ACCORDANCE WITH COMMON BUILDING PRACTICES AND LOCAL CODES. NONE OF THE EMPLOYEES OF STEEL ROLLFORMED PRODUCTS LTD ARE REGISTERED ARCHITECTS, ENGINEERS OR LAND SURVEYORS. ALL DIMENSIONS AND SPECIFICATIONS SHOULD BE VERIFIED BY CLIENT AND/OR CONTRACTOR BEFORE ACTUAL CONSTRUCTION BEGINS. IF DIMENSIONS AND SPECIFICATIONS ARE NOT VERIFIED BY CLIENT AND/OR CONTRACTOR BEFORE ACTUAL CONSTRUCTION BEGINS STEEL ROLLFORMED PRODUCTS LTD WILL BE HELD HARMLESS. STEEL ROLLFORMED PRODUCTS LTD ASSUMES NO LIABILITY FOR CHANGES AND/OR REVISIONS MADE TO PLANS BY CLIENT AND/OR CONTRACTOR.