

# Data sheet

## E-90-H: Exterior 90 to 240 minute FRR hinged door, single or pair

- Our most popular 90, 120, 180 or 240 minute FRR hinged exterior fire, smoke and acoustic door set, the E-90-H is available in singles or pairs. The door leaf is a mineral core faced on all sides and edges with 1mm steel (E-CORE). The standard door set is supplied in plain galvanised or zincalume finish. Leaf sizes up to 2440 high x 1200 wide per leaf.
- Thickness 44 – 55 mm
- Weight 28.2 kg /m<sup>2</sup>
- Acoustic singles and doubles up to STC 35. Call us on 09 579-8895 for bespoke engineered solutions to higher STC ratings.

### FACING OPTIONS

- Paint quality galvanised or zincalume steel
- Powder coat finished (surcharge applies)

### LEAF EDGE DETAILS

- 39 x 12 integral rail (all edges) under folded steel capping

### PAIR MEETING STYLES

#### Aluminium

*C/C*

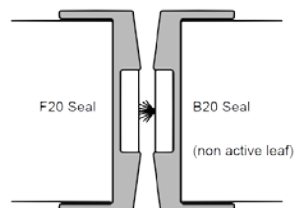
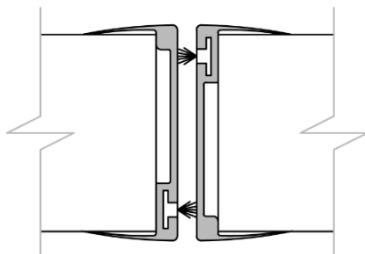

*C/J*

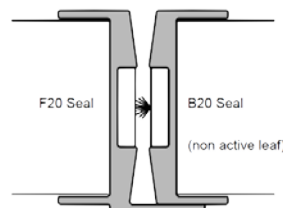
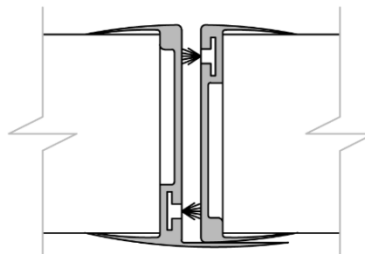

*J/J*

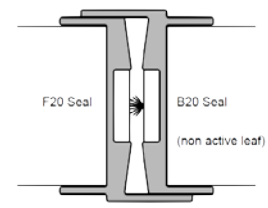
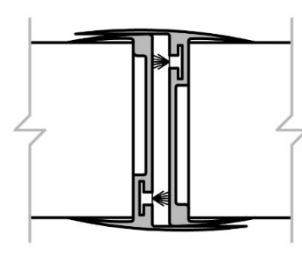

## JAMB TYPES AND PROFILES

1.6 mm electrogalv steel (types 5, 6, 7 & Speedwall), paint quality or powdercoat options available

### **T5 – Steel**

*Steel width 111 – 350 mm*

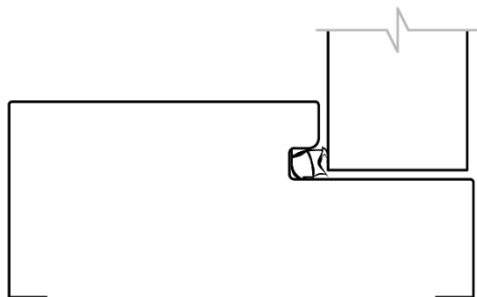

### **T6 – Steel**

*Steel width 146 – 208mm*

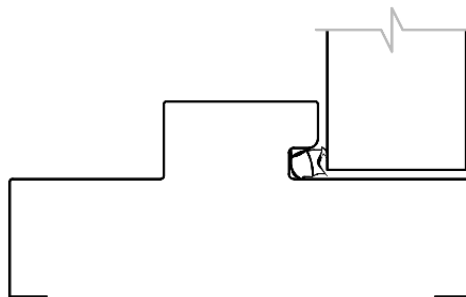

### **T7 – two piece split steel**

*Ideal for retrofit situations. No additional charge. Min 104mm if masonry wall, Min 112mm if stud wall – no max..*

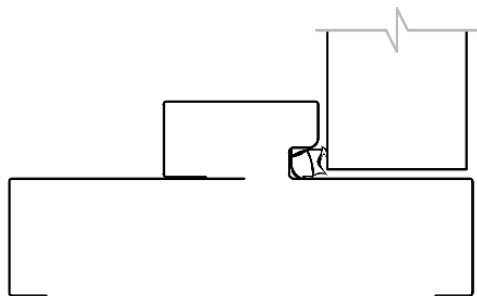

### **Steel Speedwall**

*Requires Speedwall C track (80mm end cap), (Max - /120/30sm)*

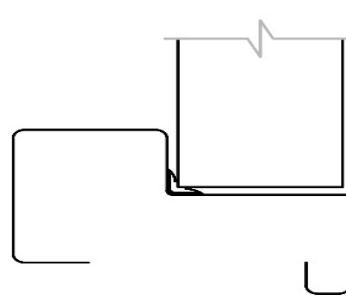

## SIDELIGHTS AND OVERLIGHTS

Not available for 90+ minute FRR fire door sets

## APPROVED HARDWARE

The minimum requirement is for a fire door to be self-closing and self-latching. Hardware must be selected from NZ Fire Doors' Approved Hardware list from the column '90, 120 min'. Fitting any hardware that inhibits self-closing or self-latching is not approved by NZS 4520

**IMPORTANT:** Fitting untested or inappropriate hardware may affect the performance of the door and will void the warranty