

Selected subfloor, glued and  
screwed to SPEEDFLOOR  
joists with 10-10x50 csk  
wingtek screws

SPEEDFLOOR perimeter  
channel, fixed to U B and timber  
blocking, with 2/M12 bolts @  
600c/c, or as specified by  
engineer

SPEEDFLOOR Floor joist,  
fixed to perimeter channel  
with 3/10-16x16 hex head  
screws, each tab

Universal Beam

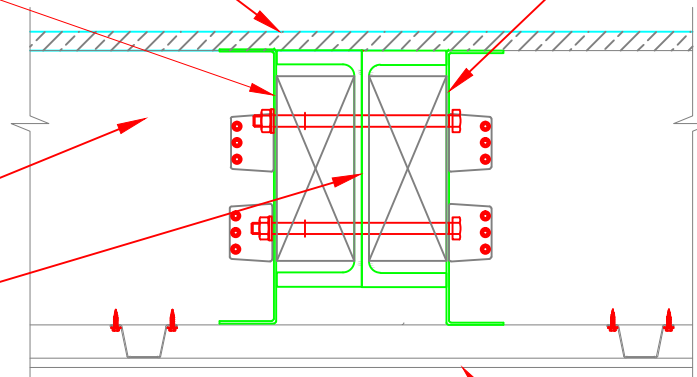

SPEEDFLOOR perimeter  
channel, fixed to U B and timber  
blocking, with 2/M12 bolts @  
600c/c, or as specified by  
engineer

SPEEDFLOOR Floor joist,  
fixed to perimeter channel  
with 3/10-16x16 hex head  
screws, each tab

Plasterboard ceiling,  
supported by steel ceiling  
battens

## MFD 6 -SPEEDFLOOR Joist to U B