

Fibre-cement based
Permanent formwork
Lightweight, load-bearing



Building better internal and external walls, façades,
balustrades, blade & party walls, lift & stair cores
and corridors

Millions of m² installed in thousands of multi-residential projects

AFS Logicwall® is a fibre cement-based permanent formwork system and a faster alternative to conventional masonry and blockwork and is load bearing for multi-level structures.

Logicwall® panels are delivered with shop-drawn accuracy and labelled for rapid installation. Consisting of lightweight panels created by bonding hard-wearing CSR Cemintel® fibre-cement sheeting against galvanised steel stud frames, logicwall® panels are load bearing (when core-filled) but lightweight enough for manual installation.

The logicwall® panels consistently provide a flat, true surface to deliver high quality finishes.

An ideal performer in the construction of multi-residential apartments, hotels, student accommodation, shopping centres, hospitals, prisons and aged care facilities.

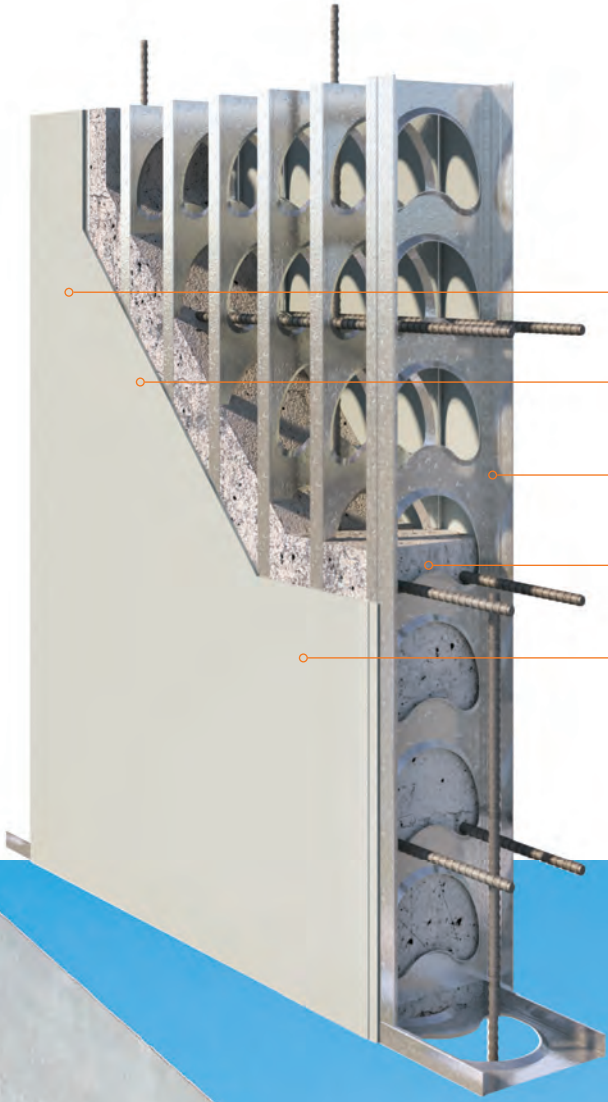

Shop-drawn, modular walling solution
Load bearing for internal and external walling,
easier materials handling, reduced or no craneage needed

Panels formed with industry-renowned Cemintel® fibre-cement sheets

Consistent clean, even surfaces for quicker completions

Durable galvanised steel stud framing

Large kidney-shaped holes to maximise flow during core filling (LW200/LW262)

Each panel labelled to ensure rapid installation

Load bearing walling solution
with a substrate ready for finishing

Preferred walling system
in thousands of projects

afs logicwall® panels come with shop-drawn accuracy, Masterspec Specification and a track-record of faster completions

One system, one solution,
from ground floor
to penthouse



SYSTEM BENEFITS

Why architects prefer logicwall®

- Proven performer in thousands of projects
- Structural substrate for rendered and designer façades
- Masterspec Specification with work section support
- Exhaustive design and technical resources

Why engineers prefer logicwall®

- Load bearing and NZS3101 compliant
- Choice of five wall thicknesses, with options for single and double reinforcement
- Comprehensive access to technical resources and guides

Why builders prefer logicwall®

- Significantly faster floor-cycles can save days, or even weeks, compared to conventional masonry and blockwork
- Fewer trades needed and sites are kept cleaner and more efficient
- Significantly reduced or no crane dependency
- Panels provide a reliably even finish

Why installers prefer logicwall®

- Panels are easily unloaded and manually installed
- Shop-drawn and labelled with unique identifications makes for speedy installation



Preferred in many projects nationwide logicwall® is favoured by architects, engineers and builders



Fibre-cement based permanent formwork for internal + external walling

Preferred by architects, engineers and builders alike, afs logicwall® panels are delivered with shop-drawn accuracy and featuring corresponding labels for easy installation. They are load bearing but lightweight enough to enable manual installation. The panels provide reliably flat, true surfaces to help deliver high quality finishes.



Benefits include:

- Speed of construction and earlier handovers
- Ease of materials handling – not crane dependent
- Simplicity of build
- Panels delivered with shop drawn accuracy
- Load bearing structure
- Reduced footprint, maximises livable space
- Solid concrete wall
- Masterspec Specification
- Acoustic performance
- Fire performance
- High quality finish
- Significant waste reduction



Building better internal and external walls, façades, balustrades, blade & party walls, lift & stair cores and corridors

Logicwall® is shop-drawn in 1100mm panel widths with thicknesses of 120mm, 150mm, 162mm, 200mm and 262mm.

It can also be supplied in any width from 200mm to 1100mm, in heights from 1200 to 4200mm (or even higher in special orders).

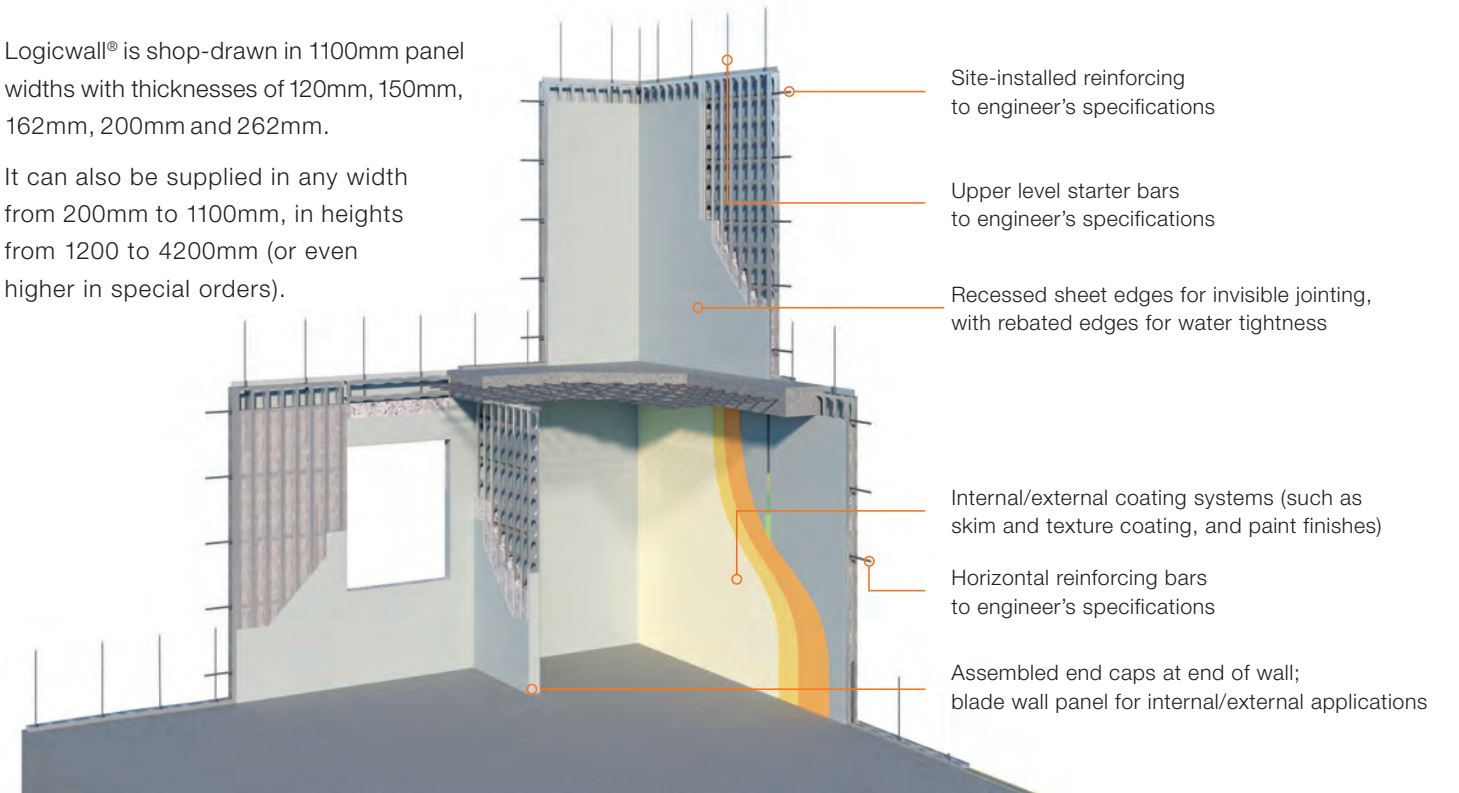

| Wall Type | LW120 Single reinforcement | LW150 Single reinforcement | LW162 Single reinforcement | LW200 Single reinforcement | LW200D Double reinforcement | LW262D Double reinforcement |
|--|---|---|--|---|---|---|
| Wall Thickness | 120mm | 150mm | 162mm | 200mm | 200mm | 262mm |
| Filled Wall Mass (kg/m ²) | 290 | 360 | 394 | 480 | 480 | 630 |
| Application | External façades, batten/sheet party walls, balustrades | External façades, batten/sheet party walls, blade walls | Stand-alone party walls, external façades, blade walls | Lift and stair shafts, stand-alone party walls, blade walls | Deep beams, lift & stair shafts, shear walls, blade walls | Shear walls, lift and stair shafts, blade walls |
| Acoustic Rating (STC) | 50 | 54 | 55 | 58 | 58 | 62 |
| Max Fire Resistance Level (based on CSIRO testing) | 240/240/180 [†] | 240/240/180 [†] | 240/240/240 [†] | 240/240/240 [†] | 240/240/240 [†] | 240/240/240 [†] |

[†] CSIRO testing, max fire load = 233kN/m @ FI-FI = 3000mm
^{*} CSIRO testing, max fire load = 200kN/m @ FI-FI = 3000mm

Load bearing, lightweight panels ensure easier materials handling with less or no crange, faster installation and quicker core filling



C O N S T R U C T I O N

Versatile enough for internal/external walls, deep beams, shear walls, façades, balustrades, blade & party walls, lift & stair cores and corridors

Available in five wall thicknesses, logicwall® suits the most challenging architectural and engineering demands, being ideal for multi-residential and commercial applications such as hotels, student accommodation, shopping centres, hospitals, prisons and aged care facilities.

Its panels can be easily installed by hand and then core-filled to form fire and sound-rated, load-bearing walls. The cement sheeting remains in place as sacrificial formwork and provides an even, high quality substrate for finishing including skim coating, acrylic rendering and painting.



Logicwall® panels are easily stacked to maximise site-efficiency



Shop-drawn panels are labelled for easy installation



Lightweight panels can be readily positioned without craneage



Robust floor tracking system ensures quick installation

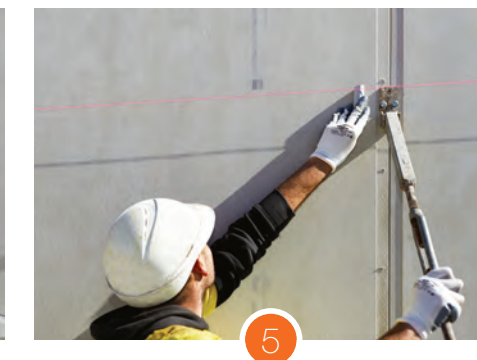

Once erected panels are plumbed and braced in readiness for core filling



Core filled via a boom pump sees walls become load bearing

M A S T E R S P E C S P E C I F I C A T I O N

Dedicated team offering work section support to specifiers using Masterspec

Specifiers are greatly reassured by having AFS' team of advisers offer work section support through Masterspec.

Logicwall's CBI number 3111AL is available to any specifier as a concrete formwork system.

in-house & on site expertise

customers rely on the expertise of our
consultant engineers and estimators

and the peace-of-mind from using
our in-house installers

afs design team

We offer the very best project advice through our in-house team of experts, including consultant engineers, estimators and technical advisers.

You'll also get access to the afs design toolbox, a library of design and construction guides, and our own team of project specialists.

approved installers

To ensure the highest quality installation of afs logicwall® in your project, we strongly recommend you engage only AFS-endorsed installers.

Customers are greatly reassured by having the AFS team co-ordinate the installation of logicwall® on their project.

From shop drawings to hand-over, our team of experts will ensure your project runs smoothly when using afs Logicwall®.

afs logicwall



Load bearing walling solutions for commercial and residential projects

COMPLIANCE & CERTIFICATION

Logicwall® meets industry demands for acoustic, fire and structural performance

The collage consists of three documents. The left document is a technical drawing of the AFS Logicwall system, showing a cross-section of a wall with a concrete core and a metal mesh. The middle document is a 'Certificate of Test' from CBRO Materials Science and Engineering, No. 2347, dated 23 November 2011. It certifies that the AFS Logicwall system meets the durability requirements of the Australian Standard AS/NZS 3101. The right document is an 'Acoustic Performance Assessment Of a Product or System' report from PIRAC Acoustic Consulting, dated 23 November 2011. It details the acoustic performance of the AFS Logicwall system, including the company description (AFS Systems Pty Ltd) and the assessment number (PKA-A144).

The New Zealand construction industry's regulatory bodies maintain some of the world's most stringent standards. Logicwall® is compliant with NZS3101, along with meeting regulatory fire resistance, acoustic and structural demands.



Our in-house team of experts can help with advice for your project



AFS offers architects, engineers and builders a wealth of technical reference and in-house technical, drafting and estimating expertise.

This ensures a customer can get the best advice on a project at the concept design phase or when plans are available. Building professionals enjoy how easy the AFS website makes it to upload plans for assessment and estimation.

Additionally, customers can access the AFS Design Toolbox, a comprehensive kit of design resources and construction guides including BIM (Building Information Modeling) files to ensure that designing, specifying and building with logicwall® is made easy.

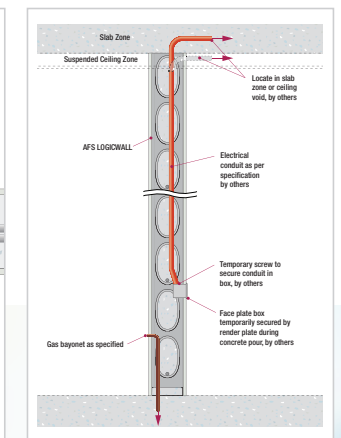
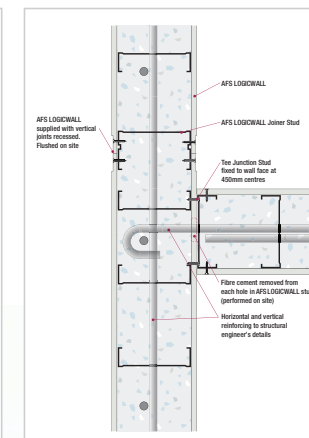
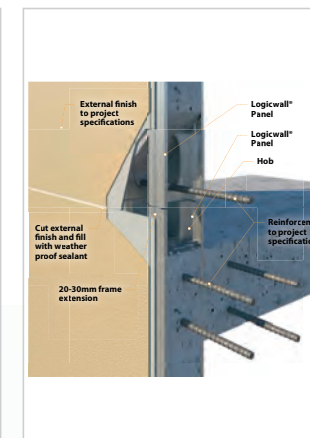
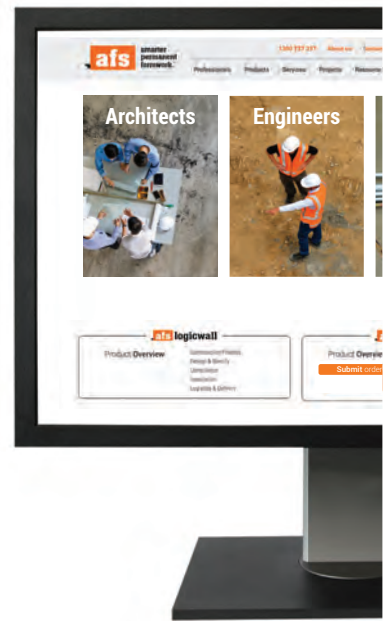

Customers enjoy ready reference to technical manuals, papers and design guides

The Design Toolbox includes:

- AFS Logicwall® Design Guide • Standard Details (PDF and DWG) • Standard Architects Specification MasterSpec Specification

The afs logicwall® Design Guide covers:

- applications • properties • structural design internal/external design considerations performance • environment • trade coordination installation • certification and architectural detailing



Fibre cement-based permanent formwork for internal and external walling, including boundary and party walls, façades, corridor and blade walls, balustrades, lift & stair shafts



Disclaimer: Information presented in this document is supplied in good faith and to the best of our knowledge was accurate at the time of preparation. The provision of this information should not be construed as a recommendation to use any of our products in violation of any patent rights or in breach of any statute or regulation. Users are advised to make their own determination as to the suitability of this

information in relation to their particular purpose or specific circumstances. Since the information contained in this document may be applied under conditions beyond our control, no responsibility can be accepted by Beatson Group Ltd, or its staff for any loss or damage caused by any person acting or refraining from action as a result of misuse of this information.

(C) 2020 Beatson Group Ltd t/a AFS New Zealand

afs

afswall.co.nz • 0508 423 769

AFS New Zealand • 9 Vivian Place, Nelson 7011