



Sliding door system for modern furniture design:
SlideLine M

Technik für Möbel

Hettich

Slide it. Love it.

Everyone does it: Slide it. Love it.

People like to keep it simple. On their tablet PCs. On their smartphones. The revolutionary aesthetic appeal of virtual sliding fascinates millions: gentle, flowing movement, simply at the touch of a finger.

But sliding in the real world is captivating more and more people: cars that provide real practical value come with a sliding door; a sliding sunroof creates a sensation of openness and space, and at home there we are sliding panel curtains and doors, whether as room dividers or on furniture.

The trend towards sliding is also opening new doors for you: Hettich gives you sliding door systems that go perfectly with your furniture ideas. For bedroom, living room, office and kitchen furniture.

Are you open to a new love? Welcome to Hettich.



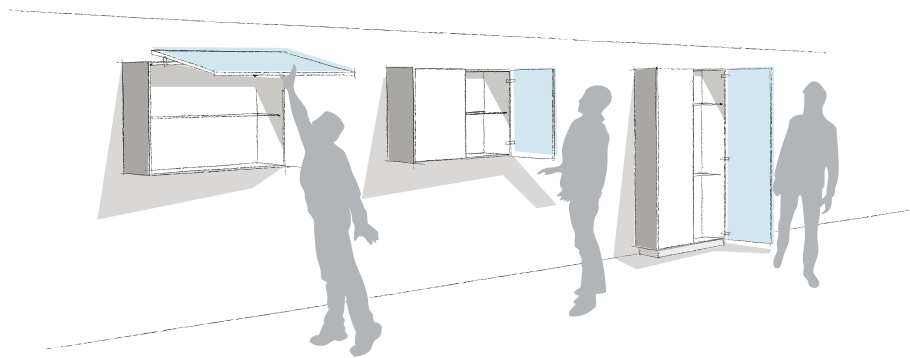

Ergonomics

Always in reach. Never in the way.

In terms of ergonomics and convenience, sliding doors are a cut above any other door system. That's clear to see in everyday use: open sliding doors don't get in the way where space is at a premium. Open doors on wall units are not likely to leave you injured. Sliding doors are also easy to open without stretching or dodging out the way.

Design

Unadulterated form. Distinctive surfaces.

Sliding doors provide the key to picking up on modern, spacious interior design and cleverly carry it through in furniture. Because large surface doors, particularly with flush fitted sliding door systems, are the ideal creative element for purist interior design.

Hettich sliding door systems impress with narrow reveals that hardly detract from the homogeneous look of furniture fronts. Only a few reveals are visible on large format fronts anyway; elegant fascias reduce the number of reveals to a minimum.

Easy precision adjustment provides superb finished results with perfect gap alignment.

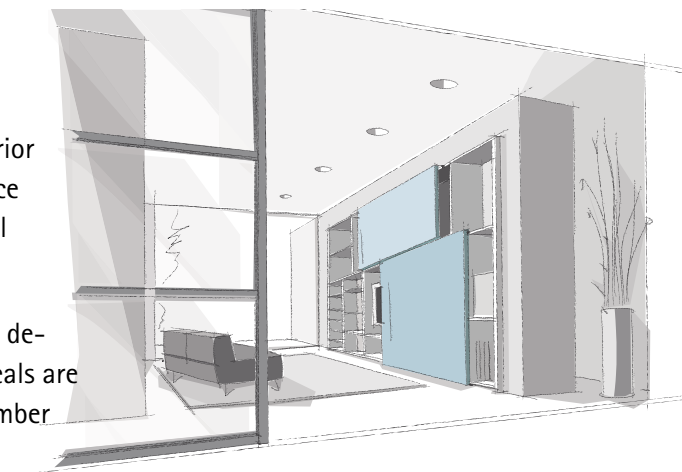

Functionality

Easy to begin with. Then quiet.

Sliding doors are particularly good at meeting the demands users place on cabinet doors today: they are easy to open and close.

The ergonomic benefit of linear door movement (see page 3) is optimised further still by low opening forces. Convenient Silent System closes the sliding door quietly and gently.

Altogether, Hettich sliding door systems leave no margin of doubt with reliable quality, superb smooth gliding action and long life.

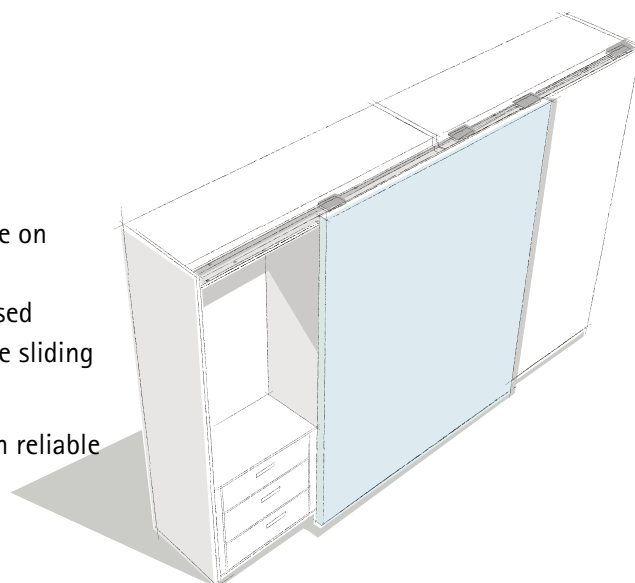

One system, many applications: SlideLine M





Design in motion

SlideLine M upgrades the practical value and design of furniture: living room units and shelf systems, kitchen wall units, bathroom furniture and office cabinets. The versatile system is ideal for all common furniture constructions. Wooden / glass or aluminium framed door weighing up to 30 kg can be installed quickly and easily. Profiles are available for several shelf thicknesses.

Letting doors slide past each another in one profile isn't a problem either. The Silent System is integrated in the running component and slows doors down in closing, opening and colliding direction.

Technical details in brief

- ▶ Single track bottom running sliding door system
- ▶ Wooden, glass or aluminium framed doors
- ▶ Doors weighing up to 30 kg
- ▶ Shelf thicknesses 15, 16, 18, 19, 22, 25, 38 mm
- ▶ Height adjustment +/- 2 mm
- ▶ Silent System in closing, opening and colliding direction
- ▶ Fast installation of front without need for tools
- ▶ Tested to DIN EN 15706

Scope for new ideas: SlideLine M



It's your ideas that decide

SlideLine M turns simple shelf units into attractive pieces of practical furniture with a look that can be varied all the time: moving the doors to different positions creates ever changing constellations of open and closed elements. This gets things moving in furniture design. And never fails to please. It's your ideas that decide. Discover the wealth of applications for SlideLine M.

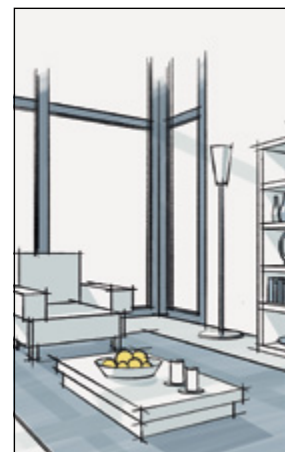

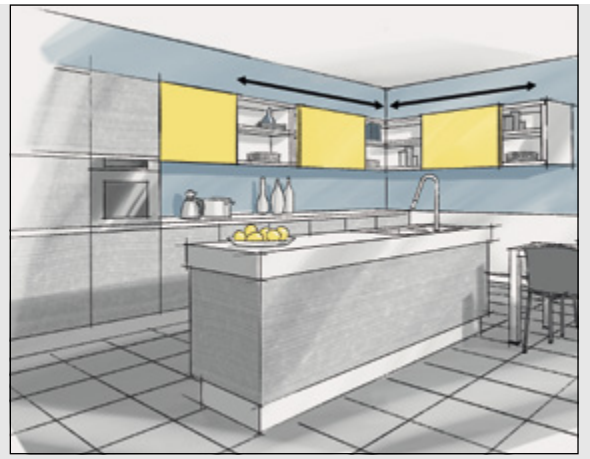

Product benefits at a glance



High creative flexibility from different door materials

SlideLine M gives you all the options in designing your furniture – can be used for wooden, aluminium framed or glass doors weighing up to 30 kg.



Easy installation on the assembled carcass

The SlideLine M system uses runner profiles that are quick and easy to install – as they simply screw into place. Cleverly designed mounting accessories means it only takes one person to install the system. As all installation steps are carried out from the front and not from the side, SlideLine M can be used for creating wall to wall units without a problem.

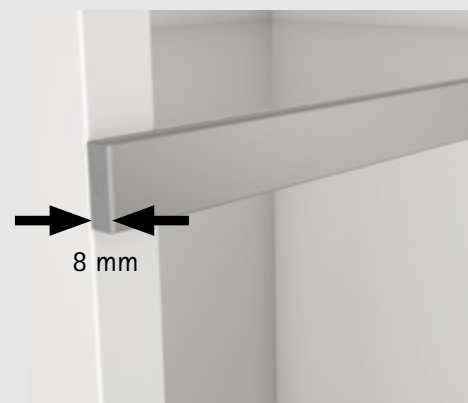
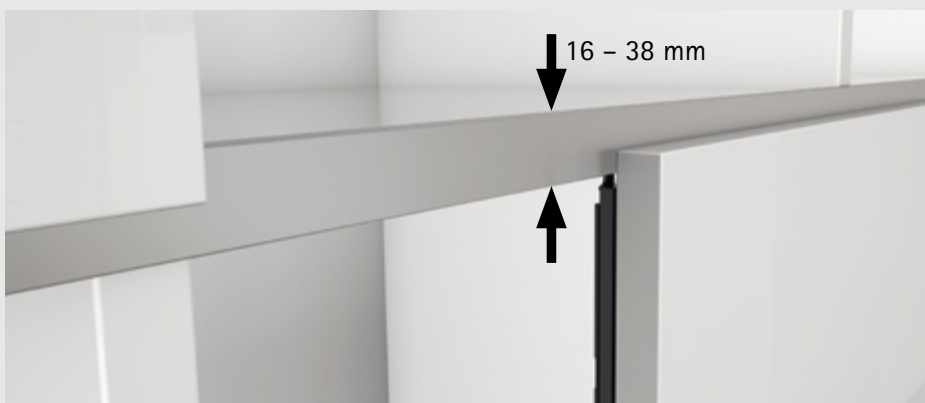

Neat look.

Discreetly vanishing into the background, SlideLine M's working components don't intrude on the design of furniture. With the profile projecting by a mere 8 mm, sliding doors can be mounted for a particularly close hugging fit. Two doors can cross each other in just one profile.

Different shelf thicknesses? Not a problem: different profile sets in profile heights of 16 – 38 mm provide perfect positive locking solutions. And the silver or black decorative profile blends elegantly into the design of furniture.



First-class soft closing action: Silent System

Perfectly soft stopped sliding doors underscore the quality of furniture. Silent System is unobtrusively integrated in SlideLine M's runner component and closes doors gently and quietly.

And where several sliding doors run side by side in one profile, Silent System in colliding direction can slow them down as they move towards each other.



Even gaps, perfect design.

Sliding doors can be perfectly aligned with the integrated height adjuster (+/- 2 mm).



Tool-less fast installation

Save time and effort: the SlideLine M system makes easy, fast work of installing sliding doors. After pulling the guide component down by means of a spring mechanism, it can be inserted and engaged in the top profile without the need for tools. Runner and guide components simply screw into place – no special work needs to be carried out on the fronts.

Sliding door system

▶ SlideLine M

▶ System components

Set of fittings for doors without Silent System



Set comprises:

- ▶ 2 running components without Silent System
- ▶ 2 guide components
- ▶ 2 end stops
- ▶ 4 guide bushes
- ▶ Fixing screws for wooden doors

Door material	Quantity required for one door	minimum door width in mm	Order no.	PU
Wooden door, Door with 55 mm aluminium frame*	1 set	300	9 156 339	1 set

Set of fittings for doors with Silent System (in closing, opening and colliding direction)



Set comprises:

- ▶ 2 running components with Silent System
- ▶ 2 guide components
- ▶ 2 end stops
- ▶ 2 guide bushes
- ▶ Fixing screws for wooden doors
- ▶ 1 Silent System in colliding direction

Door material	Quantity required for one door	minimum door width in mm	Order no.	PU
Wooden door, Door with 55 mm aluminium frame*	1 set	450	9 156 338	1 set

* The sets of fittings can be used for wooden or 55 mm aluminium frame doors without additional upgrade sets. Please note that appropriate self tapping screws must be used for installing the running and guide components on the 55 mm aluminium frame.

Upgrade set for 19 mm aluminium frame doors without Silent System

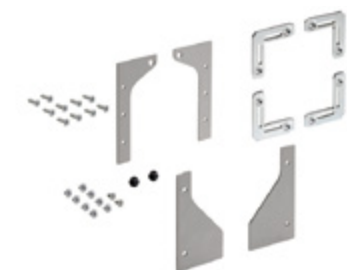

Set comprises:

- ▶ 2 guide component mounting adapters
- ▶ 2 mounting adapters for running components without Silent System
- ▶ 4 L shaped corner straps
- ▶ 2 guide bushes
- ▶ Fixing screws

Please refer to page 15 for the cross section of suitable aluminium frame profiles.

Door material	Frame colour	Quantity required for one door	Set of fittings additionally required	Minimum door width in mm	Order no.	PU
19 mm aluminium frame doors	Silver	1 set	9 156 339	300	9 184 629	1 set
	Black	1 set	9 156 339	300	9 184 706	1 set

Upgrade set for 19 mm aluminium frame doors with Silent System

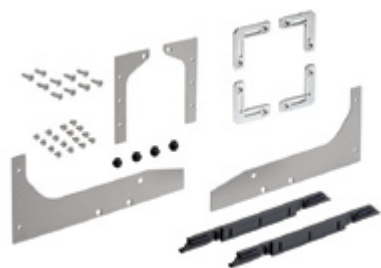

Set comprises:

- ▶ 2 guide component mounting adapters
- ▶ 2 mounting adapters for running components with Silent System
- ▶ 4 L shaped corner straps
- ▶ 4 screw on blocks
- ▶ 4 guide bushes
- ▶ Fixing screws

Please refer to page 15 for the cross section of suitable aluminium frame profiles.

Door material	Frame colour	Quantity required for one door	Set of fittings additionally required	Minimum door width in mm	Order no.	PU
19 mm aluminium frame doors	Silver	1 set	9 156 338	450	9 184 626	1 set
	Black	1 set	9 156 338	450	9 184 703	1 set

Sliding door system

- ▶ SlideLine M
- ▶ System components

Upgrade set for screw mounted glass doors without Silent System

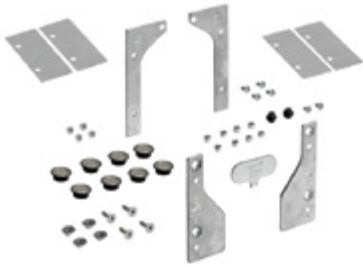

Set comprises:

- ▶ 2 screw on mounting adapters for guide components
- ▶ 2 screw on mounting adapters for running components without Silent System
- ▶ 8 discs for running and guide components, including washers, bushings and cover caps
- ▶ 2 guide bushes
- ▶ 4 cover films
- ▶ 1 special tool
- ▶ Fixing screws

Door material	Quantity required for one door	Set of fittings additionally required	Minimum door width in mm	Order no.	PU
6 mm glass door	1 set	9 156 339	300	9 184 596	1 set

Upgrade set for screw mounted glass doors with Silent System

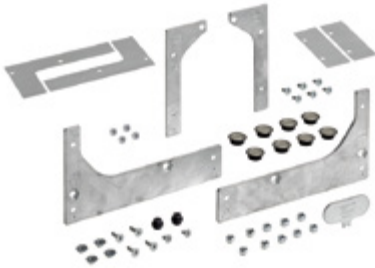

Set comprises:

- ▶ 2 screw on mounting adapters for guide components
- ▶ 2 screw on mounting adapters for running components with Silent System
- ▶ 8 discs for running and guide components, including washers, bushings and cover caps
- ▶ 2 guide bushes
- ▶ 4 cover films
- ▶ 1 special tool
- ▶ Fixing screws

Door material	Quantity required for one door	Set of fittings additionally required	Minimum door width in mm	Order no.	PU
6 mm glass door	1 set	9 156 338	450	9 184 595	1 set

Upgrade set for glue mounted glass doors with Silent System



- ▶ For use with 2-component adhesive
- ▶ Supplied without adhesive
- ▶ Material: zinc alloy to DIN EN 12844-ZP5

Set comprises:

- ▶ 2 adhesive mounting adapters for guide components
- ▶ 2 adhesive mounting adapters for running components with Silent System
- ▶ 6 overrun strips
- ▶ 1 special tool

Door material	Quantity required for one door	Set of fittings additionally required	Minimum door width in mm	Order no.	PU
Glass door	1 set	9 156 338	450	9 184 566	1 set

Installation instructions:

The adapters must be glued to the glass door by the specialised fabricator who must also select an adhesive and gluing method suitable for the door's specific properties. The fabricator must make sure that the bond is permanently capable of taking up the forces that are produced by the SlideLine M's intended use (see page 19). Hettich accepts no responsibility for gluing the adapter on correctly.

Sliding door system

▶ SlideLine M

▶ System components

Profile sets: 2 profiles

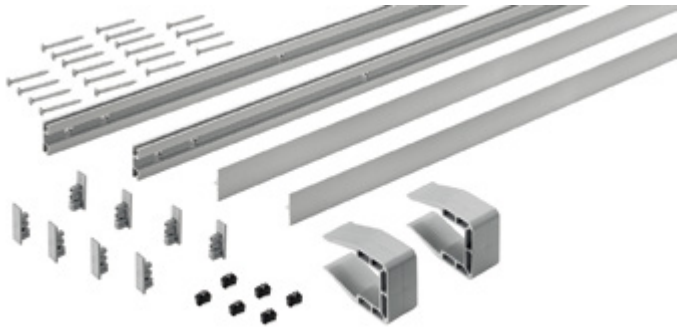

Set comprises:

- ▶ 2 aluminium anodised runner profiles, perforated
- ▶ 2 clip on aluminium decorative profiles or 2 glue on ABS decorative profiles
- ▶ 4 end caps
- ▶ 4 end caps (replacement)
- ▶ 2 end stops
- ▶ 4 end stops (replacement)
- ▶ 2 mounting clips
- ▶ Fixing screws

All profile sets available in the following specification:

Profile height mm	Shelf thickness in mm	Decorative profile	Colour	Length in mm*	Order no.	PU
16	15, 16	for gluing	silver	3000	9 157 985	1 set
16	15, 16	for gluing	silver	4000	9 157 986	1 set
16	15, 16	for gluing	black	3000	9 157 998	1 set
16	15, 16	for gluing	black	4000	9 157 999	1 set
18	18, 19	for gluing	silver	3000	9 157 983	1 set
18	18, 19	for gluing	silver	4000	9 157 984	1 set
18	18, 19	for gluing	black	3000	9 158 000	1 set
18	18, 19	for gluing	black	4000	9 158 001	1 set
22	22	for gluing	silver	3000	9 157 897	1 set
22	22	for gluing	silver	4000	9 157 979	1 set
22	22	for gluing	black	3000	9 157 981	1 set
22	22	for gluing	black	4000	9 157 980	1 set
25	25	for clipping on	silver	3000	9 157 812	1 set
25	25	for clipping on	silver	4000	9 158 234	1 set
25	25	for clipping on	black	3000	9 157 982	1 set
25	25	for clipping on	black	4000	9 158 233	1 set
38	38	for gluing	silver	3000	9 158 408	1 set
38	38	for gluing	silver	4000	9 158 410	1 set
38	38	for gluing	black	3000	9 158 381	1 set
38	38	for gluing	black	4000	9 158 386	1 set

* Customised lengths on request

Sliding door system

▶ SlideLine M

▶ System components

Profile sets: 1 profile

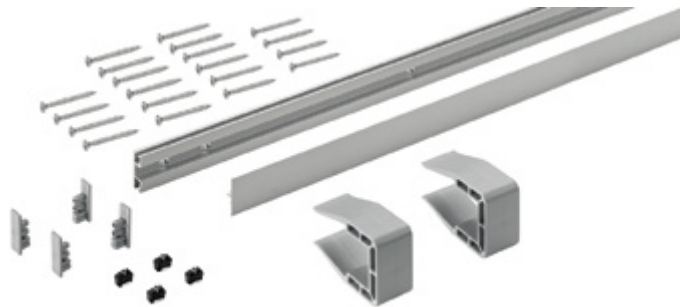

Set comprises:

- ▶ 1 aluminium anodized runner profile, perforated
- ▶ 1 clip on aluminium decorative profile or 1x glue on ABS decorative profile
- ▶ 2 end caps
- ▶ 2 end caps (replacement)
- ▶ 2 end stops
- ▶ 2 end stops (replacement)
- ▶ 2 mounting clips
- ▶ Fixing screws

All profile sets available in the following specification:

Profile height mm	Shelf thickness in mm	Decorative profile	Colour	Length in mm*	Order no.	PU
16	15, 16	for gluing	silver	3000	9 160 335	1 set
16	15, 16	for gluing	silver	4000	9 160 337	1 set
16	15, 16	for gluing	black	3000	9 160 333	1 set
16	15, 16	for gluing	black	4000	9 160 334	1 set
18	18, 19	for gluing	silver	3000	9 160 211	1 set
18	18, 19	for gluing	silver	4000	9 160 212	1 set
18	18, 19	for gluing	black	3000	9 160 199	1 set
18	18, 19	for gluing	black	4000	9 160 200	1 set
22	22	for gluing	silver	3000	9 160 391	1 set
22	22	for gluing	silver	4000	9 160 392	1 set
22	22	for gluing	black	3000	9 160 393	1 set
22	22	for gluing	black	4000	9 160 394	1 set
25	25	for clipping on	silver	3000	9 160 395	1 set
25	25	for clipping on	silver	4000	9 160 396	1 set
25	25	for clipping on	black	3000	9 160 397	1 set
25	25	for clipping on	black	4000	9 160 398	1 set
38	38	for gluing	silver	3000	9 160 399	1 set
38	38	for gluing	silver	4000	9 160 400	1 set
38	38	for gluing	black	3000	9 160 401	1 set
38	38	for gluing	black	4000	9 160 402	1 set

* Customised lengths on request

Decorative profile (accessories / replacement)



- ▶ Self adhesive
- ▶ Easily shortened

Profile height mm	Colour	Length mm	Order no.	PU
16	silver	4000	9 160 994	1 ea.
16	black	4000	9 160 996	1 ea.
18	silver	4000	9 160 997	1 ea.
18	black	4000	9 160 998	1 ea.
22	silver	4000	9 160 999	1 ea.
22	black	4000	9 161 000	1 ea.
38	silver	4000	9 161 011	1 ea.
38	black	4000	9 161 012	1 ea.

Sliding door system

- ▶ SlideLine M
- ▶ Planning dimensions

Wooden door / 55 mm aluminium frame door with Silent System

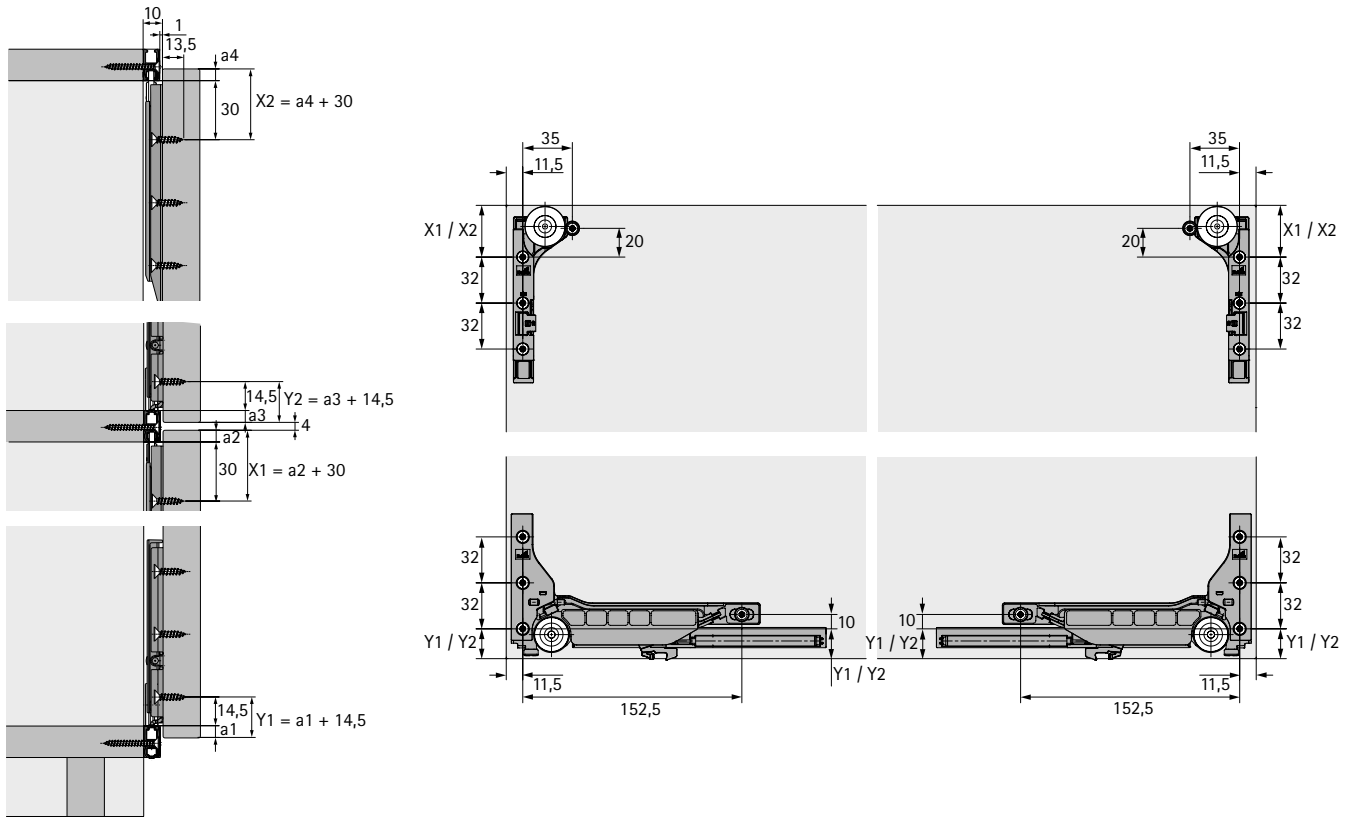

Wooden door, 55 mm aluminium frame door without Silent System

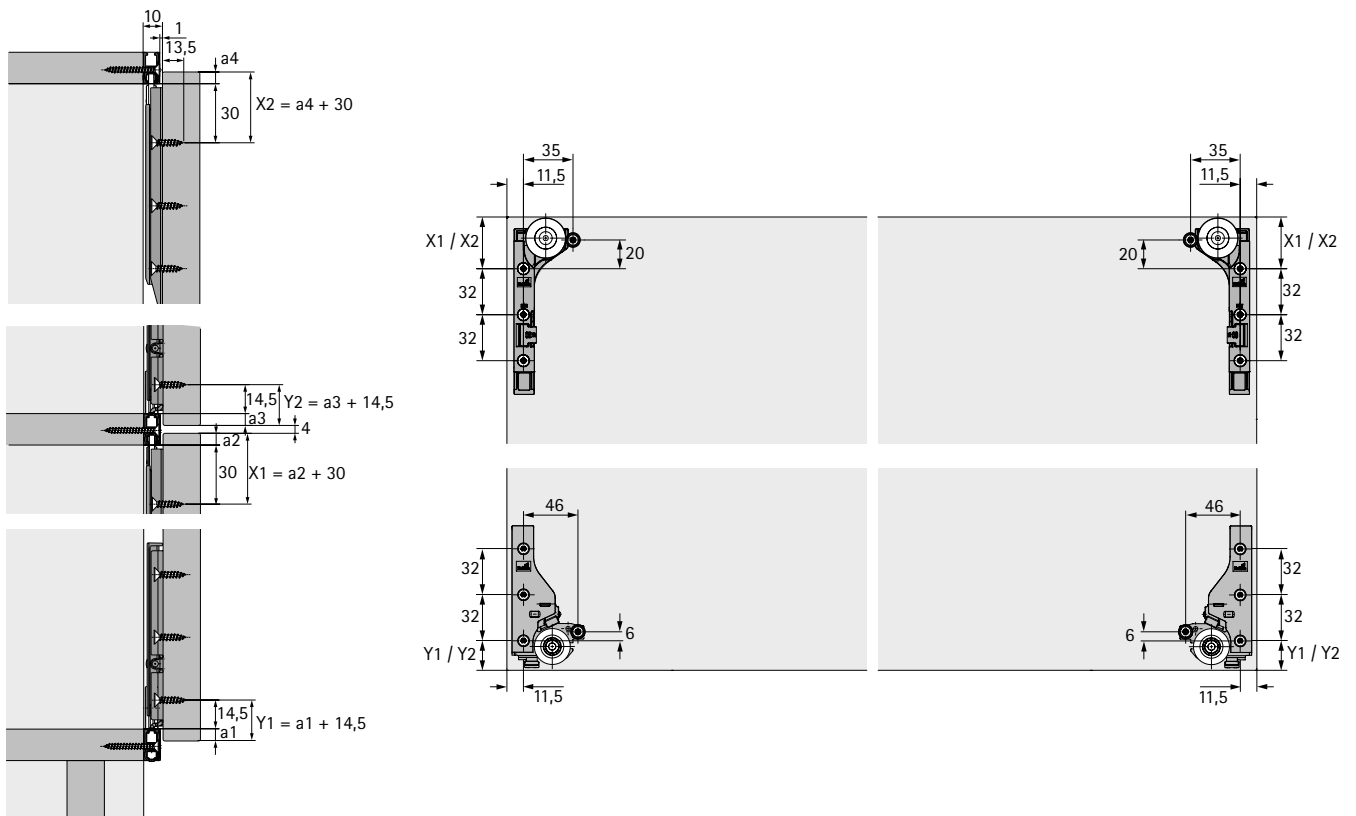

Sliding door system

- ▶ SlideLine M
- ▶ Planning dimensions

19 mm aluminium frame door with Silent System

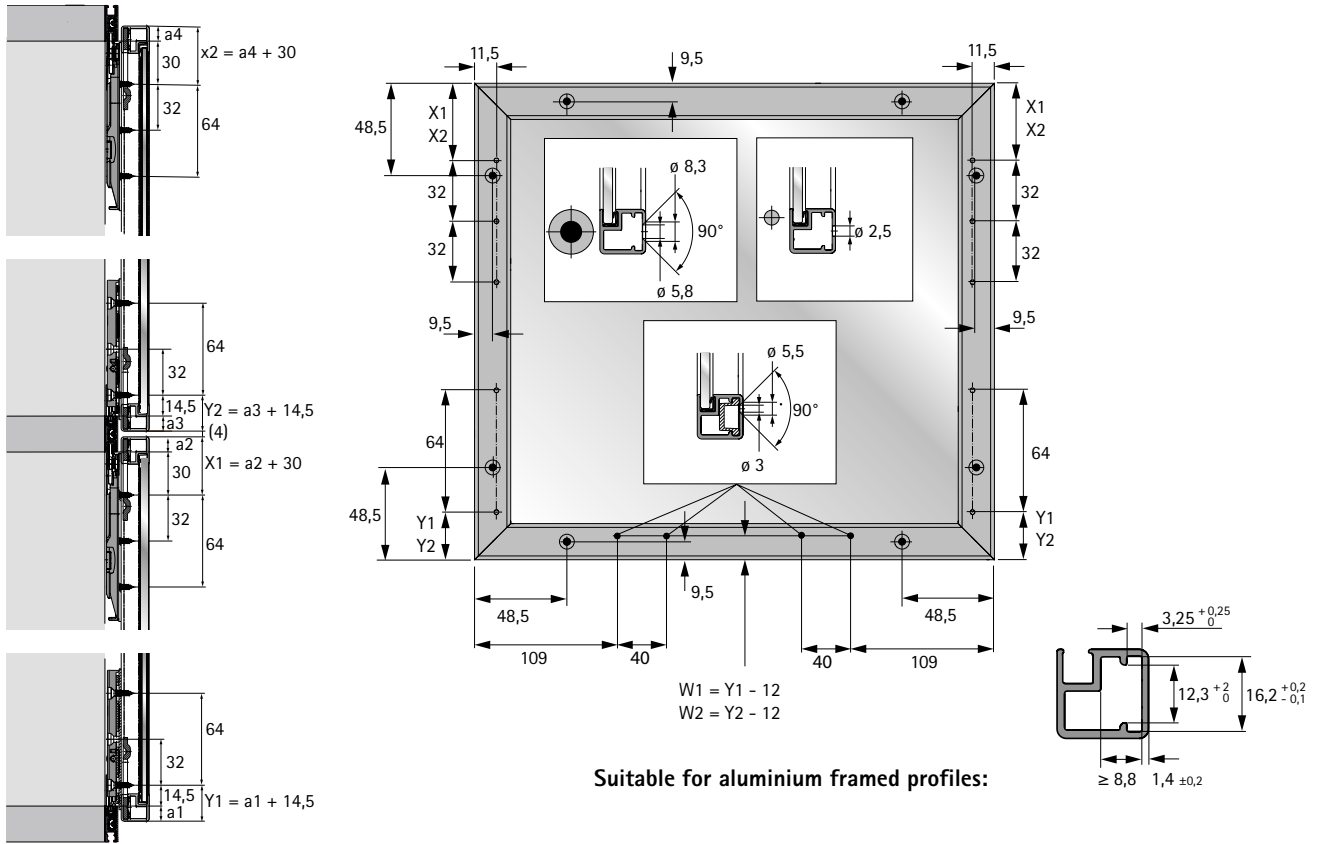

19 mm aluminium frame door without Silent System

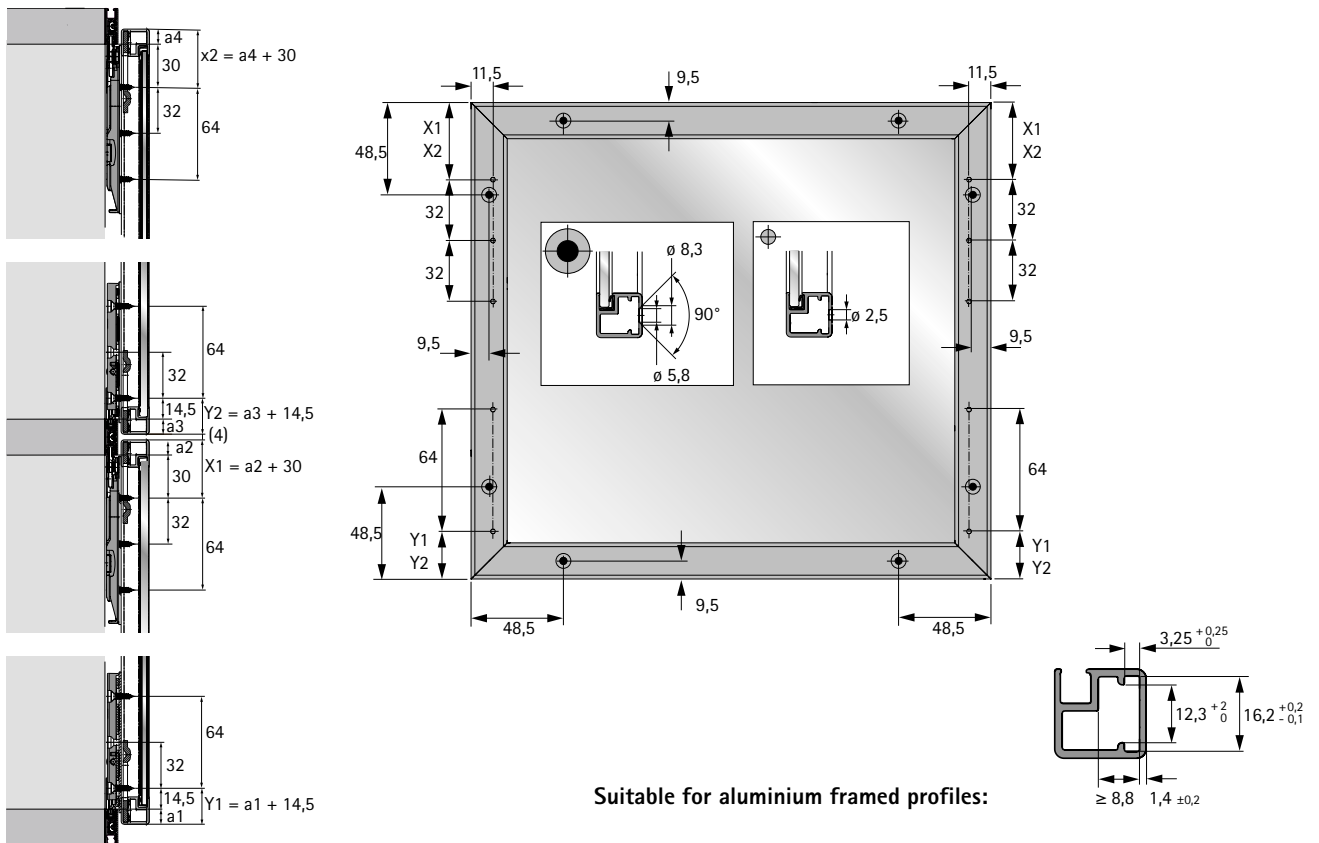

Sliding door system

- ▶ SlideLine M
- ▶ Planning dimensions

Screw mounted glass door with Silent System

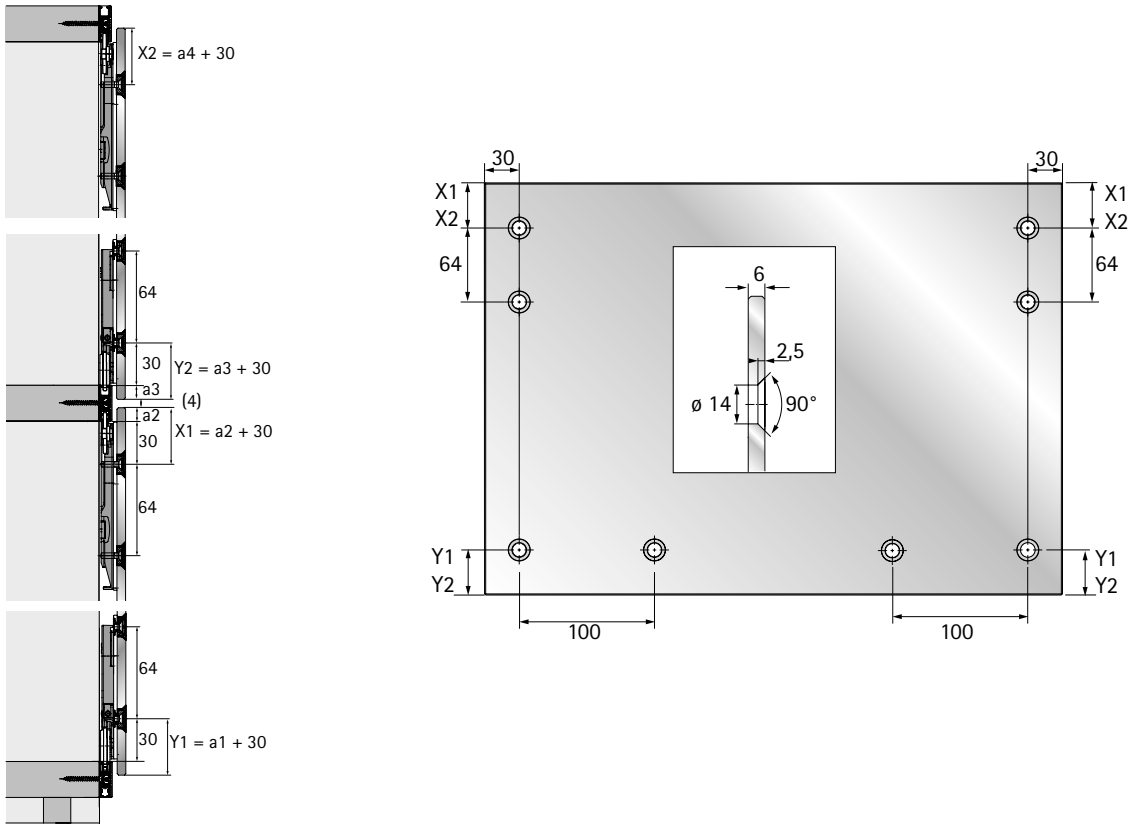

Screw mounted glass door without Silent System

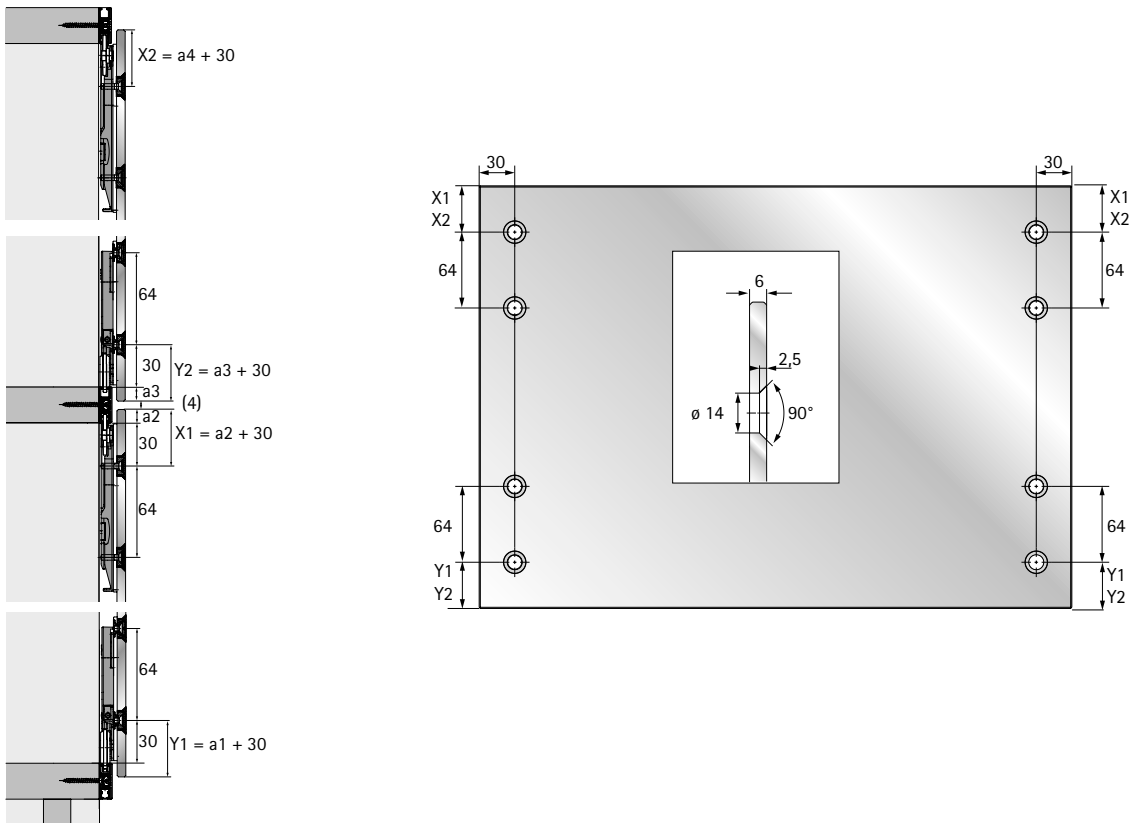

Sliding door system

- ▶ SlideLine M
- ▶ Planning dimensions

Glue mounted glass door with Silent System

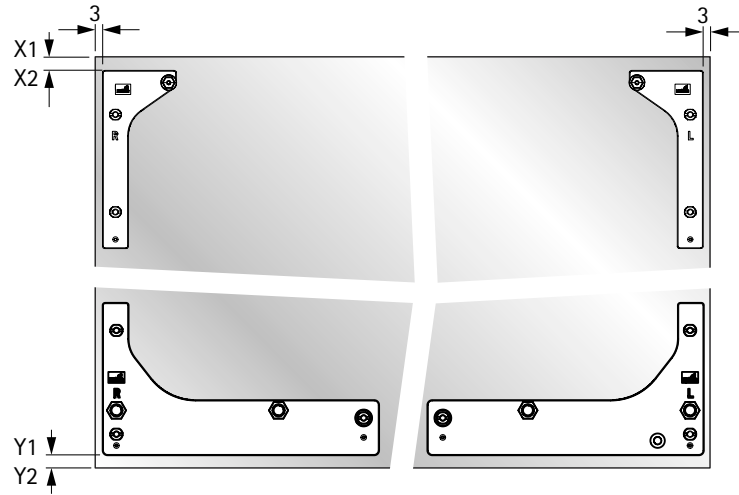
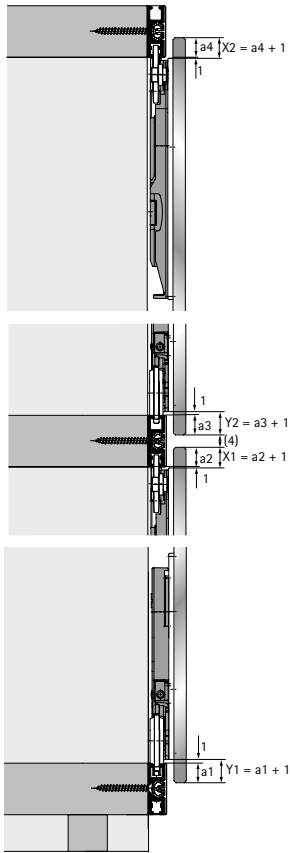

Quality that meets all the demands

The quality of sliding door systems is subject to a process of continuous monitoring. Hettich fittings comply with the national and international quality standards of the markets our customers operate in. The diagrams below show examples of the principles behind some of the testing processes.

SlideLine M with Silent System (9 156 338)

- ▶ Endurance test over 40,000 cycles
- ▶ Closing test with a pulling force of 4 kg
- ▶ Lift out test at 250 N
- ▶ Load test in horizontal direction at 250 N

SlideLine M without Silent System (9 156 339)

- ▶ Endurance test over 10,000 cycles
- ▶ Closing test with a pulling force of 2 kg
- ▶ Lift out test at 150 N
- ▶ Load test in horizontal direction at 150 N

Endurance test

The door is required to withstand a specific number of opening and closing cycles at a defined speed.

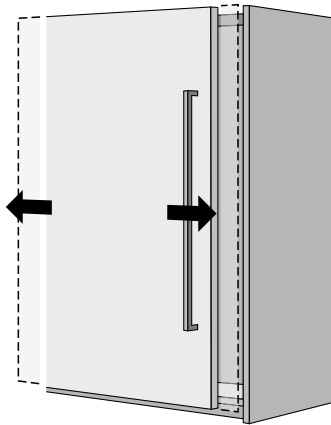

Lift off guard

The door is pulled up and forwards at an angle with a defined force and must not come off or fall out of the carcass.

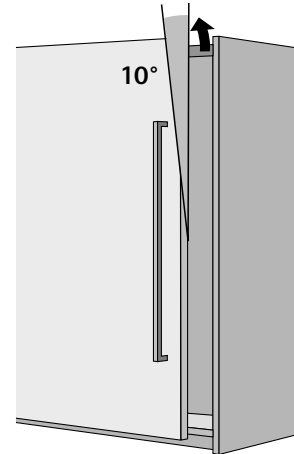

Closing test

The door must withstand a specific number of closing cycles under a defined tensile load.

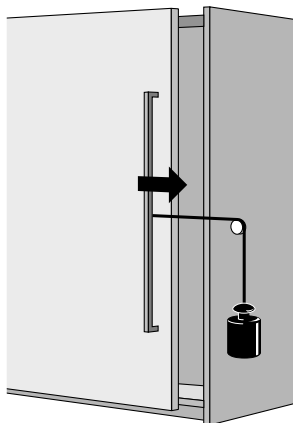

Horizontal safety test

Pressure is applied to the middle of the door with a defined force. The door must not come off or fall out of the carcass.

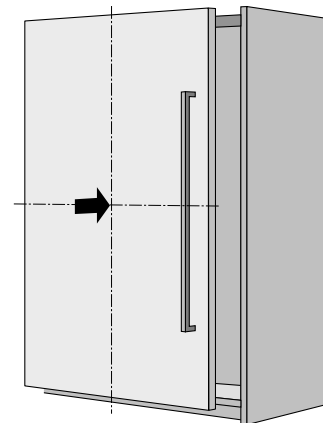

Sliding door system

- ▶ SlideLine M
- ▶ Safety precautions

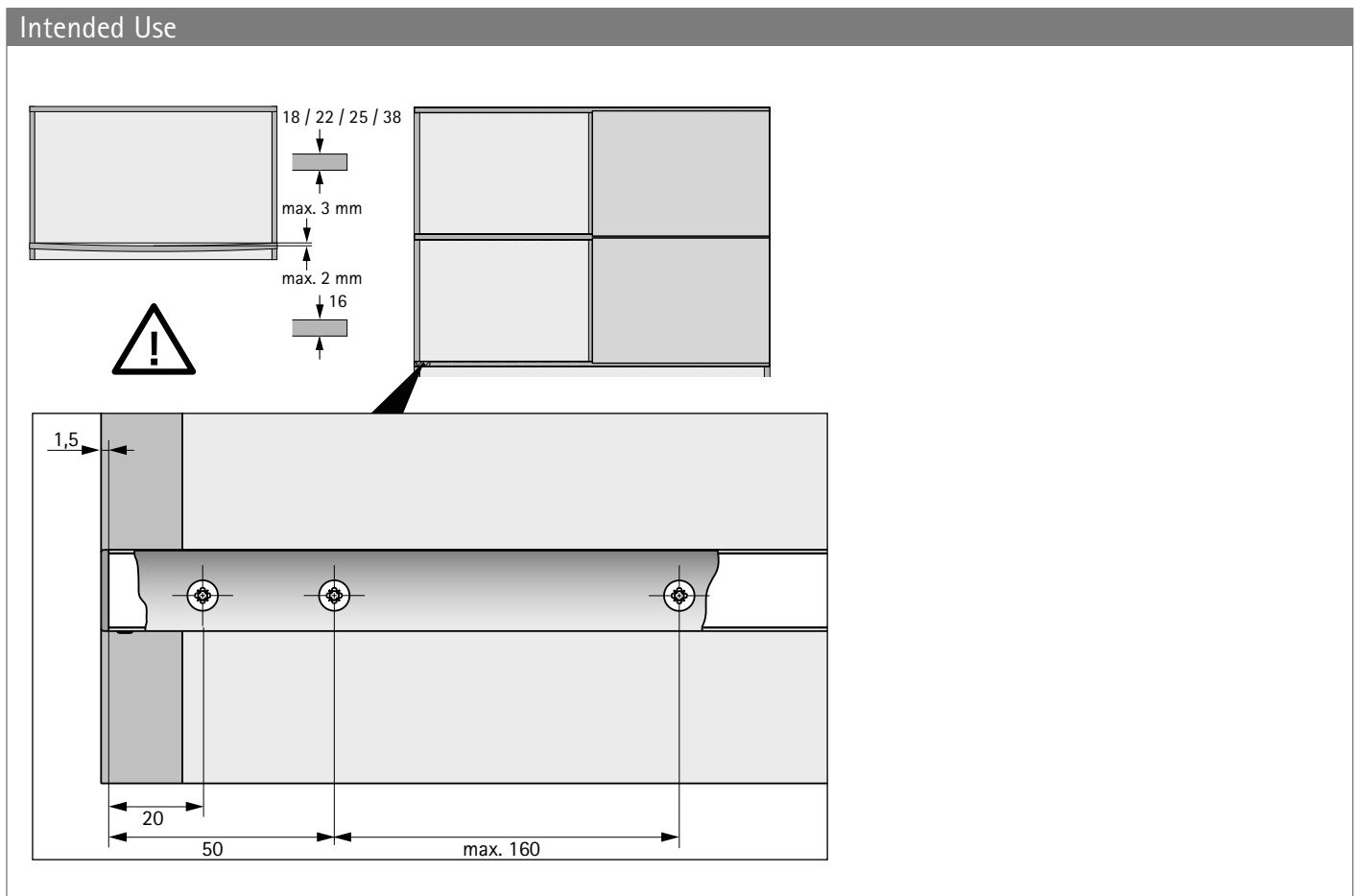

Intended Use

The SlideLine M furniture fitting is intended for application in furniture and use in dry indoor environments where it is protected from the elements. The version of the fitting with Silent System meets the requirements under DIN EN 15706 Level 3. The version of the fitting without Silent System meets the requirements under DIN EN 15706 Level 1.

Technical specifications

Door weight:	up to 30 kg	
Door format	Min.	Max.
Width:	300 mm	1800 mm
Height:	300 mm	2000 mm
Max. height H for width W:	$H \leq 2 W$	
Shelf thicknesses:	15 mm, 16 mm, 18 mm, 19 mm, 22 mm, 25 mm, 38 mm	
Height adjustment:	+/- 2.0 mm	

When constructing furniture, it is important to note that the sliding door must be no higher than twice its width. Up to this relative height, SlideLine M meets the above stated quality and safety requirements under DIN EN 15706. If the specified maximum relative height is exceeded, the furniture construction must undergo a function and safety test as defined in the relevant furniture standard.

Under DIN EN 15706 Level 1, the version of the fitting without Silent System is approved for use if it passes the 2 kg closing test provided for there. If a higher loading capacity is to be reached, e.g. on the grounds of requirements defined in a relevant furniture standard, this must be ensured by the fabricator in terms of furniture design (e.g. inset installation).



Safety risk

The SlideLine M sliding door fitting is only suitable for applications in which the design of furniture and its dimensional accuracy are capable of ensuring that the top and bottom runners always remain parallel (i.e. even where a particularly heavy load is weighing on a fixed shelf / top or bottom panel to which a runner is connected, for example) with a tolerance of no more than +/- 1.5 mm (+/- 1 mm for 16 mm shelves / panels) from the specified distance between both runners. Any failure to meet this requirement, e.g. as a result of sag in the panel to which the bottom runner is mounted, presents a safety risk (door falling out of the runner) that may cause personal injury.

The stops must be securely mounted in the profile (see Fig. 1a/1b) or safety could be put at risk (from door coming off at side) which may result in personal injury.

Sliding door system

- ▶ SlideLine M
- ▶ Installing profile sets: 16 mm, 18 mm, 22 mm, 38 mm

1. Installing end stops

16 mm
7

18 mm
8,5

22 mm
11

38 mm
19

$Z = a + 16,5$

$Z = a + 11,5$

$\varnothing 1,5$

16 mm
18 mm
22 mm

38 mm

16 mm
18 mm
22 mm
38 mm

Sliding door system

► SlideLine M

► Installing profile sets: 16 mm, 18 mm, 22 mm, 38 mm

2. Installing end caps

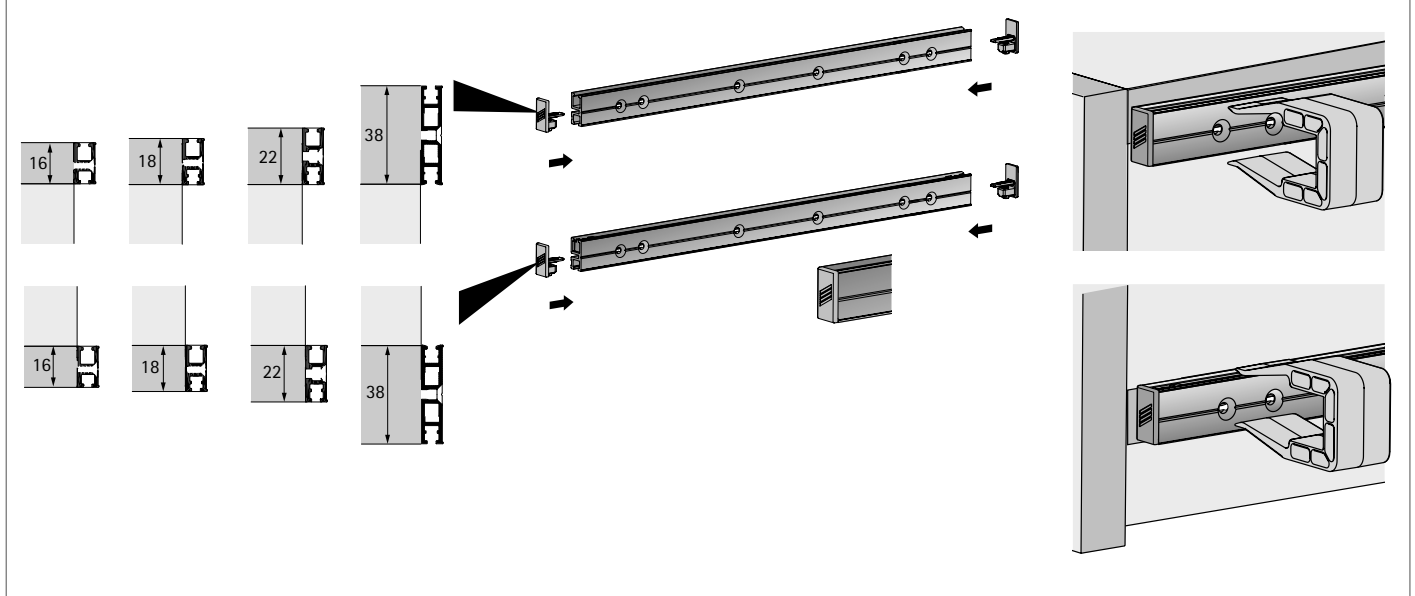

3. Installing profiles

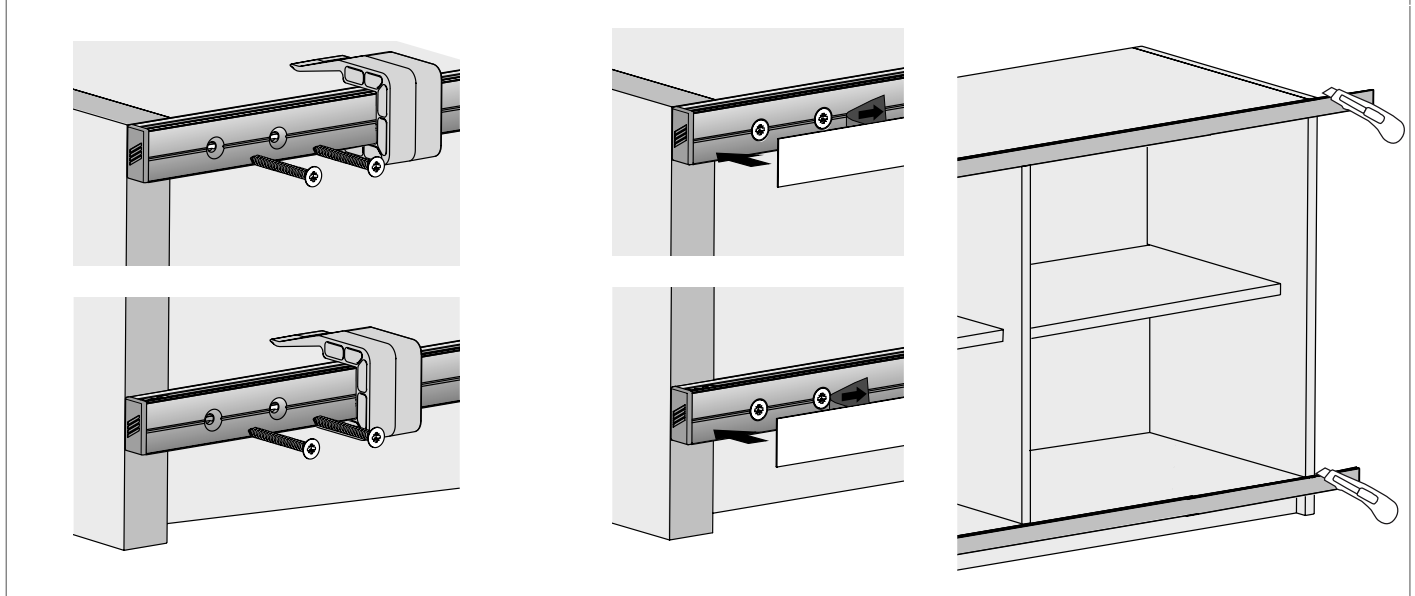

Sliding door system

▶ SlideLine M

▶ Installing profile set: 25 mm

1. Installing end stops

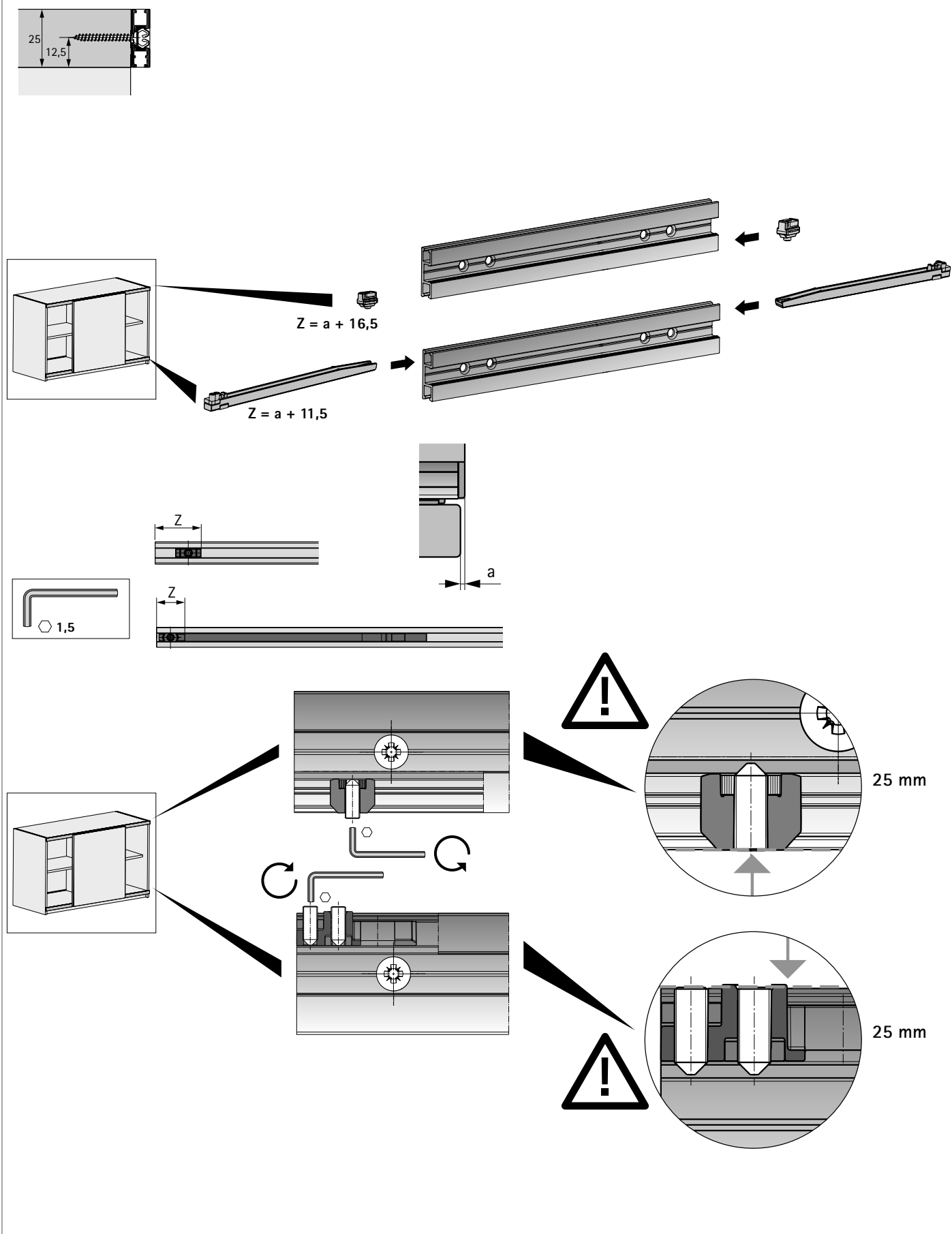

Sliding door system

► SlideLine M

► Installing profile set: 25 mm

2. Installing end caps

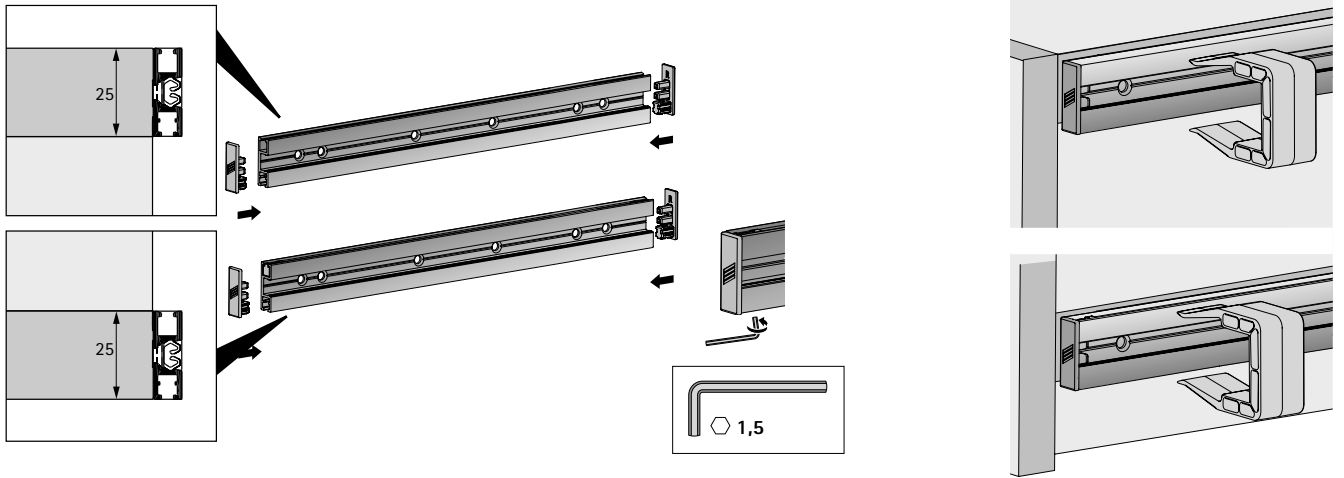

3. Installing profiles

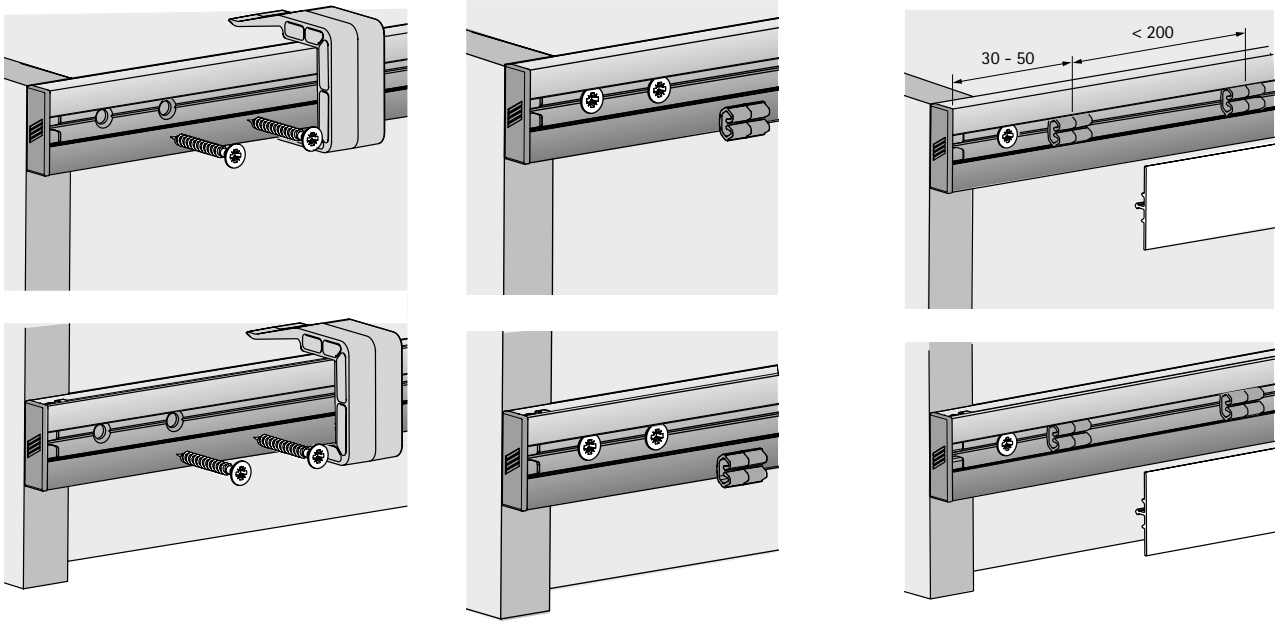

Sliding door system

- ▶ SlideLine M
- ▶ Installation

Installing fitting set

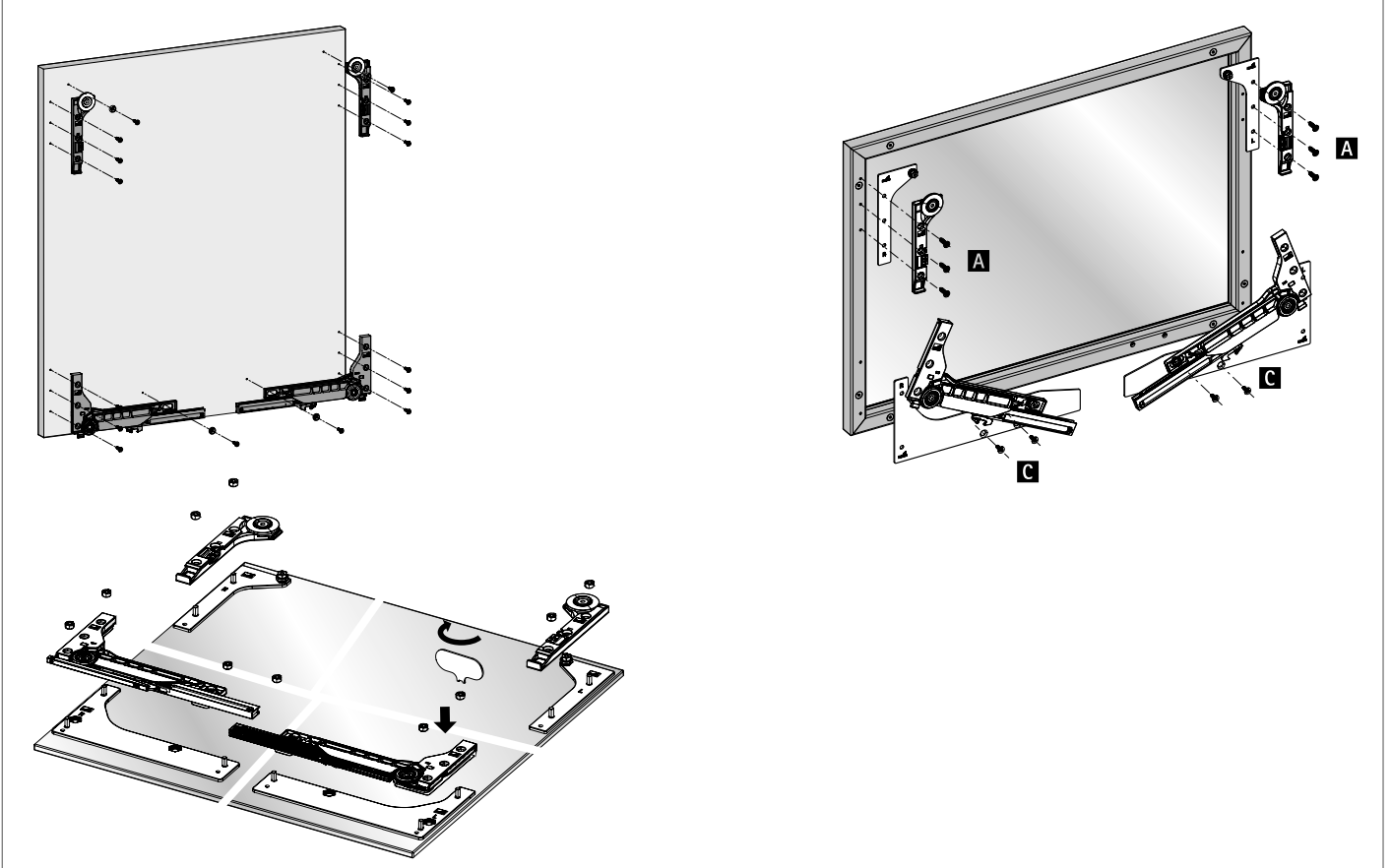

Installing door

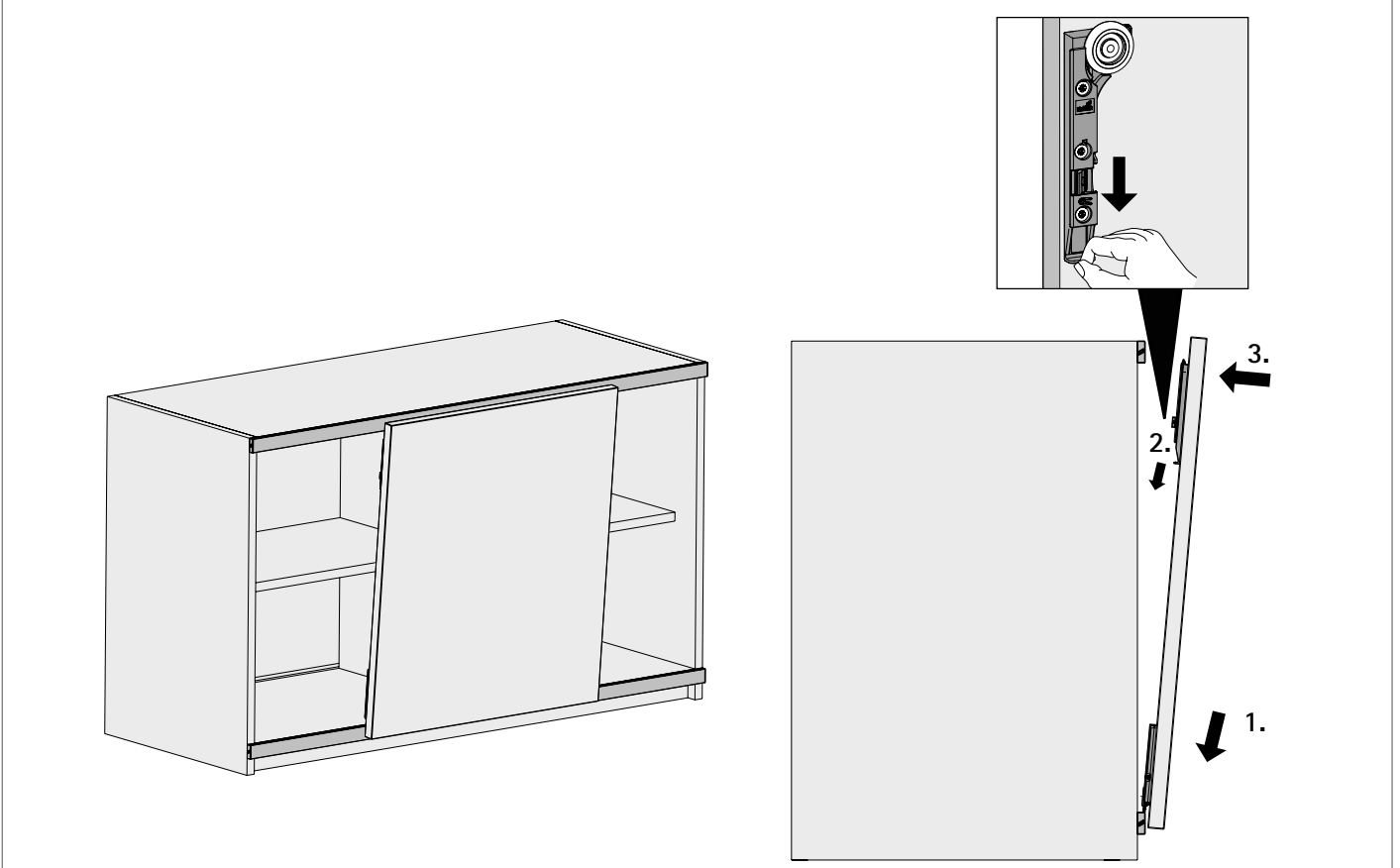

Sliding door system

- ▶ SlideLine M
- ▶ Installation

Aligning door

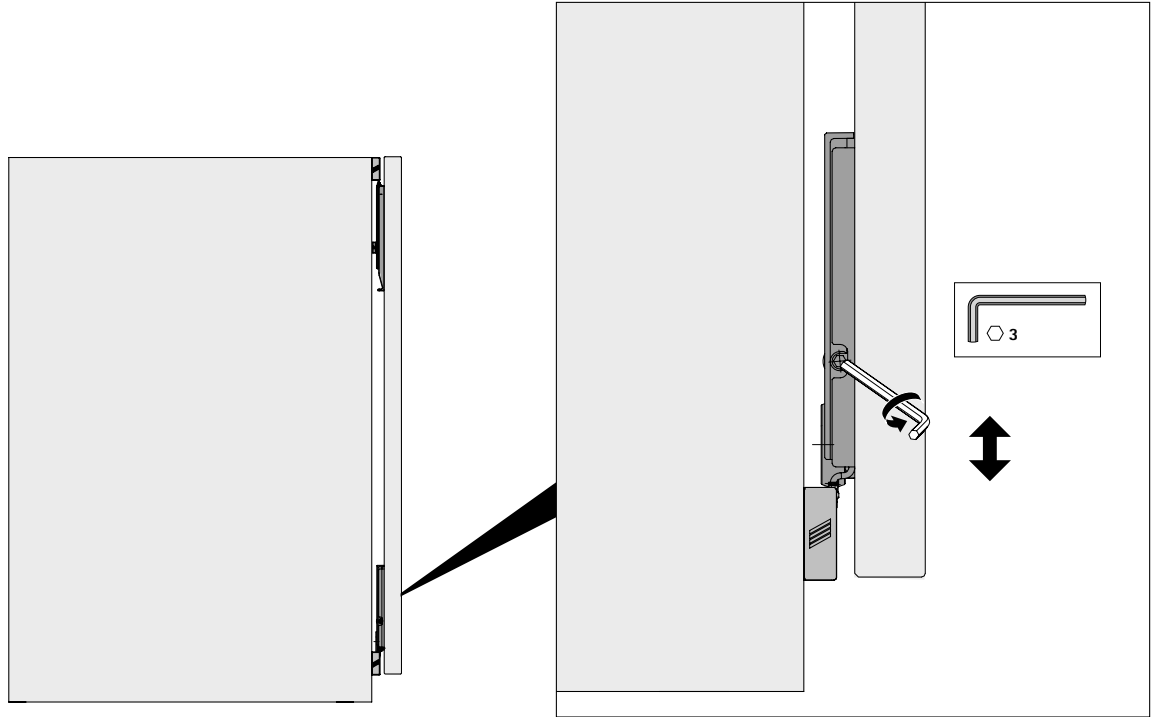
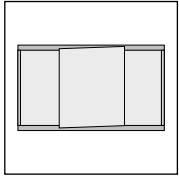

Securing door

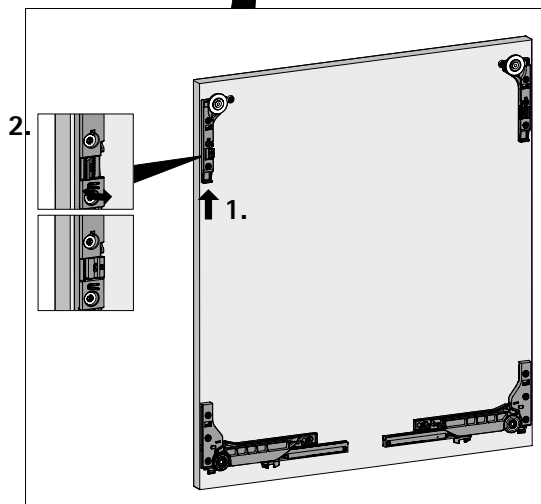
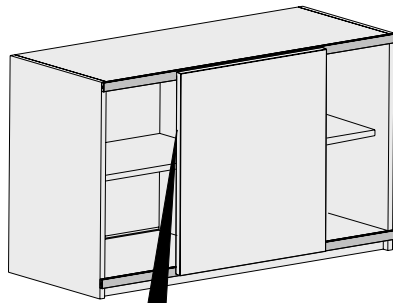
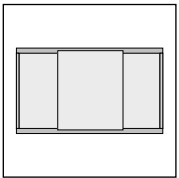

Hettich and the environment: committed to responsible practice, active protection, innovative thinking.



Hettich takes a responsibility for the world we live in. This awareness defines the strict policy of environmental management we practise. Our environmental officer has taken personal responsibility for these aspects throughout the group of companies over a period of many years. In addition, a separate environment committee has been established for each production site. We regard statutory provisions as minimum requirements. At significant sites we also implement the stringent EMAS Regulation. And we drive forward developments that in future will help to save even more raw materials and support the necessary endeavours towards sustainability.

Hettich environmental management

In 1996 Hettich started introducing effective environmental management systems under the stringent EMAS Regulation (currently: EC Regulation No. 761/2001, including EN ISO 14.001/2004). This not only enables us to

improve our environmental performance on a broad front but also achieve a high level of safety which, not least, also benefits our customers. This is why we also require our suppliers to meet the necessary minimum standards of environmental protection, industrial safety, health care and social welfare.

The results achieved in the drawer runner and drawer system product segment at the Kirchlengern operation illustrate the impressive effects these measures have and verifiably demonstrate our tireless endeavours to translate words into action:

Relief to the environment between 1997 and 2008:

Specific water consumption:	56 per cent
Specific power consumption:	21 per cent
Specific heat consumption:	84 per cent
Specific CO ₂ emissions:	29 per cent



Hettich standard for product materials

Hettich underpins its commitment by applying an internal standard for product materials. This ensures that every product – from production to disposal – satisfies all environmental requirements. Hettich products are durable. Appropriately foresighted, our rigorous standards are formulated to ensure that international legislation is met as well. This provides a reliable basis for marketing furniture worldwide.

Zero energy building – Hettich Forum

The Hettich Forum building with its neutral energy balance is a shining example of future proof building design. Photovoltaic panels and solar collection system providing hot water as well as extensive roof greening and use of rain water underscore this building's overall sustainability concept in just the same way as the broad use of cellulose

insulation material from recycled newspapers, highly efficient heat recovery and the bulb free lighting concept do.

With the Hettich Group having acquired European Commission GreenBuilding Partner status on 5 March 2009, the comprehensive approach demonstrated by the Hettich Forum has also convinced the adjudicating panel of the national "Green Building Award 2009". Hettich received the first prize to be presented in the "New Building" category.

Technik für Möbel



www.hettich.com

Order no. 9 191 882
1406-044_SideLine-M_1114_HHE/en

Technik für Möbel

