

# Outdoor like never before

Discover the  
NEW Iconic® Outdoor range



**Reduced installation time**

New patented technology for a faster, weather protected finish.



**Proven durability**

Designed for New Zealand outdoors.



**Future-proof design**

PDL Wiser™ smart connectivity and stylish finishes to suit your customers' needs.



Discover more

[pdl.co.nz/IconicOutdoor](https://pdl.co.nz/IconicOutdoor)

Life Is On

**Schneider**  
Electric



# Iconic<sup>®</sup> Outdoor Range

Introducing our next generation outdoor platform. Designed with electricians in mind.



Integrated seals into the frame reduce the need for sealants making a clean and fast installation.



New game changing design with new aesthetics for unrivalled appearance and functionality now and in the future.



PDL Iconic Outdoor sockets have integrated sealed shutters to provide IP54 protection and keep your connection reliable.



Innovative clip-on skins reduce the need for screws during installation, making a quick and easy install every time.

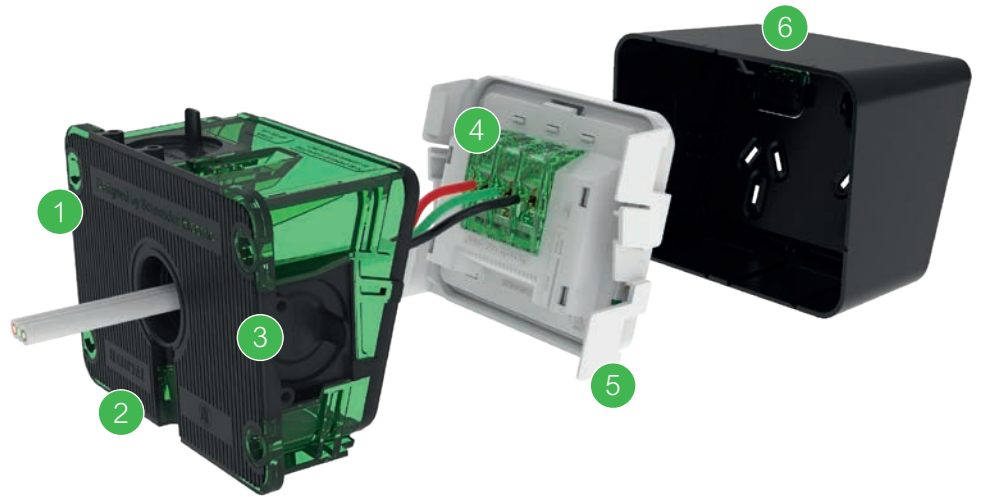

- 1 Mounting holes outside the waterproof area. Requires no drilling or caps to ensure IP rating.
- 2 Full over-moulded rubber on back to prevent slipping on the wall and absorb inconsistencies in the wall surface.
- 3 All seals integrated into the frame fix onto conduits or cables reducing the need for additional sealants. Seals can be easily opened with pull tabs.
- 4 In-line terminals make installation faster and easier.
- 5 Large clips allow the grid to be attached in seconds.
- 6 A hidden press-to-release lock allowing the cover to be easily removed and replaced.

	<b>PDLO394-XW</b> Single Socket 10A 250V White.		<b>PDLO381-XW</b> Single Switch 20A_16AX 250V White.		<b>PDLO300CE-20</b> Conduit Entry Kit Diameter 20mm White.
	<b>PDLO394-BK</b> Single Socket 10A 250V Black.		<b>PDLO381-BK</b> Single Switch 20A_16AX 250V Black.		<b>O3000CE-20-BK</b> Conduit Entry Kit Diameter 20mm Black.
	<b>PDLO395-XW</b> Twin Socket 10A 250V White.		<b>PDLO394CS-XW</b> Single Socket with Timer 10A 250V White.		<b>PDLO300CE-25</b> Conduit Entry Kit Diameter 25mm White.
	<b>PDLO395-BK</b> Twin Socket 10A 250V Black.		<b>PDLO394CS-BK</b> Single Socket with Timer 10A 250V Black.		<b>O3000CE-25-BK</b> Conduit Entry Kit Diameter 25mm Black.



Discover more  
[pdl.co.nz/IconicOutdoor](https://pdl.co.nz/IconicOutdoor)

Life Is On

**Schneider**  
Electric