

COMMERCIAL MAXISPAN WINDOW / DOOR JAMB FLASHING FOR HORIZONTAL CLADDING. (Recessed Window/Door)

DETAIL NO. CMSW032B
 DATE DRAWN 16/08/12
 FILE REFERENCE RI-CMSW032B.DWG

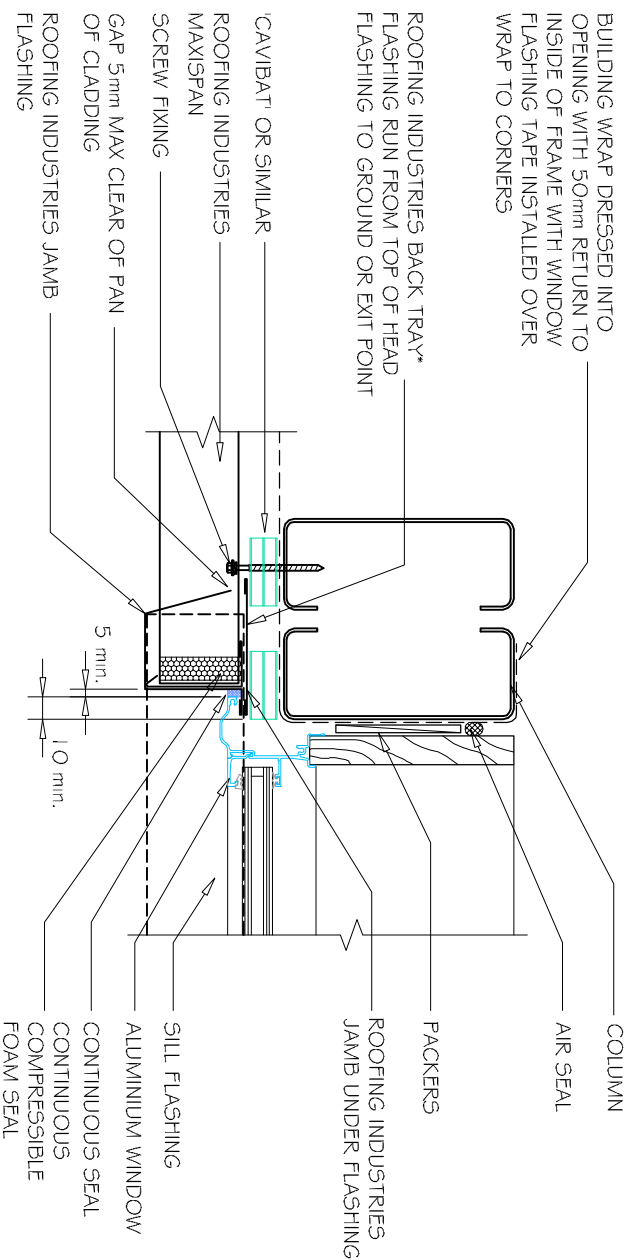

B WINDOW JAMB HORIZONTAL MAXISPAN
 1:5

- GENERAL NOTES:
- (1) REFER TO E2/AS1 OR WANZ WIS FOR GENERAL WINDOW OPENING FOR WRAPPING
 - (2) WINDOW PROFILE TO BE SELECTED TO ACHIEVE COVER SHOWN IN DETAILS.
 - (3) ARCHITRAVES ARE SHOWN FOR CONSISTENCY ONLY, DETAIL MAY BE USED WITH REBATED LINER.
 - (4) WHERE SUPPORT BRACKETS ARE REQUIRED BY THE WINDOW MANUFACTURER TO CARRY THE FRAME AND GLAZING LOADS, THEY MUST BE SUPPLIED AS AN INTEGRAL PART OF THE WINDOW MANUFACTURERS RECOMMENDATIONS.
 - (5) LASE WITH WINDOW MANUFACTURER PRIOR TO INSTALLATION.

REFERENCE FLASHINGS:
 NZ METAL ROOF AND WALL CLADDING
 CODE OF PRACTICE NZMRM,
 WANZ WIS.
 DIMENSIONS ARE INDICATIVE ONLY

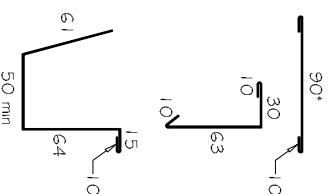

* Back tray size may require to increase to ensure coverage at ends of head flashings.

(Dimensions are indicative only)
 Turn down end of head flashing

- NOTES:
- These details are generally in compliance with the NZ Metal Roof & Wall Cladding Code of Practice and in some cases specific details by Roofing Industries.
 - The building designer is ultimately responsible to ensure that details used meet the requirements of the NZ Building Code for the specific project.
 - Details of the supporting structure are indicative only and are the responsibility of the building designer.
 - Thermal break or cavity battens may be required in some circumstances.
 - Underlay selection and building wrap types are the responsibility of the designer, Alternative support to galvanised netting should be used in severe coastal environments including when aluminium is used.
 - These details are for Roofing Industries profiles as nominated and may not be applicable to other profiles.
 - This drawing is the copyright of Roofing Industries and can only be copied or reproduced with their permission.
 - Further information can be obtained from the NZ Metal Roof & Wall Cladding Code of Practice www.metdroof.co.nz & www.roof.co.nz
 - Where necessary adjust drawings for purlin battens or cavity battens.
 - Details are for steel based materials, other substrate may require some changes.

©COPYRIGHT DETAIL 2012

