

COMMERCIAL MAXISPAN WALL CLADDING HORIZONTAL CLADDING BASE

DETAIL NO.

CMSW025A

DATE DRAWN

11/02/12

FILE REFERENCE

RI-CMSW025A.DWG

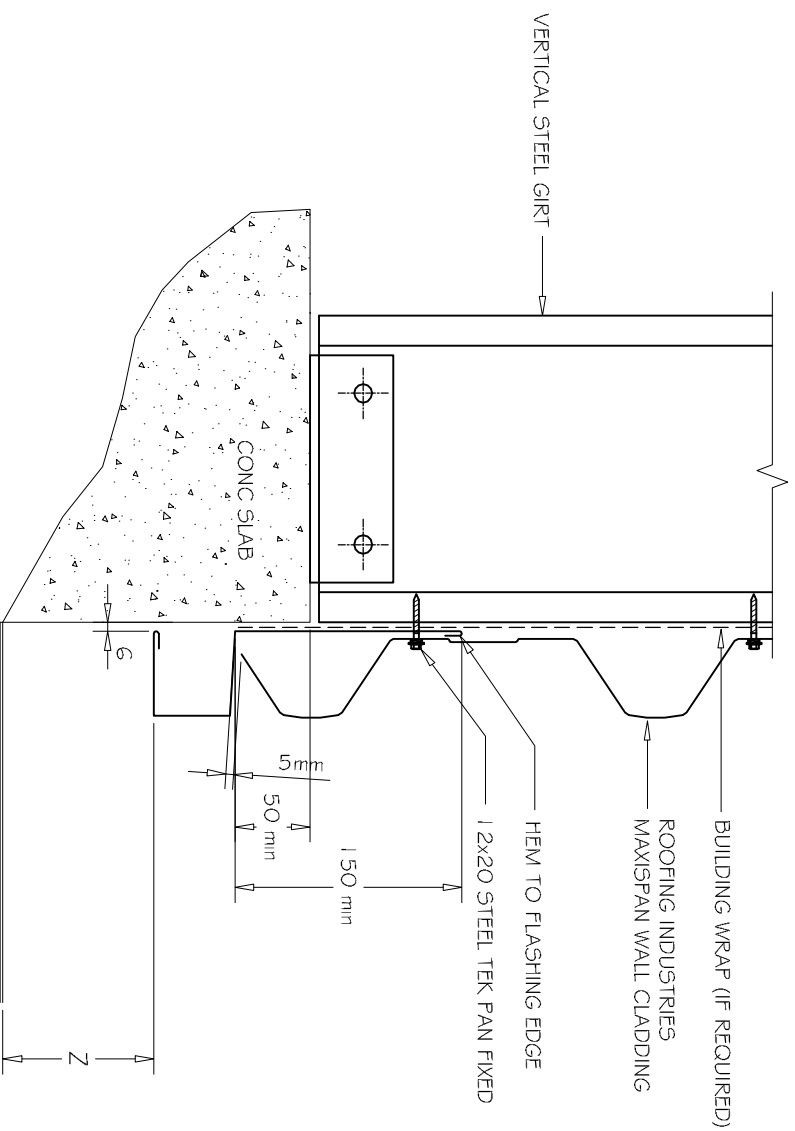

SET DOWN	MINIMUM	Z
PAVED SURFACE	100mm	
UNPAVED SURFACE	175mm	

NOTE:

- (1) THE BOTTOM EDGE OF THE CLADDING SHALL OVERLAP THE FOUNDATION WALL
- (2) DFC MUST BE INSTALLED UNDER ALL SURFACES IN CONTACT WITH A CONCRETE SUBSTRATE.

NOTES:

- These details are generally in compliance with the NZ Metal Roof & Wall Cladding Code of Practice and in some cases specific details by Roofing Industries.
- The building designer is ultimately responsible to ensure that details used meet the requirements of the NZ Building Code for the specific project.
- Details of the supporting structure are indicative only and are the responsibility of the building designer.
- Thermal break or cavity battens may be required in some circumstances.
- Underlay selection and building wrap types are the responsibility of the designer, alternative support to galvanised netting should be used in severe coastal environments including when aluminum is used.
- These details are for Roofing Industries' profiles as nominated and may not be applicable to other profiles.
- This drawing is the copyright of Roofing Industries' and can only be copied or reproduced with their permission.
- Further information can be obtained from the NZ Metal Roof & Wall Cladding Code of Practice www.metd-roofer.org.nz & www.roof.co.nz
- Where necessary adjust drawings for purlin battens or cavity battens.
- Details are for steel based materials, other substrate may require some changes.



A BASE DETAIL HORIZONTAL MAXISPAN
1:5

©COPYRIGHT DETAIL 2012

