

# COMMERCIAL MAXISPAN ROOFING TRANSLUCENT STOP END

DETAIL NO. CMSR040A

DATE DRAWN 11/03/12

FILE REFERENCE R1-CMSR040A.DWG

**NOTE:**

- (1) MINIMUM PITCH 3°
- (2) INSTALL WIDE TOP FOAM CLOSURE STRIP OVER TRANSLUCENT BEFORE INSTALLING OVERFLASHING / RIDGE ETC.

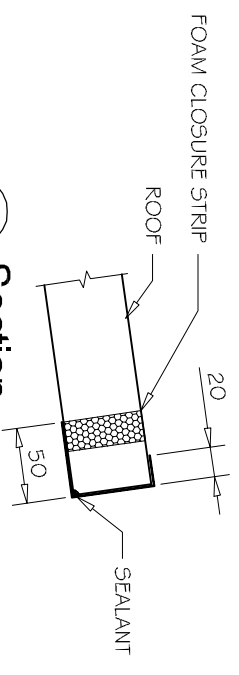
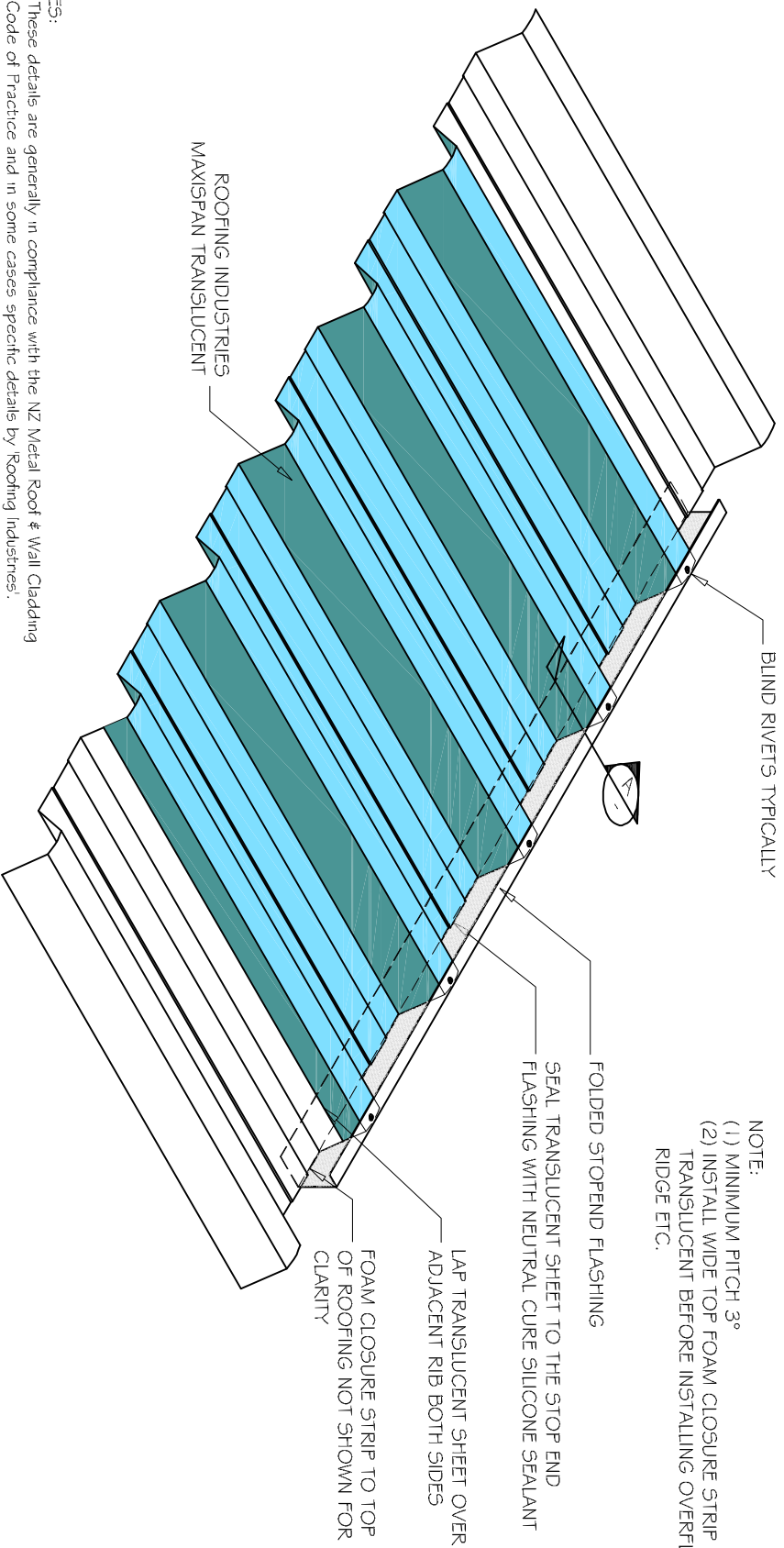

- NOTES:**
- These details are generally in compliance with the NZ Metal Roof & Wall Cladding Code of Practice and in some cases specific details by Roofing Industries.
  - The building designer is ultimately responsible to ensure that details used meet the requirements of the NZ Building Code for the specific project.
  - Details of the supporting structure are indicative only and are the responsibility of the building designer.
  - Thermal break or cavity battens may be required in some circumstances.
  - Underlay selection and building wrap types are the responsibility of the designer, Alternative support to galvanised netting should be used in severe coastal environments including when aluminium is used.
  - These details are for Roofing Industries' profiles as nominated and may not be applicable to other profiles.
  - This drawing is the copyright of Roofing Industries' and can only be copied or reproduced with their permission.
  - Further information can be obtained from the NZ Metal Roof & Wall Cladding Code of Practice [www.metlroofer.org.nz](http://www.metlroofer.org.nz) & [www.roof.co.nz](http://www.roof.co.nz)
  - Where necessary adjust drawings for purlin battens or cavity battens.
  - Details are for steel based materials, other substrate may require some changes.

©COPYRIGHT DETAIL 2012

