

# COMMERCIAL MULTIRIB ROOFING 175 BOX GUTTER DETAIL (External Bracket)

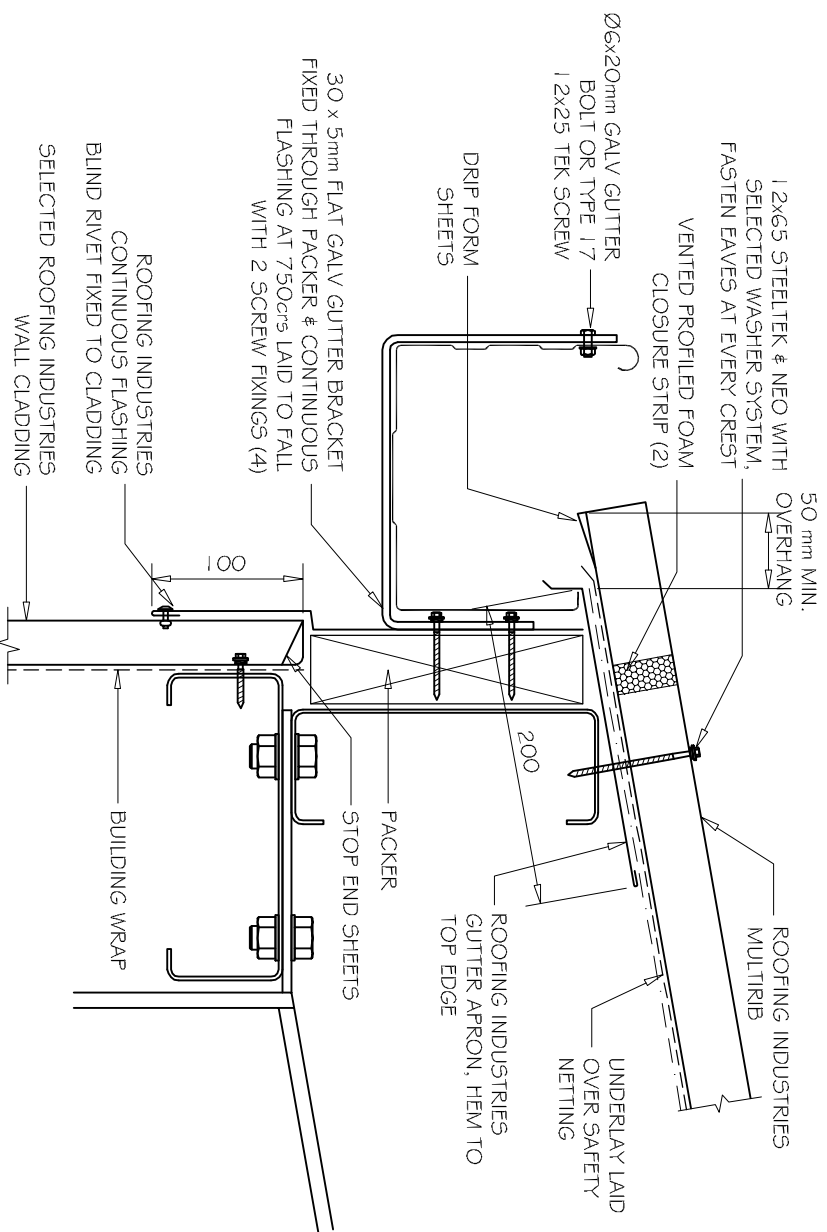

## NOTES:

- These details are generally in compliance with the NZ Metal Roof & Wall Cladding Code of Practice and in some cases specific details by Roofing Industries.
- The building designer is ultimately responsible to ensure that details used meet the requirements of the NZ Building Code for the specific project.
- Details of the supporting structure are indicative only and are the responsibility of the building designer.
- Thermal break or cavity battens may be required in some circumstances.
- Underlay selection and building wrap types are the responsibility of the designer, Alternative support to galvanised netting should be used in severe coastal environments including when aluminum is used.
- These details are for Roofing Industries profiles as nominated and may not be applicable to other profiles.
- This drawing is the copyright of Roofing Industries and can only be copied or reproduced with their permission.
- Further information can be obtained from the NZ Metal Roof & Wall Cladding Code of Practice [www.metlroofer.org.nz](http://www.metlroofer.org.nz) & [www.roof.co.nz](http://www.roof.co.nz)
- Where necessary adjust drawings for purlin battens or cavity battens.
- Details are for steel based materials, other substrate may require some changes.

DETAIL NO. CMRRO3 I B

DATE DRAWN 01/03/12

FILE REFERENCE R1-CMRRO3 I B.DWG

## NOTES:

- (1) MINIMUM PITCH 3°
- (2) FOAM CLOSURE STRIP ONLY REQUIRED IN HIGH RISK SITUATIONS OF WIND BLOWN MOISTURE ENTERING OR IF BIRD OR VERMIN PROOFING IS REQUIRED.
- (3) FOR CAPACITY CALCULATION REFER TO NZMRM CODE OF PRACTICE.
- (4) SNOW STRAPS & BRACKETS TO BE FITTED AT 600c/s TO ALL GUTTERS IN AREAS SUBJECT TO SNOW.

**B** 175 BOX GUTTER MULTIRIB PROFILE  
- 1:5

©COPYRIGHT DETAIL 2012

