

# COMMERCIAL MULTIRIB ROOFING PARAPET HEAD APRON INTERNAL CLADDING

DETAIL NO.

CMRRO08A

DATE DRAWN

01/03/12

FILE REFERENCE

RI-CMRRO08A.DWG

EX 50mm H3.1 TIMBER CAPPING SUPPORT ON DFC

BUILDING WRAP

ROOFING INDUSTRIES 0.55mm  
PARAPET FLASHING

ROOFING INDUSTRIES PROFILED CLADDING

EX 40mm H3.1 HORIZ BATTENS ON DFC  
TYPE 17 12x40 TEK SCREW

PROFILED FOAM CLOSURE STRIP (2)  
12x65 STEELTEK & NEO  
WITH SELECTED WASHER  
SYSTEM

R.I. 0.55mm AFRON FLASHING  
NOTCHED TURN-DOWN OVER  
MULTIRIB, GAP 5mm MAX CLEAR  
OF TROUGH OF ROOFING

ROOFING INDUSTRIES  
MULTIRIB

UNDERLAY LAID OVER  
SAFETY NETTING

STEEL PURLIN & CLEAT

STRUCTURAL STEEL

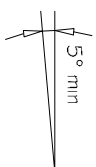

SEPERATION BARRIER BETWEEN CONCRETE  
& FLASHING (SELF ADHESIVE TAPE OR SIM)  
FIX CAPPING TO CONCRETE WITH MASONRY  
FASTENERS AT 600mm CRS

NOTE:

- (1) MINIMUM PITCH 3°
- (2) FOAM CLOSURE STRIPS ONLY REQUIRED IN HIGH  
RISK SITUATIONS OF WIND BLOWN MOISTURE ENTERING.

NOTES:

- These details are generally in compliance with the NZ Metal Roof & Wall Cladding Code of Practice and in some cases specific details by Roofing Industries.
- The building designer is ultimately responsible to ensure that details used meet the requirements of the NZ Building Code for the specific project.
- Details of the supporting structure are indicative only and are the responsibility of the building designer.
- Thermal break or cavity battens may be required in some circumstances.
- Underlay selection and building wrap types are the responsibility of the designer.
- Alternative support to galvanised netting should be used in severe coastal environments including when aluminum is used.
- These details are for Roofing Industries profile/s as nominated and may not be applicable to other profiles.
- This drawing is the copyright of Roofing Industries and can only be copied or reproduced with their permission.
- Further information can be obtained from the NZ Metal Roof & Wall Cladding Code of Practice [www.metaloof.co.nz](http://www.metaloof.co.nz) & [www.roof.co.nz](http://www.roof.co.nz)
- Where necessary adjust drawings for purlin battens or cavity battens.
- Details are for steel based materials, other substrate may require some changes.

CONCRETE  
WALL

STOP END

35 min

HEM TO  
FLASHING  
EDGE

90mm

STOP END

25

100mm

100mm LAP

200mm COVER

45mm GAP

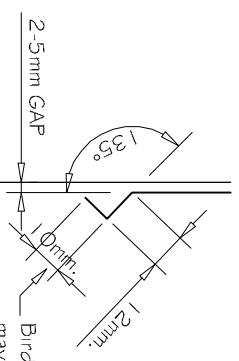
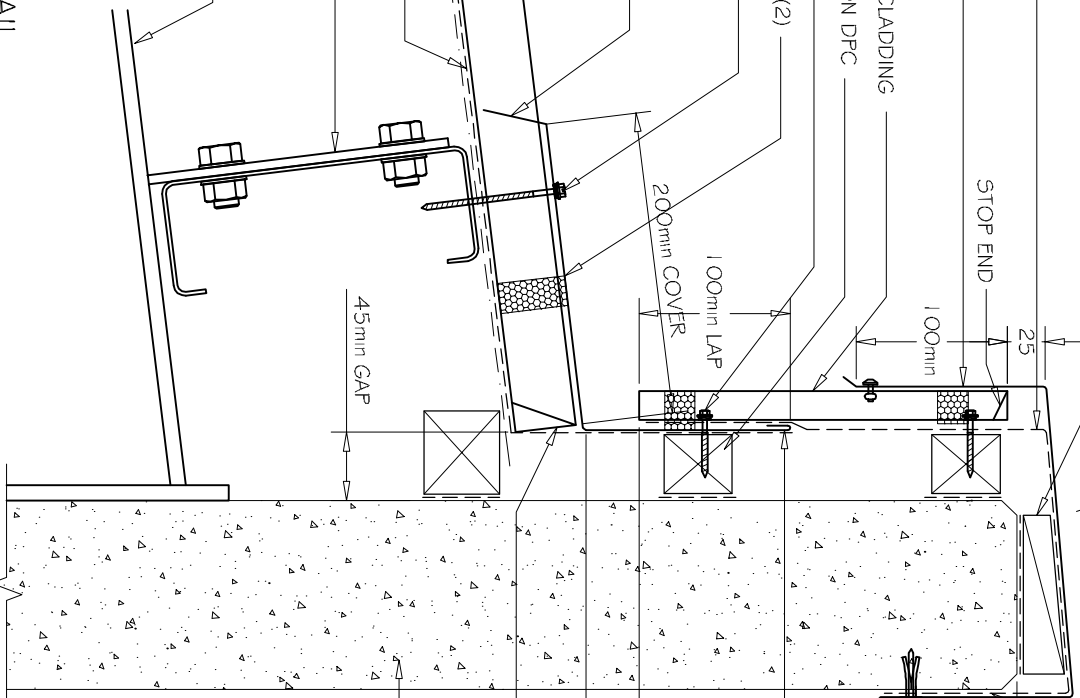

Bird's beak dimension  
may vary between  
manufacturing locations.

A PARAPET DETAIL  
1:5

©COPYRIGHT DETAIL 2012

