

COMMERCIAL RT7 ROOFING
125 BOX GUTTER DETAIL - External Bracket
(Pan Fixed)

DETAIL NO. CRT7R030C

DATE DRAWN 28/03/12

FILE REFERENCE R1-CRT7R030C.DWG

NOTES:

- (1) MINIMUM PITCH 3°
- (2) FOR CAPACITY CALCULATION REFER TO NZMRM CODE OF PRACTICE.
- (3) SNOW STRAPS AND BRACKETS TO BE FITTED AT 600c/s.
- (4) FOAM CLOSURE STRIP ONLY REQUIRED IN HIGH RISK SITUATIONS OF WIND BLOWN MOISTURE ENTERING OR IF BIRD OR VERMIN PROOFING IS REQUIRED.

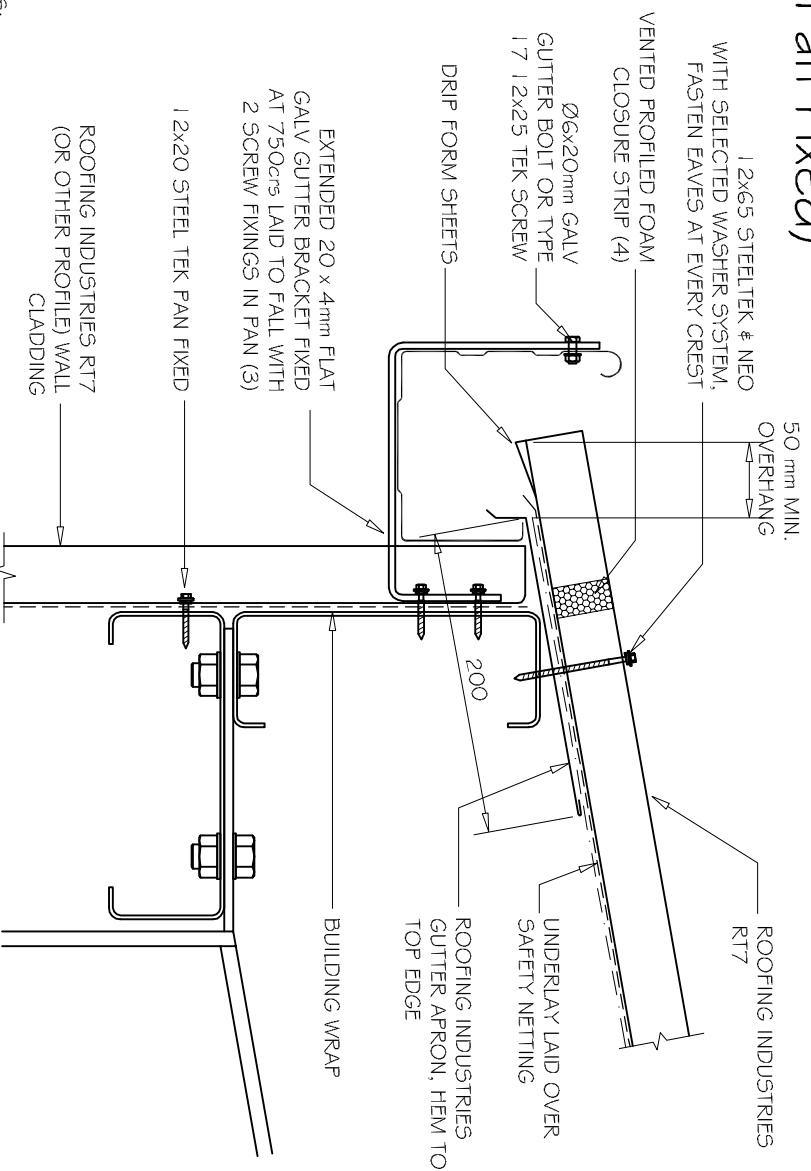

NOTES:

- These details are generally in compliance with the NZ Metal Roof & Wall Cladding Code of Practice and in some cases specific details by Roofing Industries¹.
- The building designer is ultimately responsible to ensure that details used meet the requirements of the NZ Building Code for the specific project.
- Details of the supporting structure are indicative only and are the responsibility of the building designer.
- Thermal break or cavity battens may be required in some circumstances.
- Underlayment selection and building wrap types are the responsibility of the designer.
- Alternative support to galvanneal netting should be used in severe coastal environments including when aluminum is used.
- These details are for Roofing Industries profiles as nominated and may not be applicable to other profiles.
- This drawing is the copyright of 'Roofing Industries' and can only be copied or reproduced with their permission.
- Further information can be obtained from the NZ Metal Roof & Wall Cladding Code of Practice www.metalroofers.org.nz & www.roof.co.nz
- Where necessary adjust drawings for purlin battens or cavity battens.
- Details are for steel based materials, other substrate may require some changes.

C	125 BOX GUTTER RT7 PROFILE
-	1:5

©COPYRIGHT DETAIL 2012

