

# COMMERCIAL RT7 ROOFING HEAD BARGE GIRTS BETWEEN COLUMNS (Notched - Birds Beak)

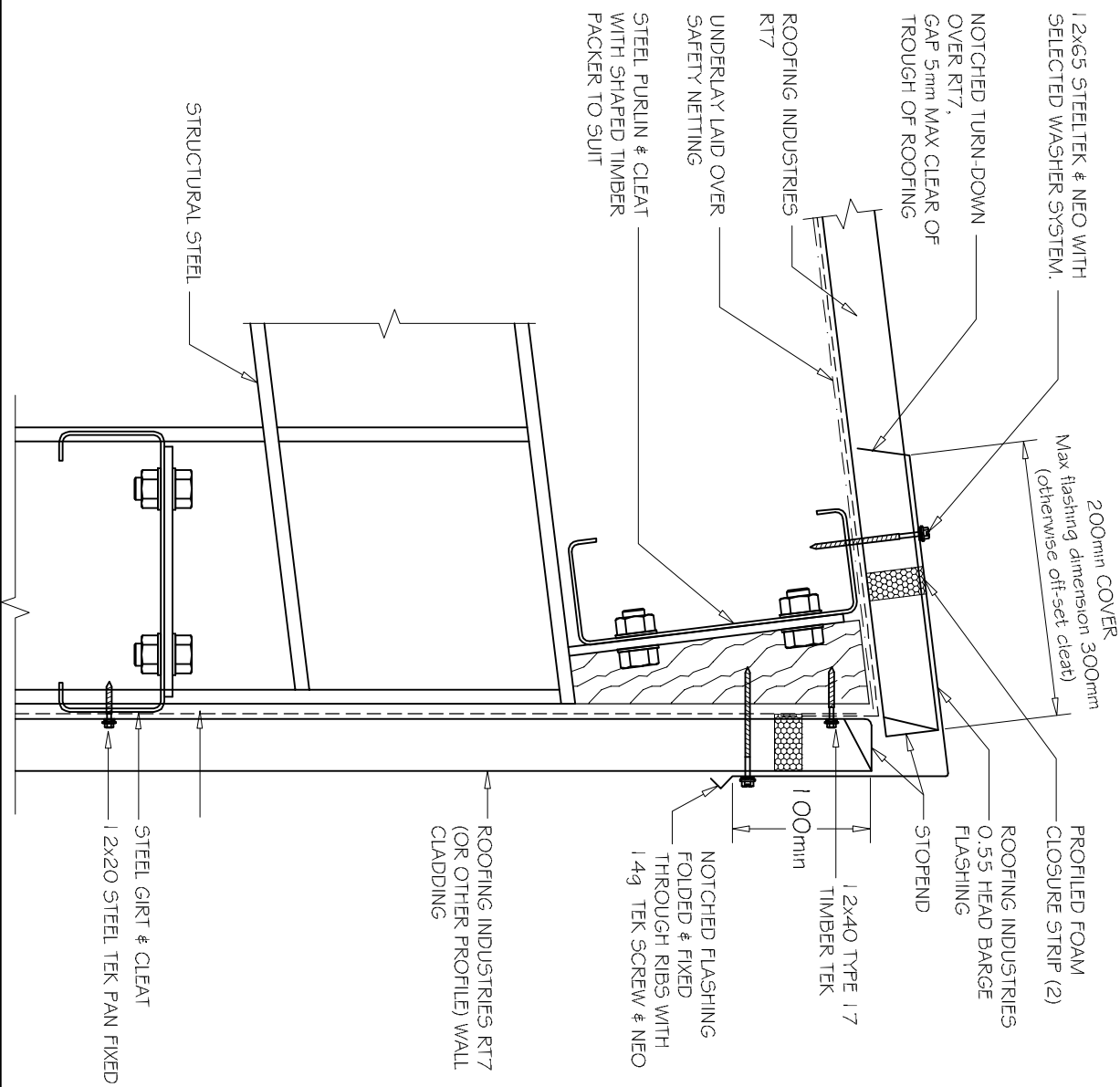

DETAIL NO. CRT7R004B  
DATE DRAWN 16/08/12  
FILE REFERENCE RI-CRT7R004B.DWG

- NOTE:  
(1) MINIMUM PITCH 3°  
(2) FOAM CLOSURE STRIP ONLY REQUIRED IN HIGH RISK SITUATIONS OF WIND BLOWN MOISTURE ENTERING.

- NOTES:
- These details are generally in compliance with the NZ Metal Roof & Wall Cladding Code of Practice and in some cases specific details by Roofing Industries.
  - The building designer is ultimately responsible to ensure that details used meet the requirements of the NZ Building Code for the specific project.
  - Details of the supporting structure are indicative only and are the responsibility of the building designer.
  - Thermal break or cavity battens may be required in some circumstances.
  - Underlay selection and building wrap types are the responsibility of the designer.
  - Alternative support to galvanised netting should be used in severe coastal environments including when aluminum is used.
  - These details are for Roofing Industries profiles as nominated and may not be applicable to other profiles.
  - This drawing is the copyright of Roofing Industries and can only be copied or reproduced with their permission.
  - Further information can be obtained from the NZ Metal Roof & Wall Cladding Code of Practice [www.metaloofers.org.nz](http://www.metaloofers.org.nz) & [www.roof.co.nz](http://www.roof.co.nz)
  - Where necessary adjust drawings for purlin battens or cavity battens.
  - Details are for steel based materials, other substrate may require some changes.

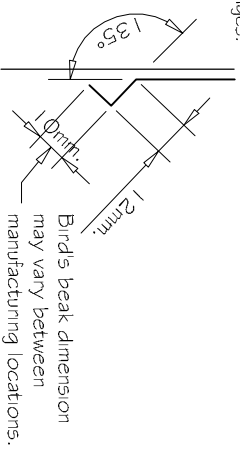

**B** HEAD BARGE  
1:5

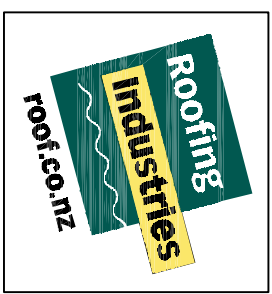

©COPYRIGHT DETAIL 2012