

ASSEMBLY SPECIFICATIONS

NZBAL-C12.0 | SPEC ID AS.35.00

'VETRO' (NO RAIL)

Refer elsewhere for corners, slopes and other situations not illustrated here.

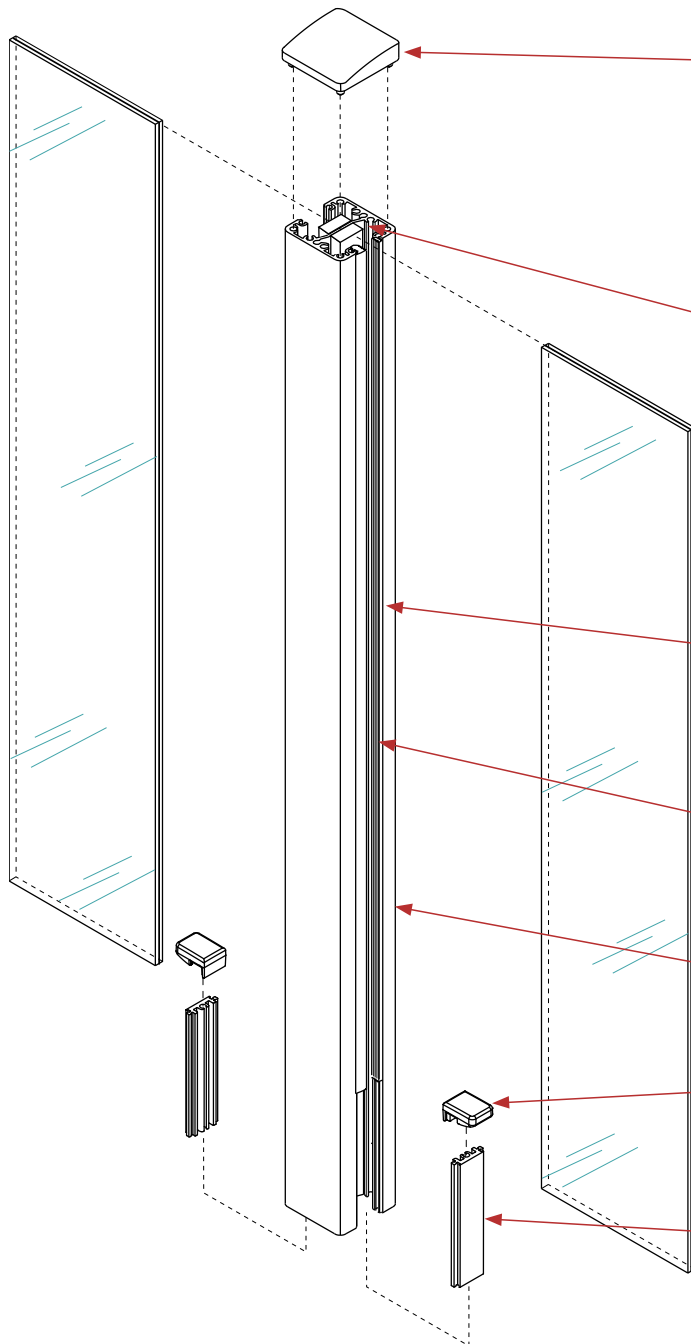

ACPR POST CAP (Illustrated) for 50 x 50 post, or ACPE for 50 x 60 post. Alternatively, use ACEFS as flat blank for 50 x 50 APE post or ACFFS on 50 x 60 APS post. Push fit to top of post after installation of glass. Secure to posts with a small amount of silicon or adhesive on the prongs.

STRUCTURAL GLAZING: Both the vertical edges of the glass shall attach to the post with structural silicone sealant, for the full height and thickness of the glass.

EVA TOUGHENED LAMINATED GLASS, of appropriate thickness, depending on the post spacing. Refer to Style Specification. Exposed horizontal edges to be flat polished.

SRG40 RETAINED GASKET to the outer face of glass 10mm or 12mm glass. SRG70 RETAINED GASKET used for 8mm glass. Must be slid into post prior to assembly.

WEDGE GASKET to the inner face of glass, SWE50 (with SRG70 RETAINED GASKET) for 8mm glass, SWE55 for 10mm glass, or SWE35 for 12mm glass.

APR2 (illustrated), APS or APE RECESSED POST. On 90° corners use APQ2 CORNER RECESSED POST

AKS2 BRACKET, to support glass. Attach to AIA insert (press fit). For further detail of bracket attachment for situations, refer to "AKS attachment" pages in Chapter 5.

AIA INSERT for supporting glass by transferring weight down to base plate or substrate.

Extrusions & Components

Style Specifications

Fixing Specifications

Assembly Specifications

Fabrication & Installation

Specifications subject to change without notice