

Installation and Care Guide

Dual-Flush Two Piece Toilet

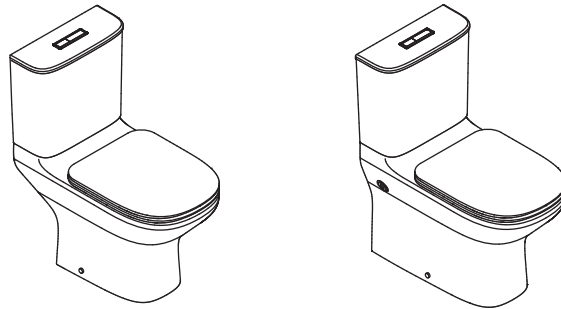

Installation and Care Guide
Dual-Flush
Two Piece Toilet

KOHLER®

Thank You for Choosing Kohler Company

Thank you for choosing Kohler. Kohler craftsmanship offers you a rare combination of proven performance and graceful sophistication that will satisfy you for years to come. The dependability and beauty of your Kohler product will surpass your highest expectations. We're very proud of our products here at Kohler and we know you will be too.

Please take a few minutes to review this manual before you start installation. If you encounter any installation or performance problems, please don't hesitate to contact us. Our phone numbers and website are listed on back cover.

All information in this manual is based upon the latest product information available at the time of publication. At Kohler, we constantly strive to improve the quality of our products. We reserve the right to make changes in product characteristics, packaging or availability at any time without notice.

Thank you for choosing Kohler Company.

Important Information

IMPORTANT NOTICE TO INSTALLERS!: Please leave these instructions for the consumer. They contain important information.

In addition to installation procedures, this manual contains important care and cleaning. Please retain for future reference.

NOTE: Some installation parts might not be provided.

NOTE: The product pictured in the installation steps may differ from the model being installed.

Before You Begin



CAUTION: Risk of personal injury or product damage. Handle with care. Product can break, chip, or cause injury if handled carelessly.



CAUTION: Risk of personal injury. Turn on the water and allow water to flow through the supply pipe to flush the system of any debris before connecting fill valve.

- Observe all local plumbing and building codes.
- Prior to installation, unpack the new lavatory and inspect it for damage. Return the product to its protective carton until you are ready to install it.
- Use the template supplied with the product.
- Failure to follow these precautions may result in a poor installation.
- If the existing toilet does not have a supply shut-off valve below the tank, install one before installing the new toilet.
- Fixture dimensions are nominal and conform to tolerances established by Standards TIS 792-2554, ASME/CSA A112.19.2/B45.1, GB6952-2015, AS1172.1-2014, BS:EN 997-2012, MS1552:2011, SS 574:2012, SNI 03-0797: 2006, PNS 156:2010 and SASO-1473-2016.
- For Australia and New Zealand: Installation shall be in accordance with AS/NZS 3500 and AS/NZS 6400.

Tools

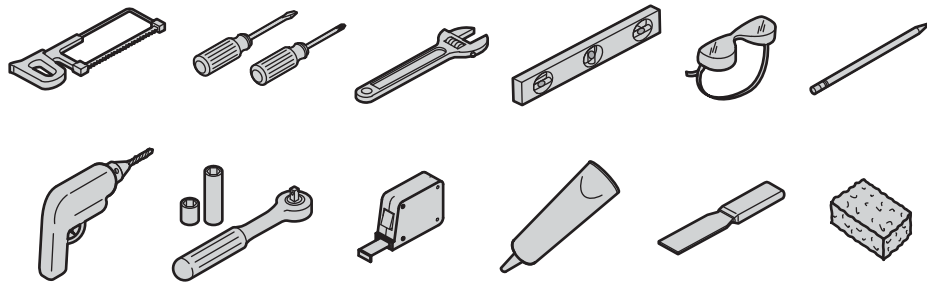

Roughing-in

Install the supply and outlet to conform to the roughing-in dimension.

Back to Wall Toilet

Connector to Wall (P-trap)

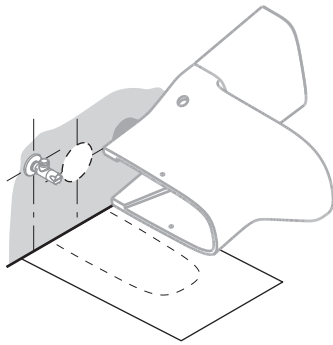

Connector to Floor (S-trap)

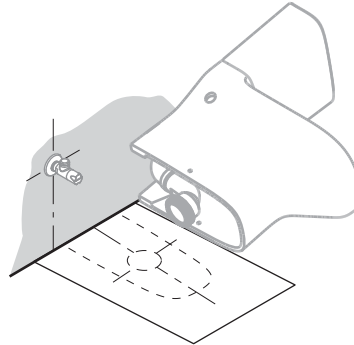

Model Number	Trap	Roughing-in (mm)
K-77708IN	S-trap	225
K-77713W	P-trap	185
K-77713W-Y	P-trap	185
K-77766A	S-trap	90-160
UJO102	S-trap	305

Non-Back to Wall Toilet

Connector to Wall (P-trap)

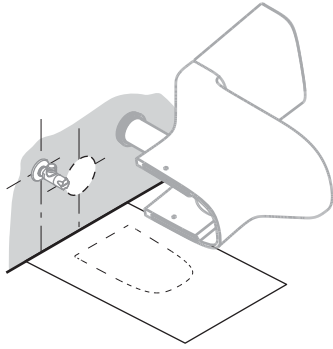

Connector to Floor (S-trap)

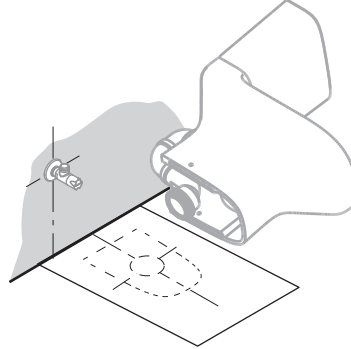

Model Number	Trap	Roughing-in (mm)
K-77715K	P-trap	185
K-77715W-Y	P-trap	185
K-77766K	P-trap	185
K-77769R	S-trap	305
K-77787H	S-trap	225
K-77793H	P-trap	185
K-78475H	S-trap	225
K-78476H	P-trap	185
K-78477K	S-trap	225
K-78478K	P-trap	185
K-78479R	S-trap	305
K-78480R	P-trap	185
K-78765R	P-trap	185
K-78766K	S-trap	225
K-78767H	S-trap	185
K-78846H	S-trap	185
UJP102	S-trap	305

Installation

Position the template on the floor to ensure the template against the wall.

Tape in place and drill holes.

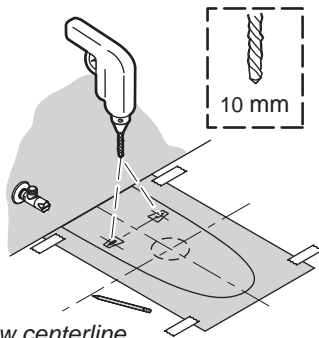

Draw centerline on the floor.

Position the brackets as shown on the template and install the brackets.

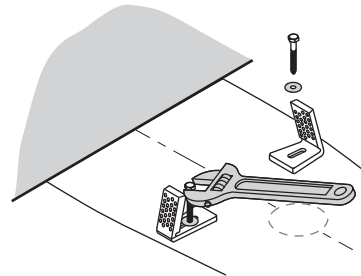

Thread the supply hose onto fill valve.

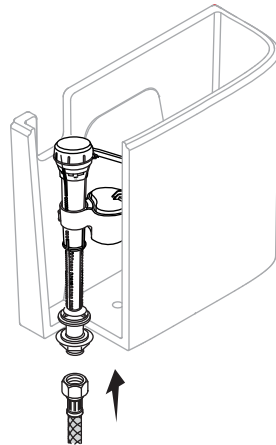

Position the gasket over the flush valve nut.

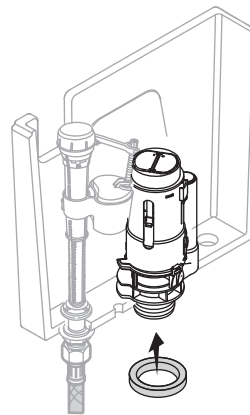

Installation

Install the tank onto the bowl with tank with tank fitting kit.

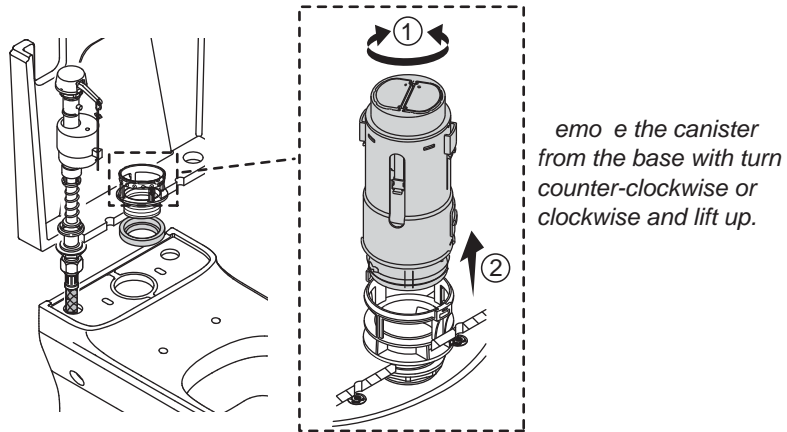

Type

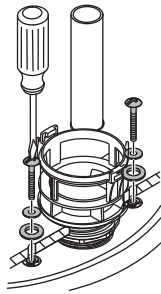

Type

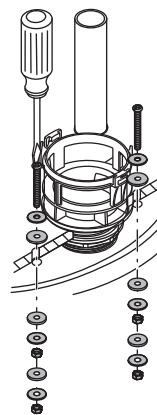

Type

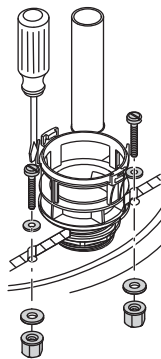

Installation

Reinstall the flush valve body by pressing it firmly onto the base.

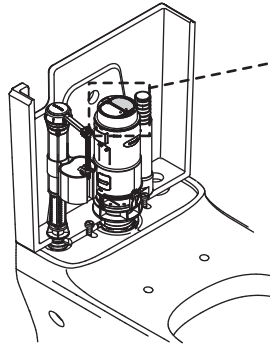

Position the full mark on the full flush button side.

Half Flush ◐ Full Flush ●

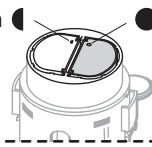

Install inlet plug in tank if needed.

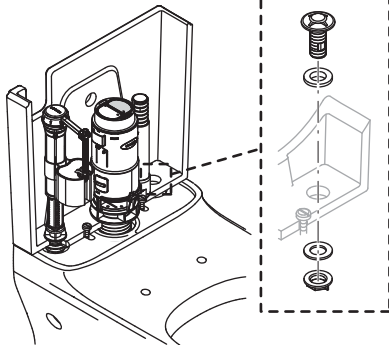

Attach inlet plug on side of bowl. Optional for left or right side

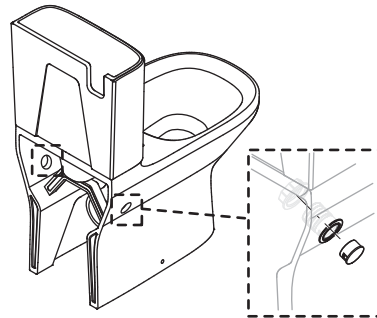

Slide the hose guide onto the hose, with the flared end last. Slide the two inserts into the flared of the hose guide.

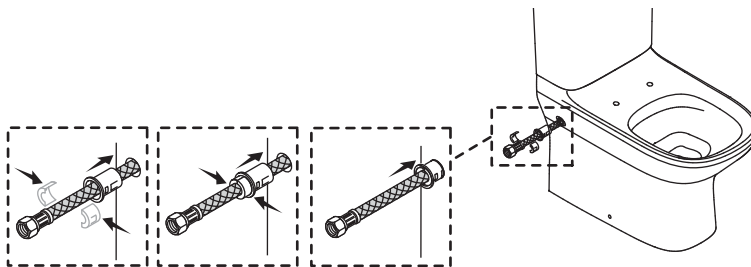

Installation

- 10** Connect the connector on the bowl. Carefully tilt backward until connector and waste pipe touch.

Connector to Wall

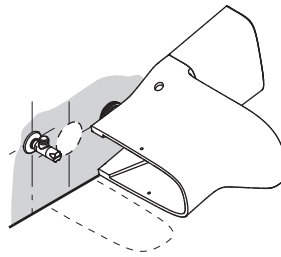
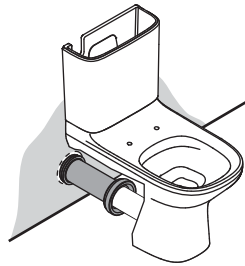

Connector to Floor

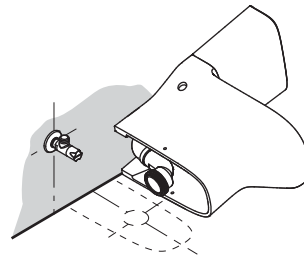
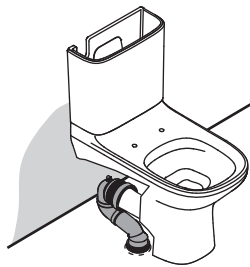

- 11** Align connector and carefully lower over brackets. Install floor mounting kit.

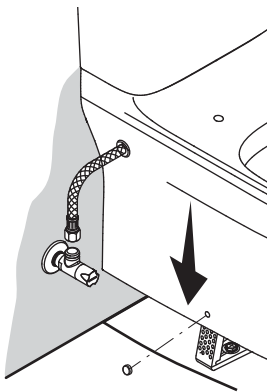

- 12** Connect supply and turn on the water.

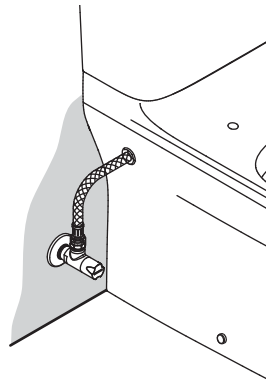

- 13** Caulk silicone around base.

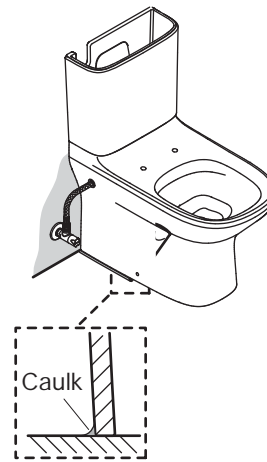

Installation

Install the Flush Button

- 1 Remove the rods from push button.

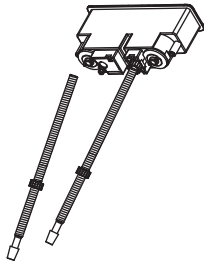

- 2 Record the height of rods (measure from the top of flush valve body to rim mouth of push button hole).

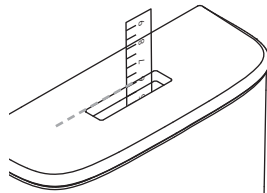

- 3 Calculate the height of rods by the record height rods minus mm. Cut excess of rods.

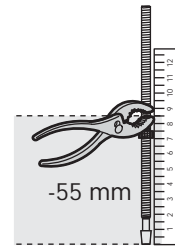

- 4 Rest the end of rods mm.

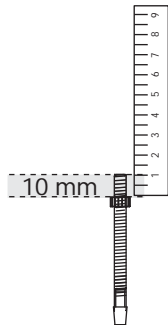

- 5 Screw the rods into the rod holes.

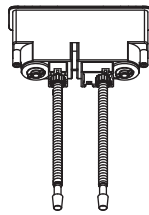

- 6 Install the push button into the push button hole.

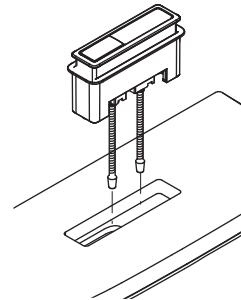

- 7 Assemble the sleeve and tighten with screws.

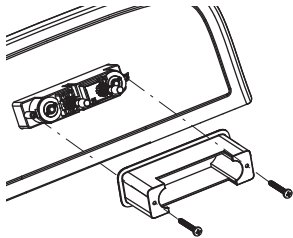

- 8 Install the tank cover.

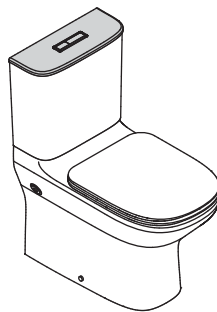

- 9 Press the push buttons for testing.

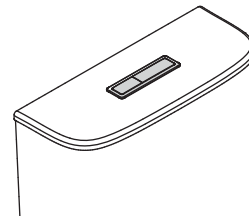

Complete Installation

- 1 Flush several times and check for leaks.
Do not overtighten

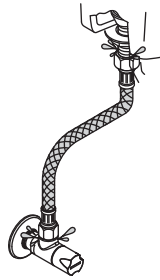

- 2 Install the seat.

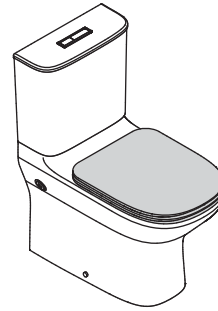

Care and Cleaning

For best results, keep the following in mind when caring for your product:

- Carefully read the cleaner product label to ensure the cleaner is safe for use on the material.
- Always test your cleaning solution on an inconspicuous area before applying to the entire surface.
- Wipe surfaces clean and rinse completely with water immediately after cleaner application. Rinse and dry any overspray that lands on nearby surfaces.
- Do not allow cleaners to sit or soak on the surface.
- Use a soft, dampened sponge or cloth. Never use an abrasive material such as a brush or scouring pad to clean surfaces.
- Be careful not to leave staining materials in contact with the surface for extended periods of time.
- The ideal cleaning technique is to rinse thoroughly and blot dry any water from the surface after each use.

Troubleshooting Guide	
Symptoms	Recommended Action
1. Poor flush.	<ul style="list-style-type: none"> A. Adjust the tank water level to match the waterline. B. Fully open the water supply shut-off valve. C. Clear obstructions from the trapway, jet, or bowl rim holes. D. Clear obstructions from the waste line.
2. No flush.	<ul style="list-style-type: none"> A. Make sure the push button rods are in place. Adjust as needed.
3. The fill valve turns on/off by itself or it runs, allowing water to enter the tank.	<ul style="list-style-type: none"> A. Adjust push button rods for proper slack so the flush valve seal isn't held off the flush valve. B. Clean or replace the flush valve seal if it is worn, dirty, or misaligned with the valve seat or flush valve seat is damaged. C. Remove the tank and tighten the flush valve nut if flush valve gasket is leaking. Do not overtighten. If leakage continues, replace the gasket. D. Clean the fill valve seal of debris or replace the seal assembly. E. Replace the fill valve if the valve float sinks.
4. Long tank fill cycle.	<ul style="list-style-type: none"> A. Fully open the water supply shut-off valve. B. Clean the valve inlet, valve head, or supply line. Flush lines.
5. Noisy tank fill cycle.	<ul style="list-style-type: none"> A. Partially close the water supply shut-off valve if the water pressure to the toilet is too high. Check the toilet performance following any such adjustment. B. Remove dirt or obstructions from the valve head. Flush lines.