

Moxie showerhead - 5": 9245T-E-CP  
Moxie showerhead - 8": 99105T-E-CP

### BEFORE YOU BEGIN

All information is based on the latest product information available at the time of publication. Kohler Co. reserves the right to make changes in product characteristics, packaging, or availability at any time without notice.

Please leave these instructions for the consumer. They contain important information.

#### NOTES:

This wireless speaker complies with CE.

To play your personal music files, you need a wireless BLUETOOTH® device.

This device is rated to IPX4.

Check local regulations for proper disposal.

Caution! Do not submerge the wireless speaker.

Caution! The wireless speaker and battery are rated to operate in temperatures up to 140°F (60°C). Do not expose to heat sources or install in any location where the temperature may exceed 140°F (60°C).

Warning! Do not expose batteries to sunlight, fire or other forms of excessive heat.

The BLUETOOTH® word mark and logos are registered trademarks owned by Bluetooth SIG, Inc. and any use of such marks by Kohler Co. is under license. Other trademarks and trade names are those of their respective owners.

#### CE Radiation Exposure Statement for Mobile Devices

This equipment complies with CE radiation exposure limits set forth for an uncontrolled environment. This equipment should be installed and operated with a minimum distance of 200 mm between the radiator and your body. The transmitter must not be co-located or operating in conjunction with any other antenna or transmitter.

### ROUGH-IN DIMENSIONS

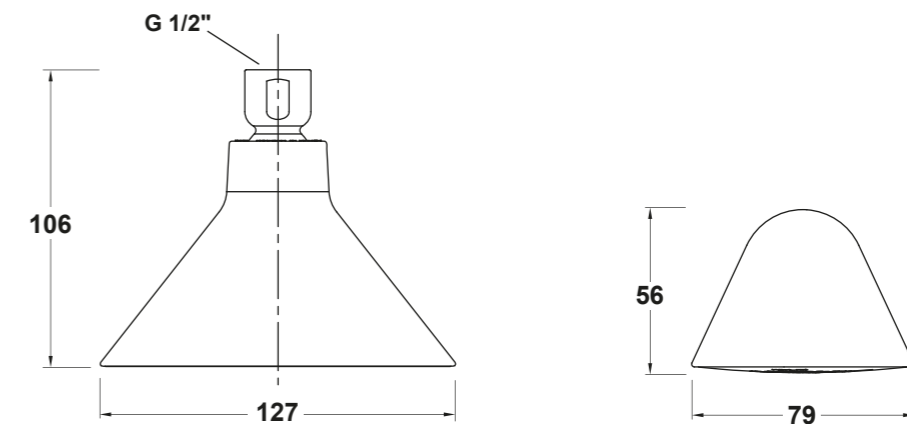

## INSTALLATION

Tools Required:

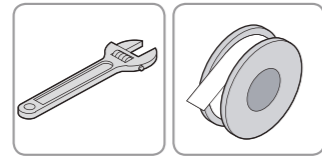

1

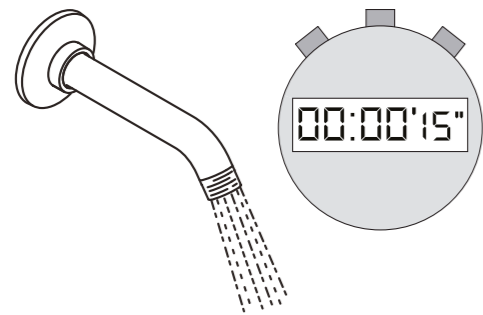

2

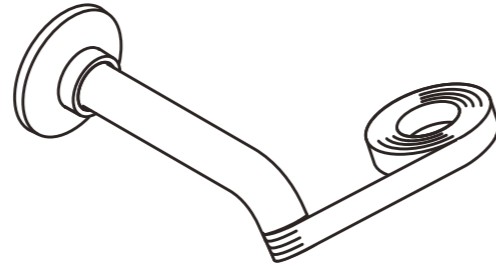

3

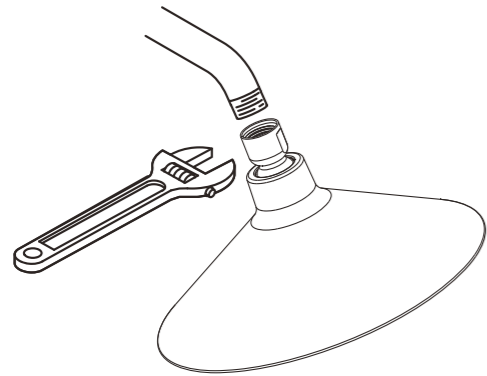

4

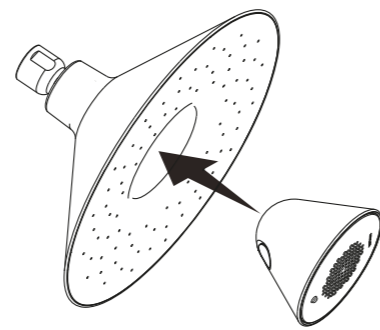

1. An in line water filter must be used with this product.
2. Take care not to damage the regulator during install.
3. Recommended working pressure: 1 to 5 bar.
4. If working pressure exceeds 5 bar(0.5MPa), a pressure reducer is required.
5. All installations should comply with the relevant requirements of AS/NZS 3500 and AS/NZS 6400.

Operating Temperature	0°C - 60°C
Maximum Relative Humidity	100% condensing
USB Cable Length	1 m
Output Power	1.5 Watts into 4 Ohms
Total Harmonic Distortion	<1% at 1 kHz full output power
BLUETOOTH® wireless range	10 m
Battery Charge Time	7 hours
Play Time*	7 hours
Charge Voltage	USB 5 V

\*Actual battery life will vary with use, settings and environmental conditions. Rechargeable batteries have a limited number of charge cycles.

## OPERATION

1

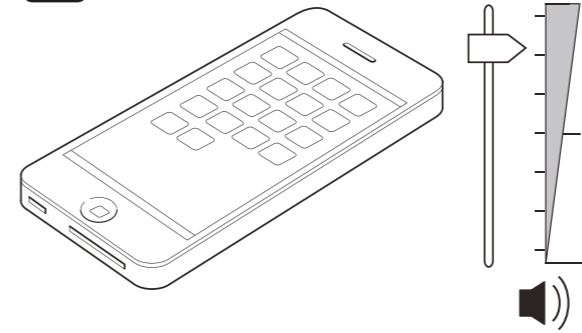

2

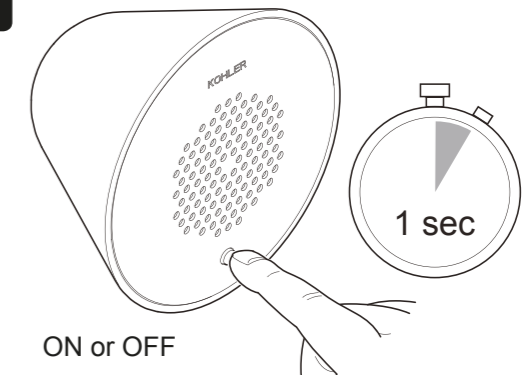

3

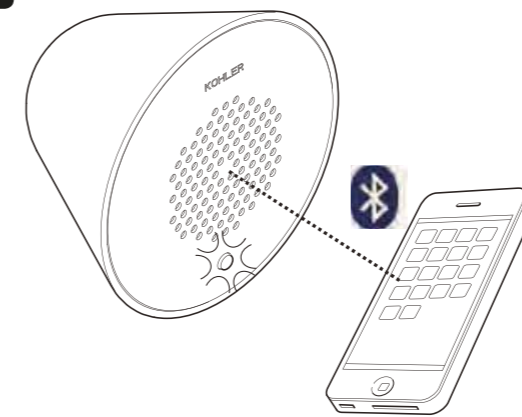

4

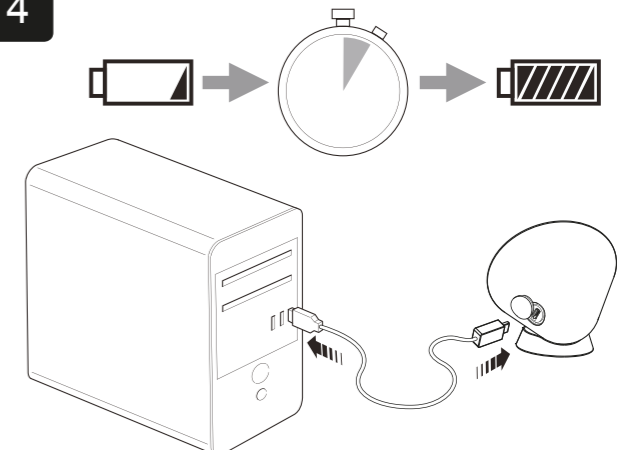

### LED Status – Charging Mode

Red blink	Battery is charging
Red	Battery recharge is complete
LED Status – Operating Mode	
Blue blink	BLUETOOTH pairing mode
Blue	Connected to a BLUETOOTH device
Blue/red blink	Connected to a BLUETOOTH device. Battery is low

Note! If pairing is lost, the wireless speaker will power OFF after 90 seconds.

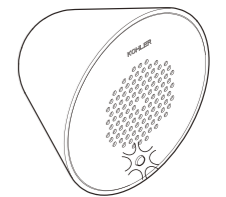

## CLEANING INSTRUCTIONS

All Finishes: Clean the finish with mild soap and warm water. Wipe entire surface completely dry with a clean soft cloth. Many cleaners may contain such chemicals as ammonia, chlorine, toilet chemicals etc. which could adversely affect the finish and are not recommended for cleaning.

**Do not use abrasive cleaners or solvents on Kohler fittings.**

## TROUBLE SHOOTING TABLE

Symptoms	Probable Cause		Recommended Action	
1. After playing music loudly, the music stops even though a song is properly selected.	A.	Thermal shut down.	A.	Shut down the system for 1 hour to allow the unit to cool. Make sure the area where the unit is installed does not exceed 60°C.
2. The status LED is not illuminated.	A.	Battery is not charged.	A.	Use the USB cable provided to recharge the battery.
3. No sound plays through the speaker.	A.	The song is paused.	A.	Make sure the song is playing. If the song is paused, press the resume feature to continue playback.
	B.	The volume is too low.	B.	Make sure the volume is turned up high enough for proper enjoyment.
4. The wireless speaker is not connecting to my BLUETOOTH® device.	A.	The BLUETOOTH device is not within range.	A.	Make sure that the BLUETOOTH device is within range of your wireless speaker.
	B.	The volume is too low.	B.	Make sure the volume is turned up high enough for proper enjoyment.
	C.	The BLUETOOTH device is not paired with the wireless speaker.	C.	Pair your BLUETOOTH device with the wireless speaker according to the pairing instructions for your BLUETOOTH device.
	D.	The BLUETOOTH requires password entry for pairing.	D.	Enter "0000" for the password.
5. LED does not blink red when charging.	A.	USB connection to the wireless speaker may be loose.	A.	Check the USB connection to the wireless speaker and reconnect if necessary.
	B.	No power to the USB port.	B.	Make sure there is power to the USB cable.

We reserve the right to change product specification due to possible technical improvements.

# KOHLER®

## SPARE PARTS

## SHOWER TAPWARE

# MOXIE

### Slide Shower

**Moxie showerhead - 5": 9245T-E-CP**  
**Moxie showerhead - 8": 99105T-E-CP**

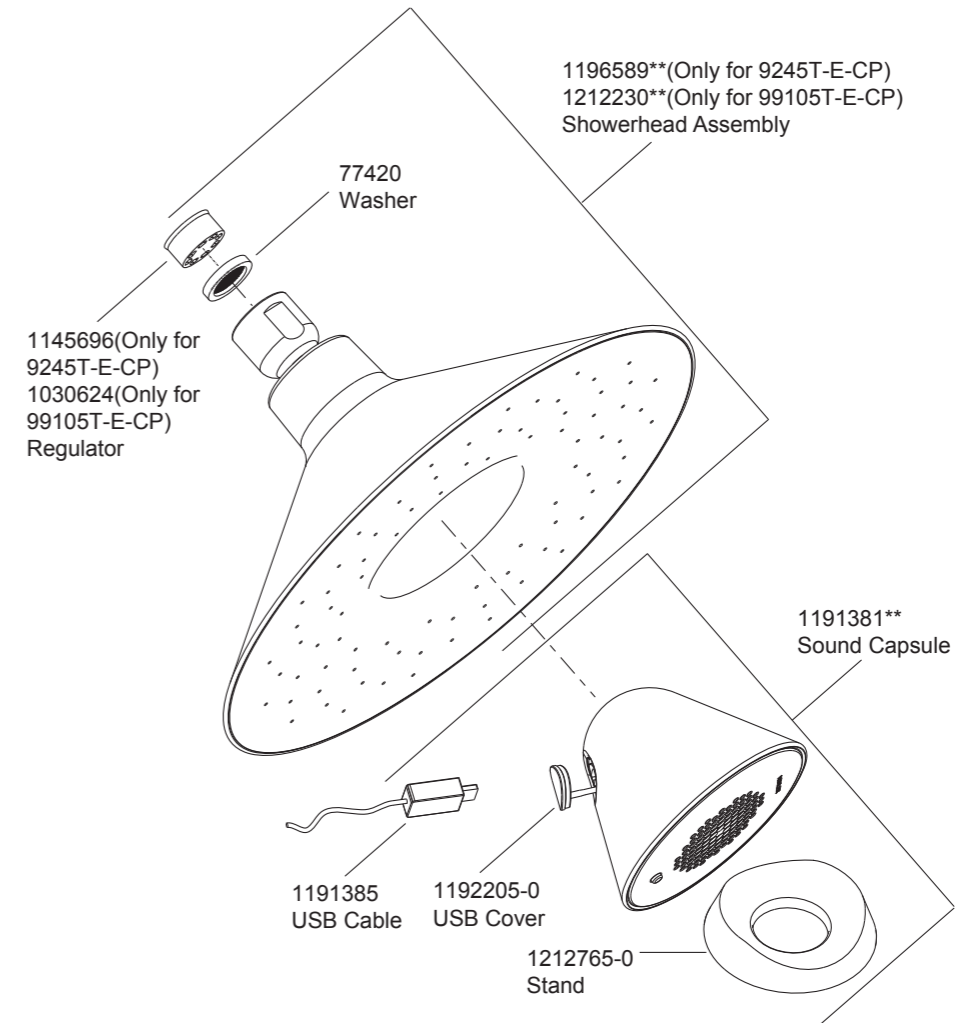

\*\*Color code must be specified when ordering