

DETAIL 3

PICTURE FRAME FOR 140MM DECKING BOARDS BY SPACING THE 2ND JOIST 40MM IN USING THE 90° BRACKETS AS A GUIDE

DETAIL 1

CONNECT JOIST TO END PLATE USING 2 X 90° BRACKETS.
 OPTION A. FIX BRACKET EXTERNALLY USING 4 X TEK SCREWS
 OPTION B. TENSION FIT BRACKET INTO JOIST AND SCREW FIX USING 2 X TEK SCREWS TO END PLATE.

DETAIL 4

CONNECT 2 JOISTS OR BEARERS END TO END USING 2 STRAIGHT CONNECTORS.
 OPTION A. FIX BRACKET EXTERNALLY USING 4 X TEK SCREWS
 OPTION B. TENSION FIT BRACKETS INTO JOIST OR BEARER.
 ALL BUTT JOIN CONNECTIONS MUST BE SUPPORTED WITHIN 200MM OF THE JOIN

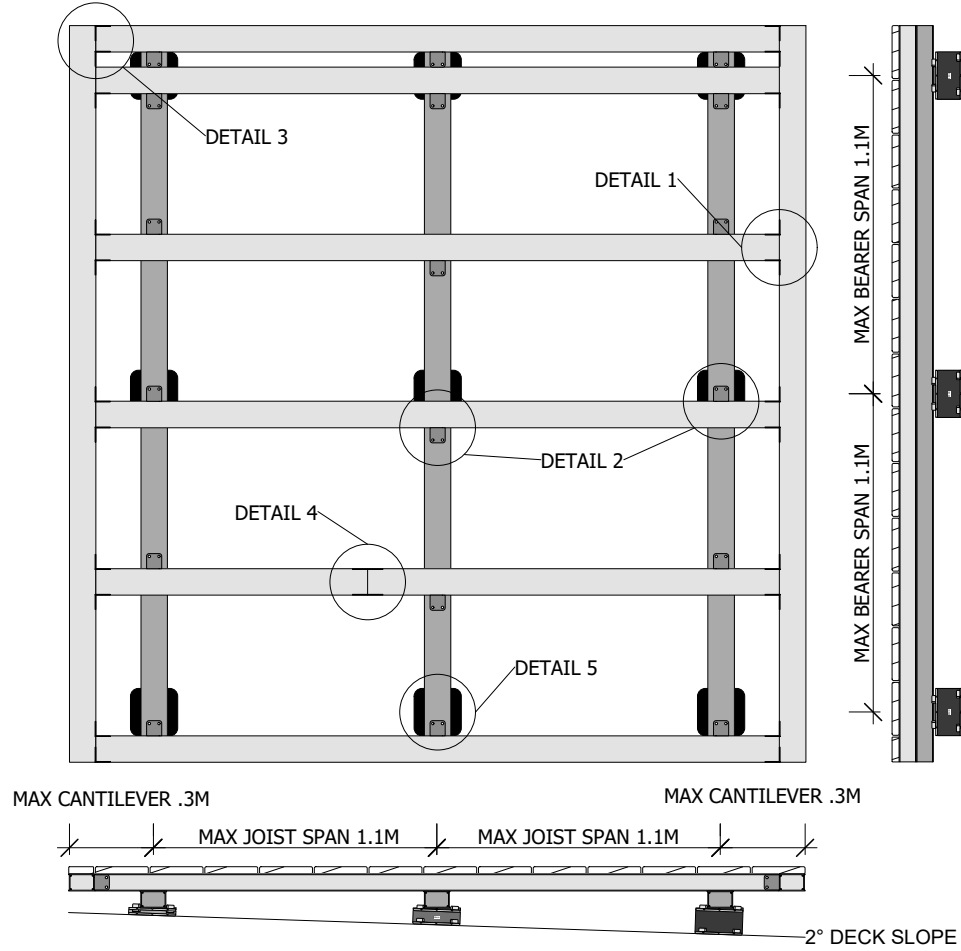

DETAIL 2

CONNECT JOIST TO BEARER USING 90° BRACKETS. ALTERNATE THE BRACKETS ALONG THE JOIST AND SCREW OFF USING 4 X TEK SCREWS

DETAIL 5

USE PROJACK DIRECTLY UNDER THE JOIST OR BEARER TO CORRECT THE FALL IN THE SUBSTRATE. FOR HEIGHTS 5MM - 13MM USE A SINGLE BASE AND WEDGE. FOR HEIGHTS 15MM AND ABOVE USE A BASE, PACKER, TOP AND WEDGE. CHANGE THE WEDGE POSITION FOR FINE HEIGHT ADJUSTMENT.

5MM - 14MM 15MM AND ABOVE