

## Pacific FW120 Fire Window -/120/-

### DESCRIPTION

The Pacific FW120 is a fire window system which is *fire-resisting glazing* as defined in the New Zealand Building Code Acceptable Solutions C/AS2 to C/AS6.

The system consists of non-opening (fixed) glazing with Pyroceram clear glass factory-fitted into a steel frame for interior use.

**For further information on this product, visit:**

<https://www.pacificdoors.co.nz/products/fire/fire-windows/frr-120-minute/fw120>

### PRODUCT FEATURES:

#### Product features:

- 120min fire rating
- Single glazed
- 2 glass options
- 2 frame options
- Suitable for both interior use only
- Compatible with timber stud, steel stud and masonry wall
- Comply with NZS 4232.2:1988 and meet NZBC C/AS2

### PRODUCT OPTIONS

The Pacific FW120 is a fire window system which is *fire resisting glazing* as defined in the New Zealand Building Code Acceptable Solutions C/AS2 to C/AS6.

The system consists of non-opening (fixed) glazing with Pyroceram clear glass factory-fitted into a steel frame for interior use.

Approximate window weight is 38 kg/m2.

Glazing Type	Maximum Glazed Area	Max Height (mm)	Max Width (mm)	Frame Type		Fire Rating
				Timber	Steel	
Pyroceram	1.28m2	845	1515		✓	-/120/-
Pyroceram	1.28m2	1515	845		✓	-/120/-

## Notes:

1. Sizes noted above are the clear view.
2. Pyrobel glazed windows can be connected as a sidelight to the VP30/VP60 doorset.  
Pyranova glazed windows can be connected as a sidelight to the TB60 doorset.
3. Glazing types marked with \* indicate Grade A Safety glass.

## Wall Types

- Precast concrete (100mm thickness) or grouted blockwork (190mm thickness).
- Non-load bearing timber stud partitions of minimum specifications GBT60a or GBT60b.  
Note that steel framed VP60 door sets may only be installed in walls of minimum stud size 100x50mm nominal (Gib® Fire Rated Systems 1997).
- Non-load bearing steel stud partitions of minimum specification GBS90 (timber framed doors) or GBS60 (Steel framed doors) (Gib® Fire Rated Systems 1997).

## Frame Types and Profiles

### TIMBER FRAME

Please see the table above for size limitations.

### Timber Framed Elevation

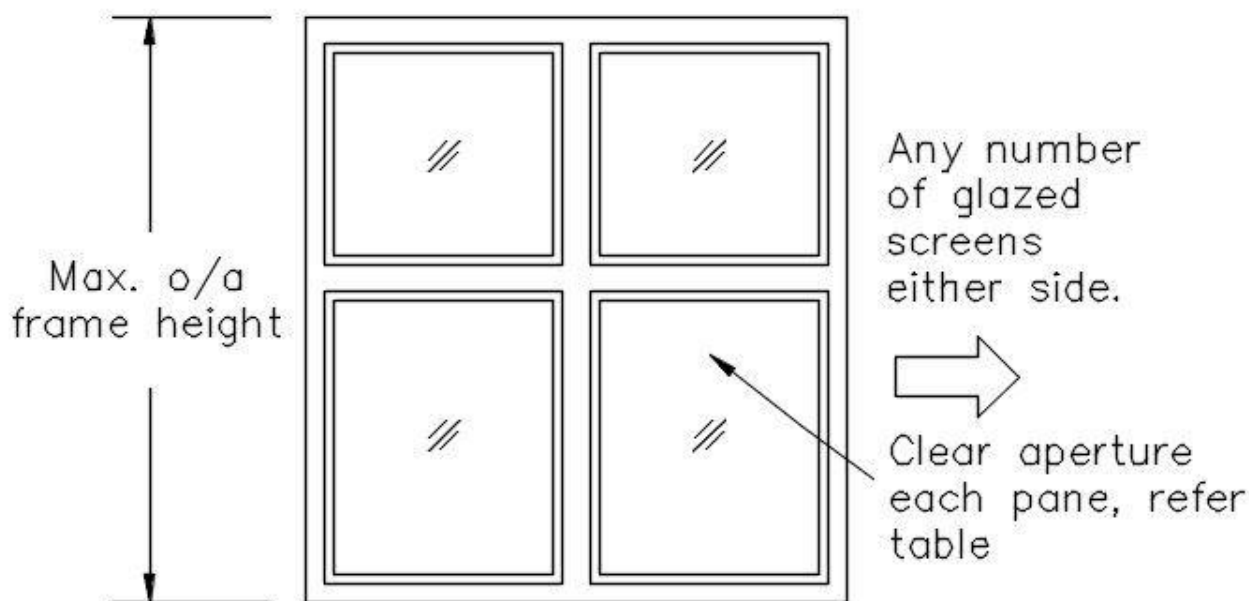

### Timber Frame Profiles

The FW30 is available in a hardwood timber frame, 580kg/m<sup>3</sup> or denser in the below frame profiles. 42 mm minimum frame thickness.

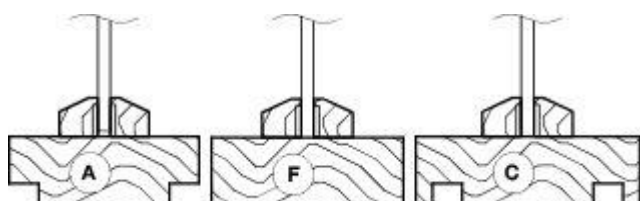

## Timber Frame Connection to a Fire Door Detail

### For VP60 System

### For TB60 System

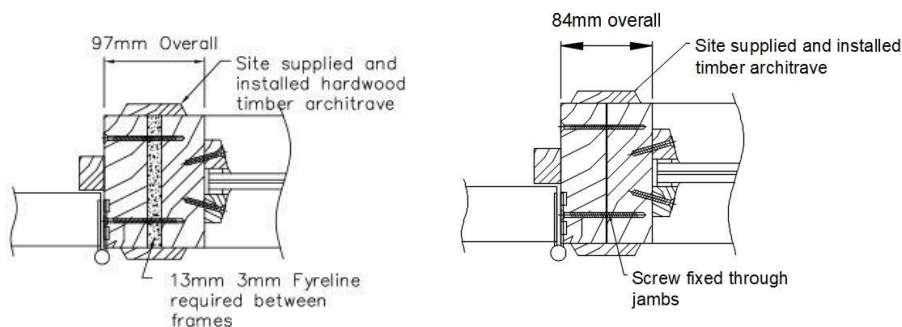

\* For the VP60 system, the separate glazed sidelight is connected to the fire door frame with a layer of 13mm plasterboard between. The joint is covered by a timber architrave as illustrated above.

## STEEL FRAME

The FW30 glazing system can include panes of up to 2820mm high x 2820mm wide in a steel frame.

### Steel Framed Elevation

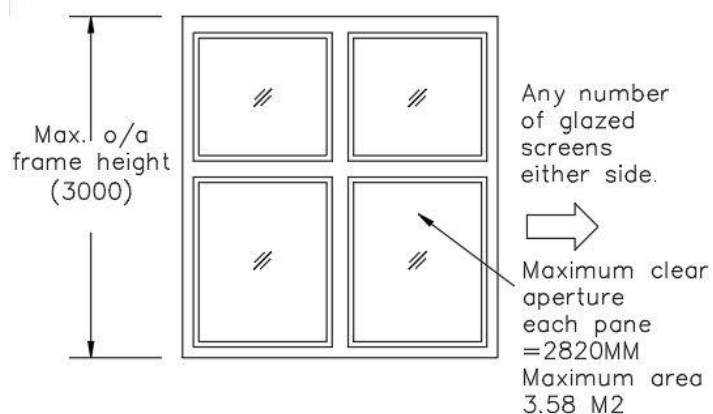

### Steel Frame Profiles

The FW60 available in the below steel frame profiles.

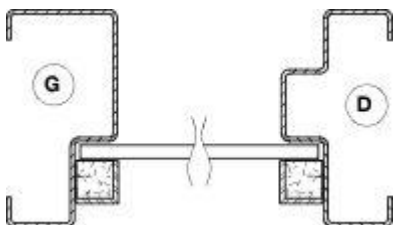

For more in-depth information on frame profiles and sizes, please see our Installation Instructions.

## Steel Frame Connection to a Fire Door Detail

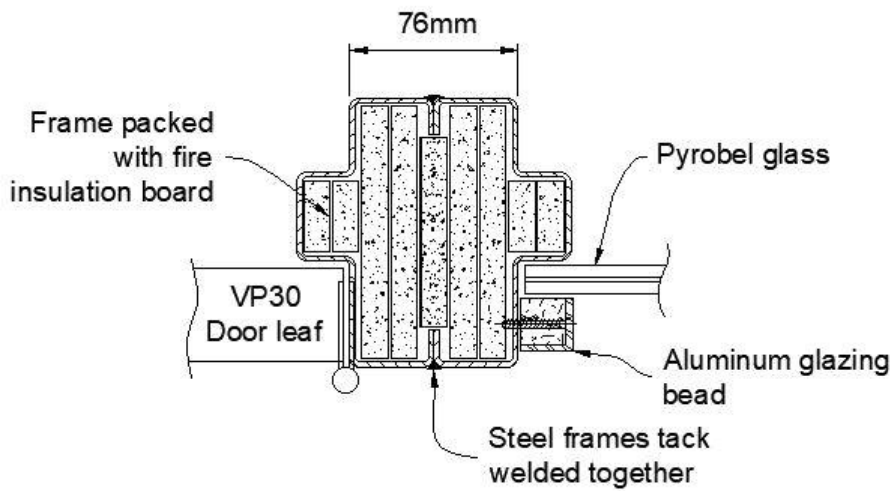

## Exterior Situations

This window is not suited to exterior conditions.