

## Set Out Details

### SHOWER SETOUT EXAMPLES

#### Sliding Shower OTR-2000 Glass To Wall - 1 Side Panel

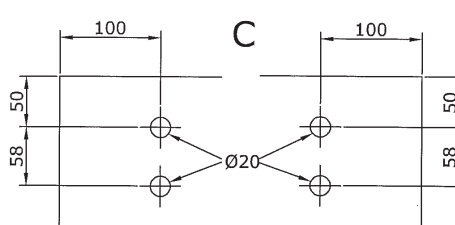
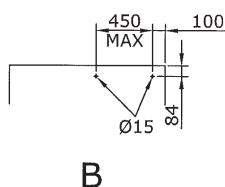
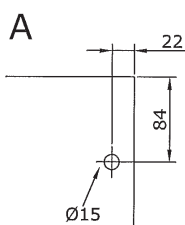
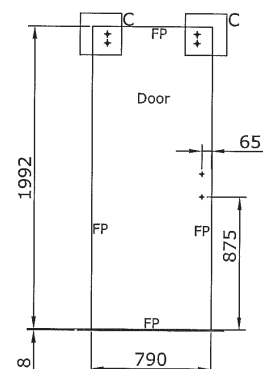
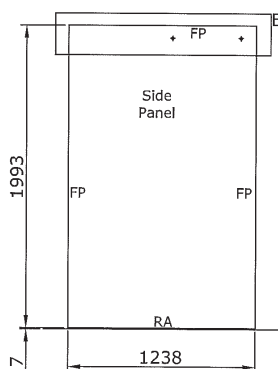
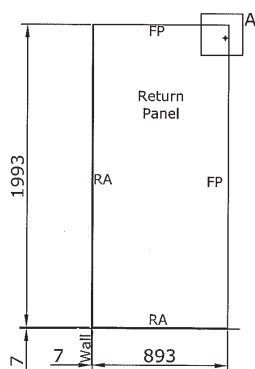
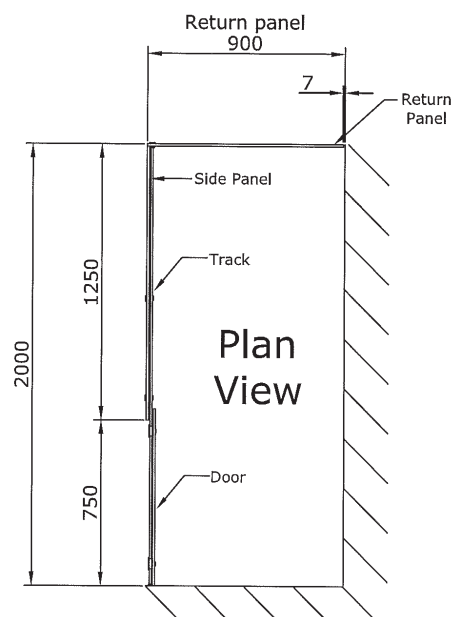
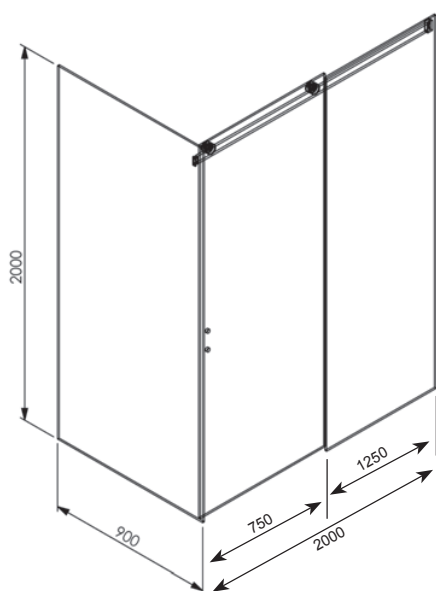

#### Hardware List

- 1 x OTR2000 Sliding Door Kit
  - CS18 Channel - sold separately
  - AS6 Water Bar - sold separately
  - CS18 End Cap - sold separately
  - 1 x Handle or Knob, Customers Selection
- Allow holes for handle or knob - sold separately

#### Note

Cut channel on side panel, less 20mm to allow door guide to clamp to glass at bottom of side panel.  
Clear opening 655mm - subject to handle type.  
Max door weight 45kgs.  
Isometric shows a left hand door plan and glass drawings are for right hand door.

Ex Auckland Store. All prices exclude G.S.T.