

DEH9610

THERMOSTATIC BASIN MIXER

DELABIE

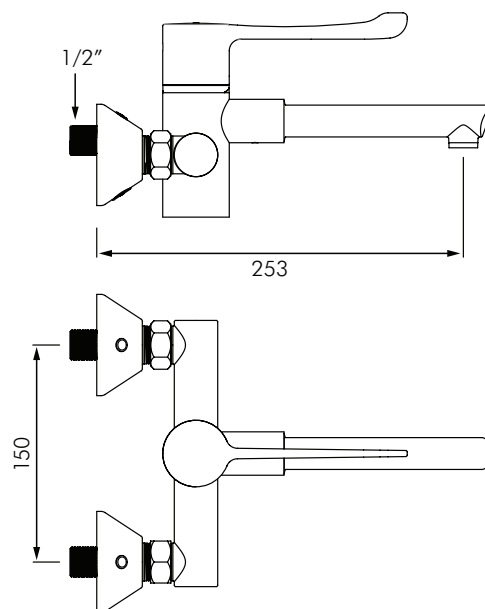

DESCRIPTION

Wall-mounted sequential thermostatic basin mixer with bioclip spout. Securitouch thermal insulation prevents body from getting hot.

- Bioclip removable spout can be easily cleaned and de-scaled.
- Progressive temperature control from cold water to 40°C, reduces the risk of scalding.
- Wall mounted for increased drop height, reducing retro-contamination and optimising hand washing.
- Easy to remove for cleaning and servicing.

This mixer comes standard with one disposable spout. Alternative spouts available to suit user requirements (note different lengths - L dimension);

- DE20002 - Stainless steel spout (257mm)
- DE20003 - Stainless steel spout (205mm)
- DE20012 - Disposable spout (253mm)
- DE20040.10P - Disposable sterile filter spout (266mm) (only available in packs of 10 pieces)

Note: Dimensions shown are based on standard DE9610. Other Models may result in slight variations to L dimension

INSTALLATION

- Temperature limiter pre-set at 40°C.
- Limited to 7 L/min flow (at 300kPa).
- Delivered through a flow straightener (not an aerator).
- 1/2" M BSP connections to eccentrics.
- Pressure range: 100 to 500kPa (300kPa recommended). Max pressure difference at inlets is 100kPa.
- For anti-scalding safety, the hot & mixed water temperature differential must be at least 15°C.

MODELS

DEH9610 - Mixer with adjustable stop/drain eccentric fittings +/- 10mm and disposable spout DE20012.

DEH9610S - Same as DEH9610 but with standard eccentric fittings.

DEH9611P - Same as DEH9610 but with inline concentric fittings.

OPTIONS:

Additional spouts as described under Description.



MACDONALD
INDUSTRIES LIMITED

Auckland (Head Office)

20 Carr Rd, Three Kings
 Auckland 1041
 P: 09 624 1115
 F: 09 624 1110
 E: sales@macdonaldindustries.co.nz

Wellington

P: 04 569 8033
 F: 04 569 8066

Christchurch

P: 03 348 2356
 F: 03 348 2376