

# Installation Instructions

## Axis

1/3

### Initial preparation

For maximum aesthetics and safety Advance Entrance Matting Systems should be recessed into the floor so that the top surface is flush with surrounding floor coverings. Advance Entrance Matting Systems predominantly have a low-profile design which avoids having to create a recess in the concrete slab or subfloor as the mats fit within the depth of the surrounding floorcoverings.

The recessed surface must be in sound condition, smooth and level and set to a 13mm depth. Often it is a concrete base, with a ceramic or stone overlay which can form the floor recess. Where a floor recess is not available Advance Flooring Systems has a range of ramps and trims to create a disability compliant entrance system that is attractive and functional.

### Matwell Frame Installation

To create a tidy and safe finish between your Advance Entrance Matting Systems and the surrounding floor coverings, a matwell frame is used. The frame, ALF3515, is 13mm deep and should be set in place to the edges of the recess and then secured with screw fixings, ensuring the top edge is flush with finished floor level on all sides.

Framing gives your surrounding flooring a firm edge to finish up to and most importantly protects the edges of many types of flooring – i.e. polished concrete, ceramic tiles from chipping by high heel shoes.

### Preparation of Matwell Base

After the framing has been secured in place to the surround of the recess, the base must be brought up to suit the exact thickness of the matting, for Axis needs to be 13mm. This preparation must provide a smooth level base that will ensure the matting sits flat and remains stable under the heavy foot traffic applicable to the application once in use. Floor Levelling Compound (FLC) is used in most locations, providing an excellent substrate that can be self-levelled to an exact depth. Where this cannot be used, materials such as plywood or rubber sheet can be used, as a packer to achieve the correct depth.

It is essential that the final matting installation is competently carried out, and there are two typical methods:

#### Method 1

The matting is cut in the factory, to an exact size or shape, and simply drops into place on site. For this to be possible, it is critical that dimensions are accurate, and templates are provided for any shaped areas using a suitable material.

#### Method 2

Dimensions are taken on site, matting is produced slightly oversize and cut to suit the exact Matwell areas by competent persons on site. Generally, aluminium matting should be installed with a small tolerance to the surround, to allow for expansion with temperature variation. PVC matting systems should be fitted tight to the Matwell surround. Exact installation detail varies between products, and should be confirmed at the time of order.

# Installation Instructions

## Axis

2/3

### Step 1

A pallet can carry up to 20 boxes. To prevent damage to the carpet tiles, 2 pallets should never be stacked on top of each other. There is a batch number on every box. Before laying, check that the tiles are from the same batch. It is important that batch numbers are not mixed within an installation in view of very slight colour variations which may occur from batch to batch.

### Step 2

To ensure optimal conditioning of tile backings, the temperature for fitting must be between 10°C and 25°C, at a relative air humidity of approximately 60%. The tiles should be removed from their outer boxes and laid loosely on the floor for 24 hours before laying so that they can become conditioned to room temperature guaranteeing stability.

### Step 3

There is an arrow on the back of each tile which indicates pile direction. If laid in a Monolithic (Broadloom) or Brick style, all the tiles should be laid with the arrows pointing in the same direction - see the diagrams on page 2. If laid Quarter turn (Checkerboard) style the arrows should be at 90 degrees to the adjacent tile – also see diagram on page 2. Start laying with a full tile laid at the door, continuing to the middle of the room in parallel with the main wall (see diagram below).

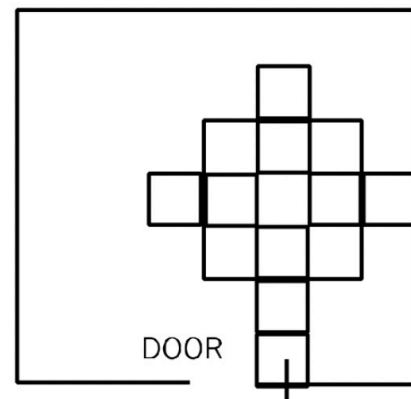

Make sure that no pile material is trapped between the tiles. This central point is a starting point for the gradual placement of the other pieces. It is necessary to apply good pressure when butting the tiles together for a neat fit.

# Installation Instructions

## Axis

3/3

### Step 4

The tiles can be laid in different ways:

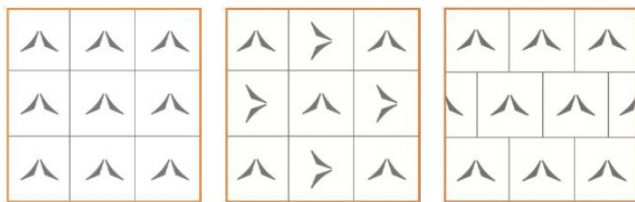

Monolithic

Quarter-turn

Brick

Installation of Carpet Tiles — Directional vs Quarter Turn, some patterns allow the carpet tiles to be laid either using a Directional method or by Quarter Turn method. Other patterns is such that they can only be laid "Quarter Turn" or in a "Random" manner. More information may be found on the relevant product data sheet on our website [www.advanceflooringsystems.com](http://www.advanceflooringsystems.com) or you can call us for further clarification if required.

### Step 5

Finally, finishing the edges:

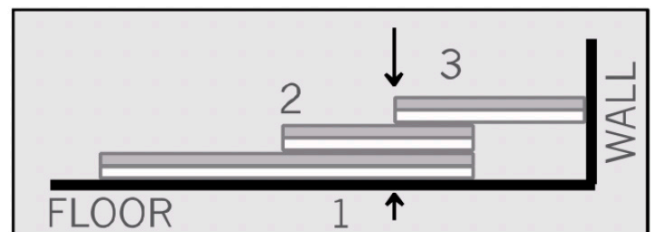

- Place the tile to be cut (2) on the tile laid last
- Slide a third tile (3) against the wall
- Cut the tile to be placed (2) along the edge of (3)
- Place the cut tile (2) against the wall

### Step 6

The tiles can be laid without adhesive although it's not recommended, but in doorways, offices, education environments and other heavy-wear installations we recommend the use of a tackifier adhesive. Regular vacuum-cleaning will help maintain the appearance of the tiles. Never use solvents (white spirits, petrol, etc.), as they can affect the colour.

#### Recommended Adhesive

Strongbond 65 (recommend application with roller) – supplied by Look Floors. PS66 for floor installation and UZIN WK222 for wall installation – supplied by Giltedge. Ultrabond Eco Tack - supplied by Mapei