



GLAZING BARS **FIXED SKYLIGHT, SMALL FIN RAFTER** **CROSS SECTION**

CAD REF. VCOG02-0

DATE
01.06.11

SCALE
1:2

Purpose Bent Flashing
Sealed to Joinery

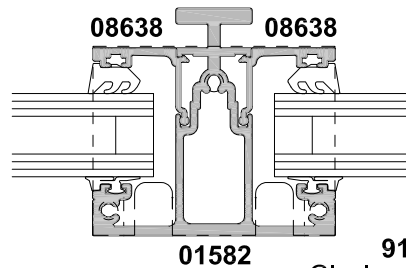
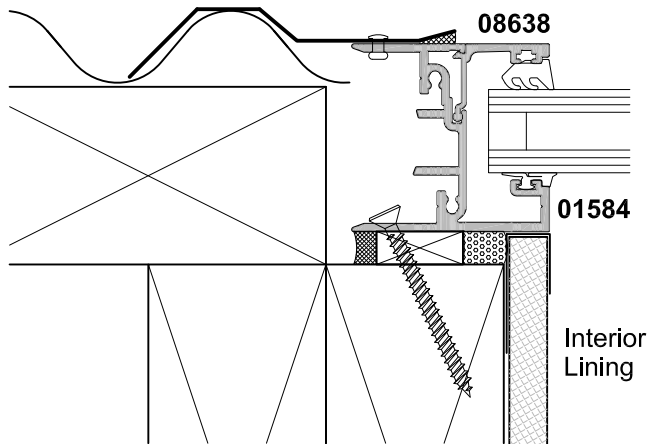

SECTION A-A

9100161
Glazing Bar End Cap
(shown dashed)

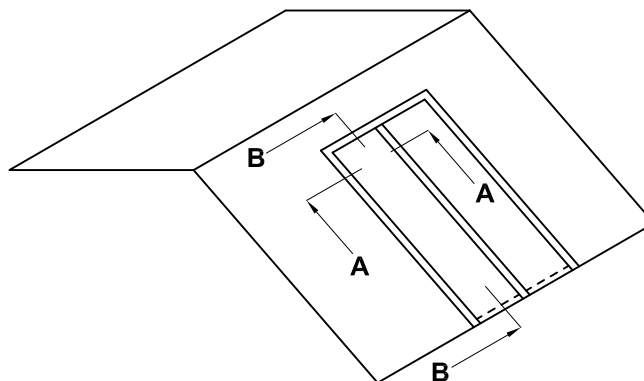
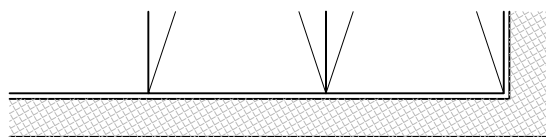

Purpose Bent Flashing
Sealed to Joinery

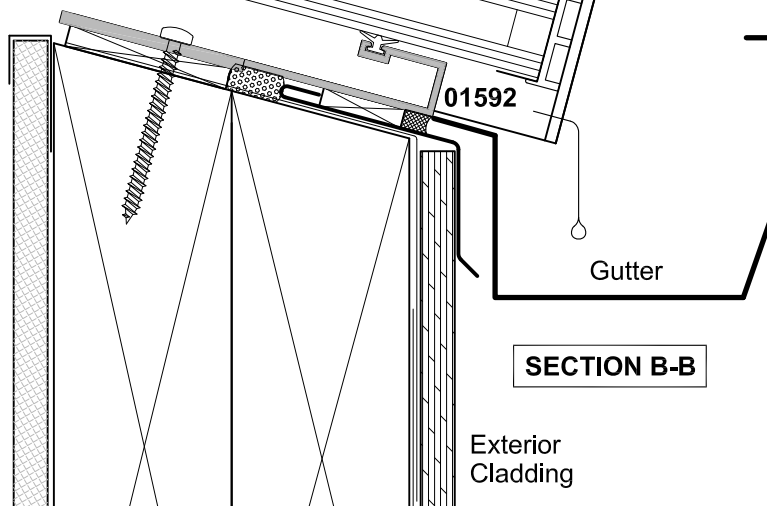
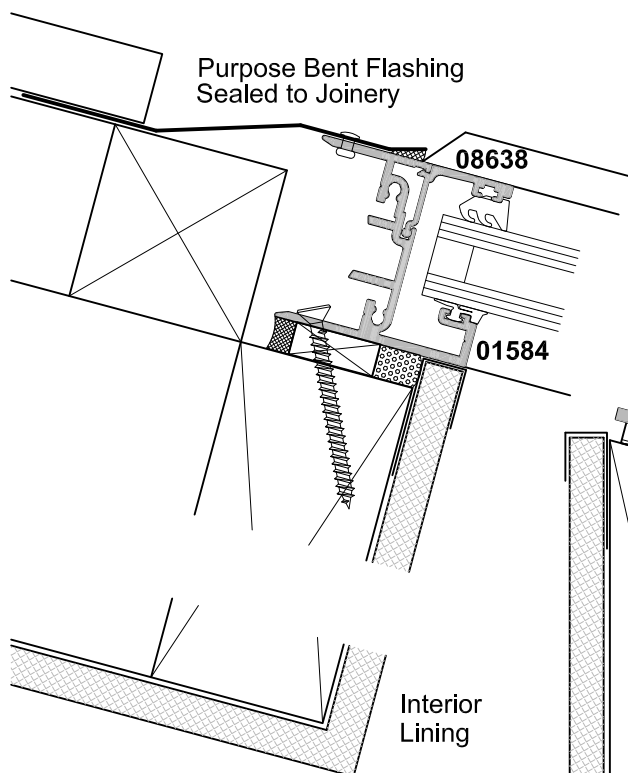

SECTION B-B

Note:
A Minimum Pitch of 5° (Double Glazing) is
required to allow water to run off the glass.