

ULLRICH ALUMINIUM



ULLTRACLAD CLADDING

ALUMINIUM WEATHERBOARDS



QUALITY • SERVICE • INTEGRITY

Contents

Introduction

Strength and Versatility

Design Initiative

Board Profiles

Surface Coating Options

Overview



ULLTRACLAD[®]

The Aluminium Weatherboard that Breathes



Introduction

- With the advent of the "leaky home syndrome" Ullrich Aluminium decided that there had to be a better way to clad the outside of new and existing homes. Designed and Manufactured in New Zealand, ULLTRACLAD[®] is an extruded aluminium cladding. Special attention was paid to the way that air circulates behind the cladding allowing it to breathe and ensure maximum protection for your home.
- ULLTRACLAD[®] has been tested and approved by BRANZ and complies with New Zealand Building Code part E2 (External Moisture). Installation of all ULLTRACLAD[®] products should be in compliance with our BRANZ approved installation details.
- The ULLTRACLAD[®] cavity-based cladding system has been designed for easy installation. It is supplied as a complete integrated system with its own flashings and corners, soffits and jointers. The ease and speed of installation associated with the system results in faster construction times, lower subcontractor costs and a controlled powder coated finish.

Designed for New Zealand Weather Conditions

Strength and Versatility

- Install ULLTRACLAD® the low maintenance cladding system, designed in New Zealand by Ullrich Aluminium for New Zealand weather conditions. With a simple regular wash, to remove dirt and grime, your powdercoating will last for many years to come.
- ULLTRACLAD® has been design tested to withstand all weather variables including; high temperatures, extra high wind speed (NZS3604:2011), sea spray zones and of course to keep moisture out.
- ULLTRACLAD® is equally suited to classic or modern home styles, giving architects and designers the ability to design something unique using a product that will stand the test of time. With its quick installation and prefinished coating you can enclose your building quickly and safely.
- ULLTRACLAD® has been seismically tested by BRANZ. The following conclusion was included in their report: *"In an earthquake, the ULLTRACLAD® wall system tested is expected to 'ride out' the expected displacements of the light timber frame to which it is attached with no observable damage up to racking displacements of +48mm. Damage at the completion of racking displacements of +65mm is expected to be slight with no components failing or falling."*

Excellence in Performance and Design

Design Initiative

- ULLTRACLAD® is an interlocking, durable aluminium cladding system complete with flashings, fixings and is powder coated or anodised in a large range of colours.
- ULLTRACLAD® is defined as a lightweight cladding, BRANZ approved for all profiles installed as per their specified application.
- ULLTRACLAD® is designed as a complete system. All technical details for council approval and construction documentation are available both online and as a hardcopy in a range of formats.
- Its low maintenance finish and excellent aesthetic appeal, ticks all of the boxes in many building specifications. The unique design of ULLTRACLAD® means you can also combine different profiles in the same wall to create a variety of looks.
- Our Building Products Division provides ULLTRACLAD® the technical support to assist you through the design, planning and construction stages of your project no matter where in the country you are situated.

The Permanent Cladding Solution for Today's Market

Board Profiles

- ULLTRACLAD® is available in eleven different profiles, that can be fitted either horizontally, vertically or both, allowing it to be specified for both domestic and commercial applications. The boards are extruded from premium grade aluminium as a weatherboard profile with either a smooth or textured surface. When installed, ULLTRACLAD® is effectively 15mm thick and ranges from 150mm to 206mm in depth.

The boards are produced in both 5.1m and 6.1m lengths.

UA 4917
TEE BOARD

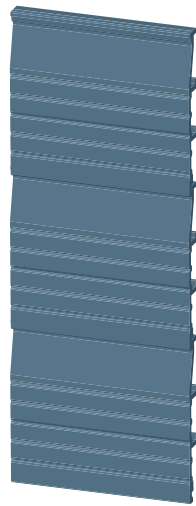

OAD 150 x 15
HORIZONTAL fit only

UA 4528
STANDARD BOARD

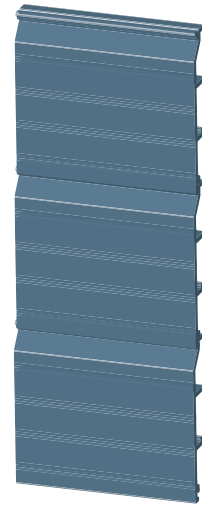

OAD 190.5 x 15
HORIZONTAL fit only

UA 5059
TRADITIONAL BOARD

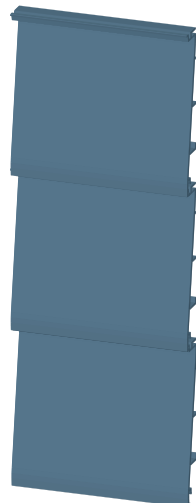

OAD 157 x 15
HORIZONTAL fit only

UA 6975
SHADOLINE BOARD

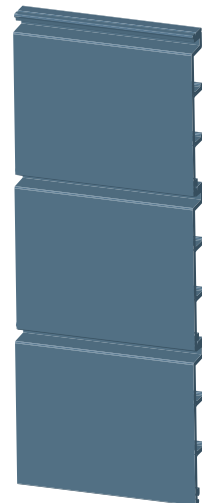

OAD 205 x 15
HORIZONTAL & VERTICAL fit

UA 7401
INFINITY BOARD

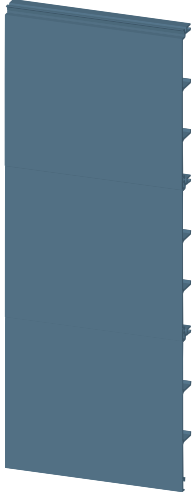

OAD 205 x 15
HORIZONTAL & VERTICAL fit

UA 7726
SHADO 100 BOARD

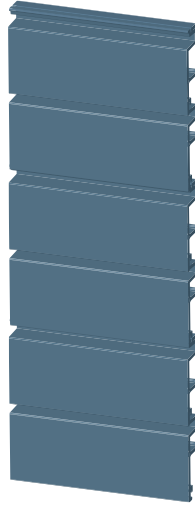

OAD 205.16 x 15
HORIZONTAL & VERTICAL fit

UA 7837
FIN BOARD

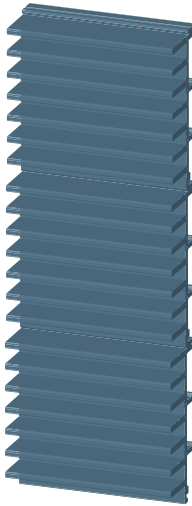

OAD 193 x 40
VERTICAL fit only

UA 7868
SHADO 140 BOARD



OAD 205.16 x 15
HORIZONTAL & VERTICAL fit

UA 7922
SHIPLAP BOARD

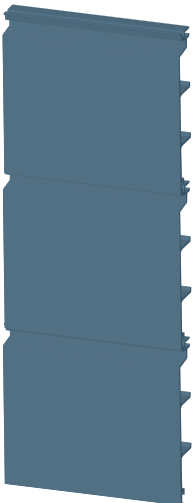

OAD 164.07 x 15
HORIZONTAL & VERTICAL fit

UA 7923
ULLTRALINE BOARD



OAD 206.18 x 15
HORIZONTAL & VERTICAL fit

UA 7937
ULLTRATRAY BOARD



OAD 205 x 15
VERTICAL fit only



Interpon: Premium Architectural Powder Coatings



OFFERED EXCLUSIVELY IN NEW ZEALAND BY

POWDER COATING GROUP®
FAST TURNAROUND . EXPERT SERVICE . PROFESSIONAL FINISH

www.powdercoating.co.nz

AkzoNobel has a passion for paints. Experts in the craft of making paints and coatings, setting the standard in colour and protection since 1792.

AkzoNobel has a world class portfolio of brands, trusted by customers around the globe. Headquartered in the Netherlands, and active in over 150 countries, AkzoNobel is committed to sustainable manufacturing and passionate about delivering high-performance products and services.

Interpon, is a global brand of AkzoNobel and is the global reference and leader in Powder Coatings technologies. Interpon have over 30 production sites across the world. Home to the Aesthetics Centre, Interpon have extensive experience in colour research, design trends and architectural colour prediction. This extensive colour experience ensures architects, designers and specifiers have complete Colour Freedom when specifying Interpon D products, the preferred powder coating for the architectural market.

Interpon D2525 Commercial Collection

The Interpon Commercial Collection has been developed with design in mind. The collection offers a broad taste of design, colour and finish options available to architects and specifiers for the decoration and protection of architectural aluminium. Interpon Powder Coatings also have the longest Track Record in Superdurable Technology globally.

Interpon D2525 meets the needs of the most demanding projects. Developed specifically for architectural components, the range is ideal for both exterior and interior aluminium applications from curtain wall extrusions to balustrades and louvre systems. Providing superdurable protection from the elements, the range exceeds global weathering standard AAMA2604, guaranteeing excellent colour retention and high resistance to chalking. Exceptional endurance to environmental stressors including high levels of UV radiation, humidity, heavy pollutants and extreme temperatures are achieved through super durable polymer technology engineered to withstand the weathering extremes of New Zealand. This results in being able to specify in all NZ3604 building zones.

Guaranteed up to 25 Years via Gold Global Warranty when applied by an Interpon Approved Applicator.

e: salesnz@interpon.com
www.specifyinterpon.co.nz
Tel: 0800 150 527



For more information on available finishes see our Brochure

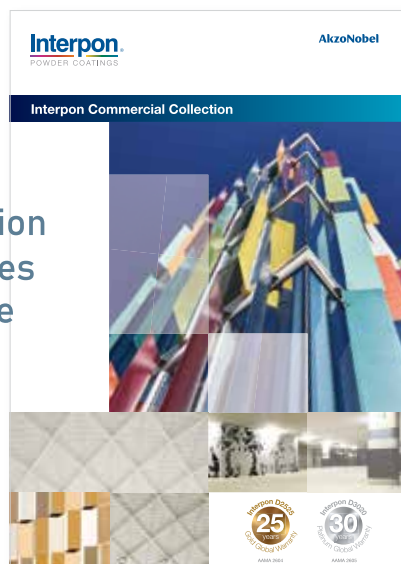

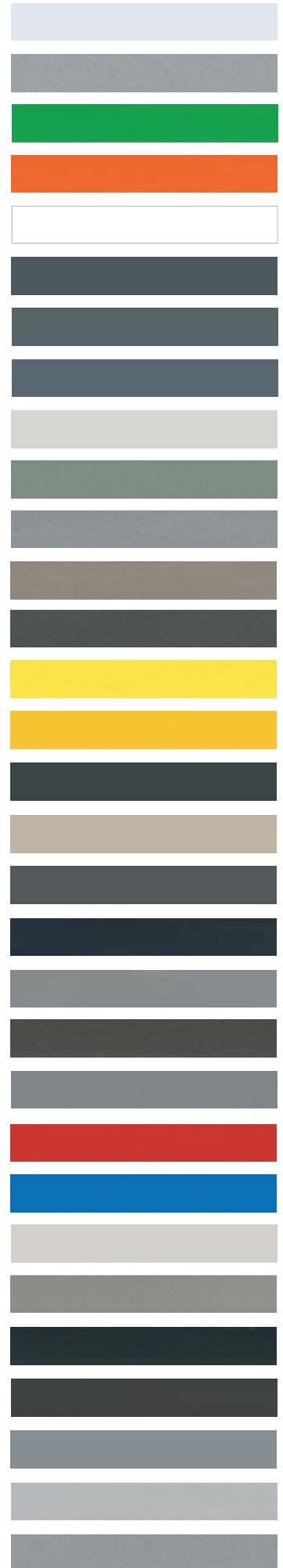

Dulux Duratec®

Dulux Duratec® is a thermosetting TGIC free powdercoating designed specifically for architectural applications where colour and gloss retention is critical. Dulux Duratec® is formulated with advanced polyester resin technology and high performance pigments to conform to the performance requirements of AAMA 2604. It has superior gloss and colour retention compared with standard polyester powdercoatings. Dulux Duratec® has been developed for use on architectural aluminium, including exterior cladding and various features on residential and commercial buildings.

Formulated to meet: AS 3715-2002. AS 4506-2005 and AAMA 2604.

Dulux Duratec® is supported by the Dulux durability warranty* on pre-treated architectural aluminium when applied by a Dulux Registered Applicator. Refer to the Dulux Powdercoating website for warranty terms and conditions.

- Suitable for developments further than 10 metres from salt water
- Durable polyester
- Excellent colour retention
- Smooth film appearance
- Hard wearing / serviceable finish
- Available in a wide range of popular colours.

Supported by a 20 year durability warranty* on pre-treated architectural aluminium when applied by a Dulux Registered Applicator.

* For further information on the full range of Dulux Powdercoating products, warranties and colour options, visit <https://www.duluxpowdercoatings.co.nz/>

Care & Maintenance

- Powdercoating is one of the most durable colour coatings available and it will provide you with many years of excellent service. To extend the life of the powdercoating and comply with warranty requirements for powdercoated aluminium, a simple, regular maintenance programme should be implemented.
- The effects of ultraviolet light, atmospheric pollution, airborne salt deposits, dirt and grime can all accumulate over time and should be removed at regular intervals. As a general rule cleaning should take place at least every three months.

Cleaning Recommendations

- Use a soft brush (non-abrasive) and dilute a solution of a mild detergent, eg. PH-neutral liquid car wash detergent in warm water (DO NOT use solvents) to remove dust, salt and other deposits.
- Ensure you thoroughly rinse the surfaces with clean fresh water after cleaning to remove all residue.



DURATEC®
POWDERCOAT RANGE



realistic, natural-looking, woodgrain finishes
for aluminium extrusions

- ✓ Lightweight
- ✓ Non-Warping
- ✓ Impact & Scratch Resistant
- ✓ Virtually Maintenance Free
- ✓ Insect Resistant
- ✓ Non Combustible
- ✓ Eco Friendly
- ✓ Stain & Fade Resistant
- ✓ Fully Customisable



For more information
on our woodgrains
and many other finishes
see our Brochure

OFFERED EXCLUSIVELY IN NEW ZEALAND BY



www.powdercoating.co.nz

Overview

Material Type Aluminium Alloy: 6060 - T5

BRANZ Approved YES

Mass Defined as 'Lightweight' (NZS:3604.2011)

Wind Zones Up to and including 'Extra High Wind Speed' (NZS:3604.2011)

Cavity Fix Up to Risk Matrix of 20 (refer NZBC/E2)

Fixing Type Aluminium Bracket with Stainless Steel Screw (hidden fixings)

Finish Options INTERPON - DULUX DURATEC - METWOOD

Seismic Testing YES (BRANZ ST0871)



ULLTRACLAD®

Phone for your nearest

ULLRICH ALUMINIUM SALES CENTRE

AUSTRALIA - 1300 650 075

NEW ZEALAND - 0800 500 338

- ALUMINIUM EXTRUSIONS
- ALUMINIUM SHEETS
- ROLLED PRODUCTS
- MARINE & TRANSPORT SECTIONS
- FASTENINGS
- LADDERS
- MOBILE SCAFFOLDS
- ULLTRACLAD CLADDING
- DESIGNER INTERNAL PARTITIONING
- PLANIT DESIGN DISPLAY UNITS

Map key:

- SALES & DISTRIBUTION
- + MANUFACTURING
- * EXTRUSION PLANT

Representative operations throughout the South Pacific

www.ulltraclad.co.nz

ULLRICH ALUMINIUM PTY LTD
 PO Box 246 Carole Park Queensland 4300
 20 Ron Boyle Crescent Carole Park Queensland Australia
 Tel +61 7 3718 1400 Fax +61 7 3271 1230
 ullrich@ullrich.com.au www.ullrich.com.au

ULLRICH ALUMINIUM CO LTD
 PO Box 98 843 Manukau City Auckland 2241
 118 Wiri Station Road Wiri 2104 New Zealand
 Tel +64 9 262 6262 Fax +64 9 262 6266
 alkalum@uacl.co.nz www.ullrich.co.nz