



# PEF Rod

P.E.F. Foam Backer

## SPECIFICATION

1. HT Green Concrete Underlay
2. Hydro™ Seal Bituminous treatment
3. Dry-Fix DPC
4. Building Wrap
5. Wrapstrap™
6. Window Tape
7. **Air Tight P.E.F Backing Rod**

### PRODUCT DESCRIPTION

Masons™ PEF Rod is a cylindrical flexible closed cell polyethylene material, available in various diameters from 6mm to 50mm. Masons™ PEF Rod is suitable for domestic and commercial applications where gaps need to be sealed in conjunction with sealant or chalking compounds.

### PHYSICAL PROPERTIES

- Type: Closed cell polyethylene foam.
- Compliance: complies to ASTM standards as a P.E.F. Backing Rod
- Material: Extruded Polyethylene foam is CFC free and non toxic
- Chemical Resistance: Unaffected by most chemicals
- Temperature Range: -40°C to 70°C
- Water Resistance: No water absorption
- Colour: White

### COMPATIBILITY

Masons™ PEF Rod provides the following functions:

- Limits the amount and depth of the sealant applied into the joint.
- Acts as a bond break to allow joint movement without undue stress to sealant.
- Acts as a barrier to the flow of sealant through a joint.
- Will assist in providing an around the window frame and penetrations through walls.
- For use with pre-cast concrete slabs and joints between brick and masonry.

### STORAGE

Masons™ PEF Rod should be kept clean and dry during installation.

Diameter	Roll Length	Masons Code
6mm	20m	Air Tight6X20
6mm	50m	Air Tight6X50
8mm	20m	Air Tight8X20
8mm	50m	Air Tight8X50
10mm	20m	Air Tight10X20
10mm	50m	Air Tight10X50
13mm	20m	Air Tight13X20
13mm	50m	Air Tight13X50
15mm	20m	Air Tight15X20
15mm	50m	Air Tight15X50
20mm	20m	Air Tight20X20
25mm	10m	Air Tight25X10
30mm	10m	Air Tight30X10
40mm	10m	Air Tight40X10
50mm	5m	Air Tight50X5



# PEF Rod

## P.E.F. Foam Backer

### INSTALLATION

Masons™ PEF Rod is suitable for domestic and commercial applications where gaps need to be sealed in conjunction with sealant or chalking compounds.

- Always allow PEF Rod to be 25-30% larger than the width of the gap requiring filling.
- Ensure that the rod is firmly in place.

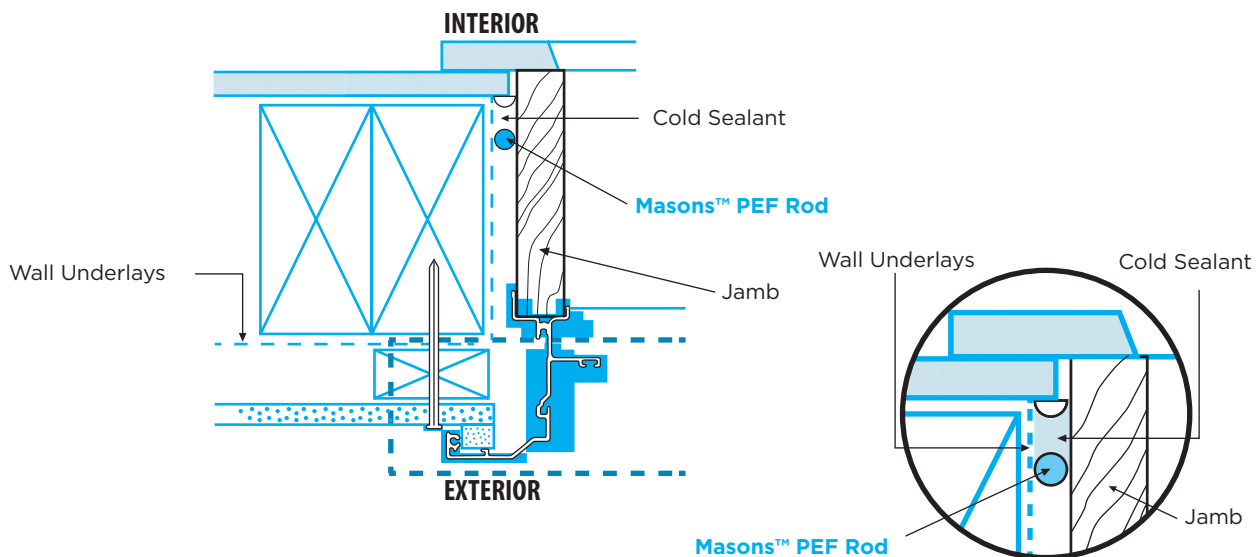

- Cut the PEF Rod to the required length and press the into the gap with a blunt tool to provide an even depth, avoid stretching and twisting the PEF Rod.

Masons™ PEF Rod is not intended in areas exposed to sunlight.

### DURABILITY

Masons™ PEF Rod will meet the performance requirements of NZBC Clauses B2, Durability (B2.3.1[b] 15 years), E2 External Moisture E2.3.2, F2 Hazardous Building Materials F2.3.1, providing:

- The rod is not damaged
- PEF Rod is installed according to the above installation guide
- PEF Rod is not exposed to sunlight for prolonged periods