

# COMMERCIAL WINDOW / DOOR SILL FLASHING FOR RIBLINE VERTICAL CLADDING (Recessed Window / Door)

DETAIL NO. CRW012C  
 DATE DRAWN 16/08/12  
 FILE REFERENCE R1-CRW012C.DWG

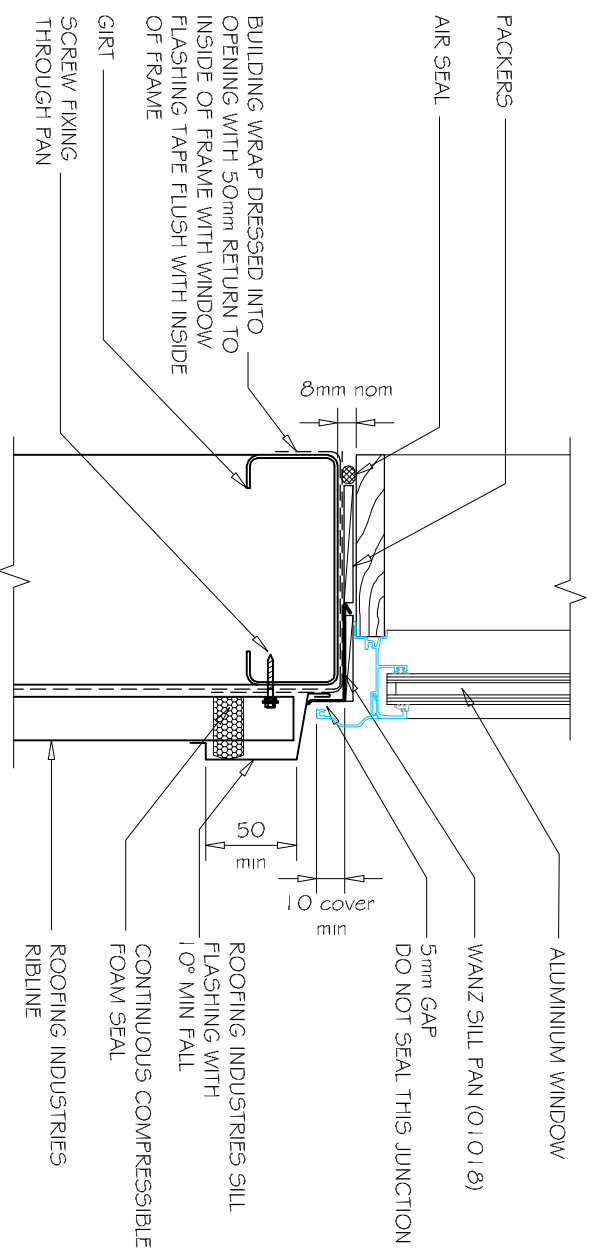

**C** WINDOW SILL VERTICAL RIBLINE  
1:5

**GENERAL NOTES:**

- (1) REFER TO E2/A5.1 OR WANSZ WIS FOR GENERAL WINDOW OPENING FOR WRAPPING
- (2) WINDOW PROFILE TO BE SELECTED TO ACHIEVE COVER SHOWN IN DETAILS.
- (3) ARCHITRAVES ARE SHOWN FOR CONSISTENCY ONLY, DETAIL MAY BE USED WITH REBATED LINER.
- (4) WHERE SUPPORT BRACKETS ARE REQUIRED BY THE WINDOW MANUFACTURER TO CARRY THE FRAME AND GLAZING LOADS, THEY MUST BE SUPPLIED AS AN INTEGRAL PART OF THE WINDOW MANUFACTURERS RECOMMENDATIONS.
- (5) LAGS WITH WINDOW MANUFACTURER PRIOR TO INSTALLATION.

**REFERENCE FLASHINGS:**  
 NZ METAL ROOF AND WALL CLADDING  
 CODE OF PRACTICE NZMRM.  
 WANSZ WIS.  
 DIMENSIONS ARE INDICATIVE ONLY

**NOTES:**

- These details are generally in compliance with the NZ Metal Roof & Wall Cladding Code of Practice and in some cases specific details by Roofing Industries!
- The building designer is ultimately responsible to ensure that details used meet the requirements of the NZ Building Code for the specific project.
- Details of the supporting structure are indicative only and are the responsibility of the building designer.
- Thermal break or cavity battens may be required in some circumstances.
- Underlay selection and building wrap types are the responsibility of the designer, environments including when aluminum is used.
- These details are for Roofing Industries profiles as nominated and may not be applicable to other profiles.
- This drawing is the copyright of Roofing Industries and can only be copied or reproduced with their permission.
- Further information can be obtained from the NZ Metal Roof & Wall Cladding Code of Practice [www.metalfinisher.org.nz](http://www.metalfinisher.org.nz) & [www.roof.co.nz](http://www.roof.co.nz)
- Where necessary adjust drawings for purlin battens or cavity battens.
- Details are for steel based materials, other substrate may require some changes.

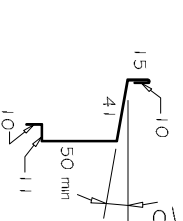

Sill flashings stop ended to receive jamb flashings (Dimensions are indicative only & show minimum lap covers)

©COPYRIGHT DETAIL 2012

