

COMMERCIAL RIBLINE ROOFING TRANSLUCENT STOP END

DETAIL NO. CRR040A

DATE DRAWN 13/03/12

FILE REFERENCE RI-CRR040A.DWG

NOTE:

- (1) MINIMUM PITCH 3°
- (2) INSTALL WIDE TOP FOAM CLOSURE STRIP OVER TRANSLUCENT BEFORE INSTALLING OVERFLASHING / RIDGE ETC.
- (3) FOAM CLOSURE STRIP NOT SHOWN FOR CLARITY

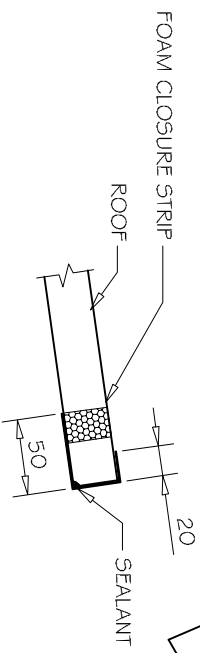
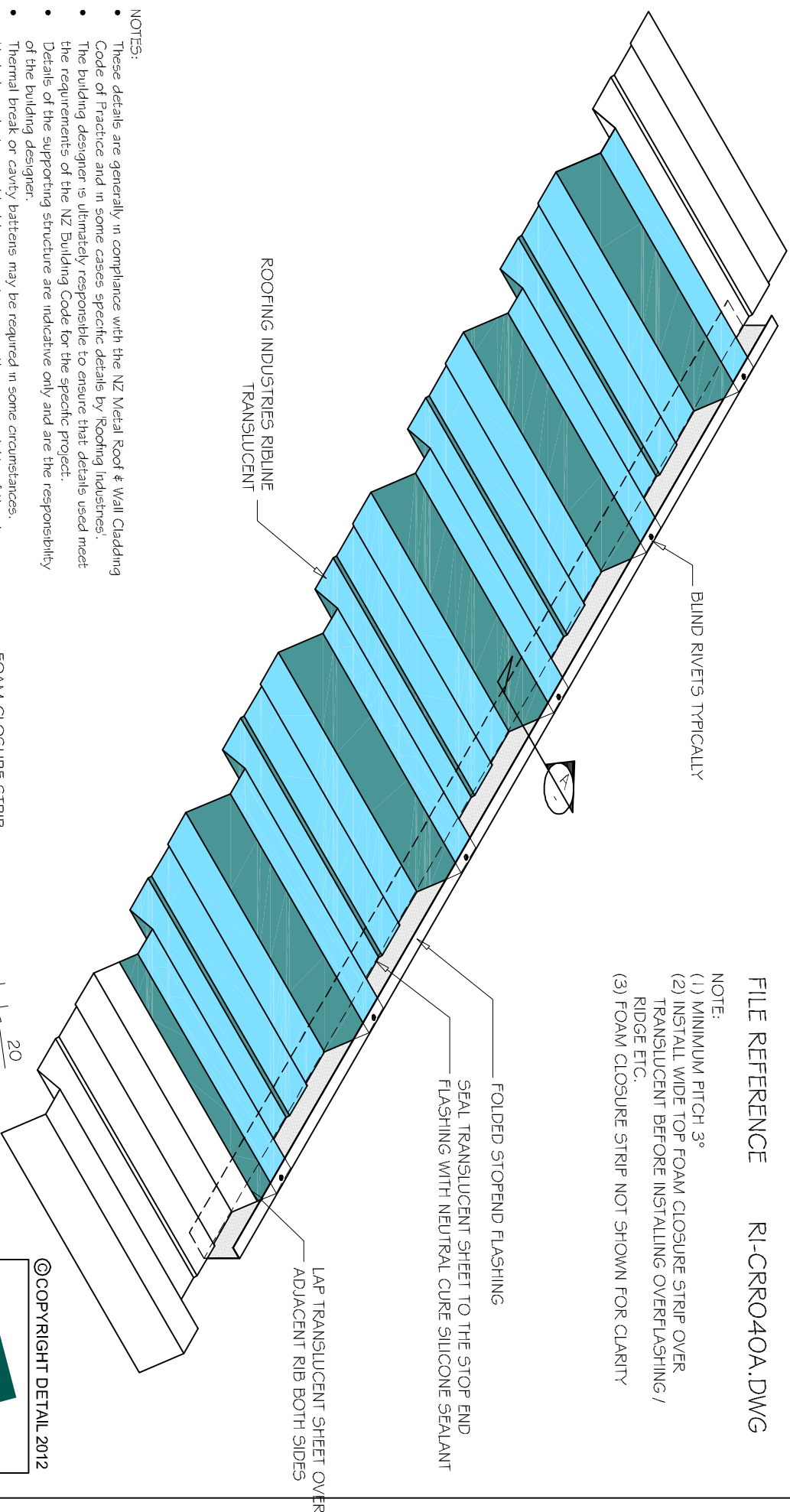

Section A-A
1:5

- NOTES:**
- These details are generally in compliance with the NZ Metal Roof & Wall Cladding Code of Practice and in some cases specific details by Roofing Industries.
 - The building designer is ultimately responsible to ensure that details used meet the requirements of the NZ Building Code for the specific project.
 - Details of the supporting structure are indicative only and are the responsibility of the building designer.
 - Thermal break or cavity battens may be required in some circumstances.
 - Underlay selection and building wrap types are the responsibility of the designer, Alternative support to galvanised netting should be used in severe coastal environments including when aluminum is used.
 - These details are for Roofing Industries profiles as nominated and may not be applicable to other profiles.
 - This drawing is the copyright of 'Roofing Industries' and can only be copied or reproduced with their permission.
 - Further information can be obtained from the NZ Metal Roof & Wall Cladding Code of Practice www.metd/roofer.org.nz & www.roof.co.nz
 - Where necessary adjust drawings for purlin battens or cavity battens.
 - Details are for steel based materials, other substrate may require some changes.

