

# COMMERCIAL RIBLINE ROOFING PARAPET HEAD APRON INTERNAL CLADDING (Soft Edge)

DETAIL NO. CRR008B  
 DATE DRAWN 1/0/2/13  
 FILE REFERENCE RI-CRR008B.DWG

SEPERATION BARRIER BETWEEN CONCRETE  
 & FLASHING (SELF ADHESIVE TAPE OR SIM)  
 FIX CAPPING TO CONCRETE WITH MASONRY  
 FASTENERS AT 600mm CRS

NOTE:  
 (1) MINIMUM PITCH 3°  
 (2) FOAM CLOSURE STRIPS ONLY REQUIRED IN HIGH  
 RISK SITUATIONS OF WIND BLOWN MOISTURE ENTERING.

- NOTES:
- These details are generally in compliance with the NZ Metal Roof & Wall Cladding Code of Practice and in some cases specific details by Roofing Industries.
  - The building designer is ultimately responsible to ensure that details used meet the requirements of the NZ Building Code for the specific project.
  - Details of the supporting structure are indicative only and are the responsibility of the building designer.
  - Thermal break or cavity battens may be required in some circumstances.
  - Underlay selection and building wrap types are the responsibility of the designer. Alternative support to galvanised netting should be used in severe coastal environments including when aluminum is used.
  - These details are for Roofing Industries profiles as nominated and may not be applicable to other profiles.
  - This drawing is the copyright of 'Roofing Industries' and can only be copied or reproduced with their permission.
  - Further information can be obtained from the NZ Metal Roof & Wall Cladding Code of Practice [www.metlroofer.org.nz](http://www.metlroofer.org.nz) & [www.roof.co.nz](http://www.roof.co.nz)
  - Where necessary adjust drawings for purlin battens or cavity battens.
  - Details are for steel based materials, other substrate may require some changes.

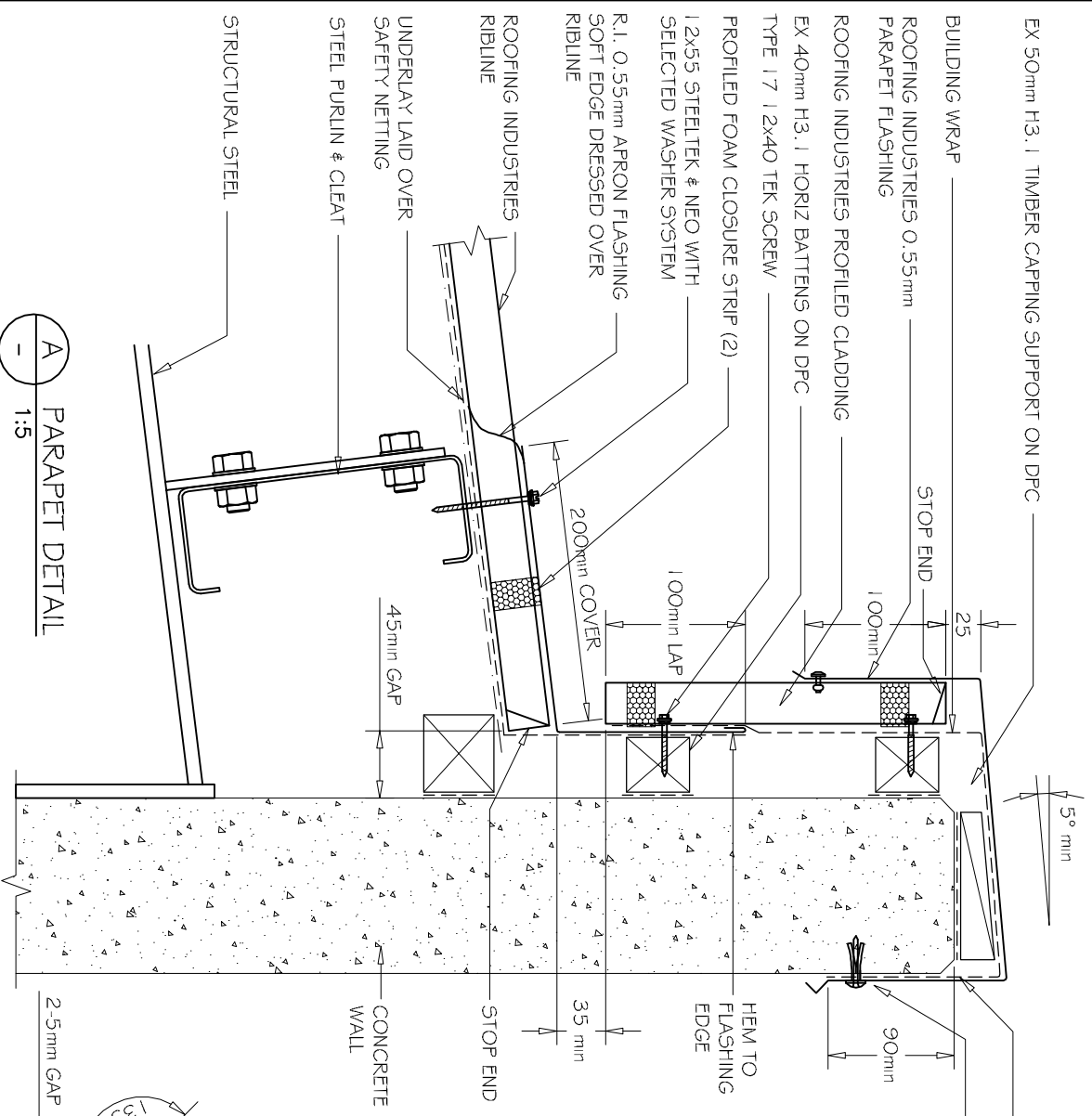

A - PARAPET DETAIL  
 1:5

