

This drawing is provided as a general guide only. Viridian Glass Ltd Partnership disclaim any responsibility for loss or damage suffered from the use of this drawing.

NOTES:

1. This proprietary balustrade system complies with New Zealand Building Code Clauses B1 Structure, F2 Hazardous Building Materials and F4 Safety From Falling Third Edition, subject to:

- all products meeting the required performance specification
- site installation carried out in accordance with intent of this drawing

2. The maximum heights of glass above anchors for residential occupancy C3 of Table 3.3 AS/NZS 1170.1 are provided in Table below.

Viridian safety glass options according to 22.4.3 of NZS 4223.3:2016 are:

- a. 15mm toughened glass with interlinking rail
- b. 17.52mm toughened SentryGlas laminated glass with gap clamps

Interlinking rail or gap clamps must be connected to each glass pane or to the building.

3. The design of concrete, timber or steel support is the responsibility of others.

4. A handrail of 32-50mm diameter is required for stairs and ramps exceeding 1:20 slope. Refer NZBC D1/AS1.

5. Maximum distance from side edge of glass to fixings - 200mm for occupancy C3.

Wind Zone and Maximum Height of Glass Above Euroanchors	
Wind zone	Y max
High and below	1300
Very high	1250
Extra high	1150

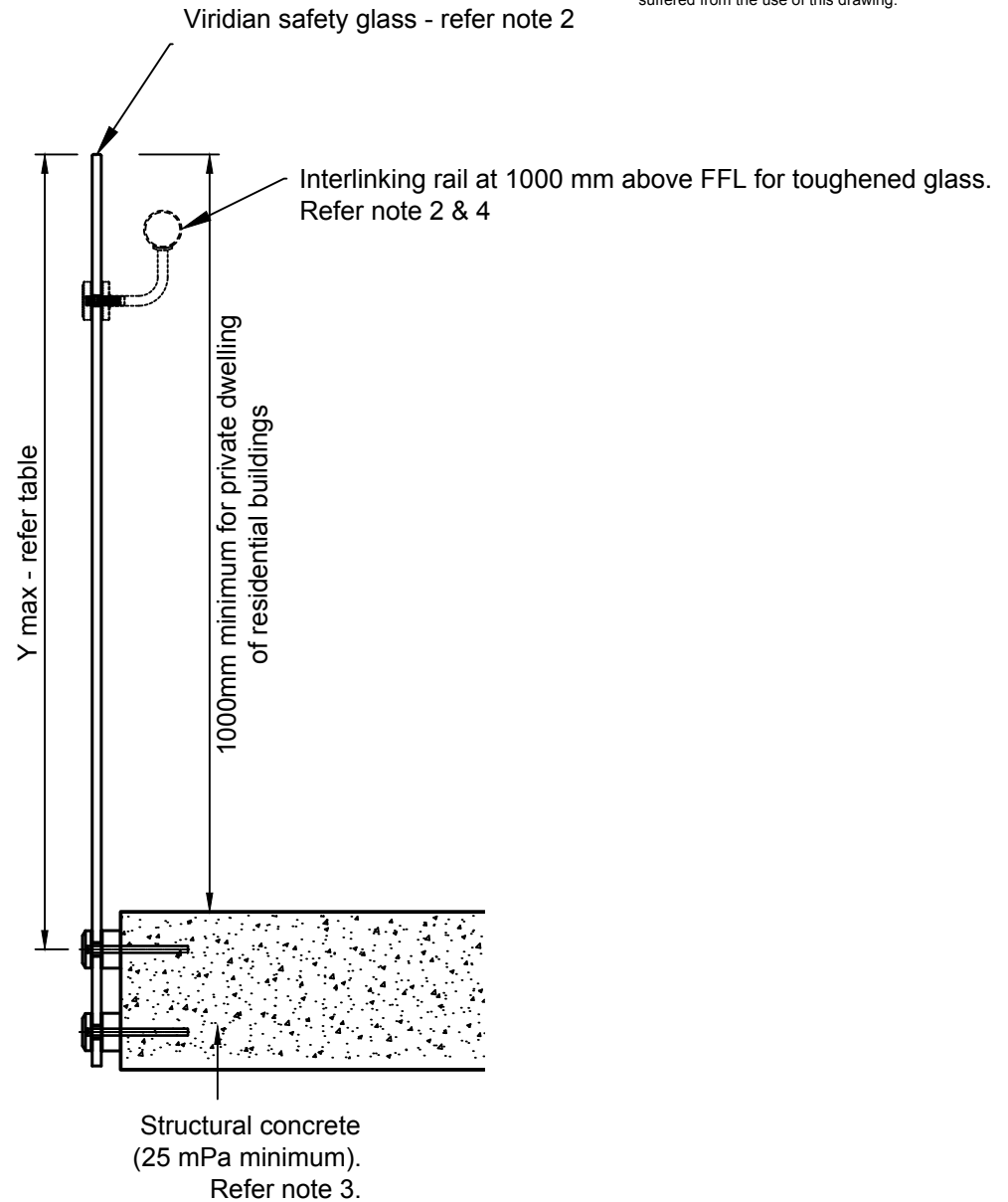

This drawing is provided as a general guide only. Viridian Glass Ltd Partnership disclaim any responsibility for loss or damage suffered from the use of this drawing.

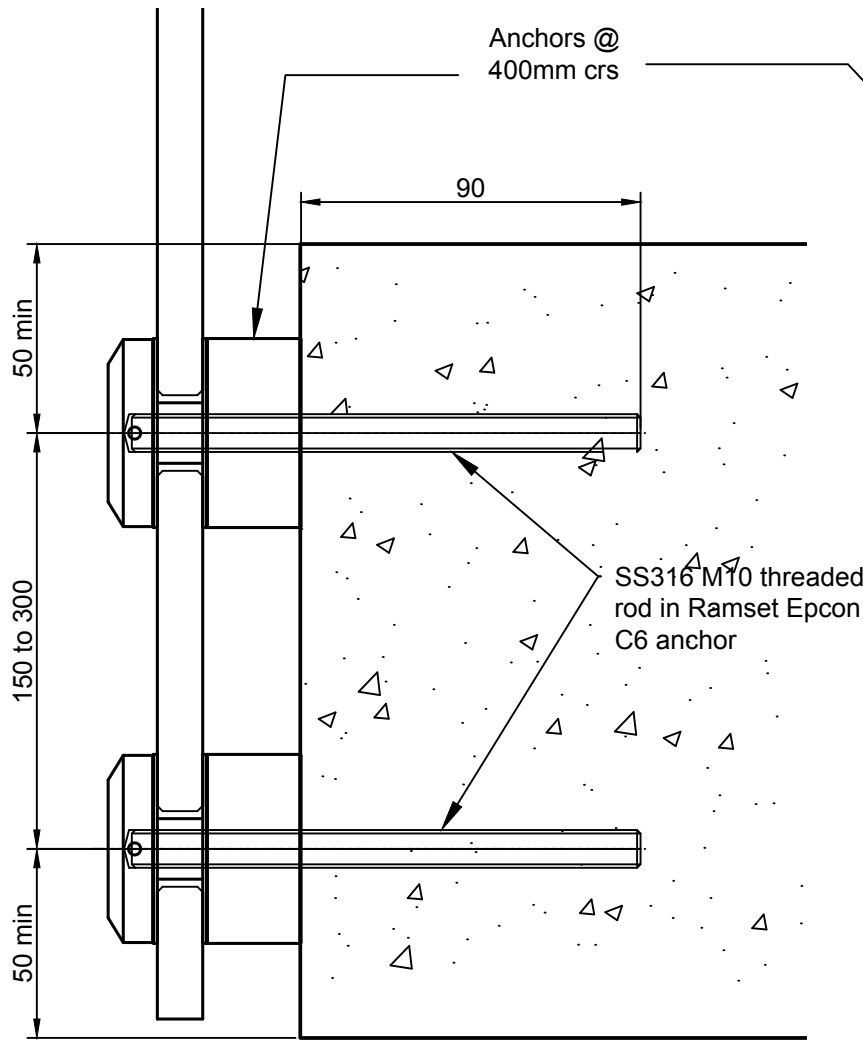

DETAIL A - CONCRETE

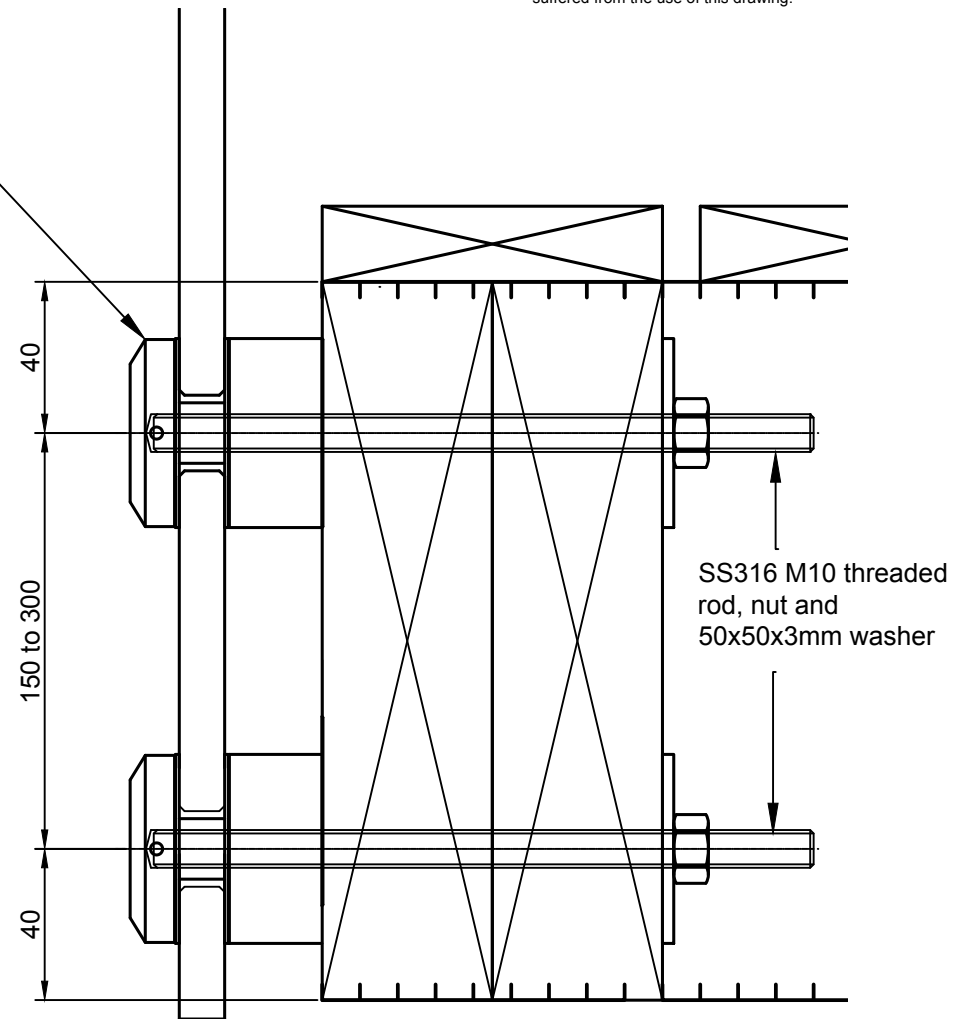

DETAIL B - SG 8 TIMBER

This drawing is provided as a general guide only. Viridian Glass Ltd Partnership disclaim any responsibility for loss or damage suffered from the use of this drawing.

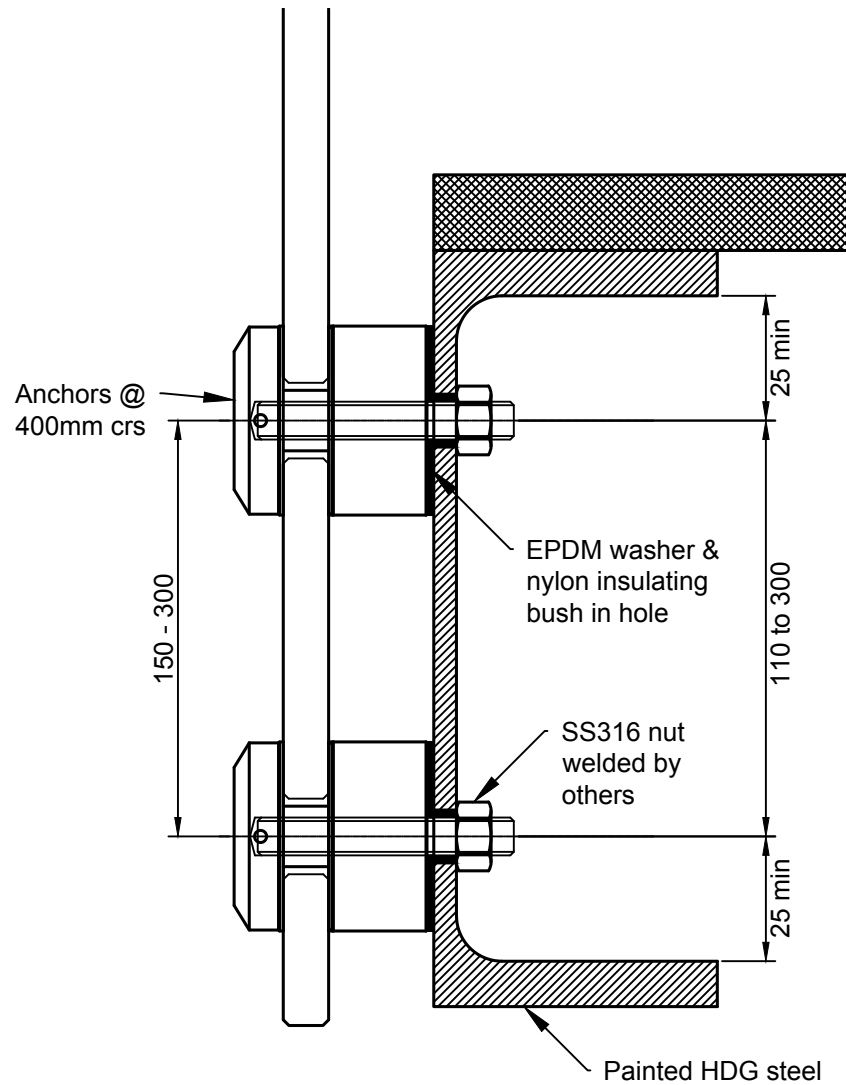

DETAIL A - STEEL - EXTERNAL

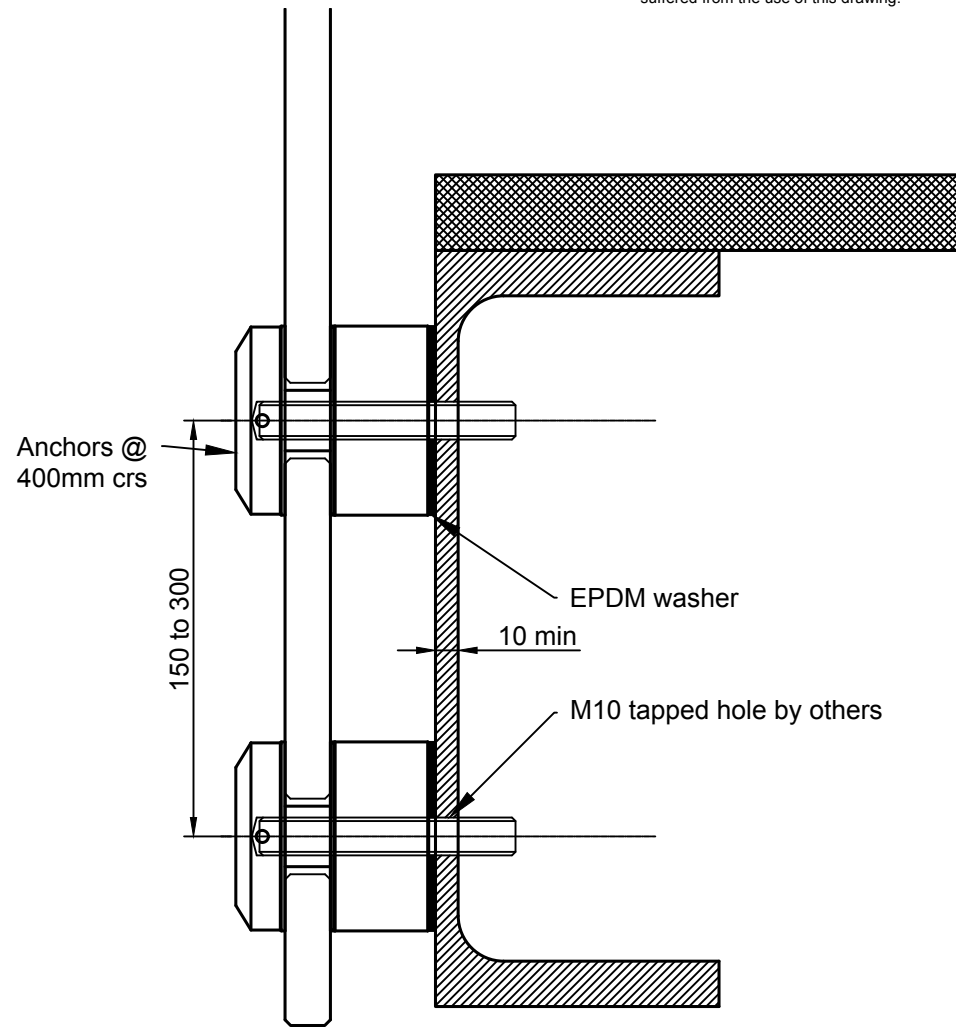

DETAIL B - STEEL - INTERNAL