

Floor

Pink® Batts® SnugFloor®

PRODUCT DATA SHEET

Application

Pink® Batts® SnugFloor® is a range of glass wool underfloor insulation products and accessories designed to:

- Reduce heat loss in new and existing homes with suspended floors
- Eliminate draughts through exposed floorboards
- Assists in meeting the requirements of the New Zealand Building Code (NZBC) for different designs and environments

Features and Benefits

- Comfort – Reduces heat loss and absorbs sound for a warmer, more relaxing, home
- Cost Saving – Lightweight, flexible and simple design makes the installation fast and easy, especially when joists are uneven or out of kilter. A well-insulated home can save up to \$1,800¹ on energy bills annually
- Sustainability – Made locally from up to 80% recycled glass Pink® Batts® insulation reduces dependence on virgin materials
- Healthy Living – R-values up to 2.6 can provide over twice the minimum required by the NZBC² which assists in keeping homes above 18°C as per the World Health Organisations recommendation for a healthy and comfortable home
- Product Safety – New wire support system requires no stapling, nailing or protective sheathing – enhancing safety when installing around electrical cables. Pink® Batts® insulation is non-combustible and will not easily burn therefore creating a safer living environment
- Assurance – BRANZ appraised giving independent assurance of the 50 year durability requirements of the New Zealand Building Code and attainment of R-Values

¹ Department of Building and Housing, Your guide to a smarter home, 2008, p. 28

² Dependent on subfloor design and use of Pink® Batts® SnugFloor® R2.6

Environment

- Manufactured using up to 80% recycled glass, making sustainable use of waste glass
- Energy used during the manufacture of Pink® Batts® products is offset by the energy saved by a home fully insulated with Pink® Batts® products within 3-15 months³
- Locally manufactured in Auckland and Christchurch, minimising shipping distances compared to imported products

Potential Green Star NZ Credits

Green Star NZ is a comprehensive environmental rating system for buildings. Pink® Batts® insulation may contribute to points under Green Star New Zealand. Further information is available at www.nzgbc.org.nz

Environmental Choice

Initiated and endorsed by the New Zealand Government, Environmental Choice recognises the genuine moves made by manufacturers to reduce the environmental impacts of their products.

While only the higher R-value Pink® Batts® Wall and Ceiling insulation products have Environmental Choice accreditation, all Pink® Batts® thermal insulation products including the Pink® Batts® SnugFloor® range are manufactured in the same environmentally considerate way.

³ Beca Carter Hollings & Ferner Ltd, Energy Economics of Fibreglass Insulation, 2005

Floor

Pink® Batts® SnugFloor®

PRODUCT DATA SHEET

Product Safety

Pink® Batts® insulation is a non hazardous, safe product.

- IARC (International Agency for Research on Cancer) classifies the glass wool formulation used to manufacture Pink® Batts® products as Group 3: 'Not classifiable as to its carcinogenicity to humans'. This is the same classification as caffeine, tea and chlorinated drinking water
- Pink® Batts® insulation is bio-soluble. In the unlikely event any fibres are inhaled into the lungs they will dissolve in the body fluids and be cleared from the body



General Health

- Pink® Batts® insulation will assist in meeting the World Health Organisation recommendation for houses to be maintained at a minimum temperature of 18°C to provide a healthy and comfortable home
- Pink® Batts® insulation has been accepted into the Asthma and Respiratory Foundation of New Zealand's Sensitive Choice programme. Insulating with Pink® Batts® insulation is beneficial to those suffering from asthma
- A Wellington School of Medicine study found insulated houses resulted in families with fewer sick days and the economic benefit was double the initial cost of the insulation⁴



⁴ Howden-Chapman, P. et al. "Effect of insulating existing houses on health inequality: cluster randomised study in the community" British Medical Journal, 2007, p334-460

Technical Data - Pink® Batts® SnugFloor® insulation

Properties	Result	Test/Method/Standard	Test Results
Combustibility	Non-Combustible ✓	NZS/AS 1530.1:1994	
Flammability	Non-Flammable ✓	NZS/AS 1530.3:1993	
		Ignitability (Range 0-20)	= 0
		Spread of Flame Index (Range 0-10)	= 0
		Heat Evolved Index (Range 0-10)	= 0
		Smoke Developed Index (Range 0-10)	= 0-1
R-value	R1.6 and R2.6 ✓	AS/NZS 4859.1:2002	
Corrosion	Non-Corrosive N/A	AS/NZS 4859.1:2002-Glasswool exempt	
Moisture Absorption	Non-Hygroscopic N/A	AS/NZS 4859.1:2002-Glasswool exempt	
Vermin Resistance	No Food Source ✓	AS/NZS 4859.1:2002-Glasswool exempt	

Technical Data - Pink® Batts® Snugfloor® Support Wires

Properties	Result	Test/Method/Standard
Corrosion	Zinc/Aluminium coating	AS/NZS4534/W05Z5A
Tensile Strength	1050-1450 MPa	N/A

New Zealand Building Code (NZBC) and Limitations

Pink® Batts® SnugFloor® when used, installed and maintained in accordance with the requirements outlined in this data sheet will meet or contribute to meeting the following provisions of the NZBC:

NZBC Clause B2: Durability

Meets the requirement NZBC B2.3.1 a) 50 years and NZBC B2.3.1 b) 15 years

NZBC Clause E3: Internal Moisture

Contributes to meeting the requirements

NZBC Clause F2: Hazardous Building Materials

Meets this requirement and will not present a health hazard to people

NZBC Clause H1: Energy Efficiency

Contributes to meeting these requirements

Limitations

To meet the provisions of the NZBC as outlined in this data sheet, Pink® Batts® SnugFloor® **MUST** be:

- Installed and maintained in a dry protected environment
- Installed in a building where the provisions of NZBC E2 and E3 are met

Pink® Batts® SnugFloor® should **NOT** be:

- Crushed unless otherwise stated

Pink® Batts® SnugFloor® Installation Instructions

Please ensure you have read the limitations of this product before commencing installation.

Safety:

Prior to installation check for all hazards that may cause injury. Carry out repair work without delay.

- Ensure there is adequate lighting to identify any hazards
- Treat all electrical cables as live
 - Repair damaged, exposed or hanging cables immediately
 - Be careful not to cut or expose electrical cables and wires
 - When supporting insulation with staples and straps, or support wires leave a 50mm gap between staples/ support wires and electrical cables. Avoid contact with electrical cables at all times.
 - Use labels to identify location of wires, pipes and cables for future reference
- Beware of sharp objects (protruding nails, splinters etc) and pests (bees, wasps, animals and vermin)

Seek professional advice if you are unsure how best to isolate the hazard or have a professional installer carry out the work on your behalf.

Equipment Required:

- Protective loose fitting, long sleeve clothing
- Rubber faced gloves
- Safety glasses
- Battery powered lighting
- Pink® Batts® SnugFloor® Support Wires and bolt cutters OR
- Danband or similar strapping (>20mm wide) and a staple gun with 10mm galvanised or plastic staples
- Dust mask
- Rubber soled footwear
- Knife and cutting board
- Tape measure

Pink® Batts® SnugFloor® Installation Instructions continued...

Correct installation is critical to ensure insulation products perform well. A small gap around the insulation can significantly reduce the construction R-value.

We can recommend professional installers throughout New Zealand who guarantee installation to NZS 4246:2006. Go to www.pinkbatts.co.nz or call 0800 PINK BATTs (746 522) to locate an installer in your region.

Prework Checklist:

Before commencing installation ensure:

- Mains power switched off
- Underfloor area has adequate working space and lighting
- No signs of water seepage beneath bathroom floors (and other wet areas). Repair damaged plumbing or sewer work
- Underfloor area is dry with adequate ventilation. If wet or damp install a polyethylene groundsheet (Moistop® Underlay)

Installation Instructions Overview:



Installation Instructions:

- Open the pack before entering underfloor area. The compressed product will expand substantially
- Start installing at the point furthest from the access point and work back towards it

Refer to the "How to install around..." section (page 9 of this data sheet) for details on how to install around electrical wiring, lights, plumbing or when you have exposed subfloors.

1 FIT

Fit width-wise between joists ensuring that there is the required overlap.

- Pink® Batts® SnugFloor® Narrow ≥30mm
- Pink® Batts® SnugFloor® Wide ≥50mm

If overlap is insufficient use wider product or fit pieces length wise between joists

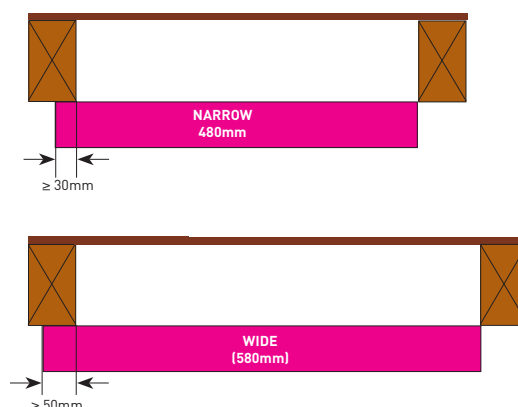

Pink® Batts® SnugFloor® Installation Instructions continued...

2 FOLD

- (a) Insert one side of the Pink® Batts® SnugFloor® piece against the joist

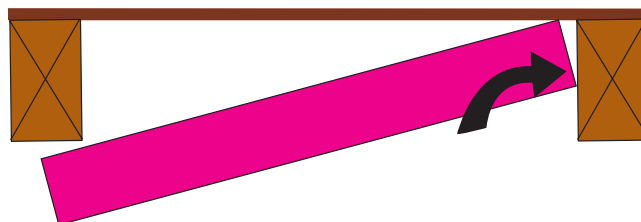

- (b) Push the other side of the Pink® Batts® SnugFloor® piece into the opposing joist with a fold to create a friction fit



- (c) Ensure there are no gaps in corners and under floor boards

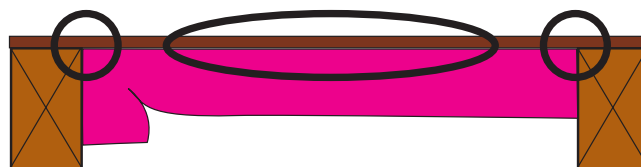

- (d) The fold must not extend beneath the joist, trim if required

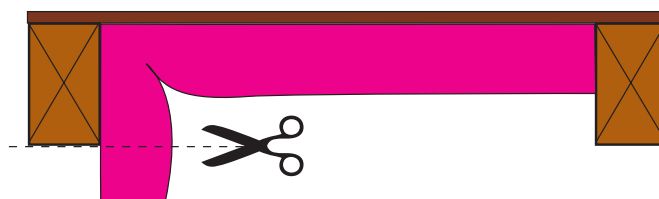

- (e) Ensure adjoining Pink® Batts® SnugFloor® pieces are butted together. It is essential that there are no gaps. Insulate out to under the bottom plate. Open air pockets around the perimeter must be blocked to prevent air flow

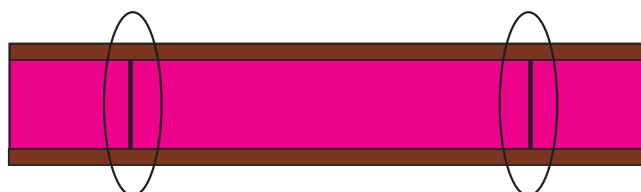

Pink® Batts® SnugFloor® Installation Instructions continued...

3 SECURE

Secure insulation with either Pink® Batts® SnugFloor® Support Wires, or strapping, such as Danband. Pink® Batts® SnugFloor® Support Wires are designed to make installation fast, easy and safer around electrical wires. They are the preferred method for securing insulation and highly recommended for both DIY and professional installers

Pink® Batts® SnugFloor® Support Wires must be adequately protected from environmental elements as detailed in the 'Exposed Subfloors' section (page 9 of this data sheet) when:

- In the sea spray zone (< 500m from the coastline)
- In corrosion Zone 1 properties that do not have a closed in subfloor perimeter

Supports are required to prevent dislodgement from vermin, timber movement and excessive vibration.

(i) SECURE with Pink® Batts® SnugFloor® Support Wires

- (a) Pink® Batts® SnugFloor® Support Wires must be at least 20mm wider than the joist spacing to ensure a strong hold between joists

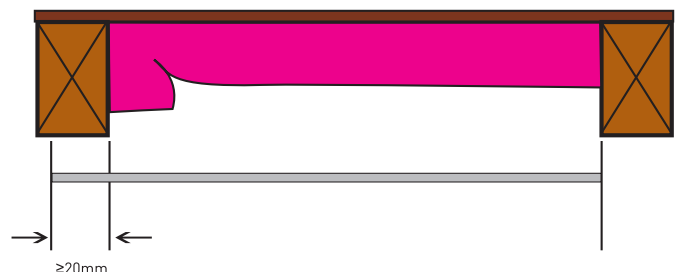

- (b) Secure using no less than three Pink® Batts® SnugFloor® Support Wires per piece:
- ❶ In the middle (approx. 600mm from the end)
 - ❷ Approx 200mm from each end

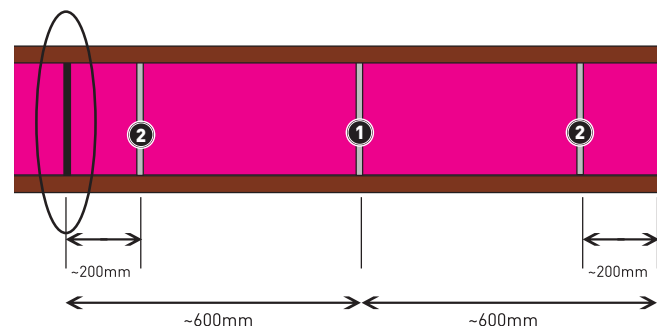

Pink® Batts® SnugFloor® Installation Instructions continued...

- (c) Keeping the support wire perpendicular to the joists, insert the wire on the opposite side from the fold so it touches the insulation. Ensure that the insulation is not being compressed. Always install the wire on the joist face supporting electrical wires first. **See note below.**

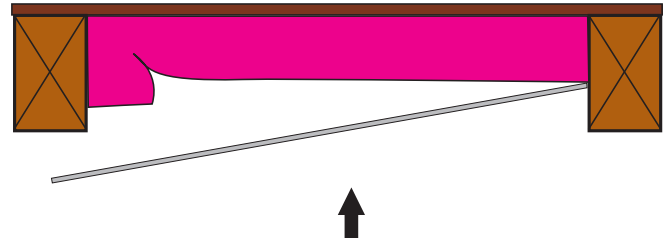

- (d) Gently slide the other end up so it holds the insulation firmly against the floor but does not compress it. Ensure that three points of contact are achieved. The wire will bend as you push upwards and the ends will bite into the wooden joists. Wires can only be installed by bending vertically towards the floor.

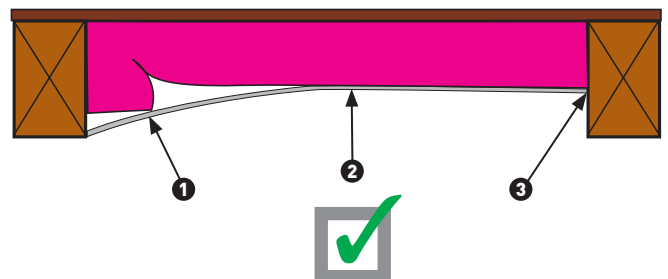

- (e) Do not compress the insulation more than 25mm. The use of Pink® Batts® SnugFloor® Support Wires that are too long will compress the insulation reducing its R-value and thermal effectiveness. Trim oversized wires using bolt cutters.

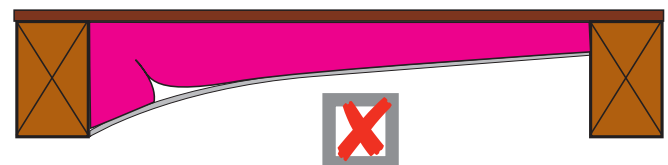

When installing around electrical cables ensure that you have a clear view of the joist face and can fit the support wire accurately. Always insert the support wire on the joist face with the electrical cabling before sliding the other end into position. If necessary refit the insulation piece so that the fold is on the opposite face to the electrical cabling.

- **Never position a support wire on an electrical cable or slide it over an electrical cable**
- **Never position a wire support where you cannot see the joist face clearly**

Pink® Batts® SnugFloor® Installation Instructions continued...

(ii) SECURE with Strapping

- (a) Secure using no less than three straps per piece:
- ❶ In the middle (approx. 600mm from the end)
 - ❷ Approx 200mm from each end

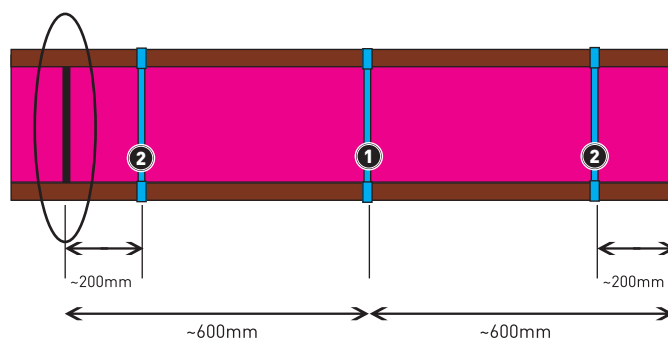

- (b) Strap up the joists and against the product using two staples at each fixing point. Always staple across the tape to avoid tearing

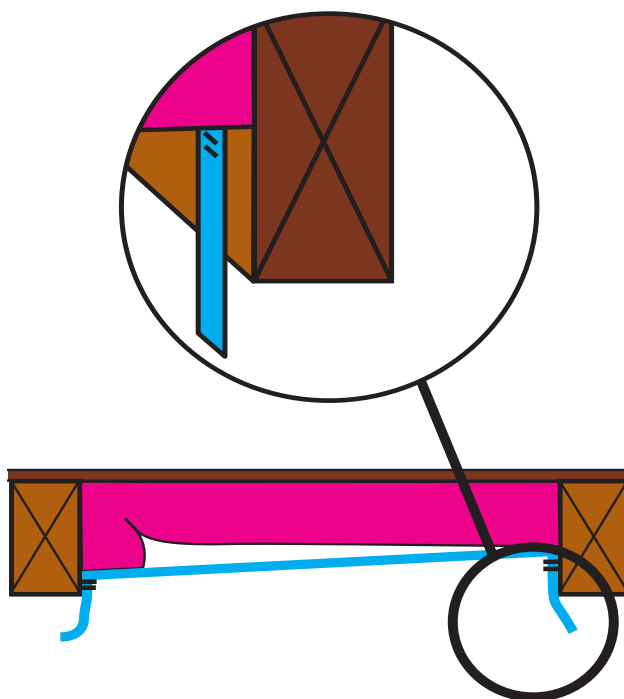

Fix a product label at an easy to find location to verify Building Code Compliance and for future reference.

Installing any underfloor insulation in your home with the addition of a dry heat source can create a warm, dry environment. This may lead to the drying out of unsealed timber floors.

How to install around...

1. Electrical Wiring

Install Pink® Batts® insulation behind electrical wiring. Electrical cables and equipment installed prior to 1989 may overheat and fail if partially or completely covered with bulk thermal insulation.

2. Lights

To reduce the risk of fire, cut and fit Pink® Batts® insulation around lights and ensure the following minimum clearances are adhered to:

Light Type	Minimum Clearance	Comments
CA80°C, CA135°C, IC and ICF rated lights	Nil	No minimum clearance is required however do not install insulation over the top of the light
Unknown classification lights 100 watt or less	100mm	From the outer edge of the light to ALL other new or existing insulation (transformers can sit in the clearance zone but MUST NOT be covered)
Unknown classification light greater than 100 watt	200mm	

3. Plumbing

Clearances are only required for pipes at the point it protrudes through the floor. Cut the insulation to maintain approx. 100mm clearances between insulation and plumbing, pipework and fittings.

Exposed Subfloors

If your house has an exposed subfloor (e.g. pole houses, houses less than 500m from the sea etc.) shield the underfloor insulation with hardboard to protect it from moisture and wind damage. Use 4mm oil tempered hardboard, or equivalent. Install with a 2.5mm separation between each sheet using flat head, hot dip galvanised nails.

Floor

Pink® Batts® SnugFloor®

PRODUCT DATA SHEET

Specification Notes

State the following:

Product required:

Pink® Batts® SnugFloor® insulation required R-value and narrow/wide
Pink® Batts® SnugFloor® Support Wires and the required size

	BRANZ APPRAISED	PRODUCT CODE	SIZE (mm)	NOMINAL STABILISED THICKNESS (mm)	NOMINAL TOTAL AREA PER PACK (m²)	APPROX COVERAGE PER PACK* (m²)	PIECES PER PACK
Insulation							
Pink® Batts® SnugFloor® R1.6 Narrow	✓	7134816	1220x480	70	9.4	8.8	16
Pink® Batts® SnugFloor® R2.6 Narrow	✓	7131451	1220x480	110	8.8	8.2	15
Pink® Batts® SnugFloor® R1.6 Wide	✓	7135816	1220x580	70	11.3	11.3	16
Pink® Batts® SnugFloor® R2.6 Wide	✓	7131601	1220x580	110	10.6	10.6	15

Support Wires

Pink® Batts® SnugFloor® Support Wires XS	✓	747001	380	-	-	13-15	5x100
Pink® Batts® SnugFloor® Support Wires S	✓	747002	410	-	-	14-16	5x100
Pink® Batts® SnugFloor® Support Wires M	✓	747003	440	-	-	15-17	5x100
Pink® Batts® SnugFloor® Support Wires L	✓	747004	470	-	-	17-18	5x100
Pink® Batts® SnugFloor® Support Wires XL	✓	747005	500	-	-	18-19	5x100
Pink® Batts® SnugFloor® Support Wires XXL	✓	747006	590	-	-	19-23	5x100

* Insulation coverage relates to maximum allowable joist spacing for each product, actual coverage may vary. Support wire coverage will vary depending on the insulation product selected. You will need approximately one pack of support wires per 2 bales of insulation.

Floor

Pink® Batts® SnugFloor®

PRODUCT DATA SHEET

Product Selection Guide

Recommended product for joist spacing

Insulation

Pink® Batts® SnugFloor® R1.6 Narrow

Pink® Batts® SnugFloor® R2.6 Narrow

Pink® Batts® SnugFloor® R1.6 Wide

Pink® Batts® SnugFloor® R1.6 Wide

Support Wires

Pink® Batts® SnugFloor® Support Wires XS

Pink® Batts® SnugFloor® Support Wires S

Pink® Batts® SnugFloor® Support Wires M

Pink® Batts® SnugFloor® Support Wires L

Pink® Batts® SnugFloor® Support Wires XL

Pink® Batts® SnugFloor® Support Wires XXL

* Insulation must be installed length wise across joists and surplus trimmed. See installation instructions section (page 4 of this data sheet) for more details.

Storage and Maintenance

Pink® Batts® SnugFloor® insulation and support wires must be protected from damage and weather, stored under cover in clean and dry conditions. The installed product must remain dry at all times. The underfloor area should be inspected annually for leaks and excessive dampness. If the product has become wet or damp the cause of fault (e.g. leak in plumbing) must be repaired immediately and the insulation replaced with new of an equivalent R-value.

Accreditations/Appraisals/Certifications*



Tasman Insulation New Zealand Ltd
Certified QMS



* Please refer to www.pinkbatts.co.nz for specific appraisal and accreditation details.



DISTRIBUTED BY

TASMAN INSULATION NEW ZEALAND LTD
9-15 HOLLOWAY PLACE, PENROSE
AUCKLAND 1061, NEW ZEALAND

This document supersedes all previous versions and may have been superseded; is a guide only and the purchaser should ascertain the suitability of this product for the end-use situation intended and when used in conjunction with other products; and is provided without prejudice to Tasman Insulation New Zealand Ltd (Tasman) standard terms of sale. Tasman retains the right to change specifications without prior notice. Refer to www.pinkbatts.co.nz or consult Tasman for further information. Do not use this product for any application not detailed in this document. All claims about this product are subject to any variation caused by normal manufacturing process and tolerances. The liability of Tasman and its employees and agents for any errors or omissions in this document or otherwise in relation to the product is limited to the fullest extent permitted by law. Except where the consumer acquires the goods for the purposes of a business, any rights a consumer may have under the Consumer Guarantees Act are not affected.