

LOUVRETEC COASTAL SERIES - SHUTTERS

BI-FOLD SHUTTER SYSTEMS

DETAILS AT A GLANCE

GENERAL

// Louvretec Coastal series bi-folding doors are available in two sizes

1. Bi-folding Coastal 25 - designed around a maximum panel weight of 25kg.
2. Bi-folding Coastal 100 - designed around a maximum panel weight of 75kg.

TOP HUNG:

// All Coastal Series bi-folds are top hung.

// As multi-panel bi-folds can load considerable weight to the top track suitable fixing at the head is essential - please contact Louvretec for Specific weight loadings.

TRANSOM:

// A transom is standard on all Coastal bi-folds

SHUTTER WEIGHT:

// Calculating the weight of a bi-folding louvered shutter - allow 15kg per sqm. This includes louvres, outer frame and transom.

MIX & MATCH:

// The same options of two pivot systems - namely Kiss Pivot and P40 Pivot, as well as simply end fixed available in the sliding shutters are also available in the bi-fold shutters.



TWO PANEL
BIFOLD DOORS



THREE PANEL
BIFOLD DOORS

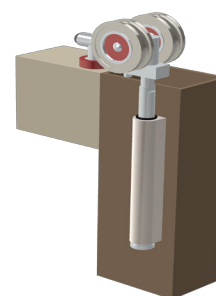

ALUMINIUM ROLLER
CARRIAGE

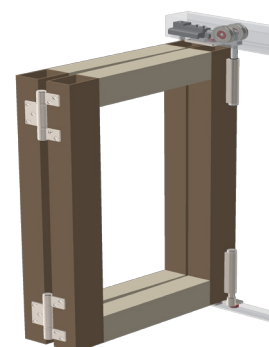

NO SIDE FRAMES
NO HINGES